

LEGEND	
	LIFT LOBBY/ LIFTS AREA/ STAIRCASES
	SHOPS & SERVICES/ EATING PLACES
	M/E SERVICE/ ANGULARY FACILITIES
	DRIVEWAY/ CARPARK/ LOADING/UNLOADING
	PAVEMENT
	ROAD ZONE - APPLICATION SITE
	OFFICE

資料來源：由申請人提供
SOURCE : SUBMITTED BY THE APPLICANT

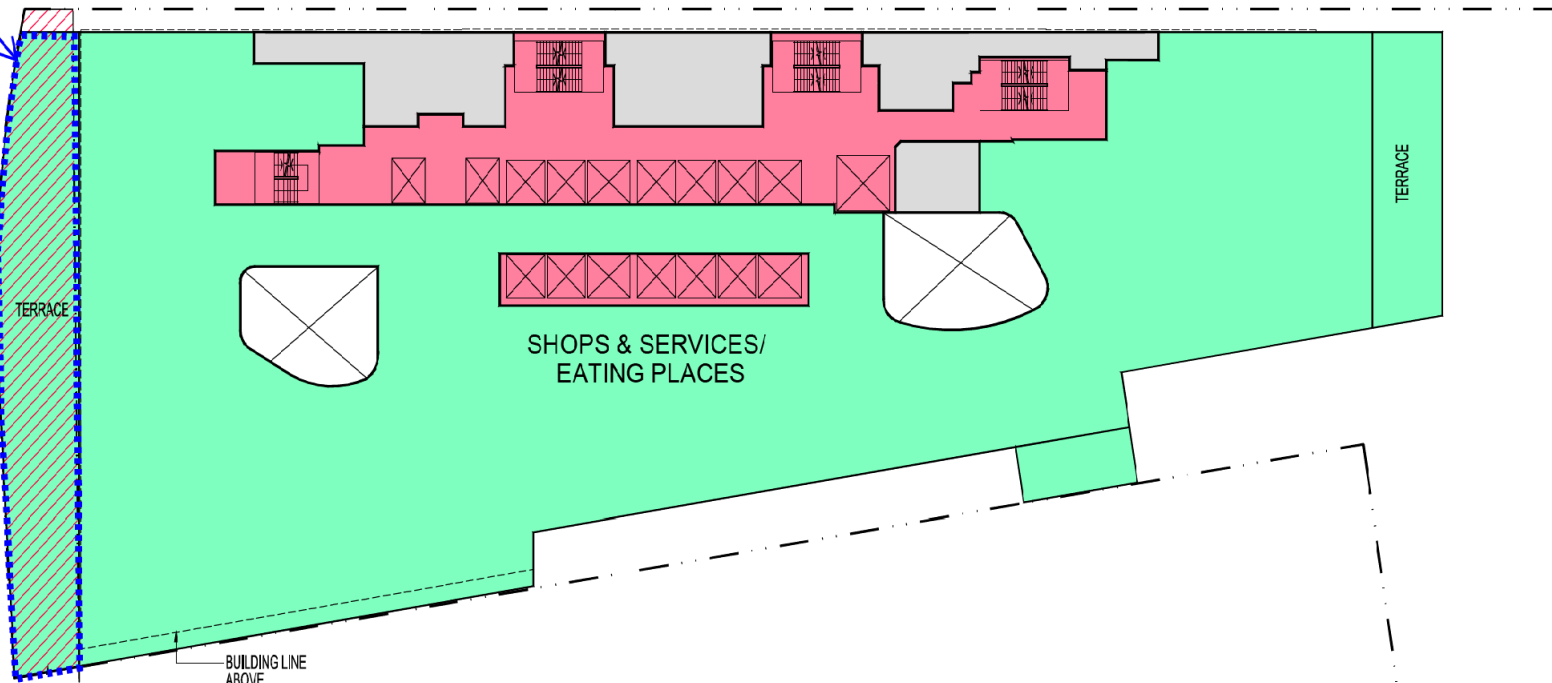





參考編號 REFERENCE No. A/H6/89	繪圖 DRAWING A - 1
---	-------------------------------

Terrace as Outdoor Seating Area within Road Zone (~205 sq.m.)



— ROAD ZONE - APPLICATION SITE

3/F DIAGRAM

LEGEND	
	LIFT LOBBY/ LIFTS AREA/ STAIRCASES
	SHOPS & SERVICES/ EATING PLACES
	M/E SERVICE/ ANCILLARY FACILITIES
	DRIVEWAY/ CARPARK / LOADING/UNLOADING
	PAVEMENT
	ROAD ZONE APPLICATION SITE
	OFFICE

資料來源：由申請人提供
SOURCE : SUBMITTED BY THE APPLICANT

參考編號 REFERENCE No.	繪圖 DRAWING
A/H6/89	A - 1a

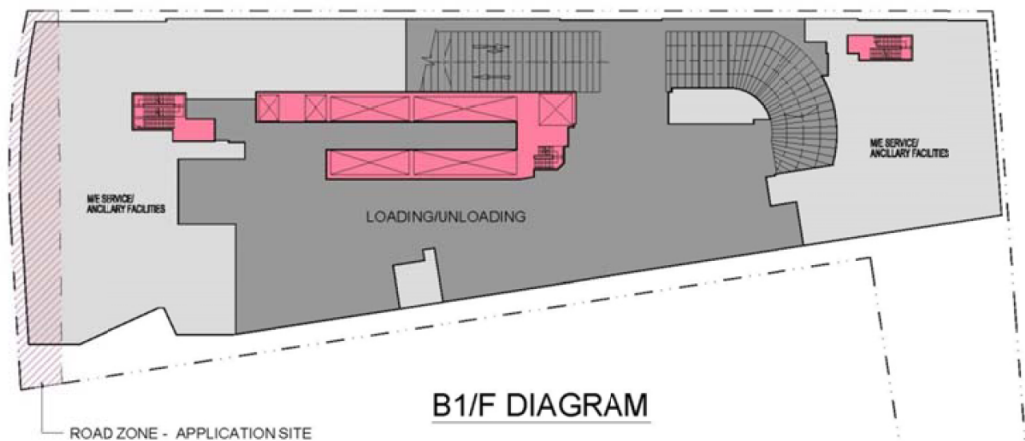
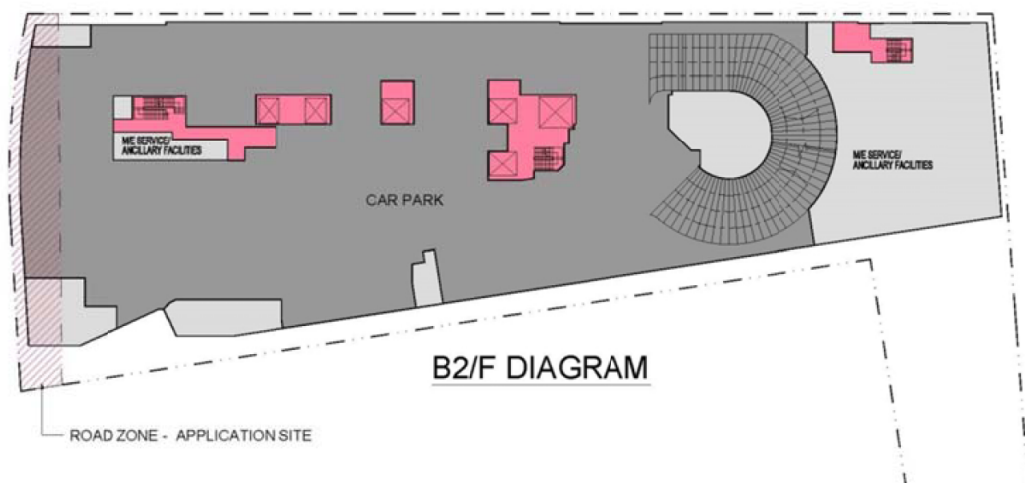
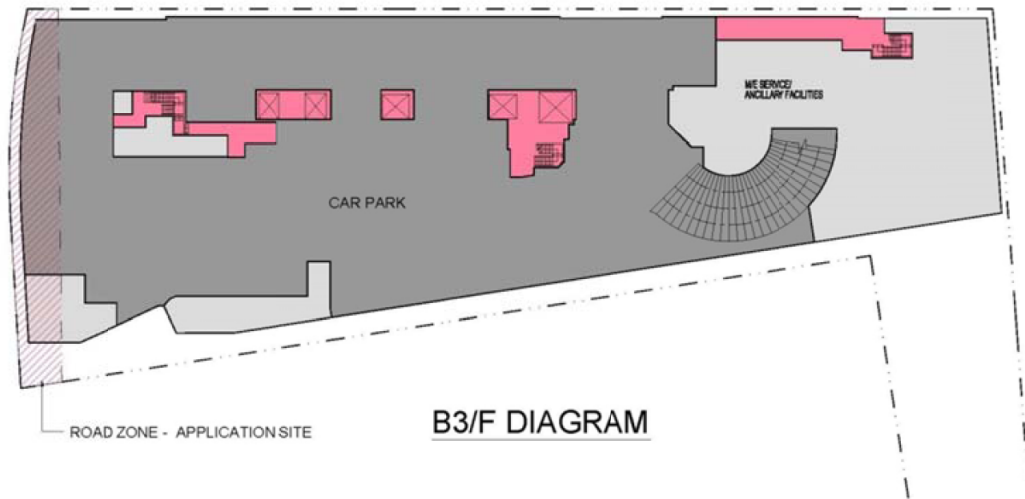

LEGEND	
 LIFT LOBBY/ LIFT AREA/ STAIRCASES	 PAVEMENT
 SHOPS & SERVICES/ EATING PLACES	 ROAD ZONE APPLICATION SITE
 ME SERVICE/ ANCLARY FACILITIES	 OFFICE
 DRIVEWAY/ CARPARK/ LOADING/UNLOADING	

Figure 9: B1/F,B2/F and B3/F layout plans indicating the portion within the “Road” zone. The eastern (top) edge of the podium is set back from the site boundary.

資料來源：由申請人提供
SOURCE : SUBMITTED BY THE APPLICANT

參考編號 REFERENCE No. A/H6/89	繪圖 DRAWING A - 2
---	-------------------------------

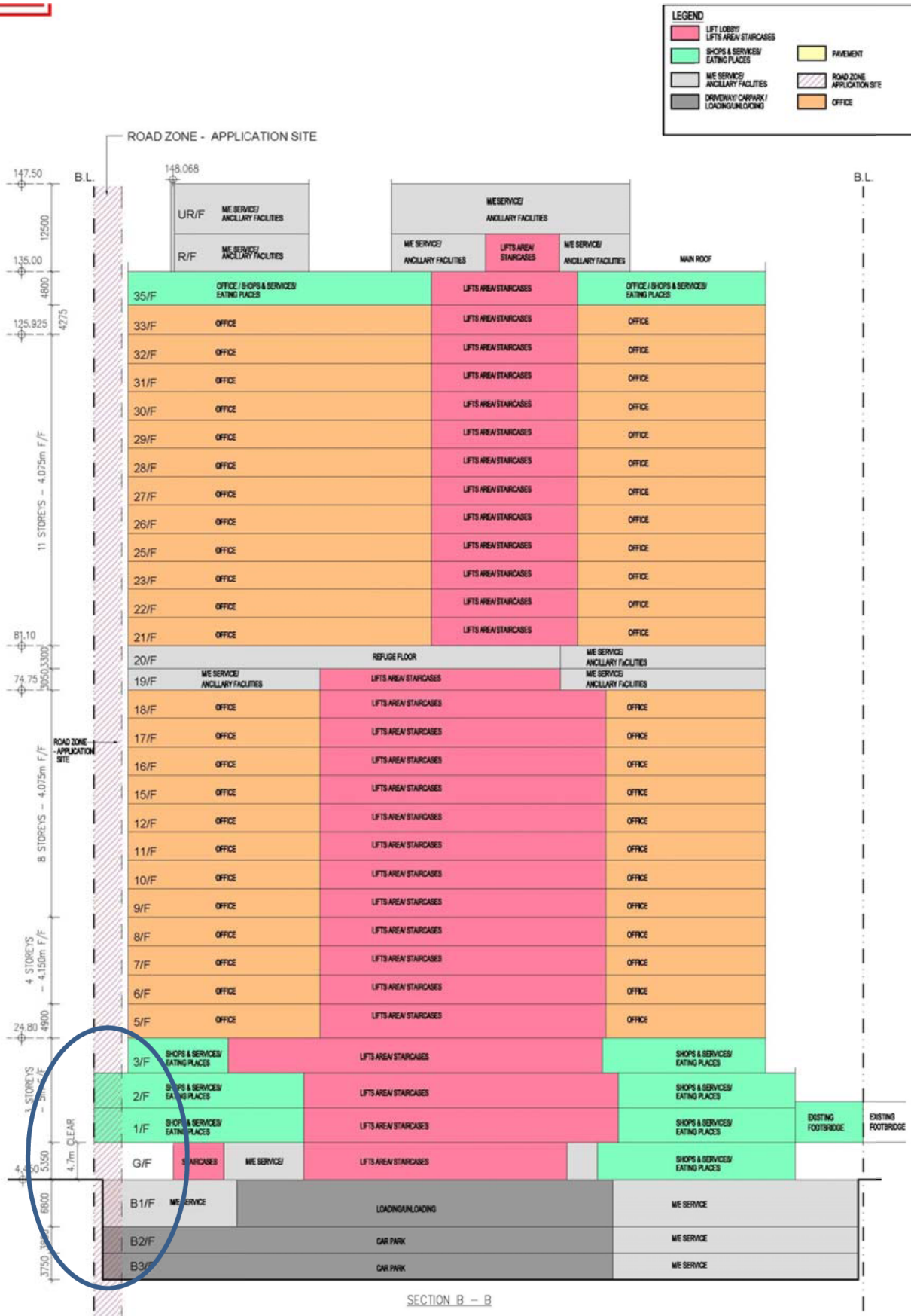

Figure 8: Section B – B of the Proposed Scheme, showing on the left, the building extending into the Application Site at all three basement levels and the over-hang at the 1/F and 2/F portions of the tower. The levels above the 3rd floor are set back from the “Road” zone. The G/F is also set back, complies with the limit of the “Road” zone, and the clear headroom will permit vehicle movements.

資料來源：由申請人提供
SOURCE : SUBMITTED BY THE APPLICANT

參考編號 REFERENCE No. A/H6/89	繪圖 DRAWING A - 3
---	-------------------------------

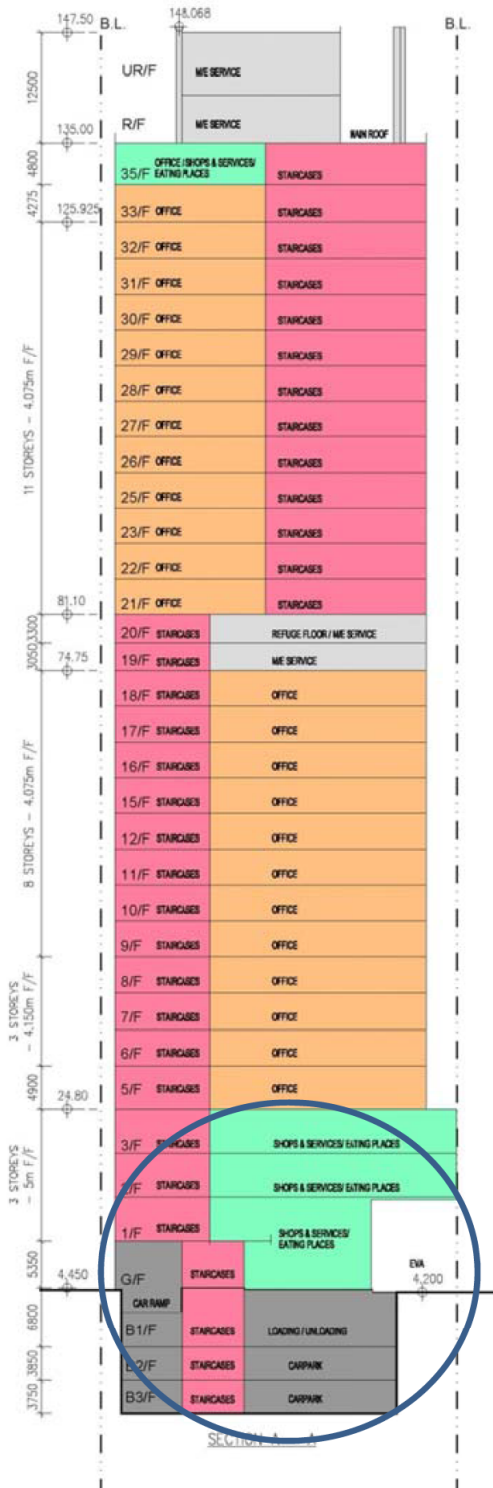
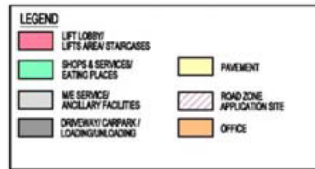
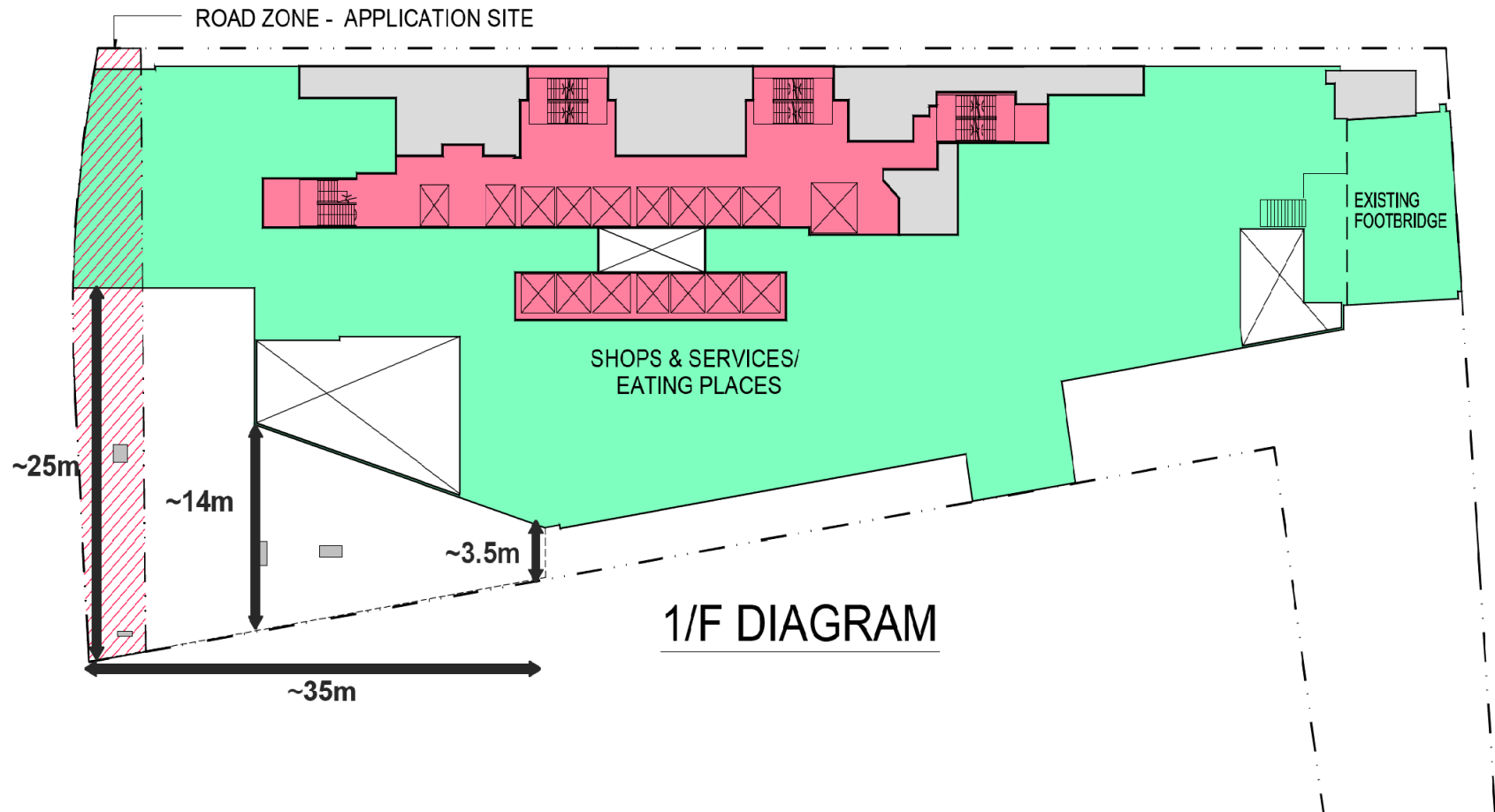









Figure 7: Section A – A of the Proposed Scheme showing the double height entrance at the north-western portion of the site (adjacent to the World Trade Centre, and fronting on to Gloucester Road) and the 3 basement levels.

資料來源：由申請人提供
SOURCE : SUBMITTED BY THE APPLICANT

參考編號 REFERENCE No. A/H6/89	繪圖 DRAWING A - 4
---	-------------------------------



LEGEND	
	LIFT LOBBY/ LIFTS AREA/ STAIRCASES
	SHOPS & SERVICES/ EATING PLACES
	M/E SERVICE/ ANCILLARY FACILITIES
	DRIVEWAY/ CARPARK / LOADING/UNLOADING
	PAVEMENT
	ROAD ZONE APPLICATION SITE
	OFFICE

資料來源：由申請人提供
SOURCE : SUBMITTED BY THE APPLICANT

參考編號 REFERENCE No. A/H6/89	繪圖 DRAWING A - 4a
---	-------------------------

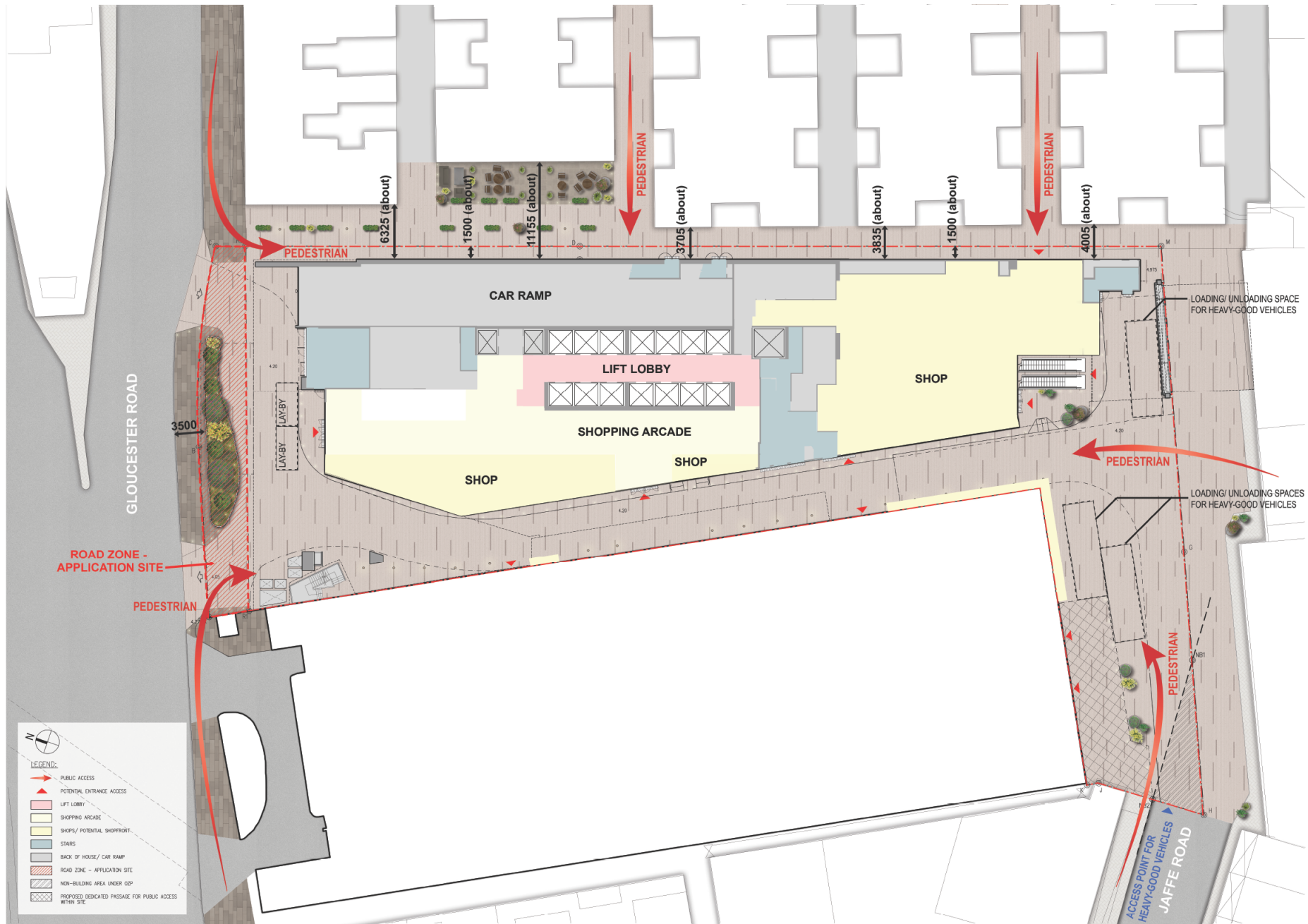

資料來源：由申請人提供
 SOURCE : SUBMITTED BY THE APPLICANT

參考編號 REFERENCE No. A/H6/89	繪圖 DRAWING A - 5
---	-------------------------------

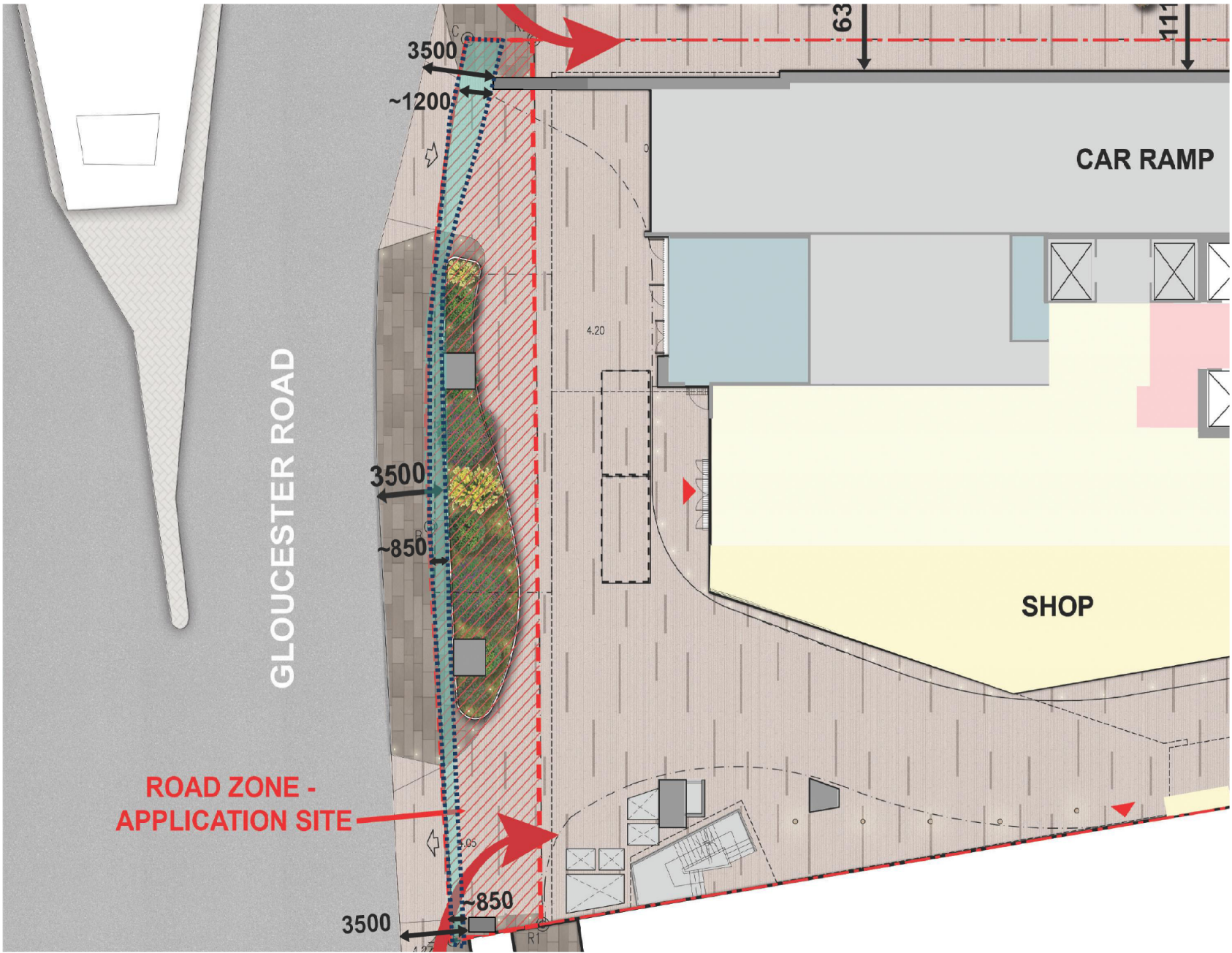

資料來源：由申請人提供
 SOURCE : SUBMITTED BY THE APPLICANT

參考編號 REFERENCE No. A/H6/89	繪圖 DRAWING A - 5a
---	-------------------------

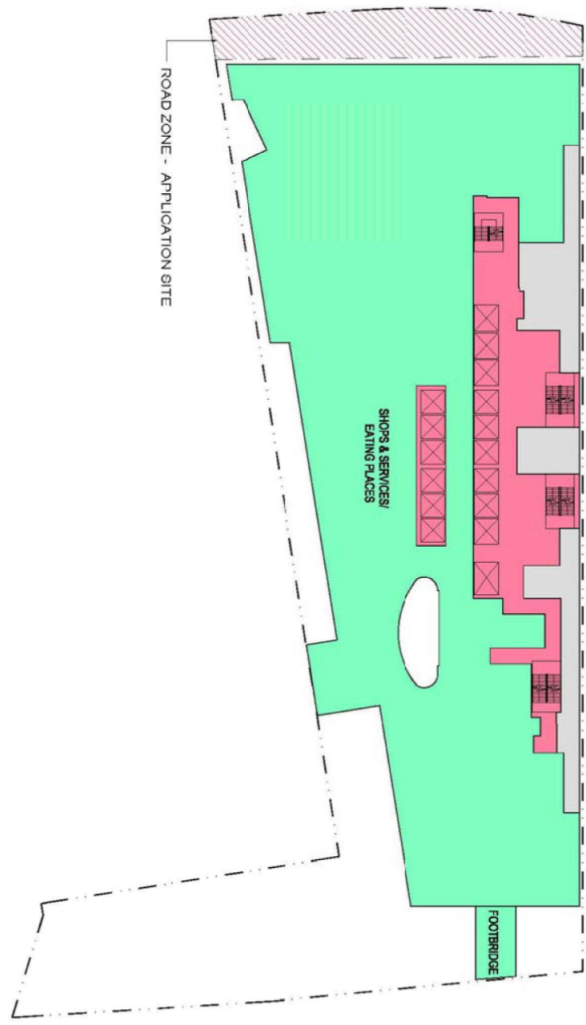
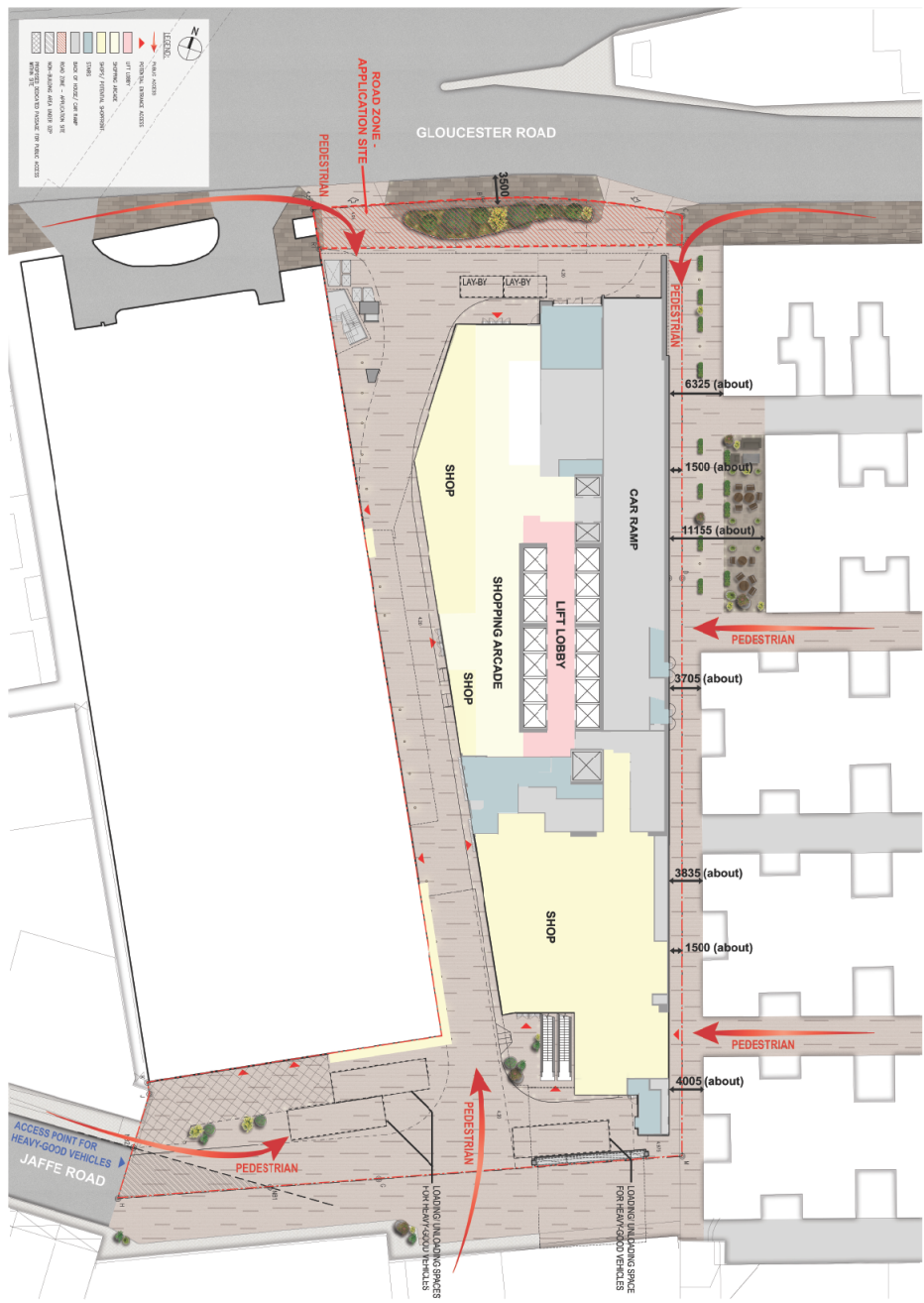

資料來源：由申請人提供
 SOURCE : SUBMITTED BY THE APPLICANT

參考編號 REFERENCE No. A/H6/89	繪圖 DRAWING A - 5b
---	--------------------------------

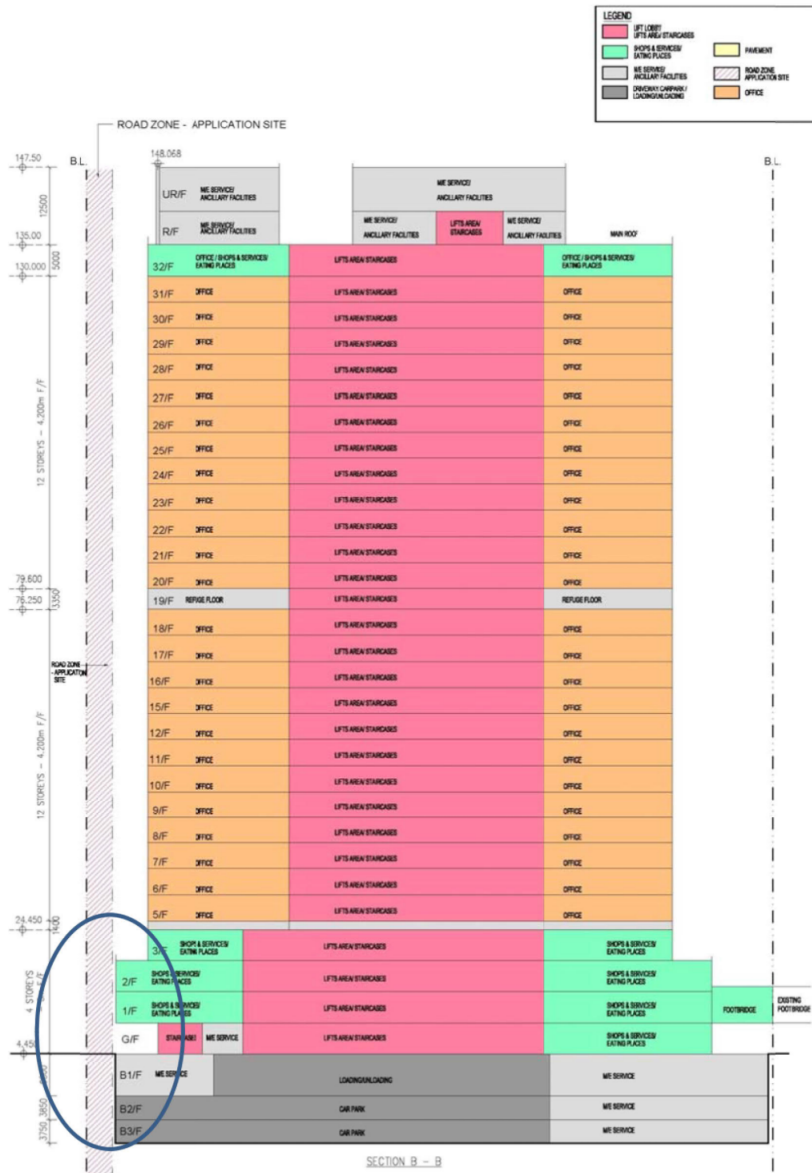

Figure 4: Approved GBP Schematic Section B-B indicating three basement levels and 4 podium levels. The building is setback from the "Road" zone.

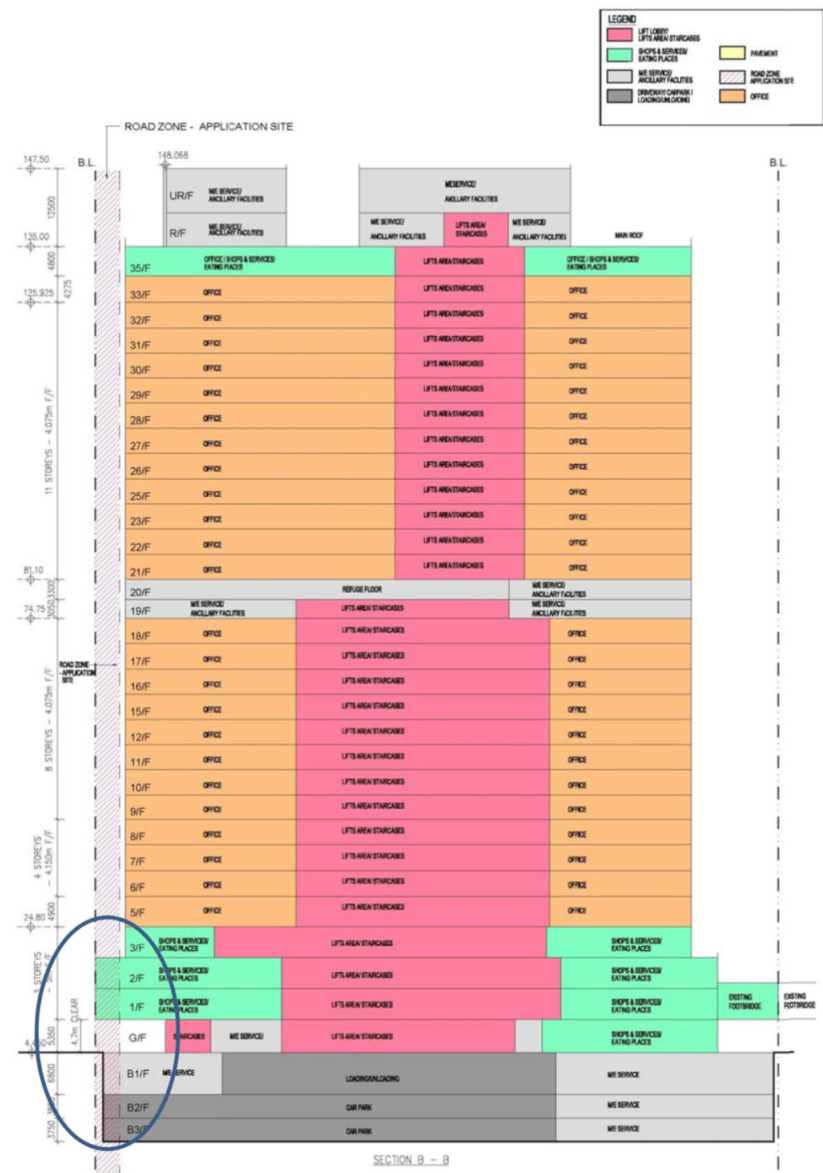

Figure 8: Section B – B of the Proposed Scheme, showing on the left, the building extending into the Application Site at all three basement levels and the over-hang at the 1/F and 2/F portions of the tower. The levels above the 3rd floor are set back from the "Road" zone. The G/F is also set back, complies with the limit of the "Road" zone, and the clear headroom will permit vehicle movements.

資料來源：由申請人提供
SOURCE : SUBMITTED BY THE APPLICANT

參考編號
REFERENCE No.
A/H6/89

繪圖
A - 5c

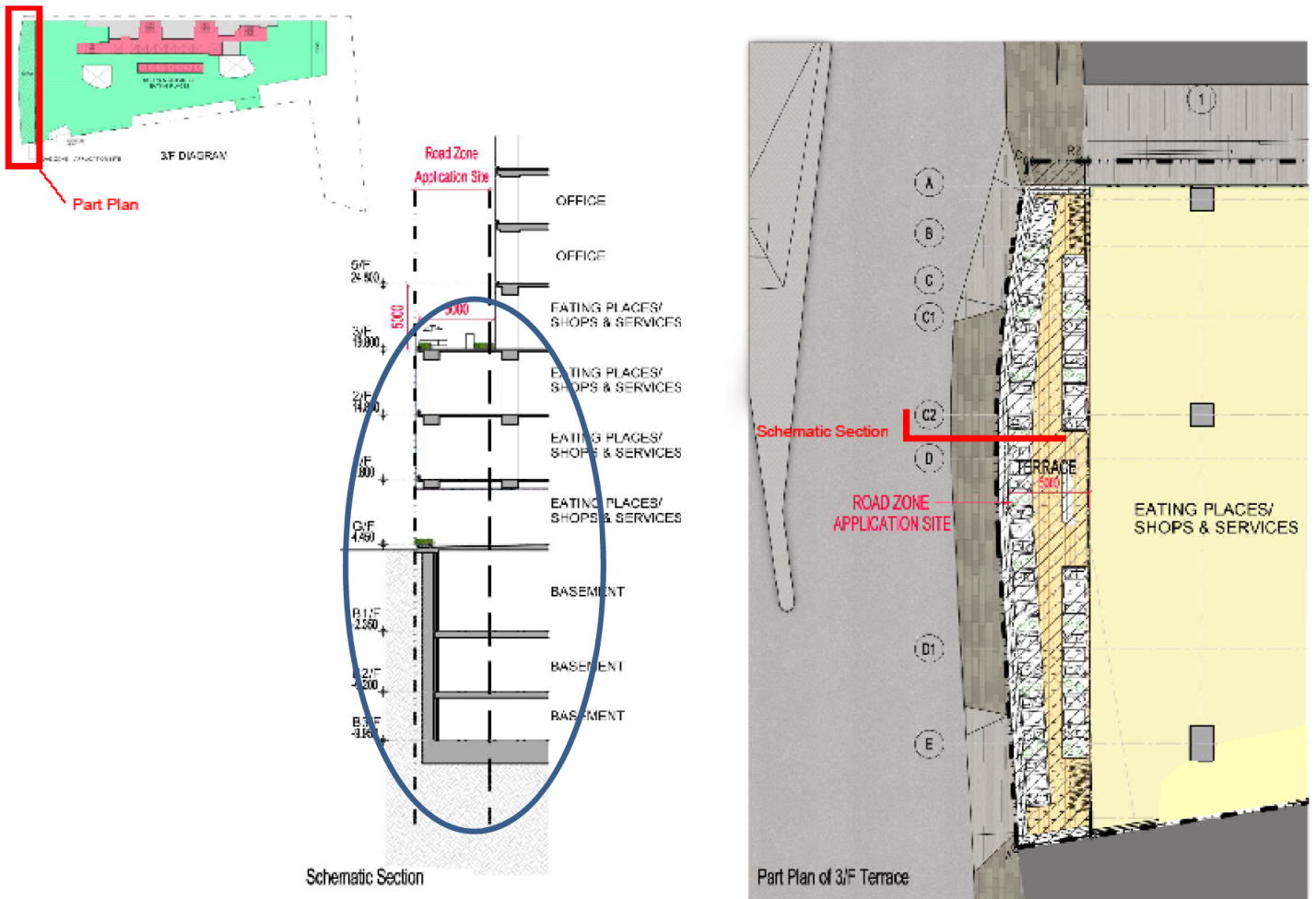

Figure 5: The Proposed Scheme in Schematic Section on the left shows the extent of the “Road” zone and the basement levels, the G/F arrival area and the coverage of pedestrian activities provided by the extension of 1/F and 2/F by approximately 5m. The Part Plan on the left shows the 3/F terrace as an outside seating area.



Figure6: Indicative Scheme This is a preliminary indication of how the Proposed Scheme may look. It is much lighter in terms of construction and material when compared with the Excelsior Hotel in **Photo 2** above. The cover offered to the public pedestrian footpath is clearly shown. The details will change as design development proceeds.

資料來源：由申請人提供
SOURCE : SUBMITTED BY THE APPLICANT

參考編號 REFERENCE No. A/H6/89	繪圖 DRAWING A - 6
---	-------------------------------

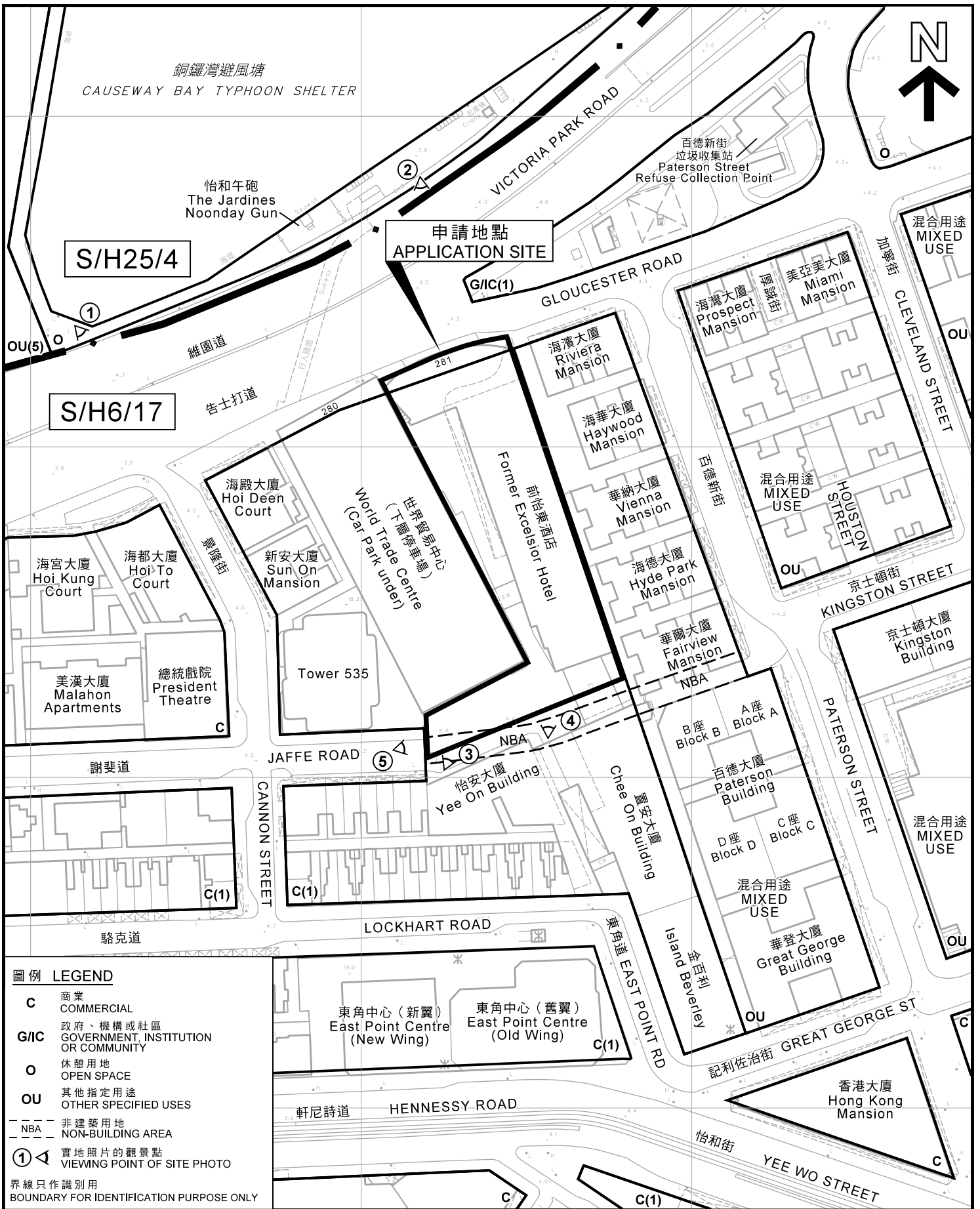

圖例 LEGEND

C	商業 COMMERCIAL
G/I/C	政府、機構或社區 GOVERNMENT, INSTITUTION OR COMMUNITY
O	休憩用地 OPEN SPACE
OU	其他指定用途 OTHER SPECIFIED USES
NBA	非建築用地 NON-BUILDING AREA
①	實地照片的觀景點 VIEWING POINT OF SITE PHOTO

界線只作識別用
BOUNDARY FOR IDENTIFICATION PURPOSE ONLY

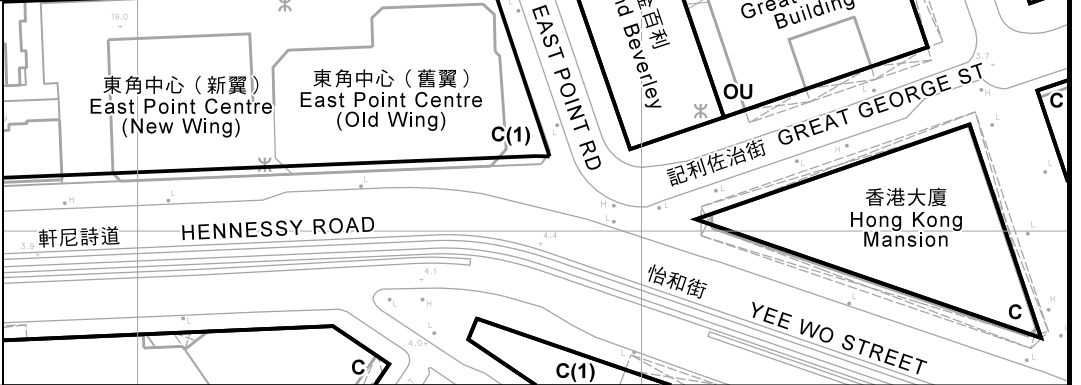

<p>本摘要圖於2020年3月27日擬備， 所根據的資料為測量圖編號 11-SW-10D</p> <p>EXTRACT PLAN PREPARED ON 27.3.2020 BASED ON SURVEY SHEET No. 11-SW-10D</p>	<p>平面圖 SITE PLAN</p> <p>擬議「辦公室」、「食肆」及「商店及服務行業」用途 香港銅鑼灣告士打道281號 PROPOSED 'OFFICE', 'EATING PLACE' AND 'SHOP AND SERVICES' USES 281 GLOUCESTER ROAD, CAUSEWAY BAY, HONG KONG</p> <p>SCALE 1 : 1 500 比例尺</p> <p style="text-align: center;"> 米 25 0 25 50 米 </p> <p style="text-align: center;">METRES</p>	<p>規劃署 PLANNING DEPARTMENT</p>
		<p>參考編號 REFERENCE No.</p> <p>A/H6/89</p>
		<p>圖 PLAN</p> <p>A - 2</p>



從維園道東南方向望向申請地點的景觀(近怡和午炮)
SOUTHEASTERN VIEW OF THE APPLICATION SITE FROM VICTORIA PARK ROAD (NEAR NOONDAY GUN)

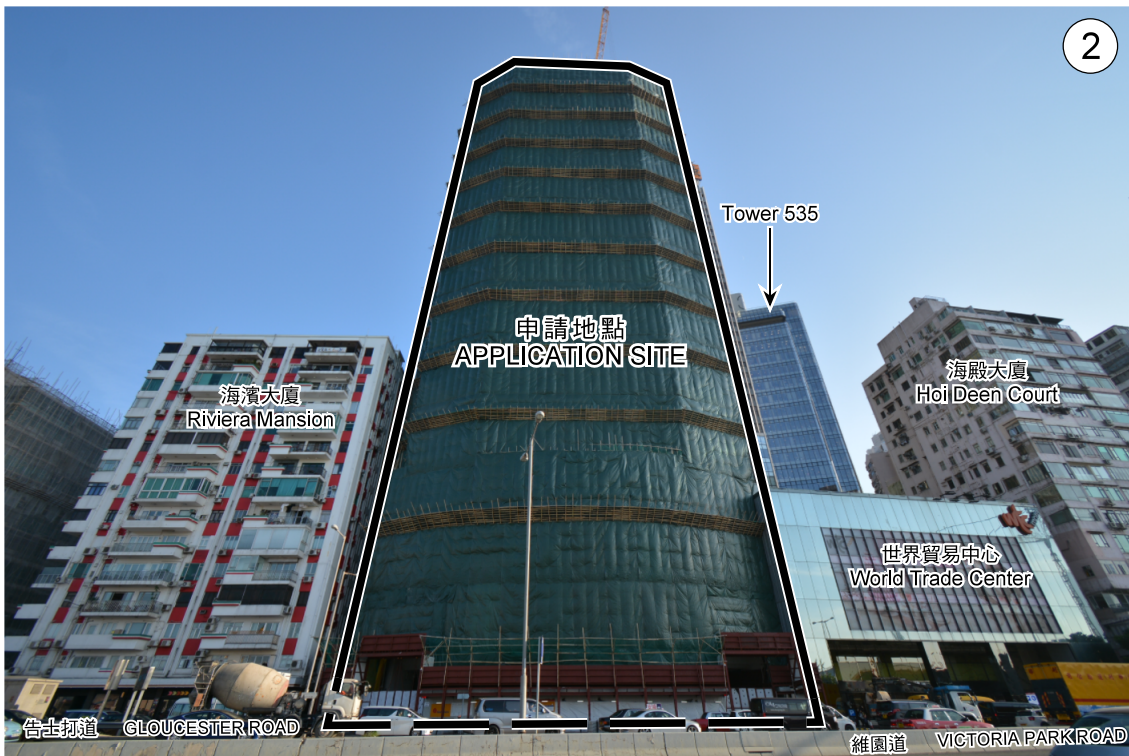

從維園道正面方向望向申請地點的景觀
FRONT VIEW OF THE APPLICATION SITE FROM VICTORIA PARK ROAD

界線只作識別用
BOUNDARY FOR IDENTIFICATION PURPOSES ONLY

本圖於2020年3月27日擬備，
所根據的資料為攝於
2019年11月1日及
2020年1月10日的實地照片
PLAN PREPARED ON 27.3.2020
BASED ON SITE PHOTOS
TAKEN ON 1.11.2019 & 10.1.2020

實地照片 SITE PHOTO

擬議「辦公室」、「食肆」及「商店及服務行業」用途
香港銅鑼灣告士打道281號
PROPOSED 'OFFICE', 'EATING PLACE' AND 'SHOP AND SERVICES' USES
281 GLOUCESTER ROAD, CAUSEWAY BAY, HONG KONG

規劃署
PLANNING
DEPARTMENT



參考編號
REFERENCE No.
A/H6/89

圖 PLAN
A - 3



從謝斐道東北方向望向申請地點的景觀
NORTHEASTERN VIEW OF THE APPLICATION SITE FROM
JAFFE ROAD



從毗鄰置安大廈望向申請地點的景觀
VIEW OF THE APPLICATION SITE FROM ADJOINING
CHEE ON BUILDING

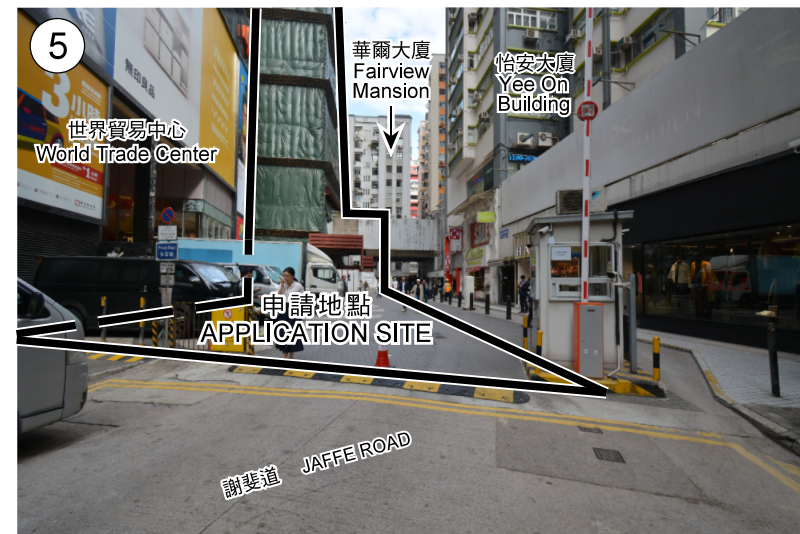

從謝斐道東方向望向申請地點的景觀
EASTERN VIEW OF THE APPLICATION SITE FROM
JAFFE ROAD

界線只作識別用
BOUNDARY FOR IDENTIFICATION PURPOSES ONLY

本圖於2020年4月1日擬備，
所根據的資料為攝於
2019年11月1日及
2020年1月10日的實地照片
PLAN PREPARED ON 1.4.2020
BASED ON SITE PHOTOS
TAKEN ON 1.11.2019 & 10.01.2020

實地照片 SITE PHOTO

擬議「辦公室」、「食肆」及「商店及服務行業」用途
香港銅鑼灣告士打道281號
PROPOSED 'OFFICE', 'EATING PLACE' AND 'SHOP AND SERVICES' USES
281 GLOUCESTER ROAD, CAUSEWAY BAY, HONG KONG

規劃署
PLANNING
DEPARTMENT



參考編號
REFERENCE No.
A/H/6/89

圖 PLAN
A - 4