

APPLICATION FOR CHANGE OF  
USE FROM INDUSTRIAL USE TO  
SHOP AND SERVICES

WORKSHOP 1-6, G/F, WING LEE  
INDUSTRIAL BUILDING, NOS. 54, 56  
& 58 TONG MI ROAD KOWLOON

Plan 1

Scale  
1:200

(資料來源：由申請人提供)  
(Source : submitted by the Applicant)

參考編號 REFERENCE No. <b>A/K3/586</b>	繪圖 DRAWING A - 1
--	------------------------

1. 800 LITE. R.C.C. ROOF TRUSS, BR. TRUSS.  
2. 400 LITE. R.C.C. ROOF TRUSS, BR. TRUSS.  
3. 200 LITE. R.C.C. ROOF TRUSS, BR. TRUSS.  
4. 100 LITE. R.C.C. ROOF TRUSS, BR. TRUSS.  
5. 50 LITE. R.C.C. ROOF TRUSS, BR. TRUSS.

LANE

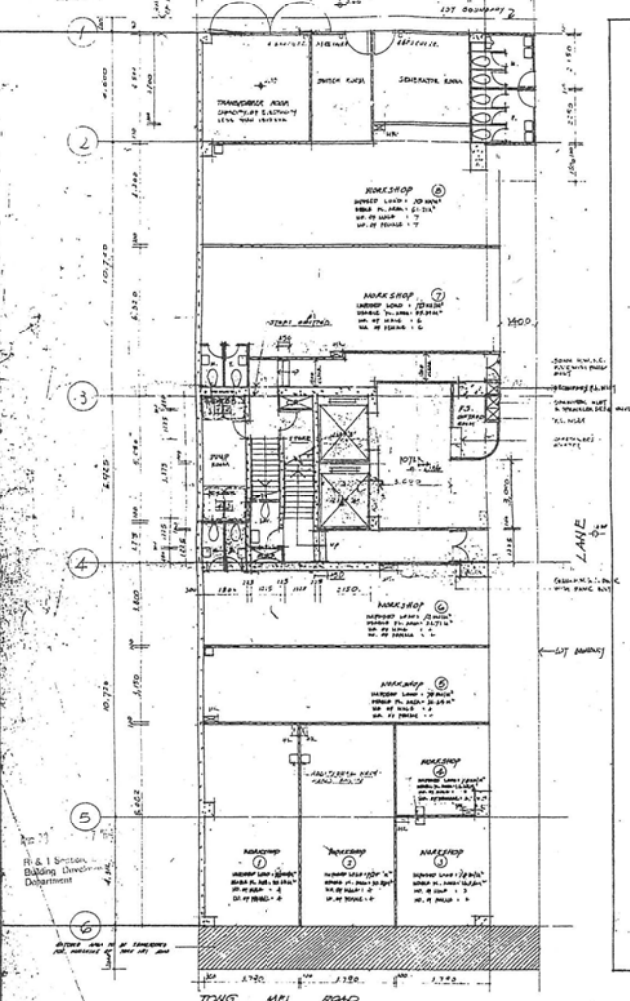

GROUND FLOOR PLAN

SPRINKLER SYSTEM TO BE PROVIDED

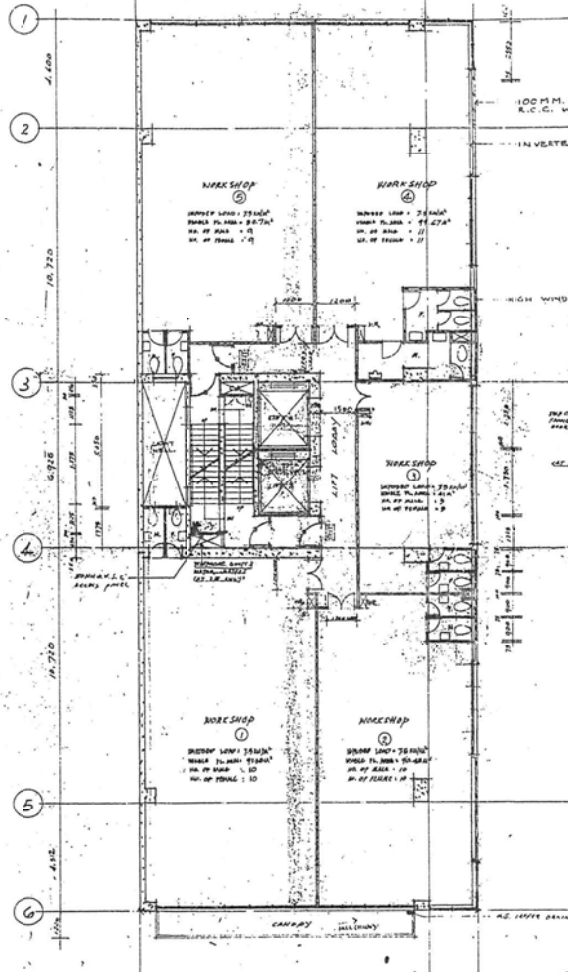

1ST - 3RD FLOOR PLAN

SPRINKLER SYSTEM TO BE PROVIDED

REV. 1. 19.8.81  
REV. 2. 19.8.81  
REV. 3. 19.8.81  
REV. 4. 19.8.81  
REV. 5. 19.8.81

ALL MEASUREMENTS MUST BE CHECKED AT THE SITE-DO NOT SCALE DRAWINGS-FOUNDED DIMENSIONS TO BE OBSERVED-READ THIS DRAWING IN CONNECTION WITH GENERAL ARCHITECTURAL PLANS AND OTHER RELATED DOCUMENTS. THE ARCHITECT TO BE NOTIFIED IMMEDIATELY OF ANY DISCREPANCY FOUND THEREIN.

JOHN S. CHAU  
HONG KONG  
TEL: 5-2522778  
SIGNATURE FOR SUBMISSION FOR CONSTRUCTION  
GORDON K.F. YEUNG  
ARCHITECT

Approved by  
LIVING CHIEF  
PRO BUILDING AUTHORITY  
19 SEP 1984

PROJECT  
PROPOSED REDEVELOPMENT  
ON SDA 54-56 TONG HAI ROAD,  
K.L.S. 4015 R.P.S. O.F.  
S.C., KOWLOON  
DRAWING TITLE  
FLOOR PLANS:  
GROUND FLOOR  
1ST & 2ND FLOOR

AMENDMENT

ARCHITECT	JOHN S. CHAU
DRAWN BY	JOHN S. CHAU
CHECKED BY	JOHN S. CHAU
DATE	5-5-81
CLASSIFICATION	2.02

參考編號  
REFERENCE No.  
A/K3/586

繪圖  
DRAWING  
A - 2

(資料來源：由申請人提供)  
(Source : submitted by the Applicant)

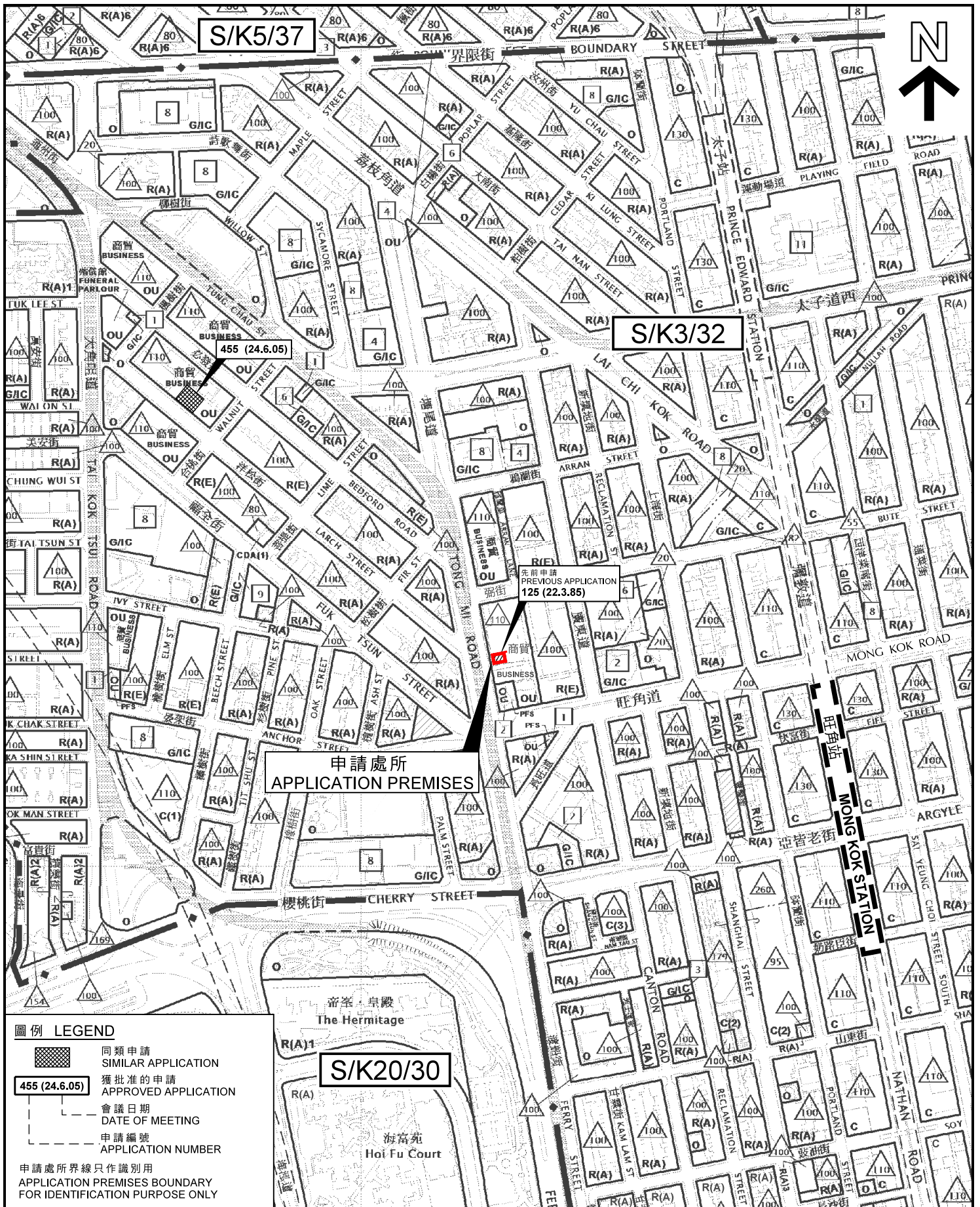

**圖例 LEGEND**

- 同類申請  
SIMILAR APPLICATION
- 獲批准的申請  
APPROVED APPLICATION
- 會議日期  
DATE OF MEETING
- 申請編號  
APPLICATION NUMBER

申請處所界線只作識別用  
APPLICATION PREMISES BOUNDARY  
FOR IDENTIFICATION PURPOSE ONLY

本摘要圖於2019年12月9日擬備，所根據的資料為：於2019年10月8日核准的分區計劃大綱圖編號 S/K3/32，於2016年12月6日核准的分區計劃大綱圖編號 S/K5/37，以及於2014年9月23日核准的分區計劃大綱圖編號 S/K20/30  
EXTRACT PLAN PREPARED ON 9.12.2019 BASED ON OUTLINE ZONING PLANS No. S/K3/32 APPROVED ON 8.10.2019, S/K5/37 APPROVED ON 6.12.2016 AND S/K20/30 APPROVED ON 23.9.2014

**位置圖 LOCATION PLAN**

商店及服務行業  
九龍塘尾道54、56及58號永利工業大廈地下1-6號單位  
SHOP AND SERVICES  
WORKSHOPS 1-6, G/F, WING LEE INDUSTRIAL BUILDING,  
54, 56 & 58 TONG MI ROAD, KOWLOON

SCALE 1:5 000 比例尺

米 100
0
100
200 米

**規劃署  
PLANNING  
DEPARTMENT**

參考編號  
REFERENCE No.

**A/K3/586**

圖 PLAN

**A - 1**

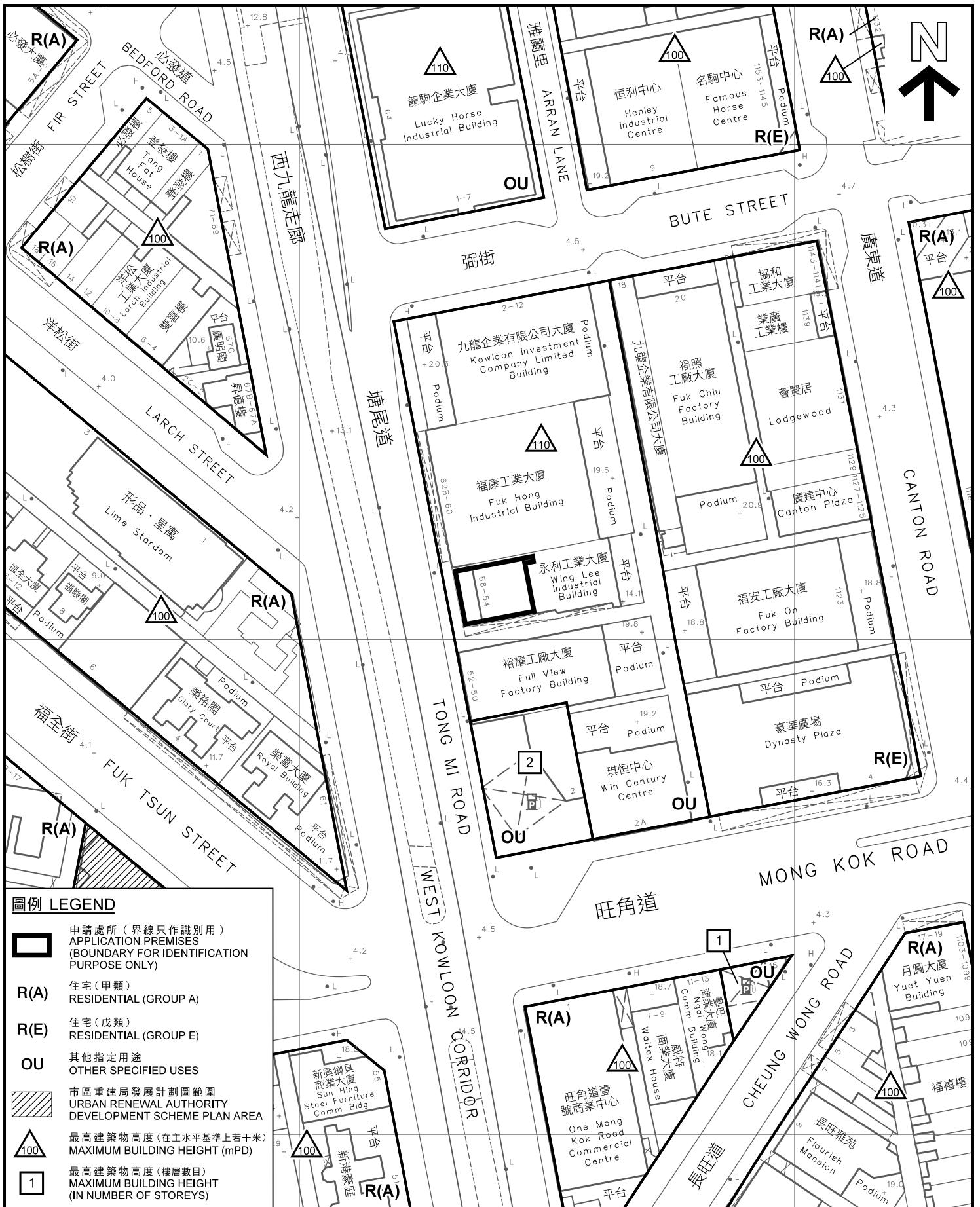

**圖例 LEGEND**

- 申請處所 (界線只作識別用)  
APPLICATION PREMISES  
(BOUNDARY FOR IDENTIFICATION  
PURPOSE ONLY)
- R(A)** 住宅(甲類)  
RESIDENTIAL (GROUP A)
- R(E)** 住宅(戊類)  
RESIDENTIAL (GROUP E)
- OU** 其他指定用途  
OTHER SPECIFIED USES
- 市區重建局發展計劃圖範圍  
URBAN RENOVATION AUTHORITY  
DEVELOPMENT SCHEME PLAN AREA
- 最高建築物高度 (在主水平基準上若干米)  
MAXIMUM BUILDING HEIGHT (mPD)
- 最高建築物高度 (樓層數目)  
MAXIMUM BUILDING HEIGHT  
(IN NUMBER OF STOREYS)

**平面圖 SITE PLAN**

商店及服務行業  
九龍塘尾道54、56及58號永利工業大廈地下1-6號單位  
SHOP AND SERVICES  
WORKSHOPS 1-6, G/F, WING LEE INDUSTRIAL BUILDING,  
54, 56 & 58 TONG MI ROAD, KOWLOON

規劃署  
**PLANNING  
DEPARTMENT**



本摘要圖於2019年12月2日擬備，  
所根據的資料為測量圖編號  
11-NW-19A  
EXTRACT PLAN PREPARED ON 2.12.2019  
BASED ON SURVEY SHEET No.  
11-NW-19A

參考編號  
REFERENCE No.  
**A/K3/586**

圖 PLAN  
**A - 2**

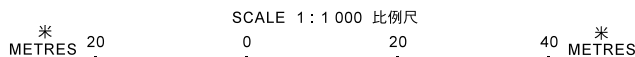

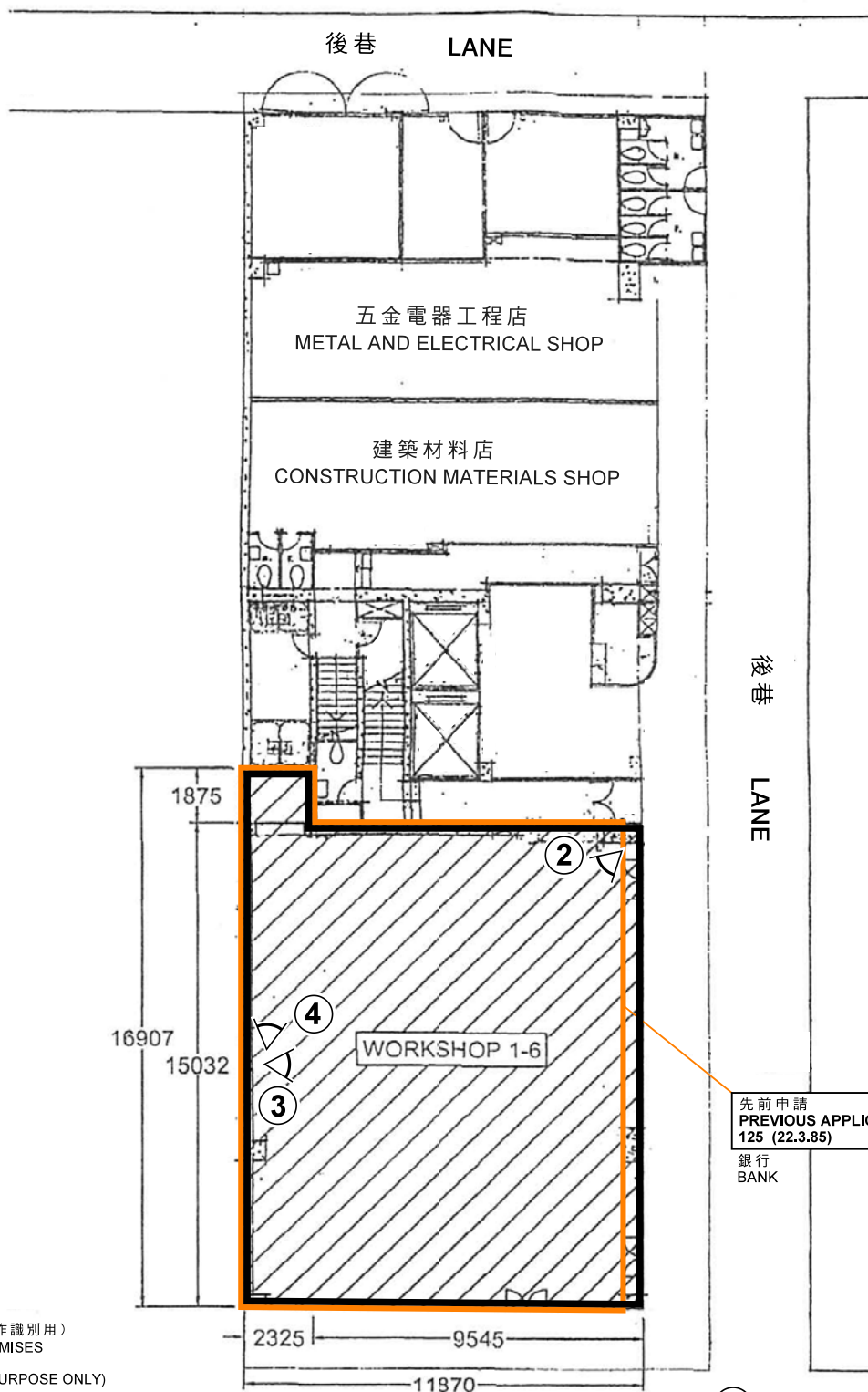

圖例 LEGEND



申請處所(界線只作識別用)  
APPLICATION PREMISES  
(BOUNDARY FOR  
IDENTIFICATION PURPOSE ONLY)

125 (22.3.85)

獲批准的申請  
APPROVED APPLICATION

125 (22.3.85)

--- 會議日期  
DATE OF MEETING  
- - - 申請編號  
APPLICATION NUMBER

① ◁ 實地照片的觀景點  
VIEWING POINT OF SITE PHOTO

塘尾道 TONG MEI ROAD

地下平面圖 GROUND FLOOR PLAN

本摘要圖於2019年12月13日擬備  
EXTRACT PLAN PREPARED ON 13.12.2019

先前及現時申請  
PREVIOUS AND CURRENT APPLICATIONS

商店及服務行業  
九龍塘尾道54、56及58號永利工業大廈地下1-6號單位  
SHOP AND SERVICES  
WORKSHOPS 1-6, G/F, WING LEE INDUSTRIAL BUILDING,  
54, 56 & 58 TONG MI ROAD, KOWLOON

規劃署  
PLANNING  
DEPARTMENT



參考編號  
REFERENCE No.  
A/K3/586

圖 PLAN  
A - 2a



照片 1 - 申請處所  
PHOTO 1 - APPLICATION PREMISES



照片 2 - 申請處所  
PHOTO 2 - APPLICATION PREMISES

界線只作識別用  
BOUNDARY FOR  
IDENTIFICATION PURPOSE ONLY

本摘要圖於2019年12月4日擬備，  
所根據的資料為攝於  
2019年11月15日的實地照片  
PLAN PREPARED ON 4.12.2019  
BASED ON SITE PHOTOS  
TAKEN ON 15.11.2019

實地照片 SITE PHOTOS

商店及服務行業  
九龍塘尾道54、56及58號永利工業大廈地下1-6號單位  
SHOP AND SERVICES  
WORKSHOPS 1-6, G/F, WING LEE INDUSTRIAL BUILDING,  
54, 56 & 58 TONG MI ROAD, KOWLOON

規劃署  
PLANNING  
DEPARTMENT



參考編號  
REFERENCE No.  
A/K3/586

圖 PLAN  
A - 3



照片 3 — 申請處所  
PHOTO 3 - APPLICATION PREMISES



照片 4 — 申請處所  
PHOTO 4 - APPLICATION PREMISES

本摘要圖於2019年12月4日擬備，  
所根據的資料為攝於  
2019年11月15日的實地照片  
PLAN PREPARED ON 4.12.2019  
BASED ON SITE PHOTOS  
TAKEN ON 15.11.2019

實地照片 SITE PHOTOS

商店及服務行業  
九龍塘尾道54、56及58號永利工業大廈地下1-6號單位  
SHOP AND SERVICES  
WORKSHOPS 1-6, G/F, WING LEE INDUSTRIAL BUILDING,  
54, 56 & 58 TONG MI ROAD, KOWLOON

規劃署  
PLANNING  
DEPARTMENT





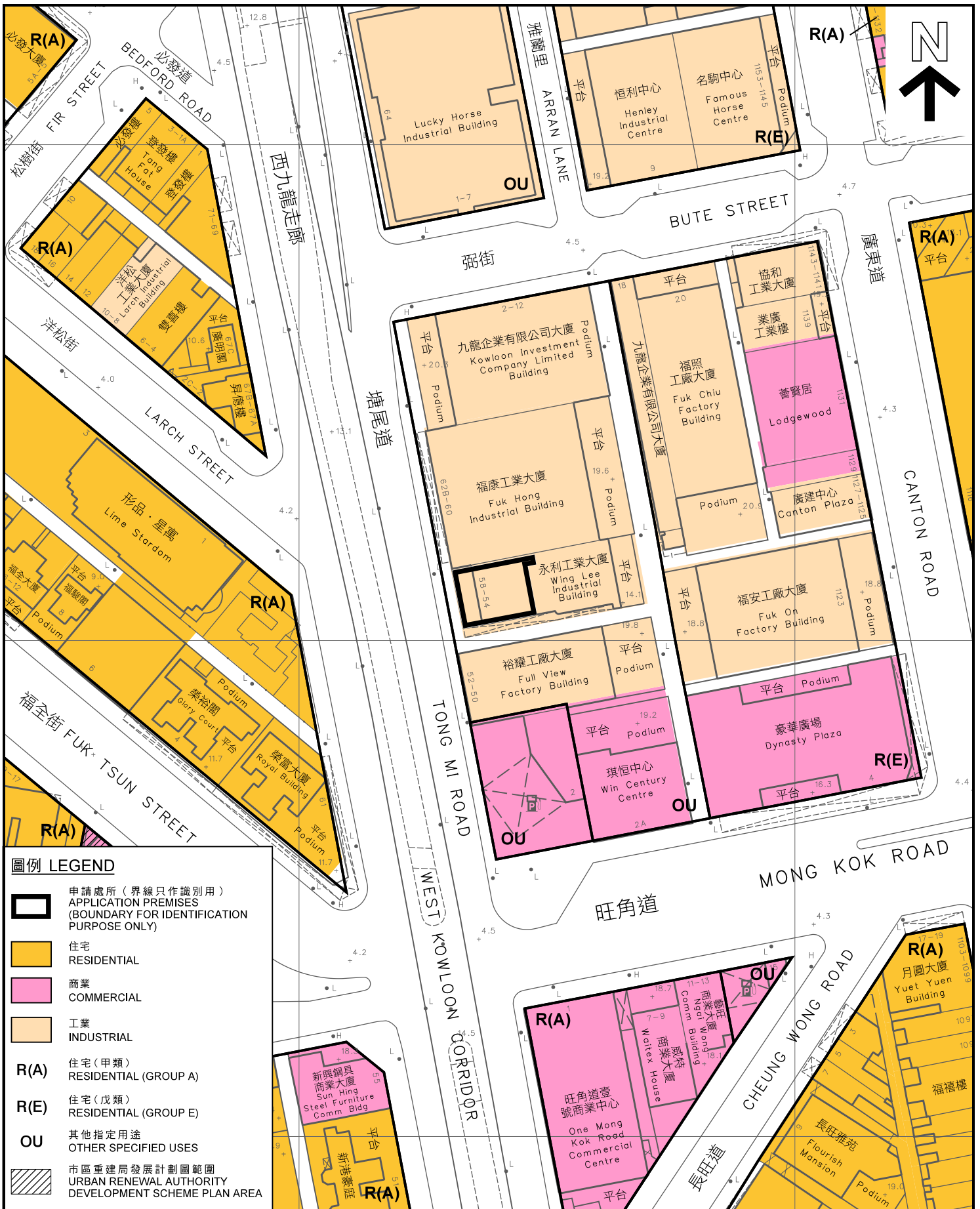

參考編號  
REFERENCE No.  
A/K3/586

圖 PLAN  
A - 4



**圖例 LEGEND**

-  申請處所 (界線只作識別用)  
APPLICATION PREMISES (BOUNDARY FOR IDENTIFICATION PURPOSE ONLY)
-  住宅  
RESIDENTIAL
-  商業  
COMMERCIAL
-  工業  
INDUSTRIAL
- R(A)** 住宅(甲類)  
RESIDENTIAL (GROUP A)
- R(E)** 住宅(戊類)  
RESIDENTIAL (GROUP E)
- OU** 其他指定用途  
OTHER SPECIFIED USES
-  市區重建局發展計劃圖範圍  
URBAN RENOVATION AUTHORITY DEVELOPMENT SCHEME PLAN AREA

**周邊現有土地用途  
EXISTING LAND USES IN THE SURROUNDING AREA**

商店及服務行業  
九龍塘尾道54、56及58號永利工業大廈地下1-6號單位  
SHOP AND SERVICES  
WORKSHOPS 1-6, G/F, WING LEE INDUSTRIAL BUILDING,  
54, 56 & 58 TONG MI ROAD, KOWLOON

規劃署  
PLANNING  
DEPARTMENT



參考編號  
REFERENCE No.

**A/K3/586**

圖 PLAN

**A - 5**

本摘要圖於2019年12月9日擬備，  
所根據的資料為測量圖編號  
11-NW-19A  
EXTRACT PLAN PREPARED ON 9.12.2019  
BASED ON SURVEY SHEET No.  
11-NW-19A

