

2ND FLOOR PLAN

3 2ND FLOOR PLAN
SCALE - 1:100

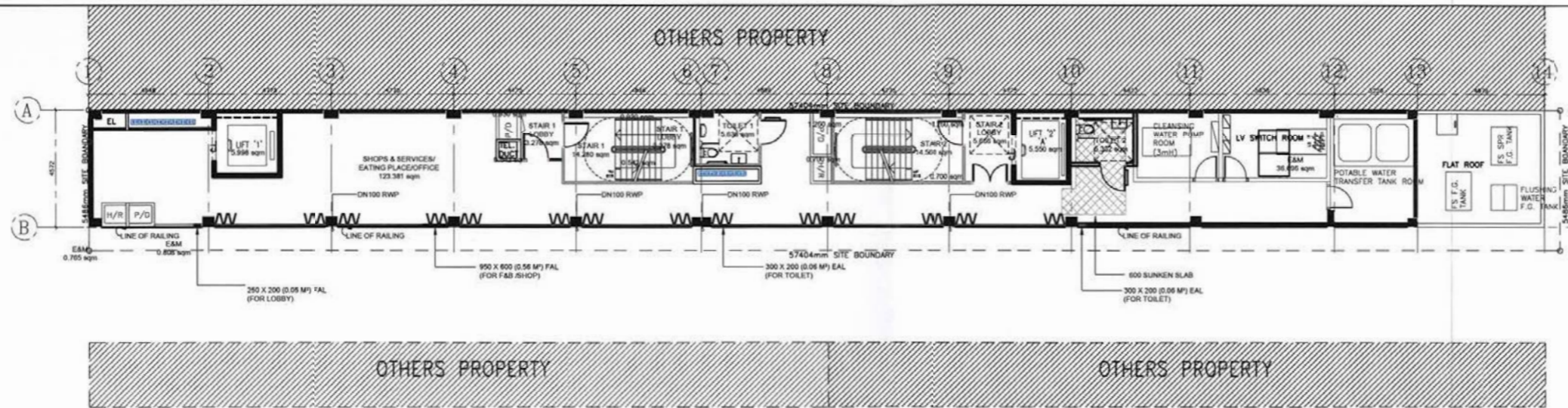

1ST FLOOR PLAN

2 1ST FLOOR PLAN
SCALE - 1:100

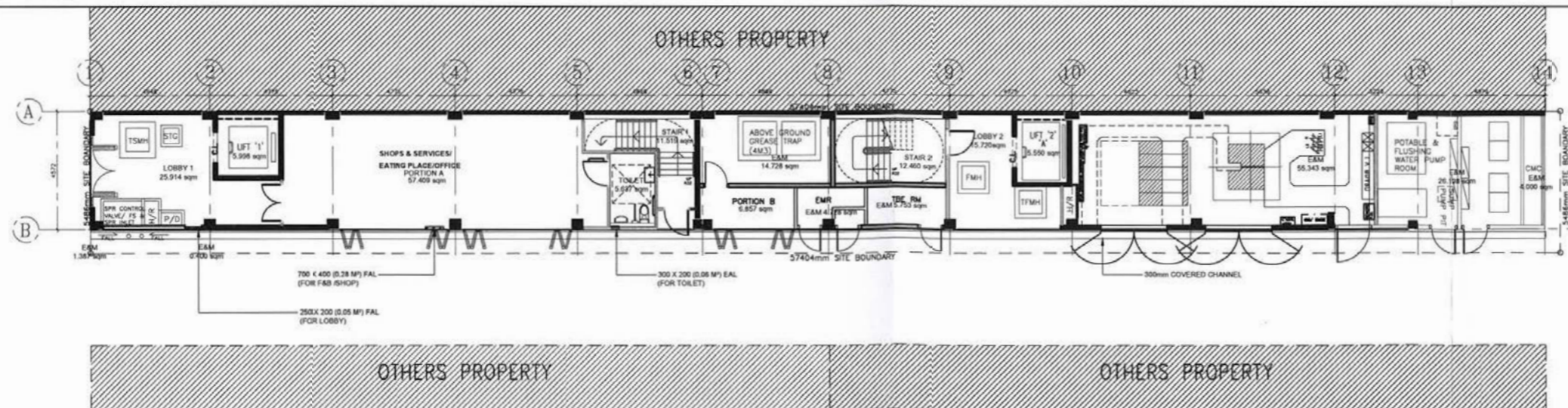

GROUND FLOOR

1 GROUND FLOOR PLAN
SCALE - 1:100

B.D. REF. NO.
F.P.B. NO.
AUTHORIZED PERSON
T.K. TSUI & ASSOCIATES LTD.
REGISTERED STRUCTURAL ENGINEER
T.K. TSUI & ASSOCIATES LTD.
DESIGN ARCHITECT
ATTITUDE
ATTITUDE ASIA INTERIORS

FIGURED DIMENSIONS ARE TO BE TAKEN IN PREFERENCE TO SCALED ONES IN ALL CASES.
BEFORE COMMENCING ANY WORK OR ORDERING ANY MATERIALS THE CONTRACTOR MUST VERIFY ALL MEASUREMENTS OF THE BUILDING. IF ANY DISCREPANCIES ARE FOUND THEY MUST BE BROUGHT TO THE NOTICE OF THE ARCHITECT IMMEDIATELY.

IN ACCORDANCE WITH THE PROVISIONS OF THE COPYRIGHT ACT 1956, AND THE COPYRIGHT (HONG KONG) ORDER 1972, COPYRIGHT IN ALL DRAWINGS AND IN THE WORK EXCLUDED FROM THEM, EXCEPT DRAWINGS AND WORKS FOR THE CROWN, WILL REMAIN THE PROPERTY OF THE ARCHITECT UNLESS OTHERWISE AGREED.

REV	DATE	DESCRIPTION	CHK.

PROJECT
PROPOSED A & A WORKS
AT No.18 BUTTE STRRE,
KOWLOON,
HONG KONG

PLAN
FLOOR PLAN

SCALE
1:100

T.K.TSUI & ASSOCIATES LTD.
REGISTERED ENGINEER, REGISTERED ARCHITECT, REGISTERED
REGISTERED PERSONS & PROPERTY DEVELOPMENT CONSULTANTS

崔德剛
T.S. TSUI & ASSOCIATES LTD.

B.D./F.S.D. APPROVAL

DRAWN CHECKED
RICKY C.K. PAT

DRAWING NO.	FIRST APPROVAL	
	A	F

Figure 7

(資料來源: 由申請人提供)
(Source: submitted by the Applicant)

參考編號
REFERENCE No.
A/K3/587

繪圖
DRAWING
A - 1

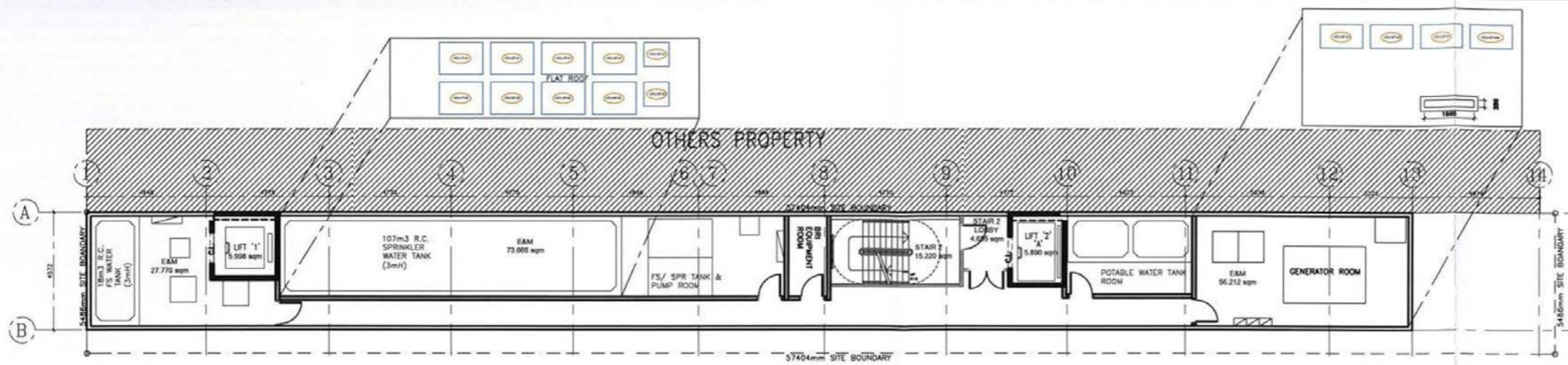

2 ROOF FLOOR PLAN
SCALE - 1:100

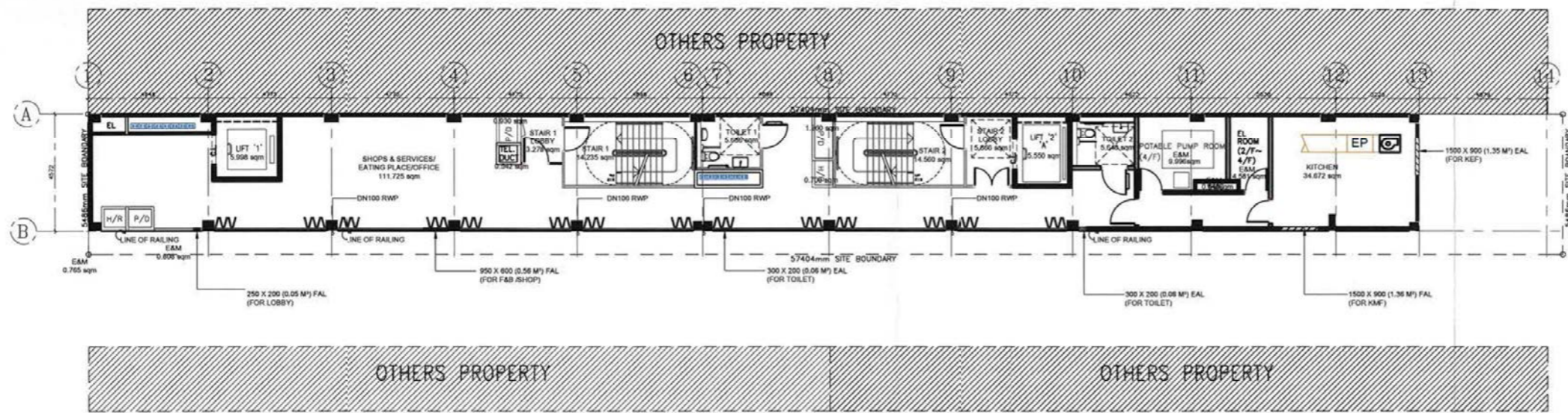

4TH FLOOR PLAN

5 4TH FLOOR PLAN
SCALE - 1:100

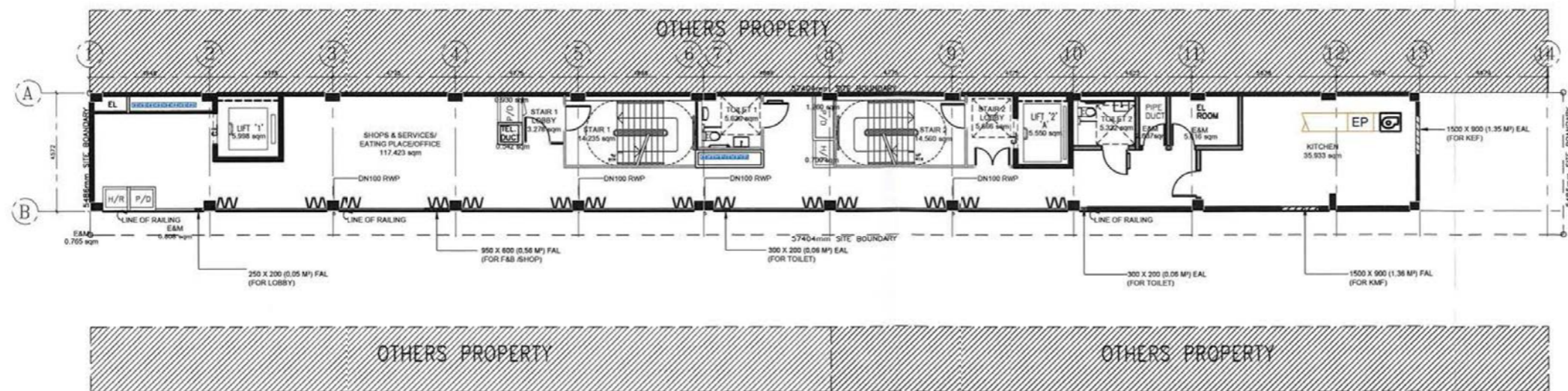

3RD FLOOR PLAN

4 3RD FLOOR PLAN
SCALE - 1:100

B.D. REF. NO. 2/3019/06
F.P.B. NO. FP B/20773

AUTHORIZED PERSON
T.K. TSUI & ASSOCIATES LTD.
REGISTERED STRUCTURAL ENGINEER
T.K. TSUI & ASSOCIATES LTD.
DESIGN ARCHITECT
ATTITUDE
ATTITUDE ASIA INTERIORS

FIGURED DIMENSIONS ARE TO BE TAKEN IN PREFERENCE TO SCALED ONES IN ALL CASES.

BEFORE COMMENCING ANY WORK OR ORDERING ANY MATERIALS THE CONTRACTOR MUST VERIFY ALL MEASUREMENTS OF THE BUILDING. IF ANY DISCREPANCIES ARE FOUND THEY MUST BE BROUGHT TO THE NOTICE OF THE ARCHITECT IMMEDIATELY.

IN ACCORDANCE WITH THE PROVISIONS OF THE COPYRIGHT ACT 1956, AND THE COPYRIGHT (HONG KONG) ORDER 1972, COPYRIGHT IN ALL DRAWINGS AND IN THE WORK EXECUTED FROM THEM, EXCEPT DRAWINGS AND WORKS FOR THE CROWN, WILL REMAIN THE PROPERTY OF THE ARCHITECT UNLESS OTHERWISE AGREED.

REV.	DATE	DESCRIPTION	CHK.

PROJECT
PROPOSED A & A WORKS
AT No.18 BUTTE STREET,
KOWLOON,
HONG KONG

PLAN
FLOOR PLAN

SCALE
1:100

T.K.TSUI & ASSOCIATES LTD.
REGISTERED ENGINEER, REGISTERED GEOTECHNICAL ENGINEER,
REGISTERED PLANNING & PROPERTY DEVELOPMENT CONSULTANT

崔德剛
T.S. TSUI

B.D./F.S.D. APPROVAL

DRAWN CHECKED
RICKY C.K. PAT

DRAWING NO.	FIRST APPROVAL:	
	A	F
3K-02		
Figure 8		

參考編號
REFERENCE No.
A/K3/587

繪圖
DRAWING
A - 2

(資料來源: 由申請人提供)
(Source: submitted by the Applicant)

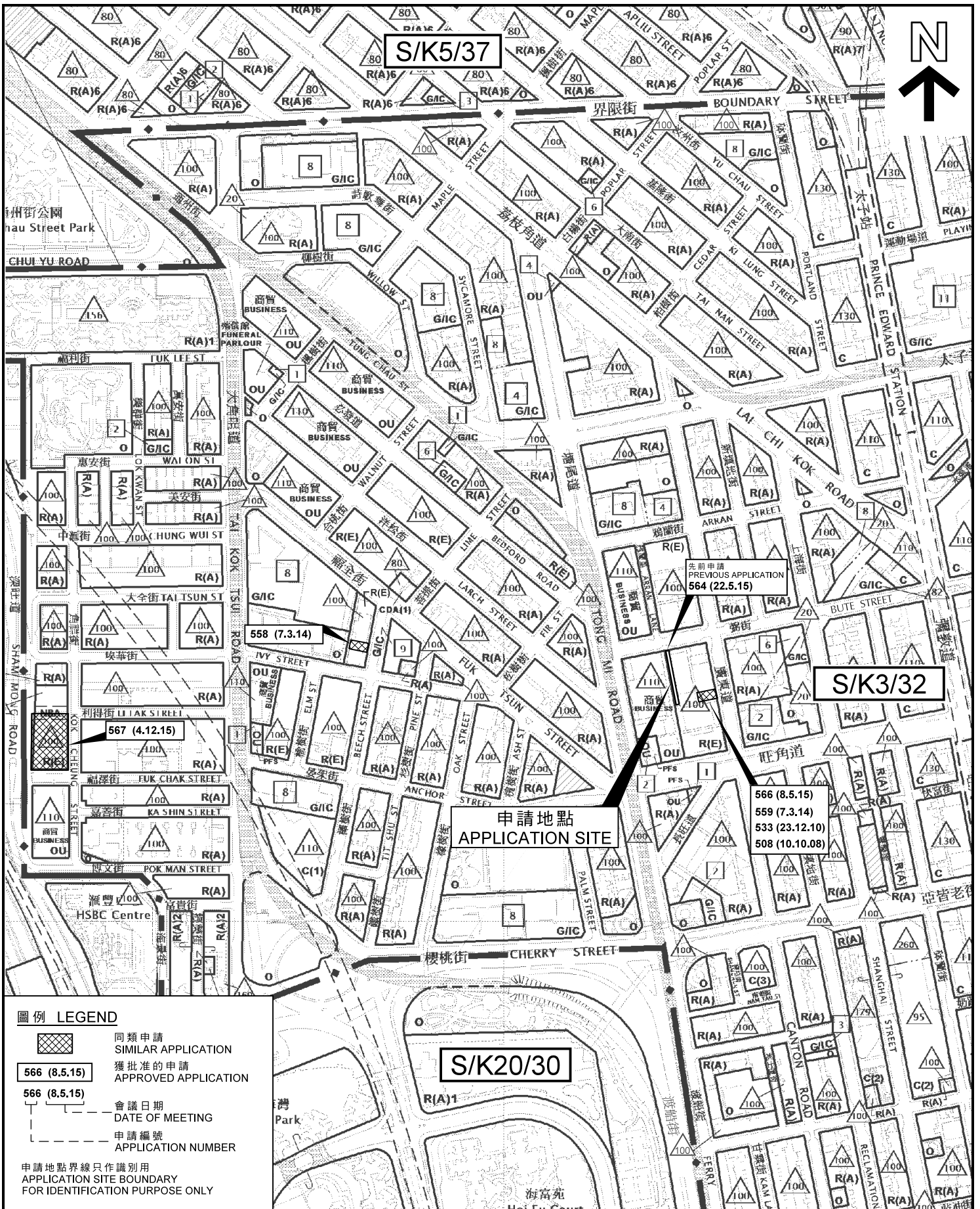

圖例 LEGEND

- 同類申請 SIMILAR APPLICATION
- 獲批准的申請 APPROVED APPLICATION
- 會議日期 DATE OF MEETING
- 申請編號 APPLICATION NUMBER
- 申請地點界線只作識別用 APPLICATION SITE BOUNDARY FOR IDENTIFICATION PURPOSE ONLY

位置圖 LOCATION PLAN

擬議改裝整幢現有工業大廈作辦公室、商店及服務行業及食肆用途
九龍旺角彌街18號
PROPOSED WHOLESALE CONVERSION OF EXISTING INDUSTRIAL BUILDING
FOR OFFICE, SHOP AND SERVICES AND EATING PLACE USES
18 BUTE STREET, MONG KOK, KOWLOON

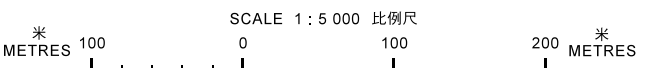

規劃署
PLANNING DEPARTMENT





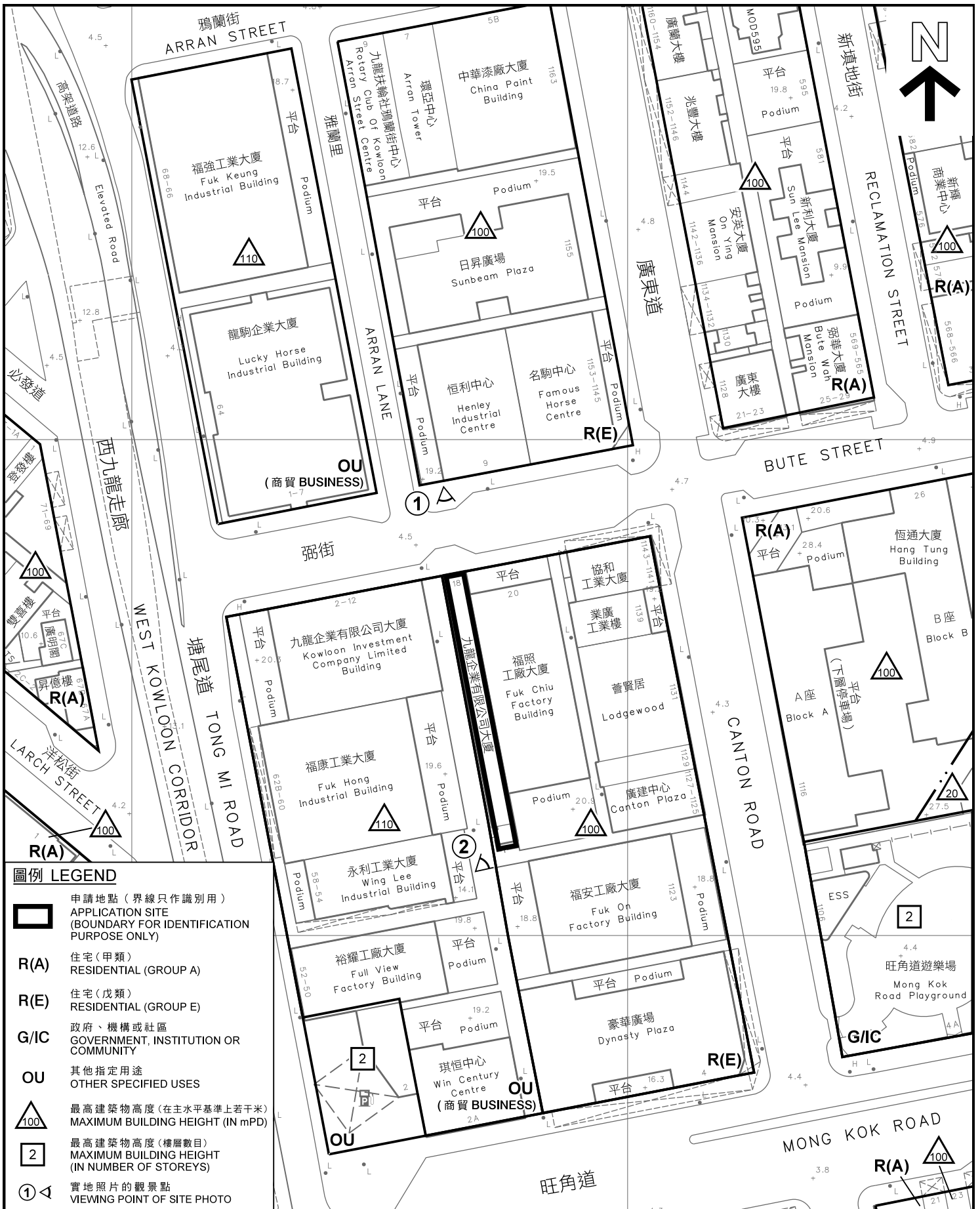

參考編號
REFERENCE No.
A/K3/587

圖 PLAN
A - 1

本摘要圖於2020年4月8日擬備，所根據的資料為於2019年10月8日核准的分區計劃大綱圖編號 S/K3/32，於2016年12月6日核准的分區計劃大綱圖編號 S/K5/37，以及於2014年9月23日核准的分區計劃大綱圖編號 S/K20/30
EXTRACT PLAN PREPARED ON 8.4.2020 BASED ON OUTLINE ZONING PLAN No. S/K3/32 APPROVED ON 8.10.2019 S/K5/37 APPROVED ON 6.12.2016 AND S/K20/30 APPROVED ON 23.9.2014



- 圖例 LEGEND**
-  申請地點 (界線只作識別用)
APPLICATION SITE
(BOUNDARY FOR IDENTIFICATION
PURPOSE ONLY)
 - R(A)** 住宅(甲類)
RESIDENTIAL (GROUP A)
 - R(E)** 住宅(戊類)
RESIDENTIAL (GROUP E)
 - G/IC** 政府、機構或社區
GOVERNMENT, INSTITUTION OR
COMMUNITY
 - OU** 其他指定用途
OTHER SPECIFIED USES
 -  最高建築物高度 (在主水平基準上若干米)
MAXIMUM BUILDING HEIGHT (IN MPD)
 -  最高建築物高度 (樓層數目)
MAXIMUM BUILDING HEIGHT
(IN NUMBER OF STOREYS)
 -  實地照片的觀景點
VIEWING POINT OF SITE PHOTO

本摘要圖於2020年4月3日擬備，
所根據的資料為測量圖編號
11-NW-14C, 14D, 19A及19B

EXTRACT PLAN PREPARED ON 3.4.2020
BASED ON SURVEY SHEET No.
11-NW-14C, 14D, 19A & 19B

平面圖 SITE PLAN

擬議改裝整幢現有工業大廈作
辦公室、商店及服務行業及食肆用途
九龍旺角彌街18號

PROPOSED WHOLESALE CONVERSION OF EXISTING INDUSTRIAL BUILDING
FOR OFFICE, SHOP AND SERVICES AND EATING PLACE USES
18 BUTE STREET, MONG KOK, KOWLOON

SCALE 1 : 1 000 比例尺



規劃署
PLANNING
DEPARTMENT



參考編號
REFERENCE No.
A/K3/587

圖 PLAN
A - 2



照片 1 — 申請地點
PHOTO 1 - APPLICATION SITE



照片 2 — 申請地點
PHOTO 2 - APPLICATION SITE

界線只作識別用
BOUNDARY FOR
IDENTIFICATION PURPOSE ONLY

本摘要圖於2020年4月16日擬備，
所根據的資料為攝於
2020年3月17日的實地照片
PLAN PREPARED ON 16.4.2020
BASED ON SITE PHOTOS
TAKEN ON 17.3.2020

實地照片 SITE PHOTOS

擬議改裝整幢現有工業大廈作
辦公室、商店及服務行業及食肆用途
九龍旺角彌街18號

PROPOSED WHOLESALE CONVERSION OF EXISTING INDUSTRIAL BUILDING
FOR OFFICE, SHOP AND SERVICES AND EATING PLACE USES
18 BUTE STREET, MONG KOK, KOWLOON

規劃署
PLANNING
DEPARTMENT



參考編號
REFERENCE No.
A/K3/587

圖 PLAN
A - 3