

Plan 2

STRUCTURE	USE	COVERED AREA	NON-DOMESTIC GFA	BUILDING HEIGHT
B1	SHOP AND SERVICES (FOOD)*	446m ² (ABOUT)	892m ² (ABOUT)	11m (ABOUT)
B2	CANOPY OF STAIRCASE TO 1/2*	18m ² (ABOUT)	N/A	11m (ABOUT)
B3	CANOPY OF STAIRCASE TO 1/2*	18m ² (ABOUT)	N/A	11m (ABOUT)
TOTAL		482m² (ABOUT)	892m² (ABOUT)	

*UNENCLOSED
*WITH ANCILLARY STORAGE AND OFFICE

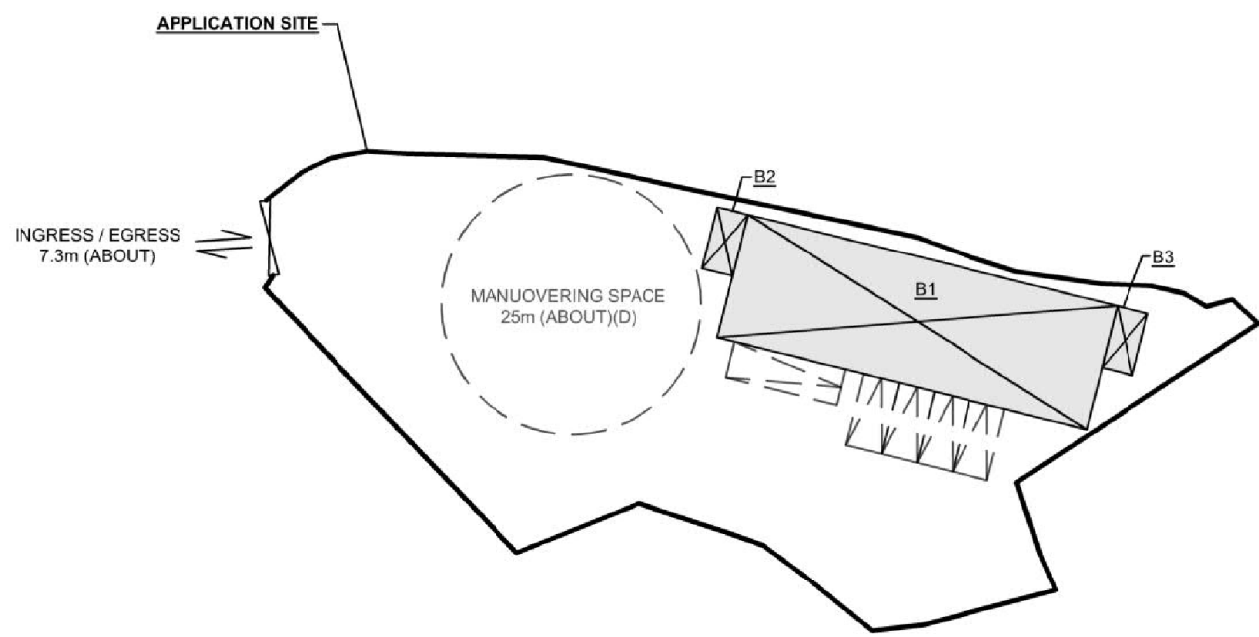
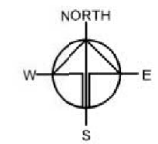

DEVELOPMENT PARAMETERS

APPLICATION SITE AREA: 2,530m² (ABOUT)
 COVERED AREA: 482m² (ABOUT)
 UNCOVERED AREA: 2,048m² (ABOUT)

NO. OF STRUCTURE: 3
 NON-DOMESTIC GFA: 892m² (ABOUT)
 BUILDING HEIGHT: 11m (ABOUT)
 NO. OF STOREY: 2

NO. OF L/UL SPACE FOR LIGHT GOODS VEHICLE (3.5m X 7m): 4
 NO. OF L/UL SPACE FOR MEDIUM GOODS VEHICLE (3.5m X 11m): 1

LEGEND

	STRUCTURE
	L/UL SPACE

Drawing No.	Ver.
P02	02
Project	
PROPOSED TEMPORARY SHOP AND SERVICES (FOOD RETAIL SHOP) WITH ANCILLARY STORAGE AND OFFICE FOR A PERIOD OF 5 YEARS	
LOT 570 (PT) AND 571 RP (PT) IN D.D. 107 & ADJ. G.L.	
Drawing Title	
LAYOUT PLAN	
Scale of A4	
1:650	
Drawn	Date
	21.3.2019
Revised	Date
	8.5.2019

(摘錄自申請人於 9. 5. 2019 呈交的進一步資料)
 (Extract from Applicant's Further Information Submitted on 9.5.2019)

參考編號 REFERENCE No.	繪圖 DRAWING
A/YL-KTN/655	A-1

STRUCTURE	USE	COVERED AREA	NON-DOMESTIC GFA	BUILDING HEIGHT
B1	SHOP AND SERVICES (FOOD)*	446m ² (ABOUT)	892m ² (ABOUT)	11m (ABOUT)(2-STOREY)
B2	CANOPY OF STAIRCASE TO 1/F*	18m ² (ABOUT)	N/A	11m (ABOUT)
B3	CANOPY OF STAIRCASE TO 1/F*	18m ² (ABOUT)	N/A	11m (ABOUT)
TOTAL		482m² (ABOUT)	892m² (ABOUT)	

*UNENCLOSED
 ^WITH ANCILLARY STORAGE AND OFFICE

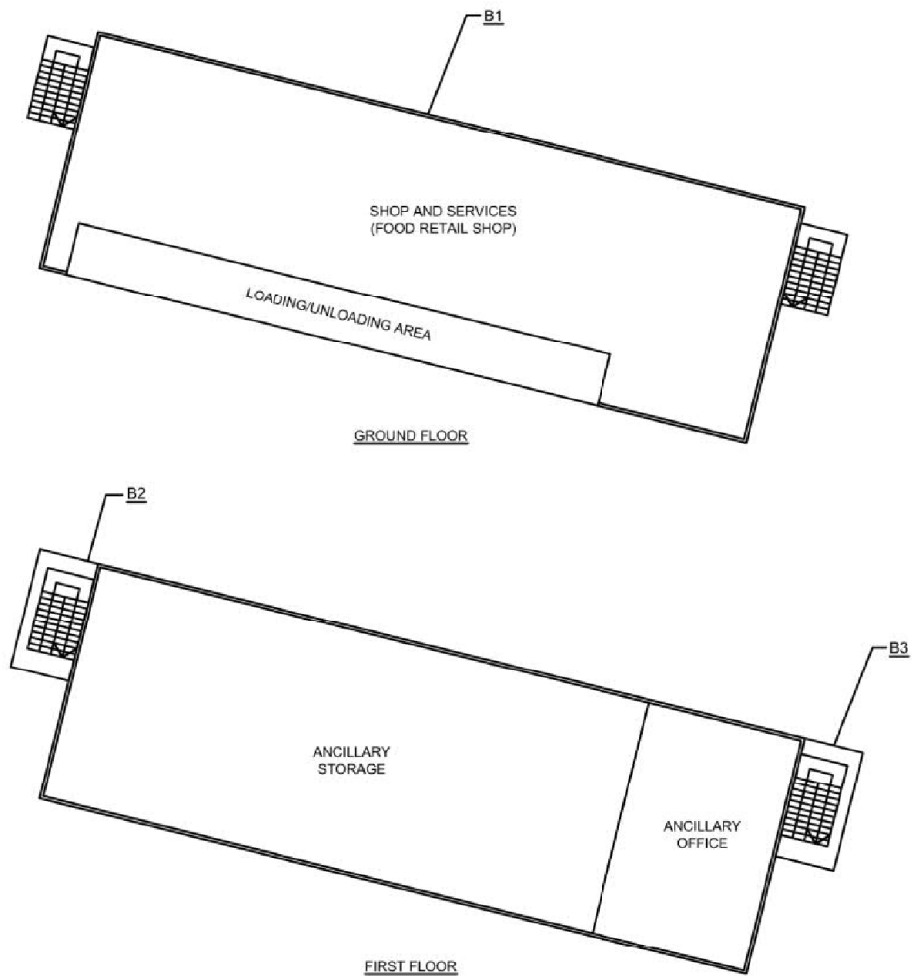

INDICATIVE ONLY

Drawing No. P03	Ver. 01	Drawing Title INT. LAYOUT PLAN	
Project PROPOSED TEMPORARY SHOP AND SERVICES (FOOD RETAL SHOP) WITH ANCILLARY STORAGE AND OFFICE FOR A PERIOD OF 5 YEARS		Scale of A4 1:350	
LOT 570 (PT) AND 571 RP (PT) IN D.D. 107 & ADJ. G.L.		Drawn 8.5.2019	
		Revised Date	

(摘錄自申請人於 9.5.2019 呈交的進一步資料)
 (Extract from Applicant's Further
 Information Submitted on 9.5.2019)

參考編號
 REFERENCE No.
 A/YL-KTN/655

繪圖 DRAWING
 A-2

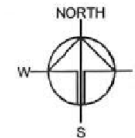
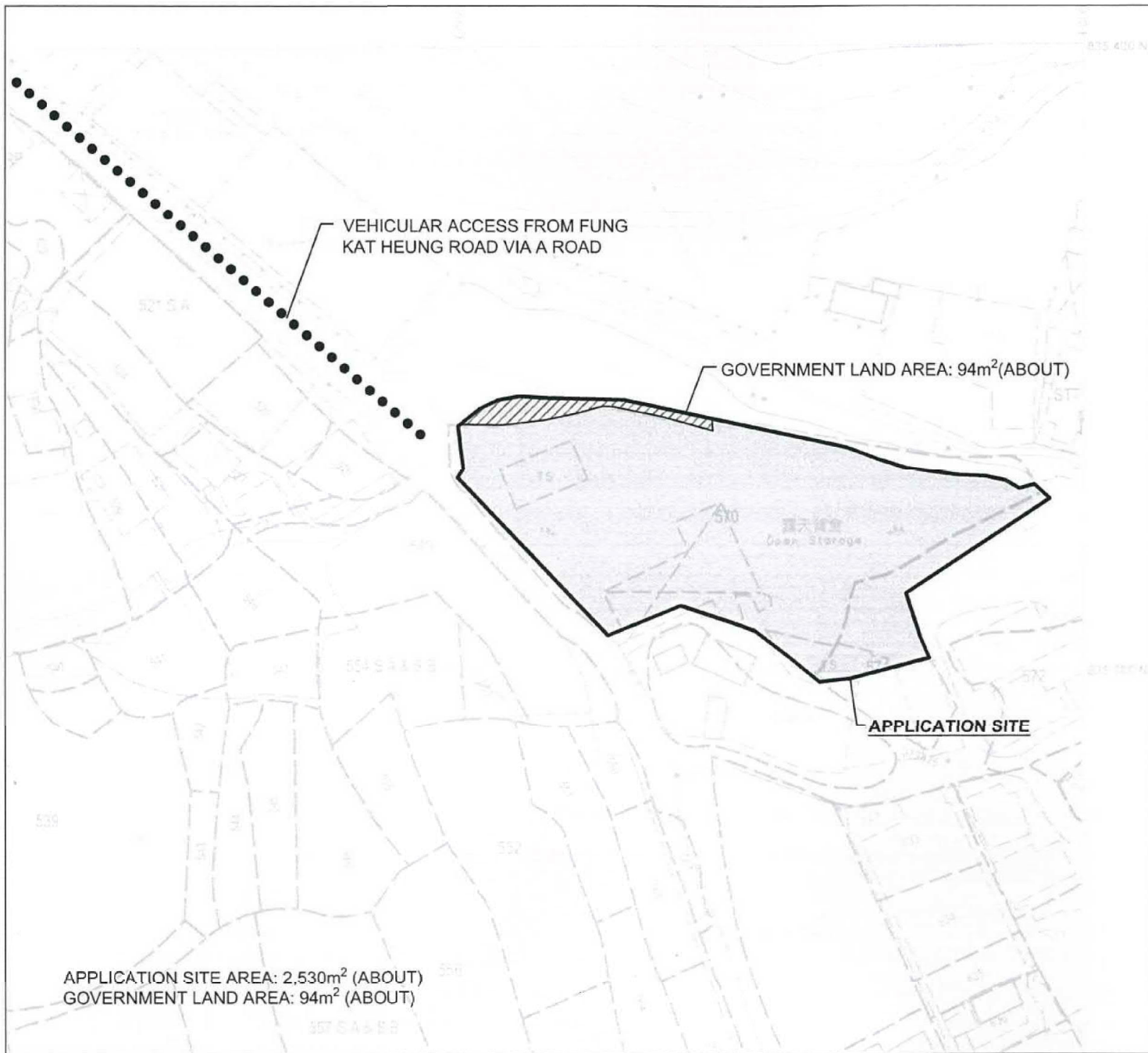

Drawing No.	Ver.
P01	01
Project	
PROPOSED TEMPORARY SHOP AND SERVICES (FOOD RETAIL SHOP) WITH ANCILLARY STORAGE AND OFFICE FOR A PERIOD OF 5 YEARS	
LOT 570 (PT) AND 571 RP (PT) IN D.D. 107 & ADJ. G.L.	
Drawing Title	
LAYOUT PLAN	
Scale of A4	
1:750	
Drawn	Date
	21.3.2019
Revised	Date

(摘錄自申請人於 27.3.2019 呈交的申請書)
(Extract from Applicant's Submission of 27.3.2019)

參考編號
REFERENCE No.
A/YL-KTN/655

繪圖 DRAWING
A-3



申請地點
APPLICATION SITE

要覽圖 KEY PLAN

SCALE 1 : 50 000 比例尺

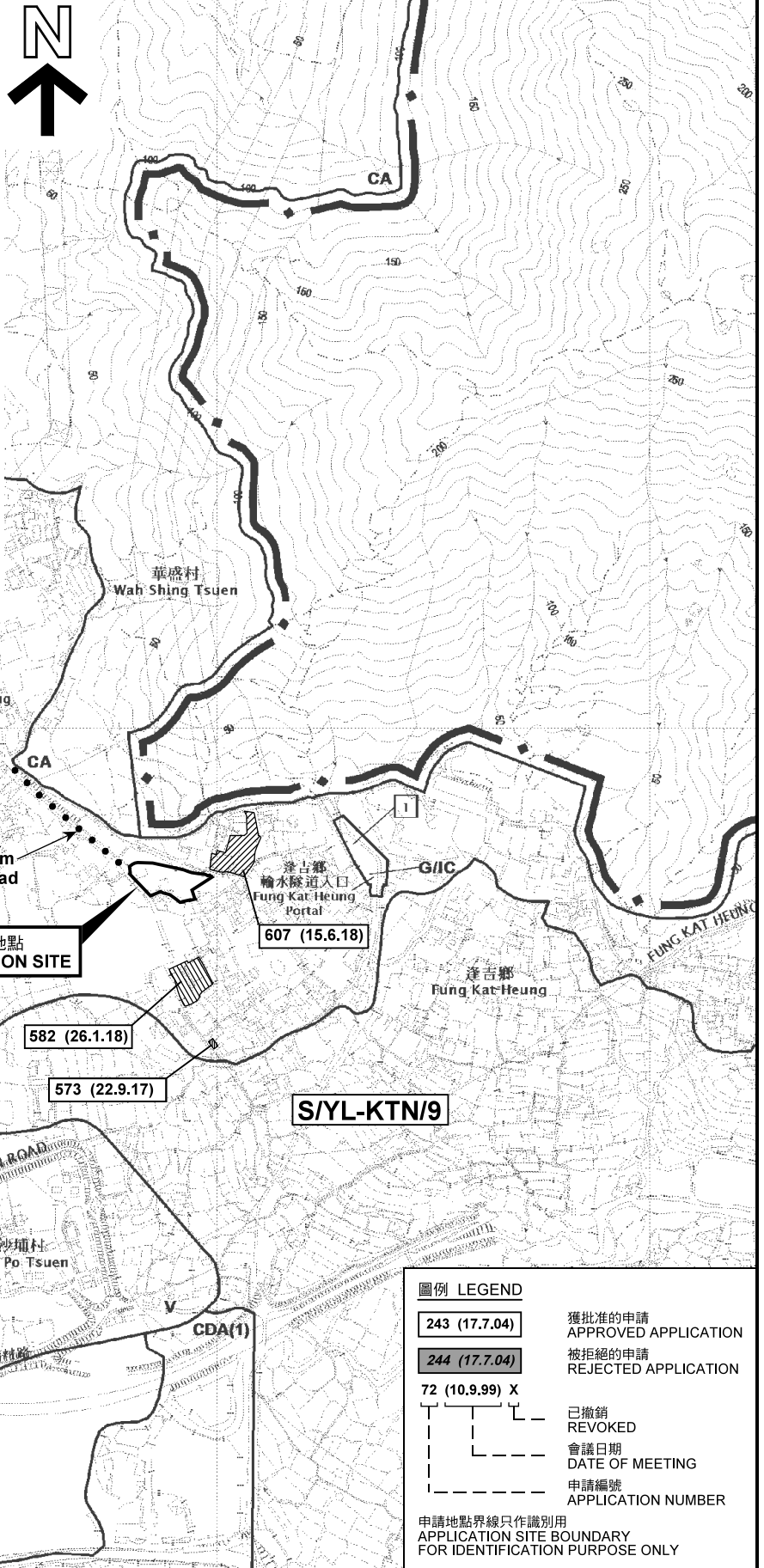

S/YL-NSW/8

連接逢吉鄉路的通道
Access Leading from
Fung Kat Heung Road

申請地點
APPLICATION SITE

607 (15.6.18)

582 (26.1.18)

573 (22.9.17)

S/YL-KTN/9

圖例 LEGEND

- 243 (17.7.04) 獲批准的申請
APPROVED APPLICATION
- 244 (17.7.04) 被拒絕的申請
REJECTED APPLICATION
- 72 (10.9.99) X 已撤銷
REVOKED
- - - 會議日期
DATE OF MEETING
- - - 申請編號
APPLICATION NUMBER

申請地點界線只作識別用
APPLICATION SITE BOUNDARY
FOR IDENTIFICATION PURPOSE ONLY

本摘要圖於2019年5月10日擬備，
所根據的資料為於2014年12月2日
核准的分區計劃大綱圖編號 S/YL-KTN/9
EXTRACT PLAN PREPARED ON 10.5.2019
BASED ON OUTLINE ZONING PLAN No.
S/YL-KTN/9 APPROVED ON 2.12.2014

位置圖及同類申請 LOCATION PLAN WITH SIMILAR APPLICATIONS

擬議臨時商店及服務行業（食品零售商店）連附屬貯物及辦公室（為期5年）
元朗錦田逢吉鄉丈量約份第107約地段第570號（部分）
及第571號餘段（部分）和毗連政府土地
PROPOSED TEMPORARY SHOP AND SERVICES (FOOD RETAIL SHOP)
WITH ANCILLARY STORAGE AND OFFICE FOR A PERIOD OF 5 YEARS
LOTS 570 (PART) AND 571 RP (PART) IN D.D.107
AND ADJOINING GOVERNMENT LAND,
FUNG KAT HEUNG, KAM TIN, YUEN LONG

SCALE 1 : 7 500 比例尺



規劃署
PLANNING
DEPARTMENT



參考編號
REFERENCE No.
A/YL-KTN/655

圖 PLAN
A-1

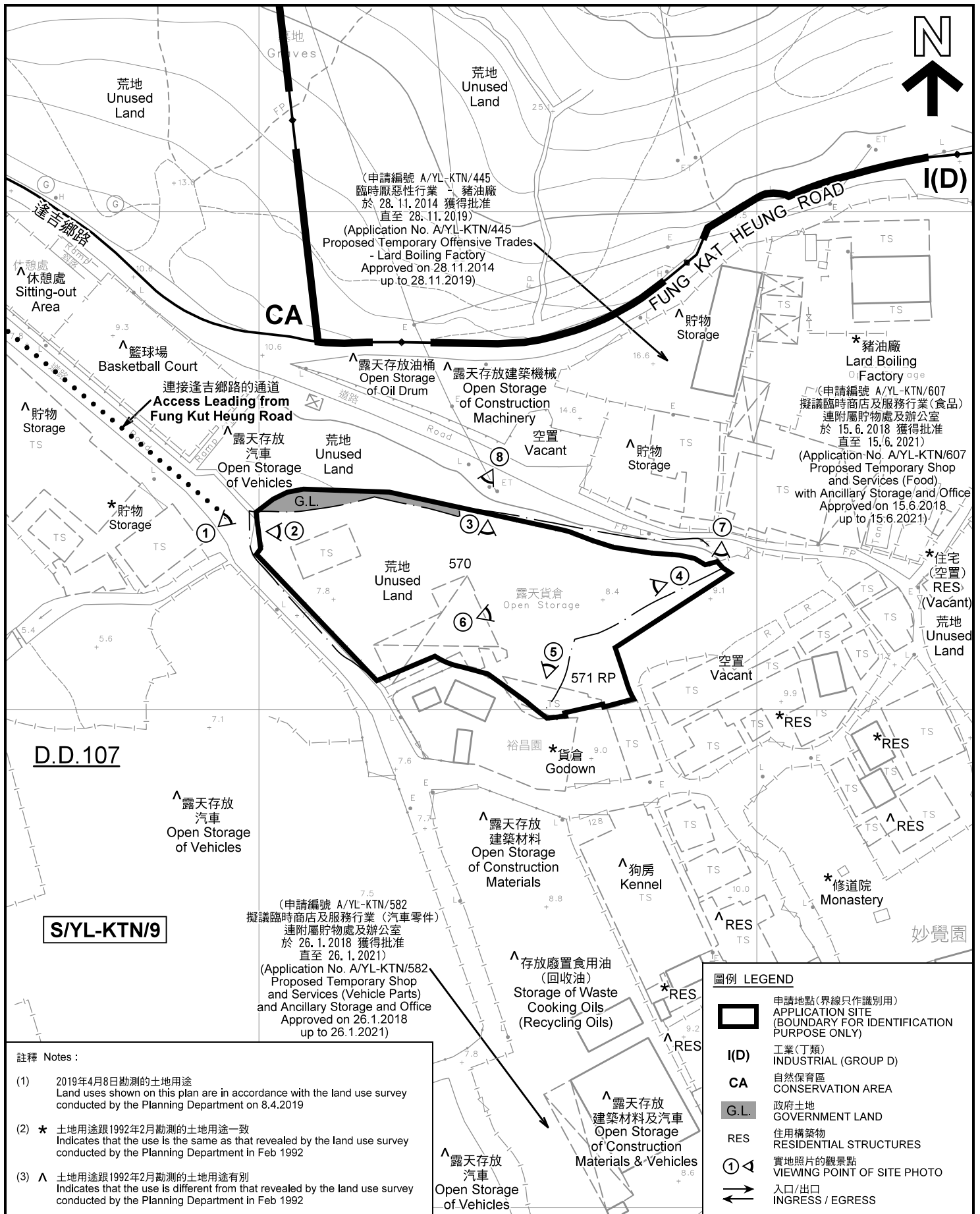

註釋 Notes :

(1) 2019年4月8日勘测的土地用途
Land uses shown on this plan are in accordance with the land use survey conducted by the Planning Department on 8.4.2019

(2) * 土地用途跟1992年2月勘测的土地用途一致
Indicates that the use is the same as that revealed by the land use survey conducted by the Planning Department in Feb 1992

(3) ^ 土地用途跟1992年2月勘测的土地用途有別
Indicates that the use is different from that revealed by the land use survey conducted by the Planning Department in Feb 1992

圖例 LEGEND	
	申請地點(界線只作識別用) APPLICATION SITE (BOUNDARY FOR IDENTIFICATION PURPOSE ONLY)
I(D)	工業(丁類) INDUSTRIAL (GROUP D)
CA	自然保育區 CONSERVATION AREA
G.L.	政府土地 GOVERNMENT LAND
RES	住用構築物 RESIDENTIAL STRUCTURES
① ^	實地照片的觀景點 VIEWING POINT OF SITE PHOTO
	入口/出口 INGRESS / EGRESS

本摘要圖於2019年4月30日擬備，所根據的資料為測量圖編號 6-NE-1B、1D、2A 及 2C
EXTRACT PLAN PREPARED ON 30.4.2019
BASED ON SURVEY SHEETS No. 6-NE-1B, 1D, 2A & 2C

平面圖 SITE PLAN

擬議臨時商店及服務行業(食品零售商店)連附屬貯物及辦公室(為期5年)
元朗錦田逢吉鄉丈量約份第107約地段第570號(部分)
及第571號餘段(部分)和毗連政府土地
PROPOSED TEMPORARY SHOP AND SERVICES (FOOD RETAIL SHOP)
WITH ANCILLARY STORAGE AND OFFICE FOR A PERIOD OF 5 YEARS
LOTS 570 (PART) AND 571 RP (PART) IN D.D.107
AND ADJOINING GOVERNMENT LAND,
FUNG KAT HEUNG, KAM TIN, YUEN LONG

SCALE 1 : 1 000 比例尺

米 METRES 20 0 20 40 米 METRES

**規劃署
PLANNING
DEPARTMENT**



參考編號
REFERENCE No.
A/YL-KTN/655

圖 PLAN
A-2

華盛村
WAH SHING
TSUEN



模範鄉
MO FAN
HEUNG

逢吉鄉路

連接逢吉鄉路的通道
Access Leading from
Fung Kut Heung Road

FUNG KAT HEUNG ROAD

逢吉鄉
FUNG KAT
HEUNG

圖例 LEGEND



申請地點(界線只作識別用)
APPLICATION SITE
(BOUNDARY FOR IDENTIFICATION
PURPOSE ONLY)

本摘要圖於2019年4月18日擬備，所根據的資料為地政總署於2018年1月3日拍得的航攝照片編號 E033698C
EXTRACT PLAN PREPARED ON 18.4.2019
BASED ON AERIAL PHOTO No.
E033698C TAKEN ON 3.1.2018
BY LANDS DEPARTMENT

航攝照片 AERIAL PHOTO

擬議臨時商店及服務行業(食品零售商店)連附屬貯物及辦公室(為期5年)
元朗錦田逢吉鄉丈量約份第107約地段第570號(部分)
及第571號餘段(部分)和毗連政府土地
PROPOSED TEMPORARY SHOP AND SERVICES (FOOD RETAIL SHOP)
WITH ANCILLARY STORAGE AND OFFICE FOR A PERIOD OF 5 YEARS
LOTS 570 (PART) AND 571 RP (PART) IN D.D.107
AND ADJOINING GOVERNMENT LAND,
FUNG KAT HEUNG, KAM TIN, YUEN LONG

規劃署
PLANNING
DEPARTMENT



參考編號
REFERENCE No.
A/YL-KTN/655

圖 PLAN
A-3



申請地點界線只作識別用 APPLICATION SITE BOUNDARY FOR IDENTIFICATION PURPOSE ONLY

實地照片 SITE PHOTOS

本圖於2019年4月29日擬備，所根據的資料為攝於2019年4月8日的實地照片
 PLAN PREPARED ON 29.4.2019
 BASED ON SITE PHOTOS
 TAKEN ON 8.4.2019

擬議臨時商店及服務行業（食品零售商店）連附屬貯物及辦公室（為期5年）
 元朗錦田逢吉鄉丈量約份第107約地段第570號（部分）
 及第571號餘段（部分）和毗連政府土地
 PROPOSED TEMPORARY SHOP AND SERVICES (FOOD RETAIL SHOP)
 WITH ANCILLARY STORAGE AND OFFICE FOR A PERIOD OF 5 YEARS
 LOTS 570 (PART) AND 571 RP (PART) IN D.D.107
 AND ADJOINING GOVERNMENT LAND,
 FUNG KAT HEUNG, KAM TIN, YUEN LONG

規劃署
**PLANNING
 DEPARTMENT**



參考編號
 REFERENCE No.
A/YL-KTN/655

圖 PLAN
A-4a

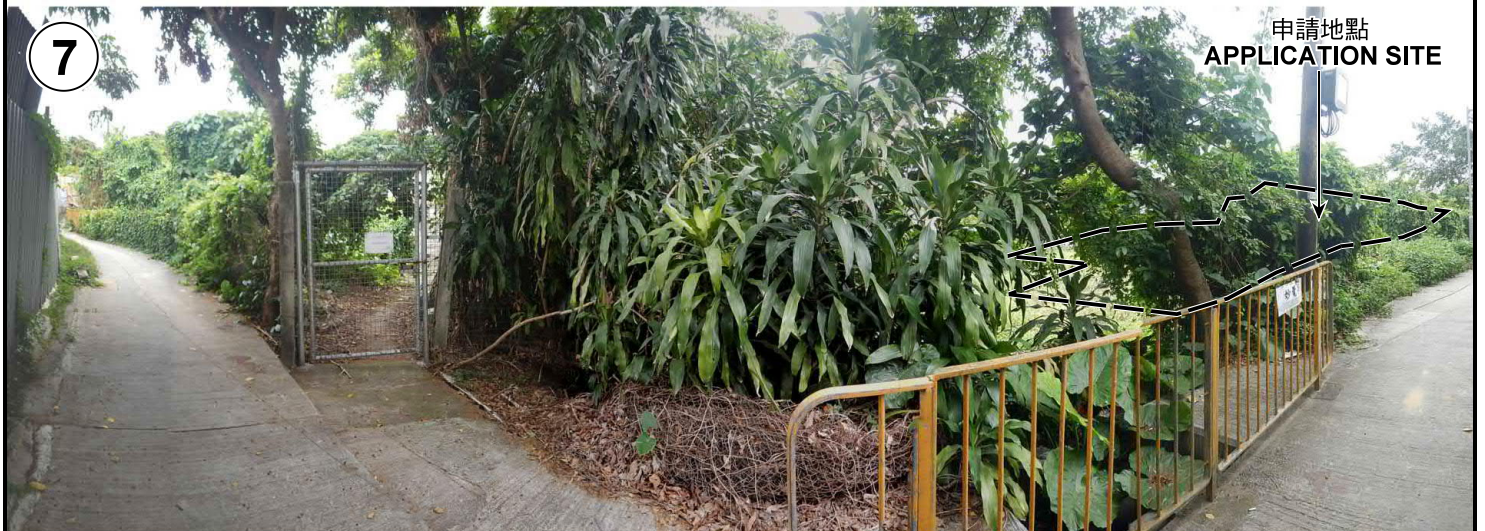

申請地點界線只作識別用 APPLICATION SITE BOUNDARY FOR IDENTIFICATION PURPOSE ONLY

實地照片 SITE PHOTOS

本圖於2019年4月29日擬備，所根據的資料為攝於2019年4月8日的實地照片
PLAN PREPARED ON 29.4.2019
BASED ON SITE PHOTOS
TAKEN ON 8.4.2019

擬議臨時商店及服務行業（食品零售商店）連附屬貯物及辦公室（為期5年）
元朗錦田逢吉鄉丈量約份第107約地段第570號（部分）
及第571號餘段（部分）和毗連政府土地
PROPOSED TEMPORARY SHOP AND SERVICES (FOOD RETAIL SHOP)
WITH ANCILLARY STORAGE AND OFFICE FOR A PERIOD OF 5 YEARS
LOTS 570 (PART) AND 571 RP (PART) IN D.D.107
AND ADJOINING GOVERNMENT LAND,
FUNG KAT HEUNG, KAM TIN, YUEN LONG

規劃署
PLANNING
DEPARTMENT



參考編號
REFERENCE No.
A/YL-KTN/655

圖 PLAN
A-4b