

G/F

Structure 1  
Cattery & Caretaker's office (1/F)  
Car parking space (G/F)  
GFA: Not exceeding 55m<sup>2</sup>  
(including the staircase)  
Height: Not exceeding 6.5m  
No. of storey: 2

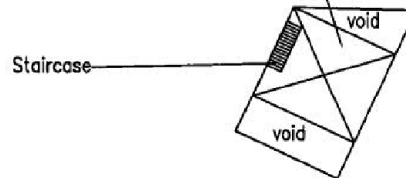

1/F

PROJECT 項目名稱: Proposed Temporary Animal Boarding Establishment (Cattery) for a Period of 3 Years at Lots 3 S.E (Part) & 8 S.L in D.D.110, Tai Kong Po, Kam Tin, Yuen Long, N.T.	DRAWING TITLE 圖目: Proposed Layout Plan	REMARKS 備註:
	DRAWING No. 圖號: NO. 2	SCALE 比例: <del>1:500</del>

(摘錄自申請人於 11.6.2019 呈交的申請書)  
(Extract from Applicant's Submission of 11.6.2019)

參考編號  
REFERENCE No.  
A/YL-KTN/669

繪圖 DRAWING  
A-1

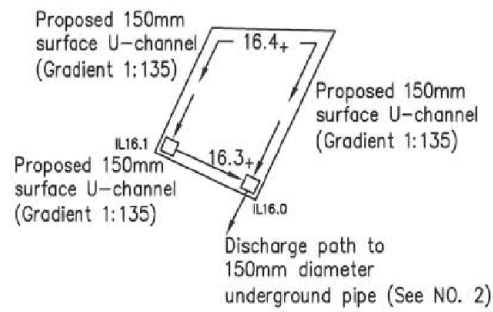

PROJECT 項目名稱: Proposed Temporary Animal Boarding Establishment (Cattery) for a Period of 3 Years at Lots 3 S.E & 8 S.L in D.D.110, Tai Kong Po, Kam Tin, Yuen Long, N.T.	DRAWING TITLE 圖目: Proposed Drainage Plan	REMARKS 備註: <input type="checkbox"/> Proposed catchpit +16.4 Level (in mPD)  IL Invert level
	DRAWING No. 圖號: NO. 1	SCALE 比例: <del>1:500</del>

(摘錄自申請人於 5.7.2019 呈交的進一步資料)  
 (Extract from Applicant's Further Information Submitted on 5.7.2019)

參考編號  
 REFERENCE No.  
 A/YL-KTN/669

繪圖 DRAWING  
 A-2



<i>Tree</i>	<i>Approximate Height</i>	<i>Spacing</i>
 Proposed Bauhinia blakeana	2.75m	4m

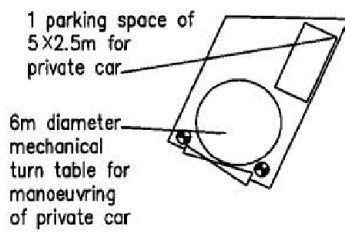

G/F

Structure 1  
 Cattery & Caretaker's office (1/F)  
 Car parking space (G/F)  
 GFA: Not exceeding 55m<sup>2</sup>  
 (including the staircase)  
 Height: Not exceeding 6.5m  
 No. of storey: 2

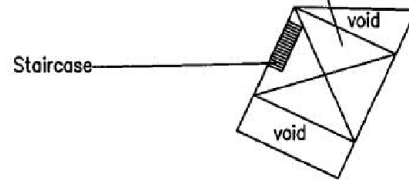

1/F

PROJECT 項目名稱: Proposed Temporary Animal Boarding Establishment (Cattery) for a Period of 3 Years at Lots 3 S.E (Part) & 8 S.L in D.D.110, Tai Kong Po, Kam Tin, Yuen Long, N.T.	DRAWING TITLE 圖目: Proposed Landscape Plan	REMARKS 備註:
	DRAWING No. 圖號: NO. 3	SCALE 比例: <del>1:500</del>

(摘錄自申請人於 11.6.2019 呈交的申請書)  
 (Extract from Applicant's Submission of 11.6.2019)

參考編號  
 REFERENCE No.  
 A/YL-KTN/669

繪圖 DRAWING  
 A-3

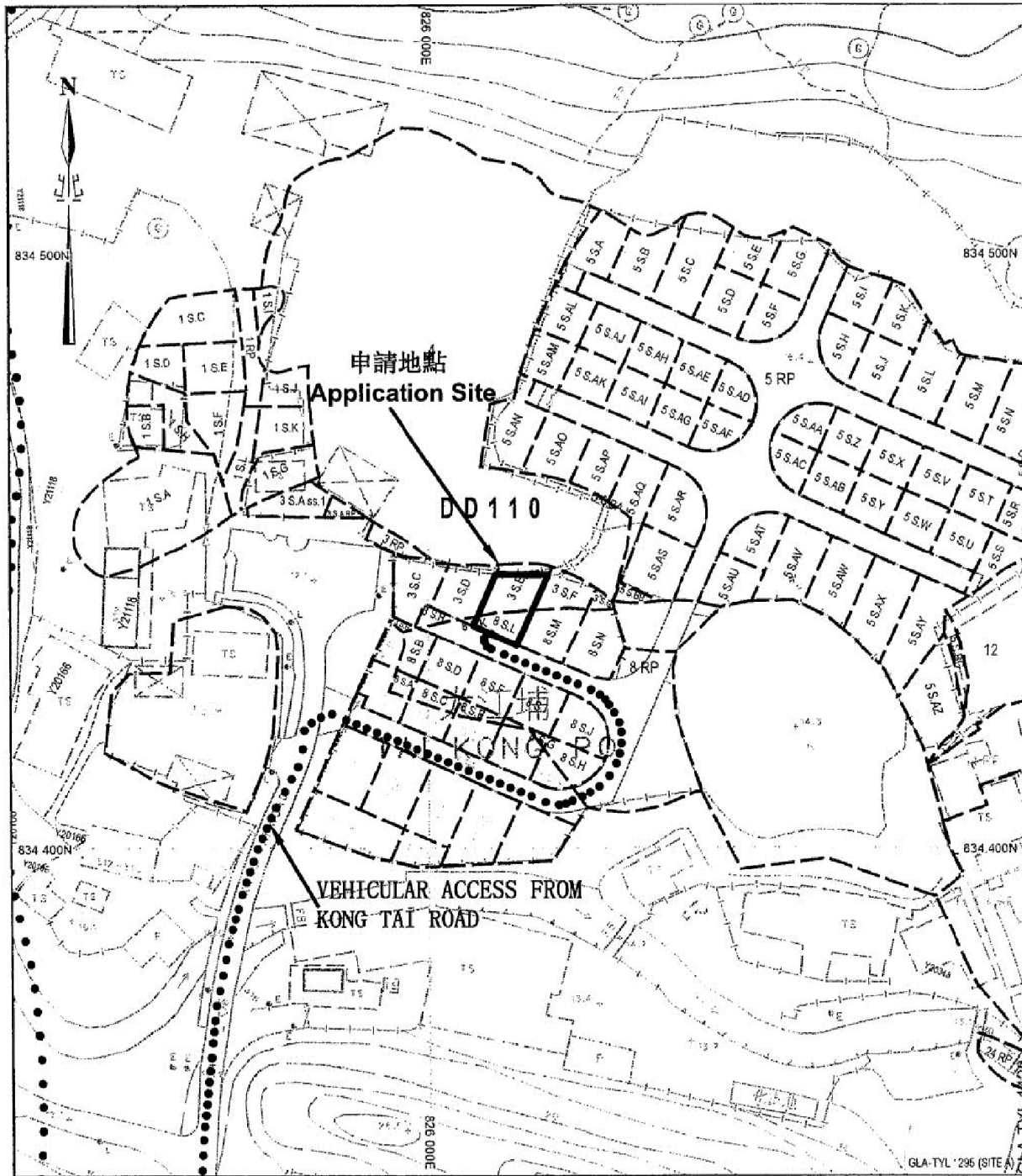

<p>PROJECT 項目名稱: Proposed Temporary Animal Boarding Establishment (Cattery) for a Period of 3 Years at Lots 3 S.E (Part) &amp; 8 S.L in D.D.110, Tai Kong Po, Kam Tin, Yuen Long, N.T.</p>	<p>DRAWING TITLE 圖目: Vehicular Access Plan</p>	<p>REMARKS 備註:</p>
	<p>DRAWING No. 圖號: NO. 4</p>	<p>SCALE 比例: 1:1000</p>

(摘錄自申請人於 11.6.2019 呈交的申請書)  
(Extract from Applicant's Submission of 11.6.2019)

<p>參考編號 REFERENCE No. A/YL-KTN/669</p>	<p>繪圖 DRAWING A-4</p>
--	---------------------------



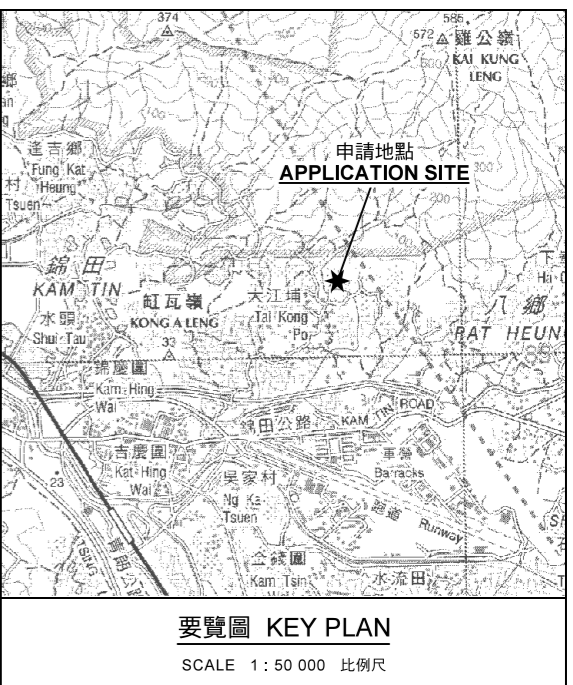
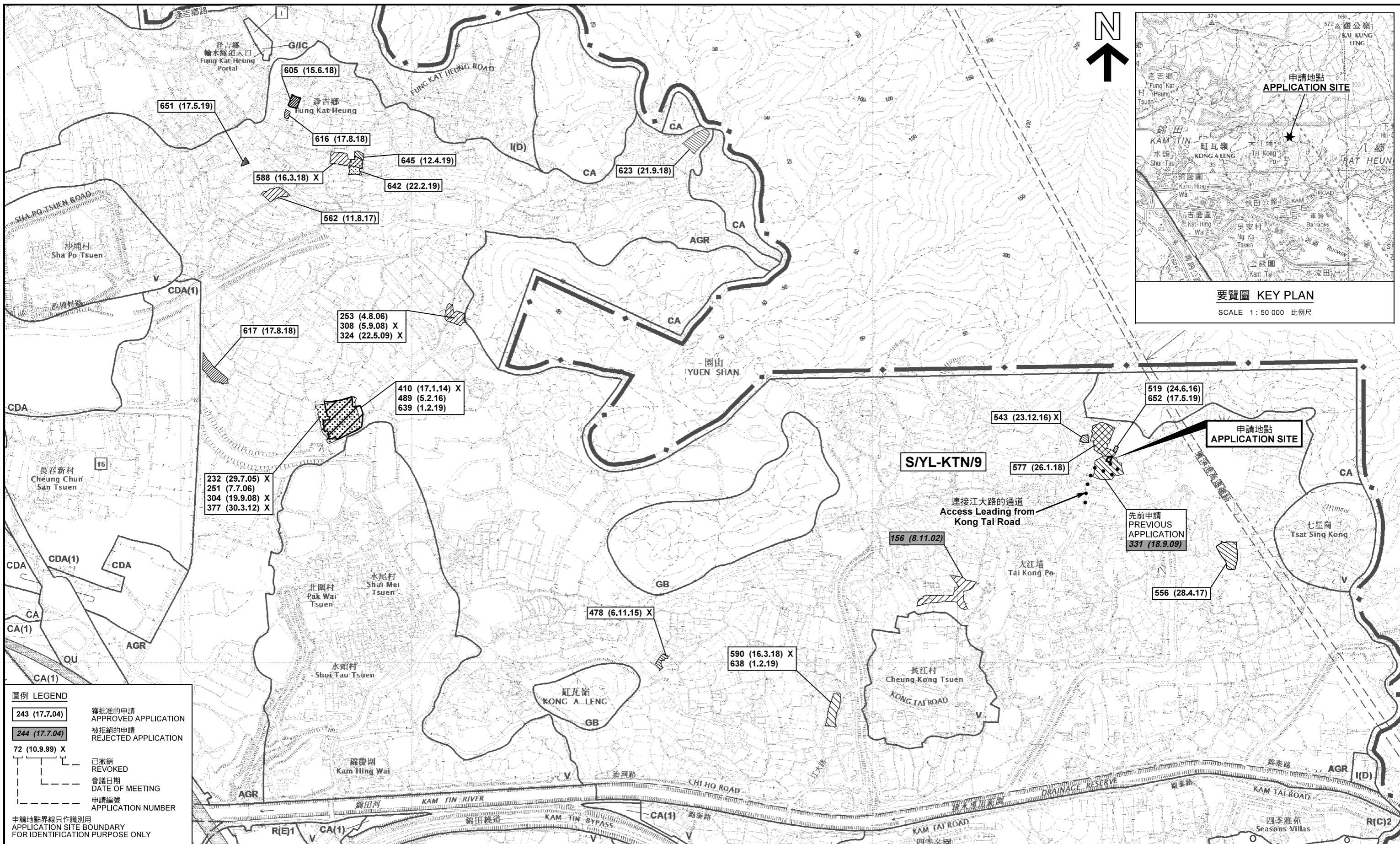

**圖例 LEGEND**

243 (17.7.04)	獲批准的申請 APPROVED APPLICATION
244 (17.7.04)	被拒絕的申請 REJECTED APPLICATION
72 (10.9.99) X	已撤銷 REVOKED
(Date)	會議日期 DATE OF MEETING
(Number)	申請編號 APPLICATION NUMBER

申請地點界線只作識別用  
APPLICATION SITE BOUNDARY  
FOR IDENTIFICATION PURPOSE ONLY

位置圖及同類申請 LOCATION PLAN WITH SIMILAR APPLICATIONS

擬議臨時動物寄養所(貓房) (為期3年)  
元朗錦田大江埔丈量約份第110約地段第3號E分段(部分)及第8號L分段  
PROPOSED TEMPORARY ANIMAL BOARDING ESTABLISHMENT  
(CATTERY) FOR A PERIOD OF 3 YEARS  
LOTS 3 S.E (PART) AND 8 S.L IN D.D. 110,  
TAI KONG PO, KAM TIN, YUEN LONG

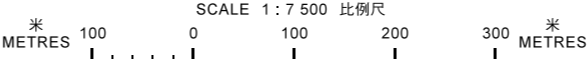

本摘要圖於2019年7月2日擬備，  
所根據的資料為於2014年12月2日  
核准的分區計劃大綱圖編號 S/YL-KTN/9  
EXTRACT PLAN PREPARED ON 2.7.2019  
BASED ON OUTLINE ZONING PLAN No.  
S/YL-KTN/9 APPROVED ON 2.12.2014

規劃署  
PLANNING DEPARTMENT



參考編號 REFERENCE No.  
A/YL-KTN/669

圖 PLAN  
A-1



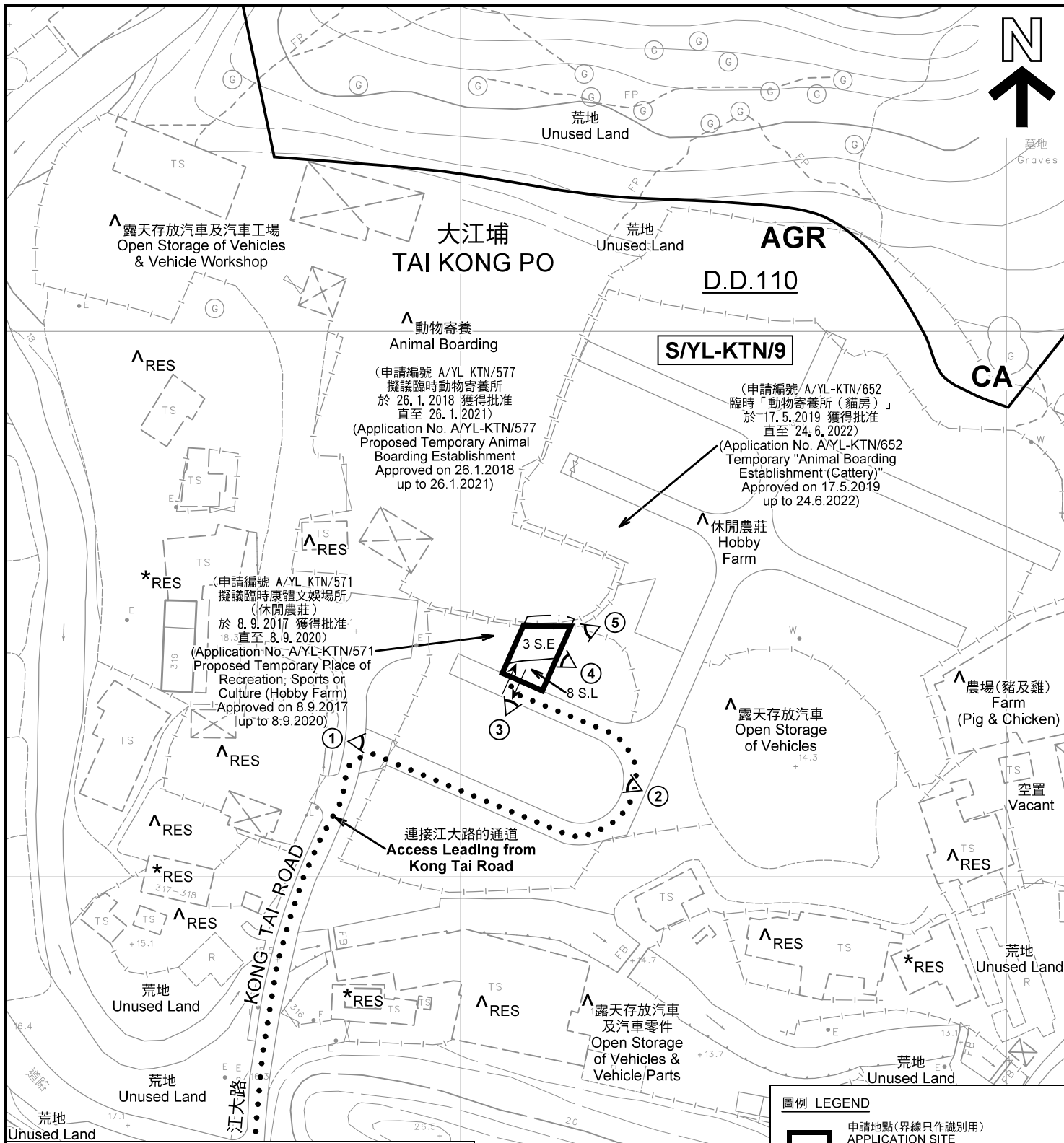

註釋 Notes :

- (1) 2019年6月18日勘測的土地用途  
Land uses shown on this plan are in accordance with the land use survey conducted by the Planning Department on 18.6.2019
- (2) \* 土地用途跟1992年2月20日勘測的土地用途一致  
Indicates that the use is the same as that revealed by the land use survey conducted by the Planning Department on 20.2.1992
- (3) ^ 土地用途跟1992年2月20日勘測的土地用途有別  
Indicates that the use is different from that revealed by the land use survey conducted by the Planning Department on 20.2.1992

平面圖 SITE PLAN

擬議臨時動物寄養所（貓房）（為期3年）  
元朗錦田大江埔丈量約份第110約地段第3號E分段（部分）及第8號L分段  
PROPOSED TEMPORARY ANIMAL BOARDING ESTABLISHMENT (CATTERY) FOR A PERIOD OF 3 YEARS  
LOTS 3 S.E (PART) AND 8 S.L IN D.D. 110,  
TAI KONG PO, KAM TIN, YUEN LONG

本摘要圖於2019年7月11日擬備，所根據的資料為測量圖編號 6-NE-8A  
EXTRACT PLAN PREPARED ON 11.7.2019  
BASED ON SURVEY SHEET No. 6-NE-8A

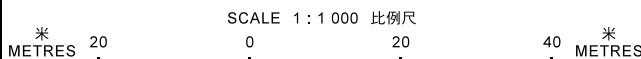

圖例 LEGEND

- 申請地點（界線只作識別用）  
APPLICATION SITE (BOUNDARY FOR IDENTIFICATION PURPOSE ONLY)
- AGR** 農業  
AGRICULTURE
- CA** 自然保育區  
CONSERVATION AREA
- RES** 住用構築物  
RESIDENTIAL STRUCTURES
- 實地照片的觀景點  
VIEWING POINT OF SITE PHOTO
- 入口/出口  
INGRESS / EGRESS

規劃署  
PLANNING  
DEPARTMENT



參考編號  
REFERENCE No.  
A/YL-KTN/669

圖 PLAN  
A-2



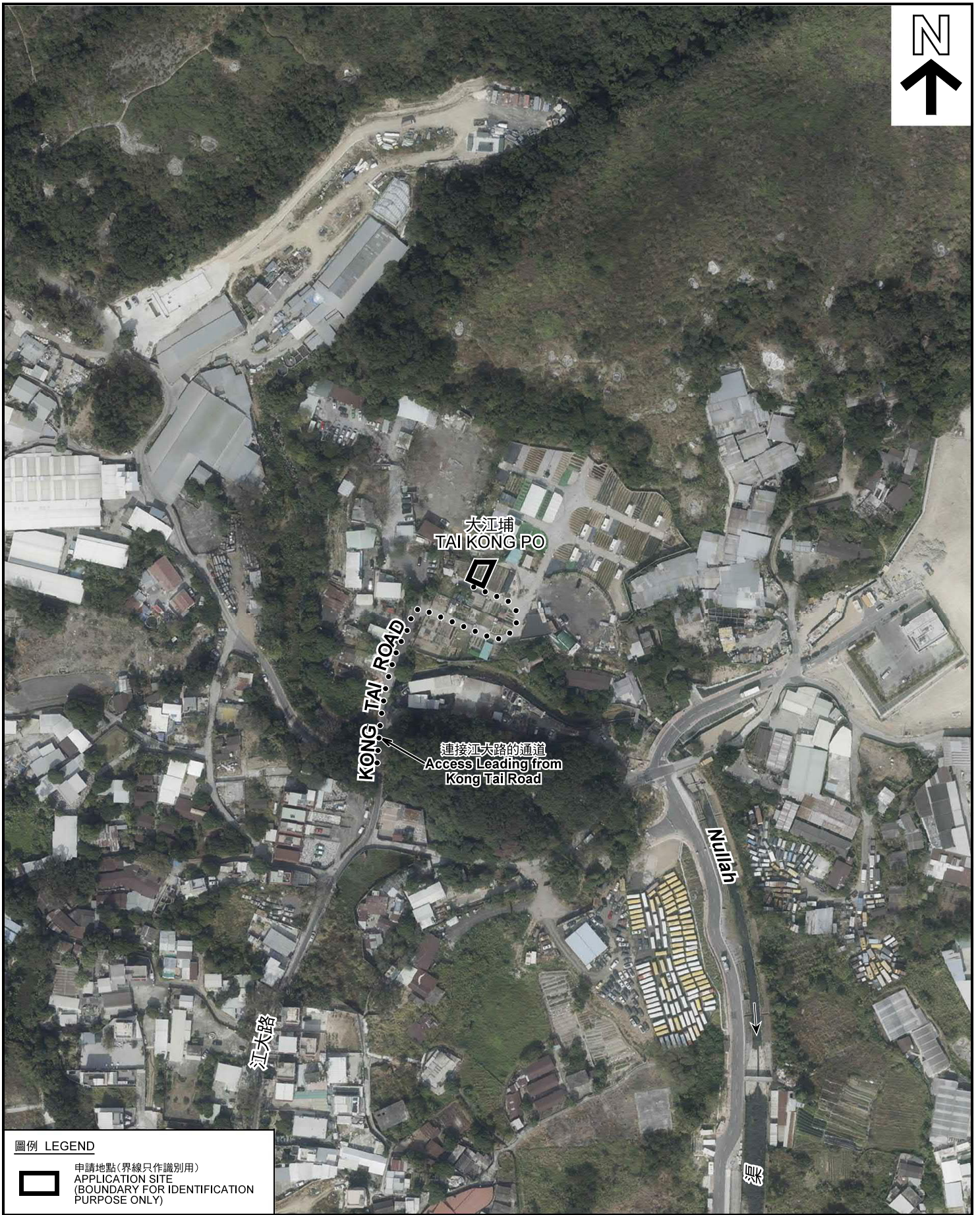

圖例 LEGEND



申請地點(界線只作識別用)  
APPLICATION SITE  
(BOUNDARY FOR IDENTIFICATION  
PURPOSE ONLY)

本摘要圖於2019年7月3日擬備，所根據的資料為地政總署於2018年1月3日拍得的航攝照片編號 E032817C  
EXTRACT PLAN PREPARED ON 3.7.2019  
BASED ON AERIAL PHOTO No.  
E032817C TAKEN ON 3.1.2018  
BY LANDS DEPARTMENT

航攝照片 AERIAL PHOTO

擬議臨時動物寄養所(貓房)(為期3年)  
元朗錦田大江埔丈量約份第110約地段第3號E分段(部分)及第8號L分段  
PROPOSED TEMPORARY ANIMAL BOARDING ESTABLISHMENT  
(CATTERY) FOR A PERIOD OF 3 YEARS  
LOTS 3 S.E (PART) AND 8 S.L IN D.D. 110,  
TAI KONG PO, KAM TIN, YUEN LONG

規劃署  
PLANNING  
DEPARTMENT



參考編號  
REFERENCE No.  
A/YL-KTN/669

圖 PLAN  
A-3



1



2



3



4



5



申請地點界線只作識別用 APPLICATION SITE BOUNDARY FOR IDENTIFICATION PURPOSE ONLY

本圖於2019年7月23日擬備，所根據的資料為攝於2019年6月18日的實地照片  
 PLAN PREPARED ON 23.7.2019  
 BASED ON SITE PHOTOS  
 TAKEN ON 18.6.2019

**實地照片 SITE PHOTOS**

擬議臨時動物寄養所(貓房) (為期3年)  
 元朗錦田大江埔丈量約份第110約地段第3號E分段(部分)及第8號L分段  
 PROPOSED TEMPORARY ANIMAL BOARDING ESTABLISHMENT  
 (CATTERY) FOR A PERIOD OF 3 YEARS  
 LOTS 3 S.E (PART) AND 8 S.L IN D.D. 110,  
 TAI KONG PO, KAM TIN, YUEN LONG

規劃署  
**PLANNING DEPARTMENT**



參考編號  
 REFERENCE No.  
 A/YL-KTN/669

圖 PLAN  
 A-4