

Drawing No.	Ver.
P01	01
Project	
PROPOSED TEMPORARY PUBLIC VEHICLE PARK (PRIVATE CAR ONLY) FOR A PERIOD OF 5 YEARS	
LOT 411 (PART) IN D.D. 105	
Drawing Title	
LOCATION PLAN	
Scale of All	
1:1000	
Drawn	Date
	16.7.2019
Revised	Drawn

(摘錄自申請人於 15.8.2019 呈交的申請書)
 (Extract from Applicant's
 Submission of 15.8.2019)

參考編號 REFERENCE No.	繪圖 DRAWING
A/YL-NTM/392	A-1

DEVELOPMENT PARAMETERS

APPLICATION SITE AREA: 1,063m² (ABOUT)
 COVERED AREA: N/A
 UNCOVERED AREA: 1,063m² (ABOUT)

NO. OF PRIVATE CAR PARKING SPACE (2.5m X 5m): 20

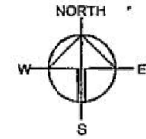
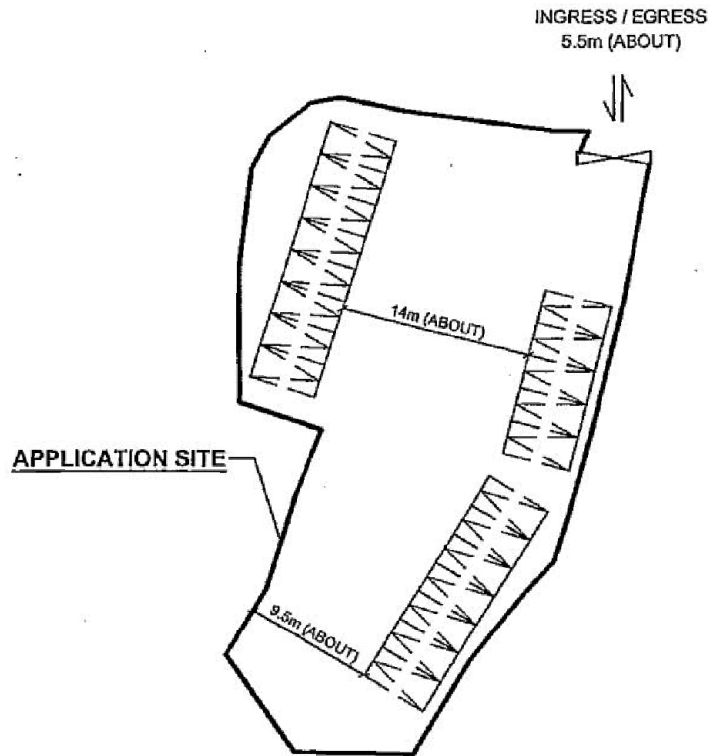

Drawing No.	Ver.
P02	01
Project	
PROPOSED TEMPORARY PUBLIC VEHICLE PARK (PRIVATE CAR ONLY) FOR A PERIOD OF 5 YEARS	
LOT 411 (PART) IN D.D. 105	
Drawing Title	
LAYOUT PLAN	
Scale of A4	
1:500	
Drawn	Date
	16.7.2019
Revised	Date

LEGEND
 PARKING SPACE

(摘錄自申請人於 15.8.2019 呈交的申請書)
 (Extract from Applicant's Submission of 15.8.2019)

參考編號 REFERENCE No.	繪圖 DRAWING
A/YL-NTM/392	A-2

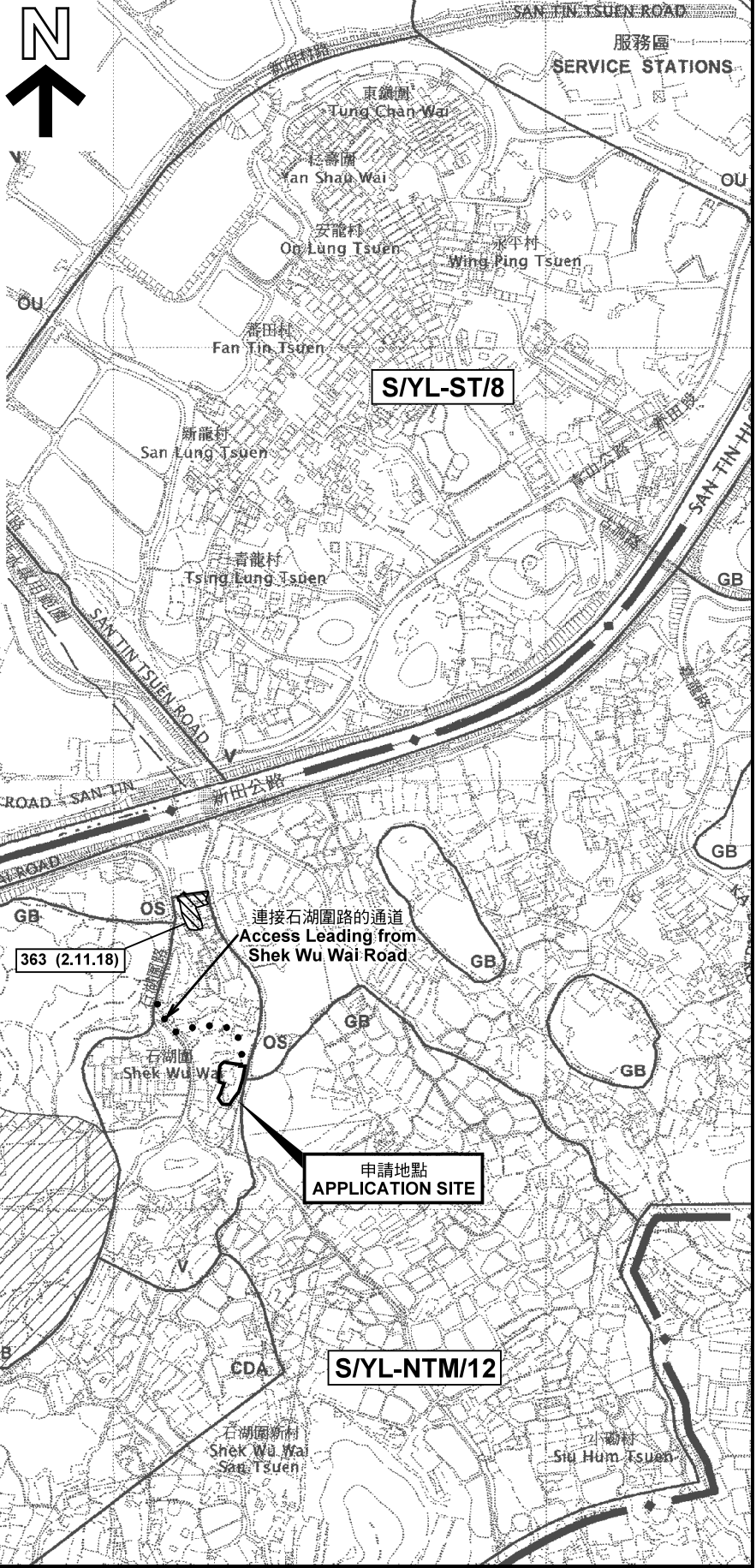

圖例 LEGEND

243 (17.7.04)	獲批准的申請 APPROVED APPLICATION
244 (17.7.04)	被拒絕的申請 REJECTED APPLICATION
72 (10.9.99) X	已撤銷 REVOKED
---	會議日期 DATE OF MEETING
---	申請編號 APPLICATION NUMBER

申請地點界線只作識別用
APPLICATION SITE BOUNDARY
FOR IDENTIFICATION PURPOSE ONLY

本摘要圖於2019年9月13日擬備，
所根據的資料為於2006年12月5日
核准的分區計劃大綱圖編號 S/YL-NTM/12
EXTRACT PLAN PREPARED ON 13.9.2019
BASED ON OUTLINE ZONING PLAN No.
S/YL-NTM/12 APPROVED ON 5.12.2006

位置圖 LOCATION PLAN

擬議臨時公眾停車場（只限私家車）（為期5年）
元朗石湖圍丈量約份第105約地段第411號（部分）
PROPOSED TEMPORARY PUBLIC VEHICLE PARK
(PRIVATE CAR ONLY) FOR A PERIOD OF 5 YEARS
LOT 411 (PART) IN D.D. 105, SHEK WU WAI, YUEN LONG

SCALE 1 : 7 500 比例尺

米 100 0 100 200 300 米
METRES

**規劃署
PLANNING
DEPARTMENT**



參考編號
REFERENCE No.
A/YL-NTM/392

**圖 PLAN
A-1**

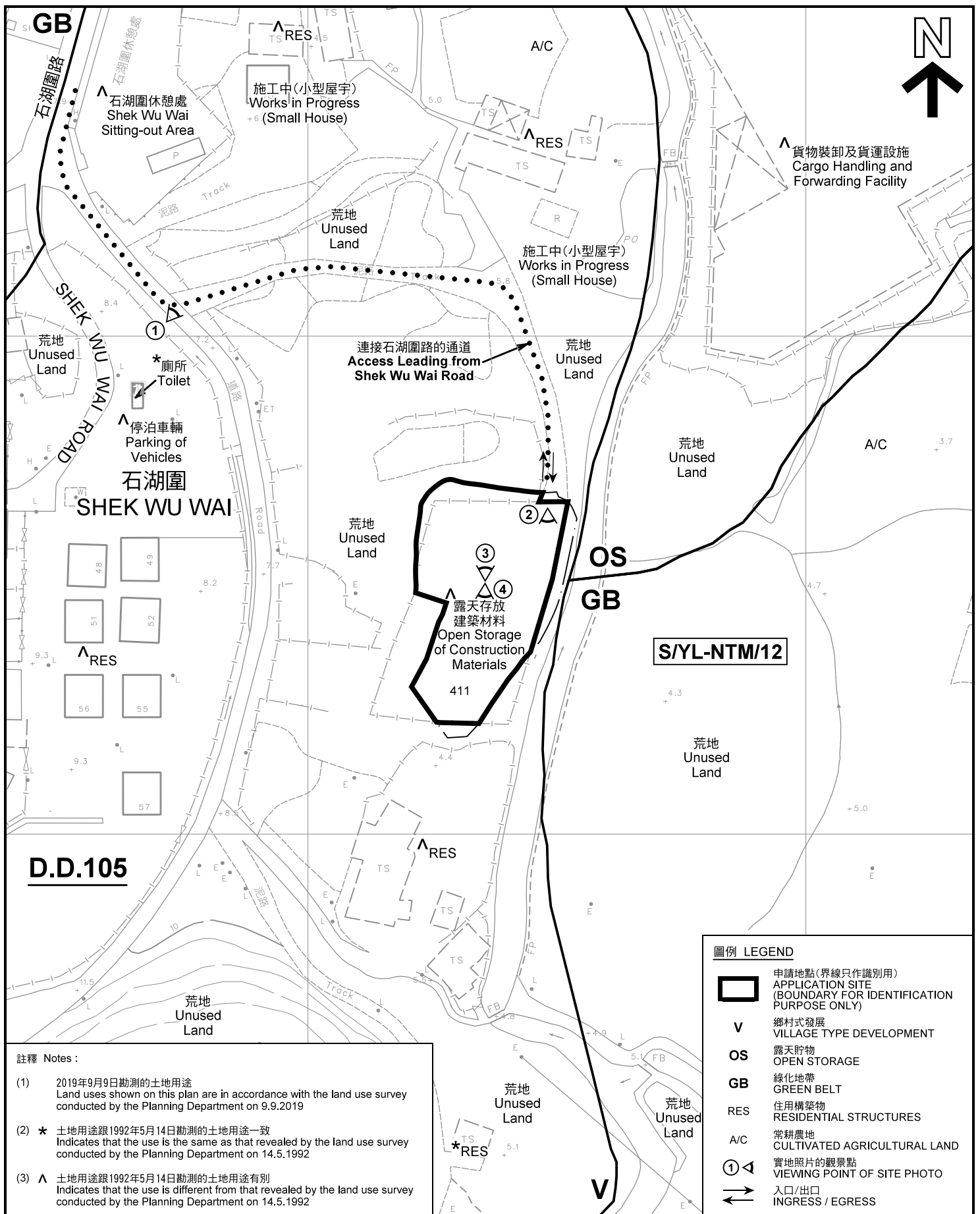

平面圖 SITE PLAN

擬議臨時公眾停車場 (只限私家車) (為期5年)
元朗石湖圍丈量約份第105約地段第411號 (部分)
PROPOSED TEMPORARY PUBLIC VEHICLE PARK
(PRIVATE CAR ONLY) FOR A PERIOD OF 5 YEARS
LOT 411 (PART) IN D.D. 105, SHEK WU WAI, YUEN LONG

本摘要圖於2019年9月13日擬備, 所根據的資料為測量圖編號 2-SE-13A
EXTRACT PLAN PREPARED ON 13.9.2019
BASED ON SURVEY SHEETS No.
2-SE-13A

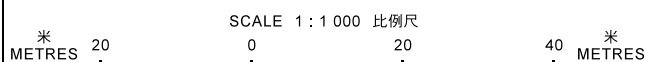

規劃署
PLANNING
DEPARTMENT



參考編號
REFERENCE No.
A/YL-NTM/392

圖 PLAN
A-2



圖例 LEGEND



申請地點(界線只作識別用)
APPLICATION SITE
(BOUNDARY FOR IDENTIFICATION
PURPOSE ONLY)

本摘要圖於2019年9月13日擬備，所根據的資料為地政總署於2017年4月3日拍得的航攝照片編號 E018661C
EXTRACT PLAN PREPARED ON 13.9.2019
BASED ON AERIAL PHOTO No.
E018661C TAKEN ON 3.4.2017
BY LANDS DEPARTMENT

航攝照片 AERIAL PHOTO

擬議臨時公眾停車場(只限私家車)(為期5年)
元朗石湖圍丈量約份第105約地段第411號(部分)
PROPOSED TEMPORARY PUBLIC VEHICLE PARK
(PRIVATE CAR ONLY) FOR A PERIOD OF 5 YEARS
LOT 411 (PART) IN D.D. 105, SHEK WU WAI, YUEN LONG

規劃署
PLANNING
DEPARTMENT



參考編號
REFERENCE No.
A/YL-NTM/392

圖 PLAN
A-3



申請地點界線只作識別用 APPLICATION SITE BOUNDARY FOR IDENTIFICATION PURPOSE ONLY

本圖於2019年9月13日擬備，所根據的資料為攝於2019年9月9日的實地照片
 PLAN PREPARED ON 13.9.2019
 BASED ON SITE PHOTOS
 TAKEN ON 9.9.2019

實地照片 SITE PHOTOS
 擬議臨時公眾停車場（只限私家車）（為期5年）
 元朗石湖圍丈量約份第105約地段第411號（部分）
 PROPOSED TEMPORARY PUBLIC VEHICLE PARK
 (PRIVATE CAR ONLY) FOR A PERIOD OF 5 YEARS
 LOT 411 (PART) IN D.D. 105, SHEK WU WAI, YUEN LONG

規劃署
 PLANNING
 DEPARTMENT



參考編號
 REFERENCE No.
 A/YL-NTM/392

圖 PLAN
 A-4