

DEVELOPMENT PARAMETERS

APPLICATION SITE AREA: 755m² (ABOUT)
 COVERED AREA: 346m² (ABOUT)
 UNCOVERED AREA: 409m² (ABOUT)

NO. OF STRUCTURE: 12
 NON-DOMESTIC GFA: 692m² (ABOUT)
 BUILDING HEIGHT: 7m (ABOUT)
 NO. OF STOREY: 2

NO. OF L/UL SPACE FOR LGV (3.5m X 7m): 1

STRUCTURE	USE	COVERED AREA	GFA	BUILDING HEIGHT
B1	SHOP & SERVICES	33m ² (ABOUT)	66m ² (ABOUT)	7m (ABOUT)(2-STOREY)
B2	SHOP & SERVICES	15m ² (ABOUT)	30m ² (ABOUT)	7m (ABOUT)(2-STOREY)
B3	SHOP & SERVICES	22m ² (ABOUT)	44m ² (ABOUT)	7m (ABOUT)(2-STOREY)
B4	SHOP & SERVICES	24m ² (ABOUT)	48m ² (ABOUT)	7m (ABOUT)(2-STOREY)
B5	SHOP & SERVICES	27m ² (ABOUT)	54m ² (ABOUT)	7m (ABOUT)(2-STOREY)
B6	SHOP & SERVICES	32m ² (ABOUT)	64m ² (ABOUT)	7m (ABOUT)(2-STOREY)
B7	SHOP & SERVICES	31m ² (ABOUT)	62m ² (ABOUT)	7m (ABOUT)(2-STOREY)
B8	SHOP & SERVICES	39m ² (ABOUT)	78m ² (ABOUT)	7m (ABOUT)(2-STOREY)
B9	SHOP & SERVICES	40m ² (ABOUT)	80m ² (ABOUT)	7m (ABOUT)(2-STOREY)
B10	SHOP & SERVICES	38m ² (ABOUT)	76m ² (ABOUT)	7m (ABOUT)(2-STOREY)
B11	SHOP & SERVICES	30m ² (ABOUT)	60m ² (ABOUT)	7m (ABOUT)(2-STOREY)
B12	SHOP & SERVICES	15m ² (ABOUT)	30m ² (ABOUT)	7m (ABOUT)(2-STOREY)
TOTAL		346m² (ABOUT)	692m² (ABOUT)	

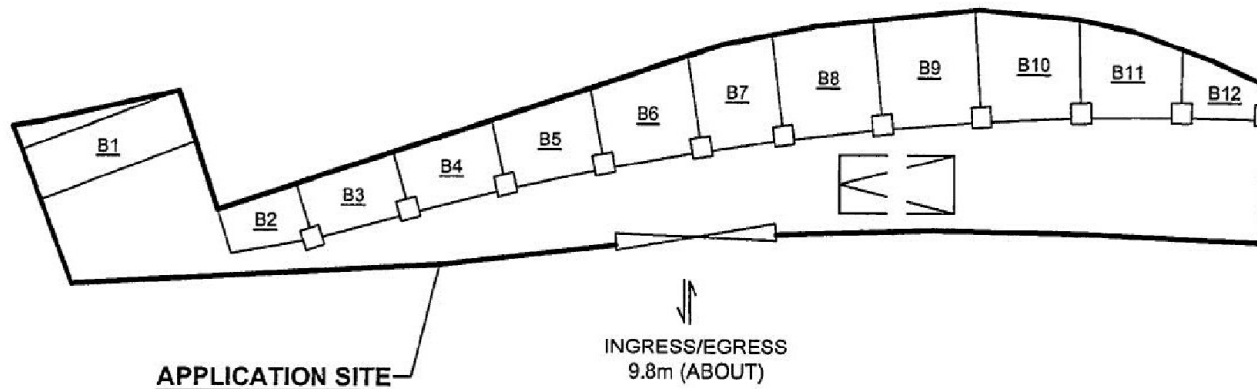

APPLICATION SITE

INGRESS/EGRESS
9.8m (ABOUT)

LEGEND

- B1 STRUCTURE
- LANDSCAPING AREA
- LOADING/UNLOADING SPACE

Drawing No.	Var.
P02	02
Project	
PROPOSED TEMPORARY SHOP AND SERVICES WITH ANCILLARY FACILITIES FOR A PERIOD OF 5 YEARS	
LOT 1458 S.B (PART) AND 1459 S.B IN D.D.111 AND ADJOINING GOVERNMENT LAND	
Drawing Title	
LAYOUT PLAN	
Scale of A1	
4:400	
Drawn	Date
	25.4.2019
Revised	Date
	29.4.2019

(摘錄自申請人於 22.5.2019 呈交的進一步資料)
 (Extract from Applicant's Further Information Submitted on 22.5.2019)

參考編號
 REFERENCE No.
 A/YL-PH/807

繪圖 DRAWING
 A-1

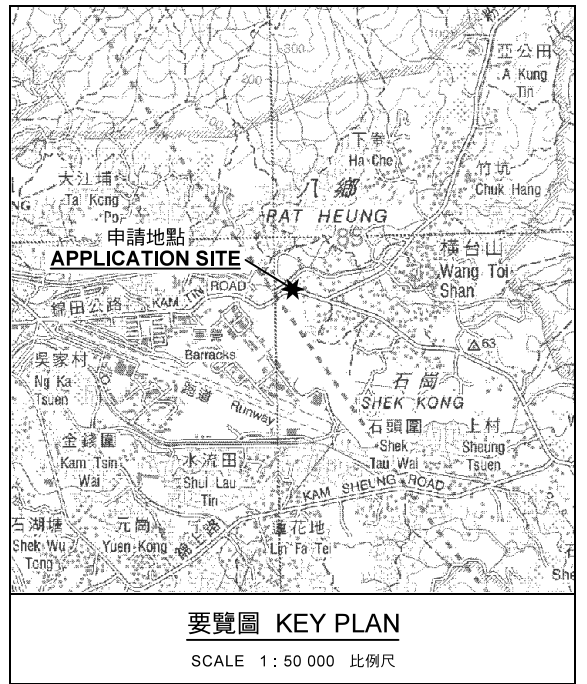
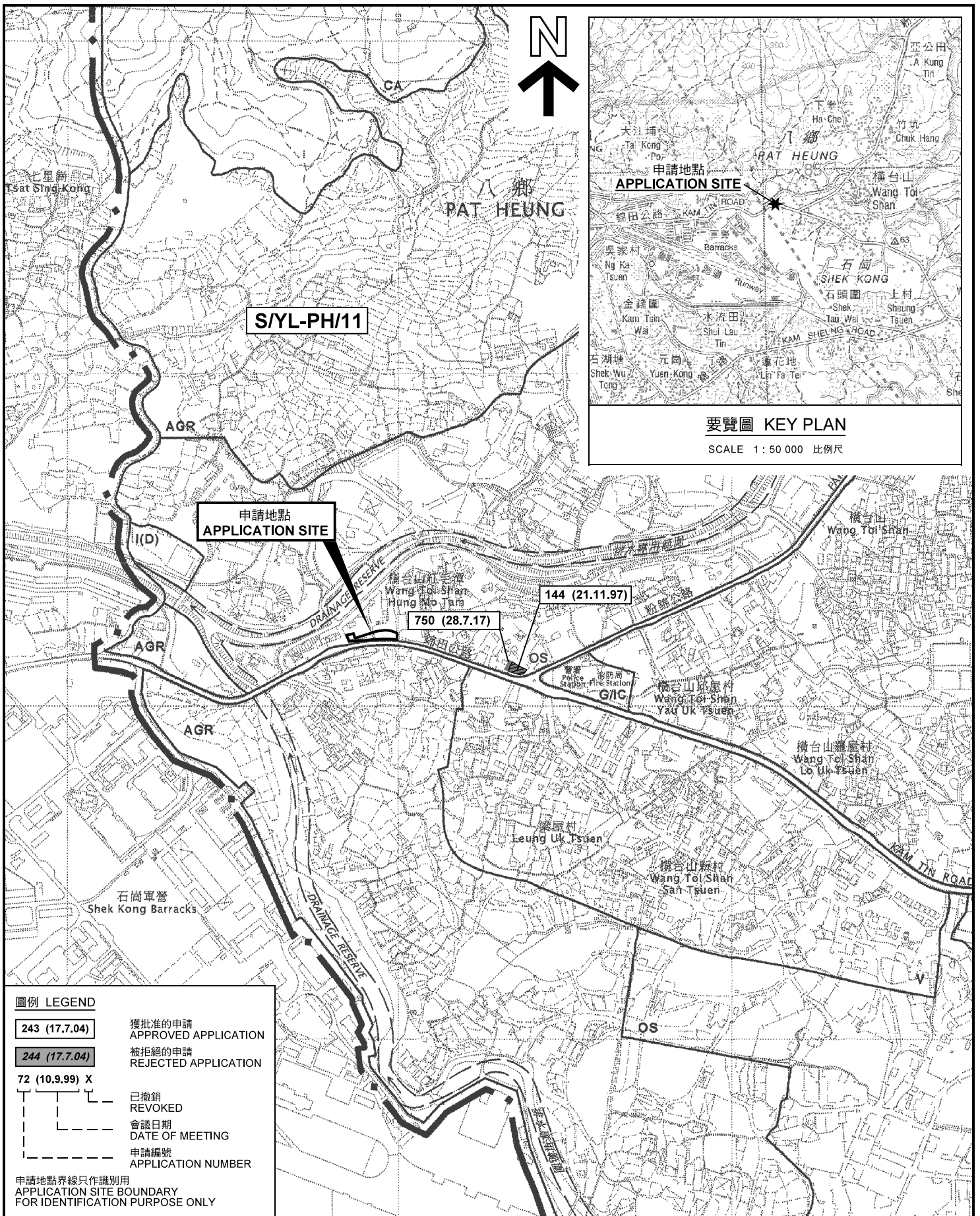

圖例 LEGEND

- 243 (17.7.04) 獲批准的申請
APPROVED APPLICATION
- 244 (17.7.04) 被拒絕的申請
REJECTED APPLICATION
- 72 (10.9.99) X 已撤銷
REVOKED
- - - 會議日期
DATE OF MEETING
- - - 申請編號
APPLICATION NUMBER

申請地點界線只作識別用
APPLICATION SITE BOUNDARY
FOR IDENTIFICATION PURPOSE ONLY

位置圖及同類申請 LOCATION PLAN WITH SIMILAR APPLICATION

擬議臨時商店及服務行業連附屬設施（為期5年）
元朗八鄉丈量約份第111約地段第1458號B分段（部分）及
第1459號B分段和丈量約份第110約的毗連政府土地
PROPOSED TEMPORARY SHOP AND SERVICES
WITH ANCILLARY FACILITIES FOR A PERIOD OF 5 YEARS
LOTS 1458 S.B (PART) AND 1459 S.B IN D.D. 111, AND ADJOINING
GOVERNMENT LAND IN D.D. 110, PAT HEUNG, YUEN LONG

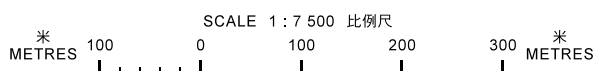

本摘要圖於2019年6月20日擬備，
所根據的資料為於2006年10月17日
核准的分區計劃大綱圖編號 S/YL-PH/11
EXTRACT PLAN PREPARED ON 20.6.2019
BASED ON OUTLINE ZONING PLAN No.
S/YL-PH/11 APPROVED ON 17.10.2006

**規劃署
PLANNING
DEPARTMENT**



參考編號
REFERENCE No.
A/YL-PH/807

**圖 PLAN
A-1a**

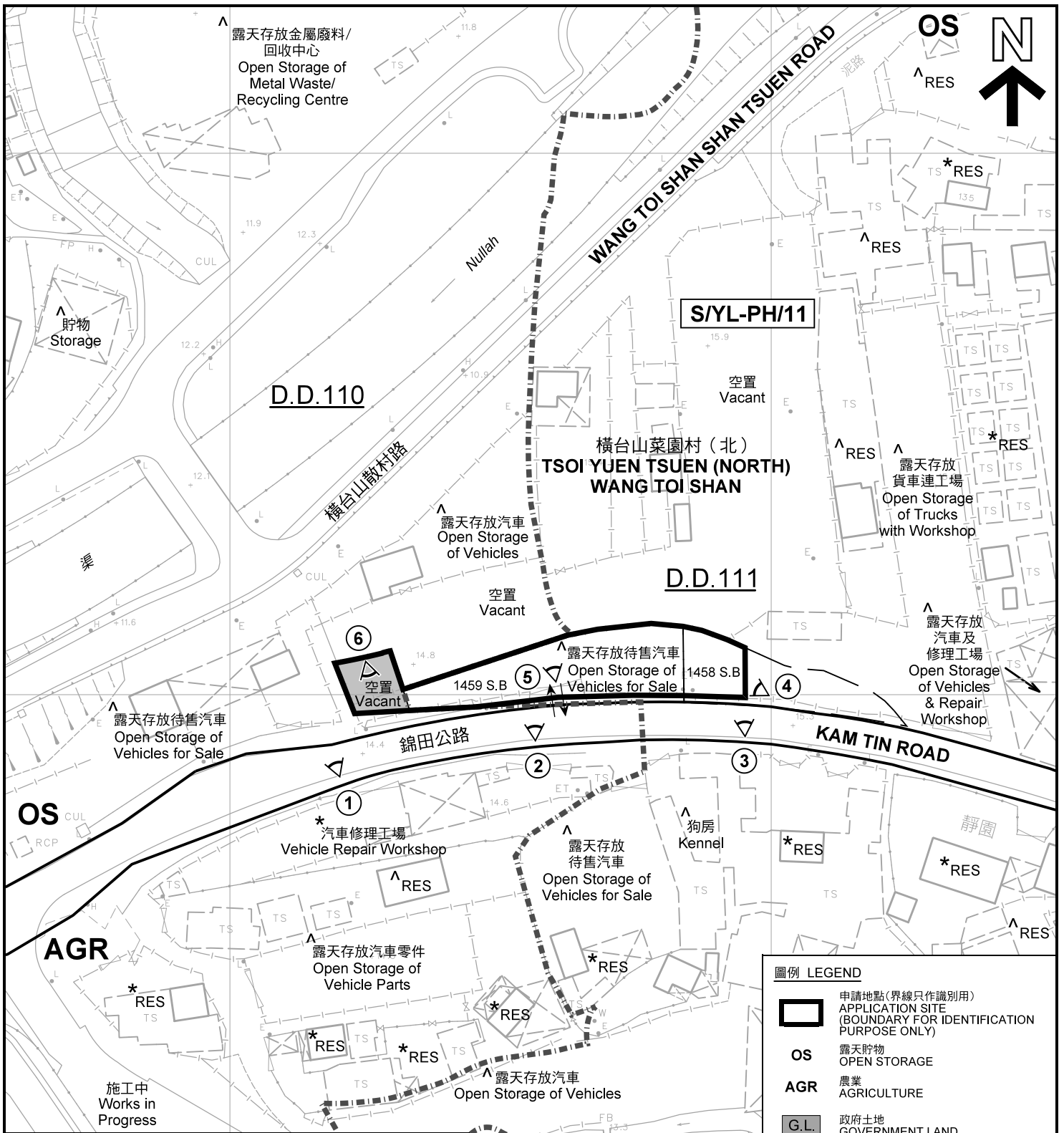

註釋 Notes :

- (1) 2019年3月25日勘測的土地用途
Land uses shown on this plan are in accordance with the land use survey conducted by the Planning Department on 25.3.2019
- (2) * 土地用途跟1991年12月17日勘測的土地用途一致
Indicates that the use is the same as that revealed by the land use survey conducted by the Planning Department on 17.12.1991
- (3) ^ 土地用途跟1991年12月17日勘測的土地用途有別
Indicates that the use is different from that revealed by the land use survey conducted by the Planning Department on 17.12.1991

圖例 LEGEND

- 申請地點(界線只作識別用)
APPLICATION SITE (BOUNDARY FOR IDENTIFICATION PURPOSE ONLY)
- OS** 露天貯物
OPEN STORAGE
- AGR** 農業
AGRICULTURE
- G.L.** 政府土地
GOVERNMENT LAND
- RES** 住用構築物
RESIDENTIAL STRUCTURES
- A/F** 休耕農地
FALLOW AGRICULTURAL LAND
- 實地照片的觀景點
VIEWING POINT OF SITE PHOTO
- 丈量約份界線
D.D. BOUNDARY
- 入口/出口
INGRESS / EGRESS

平面圖 SITE PLAN

擬議臨時商店及服務行業連附屬設施(為期5年)
元朗八鄉丈量約份第111約地段第1458號B分段(部分)及
第1459號B分段和丈量約份第110約的毗連政府土地
PROPOSED TEMPORARY SHOP AND SERVICES
WITH ANCILLARY FACILITIES FOR A PERIOD OF 5 YEARS
LOTS 1458 S.B (PART) AND 1459 S.B IN D.D. 111, AND ADJOINING
GOVERNMENT LAND IN D.D. 110, PAT HEUNG, YUEN LONG

SCALE 1 : 1 000 比例尺

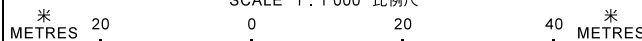

本摘要圖於2019年6月20日擬備, 所根據的資料為測量圖編號 6-NE-8D, 9C, 13B 及 14A
EXTRACT PLAN PREPARED ON 20.6.2019
BASED ON SURVEY SHEETS No. 6-NE-8D, 9C, 13B & 14A

**規劃署
PLANNING
DEPARTMENT**



參考編號
REFERENCE No.
A/YL-PH/807

**圖 PLAN
A-2**



橫台山紅毛潭
WANG TOI SHAN
HUNG MO TAM

WANG TOI SHAN SHAN TSUEN ROAD

橫台山菜園村(北)
TSOI YUEN TSUEN (NORTH)
WANG TOI SHAN

橫台山散村路

錦田公路

橫台山菜園村(北)
TSOI YUEN TSUEN (NORTH)
WANG TOI SHAN

KAM TIN ROAD

石崗列車停放處及緊急救援處
Shek Kong Stabling Sidings
and Emergency Rescue Siding

行政路

緊急救援西路

中路
CENTRAL ROAD

ERS WEST ROAD
ADMINISTRATION ROAD

梁屋村
LEUNG UK
TSUEN

圖例 LEGEND



申請地點(界線只作識別用)
APPLICATION SITE
(BOUNDARY FOR IDENTIFICATION
PURPOSE ONLY)

本摘要圖於2019年6月20日擬備, 所根據的資料為地政總署於2018年3月13日拍得的航攝照片編號 E035221C
EXTRACT PLAN PREPARED ON 20.6.2019
BASED ON AERIAL PHOTO No.
E035221C TAKEN ON 13.3.2018
BY LANDS DEPARTMENT

航攝照片 AERIAL PHOTO

擬議臨時商店及服務行業連附屬設施(為期5年)
元朗八鄉丈量約份第111約地段第1458號B分段(部分)及
第1459號B分段和丈量約份第110約的毗連政府土地
PROPOSED TEMPORARY SHOP AND SERVICES
WITH ANCILLARY FACILITIES FOR A PERIOD OF 5 YEARS
LOTS 1458 S.B (PART) AND 1459 S.B IN D.D. 111, AND ADJOINING
GOVERNMENT LAND IN D.D. 110, PAT HEUNG, YUEN LONG

規劃署
PLANNING
DEPARTMENT



參考編號
REFERENCE No.
A/YL-PH/807

圖 PLAN
A-3

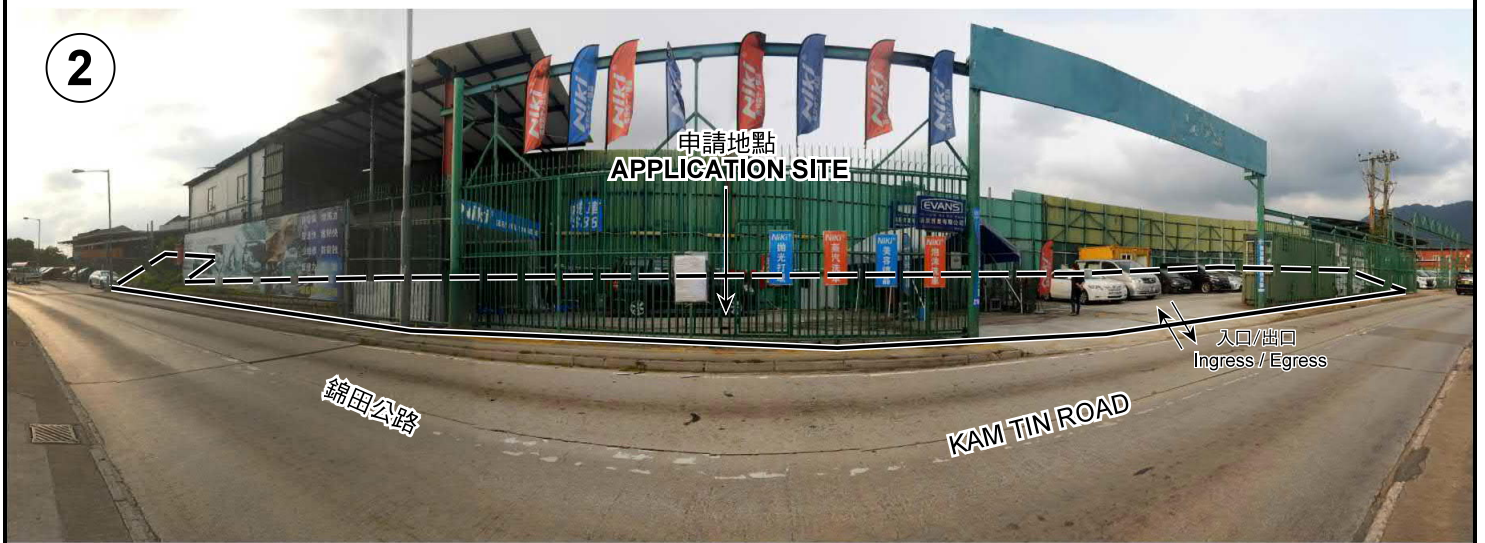

申請地點界線只作識別用 APPLICATION SITE BOUNDARY FOR IDENTIFICATION PURPOSE ONLY

實地照片 SITE PHOTOS

本圖於2019年6月26日擬備，所根據的資料為攝於2019年3月22日的實地照片
PLAN PREPARED ON 26.6.2019
BASED ON SITE PHOTOS
TAKEN ON 22.3.2019

擬議臨時商店及服務行業連附屬設施（為期5年）
元朗八鄉丈量約份第111約地段第1458號B分段（部分）及
第1459號B分段和丈量約份第110約的毗連政府土地
PROPOSED TEMPORARY SHOP AND SERVICES
WITH ANCILLARY FACILITIES FOR A PERIOD OF 5 YEARS
LOTS 1458 S.B (PART) AND 1459 S.B IN D.D. 111, AND ADJOINING
GOVERNMENT LAND IN D.D. 110, PAT HEUNG, YUEN LONG

規劃署
PLANNING
DEPARTMENT



參考編號
REFERENCE No.
A/YL-PH/807

圖 PLAN
A-4a



申請地點
APPLICATION SITE



申請地點
APPLICATION SITE



申請地點
APPLICATION SITE

申請地點界線只作識別用 APPLICATION SITE BOUNDARY FOR IDENTIFICATION PURPOSE ONLY

實地照片 SITE PHOTOS

擬議臨時商店及服務行業連附屬設施（為期5年）
元朗八鄉丈量約份第111約地段第1458號B分段（部分）及
第1459號B分段和丈量約份第110約的毗連政府土地
PROPOSED TEMPORARY SHOP AND SERVICES
WITH ANCILLARY FACILITIES FOR A PERIOD OF 5 YEARS
LOTS 1458 S.B (PART) AND 1459 S.B IN D.D. 111, AND ADJOINING
GOVERNMENT LAND IN D.D. 110, PAT HEUNG, YUEN LONG

規劃署
PLANNING
DEPARTMENT



參考編號
REFERENCE No.
A/YL-PH/807

圖 PLAN
A-4b

本圖於2019年6月26日擬備，所根據的資料為攝於2019年3月22日的實地照片
PLAN PREPARED ON 26.6.2019
BASED ON SITE PHOTOS
TAKEN ON 22.3.2019