

Plan 1

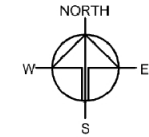

DEVELOPMENT PARAMETERS

APPLICATION SITE AREA: 2,359m² (ABOUT)
 COVERED AREA: 255m² (ABOUT)
 UNCOVERED AREA: 2,104m² (ABOUT)

NO. OF STRUCTURE: 8
 NON-DOMESTIC GFA: 255m² (ABOUT)
 BUILDING HEIGHT: 2.8m - 3m (ABOUT)
 NO. OF STOREY: 1

NO. OF PRIVATE CAR PARKING SPACE (2.5m X 5m): 5
 NO. OF L/UL SPACE FOR LGV (3.5m X 7m): 1

FARM AREA: 1,207m² (51%)(ABOUT)
 SOILED GROUND: 1,152 (49%)(ABOUT)

NO. OF FARMER RESTING ROOM (CARAVAN CONVERTED): 5
 DIMENSION OF CARAVAN: 7.62m (L) X 2.44m (W) X 2.8m (H) (ABOUT)
 COVERED AREA: 18.6m² (ABOUT)
 TOTAL COVERED AREA: 18.6m² X 5 = 93m² (ABOUT)

*CARAVAN WILL BE PROVIDED BY THE APPLICANT

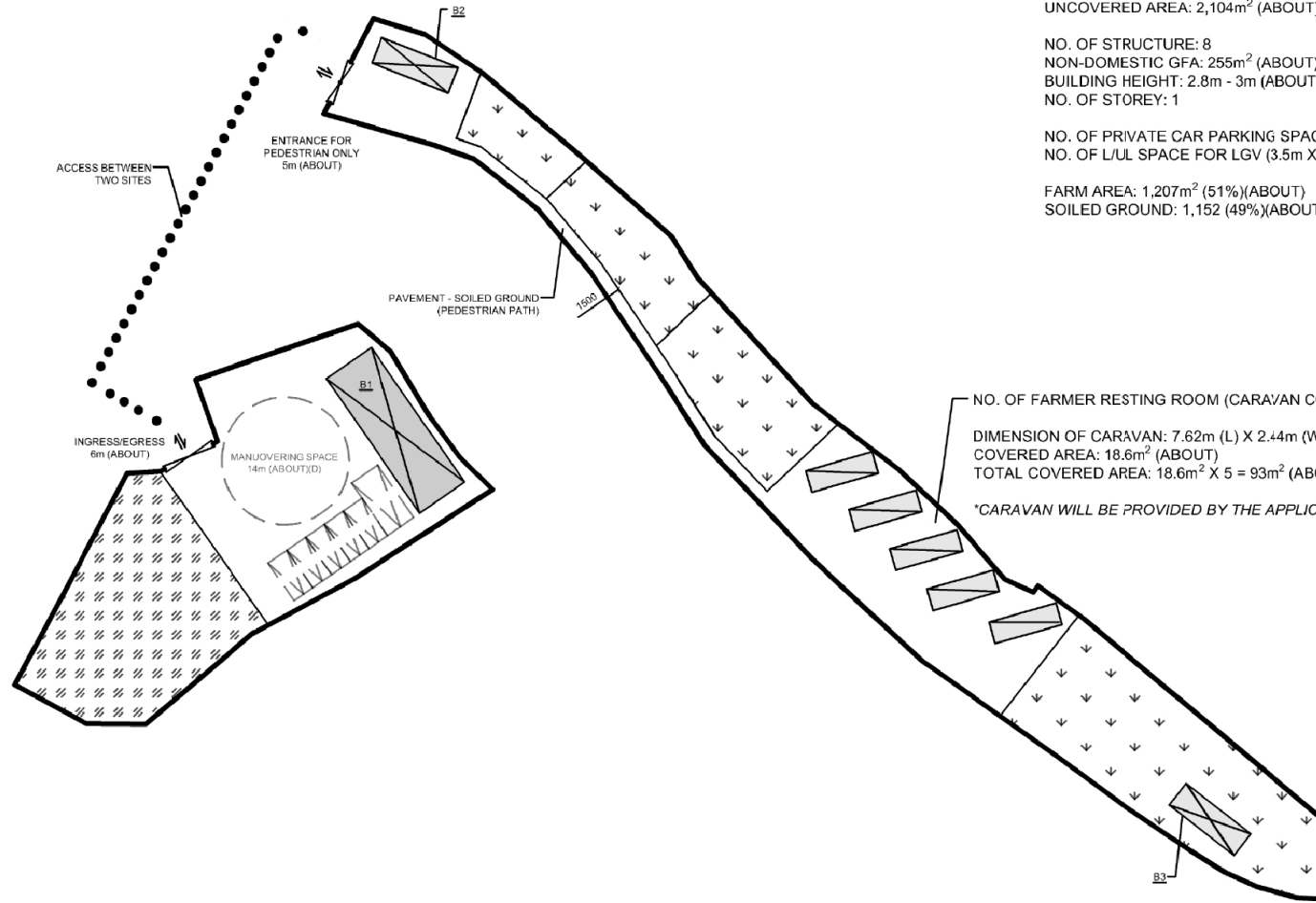

STRUCTURE	USE	COVERED AREA	NON-DOM. GFA	BUILDING HEIGHT
B1	VISITOR CENTRE	108m ² (ABOUT)	108m ² (ABOUT)	3m (ABOUT)(1-STOREY)
B2	REFRESHMENT KIOSK	27m ² (ABOUT)	27m ² (ABOUT)	3m (ABOUT)(1-STOREY)
B3	STORAGE OF FARM TOOLS	27m ² (ABOUT)	27m ² (ABOUT)	3m (ABOUT)(1-STOREY)
TOTAL		162m² (ABOUT)	162m² (ABOUT)	

LEGEND

- STRUCTURE
- PARKING/ L/UL SPACE
- CANOPY
- CARAVAN CONVERTED STRUCTURE
- FARM (VEGETABLE)
- FARM (FRUIT)

Drawing No. P03	Ver. 02
Project PROPOSED TEMPORARY PLACE OF RECREATION, SPORTS AND CULTURE (HOBBY FARM) FOR A PERIOD OF 5 YEARS	
LOT 913 RP (PART) AND V.L. IN D.D. 107, FUNG KAT HEUNG, YUEN LONG	
Drawing Title LAYOUT PLAN	
Scale of A1 1:700	
Drawn	Date 12.6.2019
Revised	Date 7.8.2019

(摘錄自申請人於 7.8.2019 呈交的進一步資料)
 (Extract from Applicant's Further Information Submitted on 7.8.2019)

參考編號 REFERENCE No. A/YL-KTN/670	繪圖 DRAWING A-1
---------------------------------------	-------------------

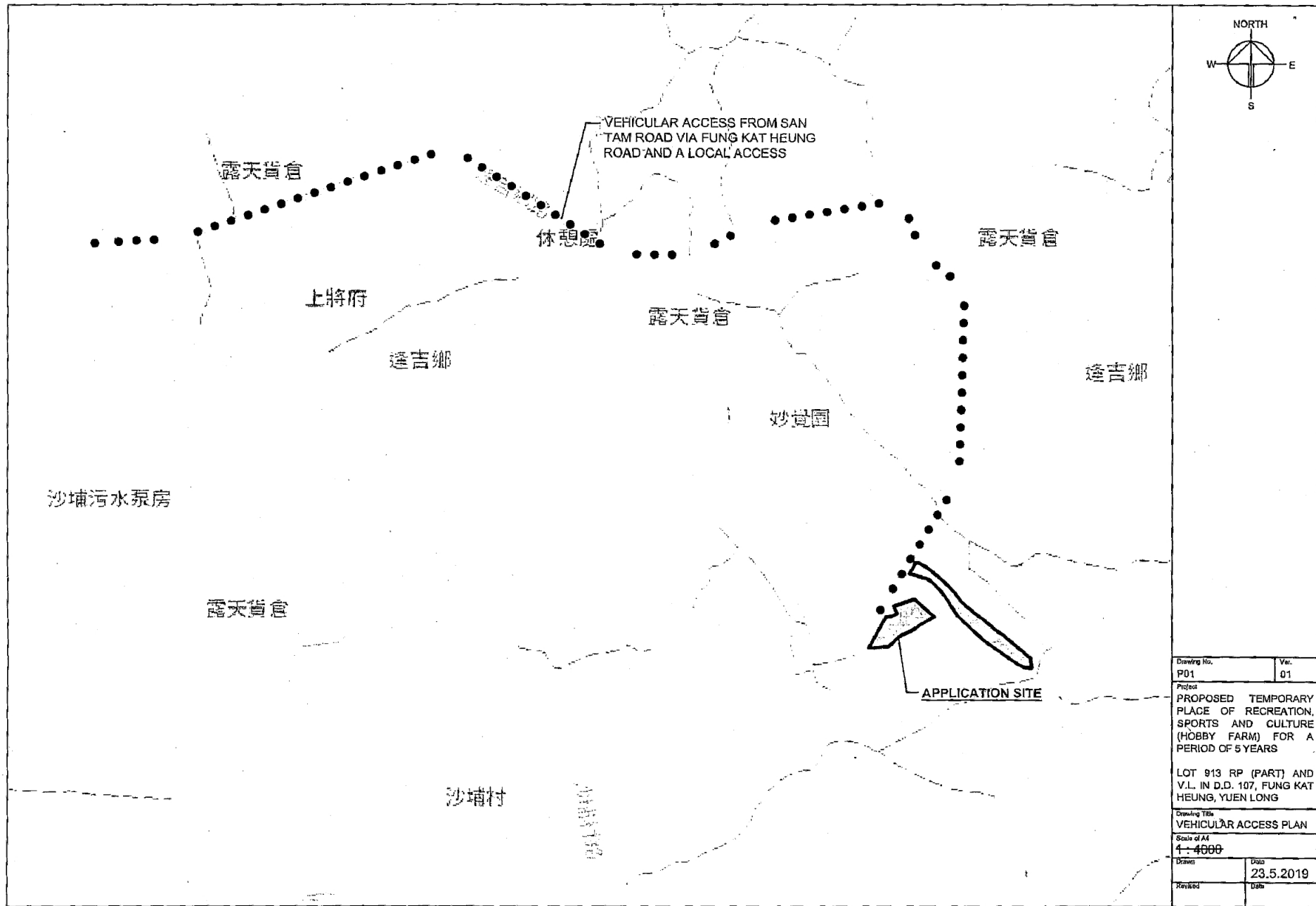

Drawing No.	Ver.
P01	01
Project	
PROPOSED TEMPORARY PLACE OF RECREATION, SPORTS AND CULTURE (HOBBY FARM) FOR A PERIOD OF 5 YEARS	
LOT 913 RP (PART) AND V.L. IN D.D. 107, FUNG KAT HEUNG, YUEN LONG	
Drawing Title	
VEHICULAR ACCESS PLAN	
Scale of A4	
1:4000	
Drawn	Date
	23.5.2019
Revised	Date

(摘錄自申請人於 18.6.2019 呈交的申請書)
 (Extract from Applicant's Submission of 18.6.2019)

參考編號 REFERENCE No.	繪圖 DRAWING
A/YL-KTN/670	A-2

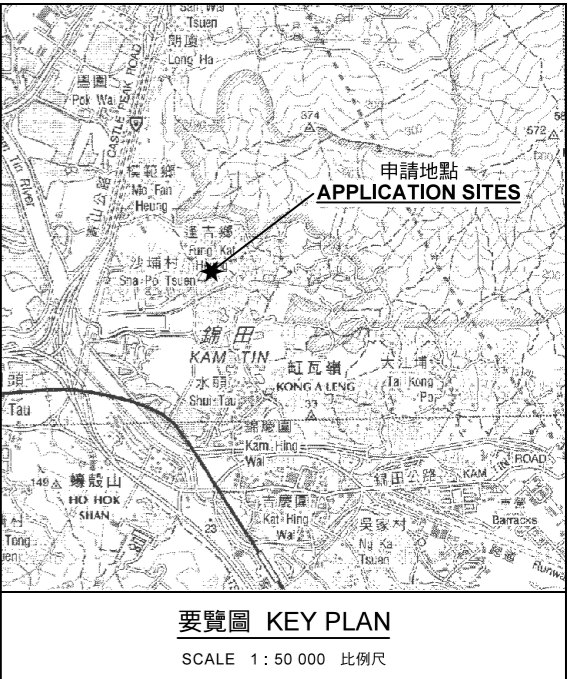
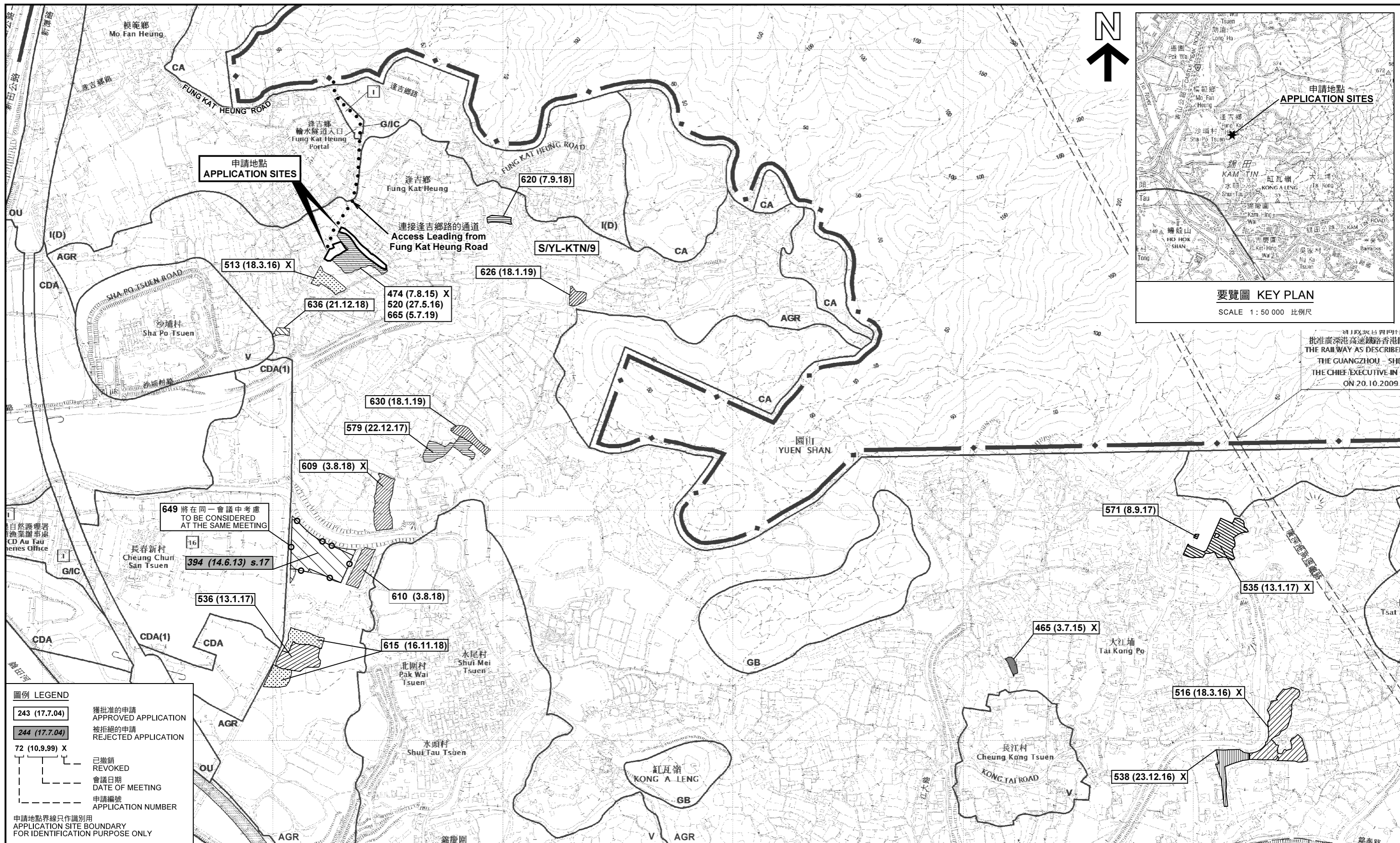

批准廣深港高速鐵路香港段
THE RAILWAY AS DESCRIBED
THE GUANGZHOU - SHE
THE CHIEF EXECUTIVE IN C
ON 20.10.2009

圖例 LEGEND

- 243 (17.7.04) 獲批准的申請
APPROVED APPLICATION
- 244 (17.7.04) 被拒絕的申請
REJECTED APPLICATION
- 72 (10.9.99) X 已撤銷
REVOKED
- 會議日期
DATE OF MEETING
- 申請編號
APPLICATION NUMBER

申請地點界線只作識別用
APPLICATION SITE BOUNDARY
FOR IDENTIFICATION PURPOSE ONLY

位置圖及同類申請 LOCATION PLAN WITH SIMILAR APPLICATIONS

擬議臨時康體文娛場所 (休閒農場) (為期5年)
元朗達吉鄉丈量約份第107約地段第913號餘段(部分)、
第925號餘段(部分)及第927號(部分)
PROPOSED TEMPORARY PLACE OF RECREATION,
SPORTS OR CULTURE (HOBBY FARM) FOR A PERIOD OF 5 YEARS
LOTS 913 RP (PART), 925 RP (PART) AND 927 (PART)
IN D.D. 107, FUNG KAT HEUNG, YUEN LONG

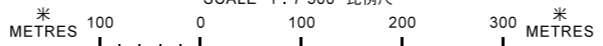

本摘要圖於2019年7月31日擬備，
所根據的資料為於2014年12月2日
核准的分區計劃大綱圖編號 S/YL-KTN/9
EXTRACT PLAN PREPARED ON 31.7.2019
BASED ON OUTLINE ZONING PLAN No.
S/YL-KTN/9 APPROVED ON 2.12.2014

規劃署
PLANNING DEPARTMENT



參考編號 REFERENCE No.
A/YL-KTN/670

圖 PLAN
A-1

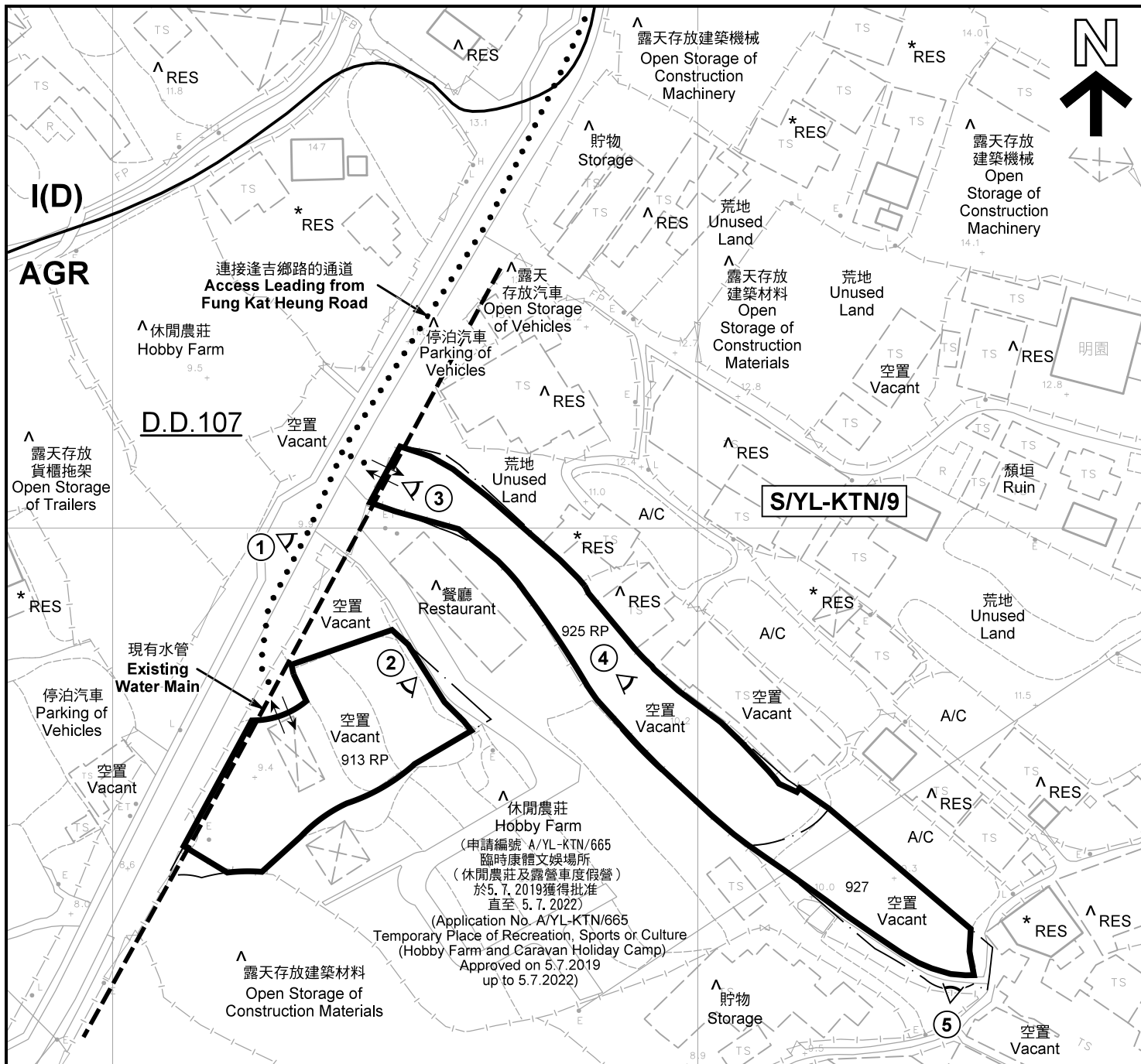

<p>註釋 Notes :</p> <p>(1) 2019年6月25日勘測的土地用途 Land uses shown on this plan are in accordance with the land use survey conducted by the Planning Department on 25.6.2019</p> <p>(2) * 土地用途跟1992年2月勘測的土地用途一致 Indicates that the use is the same as that revealed by the land use survey conducted by the Planning Department in Feb 1992.</p> <p>(3) ^ 土地用途跟1992年2月勘測的土地用途有別 Indicates that the use is different from that revealed by the land use survey conducted by the Planning Department on in Feb 1992.</p>	<p>圖例 LEGEND</p> <p> 申請地點(界線只作識別用) APPLICATION SITES (BOUNDARY FOR IDENTIFICATION PURPOSE ONLY)</p> <p>I(D) 工業(丁類) INDUSTRIAL (GROUP D)</p> <p>AGR 農業 AGRICULTURE</p> <p>RES 住用構築物 RESIDENTIAL STRUCTURES</p> <p>A/F 休耕農地 FALLOW AGRICULTURAL LAND</p> <p>A/C 常耕農地 CULTIVATED AGRICULTURAL LAND</p> <p> 實地照片的觀景點 VIEWING POINT OF SITE PHOTO</p> <p> 入口/出口 INGRESS / EGRESS</p>
---	---

<p>本摘要圖於2019年8月1日擬備，所根據的資料為測量圖編號 6-NE-2C EXTRACT PLAN PREPARED ON 1.8.2019 BASED ON SURVEY SHEETS No. 6-NE-2C</p>	<p align="center">平面圖 SITE PLAN</p> <p align="center">擬議臨時康體文娛場所(休閒農場)(為期5年) 元朗逢吉鄉丈量約份第107約地段第913號餘段(部分)、 第925號餘段(部分)及第927號(部分) PROPOSED TEMPORARY PLACE OF RECREATION, SPORTS OR CULTURE (HOBBY FARM) FOR A PERIOD OF 5 YEARS LOTS 913 RP (PART), 925 RP (PART) AND 927 (PART) IN D.D. 107, FUNG KAT HEUNG, YUEN LONG</p> <p align="center">SCALE 1 : 1 000 比例尺</p> <p align="center"> </p>	<p align="center">規劃署 PLANNING DEPARTMENT</p> <p align="center"></p> <hr/> <p>參考編號 REFERENCE No. A/YL-KTN/670</p> <hr/> <p>圖 PLAN A-2</p>
---	---	---



圖例 LEGEND

 申請地點(界線只作識別用)
APPLICATION SITES
(BOUNDARY FOR IDENTIFICATION
PURPOSE ONLY)

本摘要圖於2019年7月18日擬備，所根據的資料為地政總署於2018年1月3日拍得的航攝照片編號 E033699C
EXTRACT PLAN PREPARED ON 18.7.2019
BASED ON AERIAL PHOTO No.
E033699C TAKEN ON 3.1.2018
BY LANDS DEPARTMENT

航攝照片 AERIAL PHOTO

擬議臨時康體文娛場所(休閒農場)(為期5年)
元朗逢吉鄉丈量約份第107約地段第913號餘段(部分)、
第925號餘段(部分)及第927號(部分)
PROPOSED TEMPORARY PLACE OF RECREATION,
SPORTS OR CULTURE (HOBBY FARM) FOR A PERIOD OF 5 YEARS
LOTS 913 RP (PART), 925 RP (PART) AND 927 (PART)
IN D.D. 107, FUNG KAT HEUNG, YUEN LONG

規劃署
**PLANNING
DEPARTMENT**



參考編號
REFERENCE No.
A/YL-KTN/670

圖 PLAN
A-3



日期 DATE 25.6.2019



日期 DATE 25.6.2019



日期 DATE 9.7.2019



日期 DATE 9.7.2019



申請地點界線只作識別用 APPLICATION SITE BOUNDARY FOR IDENTIFICATION PURPOSE ONLY

日期 DATE 9.7.2019

實地照片 SITE PHOTOS

本圖於2019年8月1日擬備，所根據的資料為攝於2019年6月25日及7月9日的實地照片
PLAN PREPARED ON 1.8.2019
BASED ON SITE PHOTOS
TAKEN ON 25.6.2019 & 9.7.2019

擬議臨時康體文娛場所（休閒農場）（為期5年）
元朗逢吉鄉丈量約份第107約地段第913號餘段（部分）、
第925號餘段（部分）及第927號（部分）
PROPOSED TEMPORARY PLACE OF RECREATION,
SPORTS OR CULTURE (HOBBY FARM) FOR A PERIOD OF 5 YEARS
LOTS 913 RP (PART), 925 RP (PART) AND 927 (PART)
IN D.D. 107, FUNG KAT HEUNG, YUEN LONG

規劃署
PLANNING
DEPARTMENT



參考編號
REFERENCE No.
A/YL-KTN/670

圖 PLAN
A-4