

LEGEND:

- Application Site (Area = 8,520 sq. m.)
- Structures
- Parking Spaces for Visitors (23)



Top Bright Consultants Ltd.

Drawing No. :TB/19/588/05

Layout Plan

Various Lots in DD109 and
Adjoining Government Land,
Kam Tin North, Yuen Long, N.T.

FIGURE 5

FOR IDENTIFICATION PURPOSE

Date: 1.4.2019

Scale: 1:1000

(摘錄自申請人於 16.4.2019 呈交的申請書)
(Extract from Applicant's
Submission of 16.4.2019)

參考編號

REFERENCE No.

A/YL-KTN/658

繪圖 DRAWING

A-1

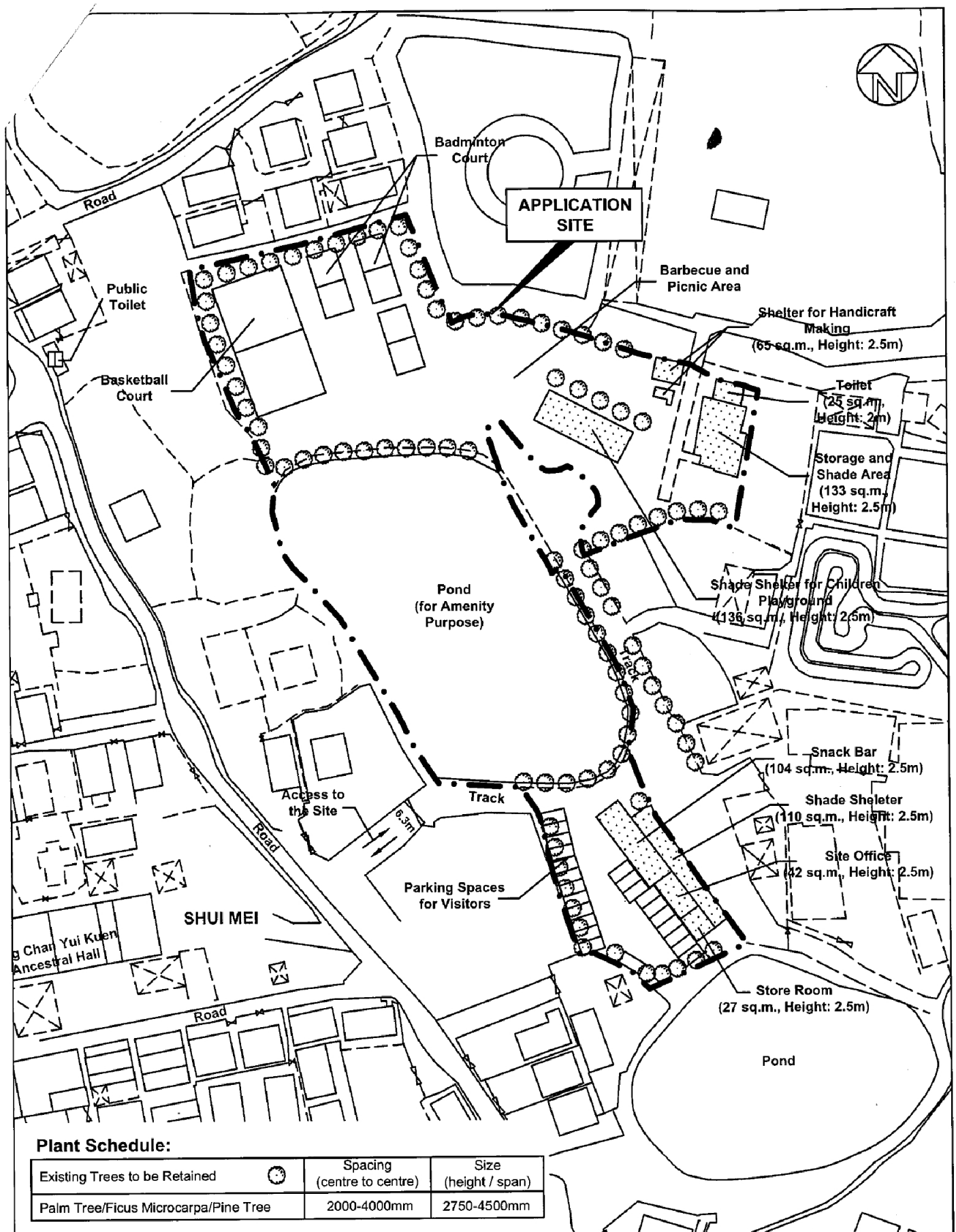

Plant Schedule:

Existing Trees to be Retained	Spacing (centre to centre)	Size (height / span)
Palm Tree/Ficus Microcarpa/Pine Tree	2000-4000mm	2750-4500mm



Top Bright Consultants Ltd.

Drawing No. :TB/19/588/06

**Landscape and Tree
Preservation Proposal**

Various Lots in DD109 and
Adjoining Government Land,
Kam Tin North, Yuen Long, N.T.

FIGURE 6

FOR IDENTIFICATION PURPOSE
Date: 1.4.2019
Scale: 1:1000

(摘錄自申請人於 16.4.2019 呈交的申請書)
(Extract from Applicant's
Submission of 16.4.2019)

參考編號
REFERENCE No.
A/YL-KTN/658

繪圖 DRAWING
A-2

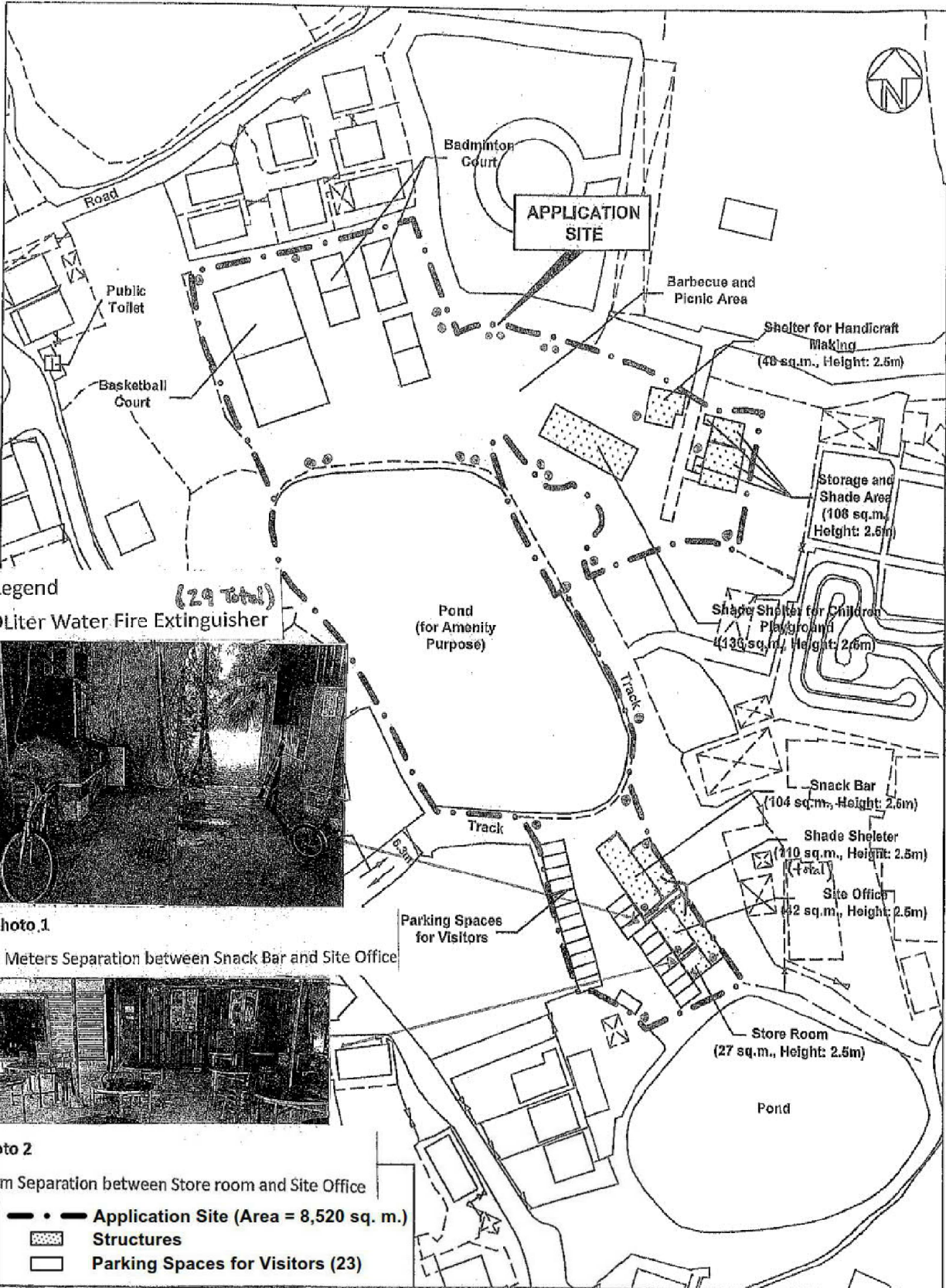

Legend

(29 Total)

9 Liter Water Fire Extinguisher

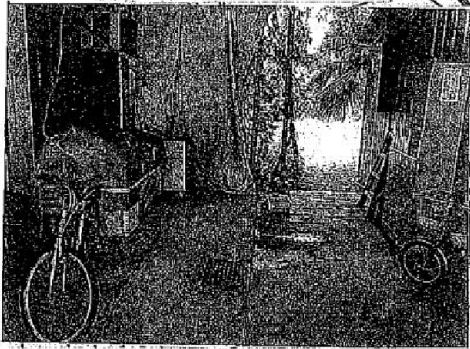

Photo 1

2 Meters Separation between Snack Bar and Site Office

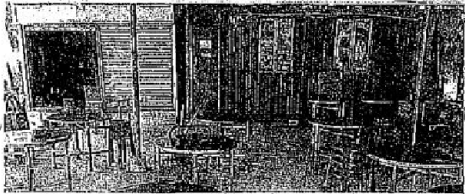

Photo 2

40cm Separation between Store room and Site Office

- Application Site (Area = 8,520 sq. m.)
- ▨ Structures
- Parking Spaces for Visitors (23)

FSI Contractor :
Hang Yue Engineering
Consultants Limited
恒裕工程顧問有限公司
 Tel: 3617 7738

Fire Service Installation Proposal

Various Lots in DD109 and
 Adjoining Government Land,
 Kam Tin North, Yuen Long, N.T.

FOR IDENTIFICATION PURPOSE

Scale: 1:1000

(摘錄自申請人於 17. 5. 2019 呈交的進一步資料)
 (Extract from Applicant's Further
 Information Submitted on 17.5.2019)

參考編號
 REFERENCE No.
A/YL-KTN/658

繪圖 DRAWING
A-3

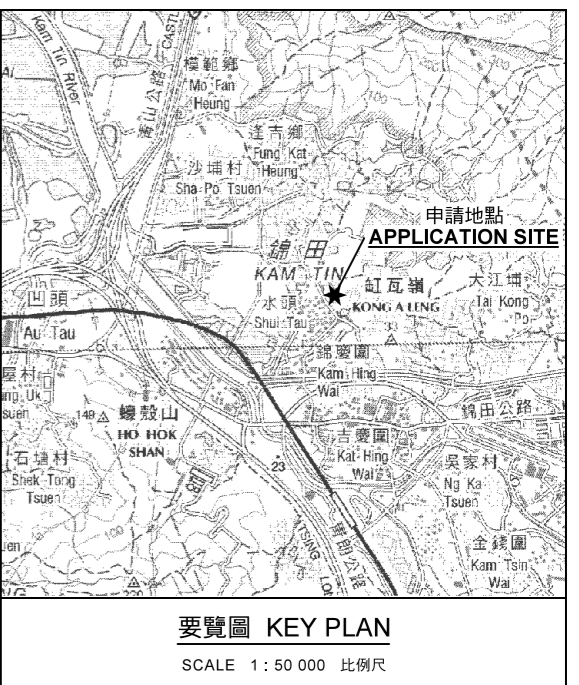
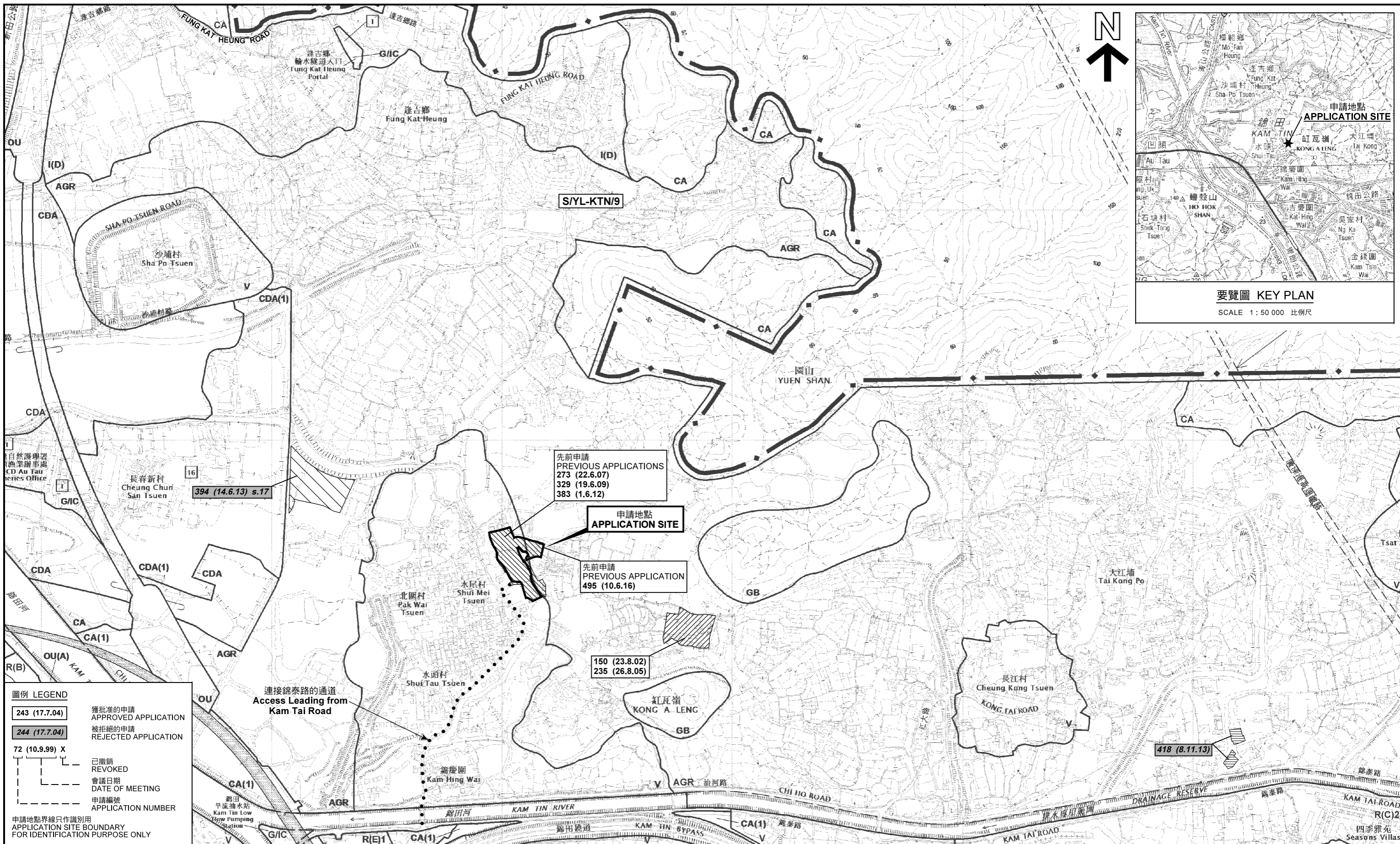

圖例 LEGEND

243 (17.7.04)	獲批准的申請 APPROVED APPLICATION
244 (17.7.04)	被拒絕的申請 REJECTED APPLICATION
72 (10.9.99) X	已撤銷 REVOKED
(Date)	會議日期 DATE OF MEETING
(Number)	申請編號 APPLICATION NUMBER

申請地點界線只作識別用
APPLICATION SITE BOUNDARY
FOR IDENTIFICATION PURPOSE ONLY

位置圖及同類申請 LOCATION PLAN WITH SIMILAR APPLICATIONS

臨時「康樂用地（包括燒烤及野營地點、兒童遊樂場、手工藝製作地點）及其附屬設施」用途的規劃許可續期（為期3年）
元朗錦田北水尾村丈量約份第109約地段第680號（部分）、第681號（部分）、第682號（部分）、第684號餘段（部分）及第1615號（部分）和毗連政府土地
RENEWAL OF PLANNING APPROVAL FOR TEMPORARY "PLACE OF RECREATION (INCLUDING BARBECUE SPOT, PICNIC AREA, CHILDREN PLAYGROUND AND HANDICRAFT MAKING AREA) WITH ANCILLARY FACILITIES" FOR A PERIOD OF 3 YEARS
LOTS 680 (PART), 681 (PART), 682 (PART), 684 RP (PART) AND 1615 (PART) IN D.D. 109 AND ADJOINING GOVERNMENT LAND, SHUI MEI TSUEN, KAM TIN NORTH, YUEN LONG

SCALE 1 : 7 500 比例尺

METRES 100 0 100 200 300 METRES

本摘要圖於2019年5月16日擬備，所根據的資料為於2014年12月2日核准的分區計劃大綱圖編號 S/YL-KTN/9
EXTRACT PLAN PREPARED ON 16.5.2019
BASED ON OUTLINE ZONING PLAN NO. S/YL-KTN/9 APPROVED ON 2.12.2014

規劃署
PLANNING DEPARTMENT



參考編號 REFERENCE No.
A/YL-KTN/658

圖 PLAN
A-1

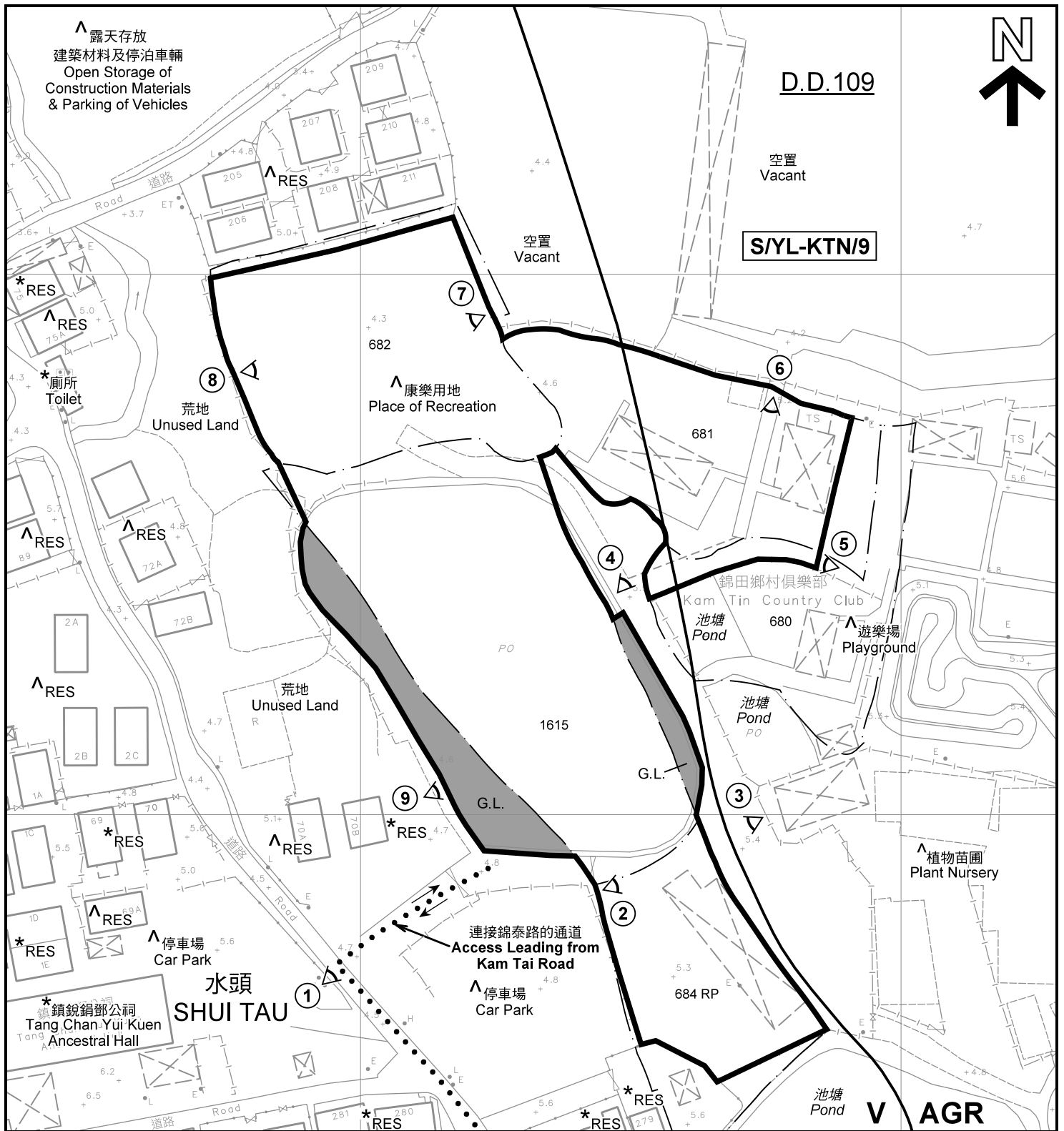

註釋 Notes :

- (1) 2019年4月26日勘測的土地用途
Land uses shown on this plan are in accordance with the land use survey conducted by the Planning Department on 26.4.2019
- (2) * 土地用途跟1992年2月20日勘測的土地用途一致
Indicates that the use is the same as that revealed by the land use survey conducted by the Planning Department on 20.2.1992
- (3) ^ 土地用途跟1992年2月20日勘測的土地用途有別
Indicates that the use is different from that revealed by the land use survey conducted by the Planning Department on 20.2.1992

圖例 LEGEND

- 申請地點(界線只作識別用)
APPLICATION SITE (BOUNDARY FOR IDENTIFICATION PURPOSE ONLY)
- 鄉村式發展
VILLAGE TYPE DEVELOPMENT
- 農業
AGRICULTURE
- 政府土地
GOVERNMENT LAND
- 住用構築物
RESIDENTIAL STRUCTURES
- 實地照片的觀景點
VIEWING POINT OF SITE PHOTO
- 入口/出口
INGRESS / EGRESS

平面圖 SITE PLAN

臨時「康樂用地(包括燒烤及野餐地點、兒童遊樂場、手工藝製作地點)及其附屬設施」用途的規劃許可(為期3年)
元朗錦田北水尾村丈量約份第109約地段第680號(部分)、第681號(部分)、第682號(部分)、第684號餘段(部分)及第1615號(部分)和毗連政府土地
RENEWAL OF PLANNING APPROVAL FOR TEMPORARY "PLACE OF RECREATION (INCLUDING BARBECUE SPOT, PICNIC AREA, CHILDREN PLAYGROUND AND HANDICRAFT MAKING AREA) WITH ANCILLARY FACILITIES" FOR A PERIOD OF 3 YEARS
LOTS 680 (PART), 681 (PART), 682 (PART), 684 RP (PART) AND 1615 (PART) IN D.D. 109 AND ADJOINING GOVERNMENT LAND, SHUI MEI TSUEN, KAM TIN NORTH, YUEN LONG

SCALE 1 : 1 000 比例尺

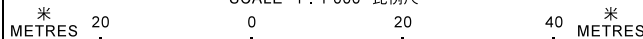

本摘要圖於2019年5月27日擬備，所根據的資料為測量圖編號 6-NE-7A 及 6-NE-7C
EXTRACT PLAN PREPARED ON 27.5.2019
BASED ON SURVEY SHEETS No. 6-NE-7A & 6-NE-7C

規劃署
PLANNING
DEPARTMENT



參考編號
REFERENCE No.
A/YL-KTN/658

圖 PLAN
A-2



圖例 LEGEND



申請地點(界線只作識別用)
APPLICATION SITE
(BOUNDARY FOR IDENTIFICATION
PURPOSE ONLY)

本摘要圖於2019年5月7日擬備，所根據的資料為地政總署於2018年1月3日拍得的航攝照片編號 E032808C
EXTRACT PLAN PREPARED ON 7.5.2019
BASED ON AERIAL PHOTO No.
E032808C TAKEN ON 3.1.2018
BY LANDS DEPARTMENT

航攝照片 AERIAL PHOTO

臨時「康樂用地(包括燒烤及野營地點、兒童遊樂場、手工藝製作地點)及其附屬設施」用途的規劃許可(為期3年)
元朗錦田北水尾村丈量約份第109約地段第680號(部分)、第681號(部分)、第682號(部分)、第684號餘段(部分)及第1615號(部分)和毗連政府土地
RENEWAL OF PLANNING APPROVAL FOR TEMPORARY "PLACE OF RECREATION (INCLUDING BARBECUE SPOT, PICNIC AREA, CHILDREN PLAYGROUND AND HANDICRAFT MAKING AREA) WITH ANCILLARY FACILITIES" FOR A PERIOD OF 3 YEARS
LOTS 680 (PART), 681 (PART), 682 (PART), 684 RP (PART) AND 1615 (PART) IN D.D. 109 AND ADJOINING GOVERNMENT LAND, SHUI MEI TSUEN, KAM TIN NORTH, YUEN LONG

規劃署
PLANNING
DEPARTMENT



參考編號
REFERENCE No.
A/YL-KTN/658

圖 PLAN
A-3

1



2



3



4



申請地點界線只作識別用 APPLICATION SITE BOUNDARY FOR IDENTIFICATION PURPOSE ONLY

實地照片 SITE PHOTOS

臨時「康樂用地（包括燒烤及野餐地點、兒童遊樂場、手工藝製作地點）及其附屬設施」用途的規劃許可續期（為期3年）
 元朗錦田北水尾村丈量約份第109約地段第680號(部分)、第681號(部分)、第682號(部分)、第684號餘段(部分)及第1615號(部分)和毗連政府土地
 RENEWAL OF PLANNING APPROVAL FOR TEMPORARY "PLACE OF RECREATION (INCLUDING BARBECUE SPOT, PICNIC AREA, CHILDREN PLAYGROUND AND HANDICRAFT MAKING AREA) WITH ANCILLARY FACILITIES" FOR A PERIOD OF 3 YEARS
 LOTS 680 (PART), 681 (PART), 682 (PART), 684 RP (PART) AND 1615 (PART) IN D.D. 109 AND ADJOINING GOVERNMENT LAND, SHUI MEI TSUEN, KAM TIN NORTH, YUEN LONG

規劃署
 PLANNING
 DEPARTMENT



參考編號
 REFERENCE No.
 A/YL-KTN/658

圖 PLAN
 A-4a

本圖於2019年5月27日擬備，所根據的資料為攝於2019年4月26日的實地照片
 PLAN PREPARED ON 27.5.2019
 BASED ON SITE PHOTOS
 TAKEN ON 26.4.2019



5

申請地點
APPLICATION SITE



6

申請地點
APPLICATION SITE



7

申請地點
APPLICATION SITE



8

申請地點
APPLICATION SITE



9

申請地點
APPLICATION SITE

申請地點界線只作識別用 APPLICATION SITE BOUNDARY FOR IDENTIFICATION PURPOSE ONLY

實地照片 SITE PHOTOS

臨時「康樂用地（包括燒烤及野餐地點、兒童遊樂場、手工藝製作地點）及其附屬設施」用途的規劃許可續期（為期3年）
元朗錦田北水尾村丈量約份第109約地段第680號(部分)、第681號(部分)、第682號(部分)、第684號餘段(部分)及第1615號(部分)和毗連政府土地
RENEWAL OF PLANNING APPROVAL FOR TEMPORARY "PLACE OF RECREATION (INCLUDING BARBECUE SPOT, PICNIC AREA, CHILDREN PLAYGROUND AND HANDICRAFT MAKING AREA) WITH ANCILLARY FACILITIES" FOR A PERIOD OF 3 YEARS
LOTS 680 (PART), 681 (PART), 682 (PART), 684 RP (PART) AND 1615 (PART) IN D.D. 109 AND ADJOINING GOVERNMENT LAND, SHUI MEI TSUEN, KAM TIN NORTH, YUEN LONG

規劃署
PLANNING
DEPARTMENT



參考編號
REFERENCE No.
A/YL-KTN/658

圖 PLAN
A-4b

本圖於2019年5月27日擬備，所根據的資料為攝於2019年4月26日的實地照片
PLAN PREPARED ON 27.5.2019
BASED ON SITE PHOTOS
TAKEN ON 26.4.2019