

DEVELOPMENT PARAMETERS OF THE APPLICATION SITE

APPLICATION SITE AREA : 1,075m² (ABOUT)
 COVERED AREA : 108m² (ABOUT)
 UNCOVERED AREA : 967m² (ABOUT)

PLOT RATIO : 0.1 (ABOUT)
 SITE COVERAGE : 10% (ABOUT)

NO. OF STRUCTURE : 2
 DOMESTIC GFA : NOT APPLICABLE
 NON-DOMESTIC GFA : 108m² (ABOUT)
 BUILDING HEIGHT : 4.2m (ABOUT)
 NO. OF STOREY : 1

STRUCTURE	USE	COVERED AREA	GFA	BUILDING HEIGHT
B1	RECEPTION, REFRESHMENT KIOSK, WASHROOM AND CHANGING ROOM	54m ² (ABOUT)	54m ² (ABOUT)	4.2m (ABOUT)(1-STOREY)
B2	PLANT NURSERY, METER ROOM STORAGE OF FARM TOOLS AND AGRICULTURAL LEARNING ROOM	54m ² (ABOUT)	54m ² (ABOUT)	4.2m (ABOUT)(1-STOREY)
TOTAL		108m² (ABOUT)	108m² (ABOUT)	

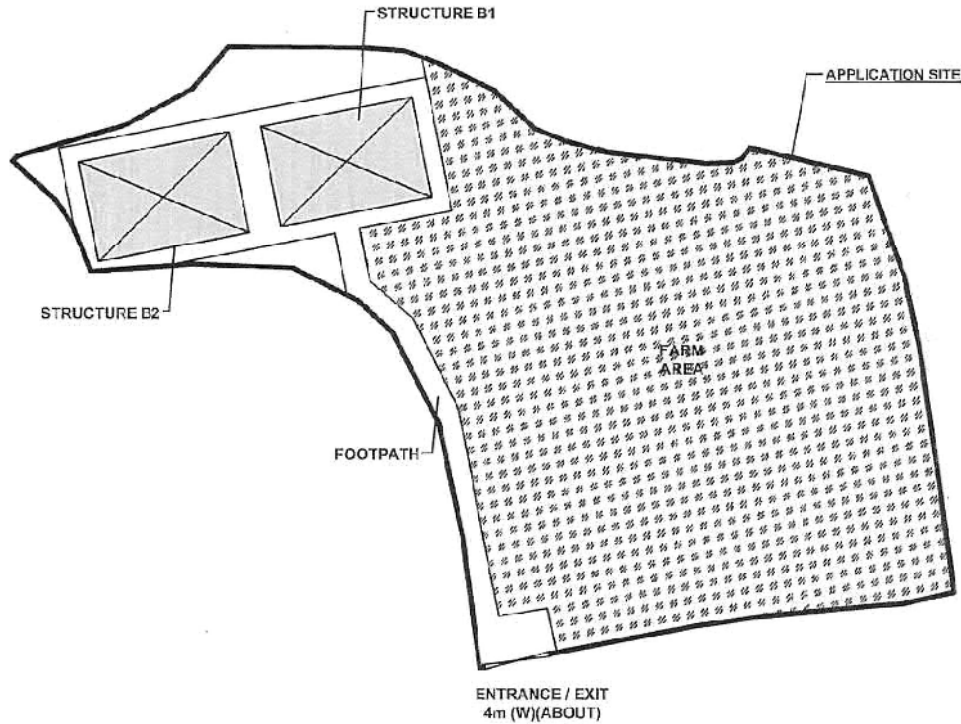
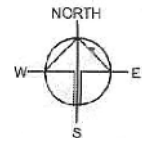

LEGEND

- STRUCTURE
- ENTRANCE / EXIT

Drawing No. P04	Ver. 01
Project PROPOSED TEMPORARY PLACE OF RECREATION, SPORTS OR CULTURE (HOBBY FARM) WITH ANCILLARY FACILITIES FOR A PERIOD OF 5 YEARS AND LAND FILLING	
LOTS 255 RP AND 257 RP IN D.D. 112, SHEK KONG, YUEN LONG, NEW TERRITORIES	
Drawing Title LAYOUT PLAN	
Scale of A4 1:100	
Drawn 22.10.2020	Check
Revised	Date

(資料來源:申請人於 13. 11. 2020 呈交的資料)
 (Source : Applicant's Submission of 13.11.2020)

參考編號
 REFERENCE No.
 A/YL-SK/294

繪圖 DRAWING
 A-1

PAVED RATIO OF THE APPLICATION SITE

APPLICATION SITE AREA COVERED BY STRUCTURE	: 1,075m ² (ABOUT) : 108m ² (10%)(ABOUT)
AREA OF FARMLAND	: 790m ² (73%)(ABOUT)
LANDSCAPING AREA	: 85m ² (8%)(ABOUT)
SOILED GROUND AREA	: 50m ² (5%)(ABOUT)
LAND FILLING AREA	: 170m ² (16%)(ABOUT)
DEPTH OF LAND FILLING	: NOT MORE THAN +0.2m
MATERIAL OF LAND FILLING	: CONCRETE
PURPOSE OF LAND FILLING	: SITE FORMATION OF STRUCTURES AND CIRCULATION PURPOSE

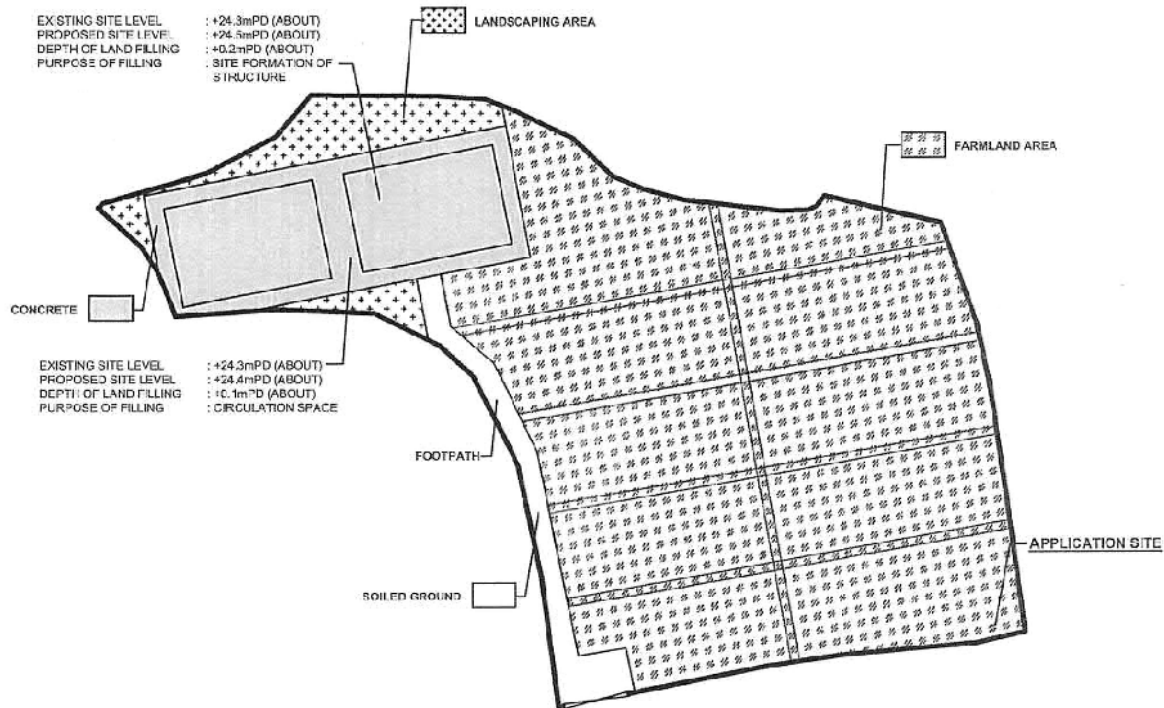
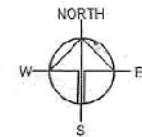

REASON OF LAND FILLING

- CONCRETE IS PROPOSED TO BE LAID AT BOTTOM OF STRUCTURES AS SITE FORMATION.
- LOADING OF STRUCTURES COULD COMPACT THE EXISTING SOILED GROUND, WHICH SUBSEQUENTLY WEAKENS THE GROUND SURFACE.
- THE CONCRETE SITE FORMATION COULD STABILISE THE EXISTING SOILED GROUND AND PREVENT EROSION FROM SURFACE RUN-OFF.
- IT PROVIDES GROUND REINFORCEMENT SO THAT IT CAN WITHSTAND THE HEAVY LOADING OF STRUCTURES.

Drawing No.	Ver.
P05	01
Project	
PROPOSED TEMPORARY PLACE OF RECREATION, SPORTS OR CULTURE (HOBBY FARM) WITH ANCILLARY FACILITIES FOR A PERIOD OF 5 YEARS AND LAND FILLING	
LOTS 286 RP AND 287 RP IN D.D. 112, SHEK KONG, YUEN LONG, NEW TERRITORIES	
Drawing Title	
PAVED RATIO OF THE SITE	
Scale of AA	
1:400	
Drawn	Date
	22.10.2020
Revised	Date

LEGEND



(資料來源: 申請人於 13. 11. 2020 呈交的資料)
(Source : Applicant's Submission of 13.11.2020)

參考編號
REFERENCE No.
AYL-SK/294

繪圖 DRAWING
A-2

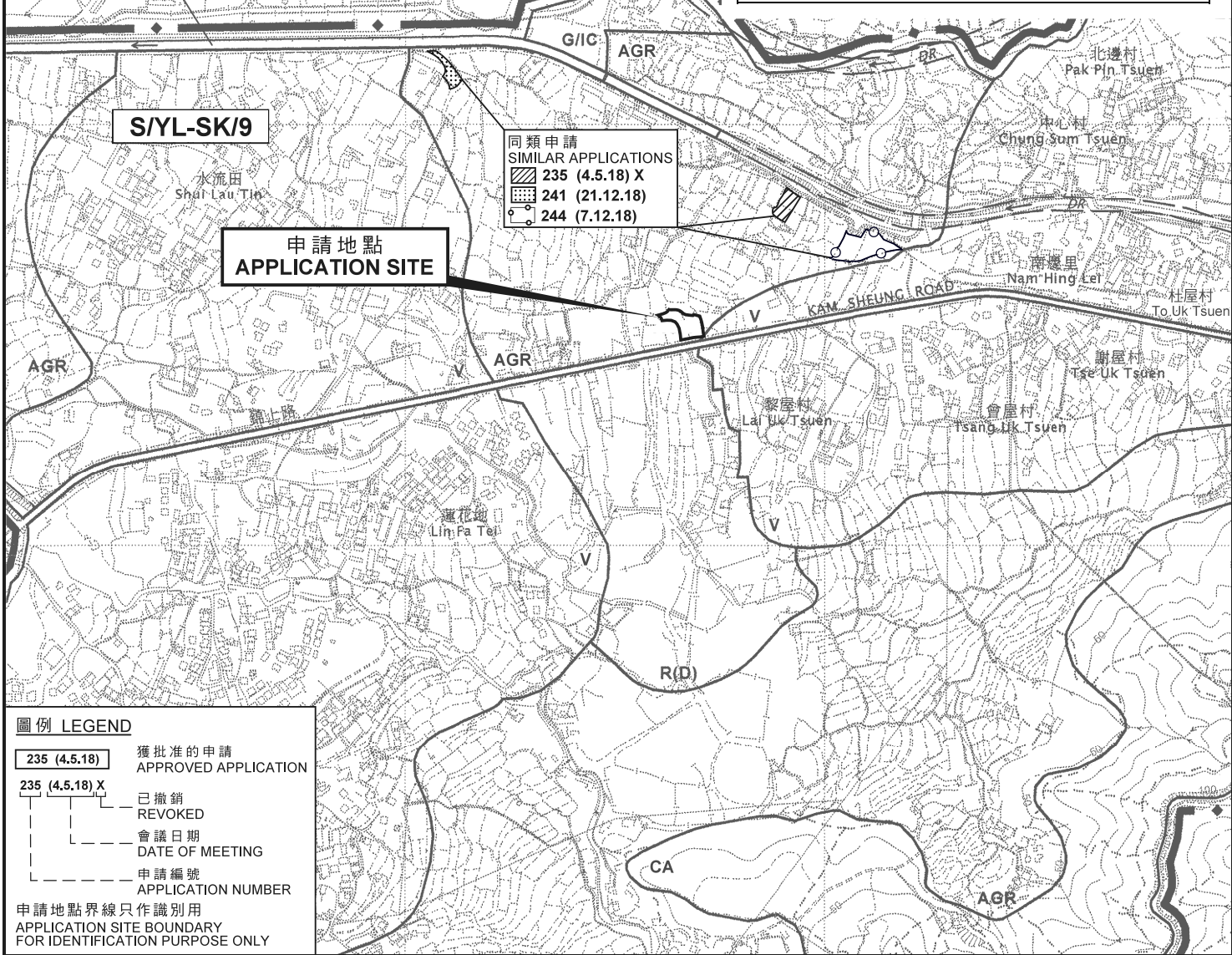
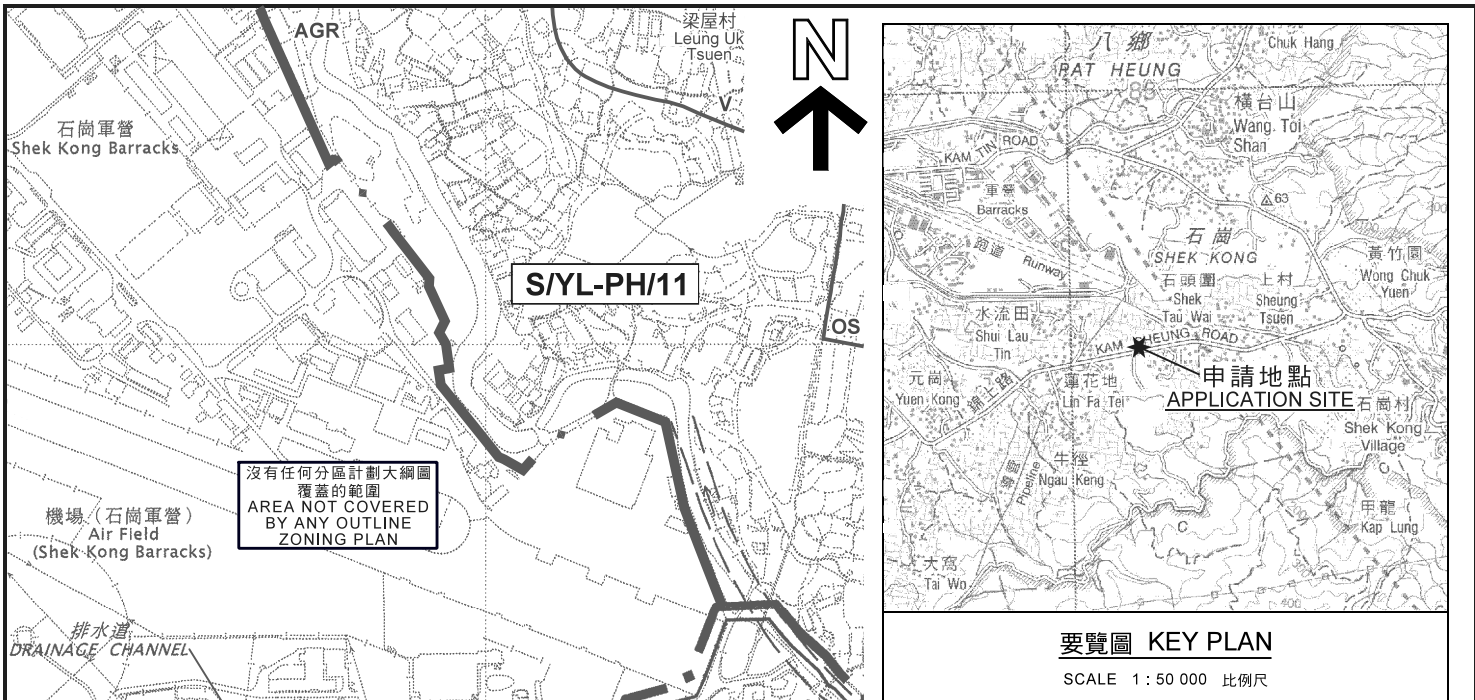

位置圖 LOCATION PLAN

本摘要圖於2020年12月7日擬備，
所根據的資料為於2006年10月17日核准的
分區計劃大綱圖編號S/YL-SK/9
EXTRACT PLAN PREPARED ON 7.12.2020
BASED ON OUTLINE ZONING PLAN
No. S/YL-SK/9 APPROVED ON 17.10.2006

擬議臨時康體文娛場所（休閒農場）（為期5年）及填土工程
元朗石崗丈量約份第112約地段第286號餘段及第287號餘段
PROPOSED TEMPORARY PLACE OF RECREATION, SPORTS OR
CULTURE (HOBBY FARM) FOR A PERIOD OF 5 YEARS AND FILLING OF LAND
LOTS 286 RP AND 287 RP IN D.D. 112, SHEK KONG, YUEN LONG

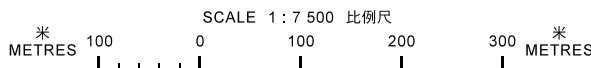

規劃署
PLANNING
DEPARTMENT



參考編號
REFERENCE No.
A/YL-SK/294

圖 PLAN
A-1

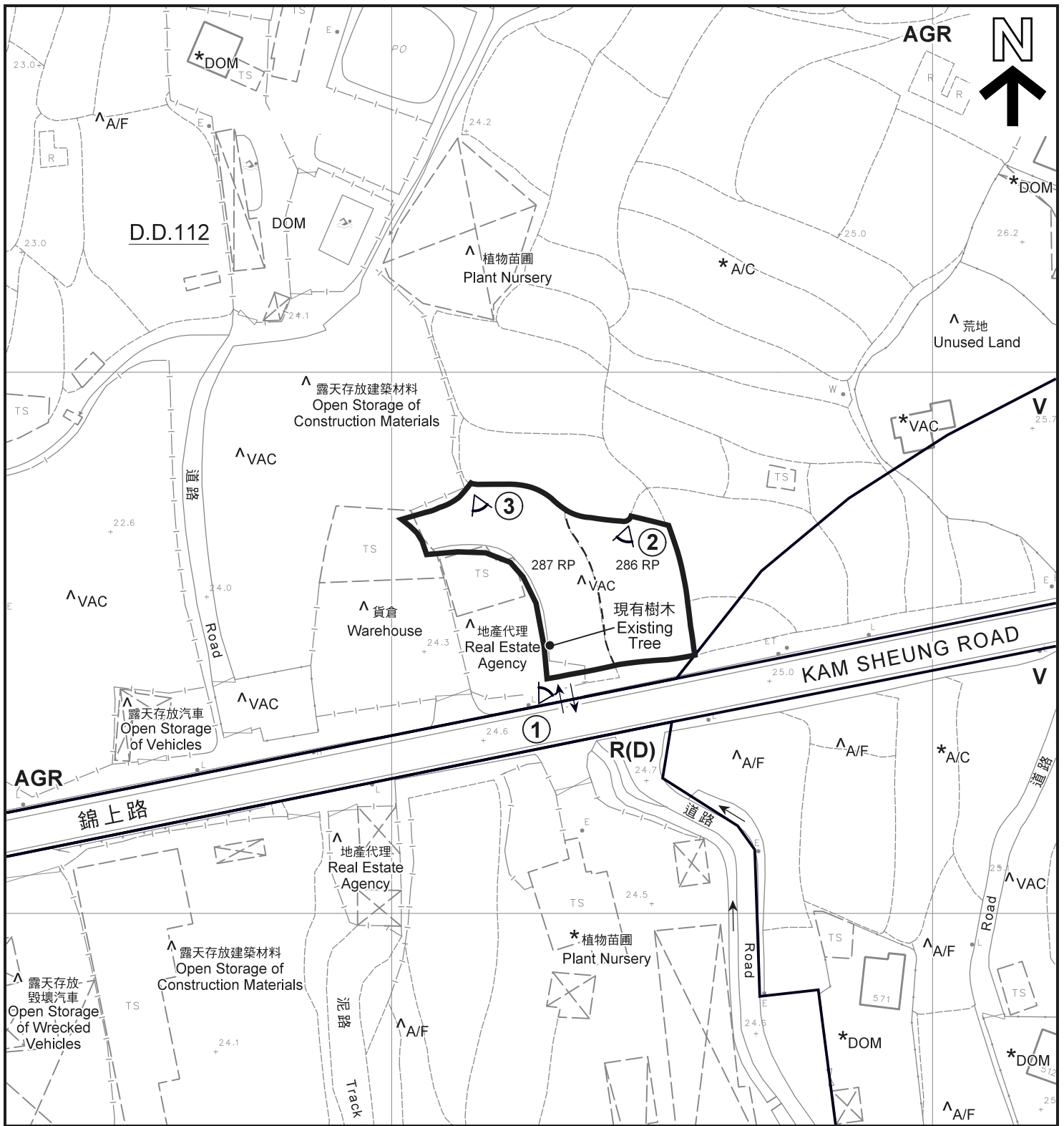

圖例 LEGEND

- 申請地點 (界線只作識別用)
APPLICATION SITE
(BOUNDARY FOR IDENTIFICATION
PURPOSE ONLY)
- AGR** 農業
AGRICULTURE
- R(D)** 住宅(丁類)
RESIDENTIAL (GROUP D)
- V** 鄉村式發展
VILLAGE TYPE DEVELOPMENT

- A/C 常耕農地
CULTIVATED AGRICULTURAL LAND
- A/F 休耕農地
FALLOW AGRICULTURAL LAND
- DOM 住用構築物
DOMESTIC STRUCTURE
- VAC 空置
VACANT
- 入口/出口
INGRESS / EGRESS
- 實地照片的觀景點
VIEWING POINT OF SITE PHOTO

- 註釋 Notes:
- (1) 2020年11月20日勘測的土地用途
Land uses shown on this plan are in accordance with the land use survey conducted by the Planning Department on 20.11.2020
 - (2) * 土地用途跟1991年勘測的土地用途一致
Indicates that the use is the same as that revealed by the land use survey conducted by the Planning Department in 1991
 - (3) ^ 土地用途跟1991年勘測的土地用途有別
Indicates that the use is different from that revealed by the land use survey conducted by the Planning Department in 1991

平面圖 SITE PLAN

本摘要圖於2020年12月30日擬備，所根據的資料為測量圖編號 6-NE-19A
EXTRACT PLAN PREPARED ON 30.12.2020
BASED ON SURVEY SHEET No. 6-NE-19A

擬議臨時康體文娛場所 (休閒農場) (為期5年) 及填土工程
元朗石崗丈量約份第112約地段第286號餘段及第287號餘段
PROPOSED TEMPORARY PLACE OF RECREATION, SPORTS OR
CULTURE (HOBBY FARM) FOR A PERIOD OF 5 YEARS AND FILLING OF LAND
LOTS 286 RP AND 287 RP IN D.D. 112, SHEK KONG, YUEN LONG

規劃署
**PLANNING
DEPARTMENT**

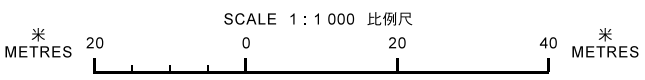

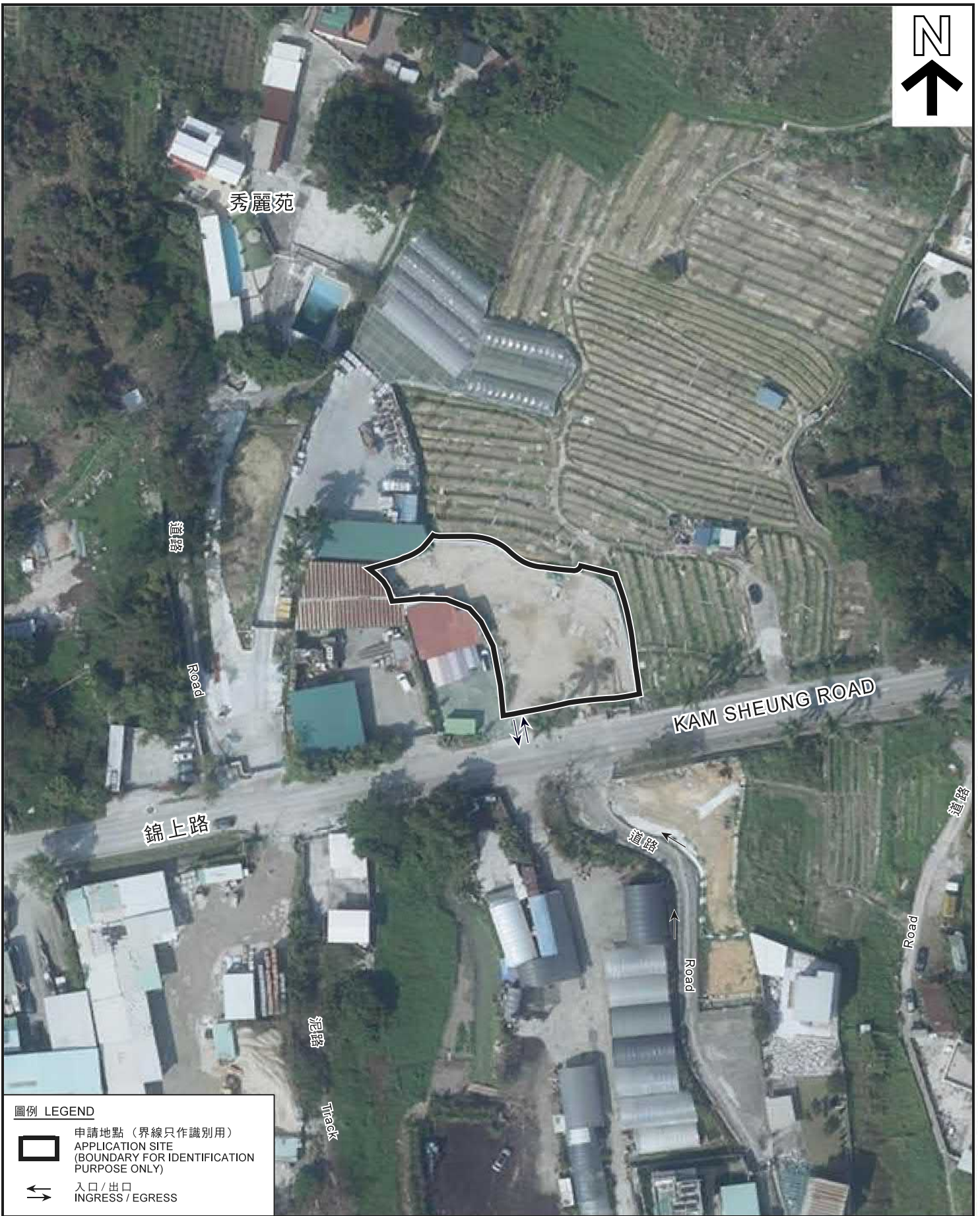

參考編號
REFERENCE No.
A/YL-SK/294

圖 PLAN
A-2



圖例 LEGEND

-  申請地點 (界線只作識別用)
APPLICATION SITE
(BOUNDARY FOR IDENTIFICATION
PURPOSE ONLY)
-  入口 / 出口
INGRESS / EGRESS

本摘要圖於2020年12月3日擬備，所根據的資料為地政總署於2020年2月18日拍得的航攝照片編號E089069C
EXTRACT PLAN PREPARED ON 3.12.2020
BASED ON AERIAL PHOTO No.
E089069C TAKEN ON 18.2.2020
BY LANDS DEPARTMENT

航攝照片 AERIAL PHOTO

擬議臨時康體文娛場所 (休閒農場) (為期5年) 及填土工程
元朗石崗丈量約份第112約地段第286號餘段及第287號餘段
PROPOSED TEMPORARY PLACE OF RECREATION, SPORTS OR
CULTURE (HOBBY FARM) FOR A PERIOD OF 5 YEARS AND FILLING OF LAND
LOTS 286 RP AND 287 RP IN D.D. 112, SHEK KONG, YUEN LONG

規劃署
PLANNING
DEPARTMENT



參考編號
REFERENCE No.
A/YL-SK/294

圖 PLAN
A-3



入口/出口
INGRESS / EGRESS



申請地點界線只作識別用
APPLICATION SITE BOUNDARY FOR IDENTIFICATION PURPOSE ONLY

<p>本摘要圖於2020年12月30日擬備， 所根據的資料為攝於 2020年11月20日的實地照片 PLAN PREPARED ON 30.12.2020 BASED ON SITE PHOTOS TAKEN ON 20.11.2020</p>	<p style="text-align: center;">實地照片 SITE PHOTO</p> <p style="text-align: center;">擬議臨時康體文娛場所（休閒農場）（為期5年）及填土工程 元朗石崗丈量約份第112約地段第286號餘段及第287號餘段 PROPOSED TEMPORARY PLACE OF RECREATION, SPORTS OR CULTURE (HOBBY FARM) FOR A PERIOD OF 5 YEARS AND FILLING OF LAND LOTS 286 RP AND 287 RP IN D.D. 112, SHEK KONG, YUEN LONG</p>	<p style="text-align: center;">規劃署 PLANNING DEPARTMENT</p> <p style="text-align: center;">參考編號 REFERENCE No. A/YL-SK/294</p>	<p style="text-align: center;"> 圖 PLAN A-4</p>
--	---	--	---