

Structure No.	Uses	No. of Storey	Floor Area (m <sup>2</sup> )	Height (m)
1	Green House for Farming	1	120	4.0
2	Store Room for Farm Tools and Toilet	1	15	2.5

**Legend:**

- • — Application Site (about 1,118 sq.m.)
- ▣ Parking Spaces for Private Cars (2.5m x 5m)

For Identification Purpose

Indicative Layout Plan

Figure 4B

Scale 1:1000



羅迅測計師行  
Lawson David & Sung  
SURVEYORS LIMITED  
Property Consultants • Planning • Valuers • Auctioneers  
Estate Agency License No. C-006328

參考編號  
REFERENCE No. A/NE-TKL/607

繪圖 DRAWING A-1

( 來源 : 附件 1e )  
( Source : Appendix 1e )

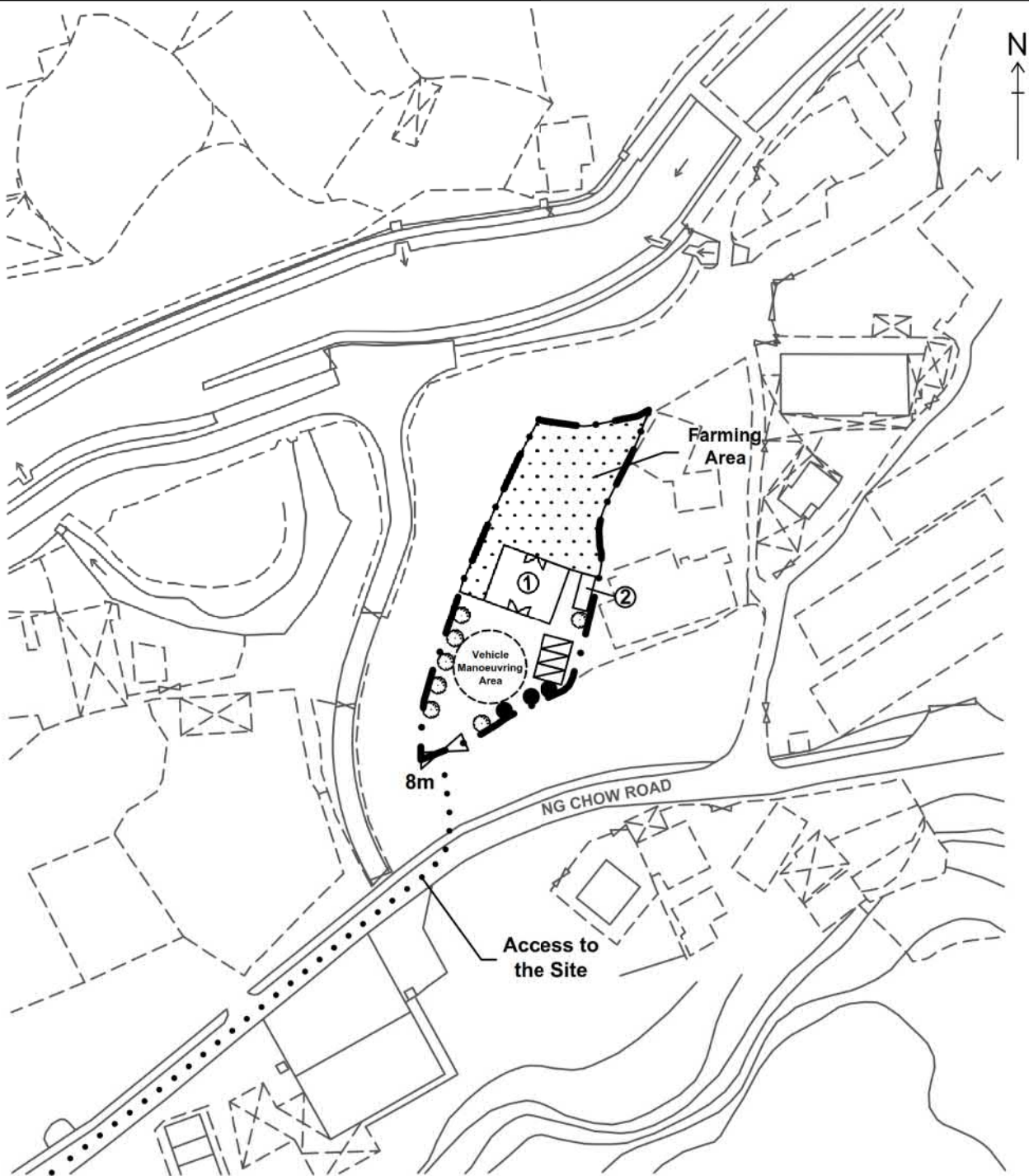

Structure No.	Uses	No. of Storey	Floor Area (m <sup>2</sup> )	Height (m)
1	Green House for Farming	1	120	4.0
2	Store Room for Farm Tools and Toilet	1	15	2.5

Plant Schedule:	Spacing (centre to centre)	Size (height / span)	Quantity
Proposed Trees: Ficus Microcarpa (細葉榕) ●	3000-4000mm	2750-3750mm	7
Existing Tree to be Preserved ●	—	—	3

For Identification Purpose

Landscape and Tree Preservation Plan

Figure 5B

Scale 1:1000



羅迅測計師行  
Lawson David & Sung  
SURVEYORS LIMITED  
Property Consultants • Planning • Valuers • Auctioneers  
Estate Agency License No. C006328

參考編號  
REFERENCE No. A/NE-TKL/607

繪圖 DRAWING A-2

(來源： 附件 1e)  
(Source : Appendix 1e)

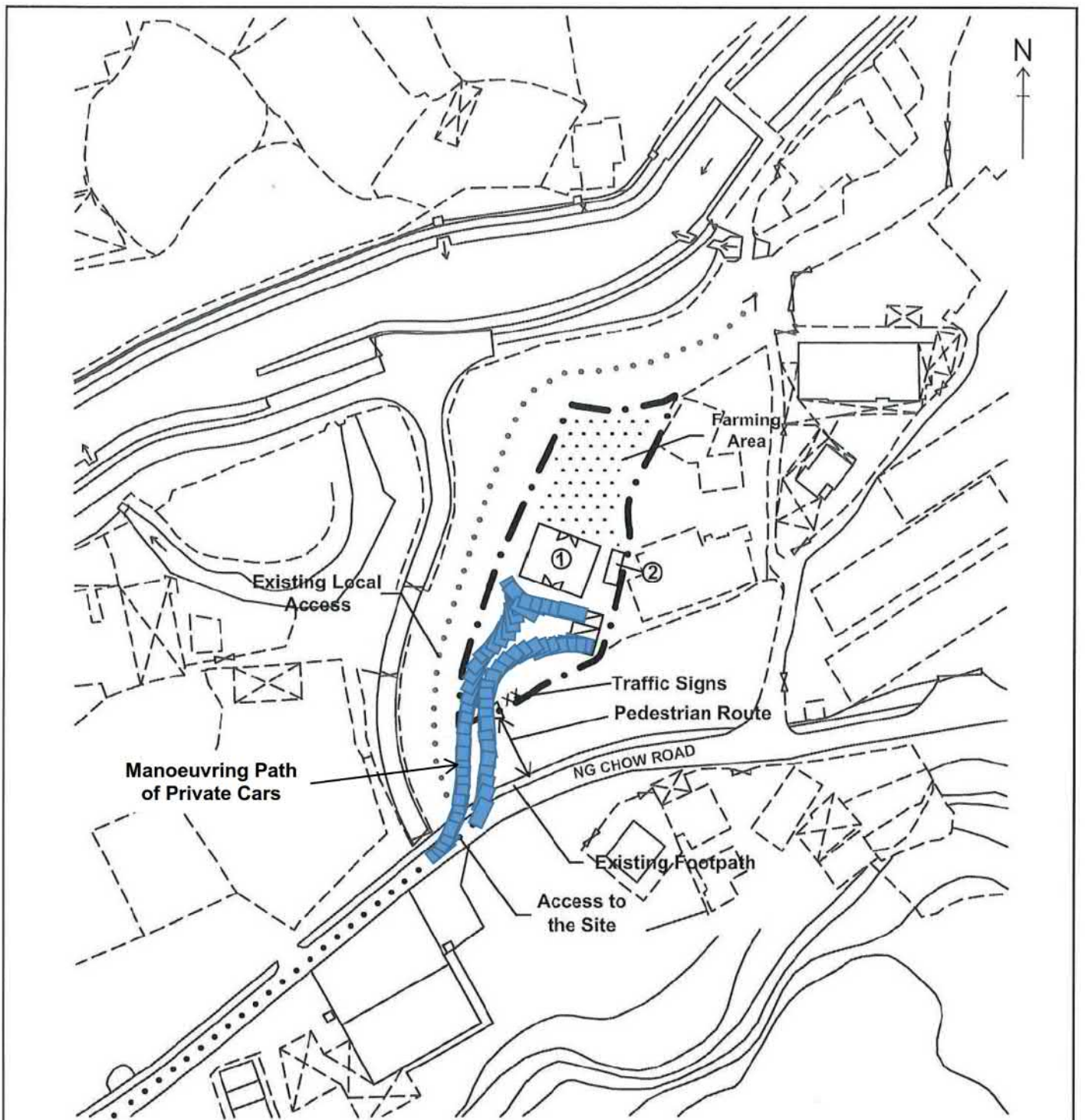

Structure No.	Uses	No. of Storey	Floor Area (m <sup>2</sup> )	Height (m)
1	Green House for Farming	1	120	4.0
2	Store Room for Farm Tools and Toilet	1	15	2.5

**Legend:**

- • — Application Site (about 1,118 sq.m.)
- ▣ Parking Spaces for Private Cars (2.5m x 5m)

For Identification Purpose

<b>Plan showing the Traffic Arrangement</b>	<b>Figure 6A</b>	 <p><b>羅迅測計師行</b> <b>Lawson David &amp; Sung</b> <b>SURVEYORS LIMITED</b> <small>Property Consultants • Planning • Valuers • Auctioneers</small> <small>Estates Agency License No. C 005328</small></p>
	Scale 1:1000	

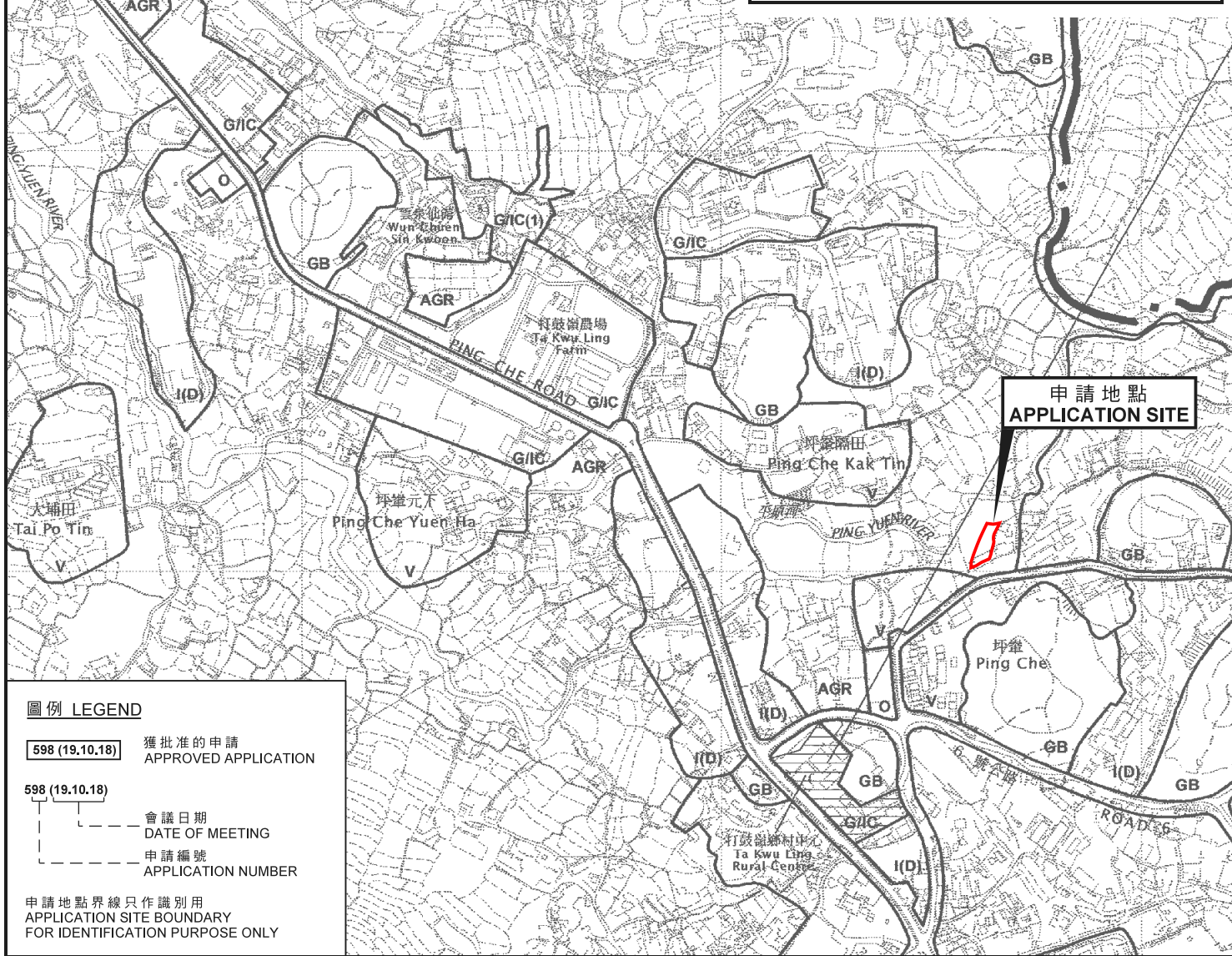
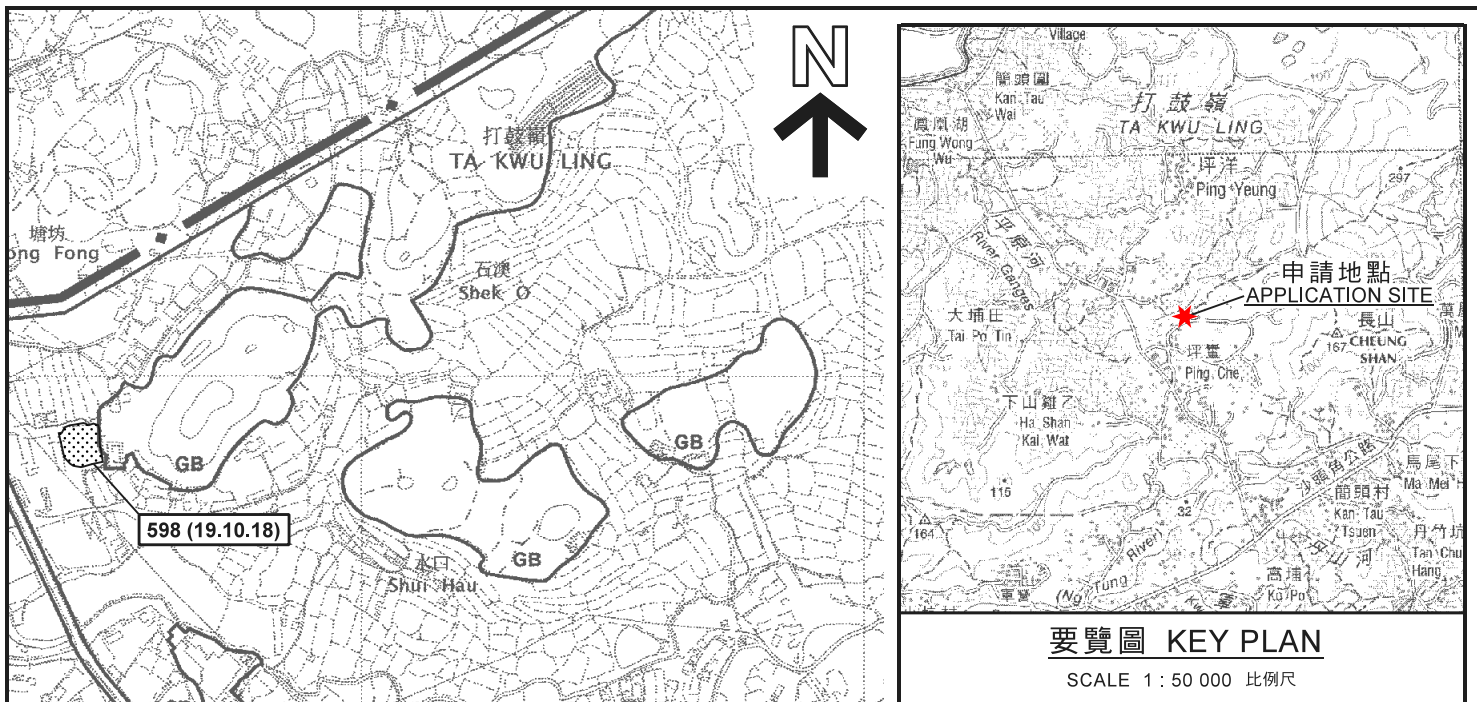

**圖例 LEGEND**

**598 (19.10.18)** 獲批准的申請  
APPROVED APPLICATION

598 (19.10.18) 會議日期  
DATE OF MEETING

598 (19.10.18) 申請編號  
APPLICATION NUMBER

申請地點界線只作識別用  
APPLICATION SITE BOUNDARY  
FOR IDENTIFICATION PURPOSE ONLY

**位置圖 LOCATION PLAN**

本摘要圖於2019年5月3日擬備，  
所根據的資料為於2010年2月2日核准的  
分區計劃大綱圖編號S/NE-TKL/14  
EXTRACT PLAN PREPARED ON 3.5.2019  
BASED ON OUTLINE ZONING PLAN  
No. S/NE-TKL/14 APPROVED ON 2.2.2010

臨時康體文娛場所 (休閒農場) (為期3年)  
新界打鼓嶺坪壘第77約  
地段第520號(部分)及第522號餘段(部分)  
TEMPORARY PLACE OF RECREATION,  
SPORTS OR CULTURE (HOBBY FARM) FOR A PERIOD OF 3 YEARS  
LOTS 520 (PART) AND 522 RP (PART) IN D.D. 77,  
PING CHE, TA KWU LING, N.T.

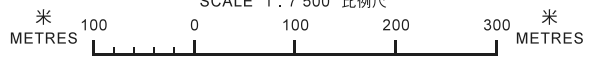

**規劃署  
PLANNING  
DEPARTMENT**



參考編號  
REFERENCE No.  
**A/NE-TKL/607**

**圖 PLAN  
A-1**

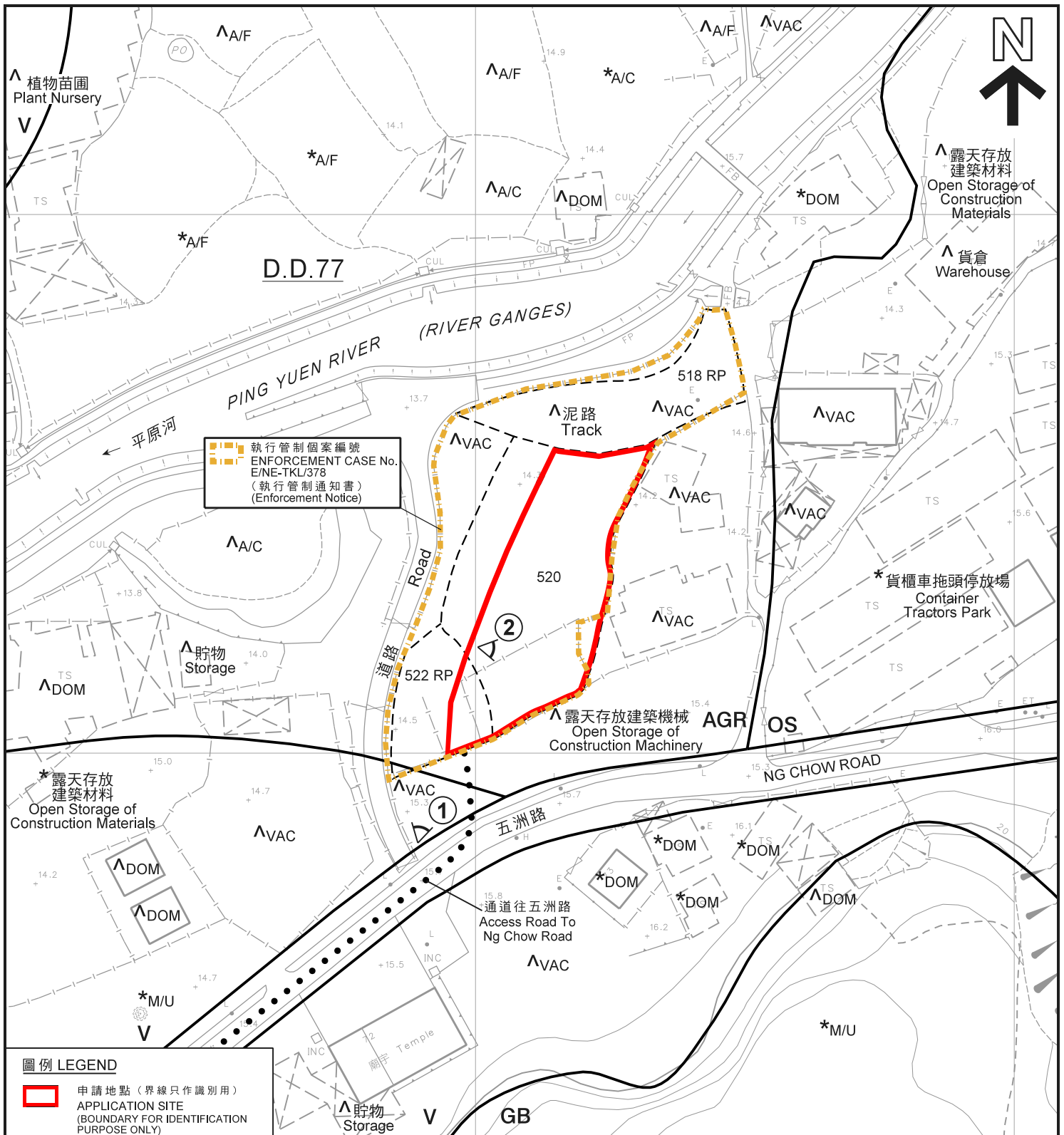

 執行管制個案編號  
 ENFORCEMENT CASE No.  
 E/NE-TKL/378  
 (執行管制通知書)  
 (Enforcement Notice)

**圖例 LEGEND**

-  申請地點 (界線只作識別用)  
APPLICATION SITE  
(BOUNDARY FOR IDENTIFICATION  
PURPOSE ONLY)
- AGR** 農業  
AGRICULTURE
- GB** 綠化地帶  
GREEN BELT
- OS** 露天貯物  
OPEN STORAGE
- V** 鄉村式發展  
VILLAGE TYPE DEVELOPMENT
-  實地照片的觀景點  
VIEWING POINT OF SITE PHOTO

- A/C 常耕農地  
ACTIVE AGRICULTURAL LAND
- A/F 休耕農地  
FALLOW AGRICULTURAL LAND
- DOM 住用構築物  
DOMESTIC STRUCTURE
- M/U 荒地  
UNUSED LAND
- VAC 空置  
VACANT

**註釋 Notes:**

- (1) 2019年5月2日勘測的土地用途  
Land uses shown on this plan are in accordance with the land use survey conducted by the Planning Department on 2.5.2019
- (2) \* 土地用途跟1990年12月28日勘測的土地用途一致  
Indicates that the use is the same as that revealed by the land use survey conducted by the Planning Department on 28.12.1990
- (3) ^ 土地用途跟1990年12月28日勘測的土地用途有別  
Indicates that the use is different from that revealed by the land use survey conducted by the Planning Department on 28.12.1990

**平面圖 SITE PLAN**

臨時康體文娛場所 (休閒農場) (為期3年)  
 新界打鼓嶺坪輦第77約  
 地段第520號(部分)及第522號餘段(部分)  
 TEMPORARY PLACE OF RECREATION,  
 SPORTS OR CULTURE (HOBBY FARM) FOR A PERIOD OF 3 YEARS  
 LOTS 520 (PART) AND 522 RP (PART) IN D.D. 77,  
 PING CHE, TA KWU LING, N.T.

SCALE 1:1 000 比例尺

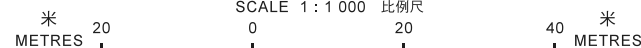

**規劃署**  
**PLANNING**  
**DEPARTMENT**



參考編號  
REFERENCE No.

A/NE-TKL/607

**圖 PLAN**  
**A-2**

本摘要圖於2019年5月8日擬備，  
 所根據的資料為測量圖編號  
 3-NW-24A  
 EXTRACT PLAN PREPARED ON 8.5.2019  
 BASED ON SURVEY SHEET No.  
 3-NW-24A



**圖例 LEGEND**

-  申請地點 (界線只作識別用)
- APPLICATION SITE (BOUNDARY FOR IDENTIFICATION PURPOSE ONLY)

本摘要圖於2019年5月3日擬備，  
 所根據的資料為地政總署  
 於2017年3月28日拍得的航攝照片  
 編號E015668C  
 EXTRACT PLAN PREPARED ON 3.5.2019  
 BASED ON AERIAL PHOTO No. E015668C  
 TAKEN ON 28.3.2017 BY  
 LANDS DEPARTMENT

**航攝照片 AERIAL PHOTO**

臨時康體文娛場所 (休閒農場) (為期3年)  
 新界打鼓嶺坪輦第77約  
 地段第520號(部分)及第522號餘段(部分)  
 TEMPORARY PLACE OF RECREATION,  
 SPORTS OR CULTURE (HOBBY FARM) FOR A PERIOD OF 3 YEARS  
 LOTS 520 (PART) AND 522 RP (PART) IN D.D. 77,  
 PING CHE, TA KWU LING, N.T.

規劃署  
 PLANNING  
 DEPARTMENT



參考編號  
 REFERENCE No.  
 A/NE-TKL/607

圖 PLAN  
 A-3



<p>本圖於2019年5月7日擬備，所根據的資料為攝於2019年5月2日的實地照片          PLAN PREPARED ON 7.5.2019 BASED ON SITE PHOTOS TAKEN ON 2.5.2019</p>	<p style="text-align: center;"><b>實地照片 SITE PHOTOS</b></p> <p style="text-align: center;">臨時康體文娛場所（休閒農場）（為期3年）          新界打鼓嶺坪輦第77約          地段第520號（部分）及第522號餘段（部分）          TEMPORARY PLACE OF RECREATION,          SPORTS OR CULTURE (HOBBY FARM) FOR A PERIOD OF 3 YEARS          LOTS 520 (PART) AND 522 RP (PART) IN D.D. 77,          PING CHE, TA KWU LING, N.T.</p>	<p style="text-align: center;"><b>規劃署          PLANNING          DEPARTMENT</b></p>  <table border="1" style="width: 100%; border-collapse: collapse;"> <tr> <td style="padding: 2px;">                 參考編號                  REFERENCE No.  <b>A/NE-TKL/607</b> </td> <td style="padding: 2px; text-align: center;"> <b>圖 PLAN                  A-4</b> </td> </tr> </table>	參考編號 REFERENCE No. <b>A/NE-TKL/607</b>	<b>圖 PLAN                  A-4</b>
參考編號 REFERENCE No. <b>A/NE-TKL/607</b>	<b>圖 PLAN                  A-4</b>			