

LOCATION PLAN

3638/SK2

Consultant

**AWJC Associates Ltd.**  
 Architectural and Engineering Consultancy  
 Project Management

Job No

Date

3638

24Oct2017

Unit A, 17/F, Success Commercial Building  
 245-251 Hennessey Road, Wanchai, Hong Kong

Telephone : 2361 0670  
 Facsimile : 2866 9016

參考編號 REFERENCE No. 繪圖 DRAWING  
 A/TM/512 A-1

(摘錄自申請人於17.11.2017呈交的申請書)  
 (Extract from Applicant's  
 Submission Dated 17.11.2017)

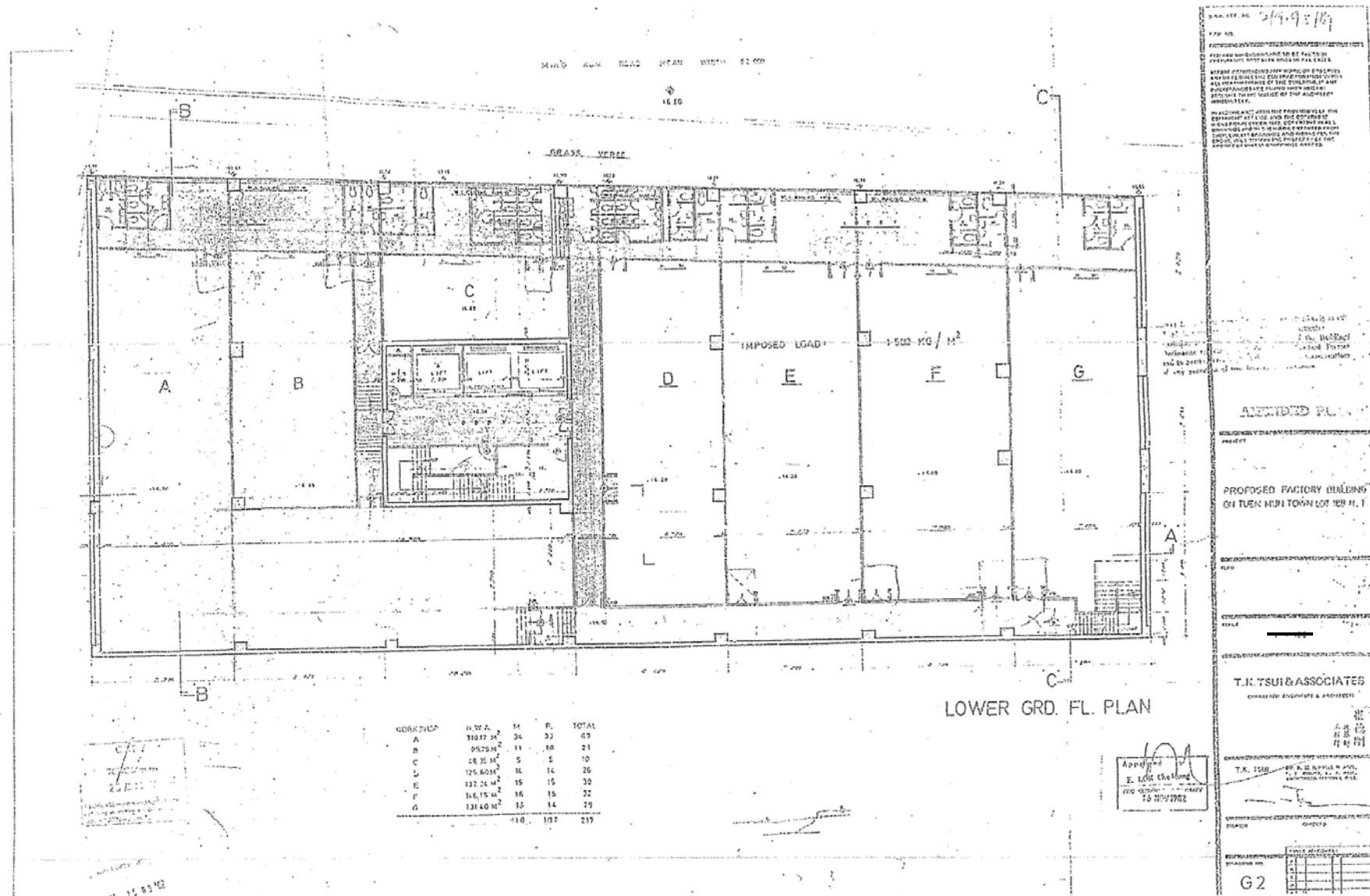

DATE: 2017/10/23  
 DRAWING NO. 3638/SK04  
 PROPOSED FACTORY BUILDING ON TUN MUN TOWN LOT T.M.T.L. 185 NT

APPROVED PLAN  
 T.K. TSUI & ASSOCIATES  
 CONSULTING ENGINEERS & ARCHITECTS

PROPOSED FACTORY BUILDING  
 ON TUN MUN TOWN LOT T.M.T.L. 185 NT

T.K. TSUI & ASSOCIATES  
 CONSULTING ENGINEERS & ARCHITECTS

APPROVED  
 T.K. TSUI  
 18 NOV 2017

AWJC Associates Ltd.  
 245-251 Shau Kei Wan Road, Hong Kong  
 Telephone: 2961 2672  
 Facsimile: 2953 3034

PROPOSED CHANGE USE OF LOWER G/F OF  
 CO-TACK INDUSTRIAL BUILDING AT  
 NO.17 KIN FAT STREET, TUN MUN  
 TOWN LOT T.M.T.L.185 NT

EXISTING LOWER GROUND FLOOR LAYOUT  
 (EXTRACTED FROM BUILDINGS  
 DEPARTMENT'S RECORD PLAN)

23 October 2017

3638  
 3638/SK04

參考編號 REFERENCE No. 繪圖 DRAWING  
 A/TM/512 A-2

(摘錄自申請人於17. 11. 2017提交的申請書)  
 (Extract from Applicant's  
 Submission Dated 17.11.2017)

MING KUM ROAD

10.BC

GRASS VERGE

B.D. REF. NO.:

F.S.D. REF. NO.:

1. All dimensions shown are in millimetres unless otherwise stated.  
 2. Use metric fractions or decimals to indicate the actual dimensions. Measurements to existing walls are to be treated as 0.

LEGEND:



KEY:

- (1) GENERAL OFFICE
- (2) STORE

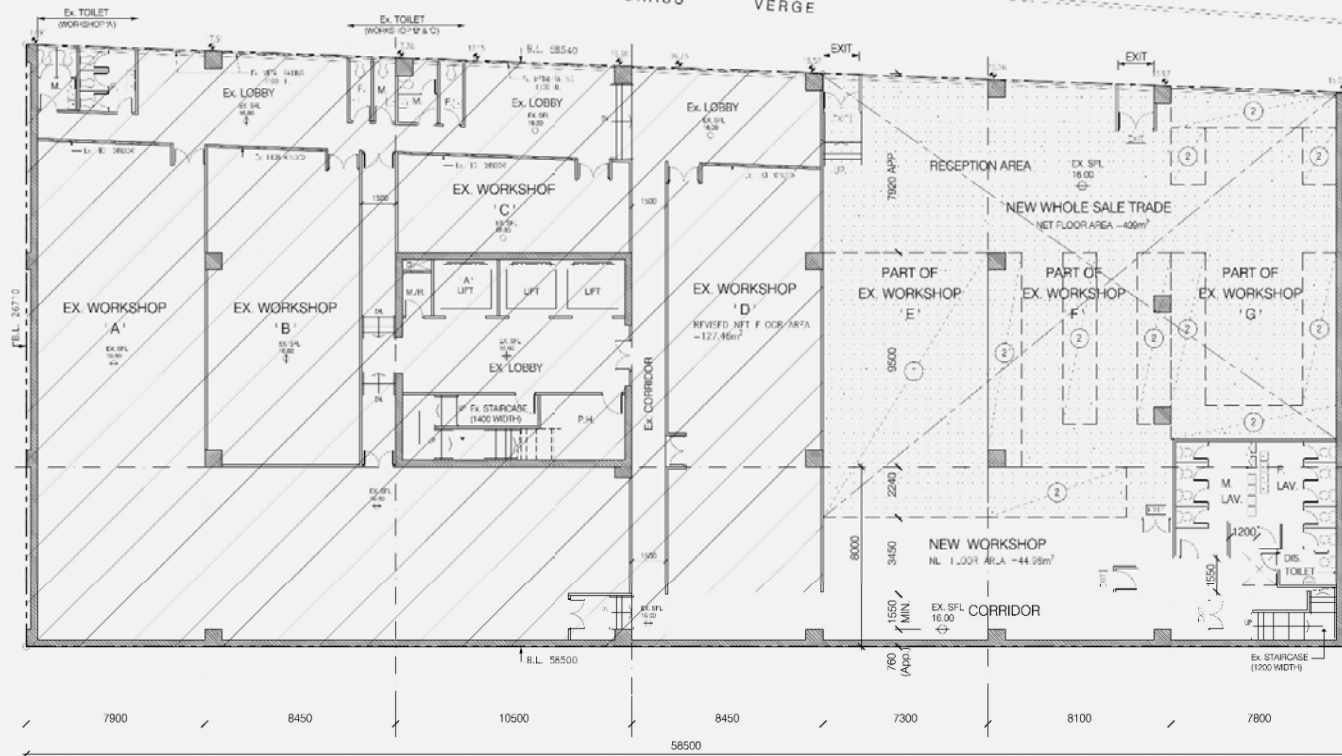

(FACING KIN FAT STREET)  
 LOWER GROUND FLOOR PLAN

NO.	DATE	BY	REVISION/COM	SCALE	APP.
GENERAL NOTES					
DRAWN					
PROJEC					
PROPOSED CHANGE USE AT LOWER GROUND FLOOR OF Co-Tack INDUSTRIAL BUILDING at No. 17 KIN FAT STREET on TUSH MUN TOWK LOT 11 M.L. 188, N.T.					
DESC					
INTERNAL ARRANGEMENT LAYOUT OF PREMISES OF THE PROPOSED CHANGE USE					
DATE/NO.					
SCALE & SIZE	CHECKED	BY	DATE	COVERED	DATE
1:50	AW	AW	18/12/17	CSW	18/12/17
NO. FILE	BRANCH	FILE	DATE	NO.	NO.
3638	BRANCH	3638/SK05			
DRAWN					
AWJC Associates Ltd. 222, Des Voeux Street East, Singapore (INCORPORATED IN SINGAPORE)					
AWJC Associates Ltd. 222, Des Voeux Street East, Singapore (INCORPORATED IN SINGAPORE)					
© COPYRIGHT RESERVED					

參考編號 REFERENCE No. 繪圖 DRAWING  
 A/TM/512 A-3

(摘錄自申請人於29. 12. 2017呈交的申請書)  
 (Extract from Applicant's  
 Submission Dated 29.12.2017)

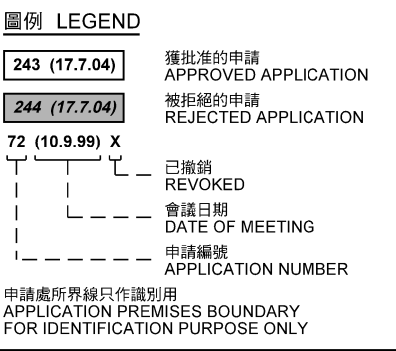
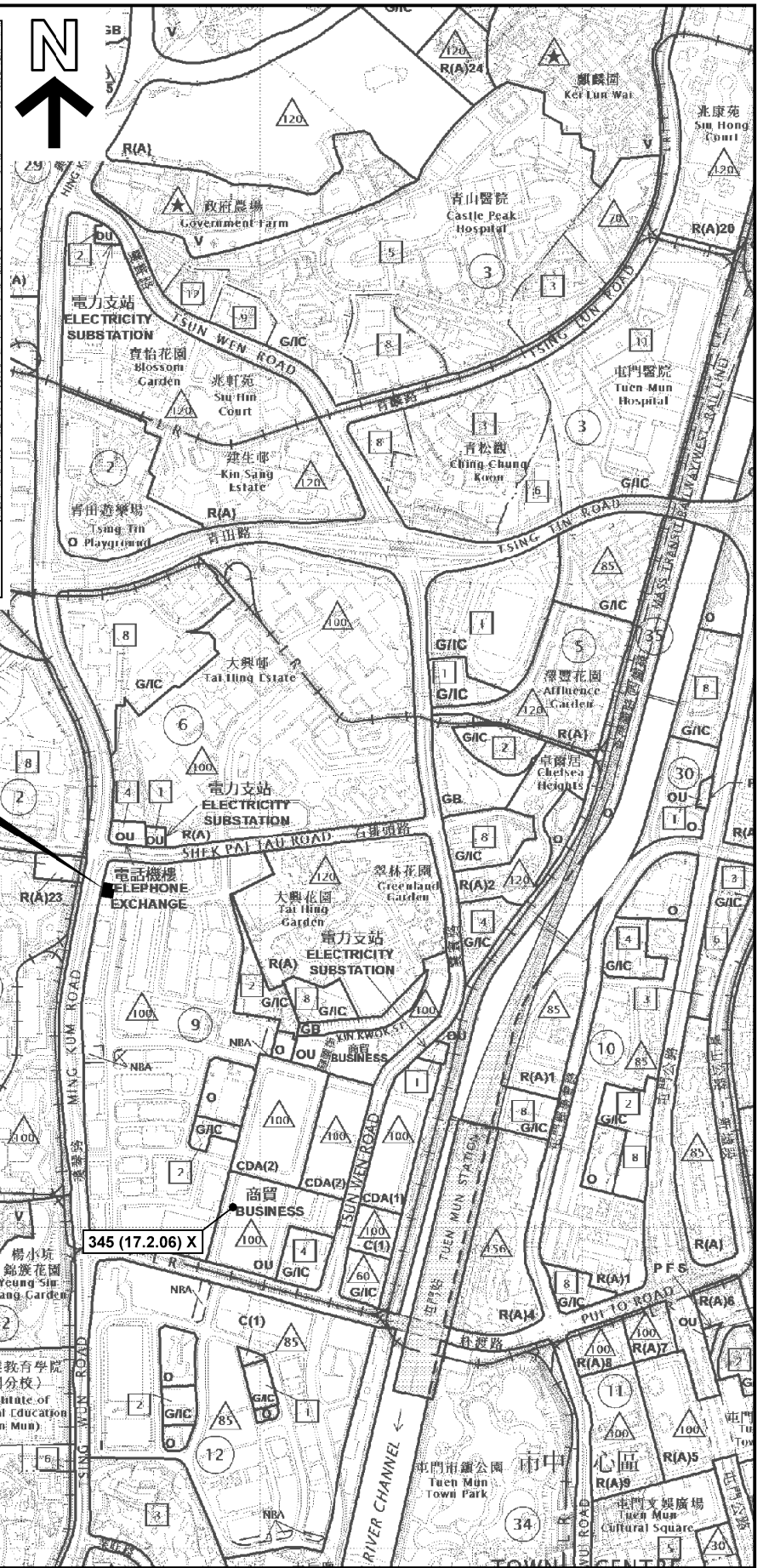
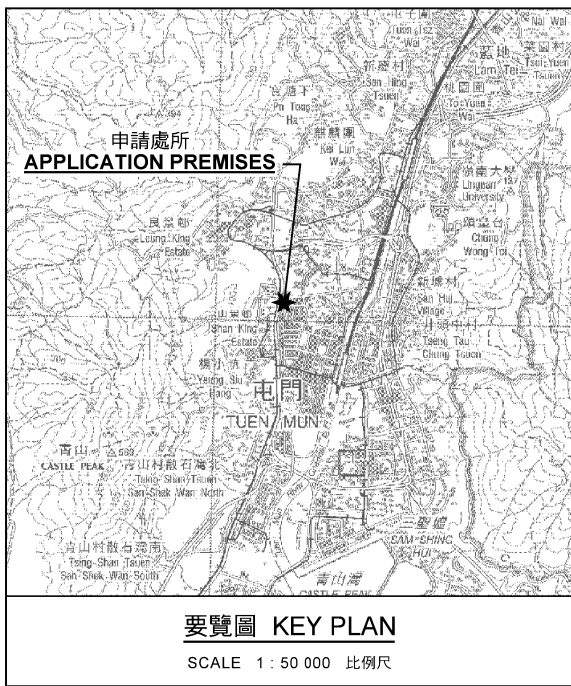

**位置圖 LOCATION PLAN**

擬議批發行業

新界屯門建發街17號同德工業大廈地下部份E、F及G單位  
PROPOSED WHOLESALE TRADE  
PART OF WORKSHOPS E, F & G AT LOWER  
GROUND FLOOR, CO TACK INDUSTRIAL BUILDING,  
17 KIN FAT STREET, TUEN MUN, NEW TERRITORIES  
SCALE 1 : 10 000 比例尺

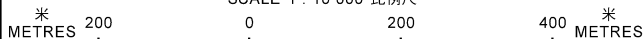

規劃署  
**PLANNING  
DEPARTMENT**



參考編號  
REFERENCE No.  
**A/TM/512**

圖 PLAN  
**A-1**

本摘要圖於2017年12月29日擬備，  
所根據的資料為於2017年11月3日  
展示的分區計劃大綱圖編號 S/TM/34  
EXTRACT PLAN PREPARED ON 29.12.2017  
BASED ON OUTLINE ZONING PLAN No.  
S/TM/34 EXHIBITED ON 3.11.2017

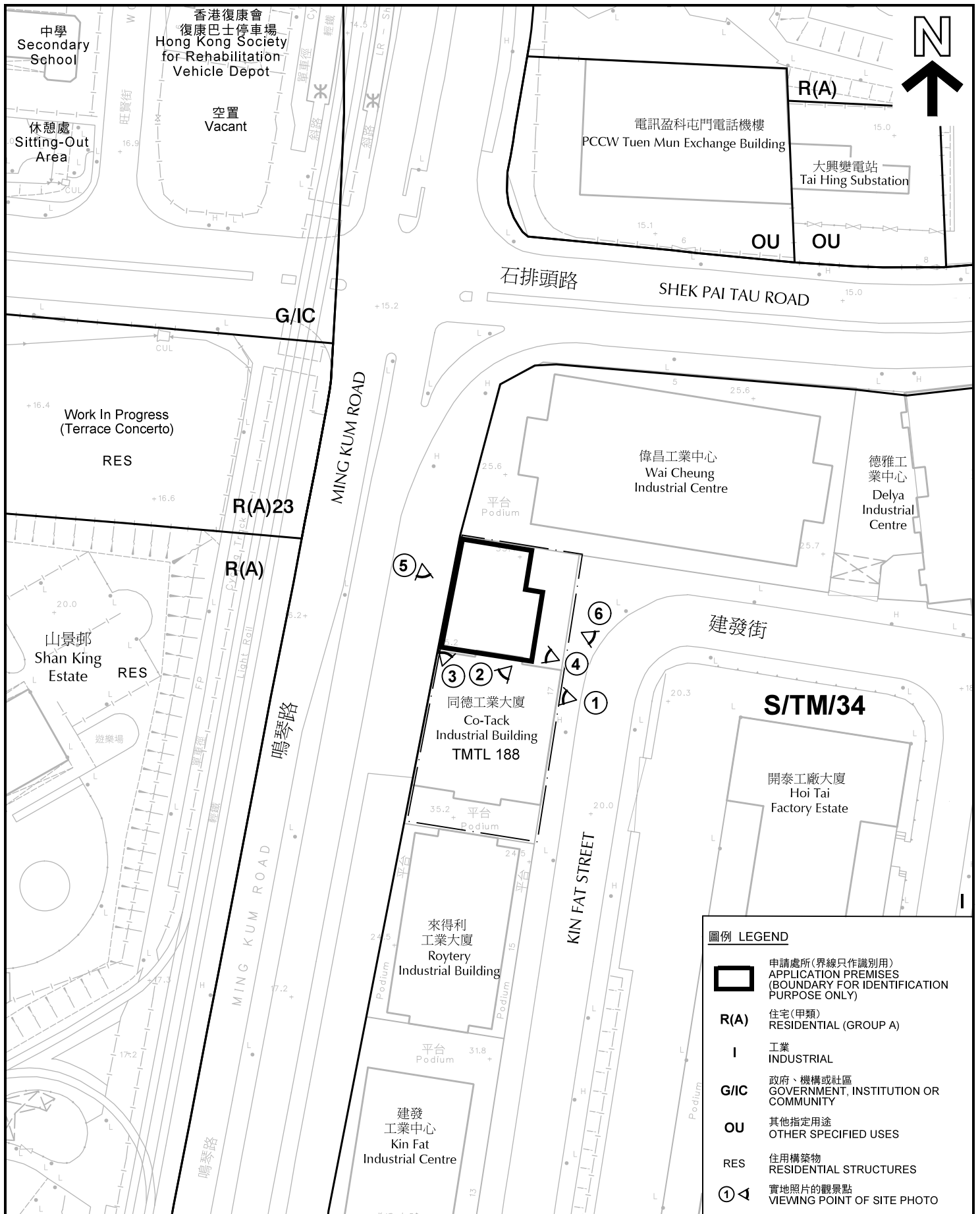

圖例 LEGEND	
	申請處所(界線只作識別用) APPLICATION PREMISES (BOUNDARY FOR IDENTIFICATION PURPOSE ONLY)
<b>R(A)</b>	住宅(甲類) RESIDENTIAL (GROUP A)
<b>I</b>	工業 INDUSTRIAL
<b>G/IC</b>	政府、機構或社區 GOVERNMENT, INSTITUTION OR COMMUNITY
<b>OU</b>	其他指定用途 OTHER SPECIFIED USES
<b>RES</b>	住用構築物 RESIDENTIAL STRUCTURES
<b>①</b>	實地照片的觀景點 VIEWING POINT OF SITE PHOTO

**平面圖 SITE PLAN**

擬議批發行業  
 新界屯門建發街17號同德工業大廈地下部份E、F及G單位  
**PROPOSED WHOLESALE TRADE**  
**PART OF WORKSHOPS E, F & G AT LOWER**  
**GROUND FLOOR, CO TACK INDUSTRIAL BUILDING,**  
**17 KIN FAT STREET, TUEN MUN, NEW TERRITORIES**

本摘要圖於2017年12月5日擬備，所根據的資料為測量圖編號 5-SE-5D  
 EXTRACT PLAN PREPARED ON 5.12.2017  
 BASED ON SURVEY SHEET No.  
 5-SE-5D

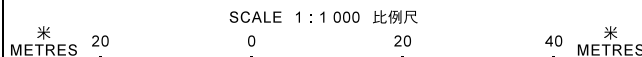

**規劃署**  
**PLANNING**  
**DEPARTMENT**



參考編號  
 REFERENCE No.  
**A/TM/512**

**圖 PLAN**  
**A-2**

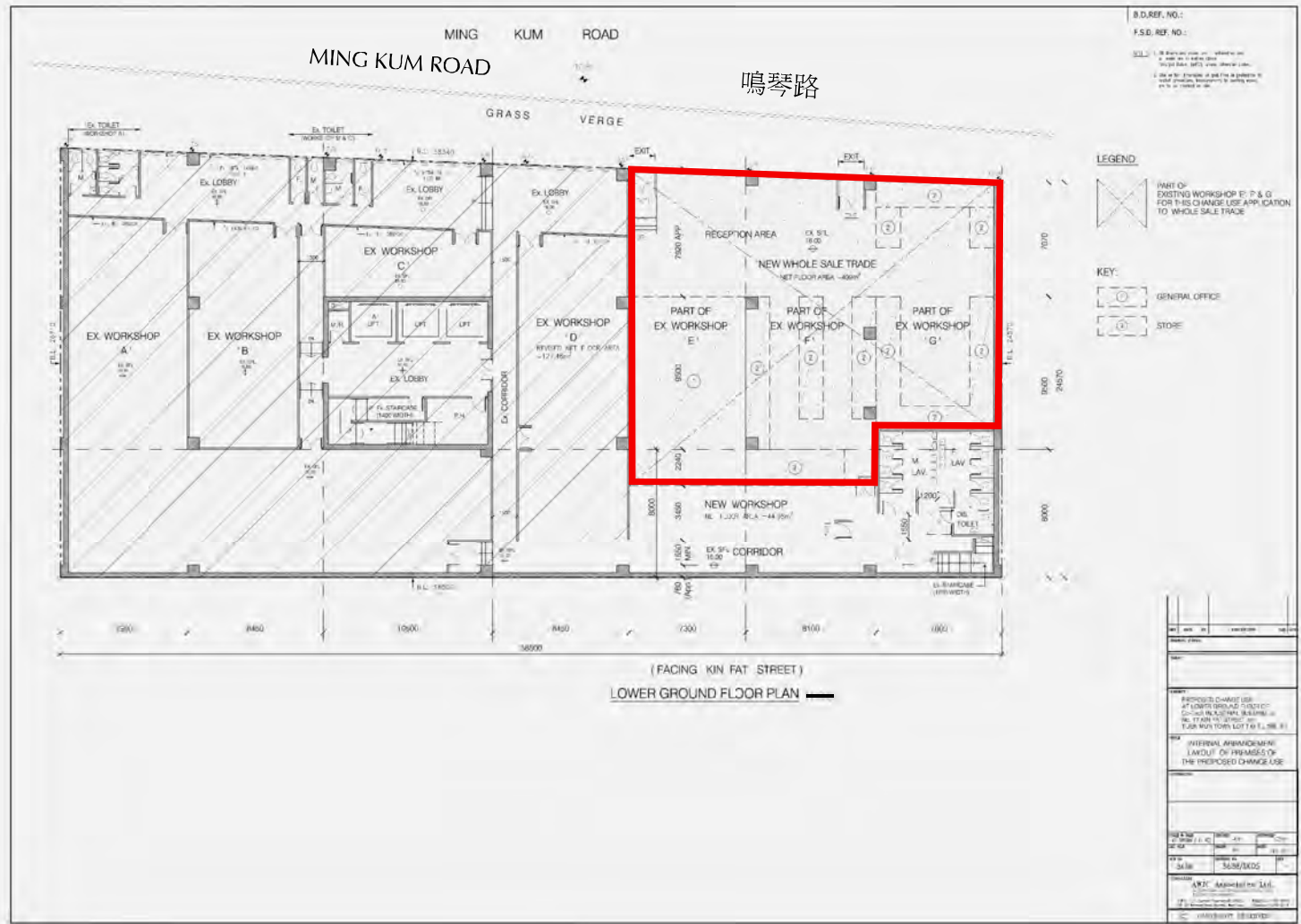

**圖例 LEGEND**

申請處所(界線只作識別用)  
APPLICATION PREMISES  
(BOUNDARY FOR IDENTIFICATION  
PURPOSE ONLY)

**同德工業大廈地下低層平面圖**  
**FLOOR PLAN OF LOWER GROUND FLOOR, CO-TACK INDUSTRIAL BUILDING**

擬議批發行業  
新界屯門建發街17號同德工業大廈地下部份E、F及G單位  
PROPOSED WHOLESALE TRADE  
PART OF WORKSHOPS E, F & G AT LOWER  
GROUND FLOOR, CO TACK INDUSTRIAL BUILDING,  
17 KIN FAT STREET, TUEN MUN, NEW TERRITORIES

**規 劃 署**  
**PLANNING**  
**DEPARTMENT**



參考編號  
REFERENCE No.  
**A/TM/512**

圖 PLAN  
**A-2a**

本摘要圖於2018年3月28日擬備  
EXTRACT PLAN PREPARED ON 28.3.2018



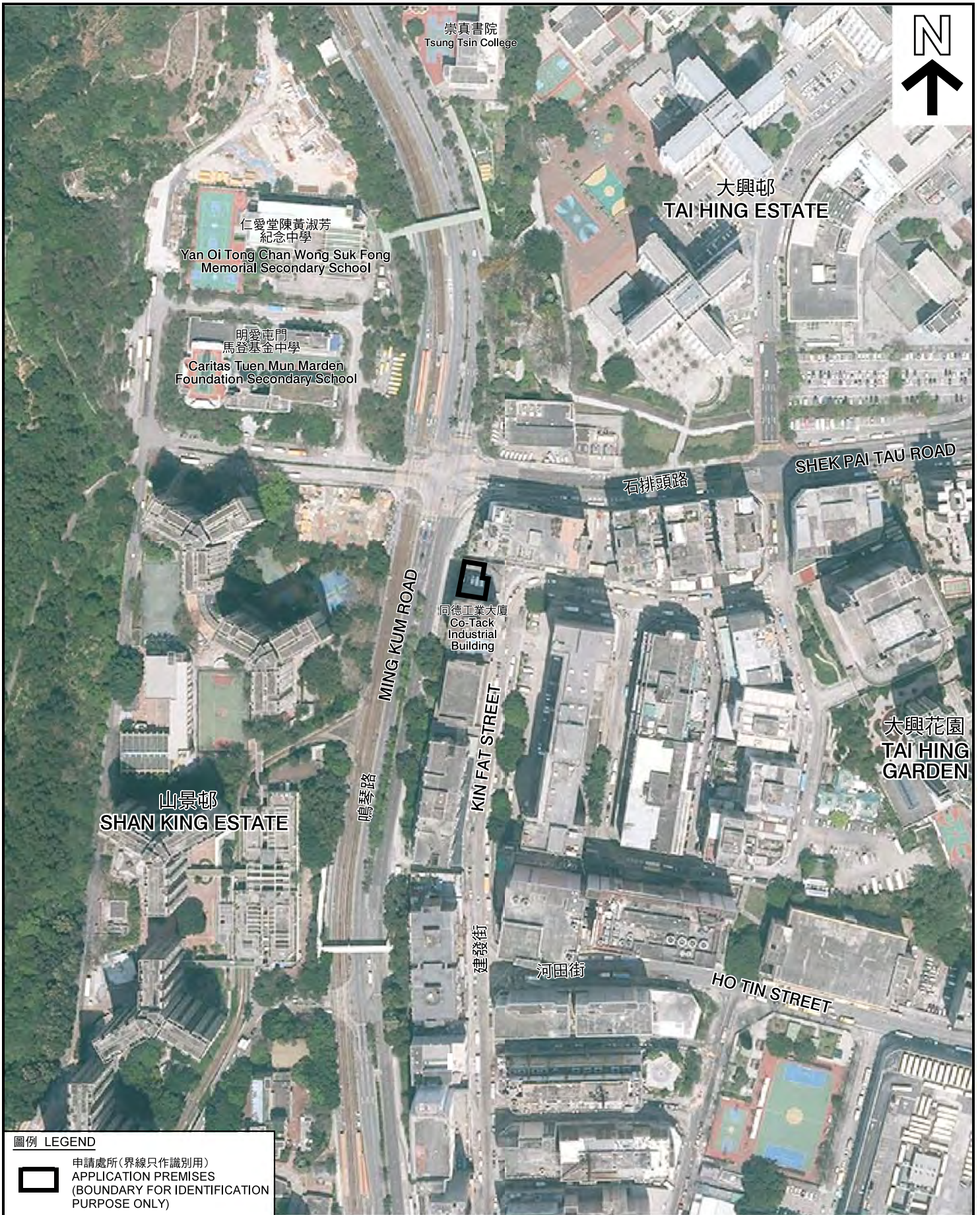

圖例 LEGEND



申請處所(界線只作識別用)  
APPLICATION PREMISES  
(BOUNDARY FOR IDENTIFICATION  
PURPOSE ONLY)

本摘要圖於2017年12月29日擬備，所根據  
的資料為地政總署於2017年4月2日拍得  
的航攝照片編號 E017962C  
EXTRACT PLAN PREPARED ON 29.12.2017  
BASED ON AERIAL PHOTO No.  
E017962C TAKEN ON 2.4.2017  
BY LANDS DEPARTMENT

航攝照片 AERIAL PHOTO

擬議批發行業  
新界屯門建發街17號同德工業大廈地下部份E、F及G單位  
PROPOSED WHOLESALE TRADE  
PART OF WORKSHOPS E, F & G AT LOWER  
GROUND FLOOR, CO TACK INDUSTRIAL BUILDING,  
17 KIN FAT STREET, TUEN MUN, NEW TERRITORIES

規劃署  
PLANNING  
DEPARTMENT



參考編號  
REFERENCE No.  
A/TM/512

圖 PLAN  
A-3





申請處所界線只作識別用 APPLICATION PREMISES BOUNDARY FOR IDENTIFICATION PURPOSE ONLY

**實地照片 SITE PHOTO**

擬議批發行業  
 新界屯門建發街17號同德工業大廈地下部份E、F及G單位  
 PROPOSED WHOLESALE TRADE  
 PART OF WORKSHOPS E, F & G AT LOWER  
 GROUND FLOOR, CO TACK INDUSTRIAL BUILDING,  
 17 KIN FAT STREET, TUEN MUN, NEW TERRITORIES

規劃署  
 PLANNING  
 DEPARTMENT



參考編號  
 REFERENCE No.  
 A/TM/512

圖 PLAN  
 A-4a

本圖於2017年12月5日擬備，所根據的資料為攝於2017年11月24日的實地照片  
 PLAN PREPARED ON 5.12.2017  
 BASED ON SITE PHOTOS  
 TAKEN ON 24.11.2017



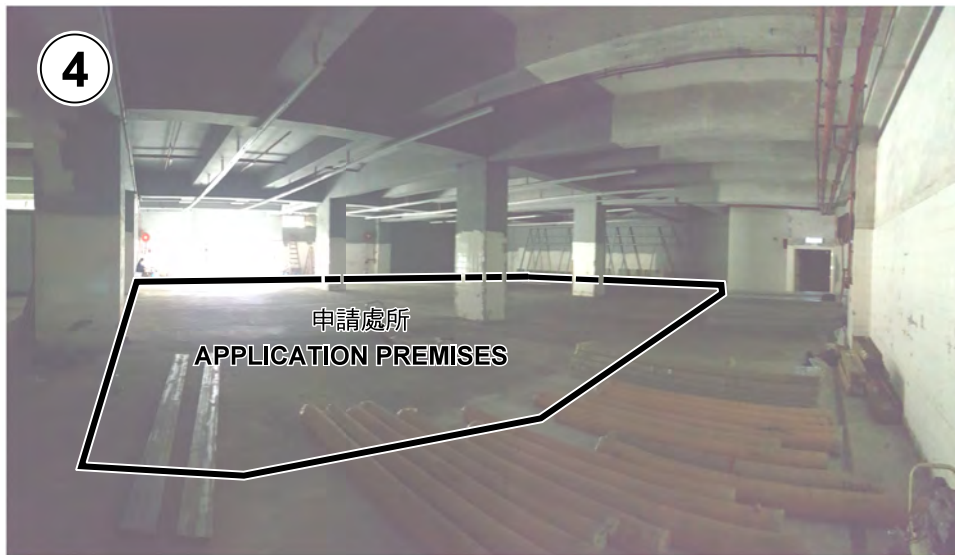

申請處所界線只作識別用 APPLICATION PREMISES BOUNDARY FOR IDENTIFICATION PURPOSE ONLY

### 實地照片 SITE PHOTO

擬議批發行業  
新界屯門建發街17號同德工業大廈地下部份E、F及G單位  
PROPOSED WHOLESALE TRADE  
PART OF WORKSHOPS E, F & G AT LOWER  
GROUND FLOOR, CO TACK INDUSTRIAL BUILDING,  
17 KIN FAT STREET, TUEN MUN, NEW TERRITORIES

規劃署  
PLANNING  
DEPARTMENT



參考編號  
REFERENCE No.  
A/TM/512

圖 PLAN  
A-4b

本圖於2017年12月5日擬備，所根據的資料為攝於2017年11月24日的實地照片  
PLAN PREPARED ON 5.12.2017  
BASED ON SITE PHOTOS  
TAKEN ON 24.11.2017