

Project 項目名稱: Proposed Temporary Public Vehicle Park for Private Cars & Light Goods Vehicles for a Period of 3 Years at Lots 2888 RP (Part) & 2889 RP (Part) in D.D. 129, Sha Kong Wai, Yuen Long, N.T.	Drawing Title 圖目: Site Plan	Remarks 備註:
	Drawing No. 圖號: Figure 1	Scale 比例: 1:1000

參考編號 REFERENCE No. A/YL-LFS/345	繪圖 DRAWING A-1
---	--------------------------

(摘錄自申請人於18. 6. 2019呈交的申請書)
 (Extract from Applicant's Submission Dated 18.6.2019)

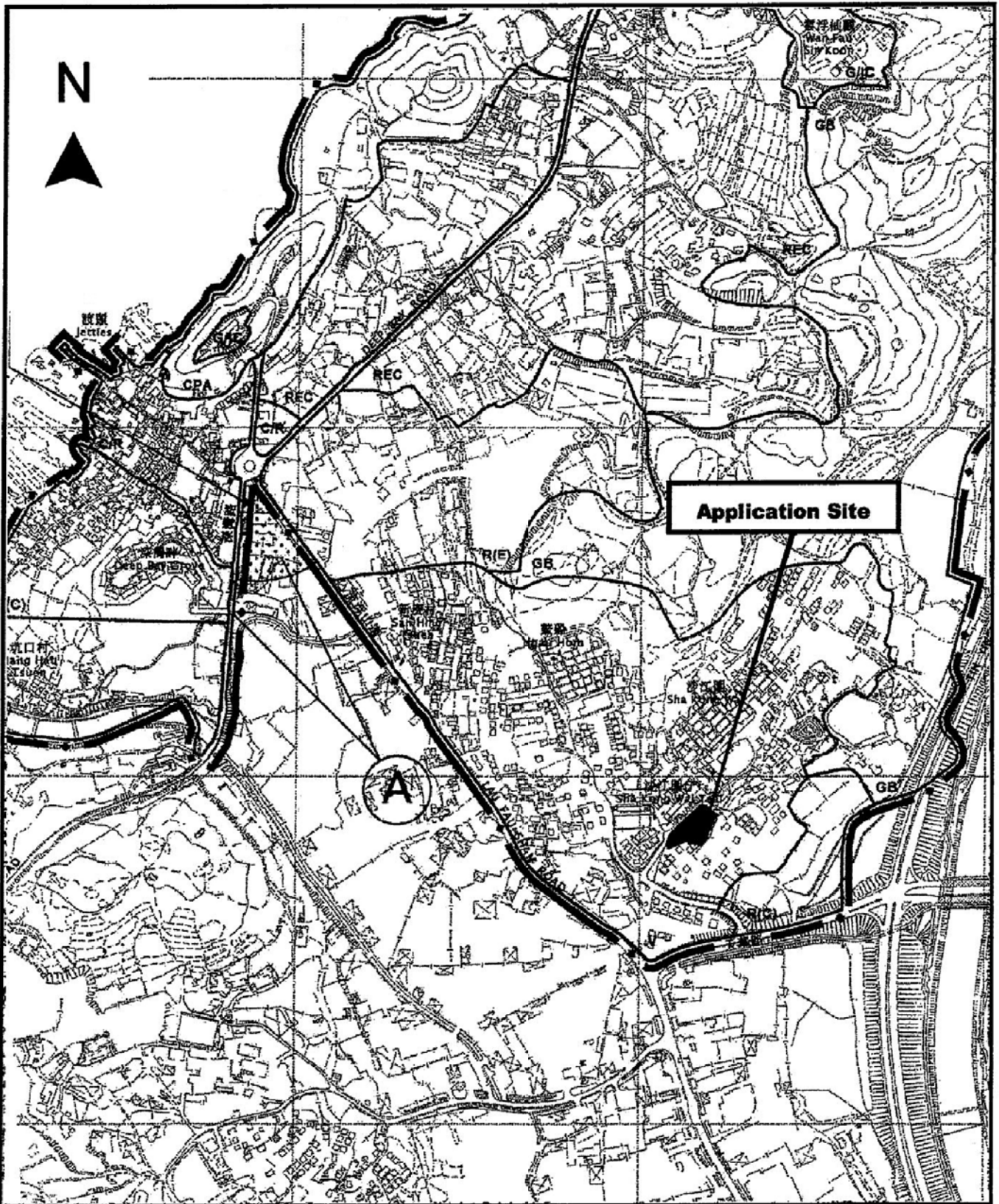

<p>Project 項目名稱: Proposed Temporary Public Vehicle Park for Private Cars & Light Goods Vehicles for a Period of 3 Years at Lots 2888 RP (Part) & 2889 RP (Part) in D.D. 129, Sha Kong Wai, Yuen Long, N.T.</p>	<p>Drawing Title 圖目: Location Plan</p>	<p>Remarks 備註: ... Vehicular access leading from Man Tak Road</p>
	<p>Drawing No. 圖號: Figure 2</p>	<p>Scale 比例: 1:7500</p>

參考編號 REFERENCE No. A/YL-LFS/345	繪圖 DRAWING A-2
---	--------------------------

(摘錄自申請人於18.6.2019呈交的申請書)
 (Extract from Applicant's Submission Dated 18.6.2019)

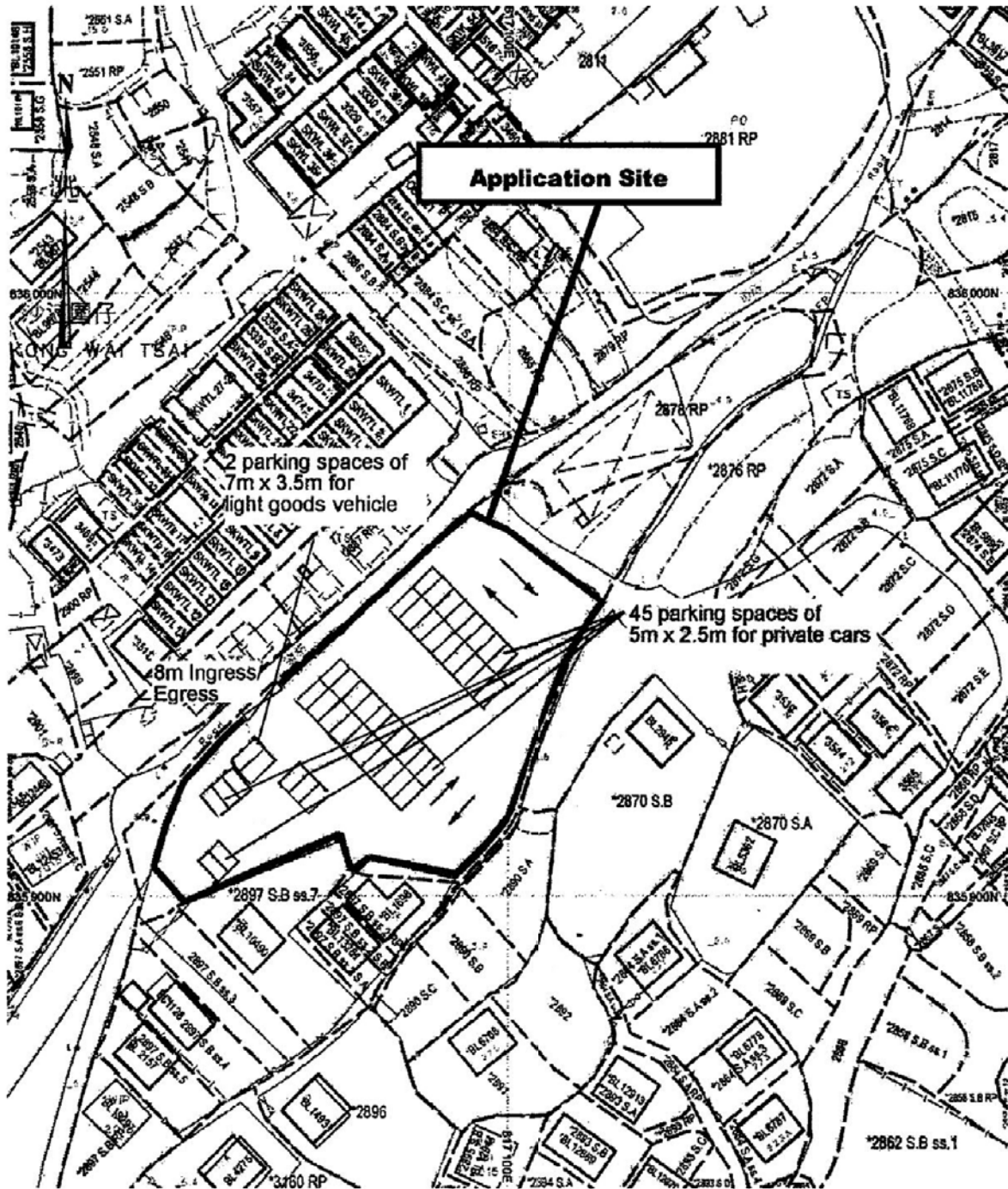

<p>Project 項目名稱: Proposed Temporary Public Vehicle Park for Private Cars & Light Goods Vehicles for a Period of 3 Years at Lots 2888 RP (Part) & 2889 RP (Part) in D.D. 129, Sha Kong Wai, Yuen Long, N.T.</p>	<p>Drawing Title 圖目: Proposed Layout Plan</p>	<p>Remarks 備註:</p>
	<p>Drawing No. 圖號: Figure 3</p>	<p>Scale 比例: 1:1000</p>

<p>參考編號 REFERENCE No. A/YL-LFS/345</p>	<p>繪圖 DRAWING A-3</p>
--	-----------------------------------

(摘錄自申請人於18. 6. 2019呈交的申請書)
 (Extract from Applicant's Submission Dated 18.6.2019)

Tree	Approximate Height	Spacing
○ Existing <i>Melaleuca leucadendron</i>	2.75m	3m to 4m

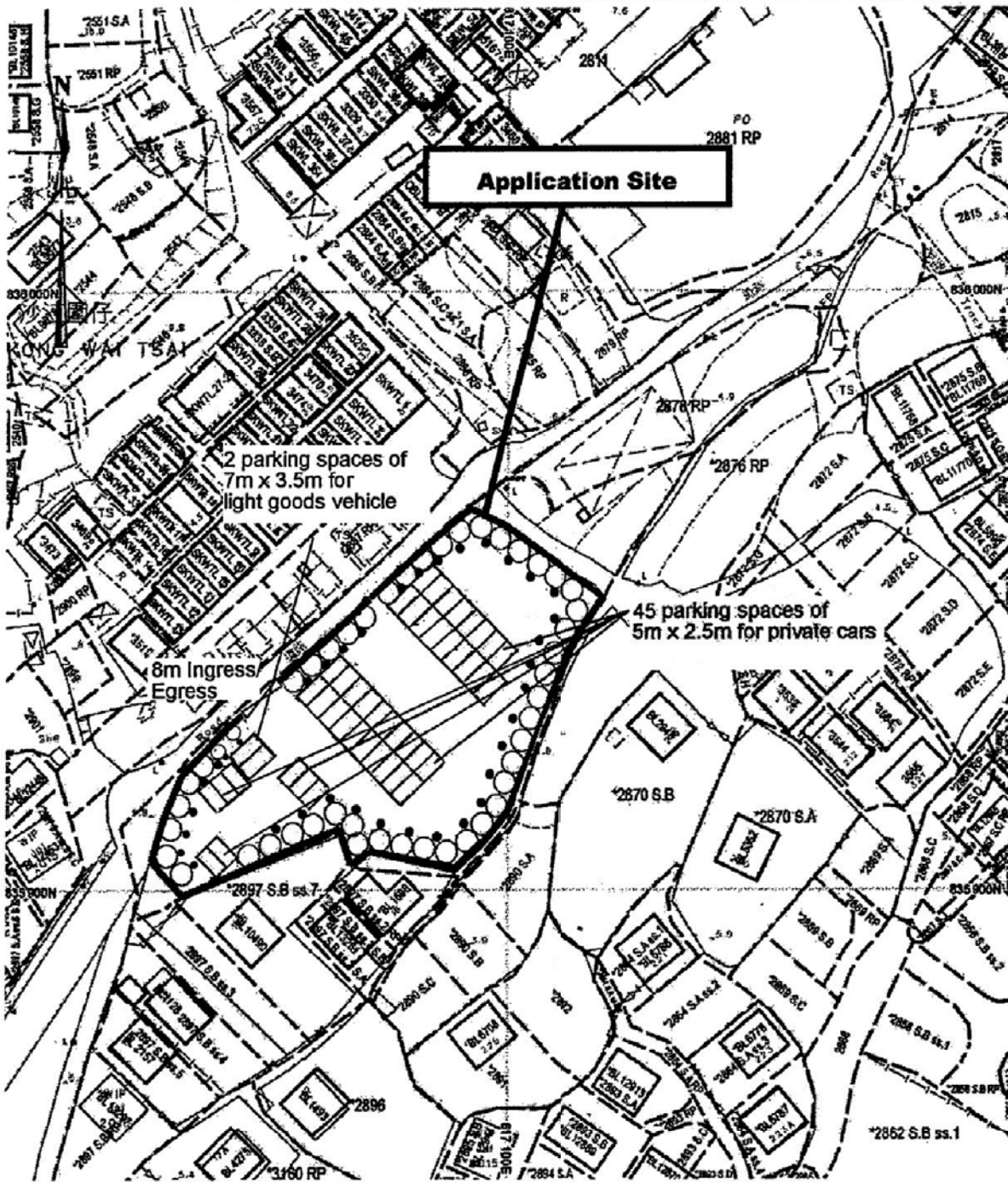

Project 項目名稱:

Proposed Temporary Public Vehicle Park for Private Cars & Light Goods Vehicles for a Period of 3 Years at Lots 2888 RP (Part) & 2889 RP (Part) in D.D. 129, Sha Kong Wai, Yuen Long, N.T.

Drawing Title 圖目:

Proposed Landscape & Tree Preservation Plan

Remarks 備註:

● Existing metal bollards

Drawing No. 圖號:

Figure 4

Scale 比例:

1:1000

參考編號 REFERENCE No. 繪圖 DRAWING
AYL-LFS/345 A-4

(摘錄自申請人於18.6.2019呈交的申請書)
(Extract from Applicant's
Submission Dated 18.6.2019)

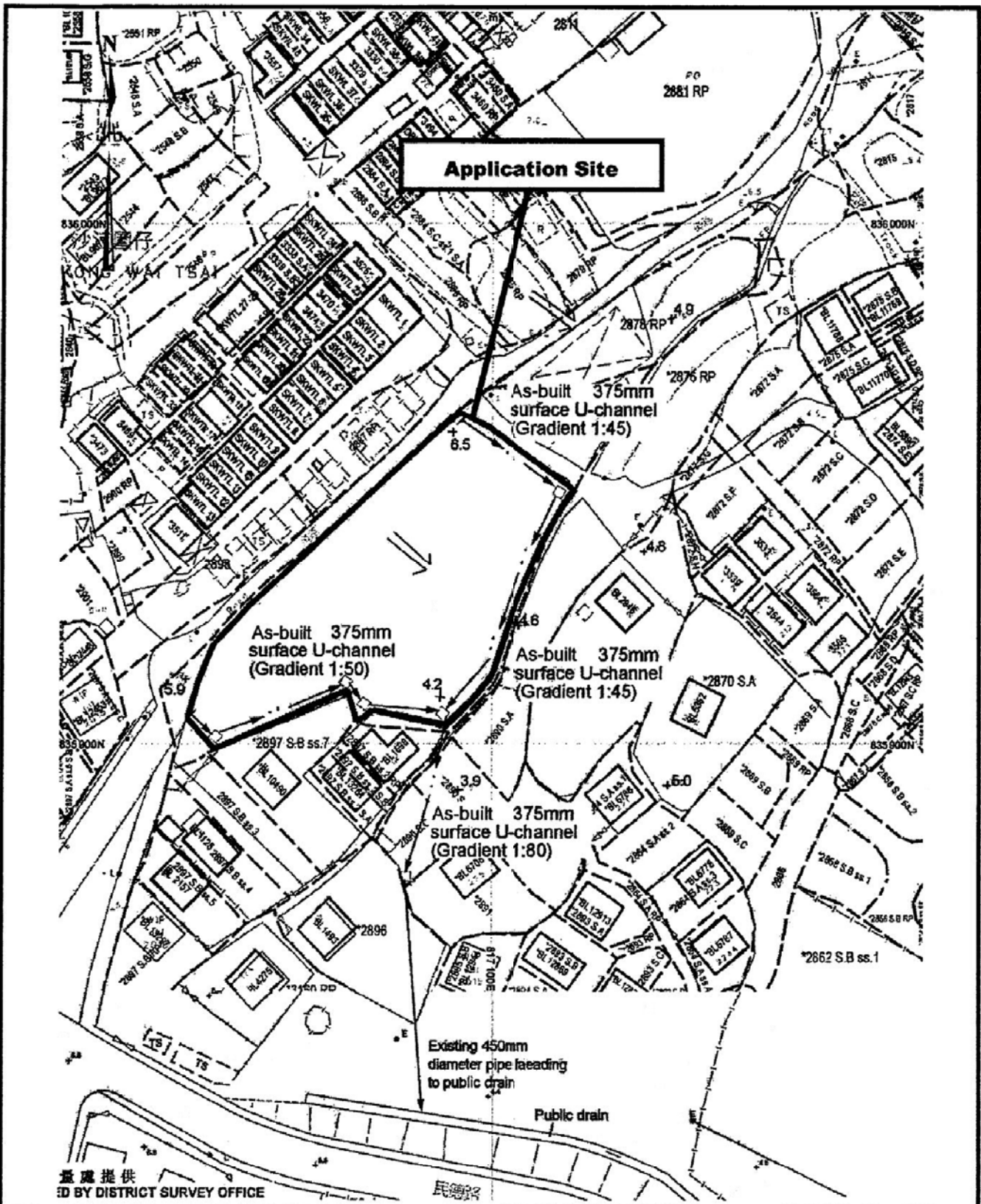

<p>Project 項目名稱: Proposed Temporary Public Vehicle Park for Private Cars & Light Goods Vehicles for a Period of 3 Years at Lots 2888 RP (Part) & 2889 RP (Part) in D.D. 129, Sha Kong Wai, Yuen Long, N.T.</p>	<p>Drawing Title 圖目: As-built Drainage Plan</p>	<p>Remarks 備註: <input type="checkbox"/> Catchpit Flow of surface runoff +6.5 Level (in mPD)</p>
	<p>Drawing No. 圖號: Figure 5</p>	<p>Scale 比例: 1:1000</p>

參考編號 REFERENCE No. A/YL-LFS/345	繪圖 DRAWING A-5
---	--------------------------

(摘錄自申請人於18. 6. 2019呈交的申請書)
 (Extract from Applicant's Submission Dated 18.6.2019)

后海灣
(深圳灣)
DEEP BAY
(SHENZHEN WAN)

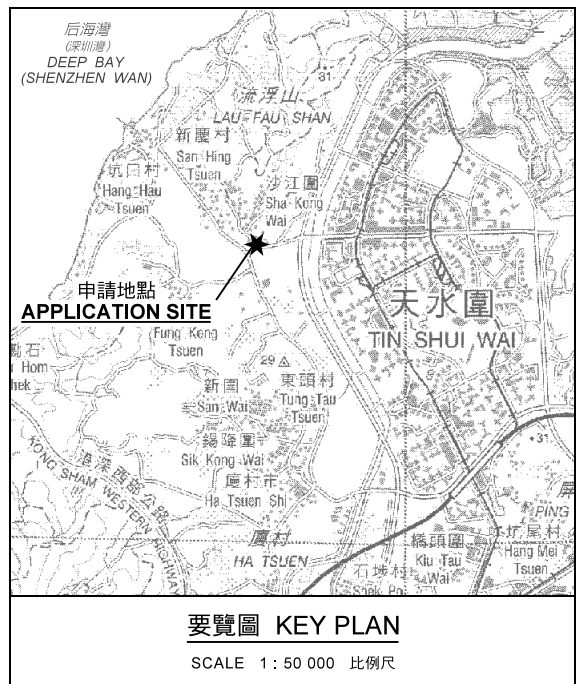

S/YL-LFS/9

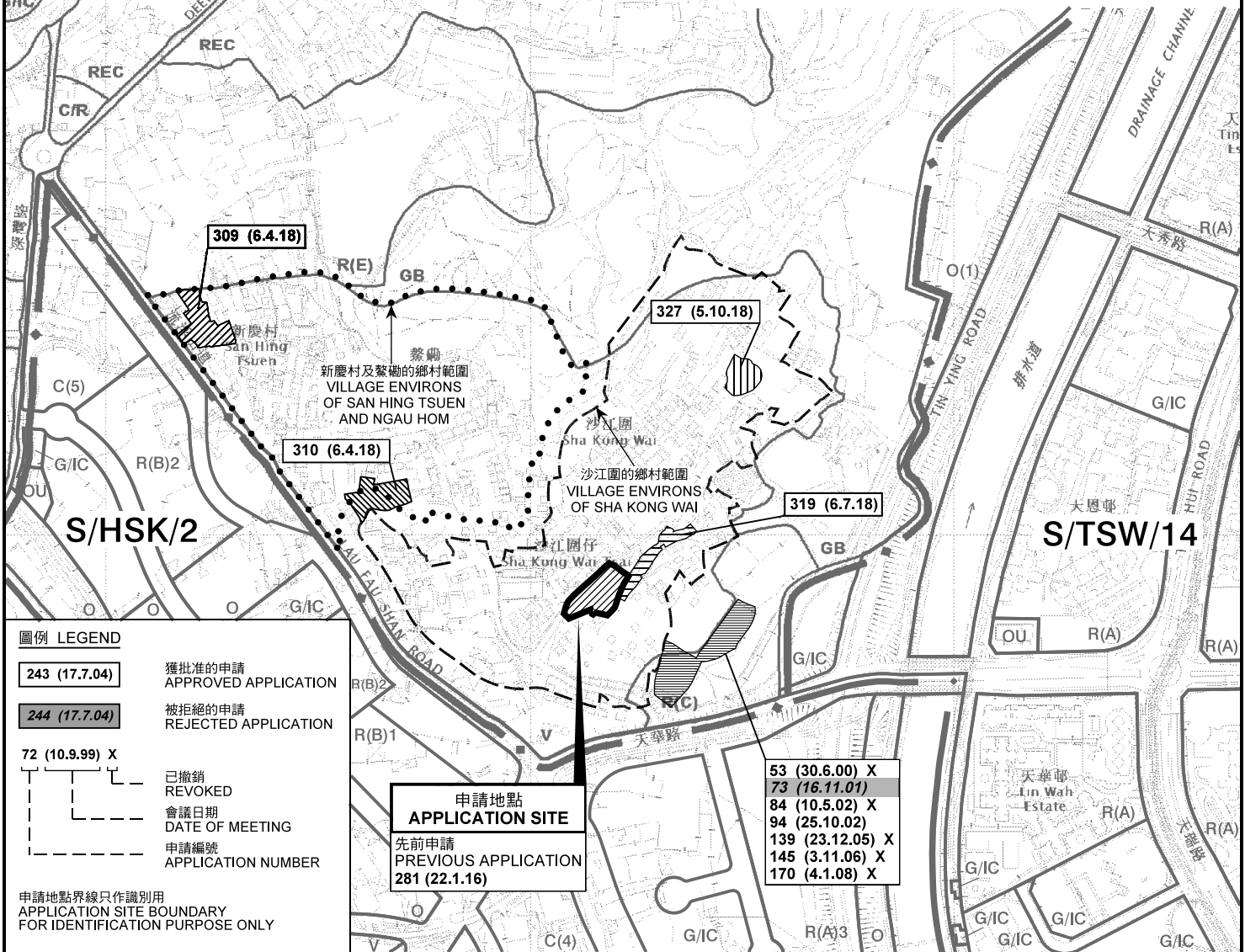

圖例 LEGEND

- 243 (17.7.04) 獲批准的申請
APPROVED APPLICATION
- 244 (17.7.04) 被拒絕的申請
REJECTED APPLICATION
- 72 (10.9.99) X
已撤銷
REVOKED
- 會議日期
DATE OF MEETING
- 申請編號
APPLICATION NUMBER

申請地點界線只作識別用
APPLICATION SITE BOUNDARY
FOR IDENTIFICATION PURPOSE ONLY

位置圖 LOCATION PLAN

臨時私家車及輕型貨車公眾停車場(為期3年)
元朗沙江圍丈量約份第129約地段
第2888號餘段(部分)及第2889號餘段(部分)
TEMPORARY PUBLIC VEHICLE PARK FOR PRIVATE CARS AND
LIGHT GOODS VEHICLES FOR A PERIOD OF 3 YEARS
LOTS 2888 RP (PART) AND 2889 RP (PART)
IN D.D. 129, SHA KONG WAI, YUEN LONG

SCALE 1 : 7 500 比例尺

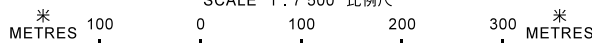

規劃署
PLANNING
DEPARTMENT



參考編號
REFERENCE No.
A/YL-LFS/345

圖 PLAN
A-1

本摘要圖於2019年8月6日擬備，
所根據的資料為於2018年10月16日
核准的分區計劃大綱圖編號 S/YL-LFS/9
EXTRACT PLAN PREPARED ON 6.8.2019
BASED ON OUTLINE ZONING PLAN No.
S/YL-LFS/9 APPROVED ON 16.10.2018

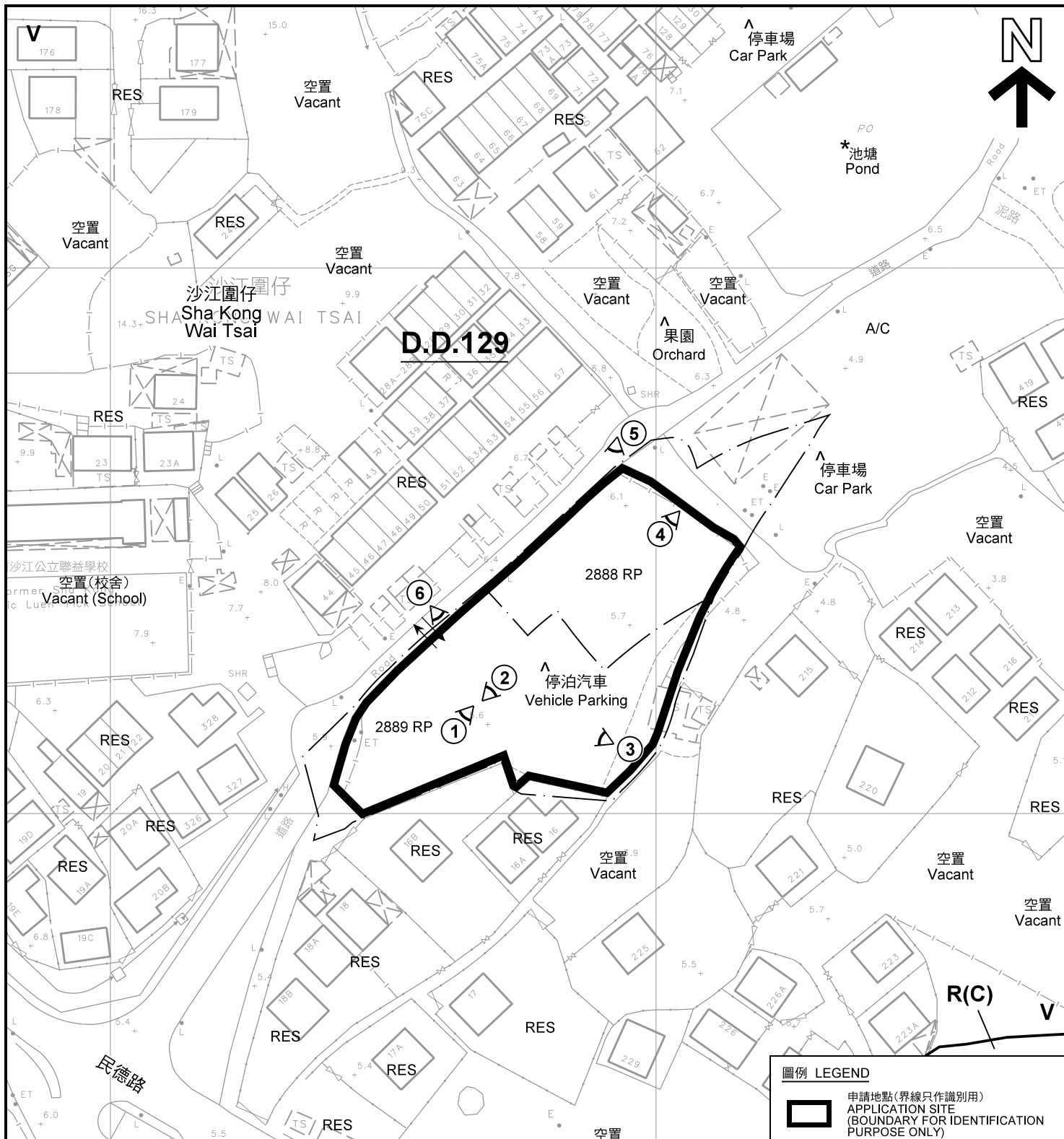

註釋 Notes:

- (1) 2019年7月4日勘測的土地用途
Land uses shown on this plan are in accordance with the land use survey conducted by the Planning Department on 4.7.2019
- (2) * 土地用途跟1992年3月4日勘測的土地用途一致
Indicates that the use is the same as that revealed by the land use survey conducted by the Planning Department on 4.3.1992
- (3) ^ 土地用途跟1992年3月4日勘測的土地用途有別
Indicates that the use is different from that revealed by the land use survey conducted by the Planning Department on 4.3.1992

圖例 LEGEND

- 申請地點(界線只作識別用)
APPLICATION SITE (BOUNDARY FOR IDENTIFICATION PURPOSE ONLY)
- R(C)** 住宅(丙類)
RESIDENTIAL (GROUP C)
- V** 鄉村式發展
VILLAGE TYPE DEVELOPMENT
- RES** 住用構築物
RESIDENTIAL STRUCTURES
- A/C** 常耕地
CULTIVATED AGRICULTURAL LAND
- 實地照片的觀景點
VIEWING POINT OF SITE PHOTO
- 入口/出口
INGRESS / EGRESS

平面圖 SITE PLAN

臨時私家車及輕型貨車公眾停車場(為期3年)
元朗沙江圍丈量約份第129約地段
第2888號餘段(部分)及第2889號餘段(部分)
TEMPORARY PUBLIC VEHICLE PARK FOR PRIVATE CARS AND
LIGHT GOODS VEHICLES FOR A PERIOD OF 3 YEARS
LOTS 2888 RP (PART) AND 2889 RP (PART)
IN D.D. 129, SHA KONG WAI, YUEN LONG

SCALE 1 : 1 000 比例尺

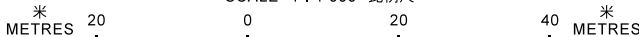

規劃署
**PLANNING
DEPARTMENT**



參考編號
REFERENCE No.
A/YL-LFS/345

圖 **PLAN**
A-2

本摘要圖於2019年8月8日擬備，所根據的資料為測量圖編號 2-SW-22C 和 6-NW-2A
EXTRACT PLAN PREPARED ON 8.8.2019
BASED ON SURVEY SHEETS No. 2-SW-22C & 6-NW-2A



沙江圍
Sha Kong Wai

沙江圍仔
Sha Kong
Wai Tsai



長德路

MAN TAK ROAD

流浮山道

LAU FAU SHAN ROAD

天華路

TIN WAH ROAD

圖例 LEGEND

 申請地點(界線只作識別用)
APPLICATION SITE
(BOUNDARY FOR IDENTIFICATION
PURPOSE ONLY)

本摘要圖於2019年7月23日擬備，所根據的資料為地政總署於2018年1月3日拍得的航攝照片編號 E033179C
EXTRACT PLAN PREPARED ON 23.7.2019
BASED ON AERIAL PHOTO No.
E033179C TAKEN ON 3.1.2018
BY LANDS DEPARTMENT

航攝照片 AERIAL PHOTO

臨時私家車及輕型貨車公眾停車場(為期3年)
元朗沙江圍丈量約份第129約地段
第2888號餘段(部分)及第2889號餘段(部分)
TEMPORARY PUBLIC VEHICLE PARK FOR PRIVATE CARS AND
LIGHT GOODS VEHICLES FOR A PERIOD OF 3 YEARS
LOTS 2888 RP (PART) AND 2889 RP (PART)
IN D.D. 129, SHA KONG WAI, YUEN LONG

規劃署
PLANNING
DEPARTMENT



參考編號
REFERENCE No.
A/YL-LFS/345

圖 PLAN
A-3

1



申請地點
APPLICATION SITE

2



申請地點
APPLICATION SITE

3



申請地點
APPLICATION SITE

實地照片 SITE PHOTO

臨時私家車及輕型貨車公眾停車場(為期3年)
元朗沙江圍丈量約份第129約地段
第2888號餘段(部分)及第2889號餘段(部分)

TEMPORARY PUBLIC VEHICLE PARK FOR PRIVATE CARS AND
LIGHT GOODS VEHICLES FOR A PERIOD OF 3 YEARS
LOTS 2888 RP (PART) AND 2889 RP (PART)
IN D.D. 129, SHA KONG WAI, YUEN LONG

規劃署
PLANNING
DEPARTMENT



參考編號
REFERENCE No.
A/YL-LFS/345

圖 PLAN
A-4a

本圖於2019年8月6日擬備，所根據的資料為攝於2019年7月4日的實地照片
PLAN PREPARED ON 6.8.2019
BASED ON SITE PHOTOS
TAKEN ON 4.7.2019

4



申請地點
APPLICATION SITE

5



申請地點
APPLICATION SITE

6



申請地點
APPLICATION SITE

本圖於2019年8月6日擬備，所根據的資料為攝於2019年7月4日的實地照片
 PLAN PREPARED ON 6.8.2019
 BASED ON SITE PHOTOS
 TAKEN ON 4.7.2019

實地照片 SITE PHOTO

臨時私家車及輕型貨車公眾停車場(為期3年)
 元朗沙江圍丈量約份第129約地段
 第2888號餘段(部分)及第2889號餘段(部分)
 TEMPORARY PUBLIC VEHICLE PARK FOR PRIVATE CARS AND
 LIGHT GOODS VEHICLES FOR A PERIOD OF 3 YEARS
 LOTS 2888 RP (PART) AND 2889 RP (PART)
 IN D.D. 129, SHA KONG WAI, YUEN LONG

規 劃 署
 PLANNING
 DEPARTMENT



參考編號
 REFERENCE No.
 A/YL-LFS/345

圖 PLAN
 A-4b