

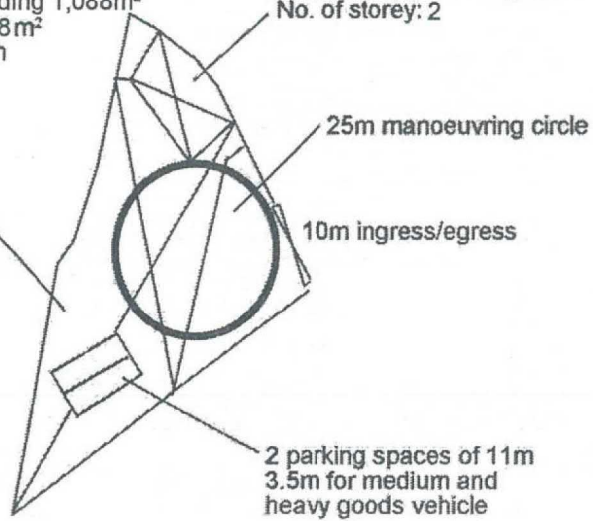

Structure 1
 Open shed for vehicle service centre
 with a site office underneath
 Covered area: Not exceeding 1,088m²
 GFA: Not exceeding 1,228 m²
 Height: Not exceeding 8m
 No. of storey: 1

Site office under the
 open shed
 GFA: Not exceeding 280m²
 (including in the GFA of open shed)
 Height: Not exceeding 6m
 No. of storey: 2



<p>Project 項目名稱: Proposed Temporary Vehicle Service Centre for a Period of 3 Years at Lots 3138RP (Part), 3139 (Part), 3140, 3141 (Part) & 3143 (Part) in D.D. 129, Ha Tsuen, Yuen Long, N.T.</p>	<p>Drawing Title 圖目: Proposed Layout Plan</p>	<p>Remarks 備註:</p>
<p>Drawing No. 圖號: Figure 3</p>	<p>Scale 比例: 1:1000</p>	

(摘錄自申請人於 19.6.2019 提交的申請書)
 (Extract from Applicant's
 Submission of 19.6.2019)

<p>參考編號 REFERENCE No. A/HSK/172</p>	<p>繪圖 DRAWING A-1</p>
---	------------------------------------



Structure 1

Open shed for vehicle service centre with a site office underneath
 Covered area: Not exceeding 1,088m²
 GFA: Not exceeding 1,228m²
 Height: Not exceeding 8m
 No. of storey: 1

Site office under the open shed
 GFA: Not exceeding 280m² (including in the GFA of open shed)
 Height: Not exceeding 6m
 No. of storey: 2

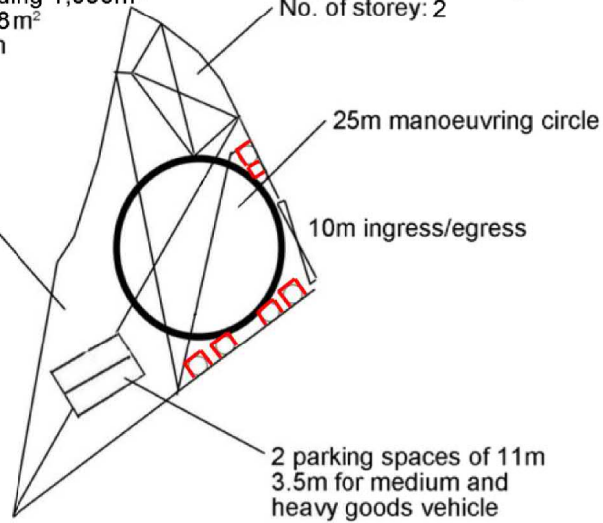

Tree	Approximate Height	Spacing
○ Existing <i>Ficus microcarpa</i>	About 2.75m	3m to 4m

Project 項目名稱:

Proposed Temporary Vehicle Service Centre for a Period of 3 Years at Lots 3138RP (Part), 3139 (Part), 3140, 3141 (Part) & 3143 (Part) in D.D. 129, Ha Tsuen, Yuen Long, N.T.

Drawing Title 圖目:

Proposed Landscape & Tree Preservation Plan

Drawing No. 圖號:

Figure 4

Remarks 備註:

□ 1m (W) x 1m (L) x 1.2m (D) planting area

Scale 比例:

1:1000

(摘錄自申請人於 27. 6. 2019 呈交的補充資料)
 (Extract from Applicant's Supplementary Information Submitted on 27.6.2019)

參考編號
 REFERENCE No.
 A/HSK/172

繪圖 DRAWING
 A-2

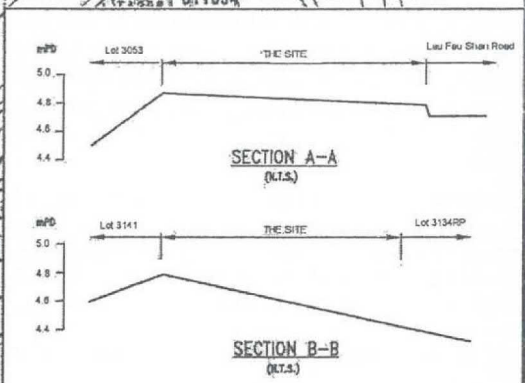
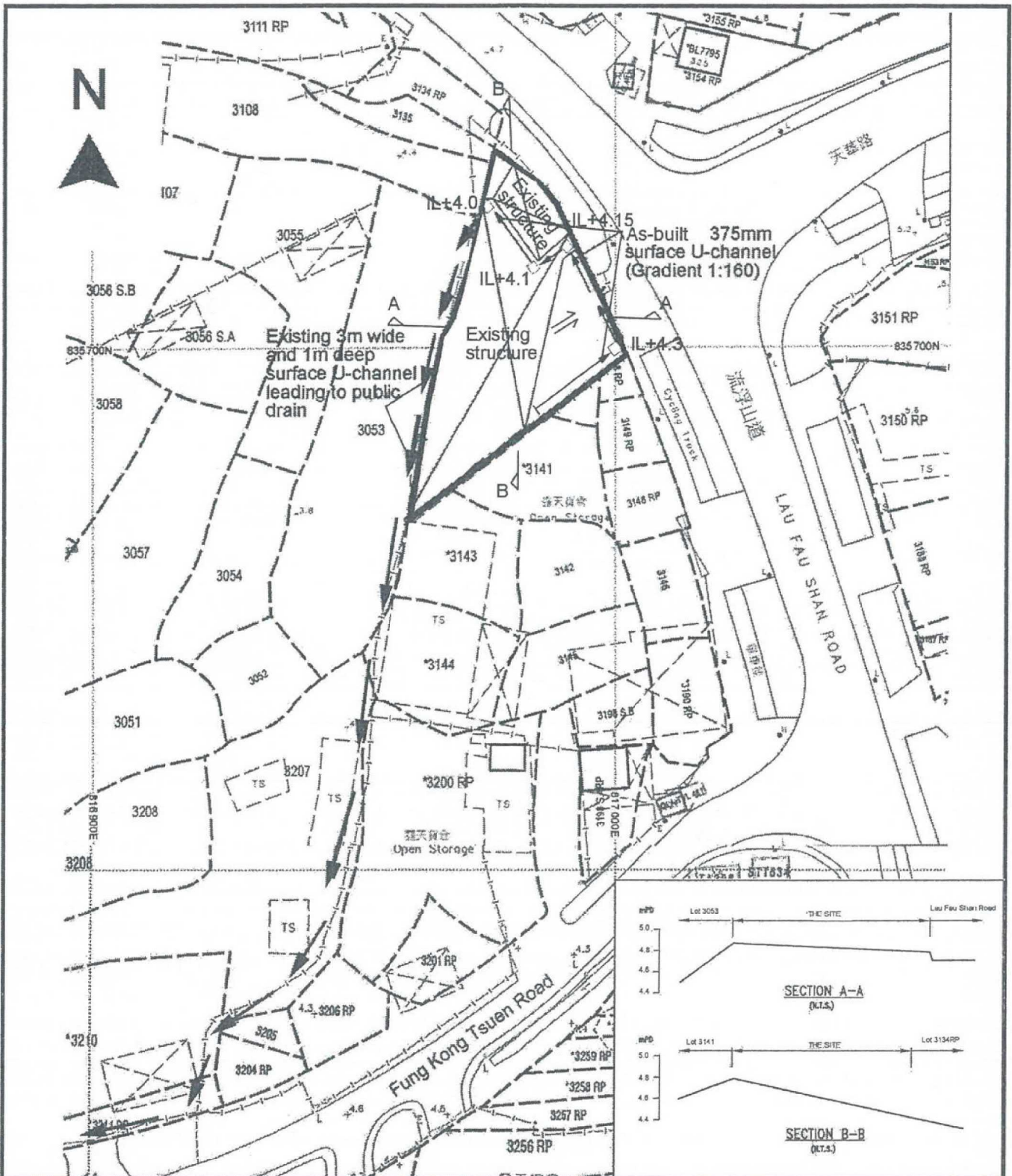

<p>Project 項目名稱: Proposed Temporary Vehicle Service Centre for a Period of 3 Years at Lots 3138RP (Part), 3139 (Part), 3140, 3141 (Part) & 3143 (Part) in D.D. 129, Ha Tsuen, Yuen Long, N.T.</p>	<p>Drawing Title 圖目: As-built Drainage Plan</p>	<p>Remarks 備註:</p>
<p>Drawing No. 圖號: Figure 5</p>	<p>Scale 比例: 1:1000</p>	

(摘錄自申請人於 19. 6. 2019 呈交的申請書)
(Extract from Applicant's Submission of 19.6.2019)

<p>參考編號 REFERENCE No. A/HSK/172</p>	<p>繪圖 DRAWING A-3</p>
---	---------------------------

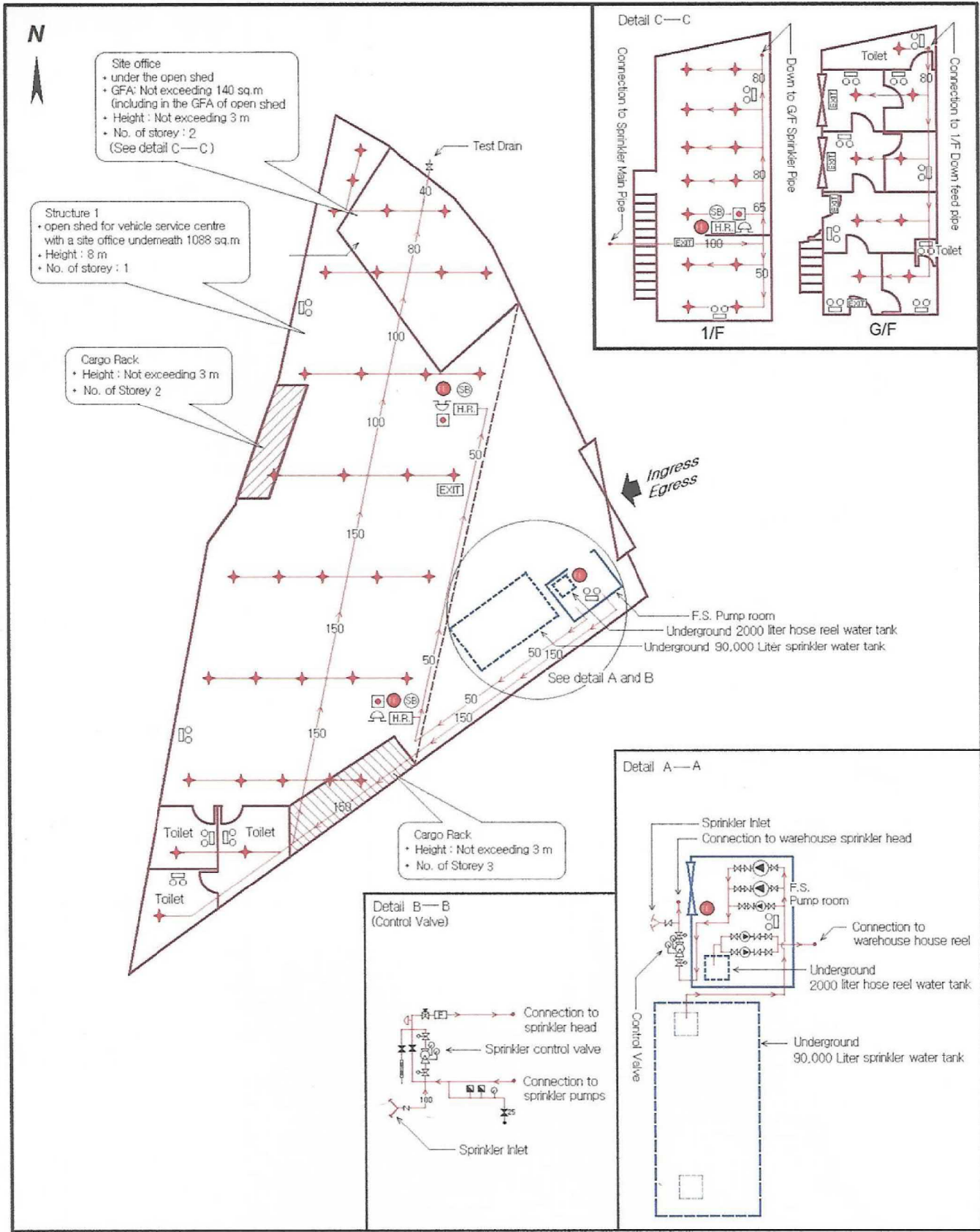

Legend :

[H.R.] Hose reel	— Proving pipe assembly	⊕ Sprinkler INLET	⊕ Control / Alarm valve
⊕ Manual fire alarm call point	⊕ Gate valve (normal close)	⊕ Non Return Valve	⊕ Pressure switch
⊕ Fire alarm bell	⊕ Gate valve (with monitoring)	⊕ Pressure gauge	⊕ Water alarm bell
⊕ 5.0kg Co gas type fire extinguisher	⊕ Subsidiary valve/ Flow switch	⊕ 30 KW Sprinkler Pumps	⊕ 3.3 KW Jockey Pump/ Hose Reel Pumps
EXIT Exit sign	⊕ Emergency light		
⊕ Sand bucket			

Planning Application : A/HSK/172 Application Address: Lots 3138 RP (part), 3139 (part), 3140, 3141 (part), & 3143 (part) in D.D. 129 Ha Tsuen, Yuen'Long, N.T.

Drawing Title: Fire Service Installation Layout Plan Drawing No: YT/2803m/FS Scale: +-400 Drawing By: K.W.Lee Tel: 9080-2250 Date: 24 Mar 2019

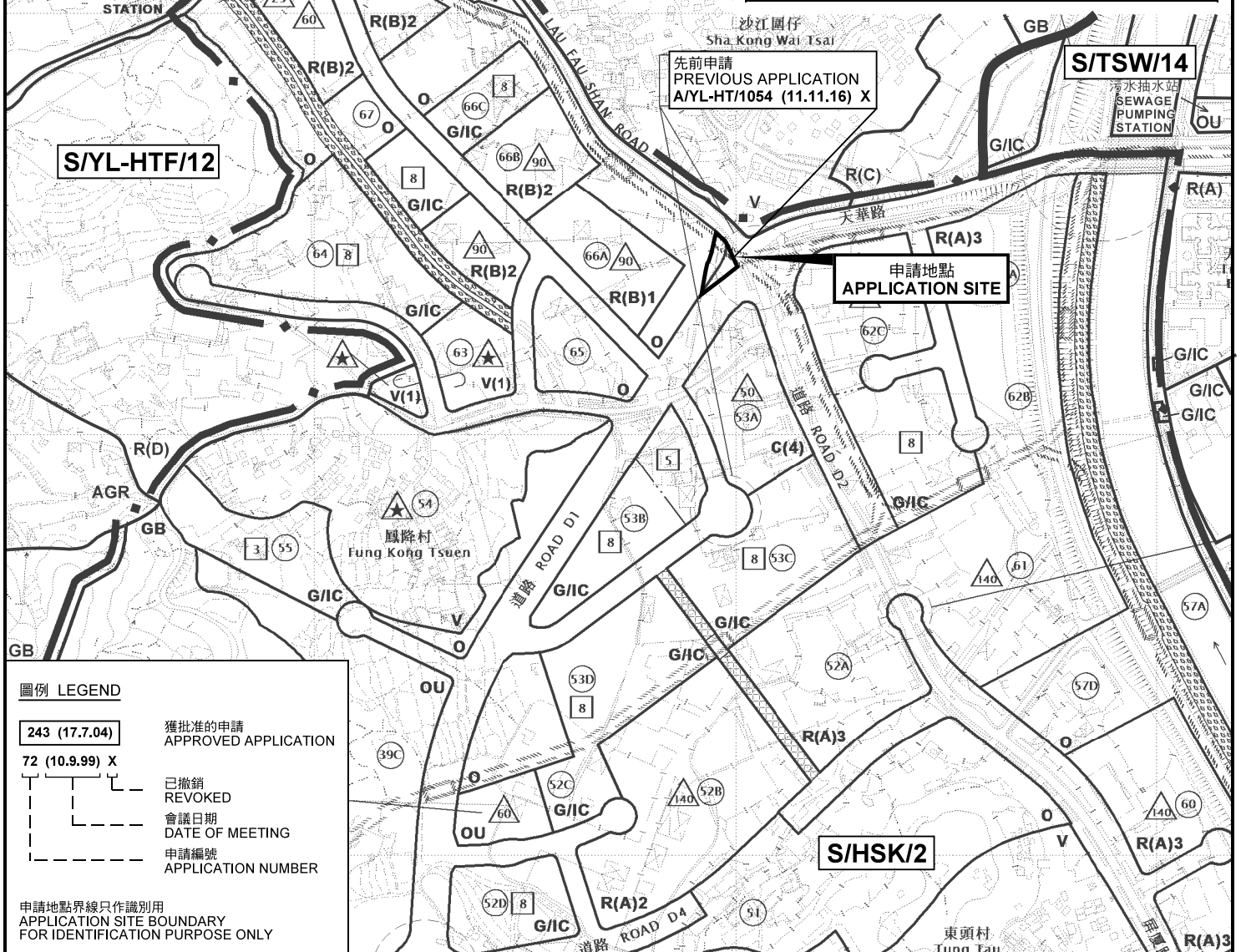

本摘要圖於2019年8月7日擬備，
所根據的資料為於2018年10月16日
核准的分區計劃大綱圖編號 S/HSK/2
EXTRACT PLAN PREPARED ON 7.8.2019
BASED ON OUTLINE ZONING PLAN No.
S/HSK/2 APPROVED ON 16.10.2018

規劃署
PLANNING
DEPARTMENT

參考編號
REFERENCE No.
A/HSK/172

圖 PLAN
A-1

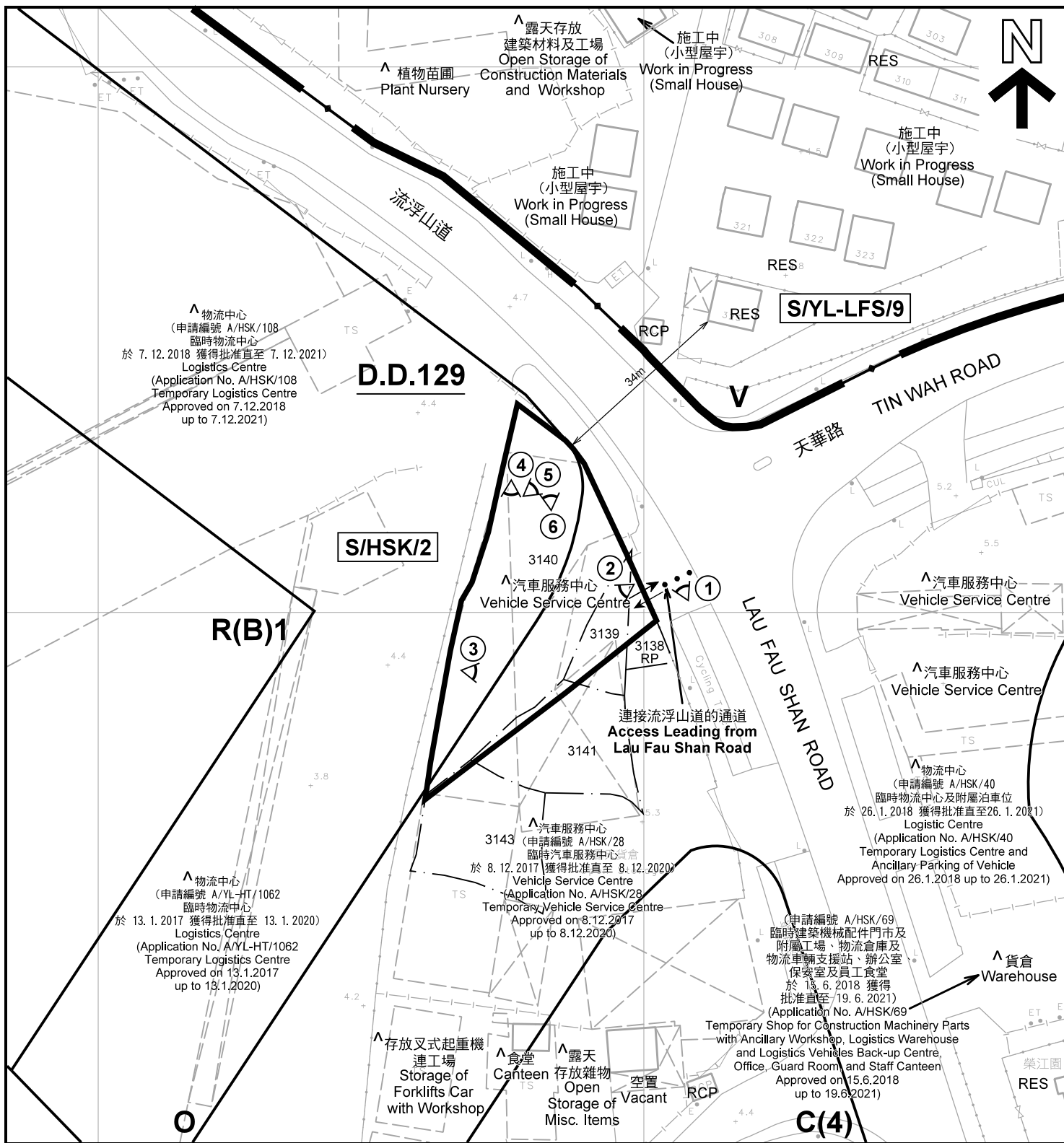

註釋 Notes :

- (1) 2019年7月5日勘測的土地用途
Land uses shown on this plan are in accordance with the land use survey conducted by the Planning Department on 5.7.2019
- (2) * 土地用途跟1992年3月勘測的土地用途一致
Indicates that the use is the same as that revealed by the land use survey conducted by the Planning Department in Mar 1992
- (3) ^ 土地用途跟1992年3月勘測的土地用途有別
Indicates that the use is different from that revealed by the land use survey conducted by the Planning Department in Mar 1992

圖例 LEGEND

- 申請地點(界線只作識別用)
APPLICATION SITE (BOUNDARY FOR IDENTIFICATION PURPOSE ONLY)
- C** 商業
COMMERCIAL
- V** 鄉村式發展
VILLAGE TYPE DEVELOPMENT
- O** 休憩用地
OPEN SPACE

- R(B)** 住宅(乙類)
RESIDENTIAL (GROUP B)
- RES** 住用構築物
RESIDENTIAL STRUCTURES
- RCP** 垃圾收集站
REFUSE COLLECTION POINT
- 實地照片的觀景點
VIEWING POINT OF SITE PHOTO
- 入口/出口
INGRESS / EGRESS

平面圖 SITE PLAN

臨時汽車服務中心 (為期3年)
元朗厦村丈量約份第129約地段第3138號餘段(部分)、
第3139號(部分)、第3140號、第3141號(部分)及第3143號(部分)
TEMPORARY VEHICLE SERVICE CENTRE
FOR A PERIOD OF 3 YEARS
LOTS 3138 RP (PART), 3139 (PART), 3140, 3141 (PART) AND
3143 (PART) IN D.D.129, HA TSUEN, YUEN LONG

SCALE 1 : 1 000 比例尺

米 METRES 20 0 20 40 米 METRES

本摘要圖於2019年8月6日擬備，所根據的資料為測量圖編號 6-NW-2A
EXTRACT PLAN PREPARED ON 6.8.2019
BASED ON SURVEY SHEET No. 6-NW-2A

規劃署
PLANNING
DEPARTMENT



參考編號
REFERENCE No.
A/HSK/172

圖 PLAN
A-2



沙江圍仔
Sha Kong Wai Tsai

流浮山道
LAU FAU SHAN ROAD

連接流浮山道的通道
Access Leading from
Lau Fau Shan Road

天華路
TIN WAH ROAD

LAU FAU SHAN ROAD

屏廈路
PING HA ROAD

鳳降村路
FUNG KONG TSUEN ROAD

圖例 LEGEND

 申請地點(界線只作識別用)
APPLICATION SITE
(BOUNDARY FOR IDENTIFICATION
PURPOSE ONLY)

本摘要圖於2019年8月6日擬備，所根據的資料為地政總署於2019年1月3日拍得的航攝照片編號 E033630C
EXTRACT PLAN PREPARED ON 6.8.2019
BASED ON AERIAL PHOTO No.
E033630C TAKEN ON 3.1.2018
BY LANDS DEPARTMENT

航攝照片 AERIAL PHOTO

臨時汽車服務中心 (為期3年)
元朗厦村丈量約份第129約地段第3138號餘段(部分)、
第3139號(部分)、第3140號、第3141號(部分)及第3143號(部分)
TEMPORARY VEHICLE SERVICE CENTRE
FOR A PERIOD OF 3 YEARS
LOTS 3138 RP (PART), 3139 (PART), 3140, 3141 (PART) AND
3143 (PART) IN D.D.129, HA TSUEN, YUEN LONG

規劃署
PLANNING
DEPARTMENT



參考編號
REFERENCE No.
A/HSK/172

圖 PLAN
A-3

申請地點
APPLICATION SITE



本圖於2019年8月6日擬備，所根據的資料為攝於2019年7月5日的實地照片
PLAN PREPARED ON 6.8.2019
BASED ON SITE PHOTOS
TAKEN ON 5.7.2019

實地照片 SITE PHOTOS

臨時汽車服務中心 (為期3年)
元朗厦村丈量約份第129約地段第3138號餘段(部分)、
第3139號(部分)、第3140號、第3141號(部分)及第3143號(部分)
TEMPORARY VEHICLE SERVICE CENTRE
FOR A PERIOD OF 3 YEARS
LOTS 3138 RP (PART), 3139 (PART), 3140, 3141 (PART) AND
3143 (PART) IN D.D.129, HA TSUEN, YUEN LONG

規劃署
PLANNING
DEPARTMENT



參考編號
REFERENCE No.
A/HSK/172

圖 PLAN
A-4a



本圖於2019年8月6日擬備，所根據的資料為攝於2019年7月5日的實地照片
 PLAN PREPARED ON 6.8.2019
 BASED ON SITE PHOTOS
 TAKEN ON 5.7.2019

實地照片 SITE PHOTOS

臨時汽車服務中心 (為期3年)
 元朗厦村丈量約份第129約地段第3138號餘段(部分)、
 第3139號(部分)、第3140號、第3141號(部分)及第3143號(部分)
 TEMPORARY VEHICLE SERVICE CENTRE
 FOR A PERIOD OF 3 YEARS
 LOTS 3138 RP (PART), 3139 (PART), 3140, 3141 (PART) AND
 3143 (PART) IN D.D.129, HA TSUEN, YUEN LONG

規劃署
 PLANNING
 DEPARTMENT



參考編號
 REFERENCE No.
 A/HSK/172

圖 PLAN
 A-4b