

Proposed NTEH at Part of Lot 2447 S.D RP in DD130

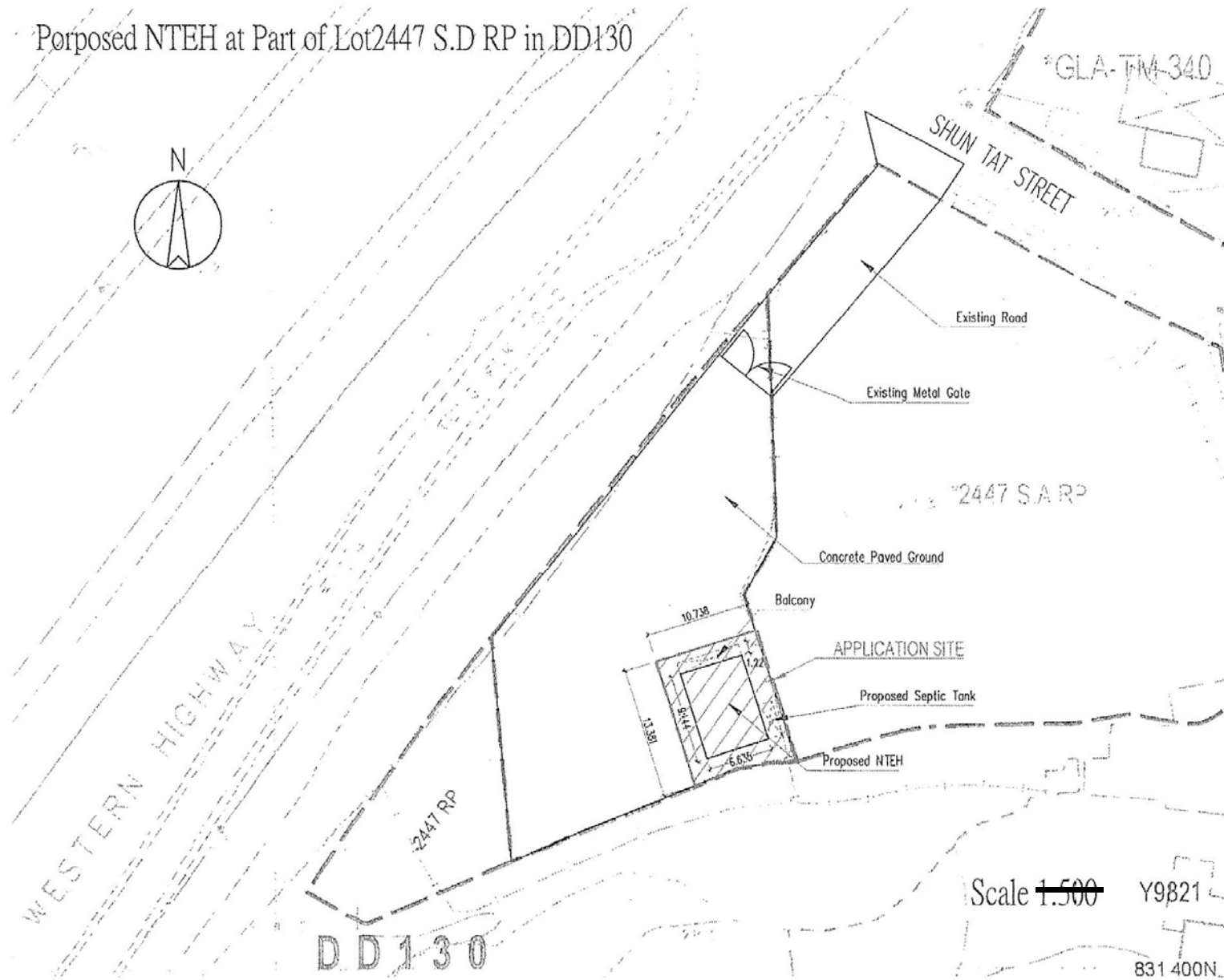

參考編號 REFERENCE No. A/TM-LTY/348	繪圖 DRAWING A-1
------------------------------------	-------------------

(摘錄自申請人於28. 2. 2018呈交的申請書)
(Extract from Applicant's
Submission Dated 28.2.2018)

Vehicular Access from Castle Road (Hung Shui Kiu) to Application Site

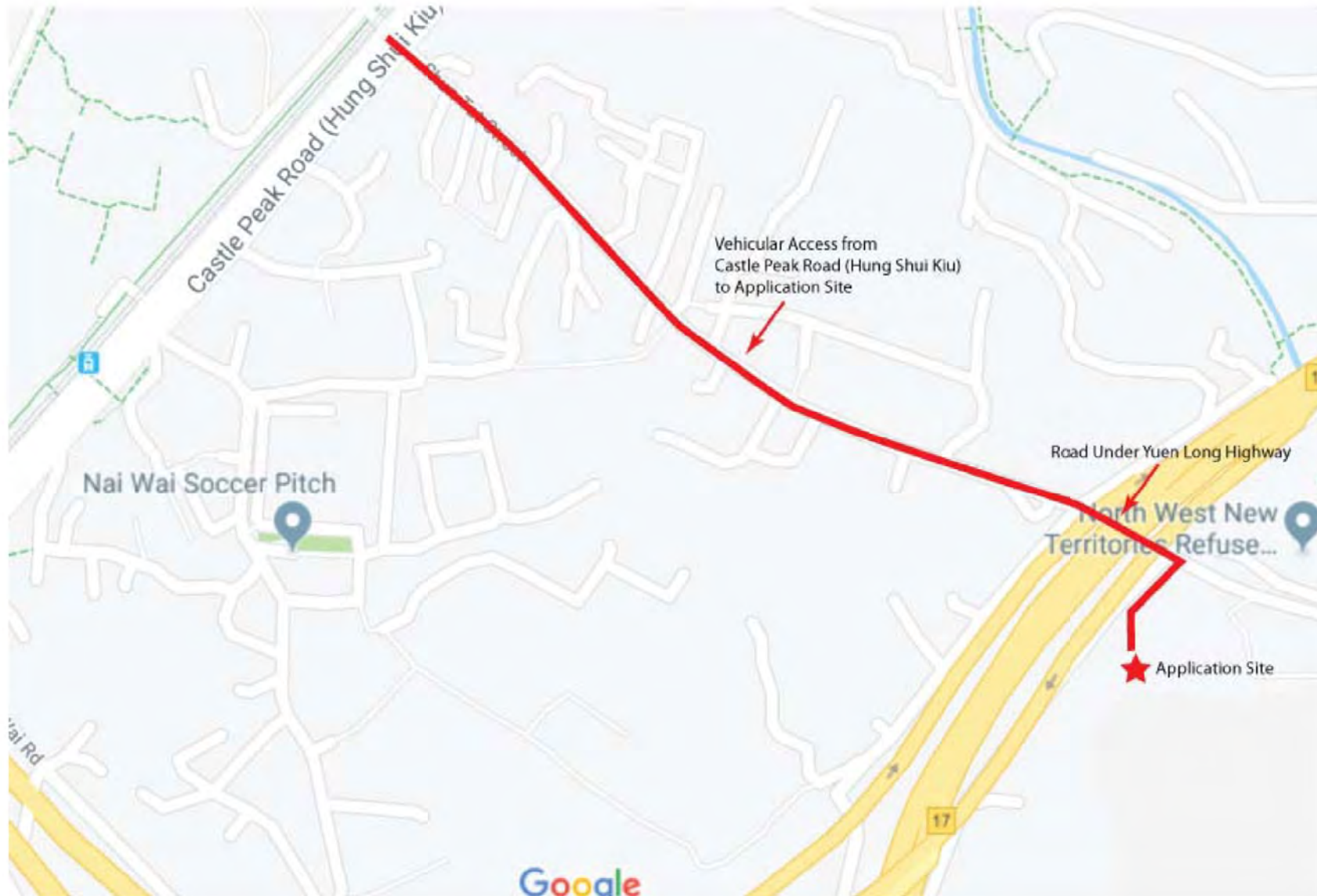

參考編號 REFERENCE No. A/TM-LTY/348	繪圖 DRAWING A-2
------------------------------------	-------------------

(摘錄自申請人於29. 3. 2018呈交的申請書)
(Extract from Applicant's
Submission Dated 29.3.2018)

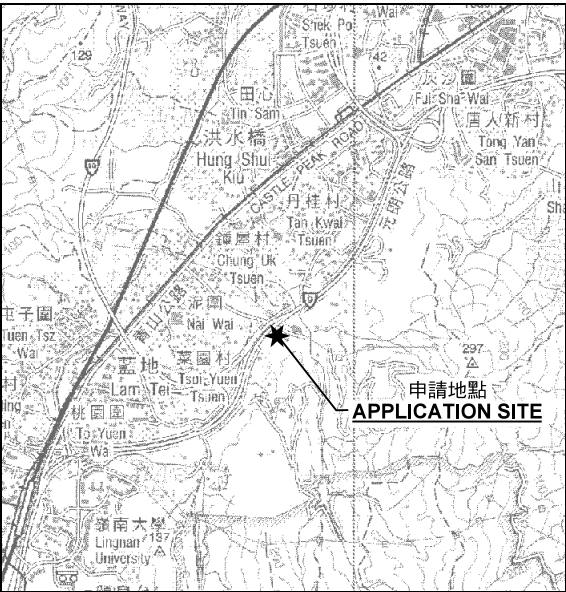
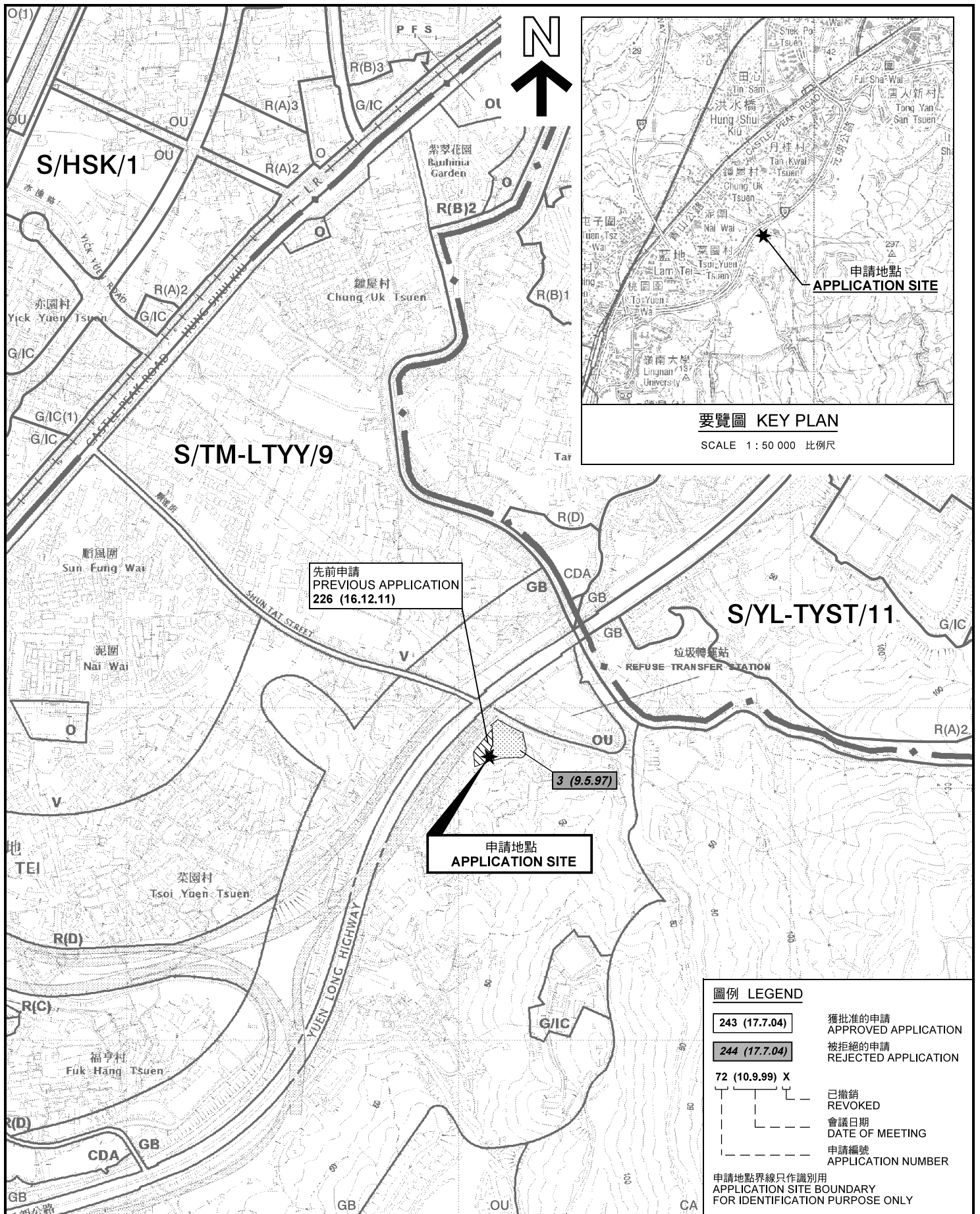

要覽圖 KEY PLAN

SCALE 1 : 50 000 比例尺

圖例 LEGEND

- 243 (17.7.04) 獲批准的申請
APPROVED APPLICATION
- 244 (17.7.04) 被拒絕的申請
REJECTED APPLICATION
- 72 (10.9.99) X
已撤銷
REVOKED
- 會議日期
DATE OF MEETING
- 申請編號
APPLICATION NUMBER

申請地點界線只作識別用
APPLICATION SITE BOUNDARY
FOR IDENTIFICATION PURPOSE ONLY

位置圖 LOCATION PLAN

擬議屋宇(新界豁免管制屋宇)
新界屯門丈量約份第130約
地段第2447號D分段餘段(部分)
PROPOSED HOUSE (NEW TERRITORIES EXEMPTED HOUSE)
LOT 2447 S.D RP (PART) IN D.D. 130,
TUEN MUN, NEW TERRITORIES

SCALE 1 : 7 500 比例尺

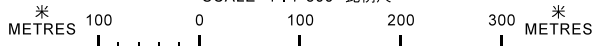

本摘要圖於2018年4月6日擬備，
所根據的資料為於2017年5月26日
展示的分區計劃大綱圖編號 S/TM-LTY/9
EXTRACT PLAN PREPARED ON 6.4.2018
BASED ON OUTLINE ZONING PLAN No.
S/TM-LTY/9 EXHIBITED ON 26.5.2017

規劃署
PLANNING
DEPARTMENT



參考編號
REFERENCE No.
A/TM-LTY/348

圖 PLAN
A-1

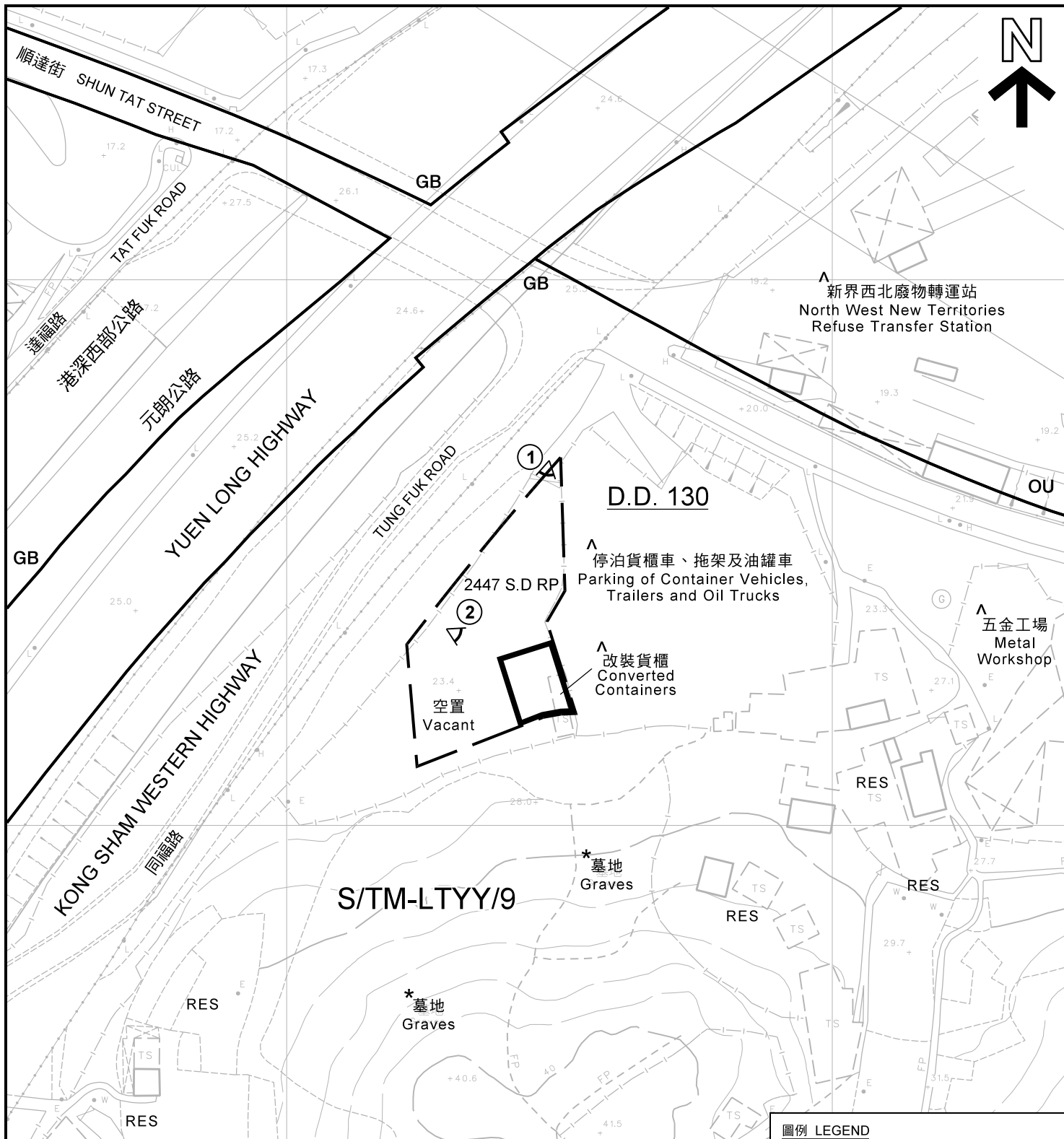

- 註釋 Notes:
- (1) 2018年3月15日勘測的土地用途
Land uses shown on this plan are in accordance with the land use survey conducted by the Planning Department on 15.3.2018
 - (2) * 土地用途跟1993年7月9日勘測的土地用途一致
Indicates that the use is the same as that revealed by the land use survey conducted by the Planning Department on 9.7.1993
 - (3) ^ 土地用途跟1993年7月9日勘測的土地用途有別
Indicates that the use is different from that revealed by the land use survey conducted by the Planning Department on 9.7.1993

圖例 LEGEND	
	申請地點(界線只作識別用) APPLICATION SITE (BOUNDARY FOR IDENTIFICATION PURPOSE ONLY)
OU	其他指定用途 OTHER SPECIFIED USES
GB	綠化地帶 GREEN BELT
RES	住用構築物 RESIDENTIAL STRUCTURES
	實地照片的觀景點 VIEWING POINT OF SITE PHOTO

本摘要圖於2018年4月12日擬備，所根據的資料為測量圖編號 6-NW-17D
EXTRACT PLAN PREPARED ON 12.4.2018
BASED ON SURVEY SHEETS No.
6-NW-17D

平面圖 SITE PLAN

擬議屋宇(新界豁免管制屋宇)
新界屯門丈量約份第130約
地段第2447號D分段餘段(部分)
PROPOSED HOUSE (NEW TERRITORIES EXEMPTED HOUSE)
LOT 2447 S.D RP (PART) IN D.D. 130,
TUEN MUN, NEW TERRITORIES

SCALE 1 : 1 000 比例尺

米 METRES 20 0 20 40 米 METRES

規 劃 署
PLANNING
DEPARTMENT

參考編號 REFERENCE No. A/TM-LTYYY/348	圖 PLAN A-2
---	---------------



和平新村
WO PING
SAN TSUEN

丹桂村
TAN KWAI
TSUEN

元朗公路

順達街

SHUN TAT STREET

新界西北廢物轉運站
North West New Territories
Refuse Transfer Station

港深西部公路

YUEN LONG HIGHWAY
KONG SHAM WESTERN HIGHWAY

元朗食水配水庫
Yuen Long Fresh Water
Service Reservoir

圖例 LEGEND



申請地點(界線只作識別用)
APPLICATION SITE
(BOUNDARY FOR IDENTIFICATION
PURPOSE ONLY)

本摘要圖於2018年4月4日擬備，所根據的資料為地政總署於2017年4月2日拍得的航攝照片編號E017075C
EXTRACT PLAN PREPARED ON 4.4.2018
BASED ON AERIAL PHOTO No.
E017075C TAKEN ON 2.4.2017
BY LANDS DEPARTMENT

航攝照片 AERIAL PHOTO

擬議屋宇(新界豁免管制屋宇)
新界屯門丈量約份第130約
地段第2447號D分段餘段(部分)
PROPOSED HOUSE (NEW TERRITORIES EXEMPTED HOUSE)
LOT 2447 S.D RP (PART) IN D.D. 130,
TUEN MUN, NEW TERRITORIES

規劃署
PLANNING
DEPARTMENT



參考編號
REFERENCE No.
A/TM-LTYT/348

圖 PLAN
A-3



申請地點界線只作識別用
APPLICATION SITE BOUNDARY FOR IDENTIFICATION PURPOSE ONLY

實地照片 SITE PHOTO

本圖於2018年4月4日擬備，所根據的資料為攝於2018年3月15日的實地照片
PLAN PREPARED ON 4.4.2018
BASED ON SITE PHOTOS
TAKEN ON 15.3.2018

擬議屋宇(新界豁免管制屋宇)
新界屯門丈量約份第130約
地段第2447號D分段餘段(部分)
PROPOSED HOUSE (NEW TERRITORIES EXEMPTED HOUSE)
LOT 2447 S.D RP (PART) IN D.D. 130,
TUEN MUN, NEW TERRITORIES

規劃署
PLANNING
DEPARTMENT



參考編號
REFERENCE No.
A/TM-LTYT/348

圖 PLAN
A-4