

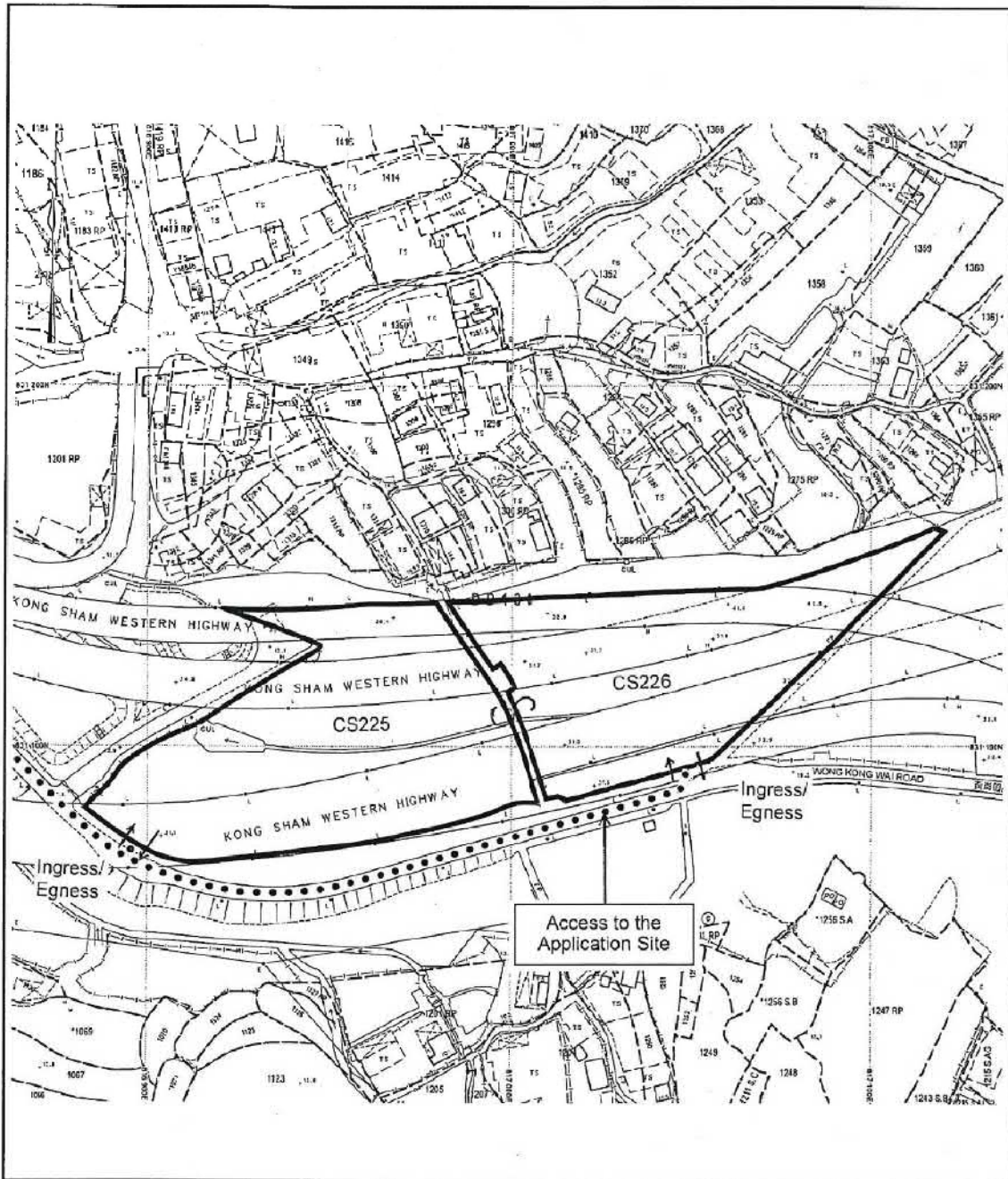

**Plan 2 (Site Plan)**



<p><b>Legend</b></p> <p> The Application Site</p> <p>Base Plan Extracted from Lot Index Plan No. ags_S000009873_0001 Reference No. 6-NW-22A &amp; 6-NW-17C, Prepared by the District Survey Land Information Centre on 18.12.2018</p>	<p style="text-align: center;"><b>Site Plan</b></p> <p style="text-align: center;">Proposed Training Ground for The Hong Kong Institute of Construction, Construction Industry Council, Lam Tei, Tuen Mun</p> <p style="text-align: center;">0 10 20 30 40 50 METRES</p>	<p style="text-align: center;"><b>Plan 2</b></p> <hr/> <p style="text-align: center;"><b>PlanArch Consultants Ltd.</b></p> <hr/> <p>Revision:                      Date: 20.10.2019</p>
--	--	---

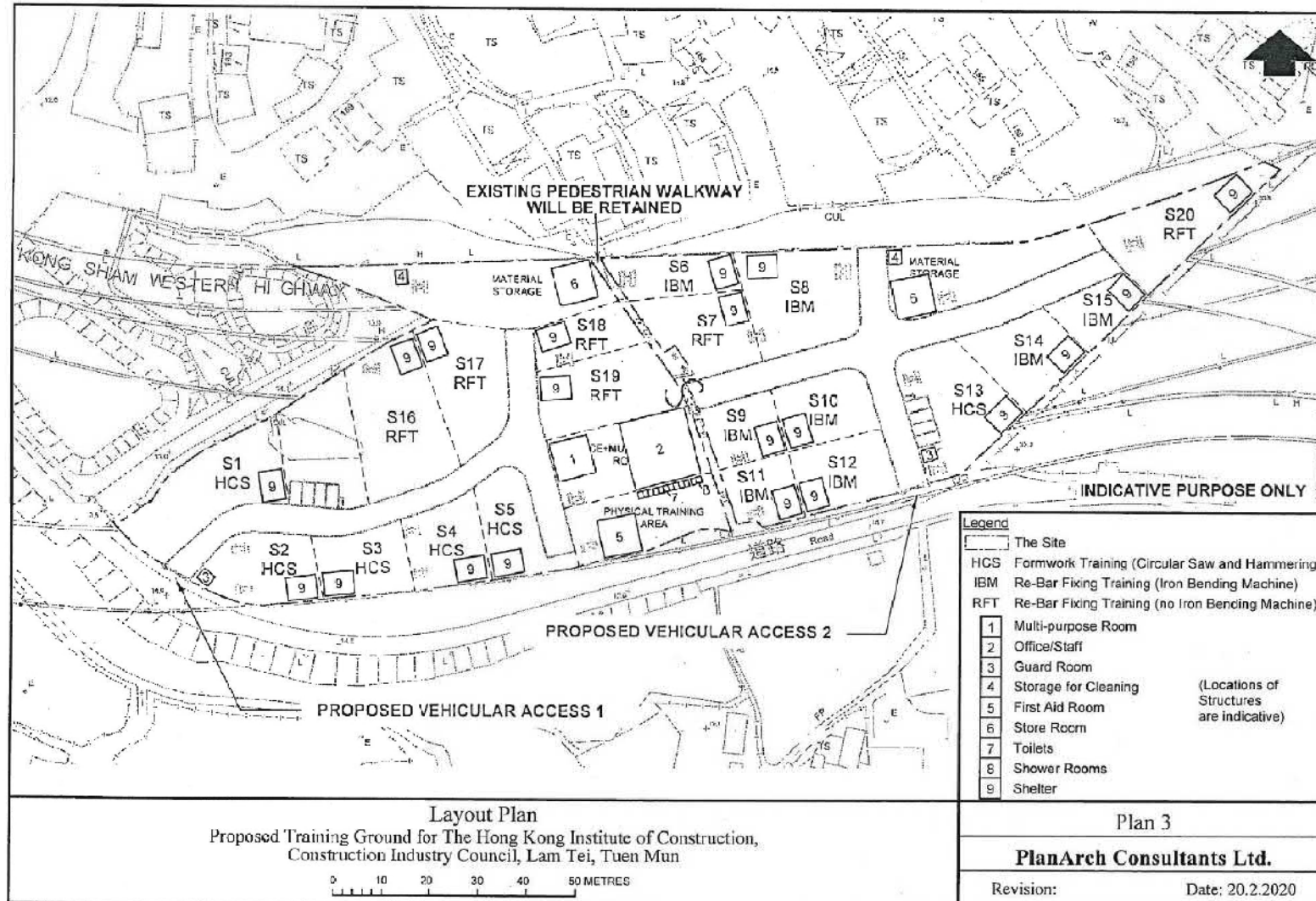

**Layout Plan**  
 Proposed Training Ground for The Hong Kong Institute of Construction,  
 Construction Industry Council, Lam Tei, Tuen Mun

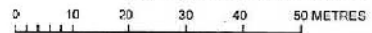

Legend	
	The Site
HCS	Formwork Training (Circular Saw and Hammering)
IBM	Re-Bar Fixing Training (Iron Bending Machine)
RFT	Re-Bar Fixing Training (no Iron Bending Machine)
	Multi-purpose Room
	Office/Staff
	Guard Room
	Storage for Cleaning
	First Aid Room
	Store Room
	Toilets
	Shower Rooms
	Shelter

(Locations of Structures are indicative)

Plan 3	
<b>PlanArch Consultants Ltd.</b>	
Revision:	Date: 20.2.2020

**Plan 3 (Layout Plan)**

Proposed Training Ground for the Hong Kong Institute of Construction, Construction Industry Council,  
 for a Period of 3 Years at Government Land Reference No. CS-225 (Part) and CS-226 (Part),  
 Lam Tei, Tuen Mun

PlanArch Consultants Ltd.

參考編號 REFERENCE No. A/TM-LTY/398	繪圖 DRAWING A-2
------------------------------------	-------------------

(摘錄自申請人於20.3.2020呈交的申請書)  
 (Extract from Applicant's  
 Submission Dated 20.3.2020)

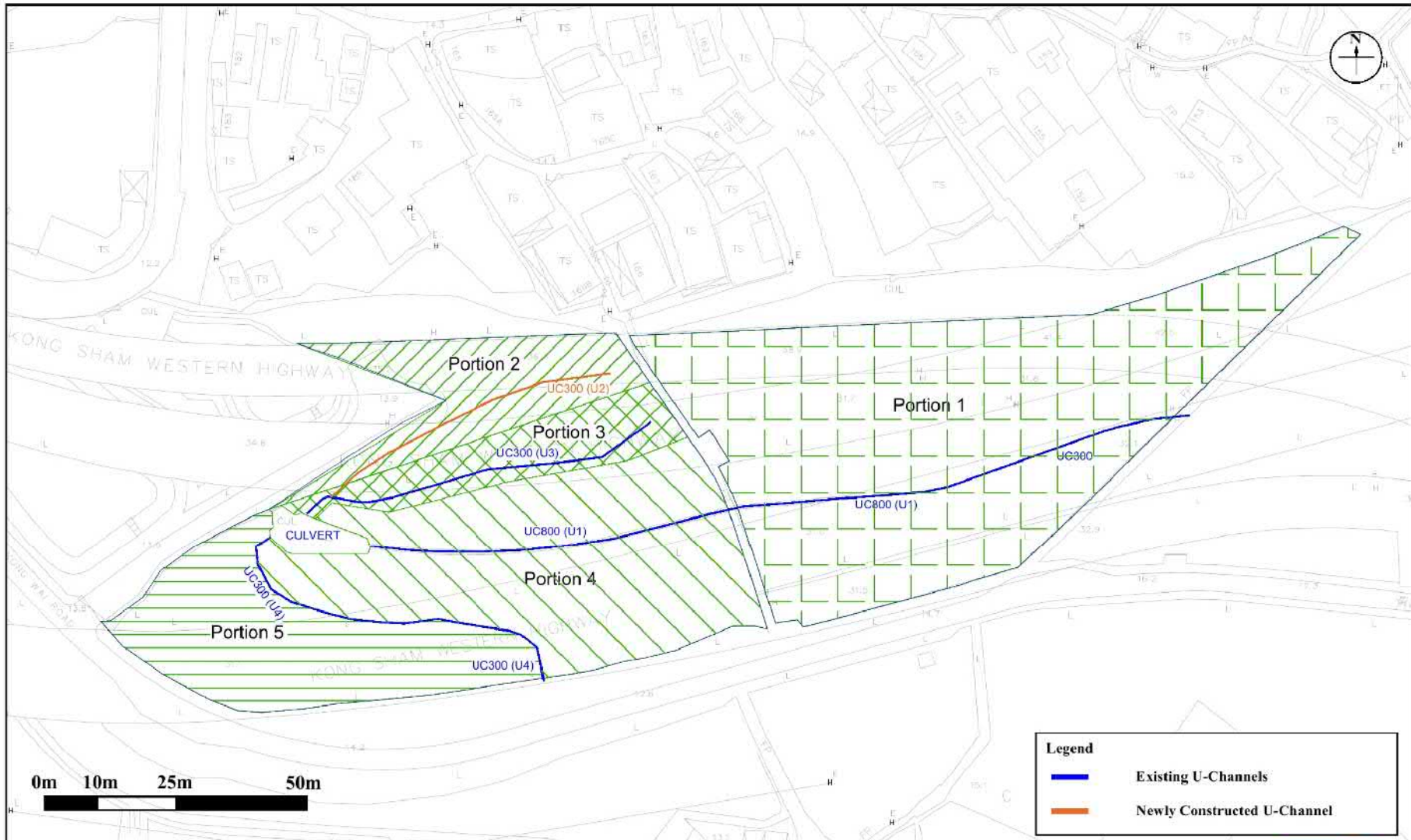

<b>Figure:</b> 3	<b>RAMBOLL</b>
<b>Title:</b> Existing and Newly Constructed Drainage Facilities and Catchment Areas in the Vicinity of the Application Site	Drawn by: MW
<b>Project:</b> Feasibility Study of Establish a Training Ground in Lam Tei, for the Hong Kong Institute of Construction, Construction Industry Council	Checked by: BF
	Rev.: 1.0
	Date: Nov 2019

Q:\Projects\PACLTCICEI00\04 Deliverables\03 DIA\01 Figures\R6981\_V1.0\Fig 3 Catchment.dwg

參考編號 REFERENCE No. A/TM-LTYT/398	繪圖 DRAWING A-3
-------------------------------------	-------------------

(摘錄自申請人於20. 3. 2020呈交的申請書)  
(Extract from Applicant's  
Submission Dated 20.3.2020)

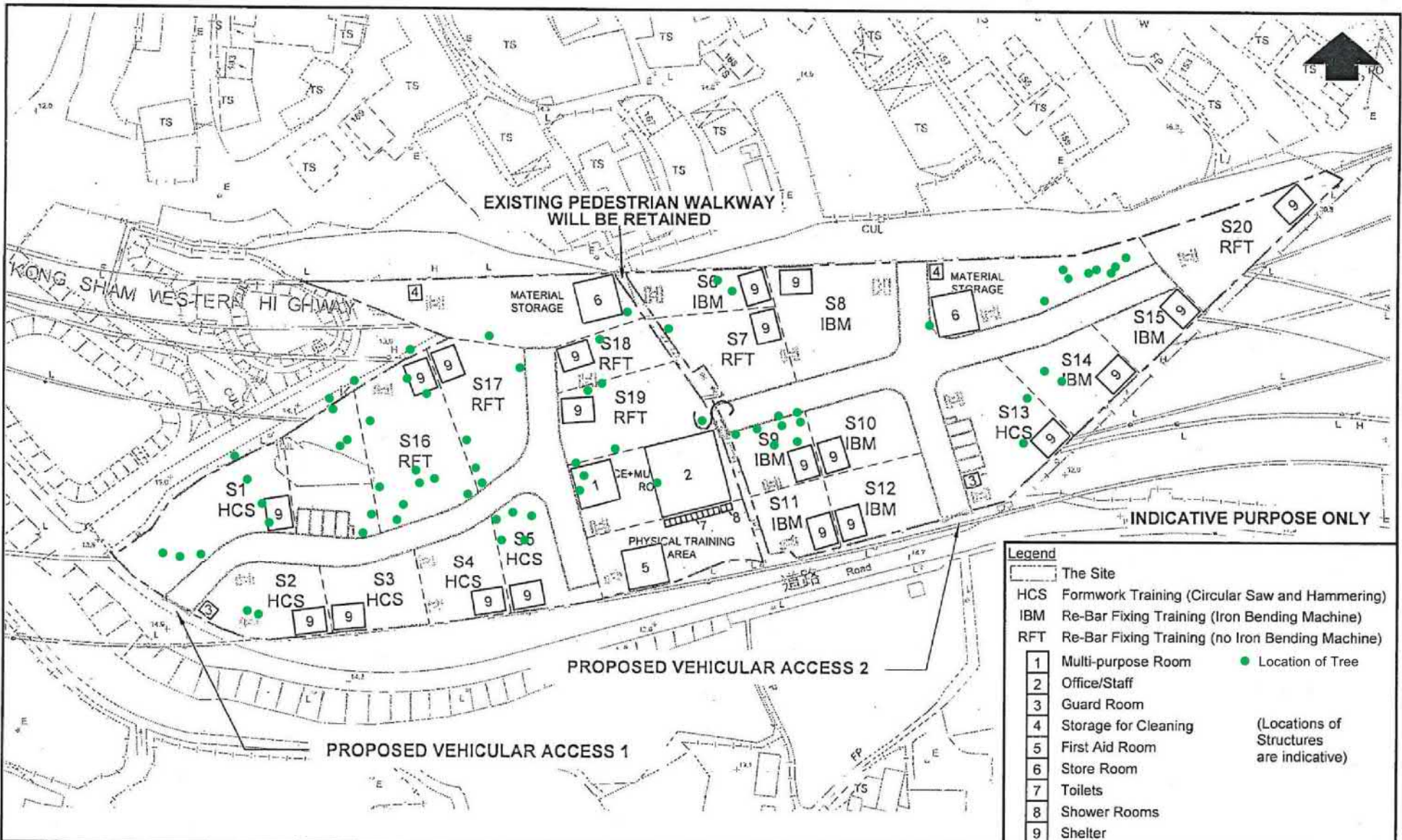

INDICATIVE PURPOSE ONLY

Legend	
	The Site
HCS	Formwork Training (Circular Saw and Hammering)
IBM	Re-Bar Fixing Training (Iron Bending Machine)
RFT	Re-Bar Fixing Training (no Iron Bending Machine)
	Multi-purpose Room
	Office/Staff
	Guard Room
	Storage for Cleaning
	First Aid Room
	Store Room
	Toilets
	Shower Rooms
	Shelter
	Location of Tree
	(Locations of Structures are indicative)

Location of Existing Trees  
 Proposed Training Ground for The Hong Kong Institute of Construction,  
 Construction Industry Council, Lam Tei, Tuen Mun

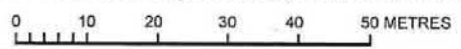

**PlanArch Consultants Ltd.**

Revision: \_\_\_\_\_ Date: 20.2.2020

參考編號 REFERENCE No. A/TM-LTY/398	繪圖 DRAWING A-4
------------------------------------	-------------------

(摘錄自申請人於29. 4. 2020呈交的申請書)  
 (Extract from Applicant's  
 Submission Dated 29.4.2020)



**LEGEND:**  
 ← P1 → SURVEYED FOOTPATH  
 — PEDESTRIAN ROUTING

PROJECT NO.	40624
DESIGNED	BSL
DRAWN	CLL
CHECKED	SLN
DATE	APR 2020
SCALE	1:5000

PROJECT TITLE: PROPOSED TRAINING GROUND FOR THE HONG KONG INSTITUTE OF CONSTRUCTION, CONSTRUCTION INDUSTRY COUNCIL, LAM TEI, TUEN MUN

DRAWING NO.	FIGURE R1
REV.	.

**PEDESTRIAN ROUTINGS TO CASTLE PEAK ROAD**

**LLA** 顧問有限公司  
 Consultancy Limited

參考編號 REFERENCE No. 繪圖 DRAWING  
 A/TM-LTY/398 A-5

(摘錄自申請人於29. 4. 2020呈交的申請書)  
 (Extract from Applicant's  
 Submission Dated 29.4.2020)

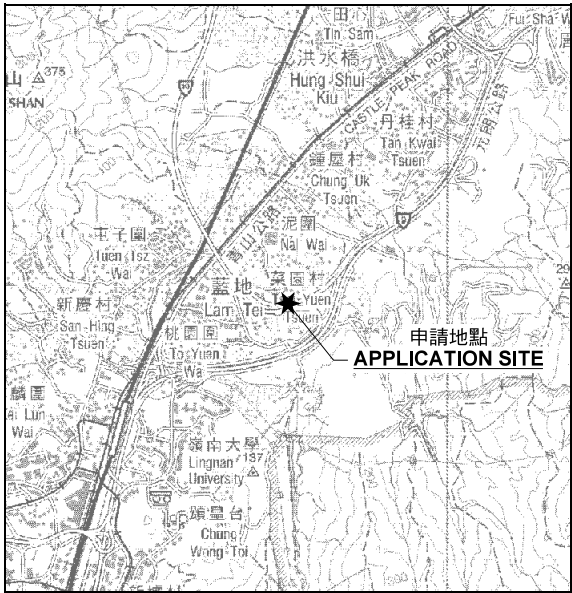
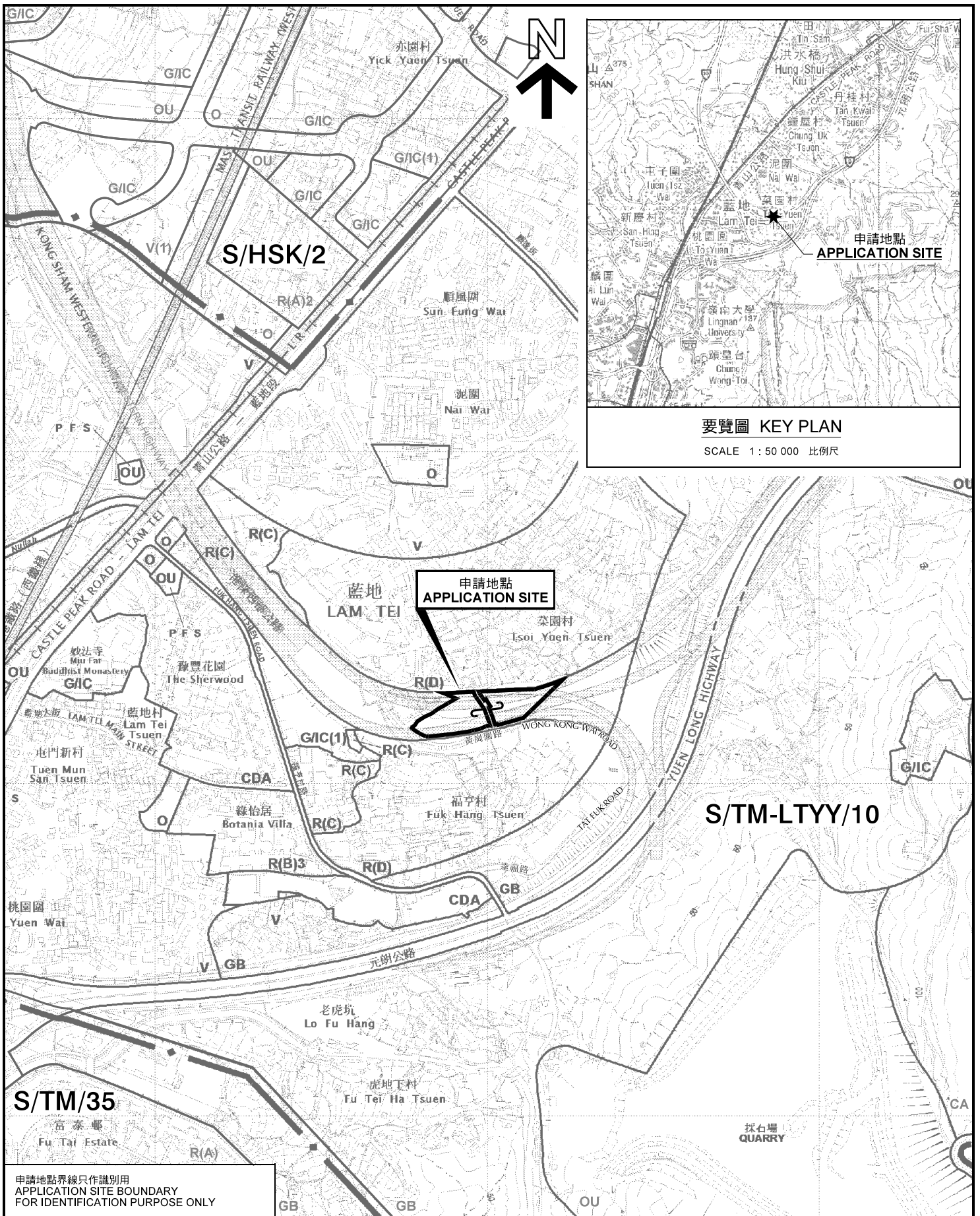

要覽圖 KEY PLAN

SCALE 1 : 50 000 比例尺

申請地點界線只作識別用  
APPLICATION SITE BOUNDARY  
FOR IDENTIFICATION PURPOSE ONLY

本摘要圖於2020年4月1日擬備，  
所根據的資料為於2018年10月16日  
核准的分區計劃大綱圖編號 S/TM-LTTY/10  
EXTRACT PLAN PREPARED ON 1.4.2020  
BASED ON OUTLINE ZONING PLAN No.  
S/TM-LTTY/10 APPROVED ON 16.10.2018

位置圖 LOCATION PLAN

擬議臨時訓練場(建造業議會香港建造學院)(為期3年)  
新界屯門藍地港深西部通道下的政府土地(黃崗圍路旁近福亨村)  
PROPOSED TEMPORARY TRAINING GROUND (HONG KONG  
INSTITUTE OF CONSTRUCTION, CONSTRUCTION INDUSTRY COUNCIL)  
FOR A PERIOD OF 3 YEARS  
GOVERNMENT LAND UNDER KONG SHAM WESTERN HIGHWAY  
(NEXT TO WONG KONG WAI ROAD NEAR FUK HANG TSUEN),  
LAM TEI, TUEN MUN, NEW TERRITORIES

SCALE 1 : 7 500 比例尺

米 100 0 100 200 300 米  
METRES METRES

規劃署  
PLANNING  
DEPARTMENT



參考編號  
REFERENCE No.  
A/TM-LTTY/398

圖 PLAN  
A-1

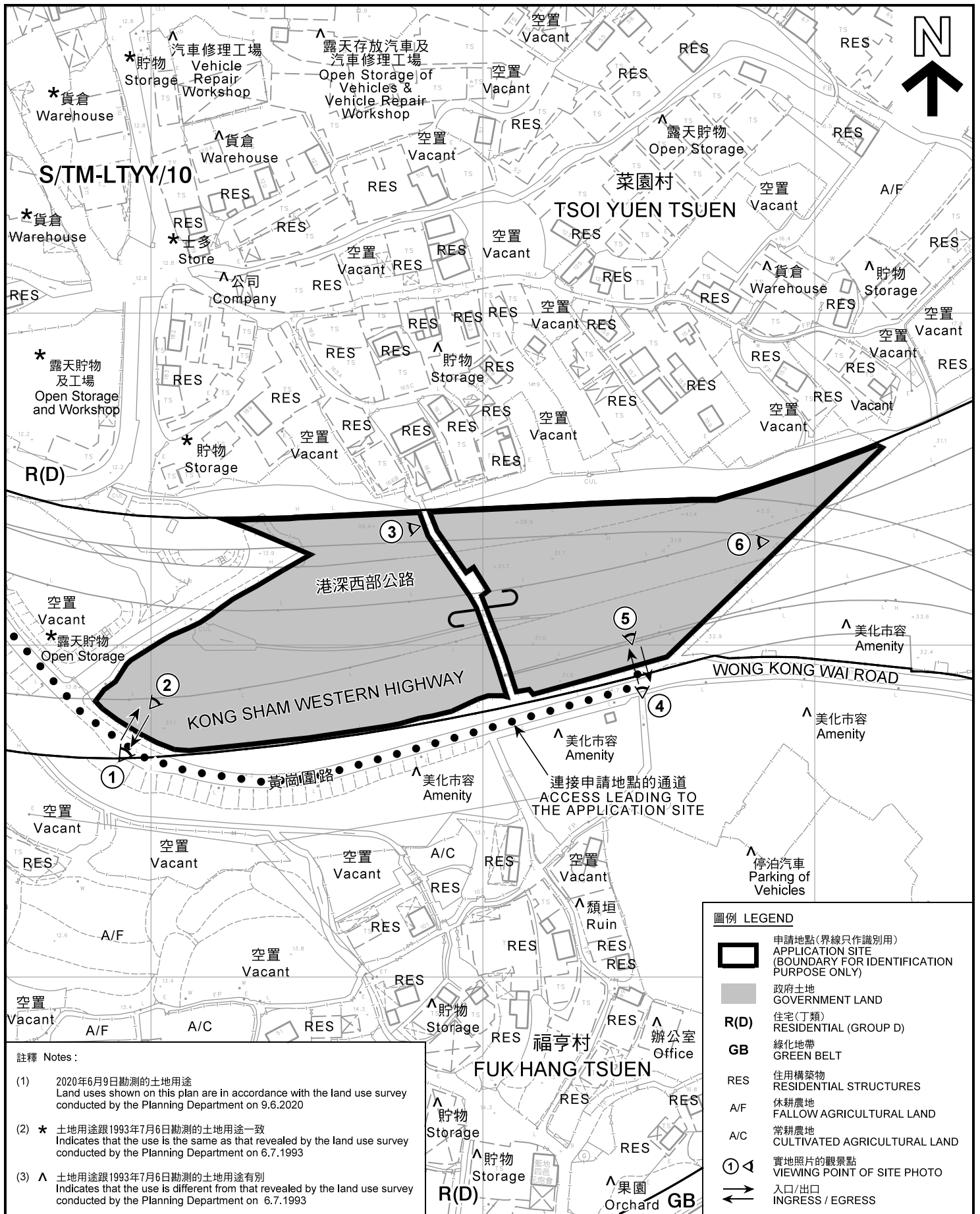

註釋 Notes:

- (1) 2020年6月9日勘測的土地用途  
Land uses shown on this plan are in accordance with the land use survey conducted by the Planning Department on 9.6.2020
- (2) \* 土地用途跟1993年7月6日勘測的土地用途一致  
Indicates that the use is the same as that revealed by the land use survey conducted by the Planning Department on 6.7.1993
- (3) ^ 土地用途跟1993年7月6日勘測的土地用途有別  
Indicates that the use is different from that revealed by the land use survey conducted by the Planning Department on 6.7.1993

平面圖 SITE PLAN

擬議臨時訓練場(建造業議會香港建造學院)(為期3年)  
 新界屯門藍地港深西部通道下的政府土地(黃崗圍路旁近福亨村)  
 PROPOSED TEMPORARY TRAINING GROUND (HONG KONG INSTITUTE OF CONSTRUCTION, CONSTRUCTION INDUSTRY COUNCIL) FOR A PERIOD OF 3 YEARS  
 GOVERNMENT LAND UNDER KONG SHAM WESTERN HIGHWAY (NEXT TO WONG KONG WAI ROAD NEAR FUK HANG TSUEN), LAM TEI, TUEN MUN, NEW TERRITORIES

本摘要圖於2020年6月12日擬備, 所根據的資料為測量圖編號 6-NW-17C 和 6-NW-22A  
 EXTRACT PLAN PREPARED ON 12.6.2020 BASED ON SURVEY SHEETS No. 6-NW-17C & 6-NW-22A

SCALE 1:1 500 比例尺  
 25 0 25 50 METRES

圖例 LEGEND

- 申請地點(界線只作識別用)  
APPLICATION SITE (BOUNDARY FOR IDENTIFICATION PURPOSE ONLY)
- 政府土地  
GOVERNMENT LAND
- R(D) 住宅(丁類)  
RESIDENTIAL (GROUP D)
- GB 綠化地帶  
GREEN BELT
- RES 住用構築物  
RESIDENTIAL STRUCTURES
- A/F 休耕農地  
FALLOW AGRICULTURAL LAND
- A/C 常耕農地  
CULTIVATED AGRICULTURAL LAND
- 實地照片的觀景點  
VIEWING POINT OF SITE PHOTO
- 入口/出口  
INGRESS / EGRESS

規劃署  
 PLANNING DEPARTMENT



參考編號  
 REFERENCE No.

A/TM-LTYT/398

圖 PLAN  
 A-2

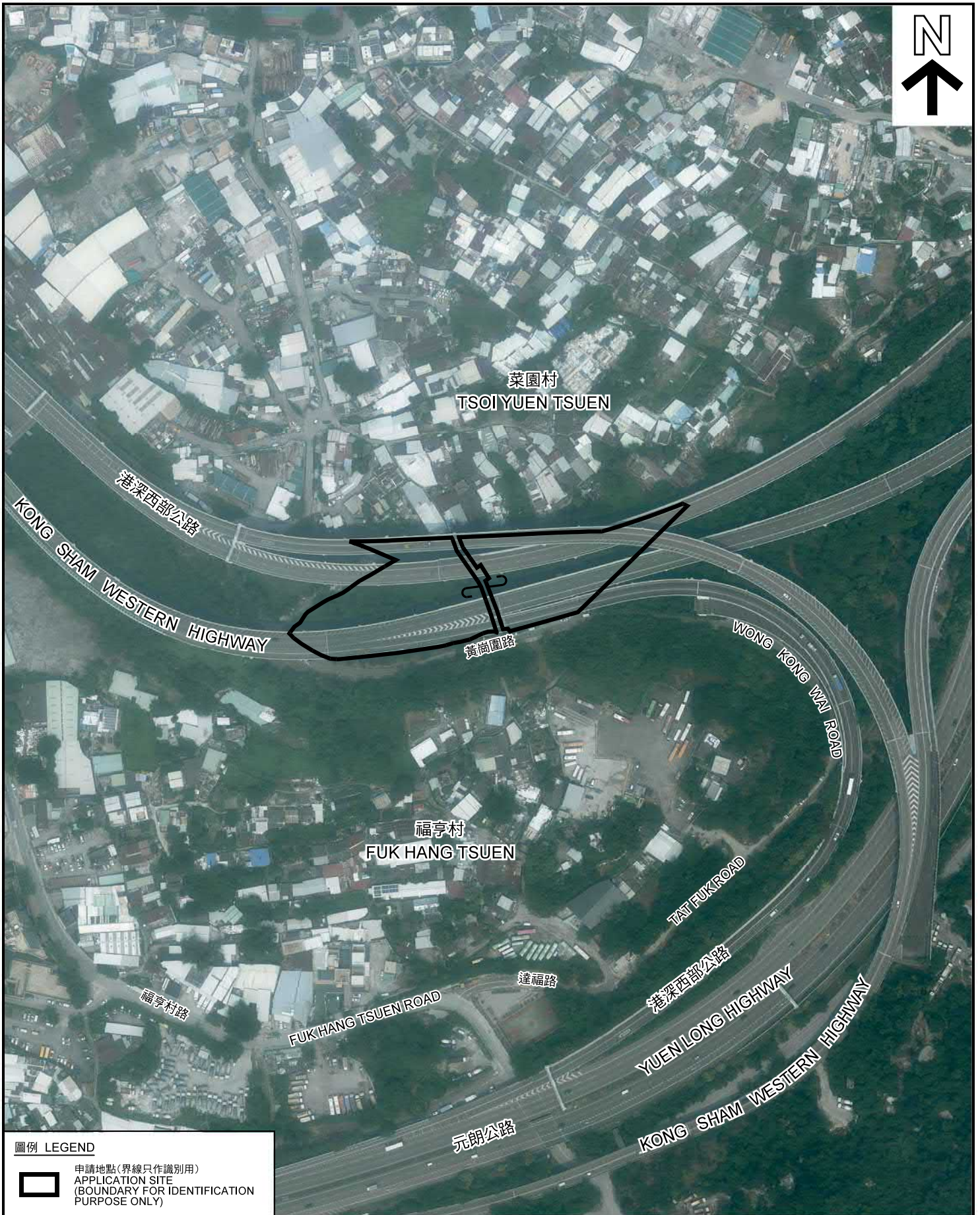

圖例 LEGEND



申請地點(界線只作識別用)  
APPLICATION SITE  
(BOUNDARY FOR IDENTIFICATION  
PURPOSE ONLY)

本摘要圖於2020年6月10日擬備，所根據的資料為地政總署於2019年9月29日拍得的航攝照片編號 E067414C  
EXTRACT PLAN PREPARED ON 10.6.2020  
BASED ON AERIAL PHOTO No.  
E067414C TAKEN ON 29.9.2019  
BY LANDS DEPARTMENT

航攝照片 AERIAL PHOTO

擬議臨時訓練場(建造業議會香港建造學院)(為期3年)  
新界屯門藍地港深西部通道下的政府土地(黃崗圍路旁近福亨村)  
PROPOSED TEMPORARY TRAINING GROUND (HONG KONG  
INSTITUTE OF CONSTRUCTION, CONSTRUCTION INDUSTRY COUNCIL)  
FOR A PERIOD OF 3 YEARS  
GOVERNMENT LAND UNDER KONG SHAM WESTERN HIGHWAY  
(NEXT TO WONG KONG WAI ROAD NEAR FUK HANG TSUEN),  
LAM TEI, TUEN MUN, NEW TERRITORIES

規劃署  
PLANNING  
DEPARTMENT



參考編號  
REFERENCE No.  
A/TM-LTTY/398

圖 PLAN  
A-3





申請地點界線只作識別用 APPLICATION SITE BOUNDARY FOR IDENTIFICATION PURPOSE ONLY

**實地照片 SITE PHOTO**

本圖於2020年6月12日擬備，所根據的資料為攝於2020年6月11日的實地照片  
PLAN PREPARED ON 12.6.2020  
BASED ON SITE PHOTOS  
TAKEN ON 11.6.2020

擬議臨時訓練場(建造業議會香港建造學院)(為期3年)  
新界屯門藍地港深西部通道下的政府土地(黃崗圍路旁近福亨村)  
PROPOSED TEMPORARY TRAINING GROUND (HONG KONG  
INSTITUTE OF CONSTRUCTION, CONSTRUCTION INDUSTRY COUNCIL)  
FOR A PERIOD OF 3 YEARS  
GOVERNMENT LAND UNDER KONG SHAM WESTERN HIGHWAY  
(NEXT TO WONG KONG WAI ROAD NEAR FUK HANG TSUEN),  
LAM TEI, TUEN MUN, NEW TERRITORIES

規劃署  
PLANNING  
DEPARTMENT



參考編號  
REFERENCE No.  
A/TM-LTYYY/398

圖 PLAN  
A-4a



申請地點界線只作識別用 APPLICATION SITE BOUNDARY FOR IDENTIFICATION PURPOSE ONLY

實地照片 SITE PHOTO

本圖於2020年6月12日擬備，所根據的資料為攝於2020年6月11日的實地照片  
PLAN PREPARED ON 12.6.2020  
BASED ON SITE PHOTOS  
TAKEN ON 11.6.2020

擬議臨時訓練場(建造業議會香港建造學院)(為期3年)  
新界屯門藍地港深西部通道下的政府土地(黃崗圍路旁近福亨村)  
PROPOSED TEMPORARY TRAINING GROUND (HONG KONG  
INSTITUTE OF CONSTRUCTION, CONSTRUCTION INDUSTRY COUNCIL)  
FOR A PERIOD OF 3 YEARS  
GOVERNMENT LAND UNDER KONG SHAM WESTERN HIGHWAY  
(NEXT TO WONG KONG WAI ROAD NEAR FUK HANG TSUEN),  
LAM TEI, TUEN MUN, NEW TERRITORIES

規劃署  
PLANNING  
DEPARTMENT



參考編號  
REFERENCE No.  
A/TM-LTTY/398

圖 PLAN  
A-4b