

Similar Application approved by TPB
 No. AYL-PS/551 (9.2.2018)
 No. AYL-PS/463 (27.2.2015)
 for Temporary Public Vehicle Park for
 Private Cars

APPLICATION SITE
 Previous Applications approved by TPB
 No. AYL-PS/509 (8.1.2016)
 No. AYL-PS/397 (11.1.2013)
 No. AYL-PS/332 (12.11.2010)
 No. AYL-PS/289 (24.10.2008)
 No. AYL-PS/254 (17.11.2006) &
 No. AYL-PS/187 (26.11.2004)
 for the Same Applied Use

Similar Application approved by TPB
 No. AYL-PS/216 (24.6.2005)
 for Temporary Public Vehicle Park for
 Private Cars and Light Goods Vehicles

Similar Application approved by TPB
 No. AYL-PS/213 (27.5.2005)
 for Temporary Public Vehicle Park for
 Private Cars and Light Goods Vehicles

Similar Applications approved by TPAB
 No. AYL-PS/206 (28.3.2008) &
 approved by TPB
 No. AYL-PS/344 (18.3.2011)
 No. AYL-PS/439 (21.3.2014)
 for Temporary Container Vehicle and
 Lorry Park

Similar Applications approved by TPAB
 No. AYL-PS/207 (28.3.2008) &
 approved by TPB
 No. AYL-PS/345 (18.3.2011)
 No. AYL-PS/438 (7.3.2014)
 for Temporary Container Vehicle and
 Lorry Park with Container Trailers
 No. AYL-PS/444 (9.5.2014)
 for Temporary Logistic Centre and
 Ancillary Parking of Vehicle
 No. AYL-PS/477 (17.4.2015) &
 No. AYL-PS/556 (6.4.2018)
 for Temporary Logistics Centre and
 Vehicle Park (Container Tractors,
 Container Trailers and Lorries
 (Medium/Heavy Goods Vehicles))



Similar Application approved by TPB
 No. AYL-PS/26 (6.3.1998)
 for Temporary Container Trailer, Lorry
 and Private Car Park

Plan Based on Approved Ping Shan Outline Zoning Plan No. S/YL-PS/18 Gazetted on 26.10.2018	Location Plan Temporary Public Vehicle Park for Private Cars and Light Goods Vehicles Various Lots in DD122 and Adjoining Government Land, Ping Shan, Yuen Long	Plan 1
		PlanArch Consultants Ltd.
	Revision: Date: 29.10.2018	

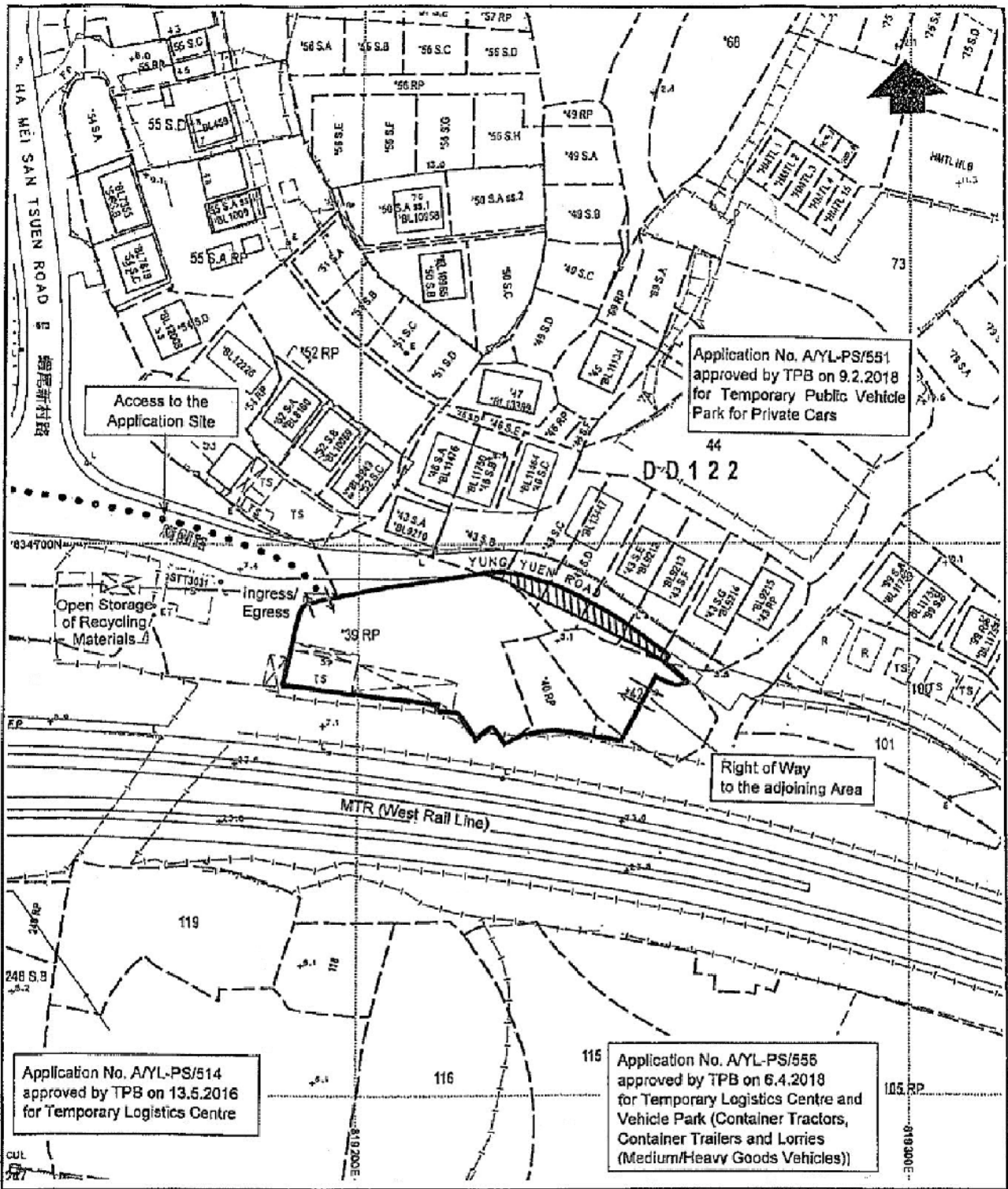
參考編號 REFERENCE No. AYL-PS/578	繪圖 DRAWING A-1
----------------------------------	-------------------



Legend

 The Application Site
 Proposed Extension
 Base Plan Extracted from
 Lot Index Plan
 No. KD0166112017
 Prepared by the District
 Survey Office /Kowloon
 on 24.11.2017

Site Plan

Temporary Public Vehicle Park for
 Private Cars and Light Goods Vehicles
 Various Lots in DD122
 and Adjoining Government Land,
 Ping Shan, Yuen Long

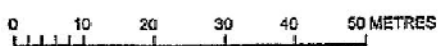

Plan 2

PlanArch Consultants Ltd.

Revision: Date: 24.10.2018

DD122

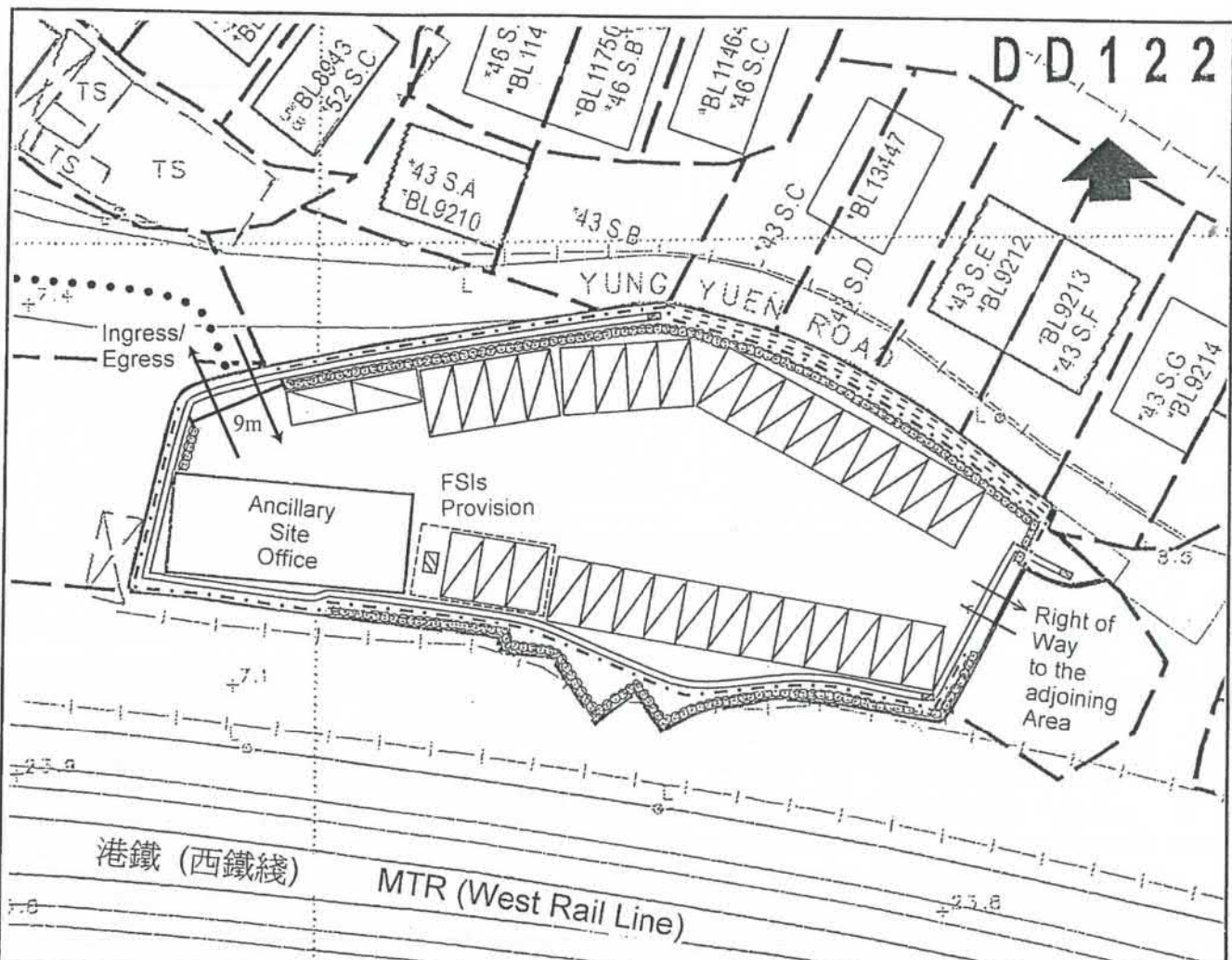

Legend

- The Application Site
- Parking Space
- Canopy for Car Park and Fire Services Installations

Landscaping Proposal

- Landscaping Belt

	Size (Height in mm)	Spacing (Centre to Centre in mm)
Ficus microcarpa L.f (細葉榕)	2,750	5,000 intervals
Double Row of Schefflera Heptaphylla (鴨腳木)	600	450

- Existing Boundary Fencing
- Surface Channel
- 150H Curb along North Site Boundary
- Catch Pit

Layout Plan

Temporary Public Vehicle Park for
Private Cars and Light Goods Vehicles
Various Lots in DD122 and Adjoining Government Land,
Ping Shan, Yuen Long

0 10 20 30 METRES

Plan 3 A

PlanArch Consultants Ltd.

Revision: Date: 7.12.2018

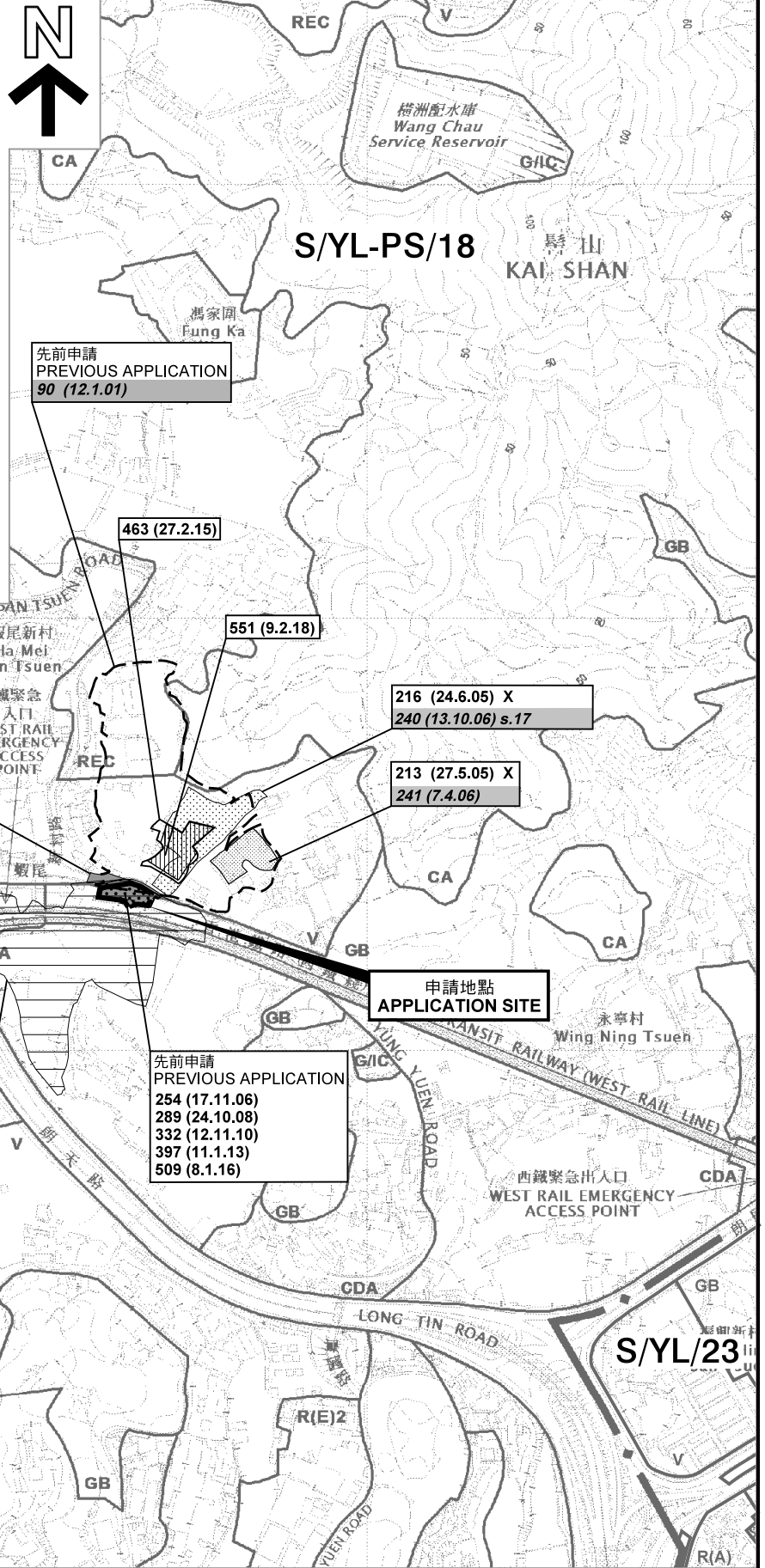
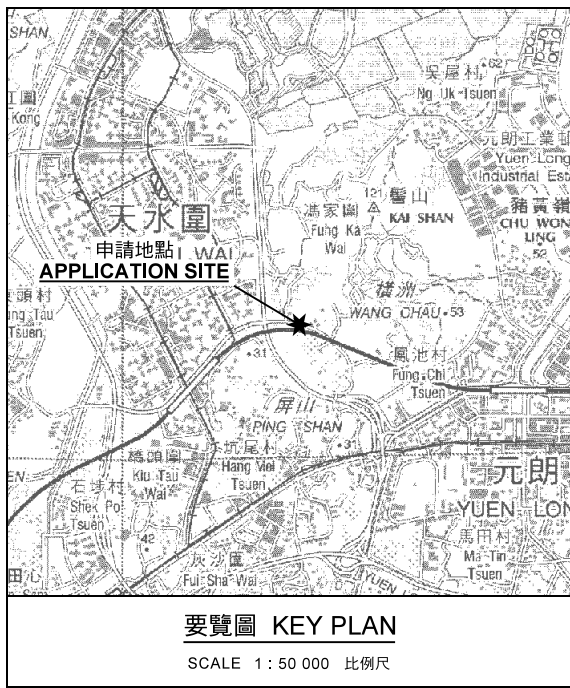

圖例 LEGEND

243 (17.7.04)	獲批准的申請 APPROVED APPLICATION
244 (17.7.04)	被拒絕的申請 REJECTED APPLICATION
72 (10.9.99) X	已撤銷 REVOKED
- - - - -	會議日期 DATE OF MEETING
- - - - -	申請編號 APPLICATION NUMBER

申請地點界線只作識別用
APPLICATION SITE BOUNDARY FOR IDENTIFICATION PURPOSE ONLY

本摘要圖於2018年12月13日擬備，所根據的資料為於2018年10月16日核准的分區計劃大綱圖編號 S/YL-PS/18 EXTRACT PLAN PREPARED ON 13.12.2018 BASED ON OUTLINE ZONING PLAN No. S/YL-PS/18 APPROVED ON 16.10.2018

位置圖 LOCATION PLAN

臨時公眾停車場(私家車及輕型貨車)(為期3年)
新界元朗屏山丈量約份第122約地段第39號餘段(部分)、第40號餘段、第42號(部分)、第43號B分段(部分)、第43號C分段(部分)、第43號D分段(部分)、第43號E分段(部分)、第43號F分段(部分)及第43號G分段(部分)和毗連政府土地
TEMPORARY PUBLIC VEHICLE PARK FOR PRIVATE CARS AND LIGHT GOODS VEHICLES FOR A PERIOD OF 3 YEARS
LOTS 39RP (PART), 40RP, 42 (PART), 43 S.B (PART), 43 S.C (PART), 43 S.D (PART), 43 S.E (PART), 43 S.F (PART) AND 43 S.G (PART) IN D.D. 122 AND ADJOINING GOVERNMENT LAND, PING SHAN, YUEN LONG, NEW TERRITORIES
SCALE 1 : 7 500 比例尺

米 100 0 100 200 300 米
METRES

**規劃署
PLANNING
DEPARTMENT**



參考編號
REFERENCE No.
A/YL-PS/578

**圖 PLAN
A-1**

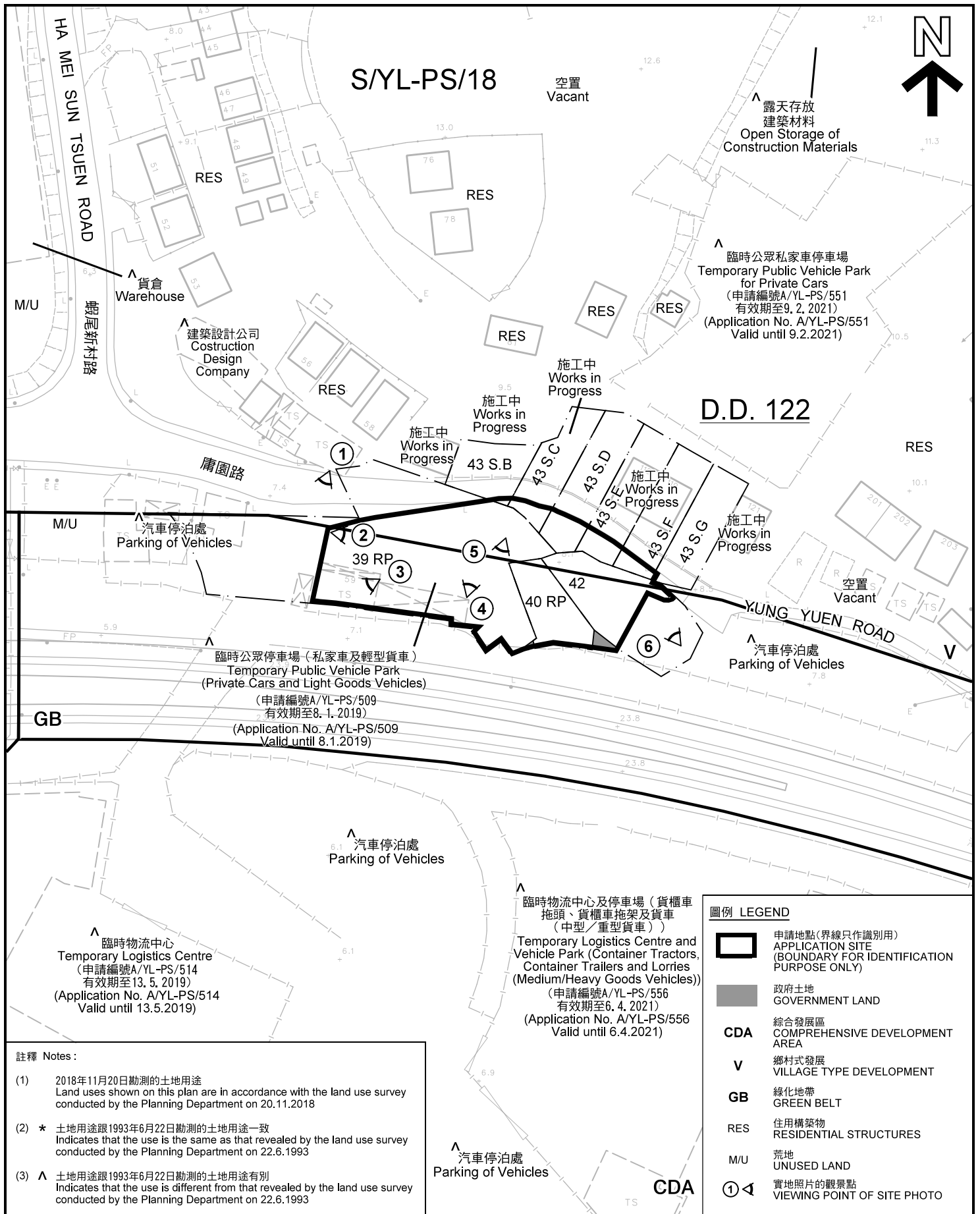

註釋 Notes:

- (1) 2018年11月20日勘測的土地用途
Land uses shown on this plan are in accordance with the land use survey conducted by the Planning Department on 20.11.2018
- (2) * 土地用途跟1993年6月22日勘測的土地用途一致
Indicates that the use is the same as that revealed by the land use survey conducted by the Planning Department on 22.6.1993
- (3) ^ 土地用途跟1993年6月22日勘測的土地用途有別
Indicates that the use is different from that revealed by the land use survey conducted by the Planning Department on 22.6.1993

圖例 LEGEND

- 申請地點(界線只作識別用)
APPLICATION SITE
(BOUNDARY FOR IDENTIFICATION PURPOSE ONLY)
- 政府土地
GOVERNMENT LAND
- CDA** 綜合發展區
COMPREHENSIVE DEVELOPMENT AREA
- V** 鄉村式發展
VILLAGE TYPE DEVELOPMENT
- GB** 綠化地帶
GREEN BELT
- RES** 住用構築物
RESIDENTIAL STRUCTURES
- M/U** 荒地
UNUSED LAND
- 實地照片的觀景點
VIEWING POINT OF SITE PHOTO

平面圖 SITE PLAN

臨時公眾停車場(私家車及輕型貨車)(為期3年)
新界元朗屏山丈量約份第122約地段第39號餘段(部分)、
第40號餘段、第42號(部分)、第43號B分段(部分)、
第43號C分段(部分)、第43號D分段(部分)、第43號E分段(部分)、
第43號F分段(部分)及第43號G分段(部分)和毗連政府土地
TEMPORARY PUBLIC VEHICLE PARK FOR PRIVATE CARS AND
LIGHT GOODS VEHICLES FOR A PERIOD OF 3 YEARS
LOTS 39RP (PART), 40RP, 42 (PART), 43 S.B (PART), 43 S.C (PART),
43 S.D (PART), 43 S.E (PART), 43 S.F (PART) AND 43 S.G (PART) IN D.D. 122 AND
ADJOINING GOVERNMENT LAND, PING SHAN, YUEN LONG, NEW TERRITORIES
SCALE 1 : 1 000 比例尺

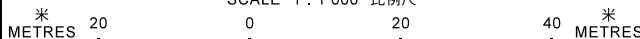

本摘要圖於2018年12月12日擬備, 所根據的資料為測量圖編號 6-NW-8B
EXTRACT PLAN PREPARED ON 12.12.2018
BASED ON SURVEY SHEETS No.
6-NW-8B

規劃署
PLANNING
DEPARTMENT



參考編號
REFERENCE No.
A/YL-PS/578

圖 PLAN
A-2



圖例 LEGEND



申請地點(界線只作識別用)
APPLICATION SITE
(BOUNDARY FOR IDENTIFICATION
PURPOSE ONLY)

本摘要圖於2018年12月13日擬備，所根據的資料為地政總署於2018年1月3日拍得的航攝照片編號 E033222C
EXTRACT PLAN PREPARED ON 13.12.2018
BASED ON AERIAL PHOTO No.
E033222C TAKEN ON 3.1.2018
BY LANDS DEPARTMENT

航攝照片 AERIAL PHOTO

臨時公眾停車場(私家車及輕型貨車)(為期3年)
新界元朗屏山丈量約份第122約地段第39號餘段(部分)、
第40號餘段、第42號(部分)、第43號B分段(部分)、
第43號C分段(部分)、第43號D分段(部分)、第43號E分段(部分)、
第43號F分段(部分)及第43號G分段(部分)和毗連政府土地
TEMPORARY PUBLIC VEHICLE PARK FOR PRIVATE CARS AND
LIGHT GOODS VEHICLES FOR A PERIOD OF 3 YEARS
LOTS 39RP (PART), 40RP, 42 (PART), 43 S.B (PART), 43 S.C (PART),
43 S.D (PART), 43 S.E (PART), 43 S.F (PART) AND 43 S.G (PART) IN D.D. 122 AND
ADJOINING GOVERNMENT LAND, PING SHAN, YUEN LONG, NEW TERRITORIES

規劃署
PLANNING
DEPARTMENT



參考編號
REFERENCE No.
AYL-PS/578

圖 PLAN
A-3

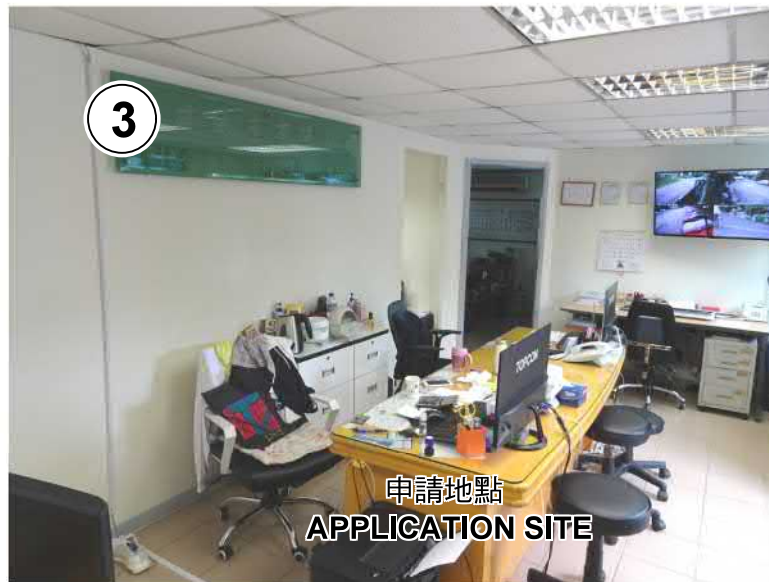

本圖於2018年12月13日擬備，所根據的資料為攝於2018年11月20日的實地照片
 PLAN PREPARED ON 13.12.2018
 BASED ON SITE PHOTOS
 TAKEN ON 20.11.2018

實地照片 SITE PHOTO

臨時公眾停車場(私家車及輕型貨車)(為期3年)
 新界元朗屏山丈量約份第122約地段第39號餘段(部分)、
 第40號餘段、第42號(部分)、第43號B分段(部分)、
 第43號C分段(部分)、第43號D分段(部分)、第43號E分段(部分)、
 第43號F分段(部分)及第43號G分段(部分)和毗連政府土地
 TEMPORARY PUBLIC VEHICLE PARK FOR PRIVATE CARS AND
 LIGHT GOODS VEHICLES FOR A PERIOD OF 3 YEARS
 LOTS 39RP (PART), 40RP, 42 (PART), 43 S.B (PART), 43 S.C (PART),
 43 S.D (PART), 43 S.E (PART), 43 S.F (PART) AND 43 S.G (PART) IN D.D. 122 AND
 ADJOINING GOVERNMENT LAND, PING SHAN, YUEN LONG, NEW TERRITORIES

規劃署
**PLANNING
 DEPARTMENT**



參考編號
 REFERENCE No.
AYL-PS/578

圖 PLAN
A-4a



申請地點
APPLICATION SITE



申請地點
APPLICATION SITE



申請地點
APPLICATION SITE

實地照片 SITE PHOTO

本圖於2018年12月13日擬備，所根據的資料為攝於2018年11月20日的實地照片
PLAN PREPARED ON 13.12.2018
BASED ON SITE PHOTOS
TAKEN ON 20.11.2018

臨時公眾停車場(私家車及輕型貨車)(為期3年)
新界元朗屏山丈量約份第122約地段第39號餘段(部分)、
第40號餘段、第42號(部分)、第43號B分段(部分)、
第43號C分段(部分)、第43號D分段(部分)、第43號E分段(部分)、
第43號F分段(部分)及第43號G分段(部分)和毗連政府土地
TEMPORARY PUBLIC VEHICLE PARK FOR PRIVATE CARS AND
LIGHT GOODS VEHICLES FOR A PERIOD OF 3 YEARS
LOTS 39RP (PART), 40RP, 42 (PART), 43 S.B (PART), 43 S.C (PART),
43 S.D (PART), 43 S.E (PART), 43 S.F (PART) AND 43 S.G (PART) IN D.D. 122 AND
ADJOINING GOVERNMENT LAND, PING SHAN, YUEN LONG, NEW TERRITORIES

規劃署
PLANNING
DEPARTMENT



參考編號
REFERENCE No.
AYL-PS/578

圖 PLAN
A-4b