

Project 項目名稱:

Proposed Temporary Public Vehicle Park for Private Cars & Light Goods Vehicles for a Period of 3 Years at Lots 270 RP, 271 RP, 272 RP & 273 RP in D.D. 122, Ping Shan, Yuen Long, N.T.

Drawing Title 圖目:

Site Plan

Remarks 備註:

Drawing No. 圖號:

Figure 1

Scale 比例:

1:1000

參考編號 REFERENCE No.
AYL-PS/595

繪圖 DRAWING
A-1

(摘錄自申請人於5.9.2019呈交的申請書)
(Extract from Applicant's
Submission Dated 5.9.2019)

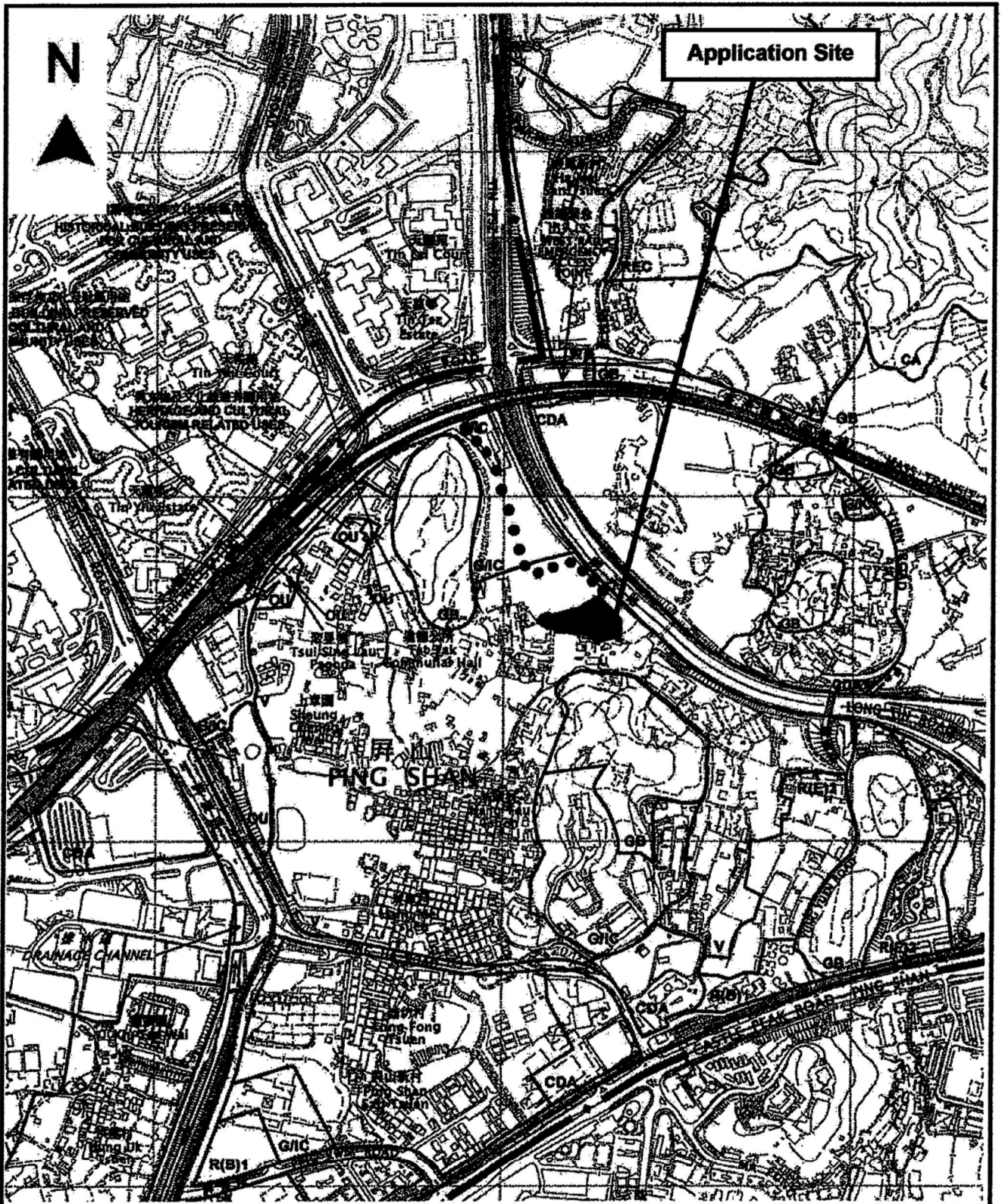

<p>Project 項目名稱: Proposed Temporary Public Vehicle Park for Private Cars & Light Goods Vehicles for a Period of 3 Years at Lots 270 RP, 271 RP, 272 RP & 273 RP in D.D. 122, Ping Shan, Yuen Long, N.T.</p>	<p>Drawing Title 圖目: Vehicular Access Plan</p>	<p>Remarks 備註: ●●● Vehicular access leading from Tsui Sing Road</p>
<p>Drawing No. 圖號: Figure 2</p>	<p>Scale 比例: 1:7500</p>	

<p>參考編號 REFERENCE No. A/YL-PS/595</p>	<p>繪圖 DRAWING A-2</p>
---------------------------------------------------	-----------------------------------

(摘錄自申請人於5.9.2019呈交的申請書)
 (Extract from Applicant's Submission Dated 5.9.2019)

N

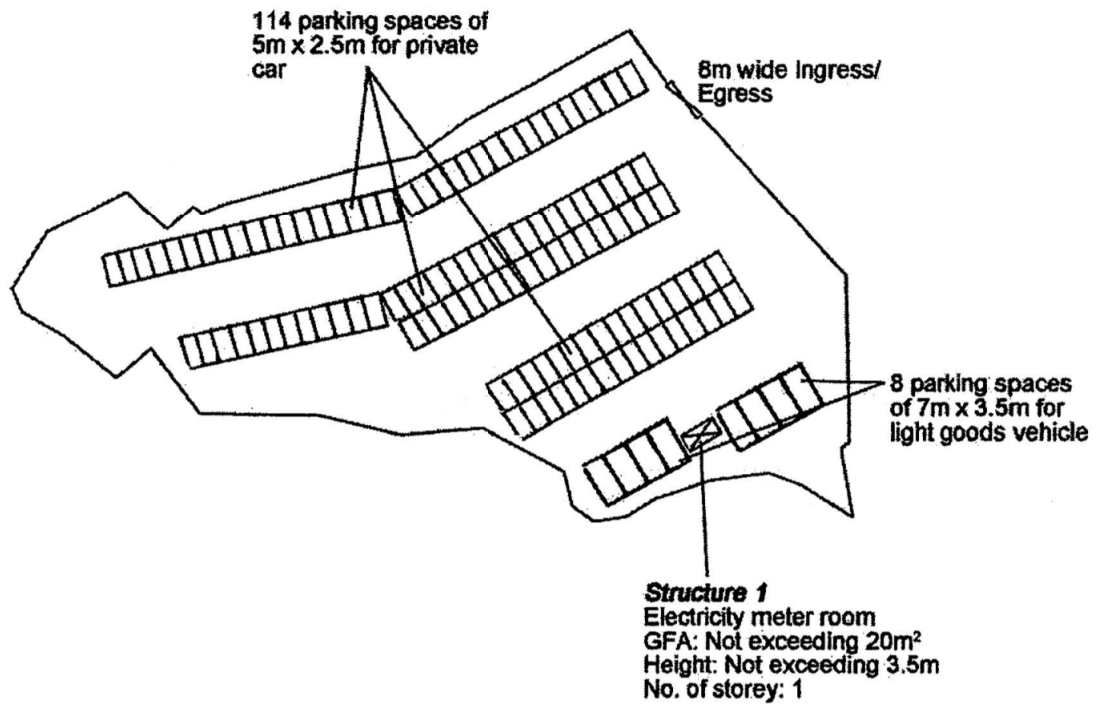

Project 項目名稱:

Proposed Temporary Public Vehicle Park for Private Cars & Light Goods Vehicles for a Period of 3 Years at Lots 270 RP, 271 RP, 272 RP & 273 RP in D.D. 122, Ping Shan, Yuen Long, N.T.

Drawing Title 圖目:

Proposed Layout Plan

Remarks 備註:

Drawing No. 圖號:

Figure 3

Scale 比例:

—1:1000—

參考編號 REFERENCE No.
A/YL-PS/595

繪圖 DRAWING
A-3

(摘錄自申請人於5.9.2019呈交的申請書)
(Extract from Applicant's
Submission Dated 5.9.2019)

N



Proposed Tree	Approximate Height	Spacing
○ Proposed <i>Melaleuca leucadendron</i>	2.75m	4m
⊗ Existing tree to be preserved	6m	NA

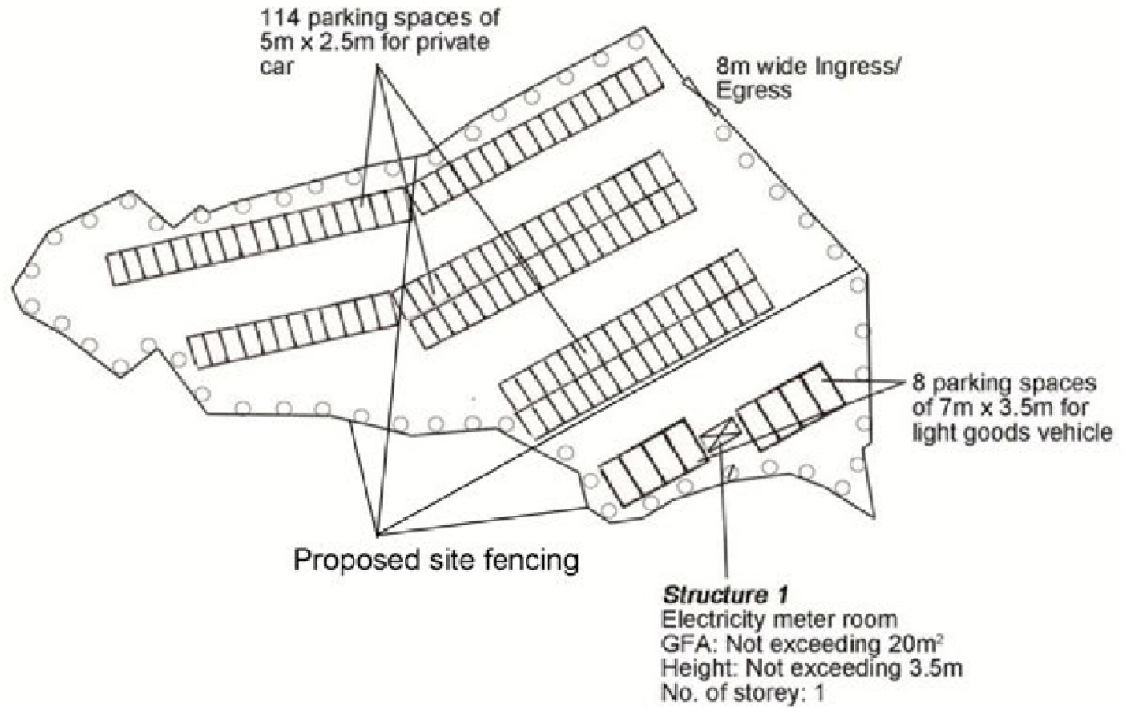

Project 項目名稱: Proposed Temporary Public Vehicle Park for Private Cars & Light Goods Vehicles for a Period of 3 Years at Lots 270 RP, 271 RP, 272 RP & 273 RP in D.D. 122, Ping Shan, Yuen Long, N.T.	Drawing Title 圖目: Proposed Landscape & Site Fencing Plan	Remarks 備註:
	Drawing No. 圖號: Figure 4	Scale 比例: 1:1000

參考編號 REFERENCE No. A/YL-PS/595	繪圖 DRAWING A-4
-----------------------------------	-------------------

(摘錄自申請人於22. 10. 2019呈交的申請書)
(Extract from Applicant's Submission Dated 22.10.2019)

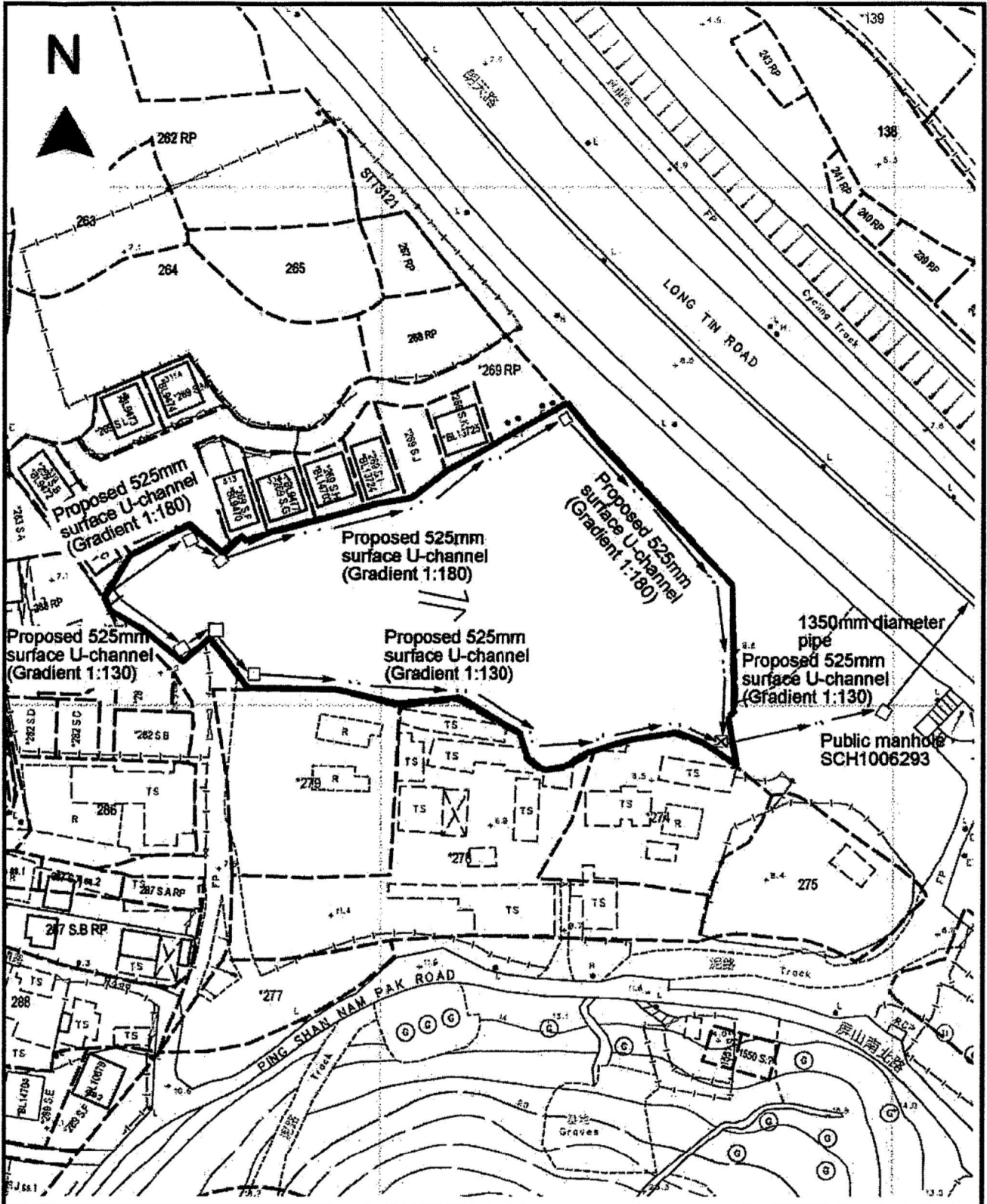

<p>Project 項目名稱: Proposed Temporary Public Vehicle Park for Private Cars & Light Goods Vehicles for a Period of 3 Years at Lots 270 RP, 271 RP, 272 RP & 273 RP in D.D. 122, Ping Shan, Yuen Long, N.T.</p>	<p>Drawing Title 圖目: Proposed Drainage Plan</p>	<p>Remarks 備註: +7.5 Level (in mPD) Flow of surface runoff <input type="checkbox"/> Proposed catchpit <input checked="" type="checkbox"/> Proposed catchpit with sandtrap</p>
	<p>Drawing No. 圖號: Figure 5</p>	<p>Scale 比例: 1:1000</p>

參考編號 REFERENCE No. A/YL-PS/595	繪圖 DRAWING A-5
-----------------------------------	-------------------

(摘錄自申請人於5.9.2019呈交的申請書)
 (Extract from Applicant's Submission Dated 5.9.2019)

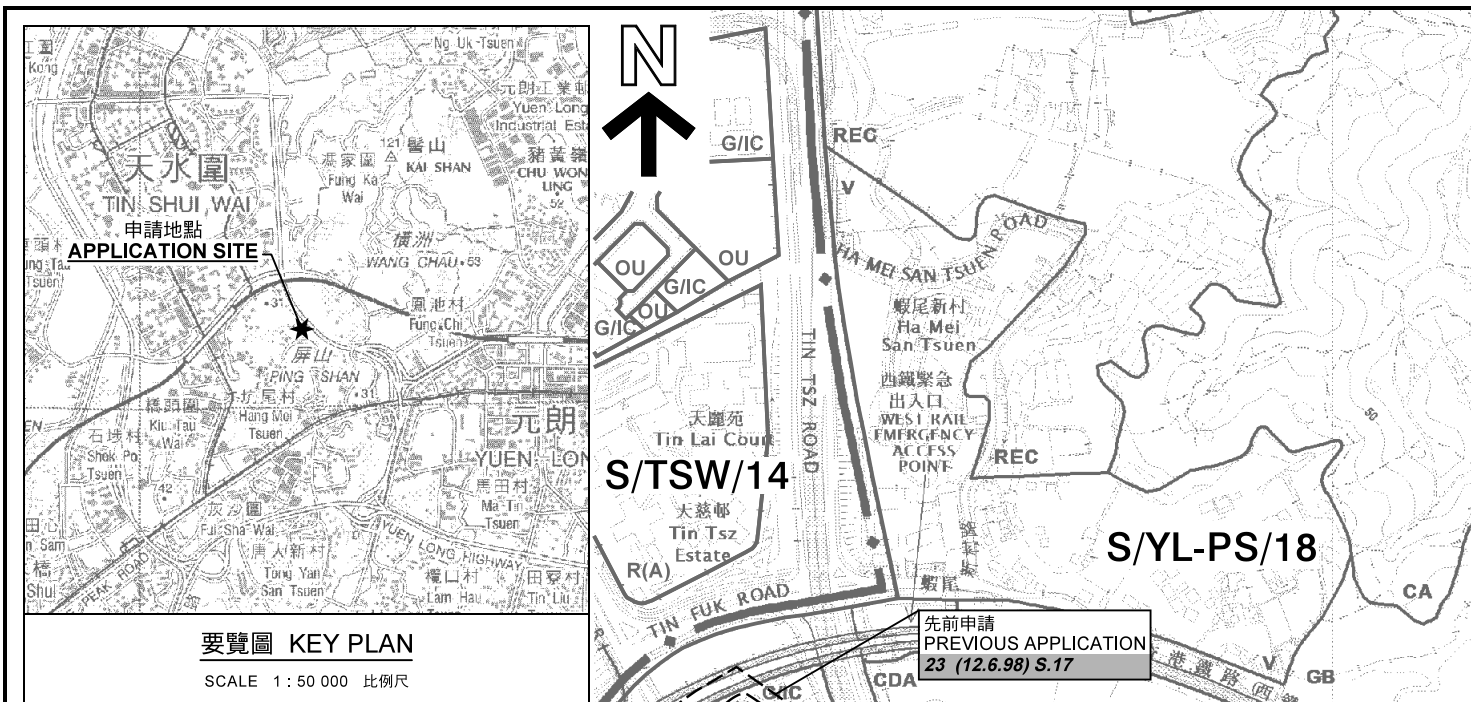

要覽圖 KEY PLAN

SCALE 1 : 50 000 比例尺

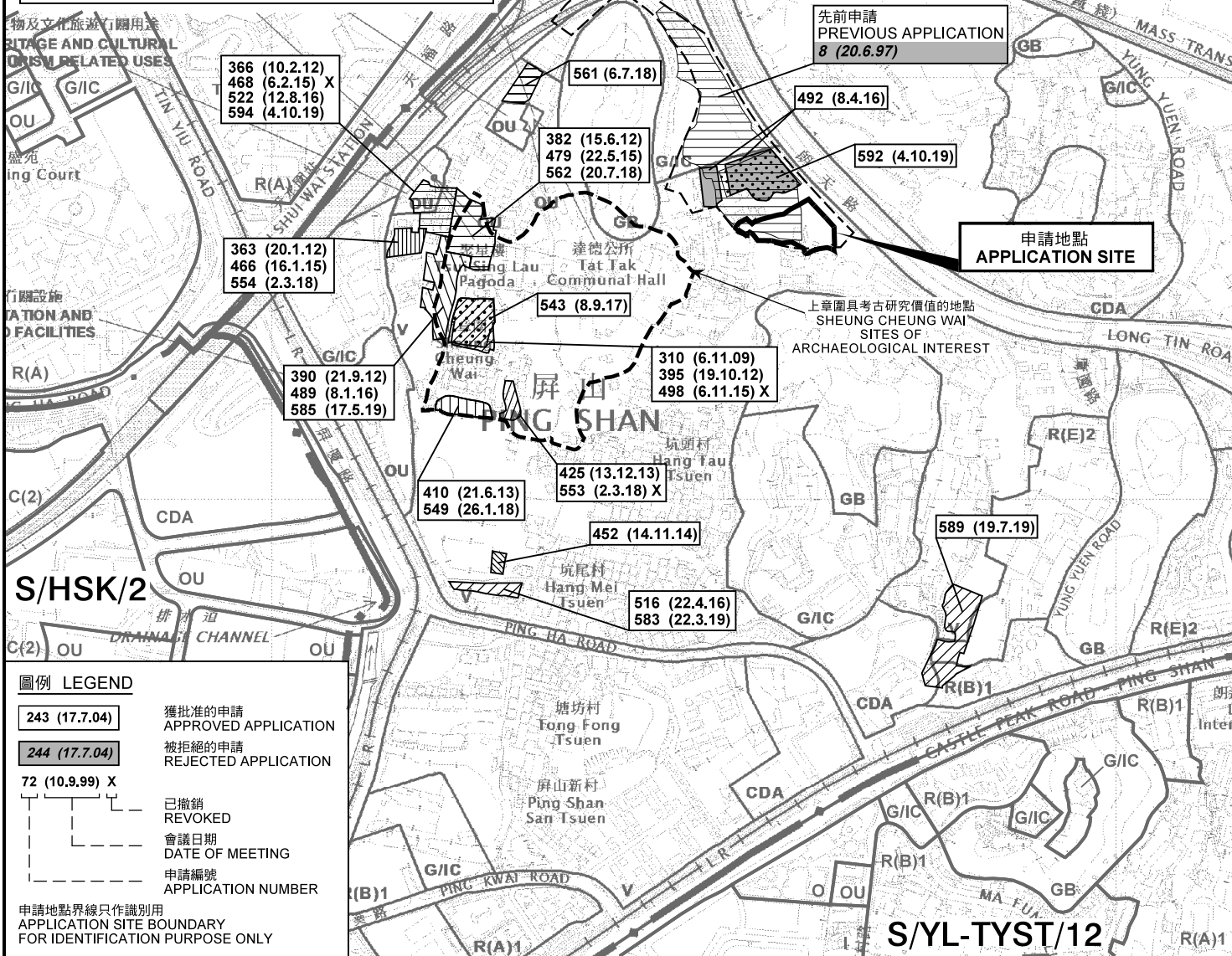

圖例 LEGEND

- 243 (17.7.04) 獲批准的申請 APPROVED APPLICATION
 - 244 (17.7.04) 被拒絕的申請 REJECTED APPLICATION
 - 72 (10.9.99) X 已撤銷 REVOKED
 - 會議日期 DATE OF MEETING
 - 申請編號 APPLICATION NUMBER
- 申請地點界線只作識別用
APPLICATION SITE BOUNDARY FOR IDENTIFICATION PURPOSE ONLY

位置圖 LOCATION PLAN

本摘要圖於2019年10月10日擬備，所根據的資料為於2018年10月16日核准的分區計劃大綱圖編號 S/YL-PS/18 EXTRACT PLAN PREPARED ON 10.10.2019 BASED ON OUTLINE ZONING PLAN No. S/YL-PS/18 APPROVED ON 16.10.2018

擬議臨時公眾停車場(私家車及輕型貨車)(為期3年)
新界元朗屏山丈量約份第122約地段
第270號餘段、第271號餘段、第272號餘段及第273號餘段
PROPOSED TEMPORARY PUBLIC VEHICLE PARK FOR PRIVATE CARS AND LIGHT GOODS VEHICLES FOR A PERIOD OF 3 YEARS
LOTS 270 RP, 271 RP, 272 RP AND 273 RP IN D.D. 122, PING SHAN, YUEN LONG, NEW TERRITORIES

規劃署
PLANNING DEPARTMENT

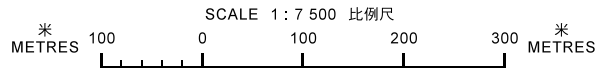

參考編號 REFERENCE No.
AYL-PS/595

圖 PLAN
A-1

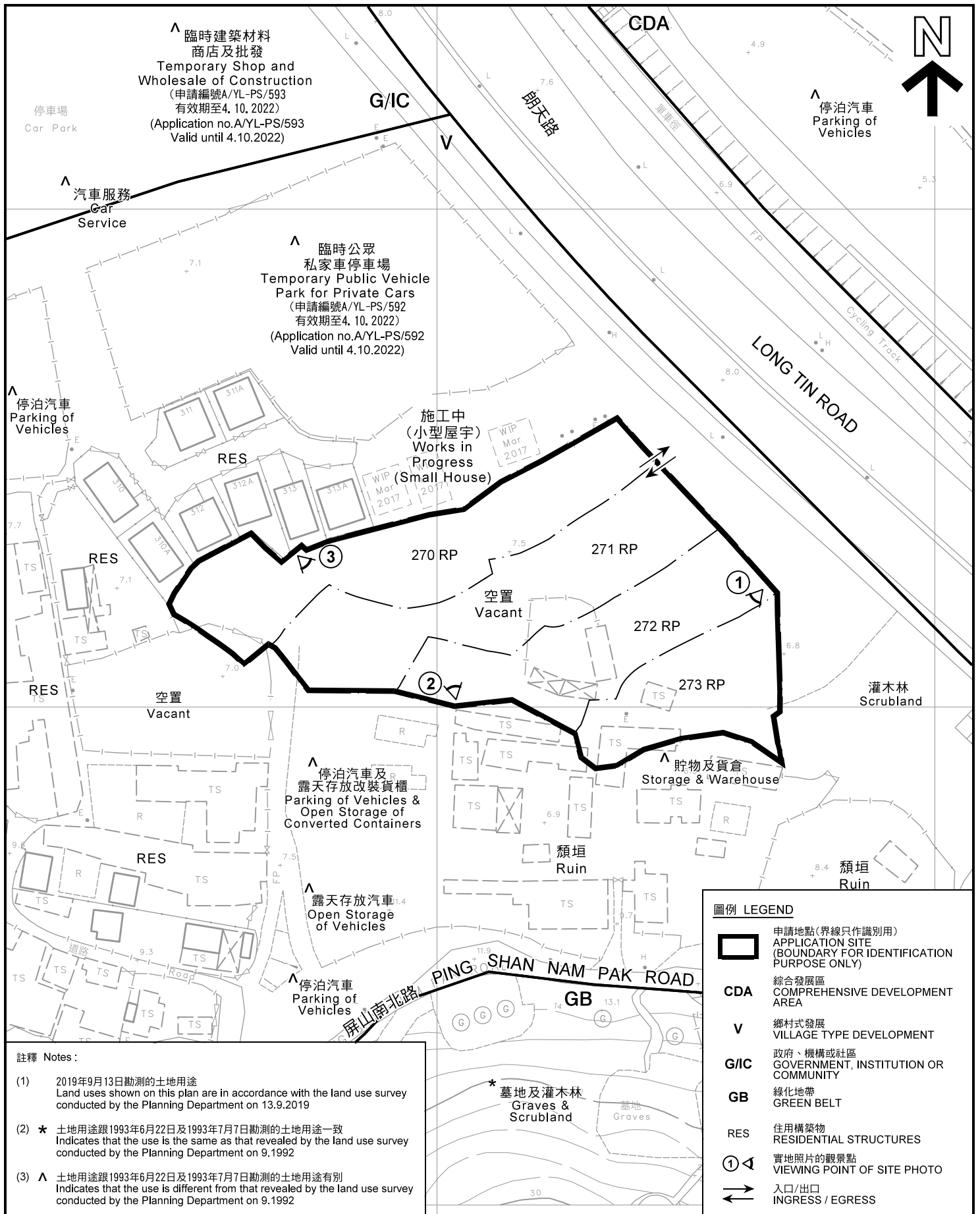

註釋 Notes:

- (1) 2019年9月13日勘測的土地用途
Land uses shown on this plan are in accordance with the land use survey conducted by the Planning Department on 13.9.2019
- (2) * 土地用途跟1993年6月22日及1993年7月7日勘測的土地用途一致
Indicates that the use is the same as that revealed by the land use survey conducted by the Planning Department on 9.1992
- (3) ^ 土地用途跟1993年6月22日及1993年7月7日勘測的土地用途有別
Indicates that the use is different from that revealed by the land use survey conducted by the Planning Department on 9.1992

圖例 LEGEND

- 申請地點(界線只作識別用)
APPLICATION SITE
(BOUNDARY FOR IDENTIFICATION PURPOSE ONLY)
- CDA** 綜合發展區
COMPREHENSIVE DEVELOPMENT AREA
- V** 鄉村式發展
VILLAGE TYPE DEVELOPMENT
- G/IC** 政府、機構或社區
GOVERNMENT, INSTITUTION OR COMMUNITY
- GB** 綠化地帶
GREEN BELT
- RES** 住用構築物
RESIDENTIAL STRUCTURES
- 實地照片的觀景點
VIEWING POINT OF SITE PHOTO
- 入口/出口
INGRESS / EGRESS

平面圖 SITE PLAN

擬議臨時公眾停車場(私家車及輕型貨車)(為期3年)
新界元朗屏山丈量約份第122約地段
第270號餘段、第271號餘段、第272號餘段及第273號餘段
PROPOSED TEMPORARY PUBLIC VEHICLE PARK FOR PRIVATE CARS
AND LIGHT GOODS VEHICLES FOR A PERIOD OF 3 YEARS
LOTS 270 RP, 271 RP, 272 RP AND 273 RP IN D.D. 122,
PING SHAN, YUEN LONG, NEW TERRITORIES

SCALE 1 : 1 000 比例尺

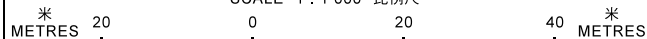

本摘要圖於2019年10月23日擬備，所根據的資料為測量圖編號6-NW-8B
EXTRACT PLAN PREPARED ON 23.10.2019
BASED ON SURVEY SHEET No.6-NW-8B

規劃署
PLANNING
DEPARTMENT



參考編號
REFERENCE No.
A/YL-PS/595

圖 PLAN
A-2



圖例 LEGEND



申請地點(界線只作識別用)
APPLICATION SITE
(BOUNDARY FOR IDENTIFICATION
PURPOSE ONLY)

本摘要圖於2019年9月27日擬備，所根據的資料為地政總署於2018年10月29日拍得的航攝照片編號 E048117C
EXTRACT PLAN PREPARED ON 27.9.2019
BASED ON AERIAL PHOTO No.
E032777C TAKEN ON 29.10.2018
BY LANDS DEPARTMENT

航攝照片 AERIAL PHOTO

擬議臨時公眾停車場(私家車及輕型貨車)(為期3年)
新界元朗屏山丈量約份第122約地段
第270號餘段、第271號餘段、第272號餘段及第273號餘段
PROPOSED TEMPORARY PUBLIC VEHICLE PARK FOR PRIVATE CARS
AND LIGHT GOODS VEHICLES FOR A PERIOD OF 3 YEARS
LOTS 270 RP, 271 RP, 272 RP AND 273 RP IN D.D. 122,
PING SHAN, YUEN LONG, NEW TERRITORIES

規劃署
**PLANNING
DEPARTMENT**



參考編號
REFERENCE No.
AYL-PS/595

圖 PLAN
A-3

1



申請地點
APPLICATION SITE

2



申請地點
APPLICATION SITE

3



申請地點
APPLICATION SITE

申請地點界線只作識別用
APPLICATION SITE BOUNDARY FOR IDENTIFICATION PURPOSE ONLY

實地照片 SITE PHOTO

擬議臨時公眾停車場(私家車及輕型貨車)(為期3年)
 新界元朗屏山丈量約份第122約地段
 第270號餘段、第271號餘段、第272號餘段及第273號餘段
 PROPOSED TEMPORARY PUBLIC VEHICLE PARK FOR PRIVATE CARS
 AND LIGHT GOODS VEHICLES FOR A PERIOD OF 3 YEARS
 LOTS 270 RP, 271 RP, 272 RP AND 273 RP IN D.D. 122,
 PING SHAN, YUEN LONG, NEW TERRITORIES

規 劃 署
 PLANNING
 DEPARTMENT



參考編號
 REFERENCE No.
 A/YL-PS/595

圖 PLAN
 A-4

本圖於2019年9月27日擬備，所根據的資料為攝於2019年9月13日的實地照片
 PLAN PREPARED ON 27.9.2019
 BASED ON SITE PHOTOS
 TAKEN ON 13.9.2019