



Legend:

-  Application Site (Area = 272 sq. m.)
-  Real Estate Agency Office (Height = 3.5m)
-  Parking Spaces for Visitors (1)

Layout Plan

Lot 1233RP (Part) in DD119,
Tai Yang, Yuen Long, N.T.

FIGURE 6

FOR IDENTIFICATION PURPOSE
Date: 25.4.2019
Scale: 1:500 (A4)

(摘錄自申請人於 19.6.2019 提交的申請書)
(Extract from Applicant's
Submission of 19.6.2019)

參考編號
REFERENCE No.
AYL-TT/475

繪圖 DRAWING
A-1

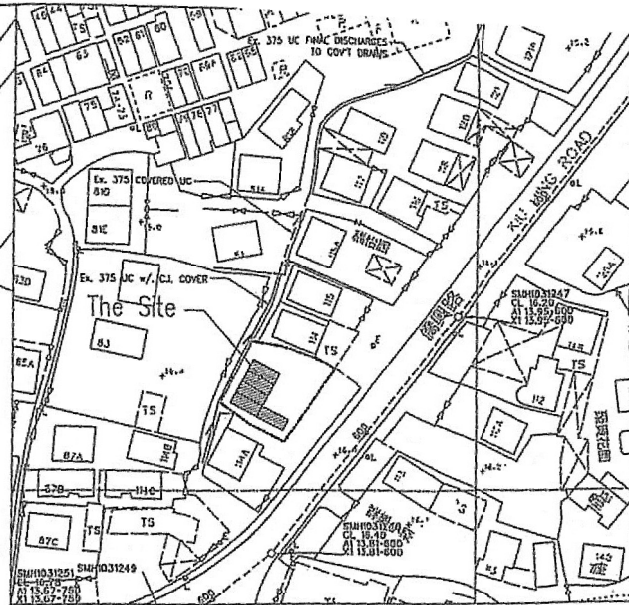
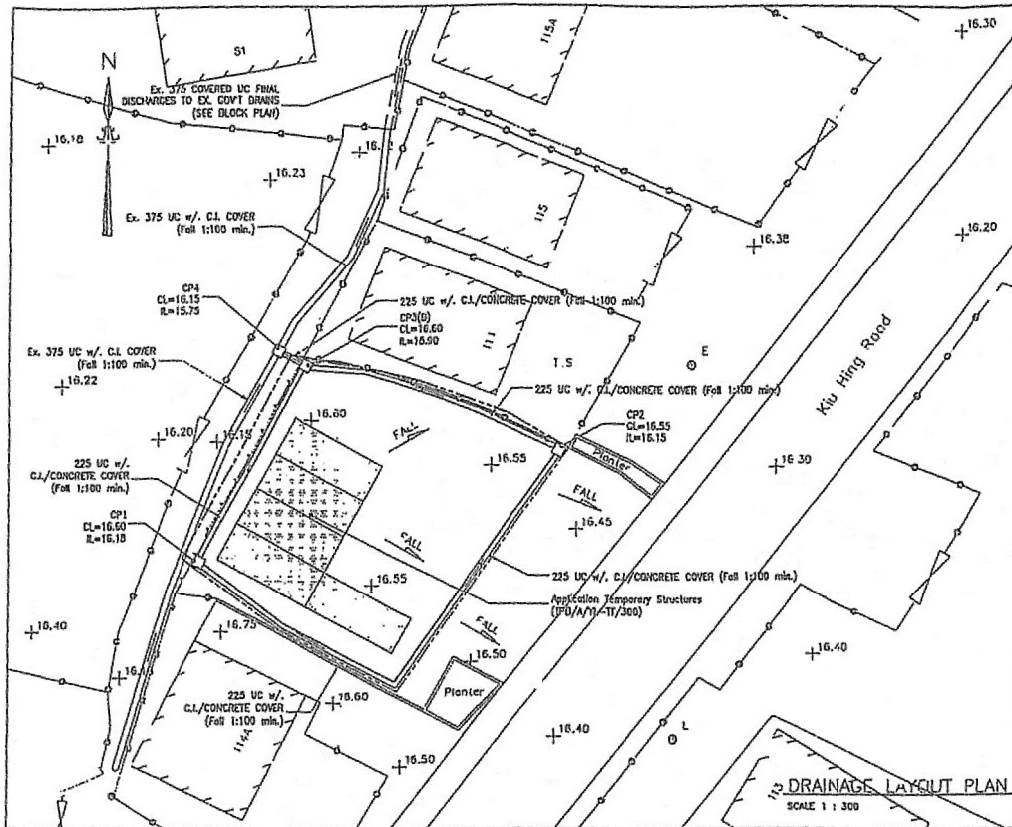

Drawing Revisions

Rev.	Date	Revision

- REMARKS**
- LEGEND / COLOUR INDICATION :**
- EXISTING OR PROPOSED TEMP. STRUCTURE
 - EXISTING GROUND LEVEL IN MGD
 - CP1 PROPOSED CATCHPIT (NO. CP1)
 - S1H1012050 EXISTING GOVERNMENT STORMWATER INWENT
 - COVERED LEVEL
 - INVERTED LEVEL

- DRAWING NOTES**
- This drawing is the property of the applicant. It shall not be reproduced, or disclosed, or assessed, and the copyright and other rights shall not be transferred in whole or in part without their prior written consent.
 - All dimensions shown are in millimetres unless otherwise stated, and in no instance shall the drawing be scaled to interpret dimensions.
 - Written dimensions and old lines should be set out and verified on site before commencement of related building works.
 - This drawing should be used in conjunction with the application, conditions of contract, technical specifications, structural plans and other related drawings and calculations.
 - Any defect Engineer should be notified immediately if any discrepancy found therein.

- GENERAL NOTES:**
- THE PROPOSED STORMWATER DRAINAGE WORKS, WHETHER WITHIN OR OUTSIDE THE LOT BOUNDARY, SHALL BE CONSTRUCTED AND MAINTAINED BY THE LOT OWNER AT HIS OWN EXPENSE. FOR WORKS TO BE UNDERTAKEN OUTSIDE THE LOT BOUNDARY, PRIOR CONSENT FROM DLO AND/OR RELEVANT PRIVATE LOT OWNERS SHALL BE SOUGHT.
 - CONSENT FROM THE OWNER / MAINTENANCE PARTY SHALL BE SOUGHT FOR THE PROPOSED DRAINAGE CONNECTION TO THE EXISTING CHANNEL, IN VICINITY OF THE SITE.
- NOTES FOR DRAINAGE WORKS**
- Concrete mix to be grade 300/20 design mix and comply with CSR:1990.
 - Blinding layer to be grade 15P mix.
 - Concrete cover to main steel bar to be 50mm.
 - Reinforcement marked "T" denote mild steel bar (fy=250 MPa) and marked "Y" denote high tensile steel bar (fy=460 MPa) in compliance with B.S.4449: 1988 and CS2: 1995.

Project
PROPOSED
TEMPORARY STRUCTURE
LOT 1293 RP (PART),
In D.D. 117,

Location
TAI TONG,
YUEN LONG, NEW TERRITORIES.

Drawing Description
STORMWATER DRAINAGE PROPOSAL
PLANS,
DETAILS & NOTES

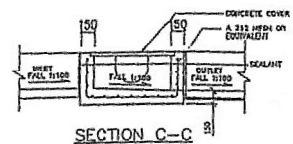

TYPICAL CATCHPIT DETAIL
 SCALE 1:1.5
 (Detail to comply with standard drawing no. C2425H)

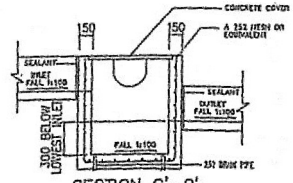

DESILTING CATCHPIT DETAIL
(CP3(D) ONLY)
 SCALE 1:1.5
 (Detail to comply with standard drawing no. C212D)

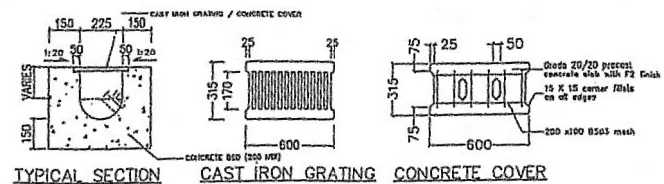
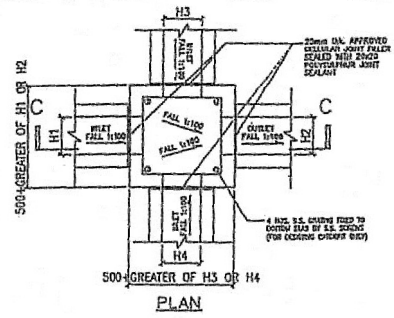

U-CHANNEL DETAILS WITH CAST IRON GRATING / CONCRETE COVER
 SCALE 1:1.5
 (Detail to comply with standard drawing no. C2412D)

- NOTE:**
- ALL CHANNELS SHOULD HAVE A FALL OF 1:100
 - CONCRETE COVER TO BE 50mm.
 - BLINDING LAYER TO BE 15P MIX.

Figure 5
 EXISTING DRAINAGE
 System at the
 Application Site
 on : 25.4.2019

(摘錄自申請人於 19.6.2019 呈交的申請書)
 (Extract from Applicant's
 Submission of 19.6.2019)

參考編號 REFERENCE No. A/YL-TT/475	繪圖 DRAWING A-2
--------------------------------------	-------------------

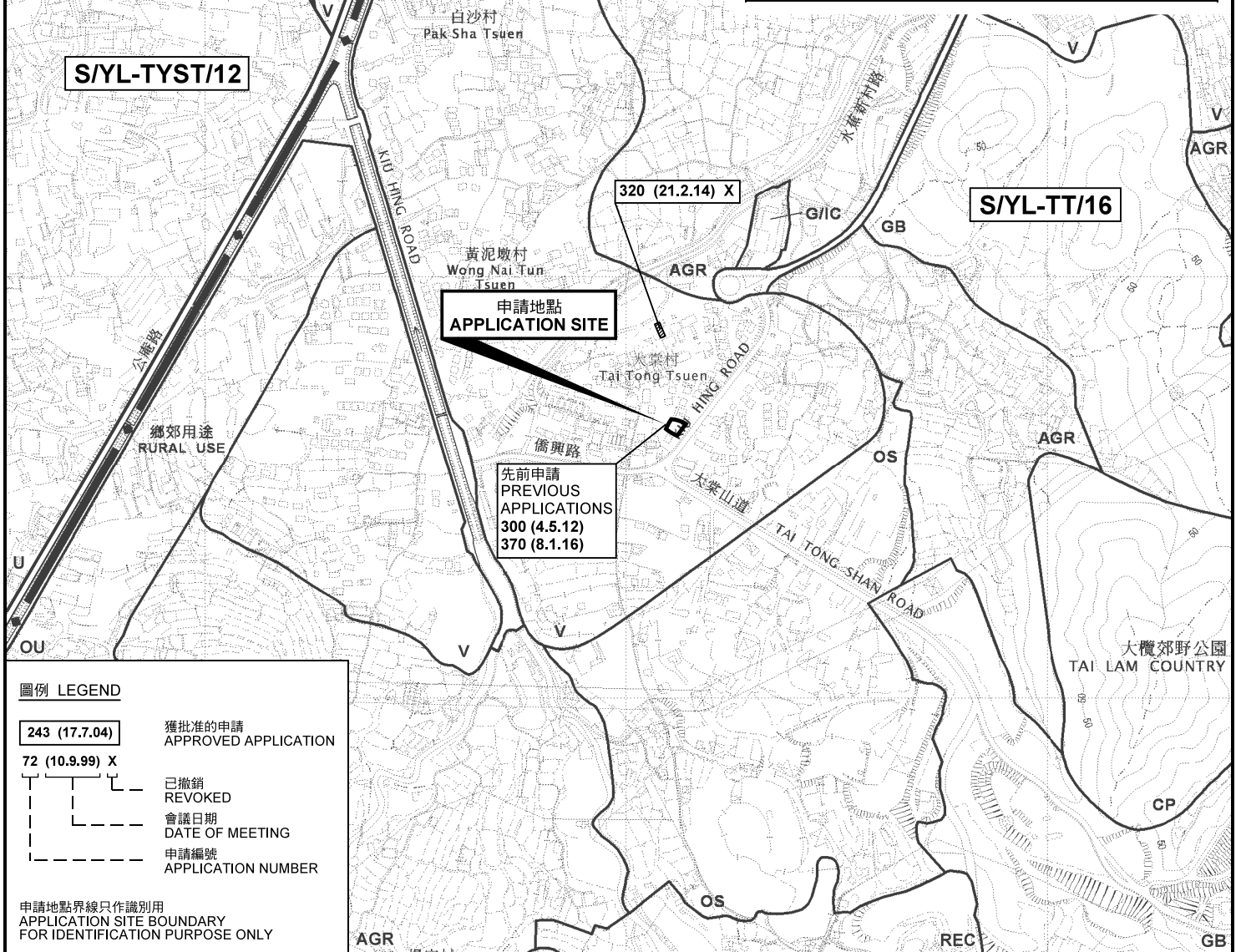
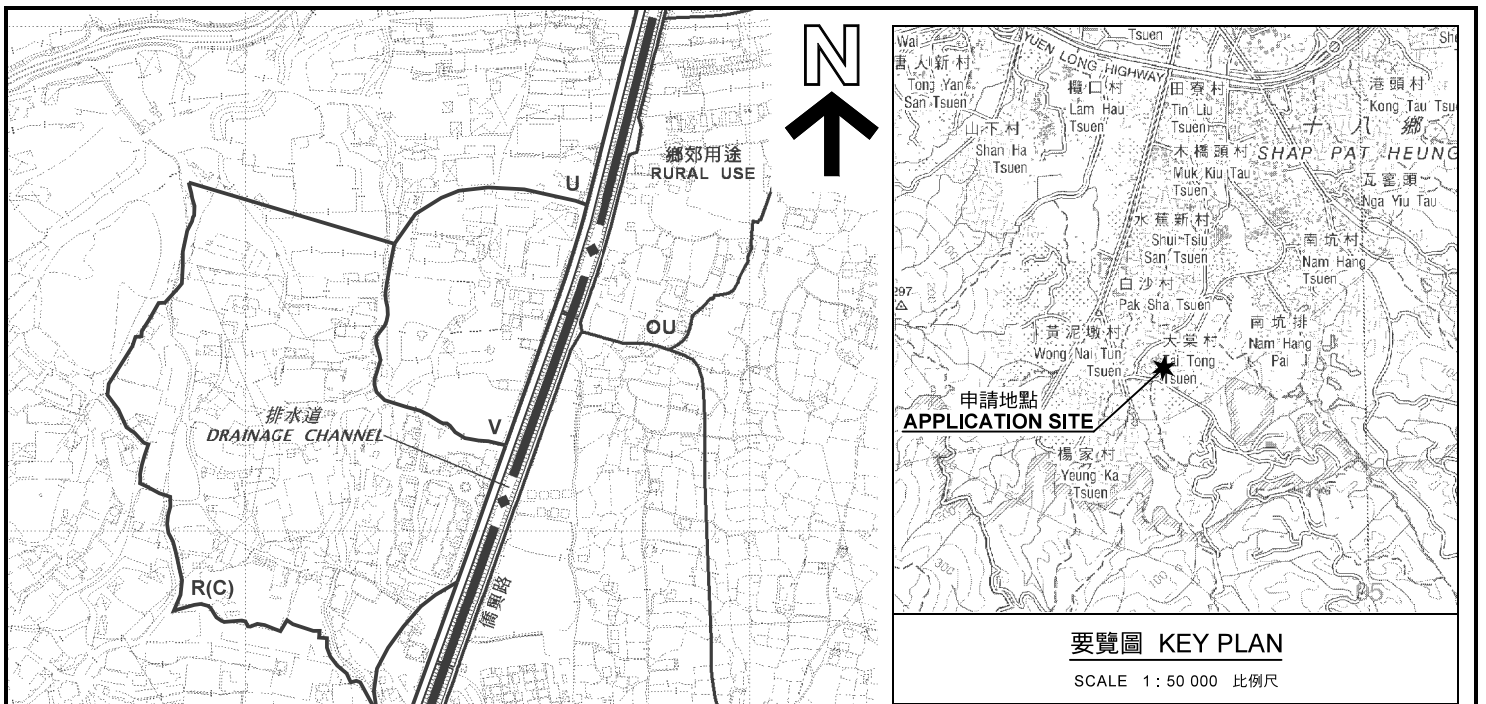

位置圖 LOCATION PLAN

臨時商店及服務行業（地產代理）（為期3年）
元朗大堂丈量約份第117約地段第1293號餘段（部分）
TEMPORARY SHOP AND SERVICES
(REAL ESTATE AGENCY) FOR A PERIOD OF 3 YEARS
LOT 1293 RP (PART) IN D.D.117, TAI TONG, YUEN LONG

規劃署
PLANNING
DEPARTMENT



本摘要圖於2019年8月8日擬備，
所根據的資料為於2012年3月13日
核准的分區計劃大綱圖編號 S/YL-TT/16
EXTRACT PLAN PREPARED ON 8.8.2018
BASED ON OUTLINE ZONING PLAN No.
S/YL-TT/16 APPROVED ON 13.3.2012

參考編號
REFERENCE No.
A/YL-TT/475

圖 PLAN
A-1

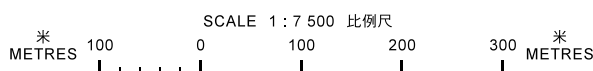



圖例 LEGEND



申請地點 (界線只作識別用)
APPLICATION SITE
(BOUNDARY FOR IDENTIFICATION
PURPOSE ONLY)

本摘要圖於2019年8月9日擬備，所根據的資料為地政總署於2018年3月22日拍得的航攝照片編號 E037246C
EXTRACT PLAN PREPARED ON 9.8.2019
BASED ON AERIAL PHOTO No.
E037246C TAKEN ON 22.3.2018
BY LANDS DEPARTMENT

航攝照片 AERIAL PHOTO

臨時商店及服務行業 (地產代理) (為期3年)
元朗大棠丈量約份第117約地段第1293號餘段 (部分)
TEMPORARY SHOP AND SERVICES
(REAL ESTATE AGENCY) FOR A PERIOD OF 3 YEARS
LOT 1293 RP (PART) IN D.D.117, TAI TONG, YUEN LONG

規劃署
PLANNING
DEPARTMENT



參考編號
REFERENCE No.
A/YL-TT/475

圖 PLAN
A-3



申請地點界線只作識別用 APPLICATION SITE BOUNDARY FOR IDENTIFICATION PURPOSE ONLY

實地照片 SITE PHOTOS

臨時商店及服務行業（地產代理）（為期3年）
元朗大棠丈量約份第117約地段第1293號餘段（部分）
TEMPORARY SHOP AND SERVICES
(REAL ESTATE AGENCY) FOR A PERIOD OF 3 YEARS
LOT 1293 RP (PART) IN D.D.117, TAI TONG, YUEN LONG

規劃署
PLANNING
DEPARTMENT



本圖於2019年8月8日擬備，所根據的資料為攝於2019年6月28日的實地照片
PLAN PREPARED ON 8.8.2019
BASED ON SITE PHOTOS
TAKEN ON 28.6.2019

參考編號
REFERENCE No.
A/YL-TT/475

圖 PLAN
A-4a

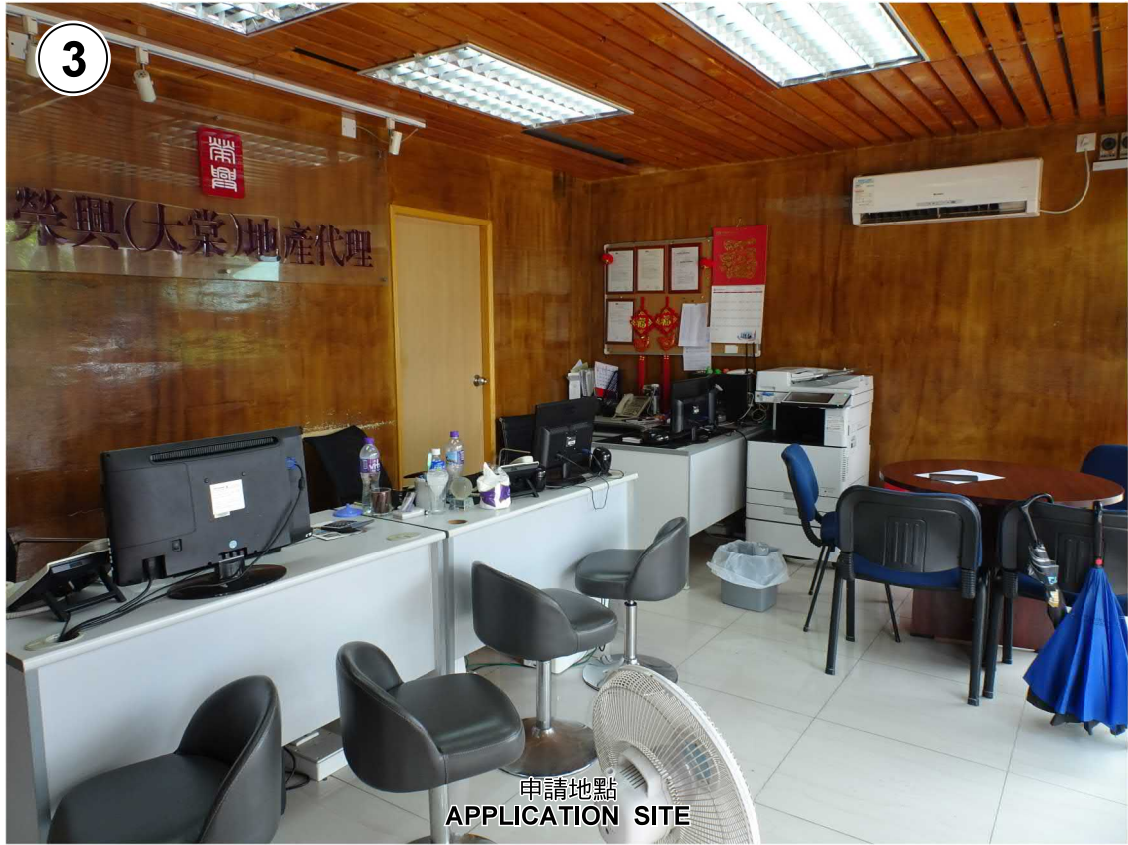

申請地點
APPLICATION SITE

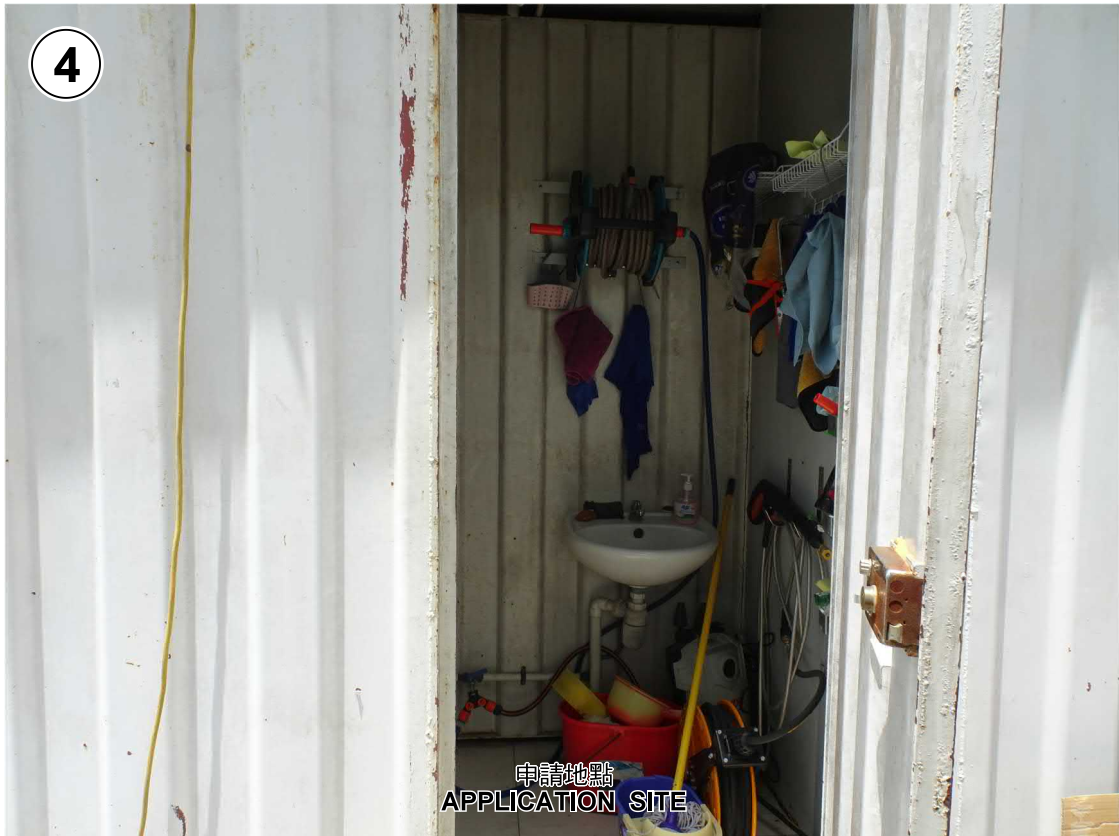

申請地點
APPLICATION SITE

實地照片 SITE PHOTOS

臨時商店及服務行業（地產代理）（為期3年）
元朗大棠丈量約份第117約地段第1293號餘段（部分）
TEMPORARY SHOP AND SERVICES
(REAL ESTATE AGENCY) FOR A PERIOD OF 3 YEARS
LOT 1293 RP (PART) IN D.D.117, TAI TONG, YUEN LONG

規劃署
**PLANNING
DEPARTMENT**



參考編號
REFERENCE No.
A/YL-TT/475

圖 PLAN
A-4b

本圖於2019年8月9日擬備，所根據的資料為攝於2019年6月28日的實地照片
PLAN PREPARED ON 9.8.2019
BASED ON SITE PHOTOS
TAKEN ON 28.6.2019