

<p>Project 項目名稱: Proposed Temporary Open Storage of Construction Machinery and Material for a Period of 3 Years at Lots 2417(Part), 2418(Part) &amp; 2421(Part) in D.D. 120, Tong Yan San Tsuen, Yuen Long, N.T.</p>	<p>Drawing Title 圖名: Location Plan</p>	<p>Remarks 備註: ●●● Vehicular Access Leading to Kung Um Road</p>
	<p>Drawing No. 圖號: Figure 2</p>	<p>Scale 比例: 1:7500</p>

(摘錄自申請人於 31. 1. 2018 呈交的申請書)  
(Extract from Applicant's Submission of 31.1.2018)

<p>參考編號 REFERENCE No. AYL-TYST/882</p>	<p>繪圖 DRAWING A-1</p>
--	---------------------------

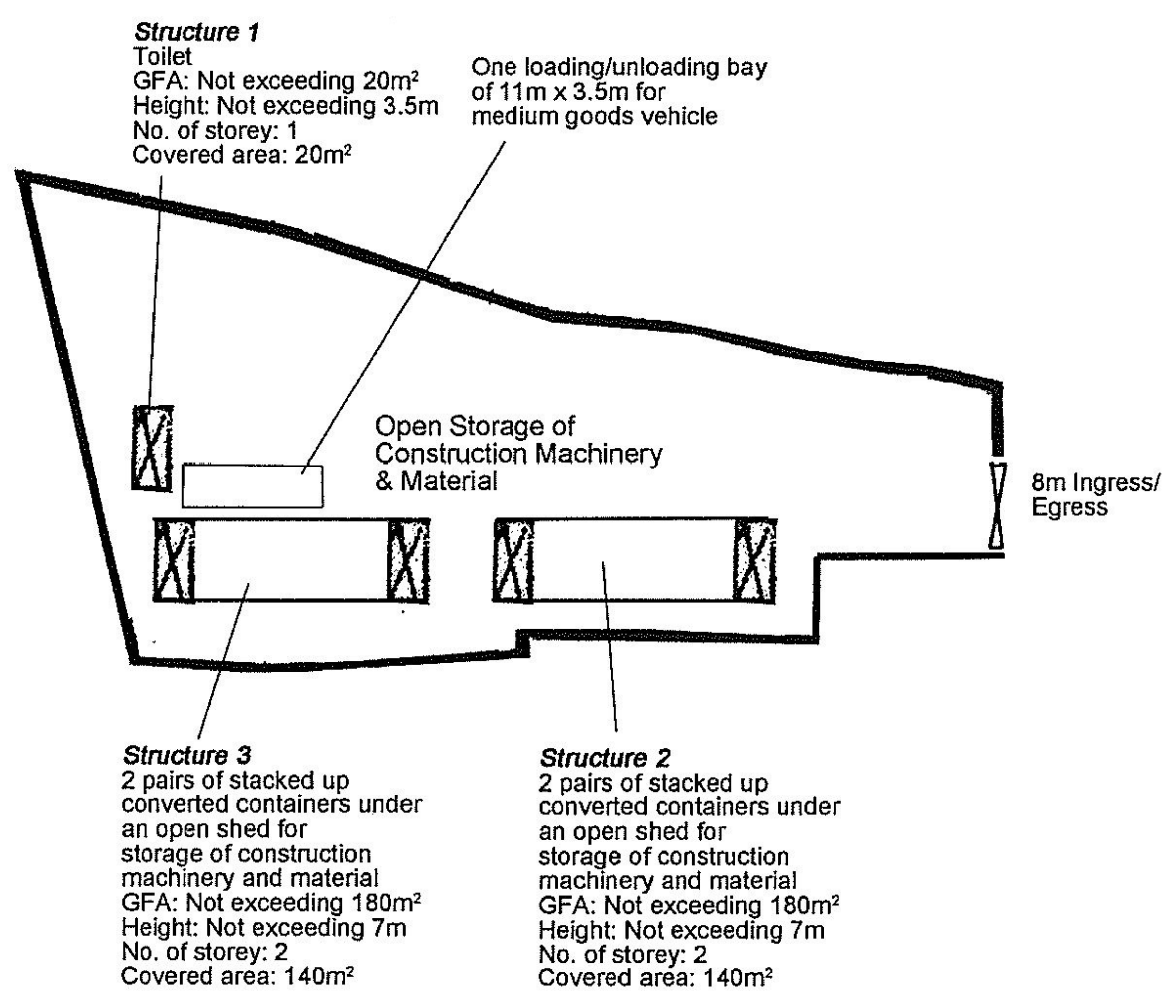

Project 項目名稱: Proposed Temporary Open Storage of Construction Machinery and Material for a Period of 3 Years at Lots 2417(Part), 2418(Part) & 2421(Part) in D.D. 120, Tong Yan San Tsuen, Yuen Long, N.T.	Drawing Title 圖目: Proposed Layout Plan	Remarks 備註:
	Drawing No. 圖號: Figure 3	
		Scale 比例: 1:500

(摘錄自申請人於 31. 1. 2018 提交的申請書)  
(Extract from Applicant's Submission of 31.1.2018)

參考編號 REFERENCE No. AYL-TYST/882	繪圖 DRAWING A-2
---------------------------------------	-------------------



**Structure 1**

Toilet  
 GFA: Not exceeding 20m<sup>2</sup>  
 Height: Not exceeding 3.5m  
 No. of storey: 1  
 Covered area: 20m<sup>2</sup>

One loading/unloading bay  
 of 11m x 3.5m for  
 medium goods vehicle

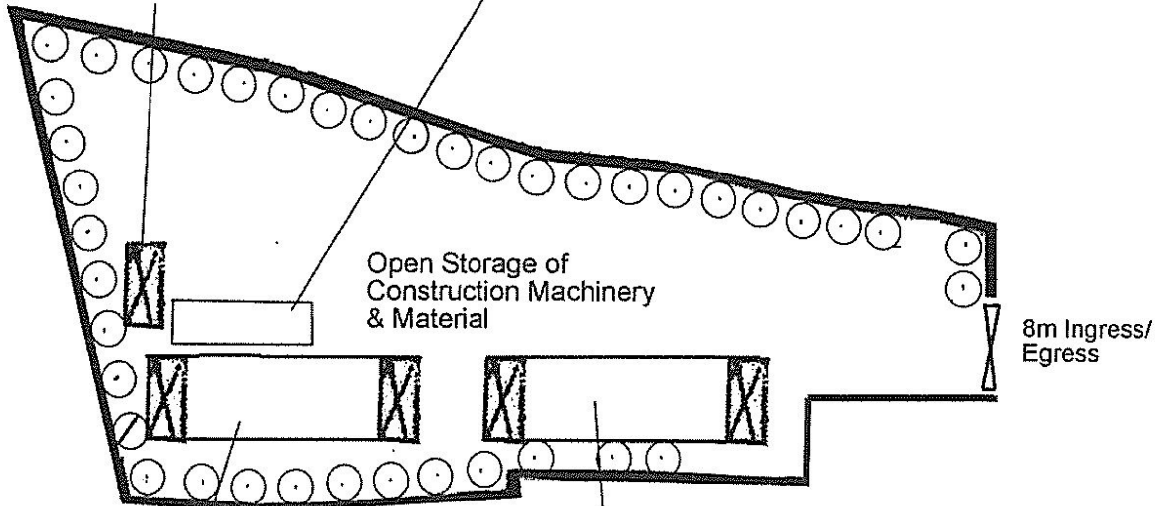

Open Storage of  
 Construction Machinery  
 & Material

8m Ingress/  
 Egress

**Structure 3**

2 pairs of stacked up  
 converted containers under  
 an open shed for  
 storage of construction  
 machinery and material  
 GFA: Not exceeding 180m<sup>2</sup>  
 Height: Not exceeding 7m  
 No. of storey: 2

**Structure 2**

2 pairs of stacked up  
 converted containers under  
 an open shed for  
 storage of construction  
 machinery and material  
 GFA: Not exceeding 180m<sup>2</sup>  
 Height: Not exceeding 7m  
 No. of storey: 2

Tree	Approximate Height	Spacing
Existing <i>Ficus microcarpa</i> to be preserved	3m to 5m	3m to 4m
Proposed <i>Bauhinia blakeana</i> / <i>Melaleuca leucadendron</i> to replace the missing tree	2.75m	4m

Project 項目名稱:

Proposed Temporary Open Storage of Construction Machinery and Material for a Period of 3 Years at Lots 2417(Part), 2418(Part) & 2421(Part) in D.D. 120, Tong Yan San Tsuen, Yuen Long, N.T.

Drawing Title 圖目:

Proposed Landscape & Tree Preservation Plan

Drawing No. 圖號:

Figure 4

Remarks 備註:

Scale 比例:

1:500

(摘錄自申請人於 31. 1. 2018 提交的申請書)  
 (Extract from Applicant's  
 Submission of 31.1.2018)

參考編號  
 REFERENCE No.  
 AYL-TYST/882

繪圖 DRAWING  
 A-3

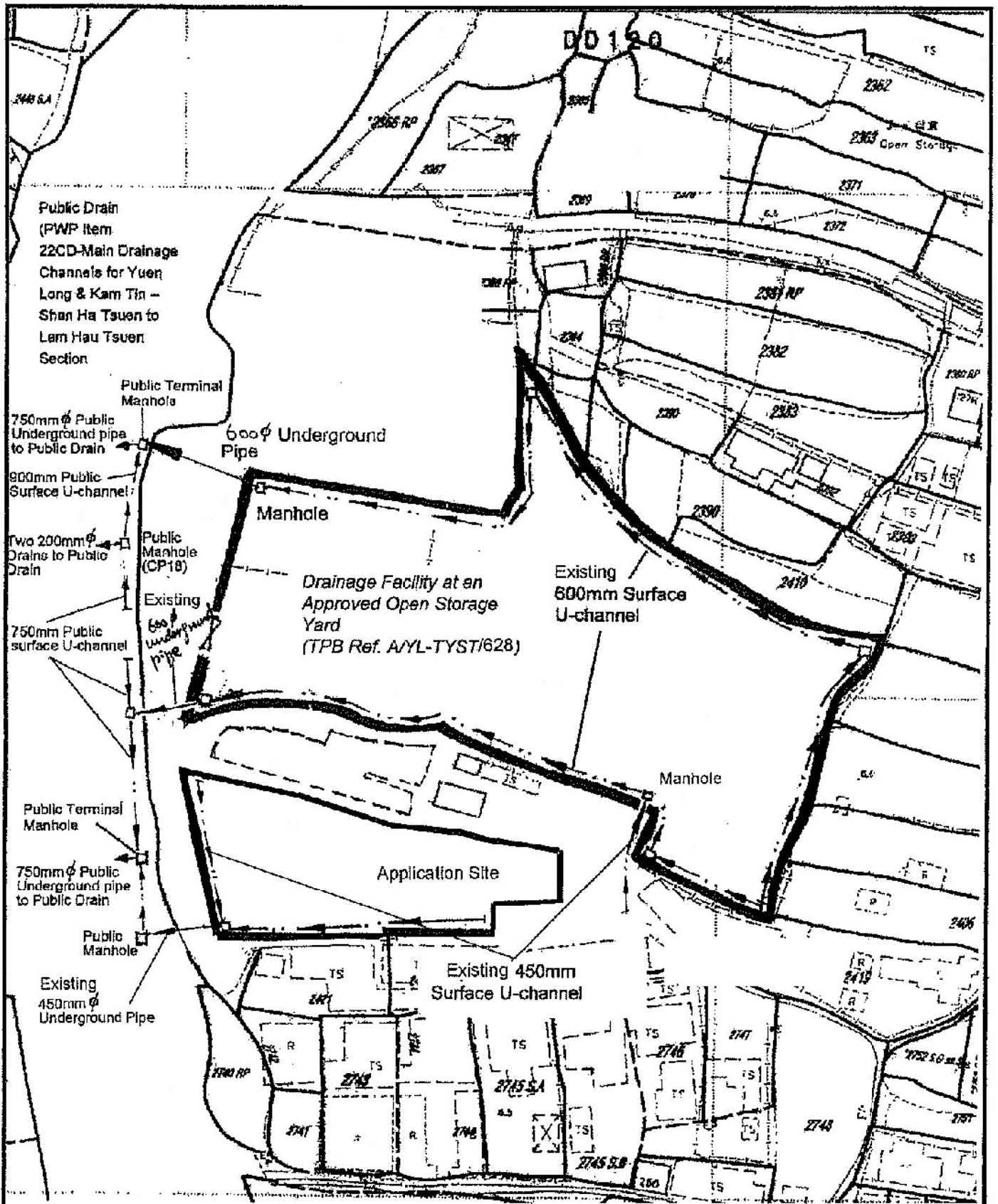

<p>Project 項目名稱:  <b>Proposed Temporary Open Storage of Construction Machinery and Material for a Period of 3 Years at Lots 2417(Part), 2418(Part) &amp; 2421(Part) in D.D. 120, Tong Yan San Tsuen, Yuen Long, N.T.</b></p>	<p>Drawing Title 圖目:  <b>As-built Drainage Plan</b></p>	<p>Remarks 備註:          As-built drainage plan has been approved by DSD for previous planning permission No. AYL-TYST/318</p>
	<p>Drawing No. 圖號:  <b>Figure 5</b></p>	<p>Scale 比例:  <b>Not to scale</b></p>

(摘錄自申請人於 31. 1. 2018 呈交的申請書)  
 (Extract from Applicant's Submission of 31.1.2018)

<p>參考編號  <b>REFERENCE No.          AYL-TYST/882</b></p>	<p>繪圖 <b>DRAWING</b>  <b>A-4</b></p>
---	--

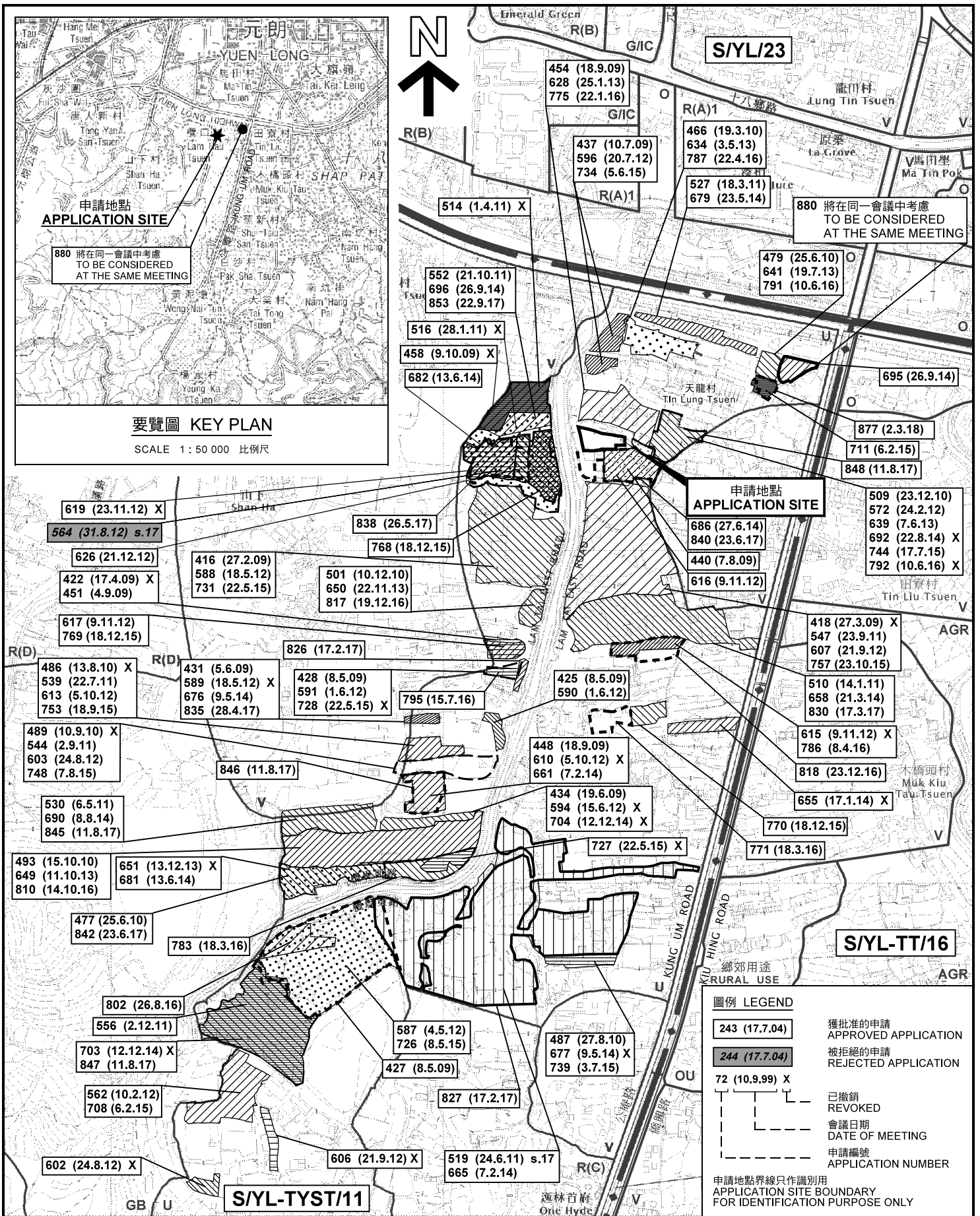

本摘要圖於2018年3月2日擬備，所根據的資料為於2017年9月29日展示的分區計劃大綱圖編號 S/YL-TYST/11 EXTRACT PLAN PREPARED ON 2.3.2018 BASED ON OUTLINE ZONING PLAN NO. S/YL-TYST/11 EXHIBITED ON 29.9.2017

位置圖及同類申請 LOCATION PLAN WITH SIMILAR APPLICATIONS

臨時露天存放建築機械及材料 (為期3年)  
元朗唐人新村丈量約份第120約地段第2417號(部分)、  
第2418號(部分)及2421號(部分)  
TEMPORARY OPEN STORAGE OF CONSTRUCTION MACHINERY  
AND MATERIAL FOR A PERIOD OF 3 YEARS  
LOTS 2417 (PART), 2418 (PART) AND 2421 (PART)  
IN D.D.120, TONG YAN SAN TSUEN, YUEN LONG

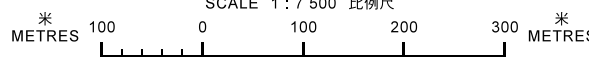

規劃署  
PLANNING  
DEPARTMENT



參考編號  
REFERENCE No.  
A/YL-TYST/882

圖 PLAN  
A-1a

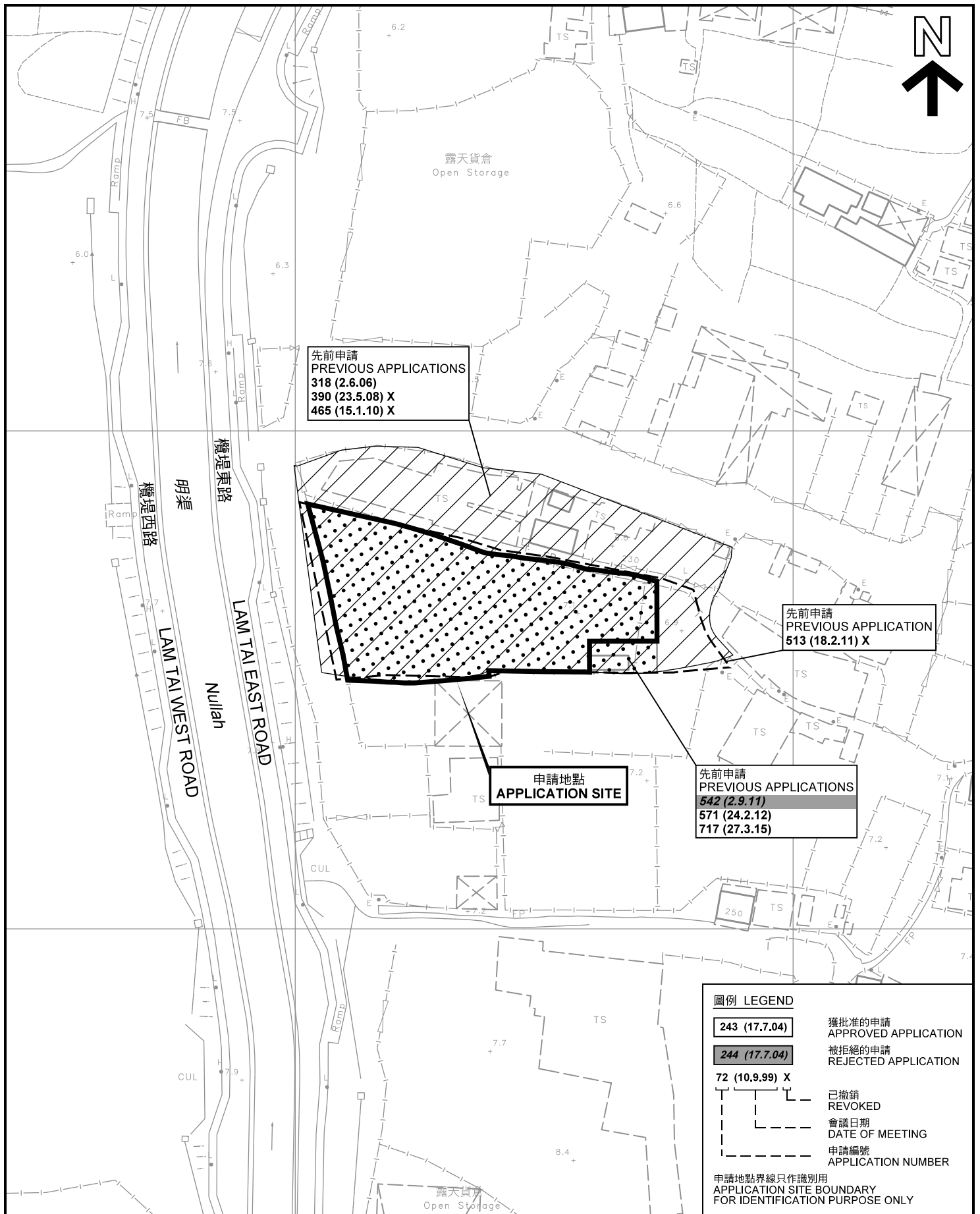

圖例 LEGEND	
243 (17.7.04)	獲批准的申請 APPROVED APPLICATION
244 (17.7.04)	被拒絕的申請 REJECTED APPLICATION
72 (10.9.99) X	已撤銷 REVOKED
- - - - -	會議日期 DATE OF MEETING
- - - - -	申請編號 APPLICATION NUMBER
申請地點界線只作識別用 APPLICATION SITE BOUNDARY FOR IDENTIFICATION PURPOSE ONLY	

**先前申請圖 PREVIOUS APPLICATIONS PLAN**

臨時露天存放建築機械及材料 (為期3年)  
元朗唐人新村丈量約份第120約地段第2417號(部分)、  
第2418號(部分)及2421號(部分)  
TEMPORARY OPEN STORAGE OF CONSTRUCTION MACHINERY  
AND MATERIAL FOR A PERIOD OF 3 YEARS  
LOTS 2417 (PART), 2418 (PART) AND 2421 (PART)  
IN D.D.120, TONG YAN SAN TSUEN, YUEN LONG  
SCALE 1 : 1 000 比例尺

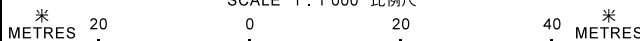

本摘要圖於2018年2月28日擬備，所根據的資料為測量圖編號 6-NW-14C 及 14D  
EXTRACT PLAN PREPARED ON 28.2.2018  
BASED ON SURVEY SHEETS No. 6-NW-14C & 14D

規劃署  
PLANNING  
DEPARTMENT



參考編號  
REFERENCE No.  
AYL-TYST/882

圖 PLAN  
A-1b

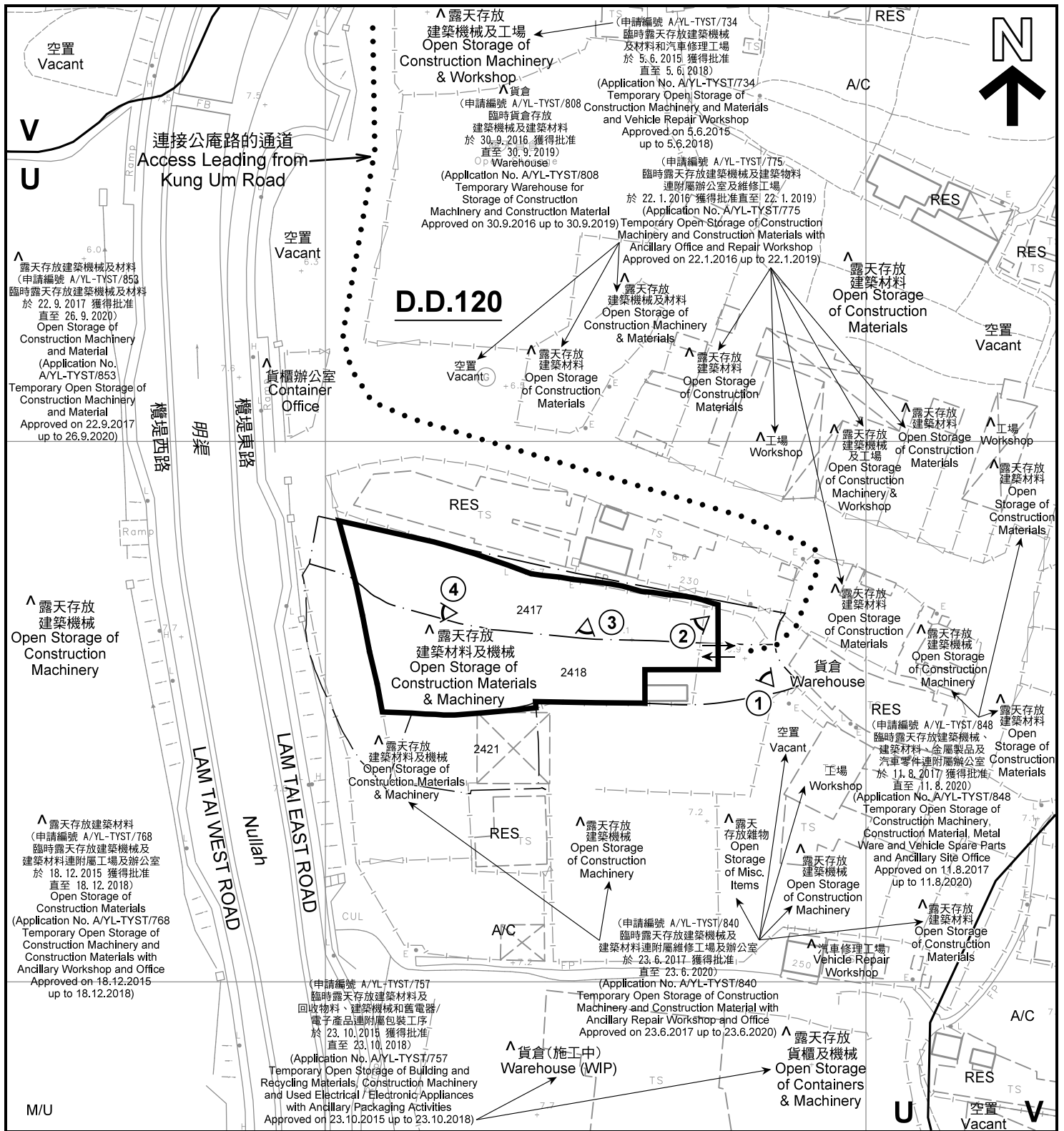

註釋 Notes :

- (1) 2018年2月9日勘測的土地用途  
Land uses shown on this plan are in accordance with the land use survey conducted by the Planning Department on 9.2.2018
- (2) \* 土地用途跟1993年6月21日勘測的土地用途一致  
Indicates that the use is the same as that revealed by the land use survey conducted by the Planning Department on 21.6.1993
- (3) ^ 土地用途跟1993年6月21日勘測的土地用途有別  
Indicates that the use is different from that revealed by the land use survey conducted by the Planning Department on 21.6.1993

圖例 LEGEND

	申請地點(界線只作識別用) APPLICATION SITE (BOUNDARY FOR IDENTIFICATION PURPOSE ONLY)	M/U	荒地 UNUSED LAND
	鄉村式發展 VILLAGE TYPE DEVELOPMENT	A/C	常耕農地 CULTIVATED AGRICULTURAL LAND
	未決定用途 UNDETERMINED	WIP	施工中 WORKS IN PROGRESS
	住用構築物 RESIDENTIAL STRUCTURES	①	實地照片的觀景點 VIEWING POINT OF SITE PHOTO
			入口/出口 INGRESS / EGRESS

平面圖 SITE PLAN

臨時露天存放建築機械及材料 (為期3年)  
元朗唐人新村丈量約份第120約地段第2417號(部分)、  
第2418號(部分)及2421號(部分)  
TEMPORARY OPEN STORAGE OF CONSTRUCTION MACHINERY  
AND MATERIAL FOR A PERIOD OF 3 YEARS  
LOTS 2417 (PART), 2418 (PART) AND 2421 (PART)  
IN D.D.120, TONG YAN SAN TSUEN, YUEN LONG  
SCALE 1 : 1 000 比例尺

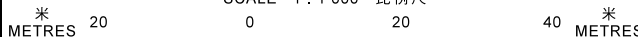

本摘要圖於2018年2月28日擬備, 所根據的資料為測量圖編號 6-NW-14C 及 14D  
EXTRACT PLAN PREPARED ON 28.2.2018  
BASED ON SURVEY SHEETS No.  
6-NW-14C & 14D

規劃署  
PLANNING  
DEPARTMENT



參考編號  
REFERENCE No.  
AYL-TYST/882

圖 PLAN  
A-2

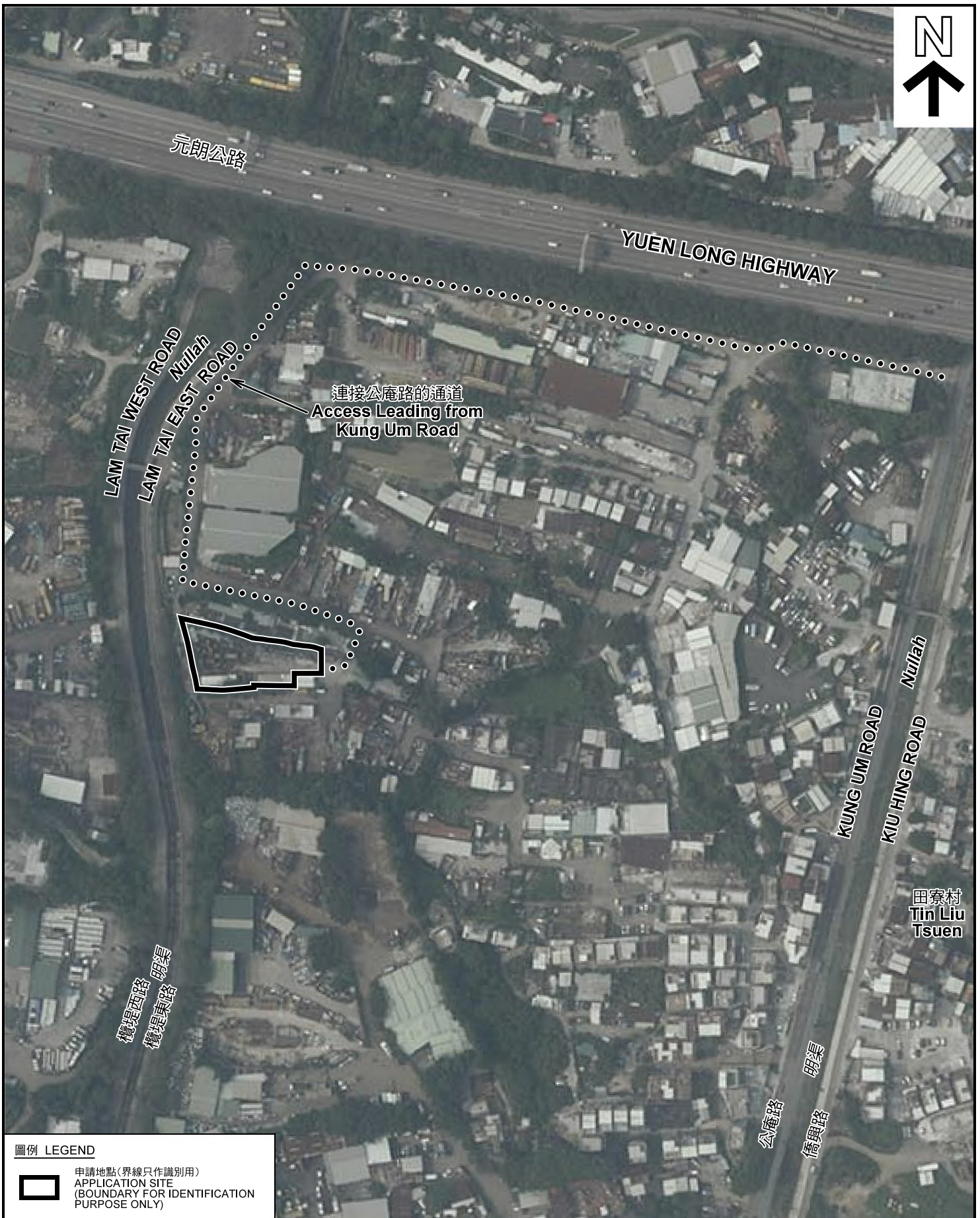

圖例 LEGEND



申請地點(界線只作識別用)  
APPLICATION SITE  
(BOUNDARY FOR IDENTIFICATION  
PURPOSE ONLY)

本摘要圖於2018年2月28日擬備，所根據的資料為地政總署於2017年4月29日拍得的航攝照片編號 E023541C  
EXTRACT PLAN PREPARED ON 28.2.2018  
BASED ON AERIAL PHOTO No.  
E023541C TAKEN ON 29.4.2017  
BY LANDS DEPARTMENT

航攝照片 AERIAL PHOTO

臨時露天存放建築機械及材料(為期3年)  
元朗唐人新村丈量約份第120約地段第2417號(部分)、  
第2418號(部分)及2421號(部分)  
TEMPORARY OPEN STORAGE OF CONSTRUCTION MACHINERY  
AND MATERIAL FOR A PERIOD OF 3 YEARS  
LOTS 2417 (PART), 2418 (PART) AND 2421 (PART)  
IN D.D.120, TONG YAN SAN TSUEN, YUEN LONG

規劃署  
PLANNING  
DEPARTMENT



參考編號  
REFERENCE No.  
AYL-TYST/882

圖 PLAN  
A-3



1

申請地點  
APPLICATION SITE

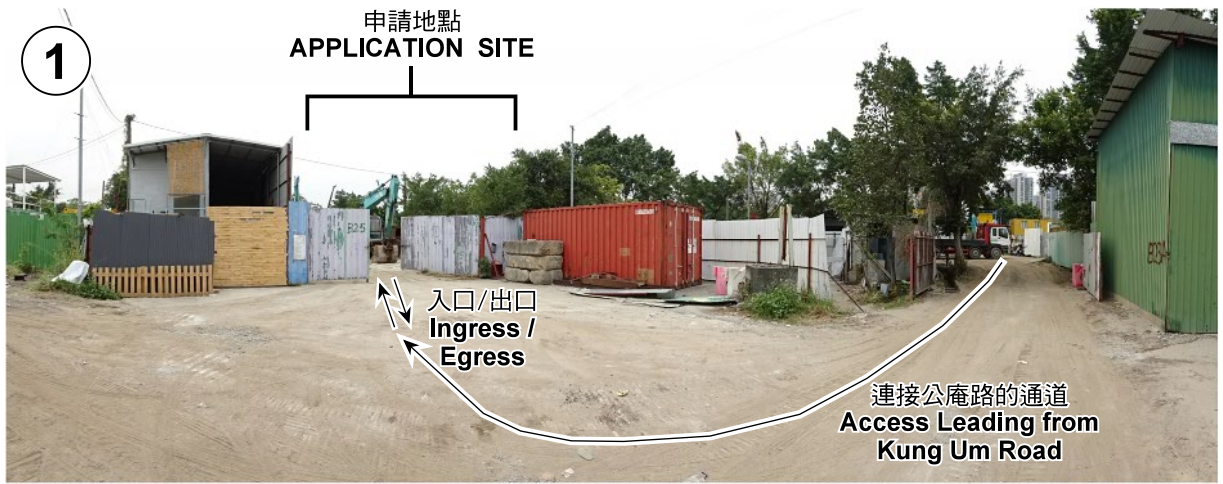

連接公庵路的通道  
Access Leading from  
Kung Um Road

2



申請地點  
APPLICATION SITE

3



申請地點  
APPLICATION SITE

4



申請地點  
APPLICATION SITE

實地照片 SITE PHOTOS

臨時露天存放建築機械及材料 (為期3年)  
元朗唐人新村丈量約份第120約地段第2417號(部分)、  
第2418號(部分)及2421號(部分)  
TEMPORARY OPEN STORAGE OF CONSTRUCTION MACHINERY  
AND MATERIAL FOR A PERIOD OF 3 YEARS  
LOTS 2417 (PART), 2418 (PART) AND 2421 (PART)  
IN D.D.120, TONG YAN SAN TSUEN, YUEN LONG

規劃署  
PLANNING  
DEPARTMENT



參考編號  
REFERENCE No.  
AYL-TYST/882

圖 PLAN  
A-4

本圖於2018年2月28日擬備，所根據的資料為攝於2018年2月9日的實地照片  
PLAN PREPARED ON 28.2.2018  
BASED ON SITE PHOTOS  
TAKEN ON 9.2.2018