

Extracted from Approved Tong Yan San Tsuen Outline Zoning Plan No. S/YL-TYST/12

Not to Scale	Location Plan	Goldrich Planners & Surveyors Ltd.
December 2018	Lot Nos. 326 (Part), 327 S.A (Part), 327 S.Ass.1 (Part), 327 S.B (Part), 327 S.C (Part), 327 S.D (Part) and 328 (Part) in D.D. 119, Shan Ha Tsuen, Yuen Long, New Territories	Plan 1 (P 6024)

(摘錄自申請人於 17. 1. 2019 提交的申請書)
(Extract from Applicant's Submission of 17.1.2019)

參考編號 REFERENCE No. A/YL-TYST/946	繪圖 DRAWING A-1
----------------------------------------	-------------------

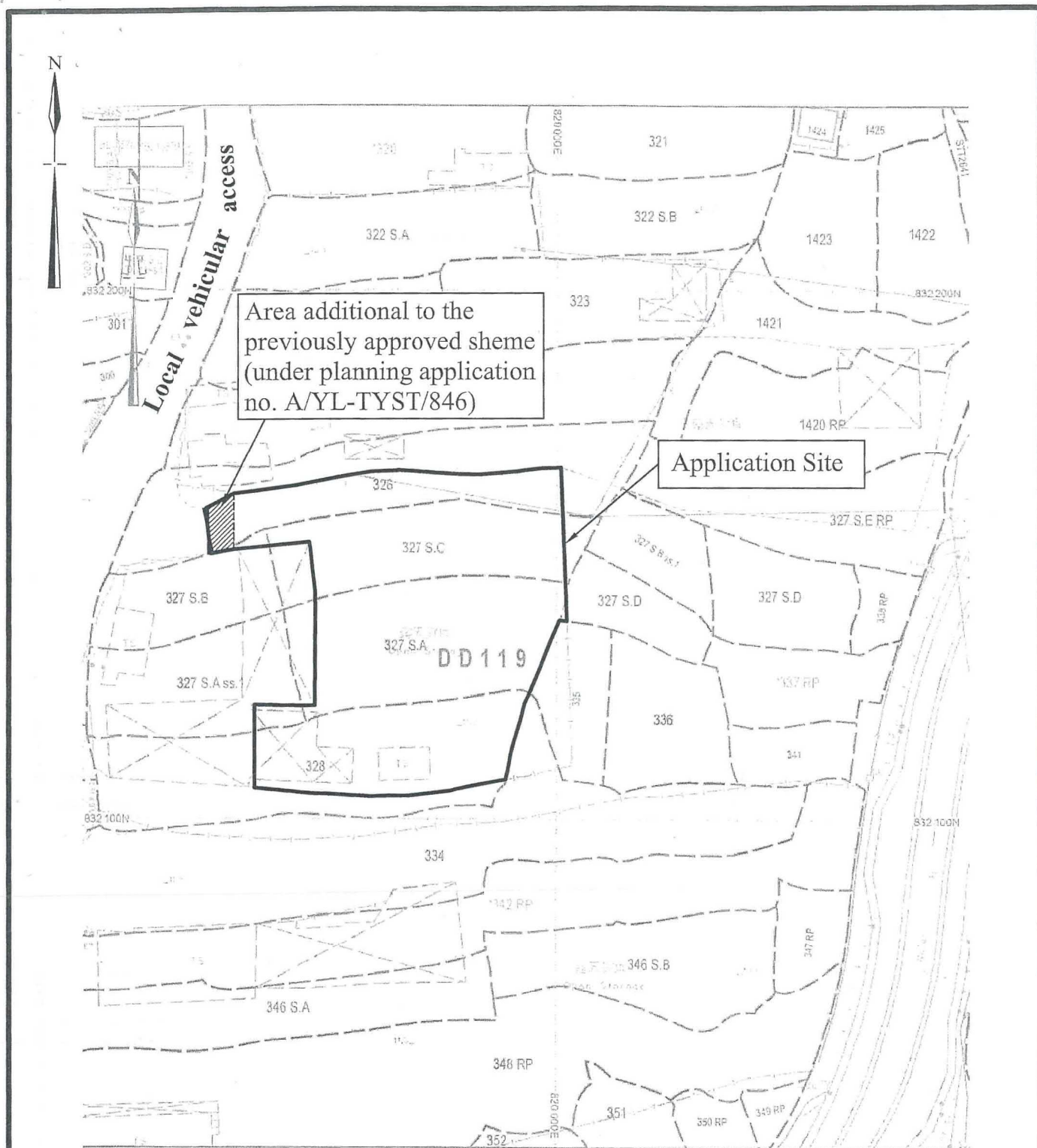

Site Area under the previously approved scheme
(application no. A/YL-TYST/846) (about): 2,955.4m²

 Additional Site Area (about): 47m²

Proposed Site Area (about): 3002.4m²

1:1000	Lot Index Plan	Goldrich Planners & Surveyors Ltd.
December 2018	Lot Nos. 326 (Part), 327 S.A (Part), 327 S.Ass.1 (Part), 327 S.B (Part), 327 S.C (Part), 327 S.D (Part) and 328 (Part) in D.D. 119, Shan Ha Tsuen, Yuen Long, New Territories	Plan 3 (P 6024)

(摘錄自申請人於 17. 1. 2019 呈交的申請書)
(Extract from Applicant's
Submission of 17.1.2019)

參考編號 REFERENCE No. A/YL-TYST/946	繪圖 DRAWING A-2
----------------------------------------	-------------------

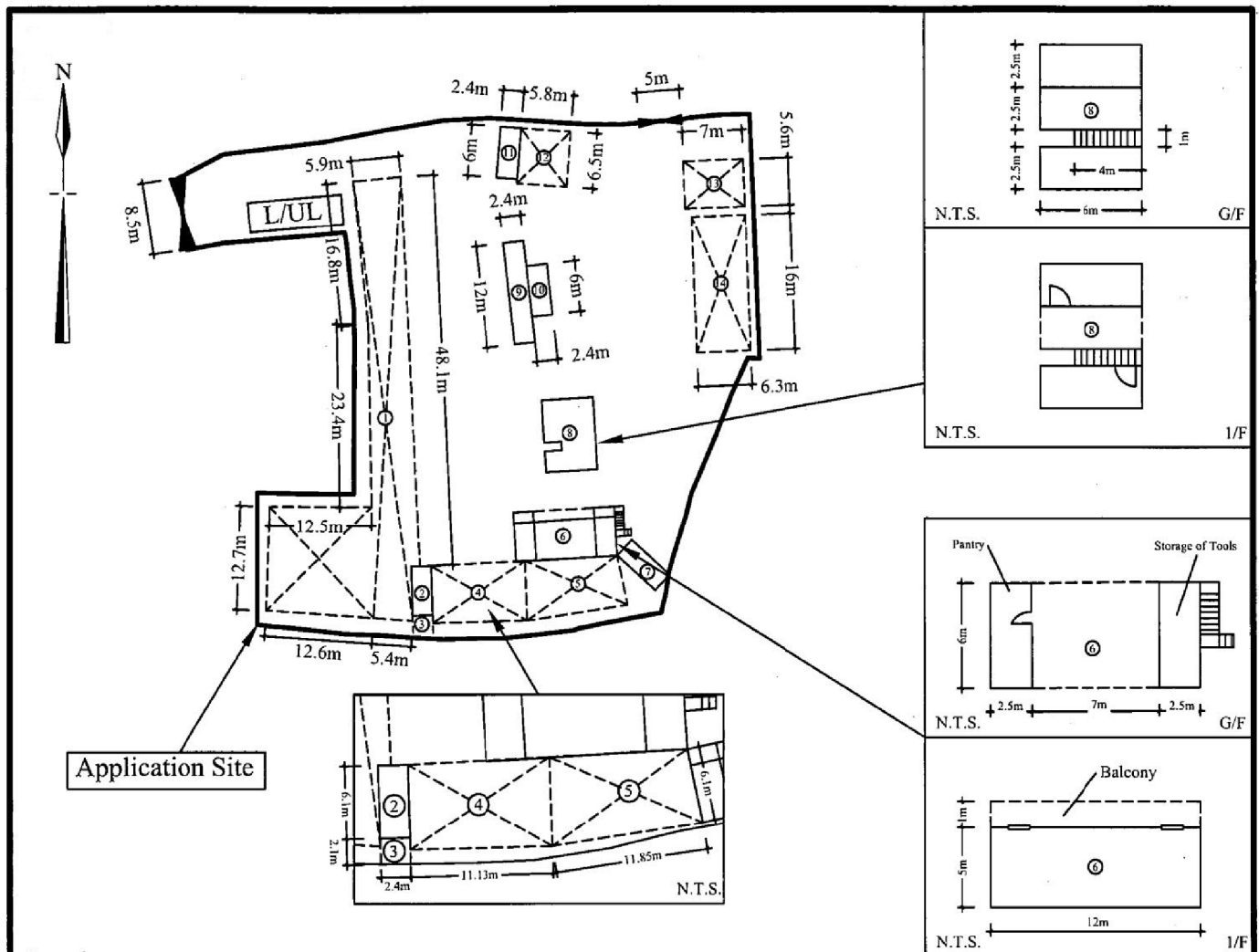

Application Site

Legend

- Vehicular Ingress/ Egress
- Loading/ unloading space for Medium Goods Vehicle (11m(L) x 3.5m(W))

Total Site Area: 3,002.4m²

No.	Structures	Covered Area (m ²)	Floor Area (m ²)	Height(m)
1	Open Shed (Storage)	473.6	473.6	4.2
2	Tool storeroom (G/F) and Equipment Container (1/F)	14.64	29.28	5.2
3	Open Shed (Storage)	5.04	5.04	2.6
4	Open Shed (Workshop)	82.72	82.72	5.2
5	Open Shed (Workshop)	78.17	78.17	3
6	Site Office	72	136.4	5.2
7	Site Office	15	15	2.6
8	Storeroom (G/F) and Site Office (1/F)	49	79	5.2
9	Container - converted Storeroom	28.8	28.8	2.6
10	2-Storey Container - converted Storeroom	14.4	28.8	5.2
11	Container - converted Storeroom	14.4	14.4	2.6
12	Open Shed (Workshop)	37.7	37.7	2.6
13	Open Shed (Workshop)	39.2	39.2	2.6
14	Open Shed (Workshop)	100.8	100.8	2.6
	Total	<u>1,025.47</u>	<u>1,148.91</u>	-

-1:750-	Site Plan	Goldrich Planners & Surveyors Ltd.
December 2018	Lot Nos. 326 (Part), 327 S.A (Part), 327 S.Ass.1 (Part), 327 S.B (Part), 327 S.C (Part), 327 S.D (Part) and 328 (Part) in D.D. 119, Shan Ha Tsuen, Yuen Long, New Territories	Plan 4 (P 6024)

(摘錄自申請人於 17. 1. 2019 提交的申請書)
(Extract from Applicant's Submission of 17.1.2019)

參考編號 REFERENCE No. A/YL-TYST/946	繪圖 DRAWING A-3
----------------------------------------	-------------------

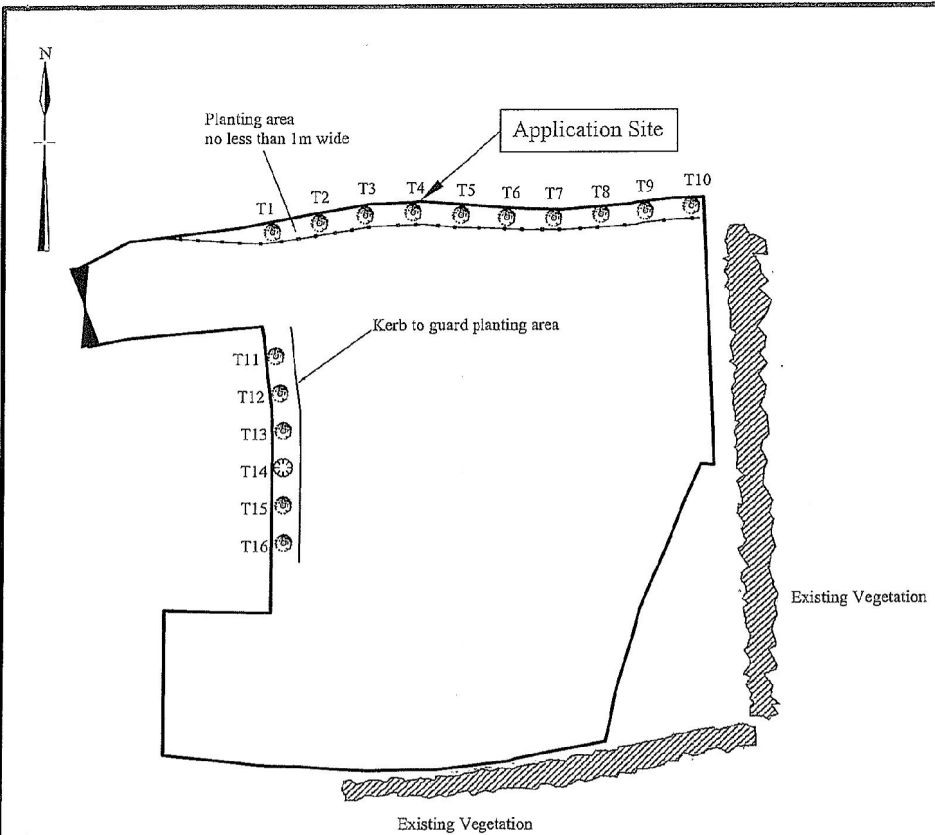

Notes:
All of the 16 existing trees are planted at grade.

Legend

	Vehicular Ingress/ Egress	Spacing (Centre to Centre)	Min. Size (Height)	Quantity
⊙	Existing Ficus Microcarpa(細葉榕) (Planted under previous application A/YL-TYST/661)	4m	2.75m	15
⊗	Existing Celtis sinensis(朴樹)	4m	2.75m	1
			Total:	16

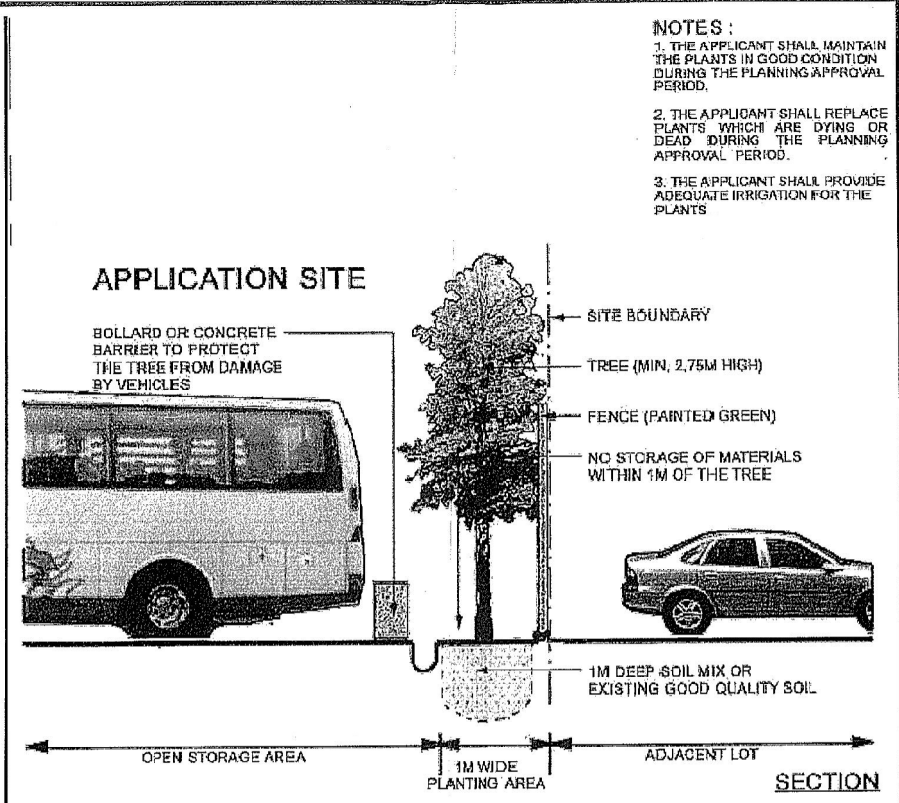

- NOTES:**
1. THE APPLICANT SHALL MAINTAIN THE PLANTS IN GOOD CONDITION DURING THE PLANNING APPROVAL PERIOD.
 2. THE APPLICANT SHALL REPLACE PLANTS WHICH ARE DYING OR DEAD DURING THE PLANNING APPROVAL PERIOD.
 3. THE APPLICANT SHALL PROVIDE ADEQUATE IRRIGATION FOR THE PLANTS

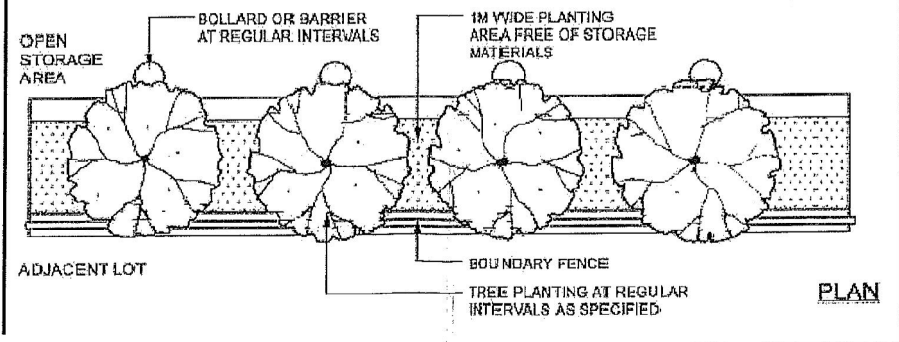

1:500
December 2018

Landscape and Tree Preservation Proposal
(Revised from the previously approved plan under planning application no. A/YL-TYST/846)
Lot 326 (Part), 327 S.A (Part), 327 S.Ass.1 (Part), 327 S.B (Part), 327 S.C (Part), 327 S.D (Part),
328 (Part), 334 (Part) and 335 (Part) in D.D. 119

Goldrich Planners
& Surveyors Ltd.

Plan 5
(P 6024)

(摘錄自申請人於 17.1.2019 呈交的申請書)
(Extract from Applicant's
Submission of 17.1.2019)

參考編號 REFERENCE No. A/YL-TYST/946	繪圖 DRAWING A-4
----------------------------------------	-------------------

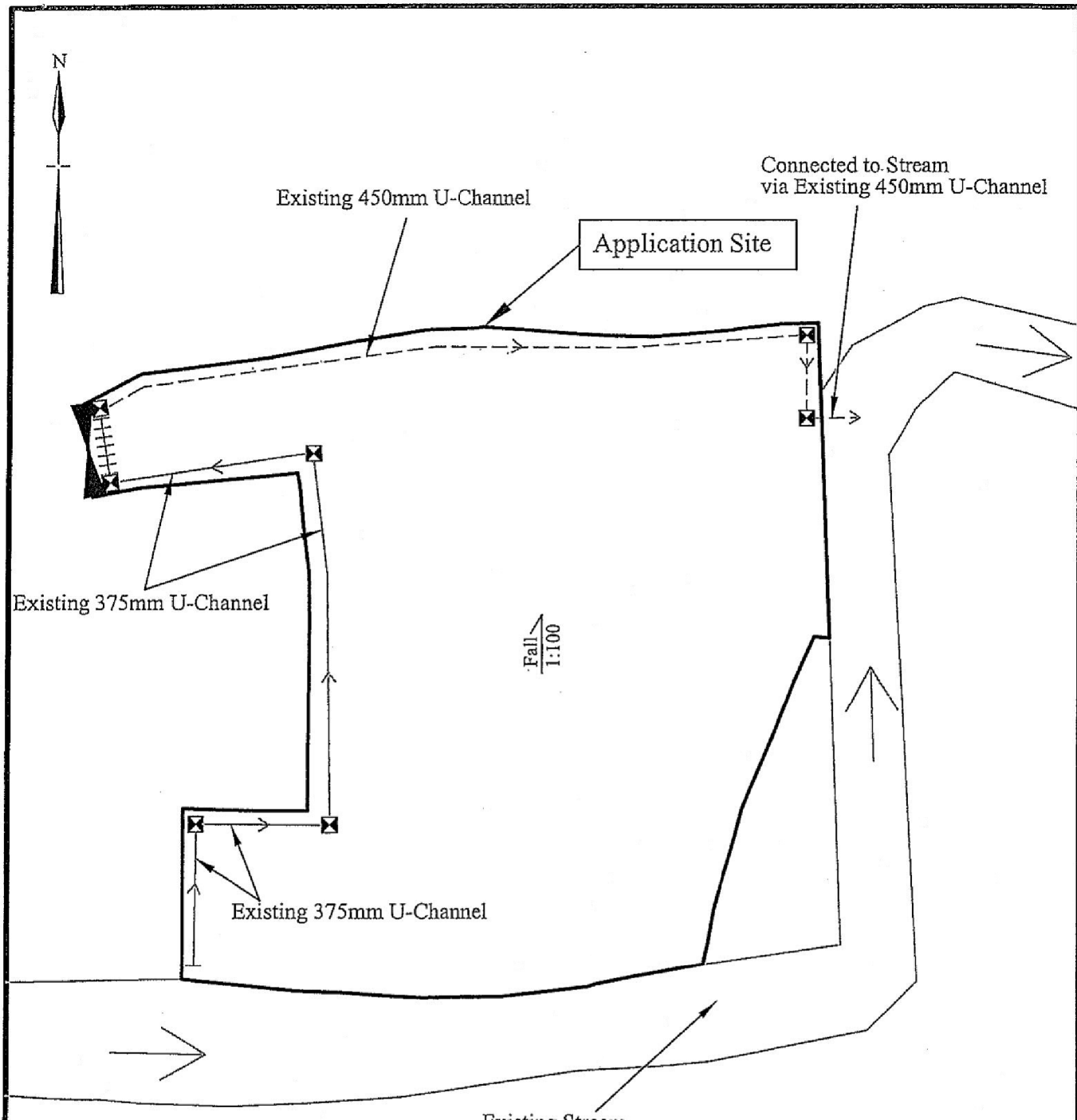

Total Site Area: 3,002.4m²

Legend

- Vehicular Ingress/ Egress
- Existing Catchpit
- Existing 375mm U-Channel
- Existing 450mm U-Channel
- Existing U-Channel with C.I. Cover

1:500	<p>Drainage Proposal (Revised from the previously approved plan under planning applicaiton no. A/YL-TYST/846)</p>	<p>Goldrich Planners & Surveyors Ltd.</p>
December 2018	<p>Lot Nos. 326 (Part), 327 S.A (Part), 327 S.Ass.1 (Part), 327 S.B (Part), 327 S.C (Part), 327 S.D (Part) and 328 (Part) in D.D. 119, Shan Ha Tsuen, Yuen Long, New Territories</p>	<p>Plan 6 (P 6024)</p>

(摘錄自申請人於 17. 1. 2019 提交的申請書)
 (Extract from Applicant's
 Submission of 17.1.2019)

參考編號 REFERENCE No. A/YL-TYST/946	繪圖 DRAWING A-5
-----------------------------------------------	--------------------------

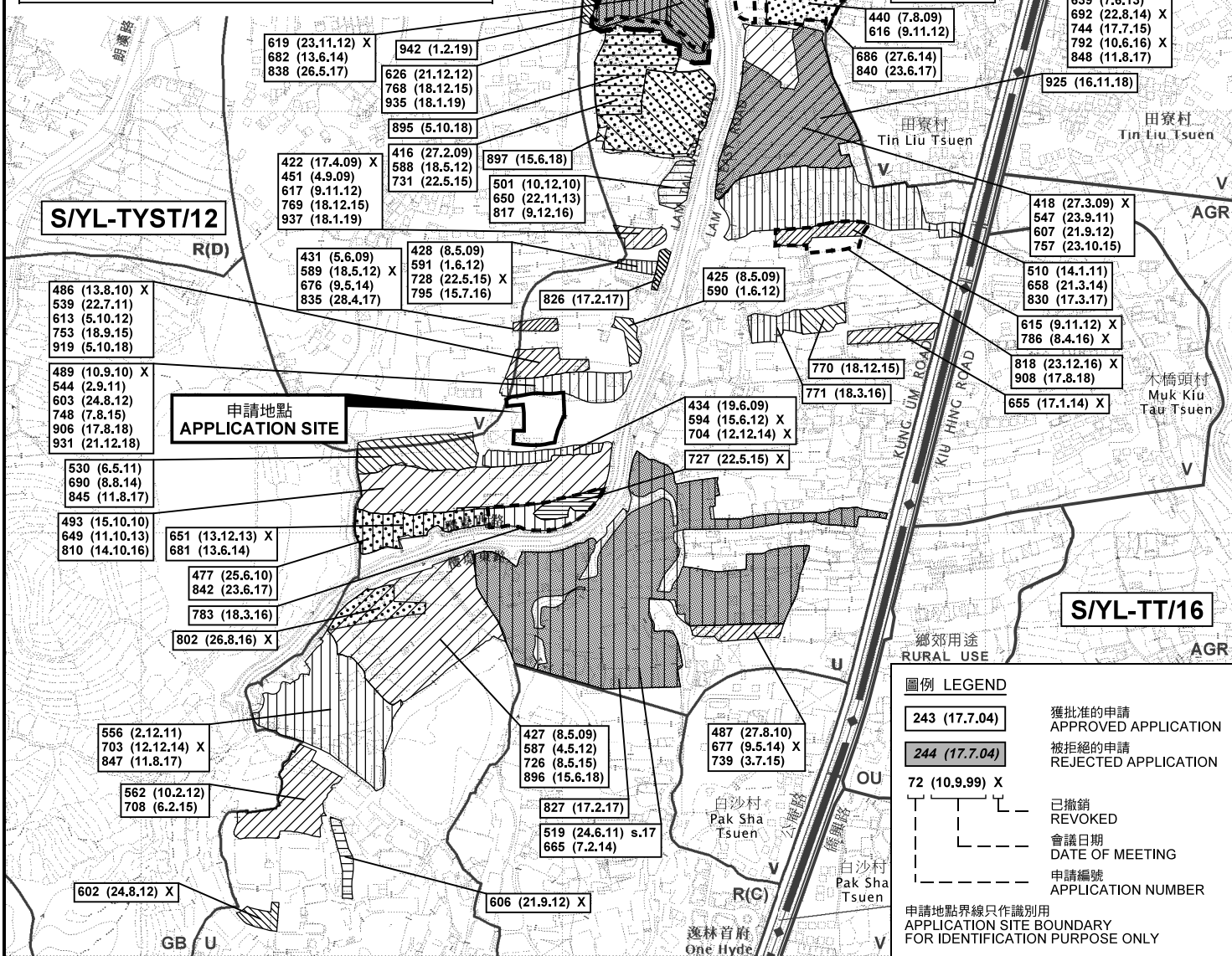
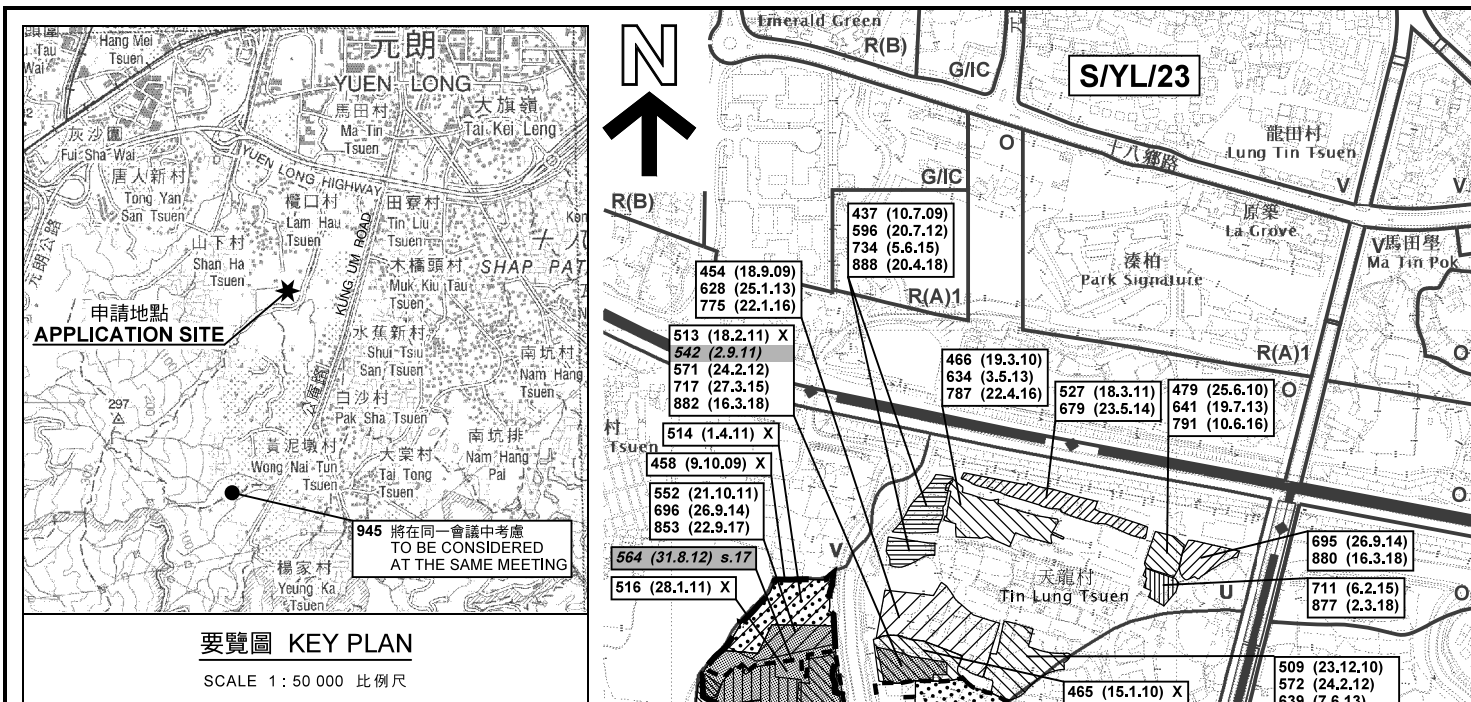

位置圖及同類申請 LOCATION PLAN WITH SIMILAR APPLICATIONS

臨時露天存放回收貨物(二手電子產品)連附屬工場及場地辦公室(為期3年)
元朗山下村丈量約份第119約地段第326號(部分)、
第327號A分段(部分)、第327號A分段第1小分段(部分)、
第327號B分段(部分)、第327號C分段(部分)、第327號D分段(部分)及第328號(部分)
TEMPORARY OPEN STORAGE OF RECYCLED GOODS (USED ELECTRONIC APPLIANCES)
WITH ANCILLARY WORKSHOP AND SITE OFFICE FOR A PERIOD OF 3 YEARS
LOTS 326 (PART), 327 S.A (PART), 327 S.A ss.1 (PART), 327 S.B (PART), 327 S.C (PART),
327 S.D (PART) AND 328 (PART) IN D.D.119, SHAN HA TSUEN, YUEN LONG

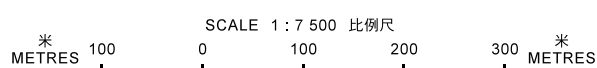

本摘要圖於2019年2月22日擬備，
所根據的資料為於2018年9月4日
核准的分區計劃大綱圖編號 S/YL-TYST/12
EXTRACT PLAN PREPARED ON 22.2.2019
BASED ON OUTLINE ZONING PLAN No.
S/YL-TYST/12 APPROVED ON 4.9.2018

規劃署
PLANNING
DEPARTMENT



參考編號
REFERENCE No.
A/YL-TYST/946

圖 PLAN
A-1a

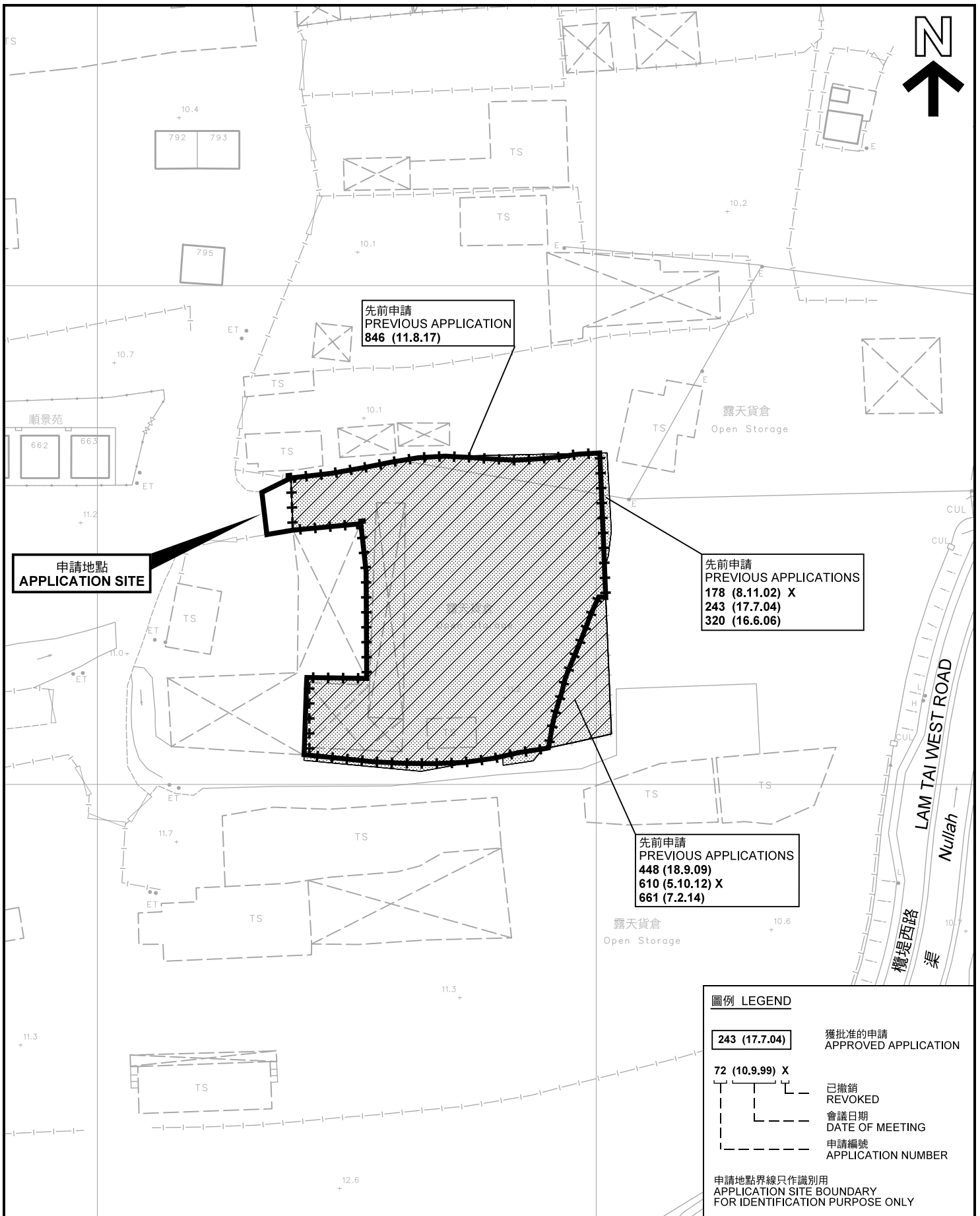

圖例 LEGEND	
243 (17.7.04)	獲批准的申請 APPROVED APPLICATION
72 (10.9.99) X	已撤銷 REVOKED
—	會議日期 DATE OF MEETING
—	申請編號 APPLICATION NUMBER
申請地點界線只作識別用 APPLICATION SITE BOUNDARY FOR IDENTIFICATION PURPOSE ONLY	

先前申請圖 PREVIOUS APPLICATIONS PLAN

臨時露天存放回收貨物(二手電子產品)連附屬工場及場地辦公室(為期3年)
 元朗山下村丈量約份第119約地段第326號(部分)、
 第327號A分段(部分)、第327號A分段第1小分段(部分)、
 第327號B分段(部分)、第327號C分段(部分)、第327號D分段(部分)及第328號(部分)
 TEMPORARY OPEN STORAGE OF RECYCLED GOODS (USED ELECTRONIC APPLIANCES)
 WITH ANCILLARY WORKSHOP AND SITE OFFICE FOR A PERIOD OF 3 YEARS
 LOTS 326 (PART), 327 S.A (PART), 327 S.A ss.1 (PART), 327 S.B (PART), 327 S.C (PART),
 327 S.D (PART) AND 328 (PART) IN D.D.119, SHAN HA TSUEN, YUEN LONG

SCALE 1 : 1 000 比例尺

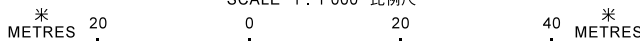

本摘要圖於2019年2月22日擬備，所根據的資料為測量圖編號 6-NW-19A
 EXTRACT PLAN PREPARED ON 22.2.2019
 BASED ON SURVEY SHEET No. 6-NW-19A

規劃署
**PLANNING
 DEPARTMENT**



參考編號
 REFERENCE No.
A/YL-TYST/946

圖 PLAN
A-1b



圖例 LEGEND

 申請地點(界線只作識別用)
APPLICATION SITE
(BOUNDARY FOR IDENTIFICATION
PURPOSE ONLY)

本摘要圖於2019年2月22日擬備，所根據的資料為地政總署於2018年3月13日拍得的航攝照片編號 E035360C
EXTRACT PLAN PREPARED ON 22.2.2019
BASED ON AERIAL PHOTO No.
E035360C TAKEN ON 13.3.2018
BY LANDS DEPARTMENT

航攝照片 AERIAL PHOTO

臨時露天存放回收貨物(二手電子產品)連附屬工場及場地辦公室(為期3年)
元朗山下村丈量約份第119約地段第326號(部分)、
第327號A分段(部分)、第327號A分段第1小分段(部分)、
第327號B分段(部分)、第327號C分段(部分)、第327號D分段(部分)及第328號(部分)
TEMPORARY OPEN STORAGE OF RECYCLED GOODS (USED ELECTRONIC APPLIANCES)
WITH ANCILLARY WORKSHOP AND SITE OFFICE FOR A PERIOD OF 3 YEARS
LOTS 326 (PART), 327 S.A (PART), 327 S.A ss.1 (PART), 327 S.B (PART), 327 S.C (PART),
327 S.D (PART) AND 328 (PART) IN D.D.119, SHAN HA TSUEN, YUEN LONG

規劃署
PLANNING
DEPARTMENT



參考編號
REFERENCE No.
AYL-TYST/946

圖 PLAN
A-3

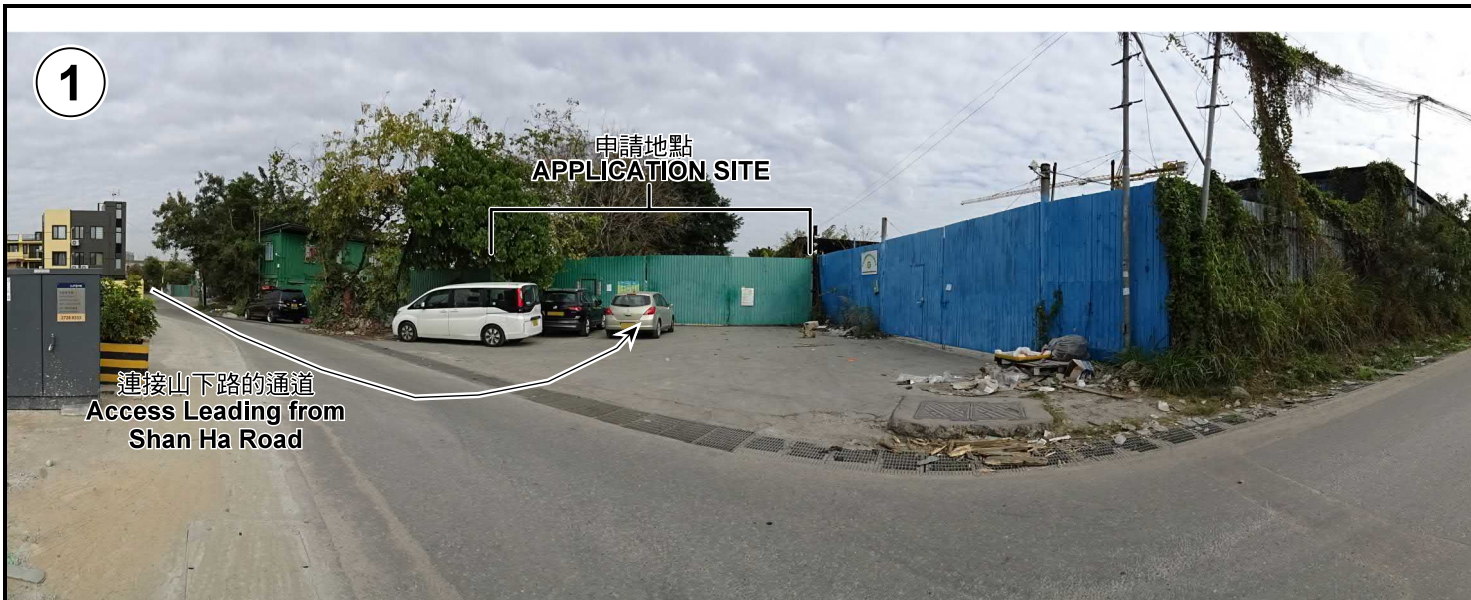

申請地點界線只作識別用 APPLICATION SITE BOUNDARY FOR IDENTIFICATION PURPOSE ONLY

實地照片 SITE PHOTOS

臨時露天存放回收貨物(二手電子產品)連附屬工場及場地辦公室 (為期3年)
 元朗山下村丈量約份第119約地段第326號(部分)、
 第327號A分段(部分)、第327號A分段第1小分段(部分)、
 第327號B分段(部分)、第327號C分段(部分)、第327號D分段(部分)及第328號(部分)

TEMPORARY OPEN STORAGE OF RECYCLED GOODS (USED ELECTRONIC APPLIANCES)
 WITH ANCILLARY WORKSHOP AND SITE OFFICE FOR A PERIOD OF 3 YEARS
 LOTS 326 (PART), 327 S.A (PART), 327 S.A ss.1 (PART), 327 S.B (PART), 327 S.C (PART),
 327 S.D (PART) AND 328 (PART) IN D.D. 119, SHAN HA TSUEN, YUEN LONG

本圖於2019年2月22日擬備，所根據的資料為攝於2019年1月28日的實地照片
 PLAN PREPARED ON 22.2.2019
 BASED ON SITE PHOTOS
 TAKEN ON 28.1.2019

規劃署
 PLANNING
 DEPARTMENT



參考編號
 REFERENCE No.
 A/YL-TYST/946

圖 PLAN
 A-4a



4

申請地點
APPLICATION SITE



5

申請地點
APPLICATION SITE



6

申請地點
APPLICATION SITE



7

申請地點
APPLICATION SITE

實地照片 SITE PHOTOS

臨時露天存放回收貨物(二手電子產品)連附屬工場及場地辦公室 (為期3年)
元朗山下村丈量約份第119約地段第326號(部分)、

第327號A分段(部分)、第327號A分段第1小分段(部分)、

第327號B分段(部分)、第327號C分段(部分)、第327號D分段(部分)及第328號(部分)

TEMPORARY OPEN STORAGE OF RECYCLED GOODS (USED ELECTRONIC APPLIANCES)
WITH ANCILLARY WORKSHOP AND SITE OFFICE FOR A PERIOD OF 3 YEARS

LOTS 326 (PART), 327 S.A (PART), 327 S.A ss.1 (PART), 327 S.B (PART), 327 S.C (PART),

327 S.D (PART) AND 328 (PART) IN D.D. 119, SHAN HA TSUEN, YUEN LONG

規 劃 署
**PLANNING
DEPARTMENT**



本圖於2019年2月22日擬備，所根據的資料為攝於2019年1月28日的實地照片
PLAN PREPARED ON 22.2.2019
BASED ON SITE PHOTOS
TAKEN ON 28.1.2019

參考編號
REFERENCE No.
A/YL-TYST/946

圖 PLAN
A-4b