

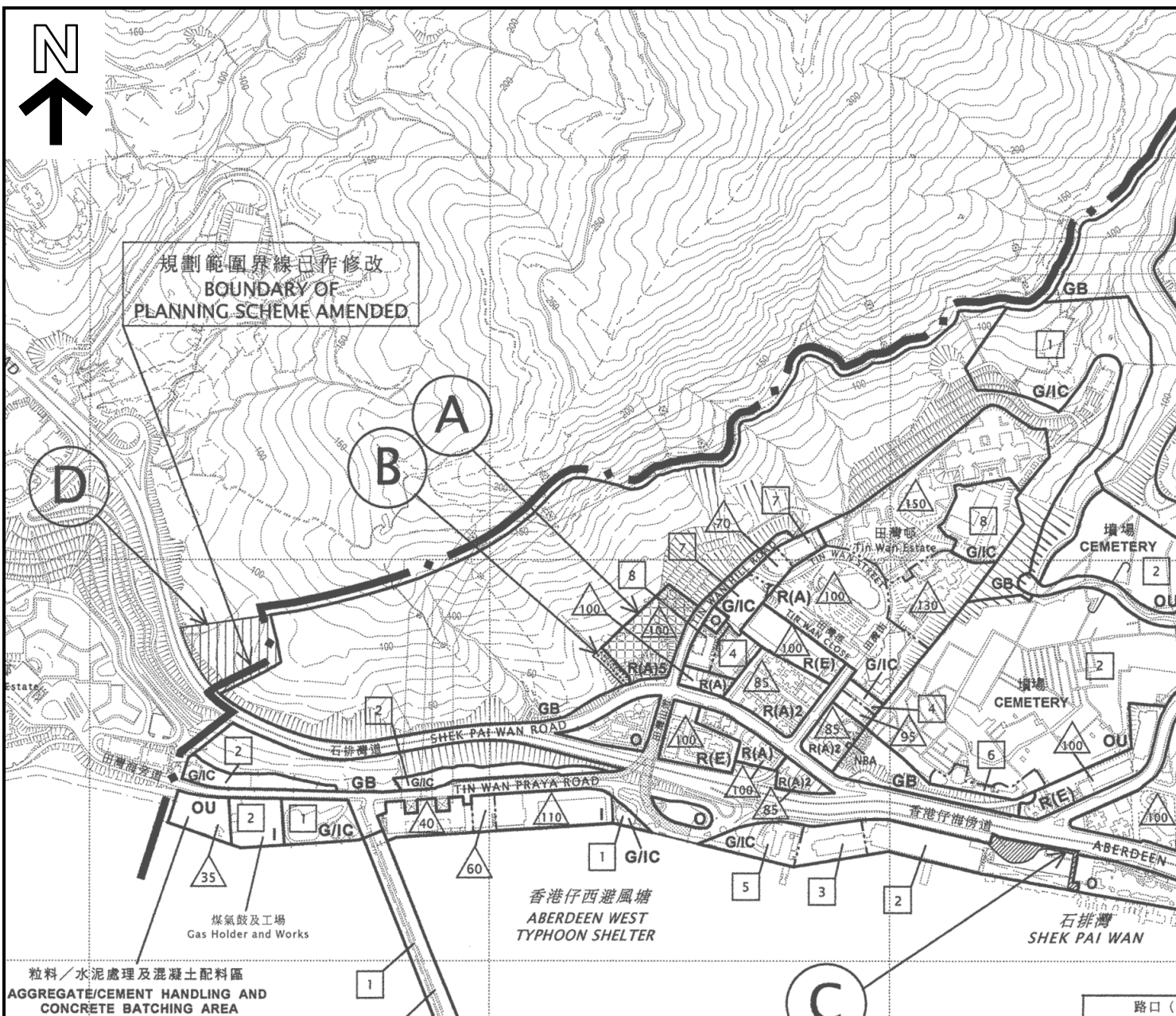

規劃範圍界線已作修改
BOUNDARY OF
PLANNING SCHEME AMENDED



粒料／水泥處理及混凝土配料區
AGGREGATE/CEMENT HANDLING AND
CONCRETE BATCHING AREA

圖例 LEGEND

修訂項目 AMENDMENT ITEM

- (A)** 把位於石排灣道及田灣山道交界的一幅土地由「政府、機構或社區」地帶及顯示為「道路」的地方改劃為「住宅(甲類)5」地帶
REZONING OF A SITE AT THE JUNCTION OF SHEK PAI WAN ROAD AND TIN WAN HILL ROAD FROM "GOVERNMENT, INSTITUTION OR COMMUNITY" AND AN AREA SHOWN AS "ROAD" TO "RESIDENTIAL (GROUP A)5"
- (B)** 把位於石排灣道近石排灣道及田灣山道交界的一幅狹長土地由顯示為「道路」的地方改劃為「綠化地帶」
REZONING OF A STRIP OF LAND AT SHEK PAI WAN ROAD NEAR THE JUNCTION OF SHEK PAI WAN ROAD AND TIN WAN HILL ROAD FROM AN AREA SHOWN AS "ROAD" TO "GREEN BELT"
- (C)** 把毗鄰香港仔漁類批發市場的一幅土地由「休憩用地」地帶及顯示為「道路」的地方改劃為「政府、機構或社區」地帶
REZONING OF A PIECE OF LAND ADJOINING THE ABERDEEN WHOLESALE FISH MARKET FROM "OPEN SPACE" AND AN AREA SHOWN AS "ROAD" TO "GOVERNMENT, INSTITUTION OR COMMUNITY"
- (D)** 把位於石排灣道華貴邨東面的一幅土地從規劃區剔除，以納入《薄扶林分區計劃大綱草圖編號S/H10/16》內
EXCISION OF AN AREA TO THE EAST OF WAH KWAI ESTATE ACROSS SHEK PAI WAN ROAD FROM THE PLANNING SCHEME AREA FOR INCORPORATION INTO THE DRAFT POK FU LAM OUTLINE ZONING PLAN No. S/H10/16



本摘要圖於2018年3月1日擬備，
所根據的資料為於2017年9月15日
展示的分區計劃大綱圖編號S/H15/32
EXTRACT PLAN PREPARED ON 3.1.2018
BASED ON OUTLINE ZONING PLAN
No. S/H15/32 EXHIBITED ON 15.9.2017

納入香港仔及鴨洲分區計劃大綱草圖
編號 S/H15/32 的修訂項目
AMENDMENTS INCORPORATED INTO
THE DRAFT ABERDEEN & AP LEI CHAU
OUTLINE ZONING PLAN No. S/H15/32

規劃署
PLANNING
DEPARTMENT



參考編號
REFERENCE No.
R/S/H15/32

圖 PLAN
P - 1

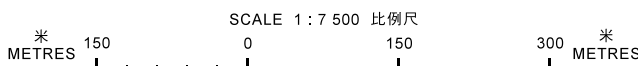



規劃範圍界線已作修改
BOUNDARY OF
PLANNING SCHEME AMENDED

申述個案編號R1-R2
REPRESENTATIONS No. R1-R2
意見編號C1-C6和C14
COMMENTS No. C1-C6 & C14
修訂項目A
AMENDMENT ITEM A

申述個案編號R1
REPRESENTATIONS No. R1
意見編號C6和C14
COMMENTS No. C6 & C14
修訂項目B
AMENDMENT ITEM B

申述個案編號R1-R3
REPRESENTATIONS No. R1-R3
意見編號C1-C6和C8-C13
COMMENTS No. C1-C6 & C8-C13
修訂項目D
AMENDMENT ITEM D

申述個案編號R1
REPRESENTATIONS No. R1
意見編號C6-C7
COMMENTS No. C6-C7
修訂項目C
AMENDMENT ITEM C

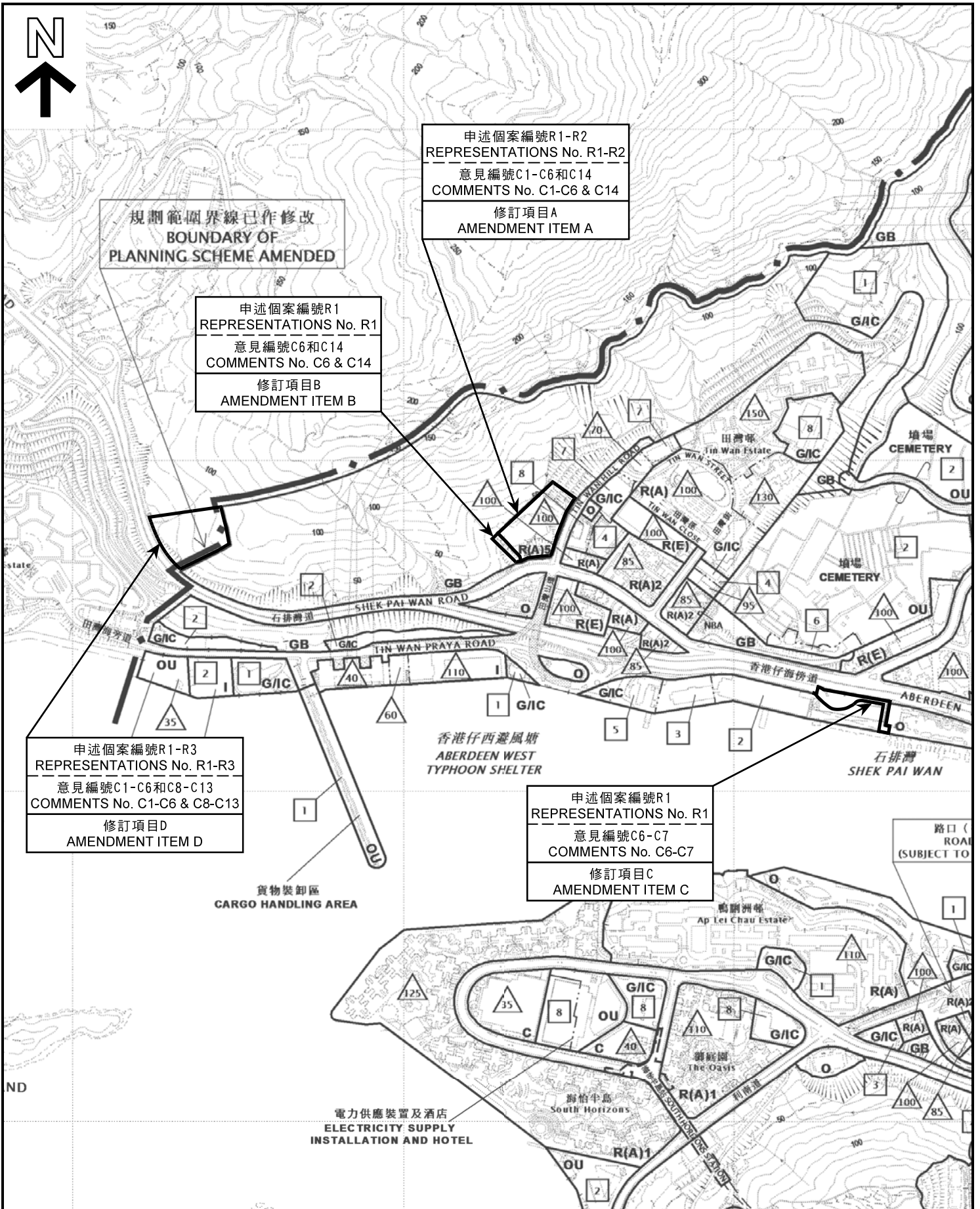

位置圖 LOCATION PLAN

就香港仔及鴨脷洲分區計劃大綱草圖編號 S/H15/32 提出的申述個案編號R1-R3及相關意見編號C1-C14作出考慮
CONSIDERATION OF REPRESENTATIONS No. R1-R3 AND RELATED COMMENTS No. C1-C14 TO THE DRAFT ABERDEEN & AP LEI CHAU OUTLINE ZONING PLAN No. S/H15/32

規劃署
PLANNING DEPARTMENT



參考編號
REFERENCE No.
R/S/H15/32

圖 PLAN
P - 2

本摘要圖於2018年3月7日擬備，所根據的資料為於2017年9月15日展示的分區計劃大綱圖編號S/H15/32
EXTRACT PLAN PREPARED ON 7.3.2018 BASED ON OUTLINE ZONING PLAN No. S/H15/32 EXHIBITED ON 15.9.2017

