

參考編號 REFERENCE No. A/K5/814	繪圖 DRAWING R-1
-----------------------------------	----------------------

(來源：附件 E)
(Source : Annex E)



A&B 卓東建築師事務所
ARCHITECTS

Unit 1204-01, 12/F, Prosperity Mall, Phase 6, 434 King's Road, North Point, Hong Kong
T: 2339 2212 | F: 2339 9653 | E: info@abdesign.com.hk | www.abdesign.com.hk
RMA Chartered Practitioner | HKIA Registered Practitioner | 2017/001/2015 Certified

Plan C: Revised Level 1 Floor Plan

參考編號
REFERENCE No.
A/K5/814

繪圖
DRAWING
R-2

(來源：附件 E)
(Source : Annex E)

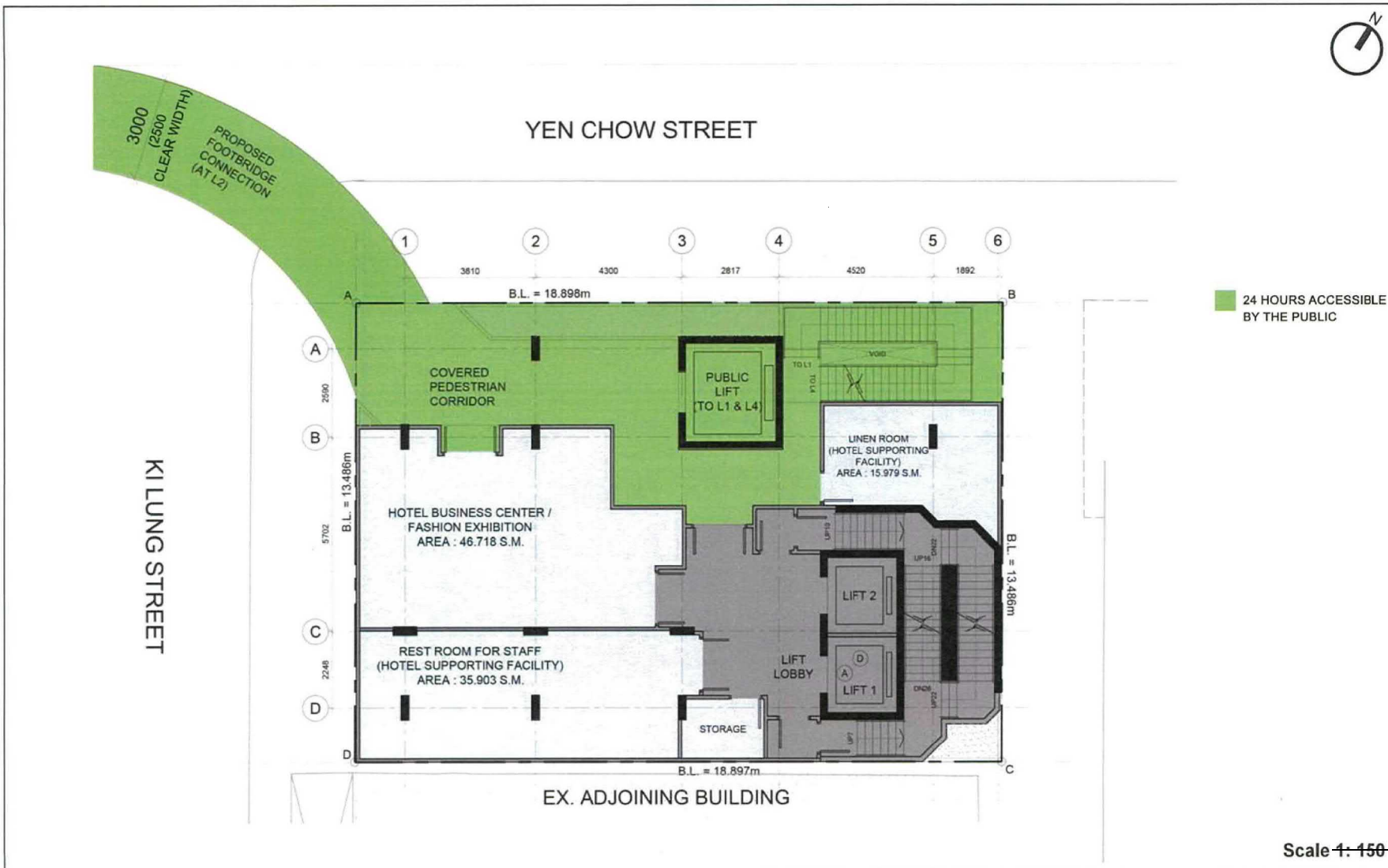

A&B 卓東建築師事務所
ARCHITECTS

Unit 1704-05, 17/F, Prosperity Millennium Plaza, 483 King's Road, North Point, Hong Kong
T: 2229 2222 F: 2229 9920 E: info@abarchitects.com.hk www.abarchitects.com.hk
RMA Chartered Practitioner RMA Registered Practitioner R21 98912015 (Civil)

Plan D: Revised Level 2 Floor Plan

參考編號
REFERENCE No.
A/K5/814

繪圖
DRAWING
R-3

(來源：附件 E)
(Source : Annex E)

ASSUMPTION

1. SCHEDULE OF ACCOMMODATION UNDER OZP

- 1.1 LOCATION OF SITE : 56, YEN CHOW STREET, KOWLOON
- 1.2 OZP NO. : S/K5/37
- 1.3 ZONING : RESIDENTIAL (GROUP A) - R(A)5
- 1.4 PROPOSED USE : COMPOSITE BUILDING
- 1.5 AREA OF SITE : 254.9 S.M. (= 2,646.93 S.F.)
- 1.6 PERMITTED MAX. P.R. FOR DOMESTIC BUILDING (UNDER OZP) : 7.5
- 1.7 PERMITTED MAX. P.R. FOR NON-DOMESTIC BUILDING (UNDER OZP) : 9
- 1.8 PROPOSED P.R. FOR NON-DOMESTIC FROM G/F TO 2/F : 0.80 (APPROX. 179,888 S.M.) (TBC)
- 1.9 PROPOSED P.R. FOR DOMESTIC : = (PERMITTED N.D.P.R. - PROPOSED N.D.P.R.) X PERMITTED D.P.R. / PERMITTED N.D.P.R.
= (9 - 0.80) X $\frac{7.5}{9}$
= 6.833
- 1.10 PROPOSED TOTAL G.F.A. FOR DOMESTIC : 1,741.7 S.M. (= 6,833 X 254.9 S.M.)
- 1.11 PERMITTED S.C. FOR DOMESTIC ABOVE G/F : 37.5% (= 95,587.5 S.M.) (CLASS B - OVER 61M UNDER B(P)R) (NOT INCLUDED CURTAIN WALL)
- 1.12 PERMITTED MAX. BUILDING HEIGHT : 80mPD (= 75.5 M. ABOVE MEAN STREET LEVEL)
- 1.13 PROPOSED NO. OF STOREY FOR DOMESTIC : 2/F TO 20/F
TOTAL 19 STOREYS WITH 3,500mm(H) FLOOR TO FLOOR

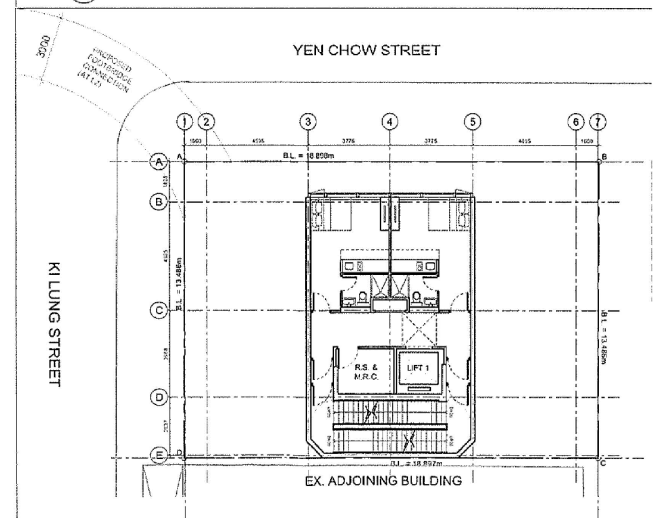
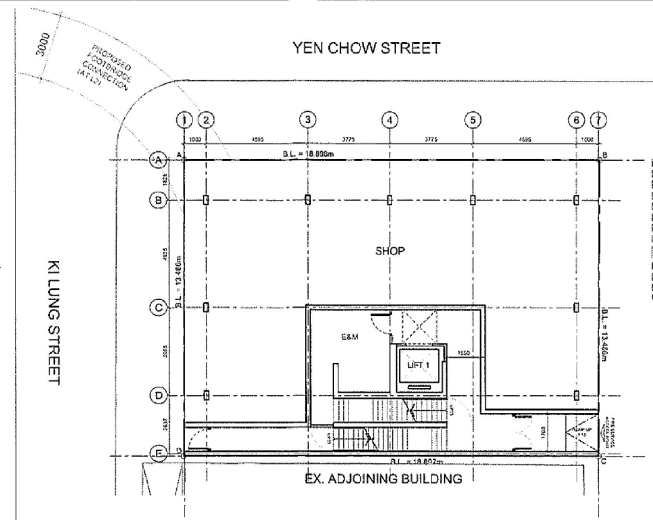
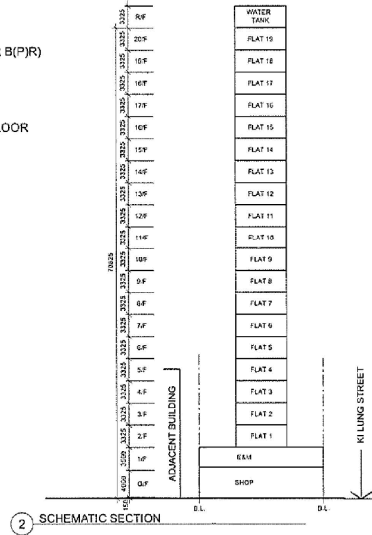
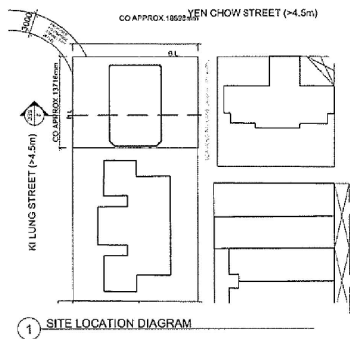

Not to Scale

Plan J: Notional Residential Scheme at the Site

參考編號 REFERENCE No. A/K5/814	繪圖 DRAWING R-5
--	-----------------------------

(來源：附件 E)
 (Source : Annex E)

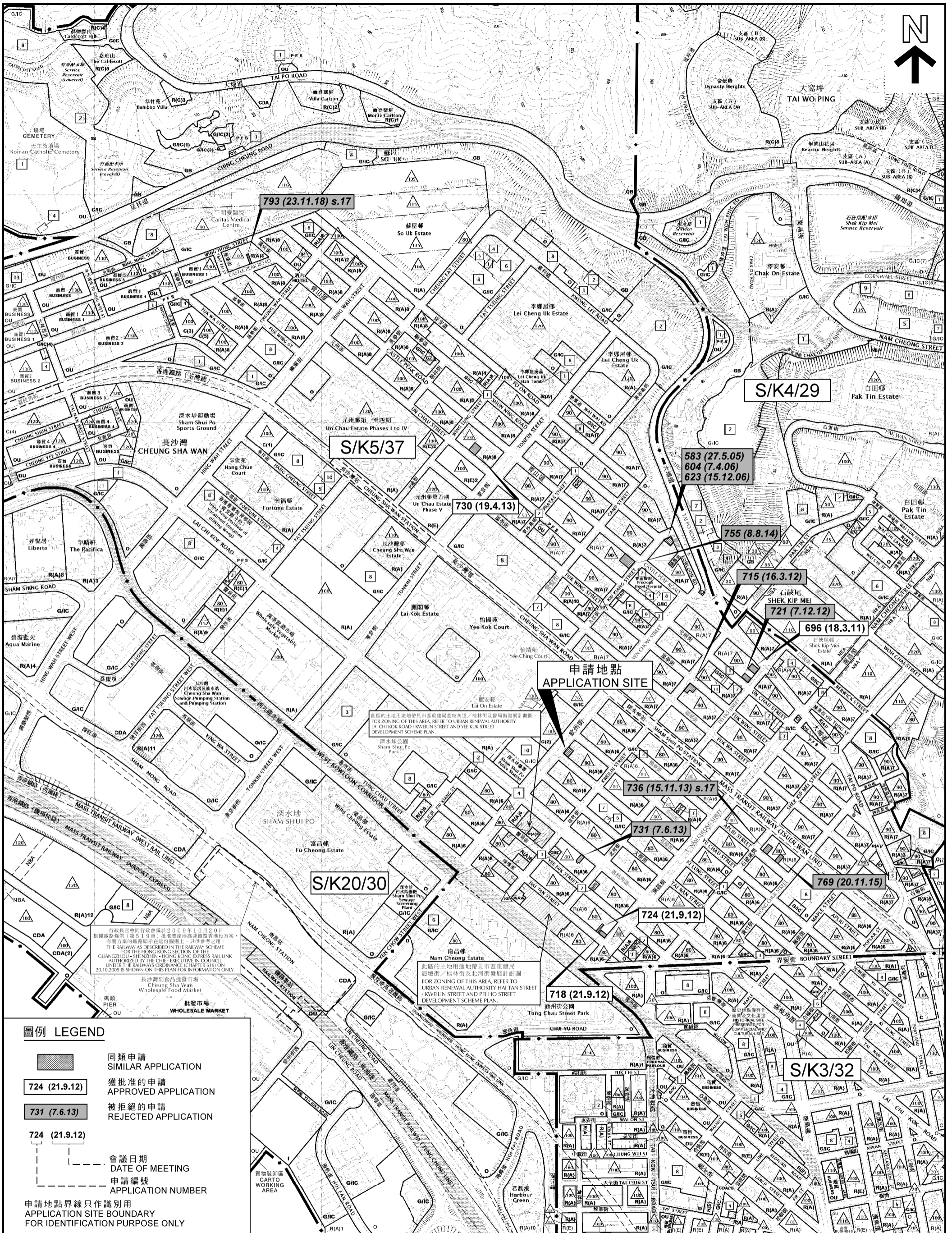

行政長官會同行政會議於2009年10月20日根據鐵路條例(第519章)批准興建港鐵西港段方案有關的鐵路圖則在圖中顯示。只供參考之用。THE RAILWAY AS DESCRIBED IN THE RAILWAY SCHEME FOR THE HONG KONG SECTION OF THE GUANGZHOU-SHENZHEN-HONG KONG EXPRESS RAIL LINK AUTHORIZED BY THE CHIEF EXECUTIVE IN COUNCIL UNDER THE RAILWAYS ORDINANCE (CHAPTER 519) ON 20.10.2009 IS SHOWN ON THIS PLAN FOR INFORMATION ONLY.

長沙灣食品批發市場
Cheung Sha Wan Wholesale Food Market

圖例 LEGEND

- 同類申請
SIMILAR APPLICATION
- 獲批准的申請
APPROVED APPLICATION
- 被拒絕的申請
REJECTED APPLICATION
- 會議日期
DATE OF MEETING
- 申請編號
APPLICATION NUMBER

申請地點界線只作識別用
APPLICATION SITE BOUNDARY FOR IDENTIFICATION PURPOSE ONLY

本摘要圖於2020年9月9日擬備，所根據的資料為於2019年10月8日核准的分區計劃大綱圖編號S/K3/32，於2015年7月21日核准的分區計劃大綱圖編號S/K4/29，於2016年12月6日核准的分區計劃大綱圖編號S/K5/37及於2014年9月23日核准的分區計劃大綱圖編號S/K20/30

EXTRACT PLAN PREPARED ON 9.9.2020 BASED ON OUTLINE ZONING PLANS No. S/K3/32 APPROVED ON 8.10.2019, S/K4/29 APPROVED ON 21.7.2015, S/K5/37 APPROVED ON 6.12.2016 AND S/K20/30 APPROVED ON 23.9.2014

位置圖 LOCATION PLAN

擬議酒店
PROPOSED HOTEL

九龍深水埗欽州街56G-56H號及56J-56K號
56G-56H AND 56J-56K YEN CHOW STREET,
SHAM SHUI PO, KOWLOON

SCALE 1 : 7 500 比例尺

米 100 0 100 200 300 400 500 600 700 METRES

規劃署
PLANNING DEPARTMENT

參考編號
REFERENCE No.

A/K5/814

圖 PLAN
R-1

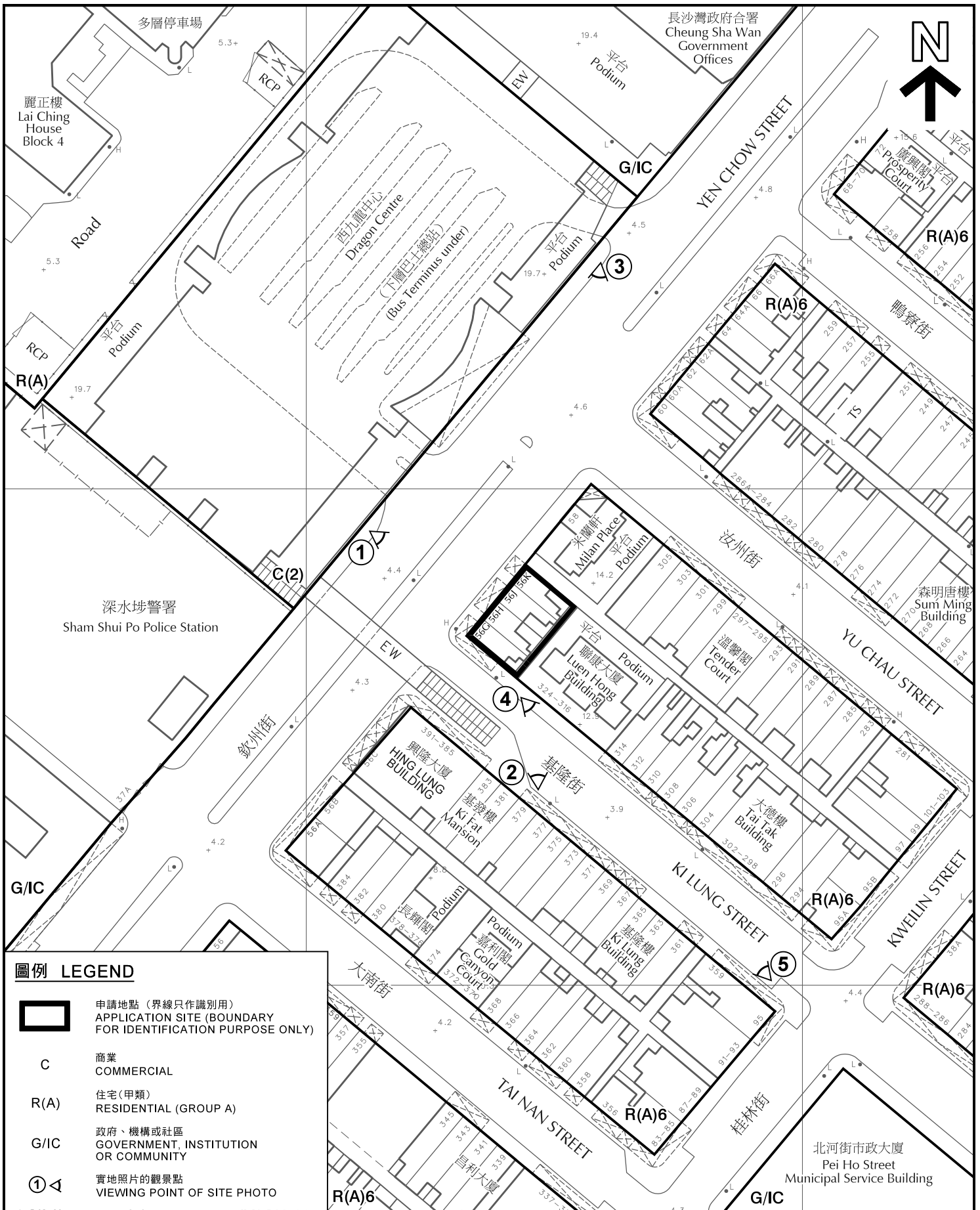

本摘要圖於2020年9月25日擬備，
所根據的資料為測量圖編號
11-NW-13B及11-NW-14A
EXTRACT PLAN PREPARED ON 25.9.2020
BASED ON SURVEY SHEETS No.
11-NW-13B AND 11-NW-14A

平面圖 SITE PLAN
擬議酒店
九龍深水埗欽州街56G-56H號及56J-56K號
PROPOSED HOTEL
56G-56H AND 56J-56K YEN CHOW STREET,
SHAM SHUI PO, KOWLOON

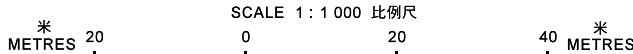

規劃署
PLANNING DEPARTMENT



參考編號
REFERENCE No.
A/K5/814

圖 PLAN
R-2

APPROXIMATE LOCATION OF
POSSIBLE FUTURE MASS TRANSPORT
RAILWAY AND STATIONS.
將來可能建設之地下鐵
路綫及車站之大約位置

申請地點
APPLICATION SITE

於1973年6月1日展示的分區計劃大綱圖編號LK3/8
OUTLINE ZONING PLAN No.
LK3/8 EXHIBITED ON 1.6.1973

申請地點
APPLICATION SITE

於1975年5月23日展示的分區計劃大綱圖編號LK3/10
OUTLINE ZONING PLAN No.
LK3/10 EXHIBITED ON 23.5.1975

申請地點界線只作識別用
APPLICATION SITE BOUNDARY
FOR IDENTIFICATION PURPOSE ONLY

本摘要圖於2020年9月9日擬備，
所根據的資料為於1973年6月1日
展示的分區計劃大綱圖編號LK3/8和
於1975年5月23日展示的分區
計劃大綱圖編號LK3/10

EXTRACT PLAN PREPARED ON 9.9.2020
BASED ON OUTLINE ZONING PLANS No.
LK3/8 EXHIBITED ON 1.6.1973 AND
LK3/10 EXHIBITED ON 23.5.1975

位置圖 LOCATION PLAN

擬議酒店
九龍深水埗欽州街56G-56H號及56J-56K號
PROPOSED HOTEL
56G-56H AND 56J-56K YEN CHOW STREET,
SHAM SHUI PO, KOWLOON

SCALE 1:2 500 比例尺
50 0 50 100 METRES

規劃署
PLANNING
DEPARTMENT



參考編號
REFERENCE No.

A/K5/814

圖 PLAN

R-3

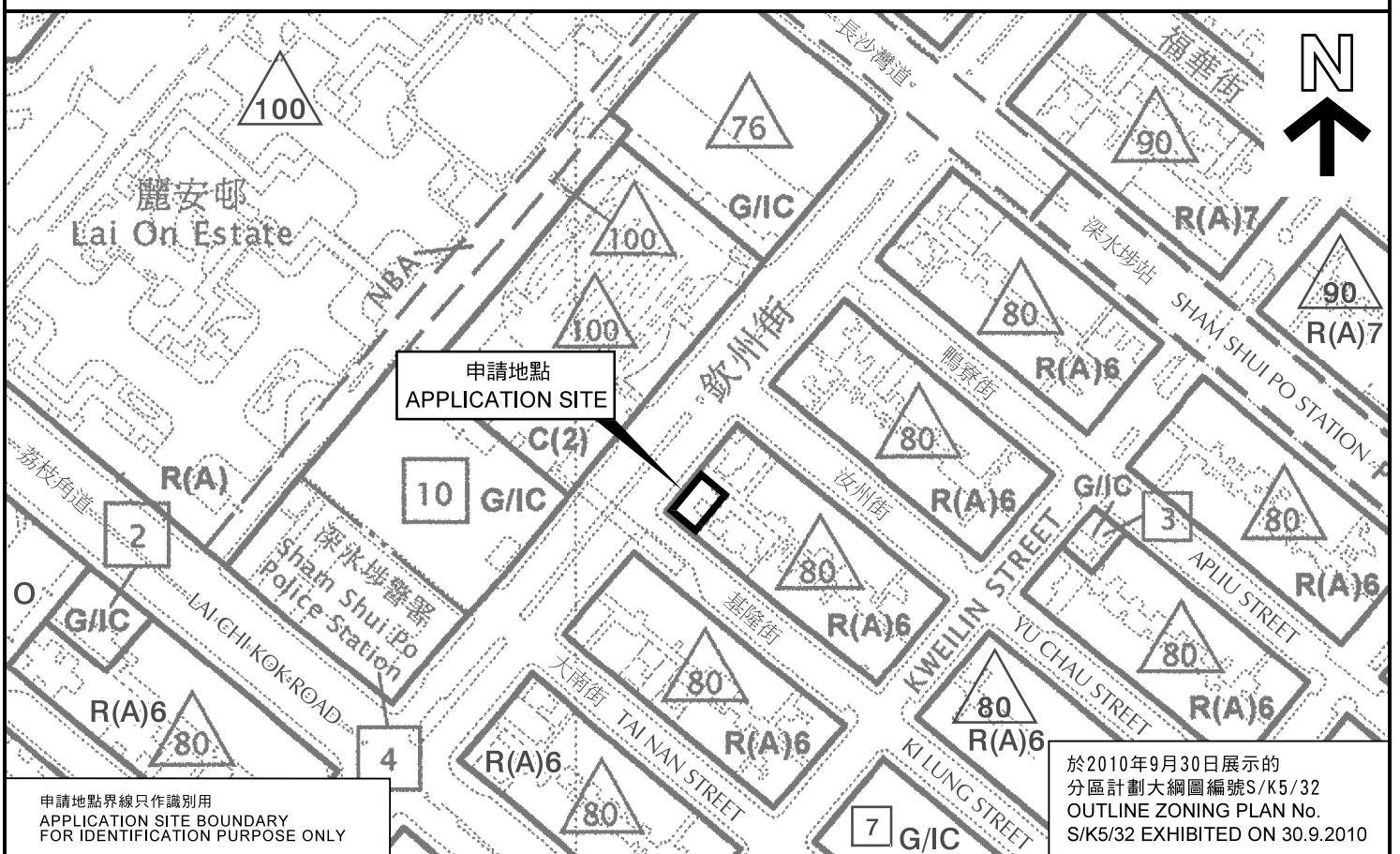
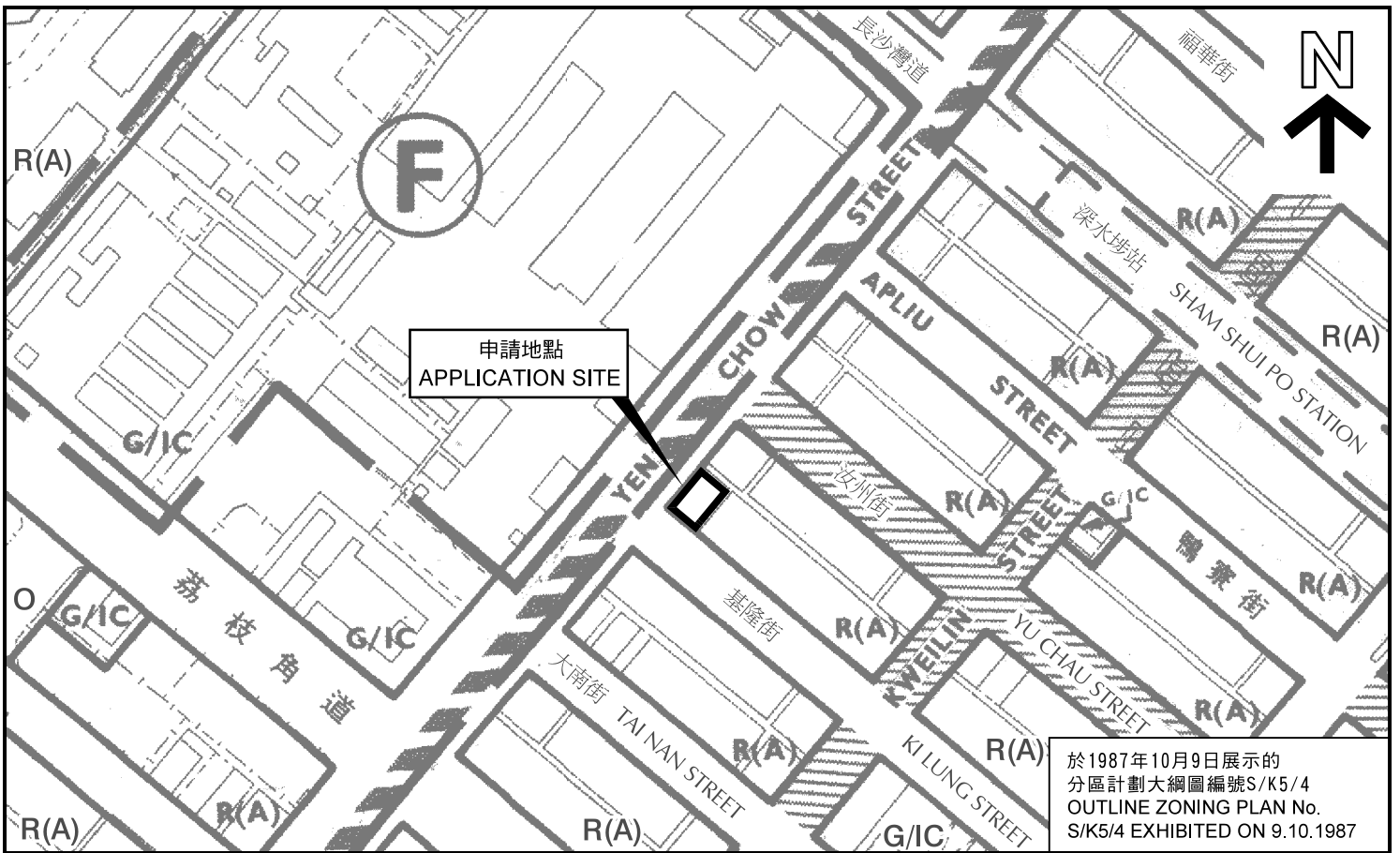

申請地點界線只作識別用
APPLICATION SITE BOUNDARY
FOR IDENTIFICATION PURPOSE ONLY

本摘要圖於2020年9月9日擬備，
所根據的資料為於1987年10月9日
展示的分區計劃大綱圖編號S/K5/4和
於2010年9月30日展示的分區
計劃大綱圖編號S/K5/32
EXTRACT PLAN PREPARED ON 9.9.2020
BASED ON OUTLINE ZONING PLANS No.
S/K5/4 EXHIBITED ON 9.10.1987 AND
S/K5/32 EXHIBITED ON 30.9.2010

位置圖 LOCATION PLAN

擬議酒店
九龍深水埗欽州街56G-56H號及56J-56K號
PROPOSED HOTEL
56G-56H AND 56J-56K YEN CHOW STREET,
SHAM SHUI PO, KOWLOON

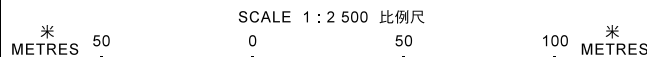

規劃署
PLANNING
DEPARTMENT



參考編號
REFERENCE No.
A/K5/814

圖 PLAN
R-4

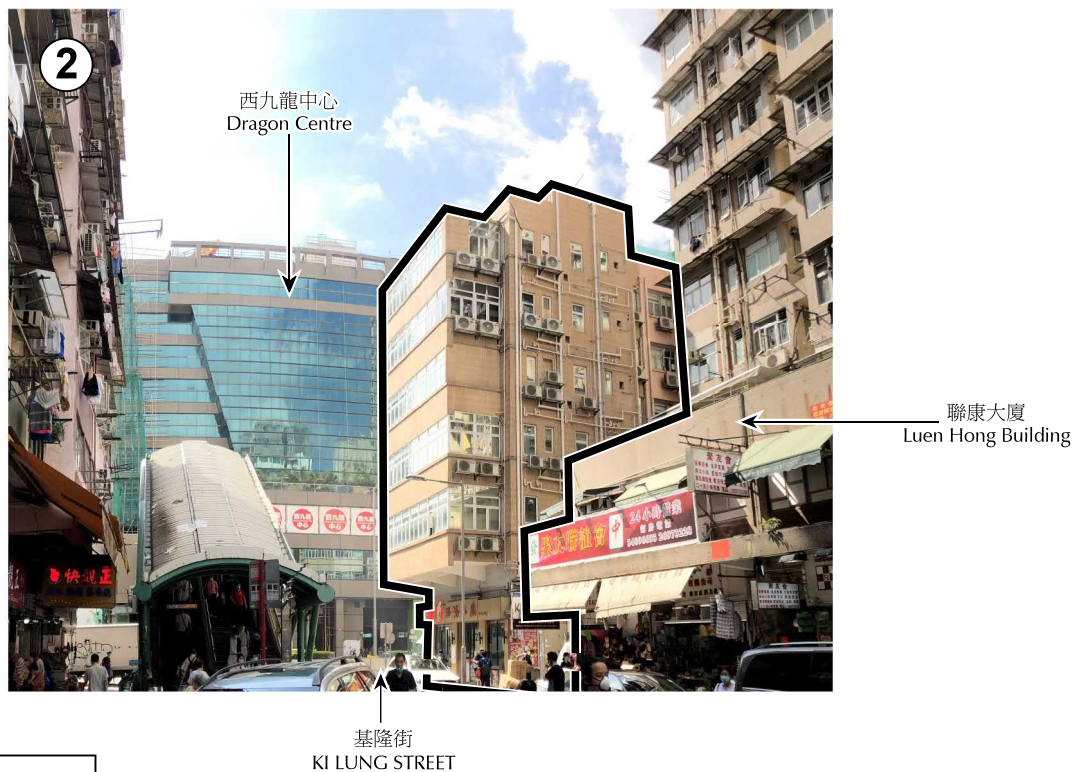
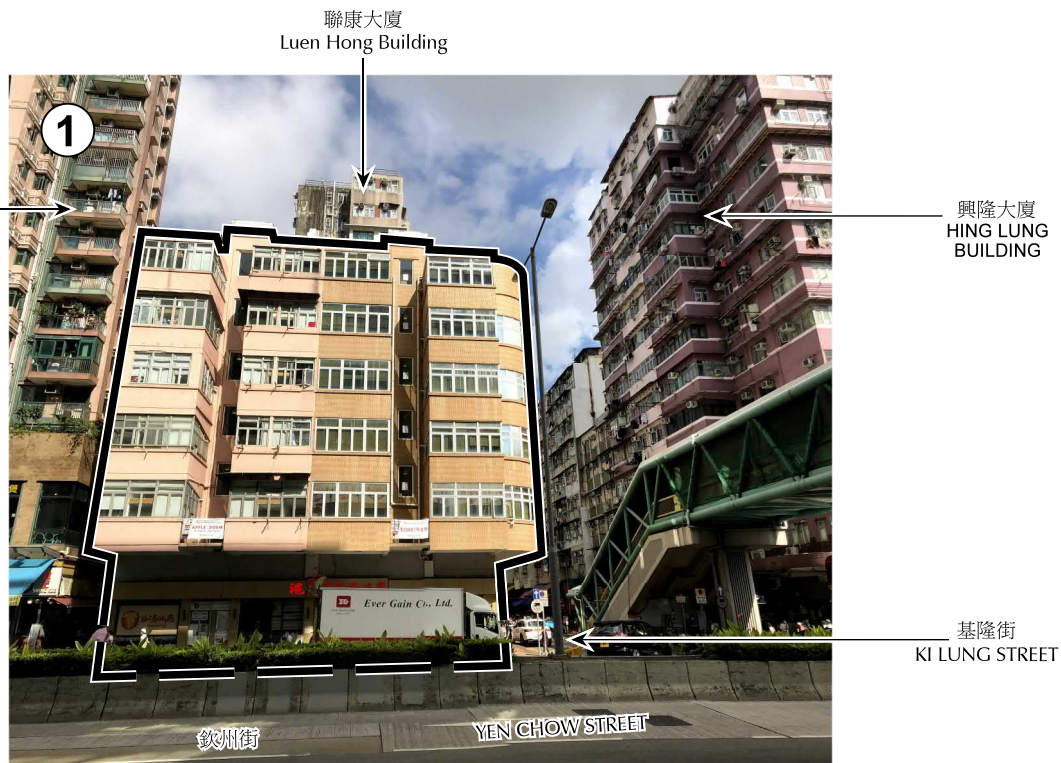

 申請地點 (界線只作識別用)
 APPLICATION SITE
 (BOUNDARY FOR IDENTIFICATION
 PURPOSE ONLY)

本圖於2020年9月9日擬備，所根據的
 資料為攝於2020年6月12日的實地照片
 PLAN PREPARED ON 9.9.2020
 BASED ON SITE PHOTOS
 TAKEN ON 12.6.2020

實地照片 SITE PHOTOS

擬議酒店
 九龍深水埗欽州街56G-56H號及56J-56K號
 PROPOSED HOTEL
 56G-56H AND 56J-56K YEN CHOW STREET,
 SHAM SHUI PO, KOWLOON

規劃署
 PLANNING
 DEPARTMENT



參考編號
 REFERENCE No.

A/K5/814

 PLAN

R-5

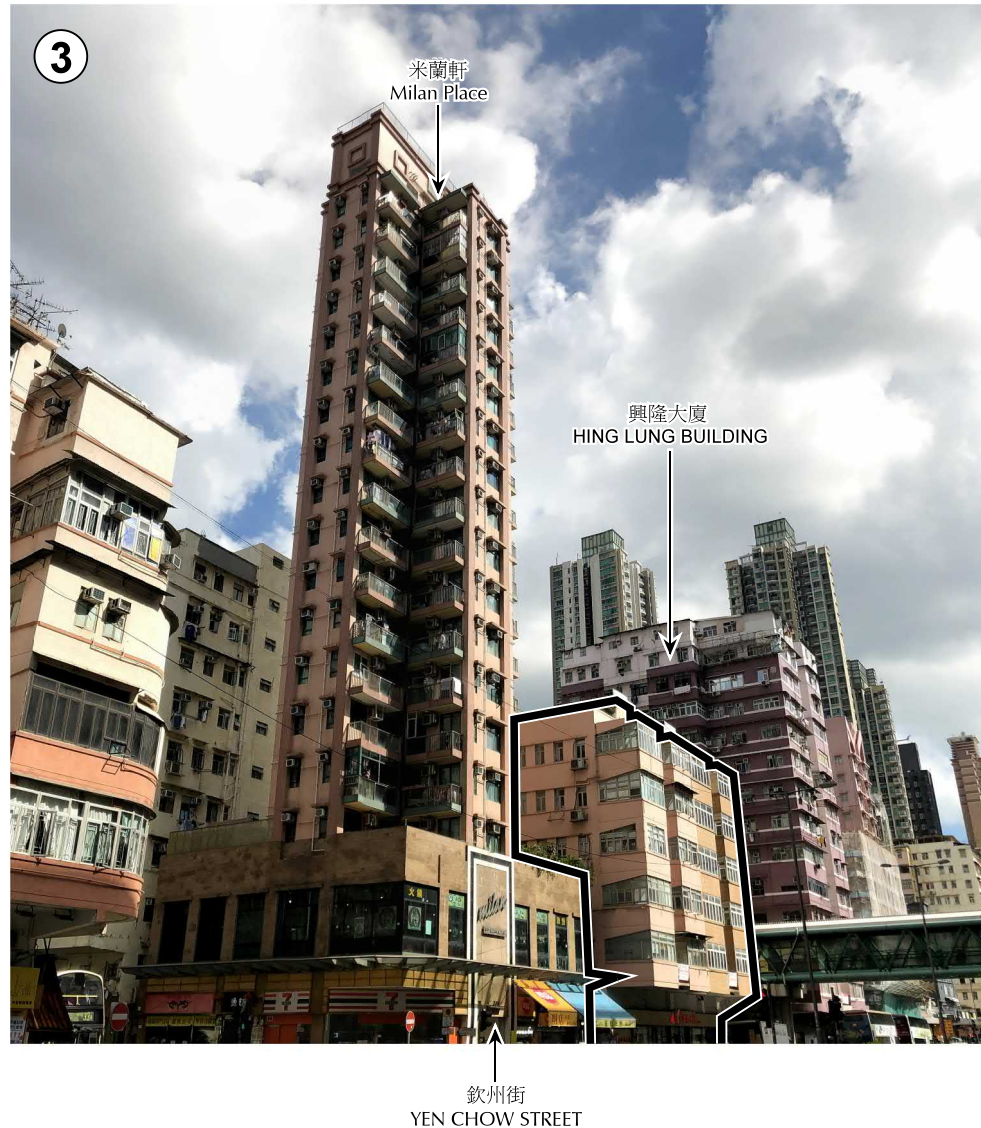

申請地點 (界線只作識別用)
APPLICATION SITE
(BOUNDARY FOR IDENTIFICATION
PURPOSE ONLY)

本圖於2020年9月9日擬備，
所根據的資料為攝於2020年6月12日的
實地照片
PLAN PREPARED ON 9.9.2020
BASED ON SITE PHOTO TAKEN ON
12.6.2020

實地照片 SITE PHOTO

擬議酒店
九龍深水埗欽州街56G-56H號及56J-56K號
PROPOSED HOTEL
56G-56H AND 56J-56K YEN CHOW STREET,
SHAM SHUI PO, KOWLOON

規劃署
PLANNING
DEPARTMENT



參考編號
REFERENCE No.

A/K5/814

圖 PLAN

R-6

北河街市政大廈
Pei Ho Street
Municipal Services Building

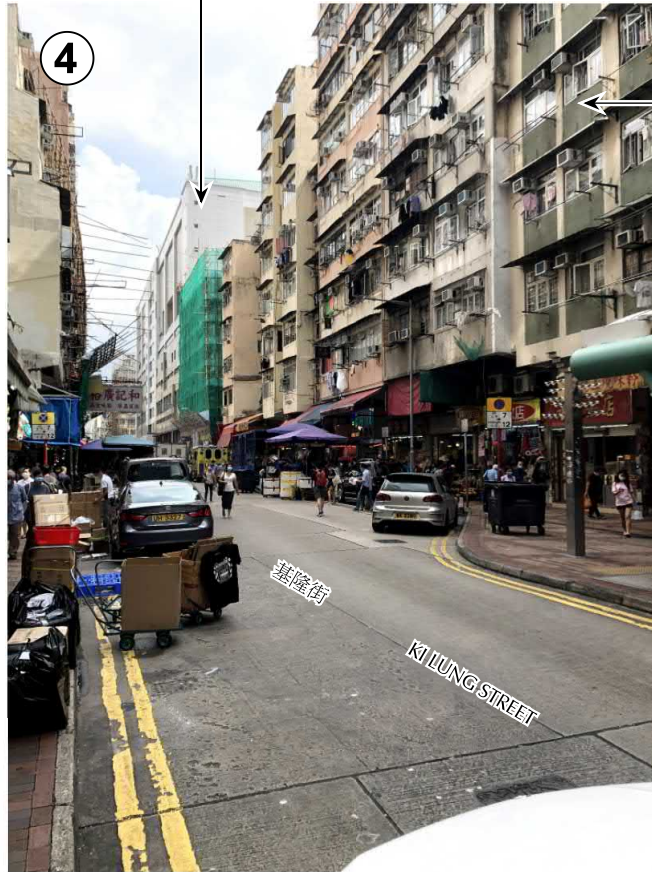

基隆樓
Ki Lung Building

興隆大廈
HING LUNG BUILDING



西九龍中心
Dragon Centre

本圖於2020年10月8日擬備，所根據的資料為攝於2020年9月24日的實地照片
PLAN PREPARED ON 8.10.2020
BASED ON SITE PHOTOS
TAKEN ON 24.9.2020

實地照片 SITE PHOTOS

擬議酒店
九龍深水埗欽州街56G-56H號及56J-56K號
PROPOSED HOTEL
56G-56H AND 56J-56K YEN CHOW STREET,
SHAM SHUI PO, KOWLOON

規劃署
PLANNING
DEPARTMENT



參考編號
REFERENCE No.

A/K5/814

圖 PLAN

R-7