

# *Attachment 3*

---

INDICATIVE LANDSCAPE PLAN

Indicative only



**LEGEND**

- SITE BOUNDARY
- RETAIL
- LANDSCAPE AREA
- HARD-PAVED AREA
- RESIDENTIAL LIFT / CIRCULATION CORE

PROPOSED MINOR RELAXATION OF MAXIMUM BUILDING HEIGHT AND PLOT RATIO RESTRICTIONS FOR PERMITTED COMPOSITE RESIDENTIAL DEVELOPMENT AT WU NGA LOK YEUNG, FANLING, NEW TERRITORIES  
 MINOR RELAXATION OF PERMITTED BUILDING HEIGHT APPROVED UNDER TPB NO. A/FLN/30 TO FACILITATE ADOPTION OF MODULAR INTEGRATED CONSTRUCTION  
 Proposed Scheme - GF Plan  
 30-07-2024  
 1:600 (A3)



Indicative only

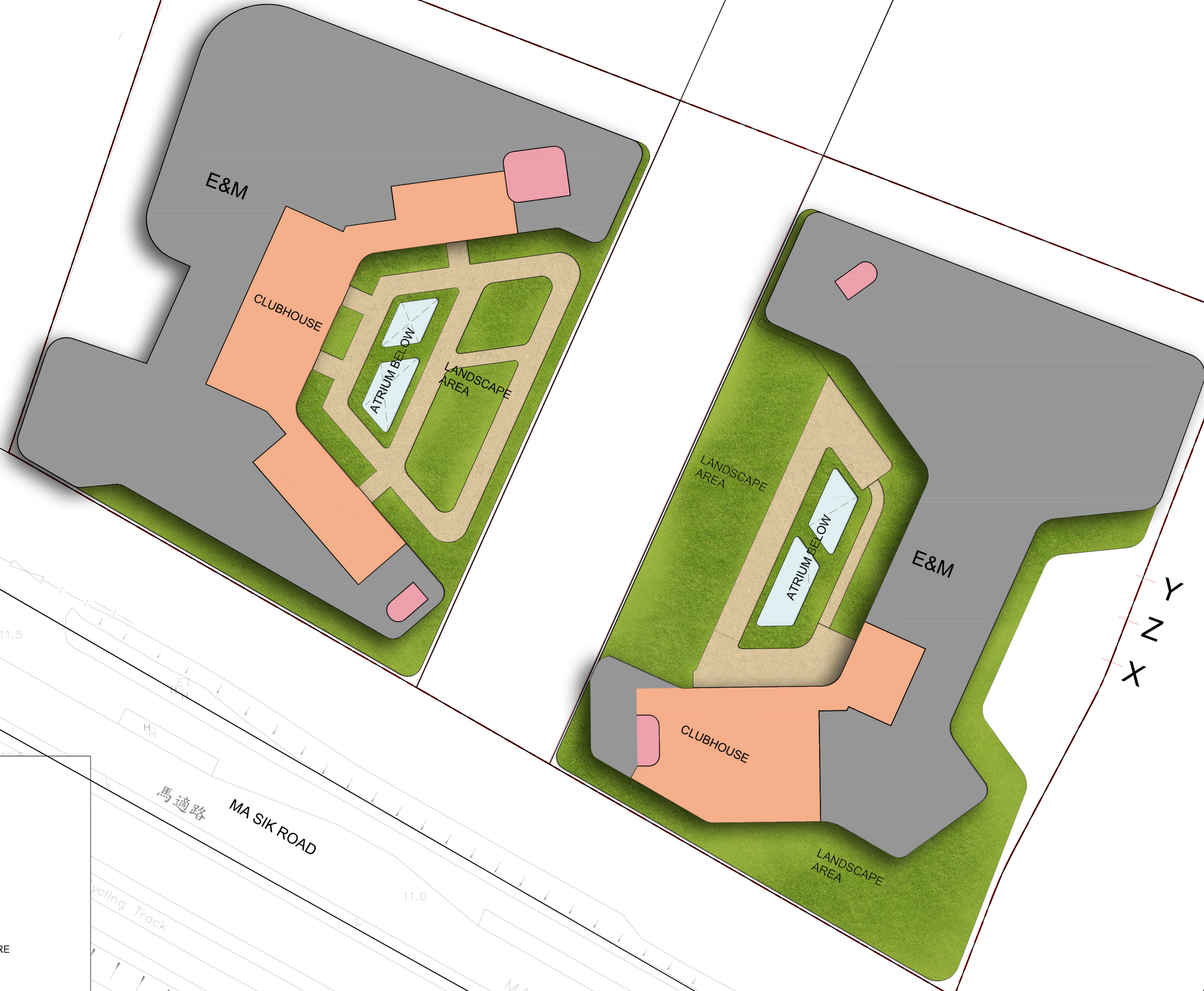

**LEGEND**

- SITE BOUNDARY
- RESIDENT'S CLUBHOUSE
- LANDSCAPE AREA
- HARD-PAVED AREA
- E&M
- RESIDENTIAL LIFT / CIRCULATION CORE

PROPOSED MINOR RELAXATION OF BUILDING MAXIMUM HEIGHT AND PLOT RATIO RESTRICTIONS FOR PERMITTED COMPOSITE RESIDENTIAL DEVELOPMENT AT WU NGA LOK YEUNG, FANLING, NEW TERRITORIES  
 MINOR RELAXATION OF PERMITTED BUILDING HEIGHT APPROVED UNDER TPB NO. A/FLN/30 TO FACILITATE ADOPTION OF MODULAR INTEGRATED CONSTRUCTION  
 Proposed Scheme - 2F Plan  
 30-07-2024  
 1:600 (A3)



Indicative only



**LEGEND**

- SITE BOUNDARY
- RESIDENTIAL LIFT / CIRCULATION CORE
- RESIDENT'S CLUBHOUSE
- LANDSCAPE AREA
- HARD-PAVED AREA
- E&M
- RESIDENTIAL

PROPOSED MINOR RELAXATION OF MAXIMUM BUILDING HEIGHT AND PLOT RATIO RESTRICTIONS FOR PERMITTED COMPOSITE RESIDENTIAL DEVELOPMENT AT WU NGA LOK YEUNG, FANLING, NEW TERRITORIES  
 MINOR RELAXATION OF PERMITTED BUILDING HEIGHT APPROVED UNDER TPB NO. A/FLN/30 TO FACILITATE ADOPTION OF MODULAR INTEGRATED CONSTRUCTION  
 Proposed Scheme - 3F Plan  
 30-07-2024  
 1:600 (A3)

