

銅鑼灣



Causeway Bay

Annex B

Replacement Pages of Layout Plan

LEGEND

	APPLICATION SITE
	PINK HATCHED BLUE NO STRUCTURE ERECTED ABOVE OR WITHIN 4M BELOW GROUND LEVEL
	PUBLIC OPEN SPACE
	COMMERCIAL/E&M
	G.I.C. FACILITIES
	FUTURE FOOTBRIDGE
	LIGHT BUSES LAYBYS
	CARPARK (PVP)
	CARPARK (PRIVATE)
	CARPARK (G.I.C. FACILITIES)
	ACCESS ROAD
	LOADING & UNLOADING CARPARK (PVP)
	UNEXCAVATED
	24-HR PEDESTRIAN WALKWAY
	PUBLIC OPEN SPACE WITH 24-HR PEDESTRIAN WALKWAY
	PEDESTRIAN LINK
	E&M
	CIRCULATION/ E&M

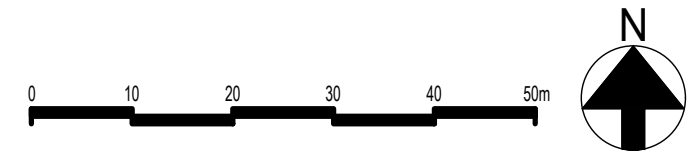
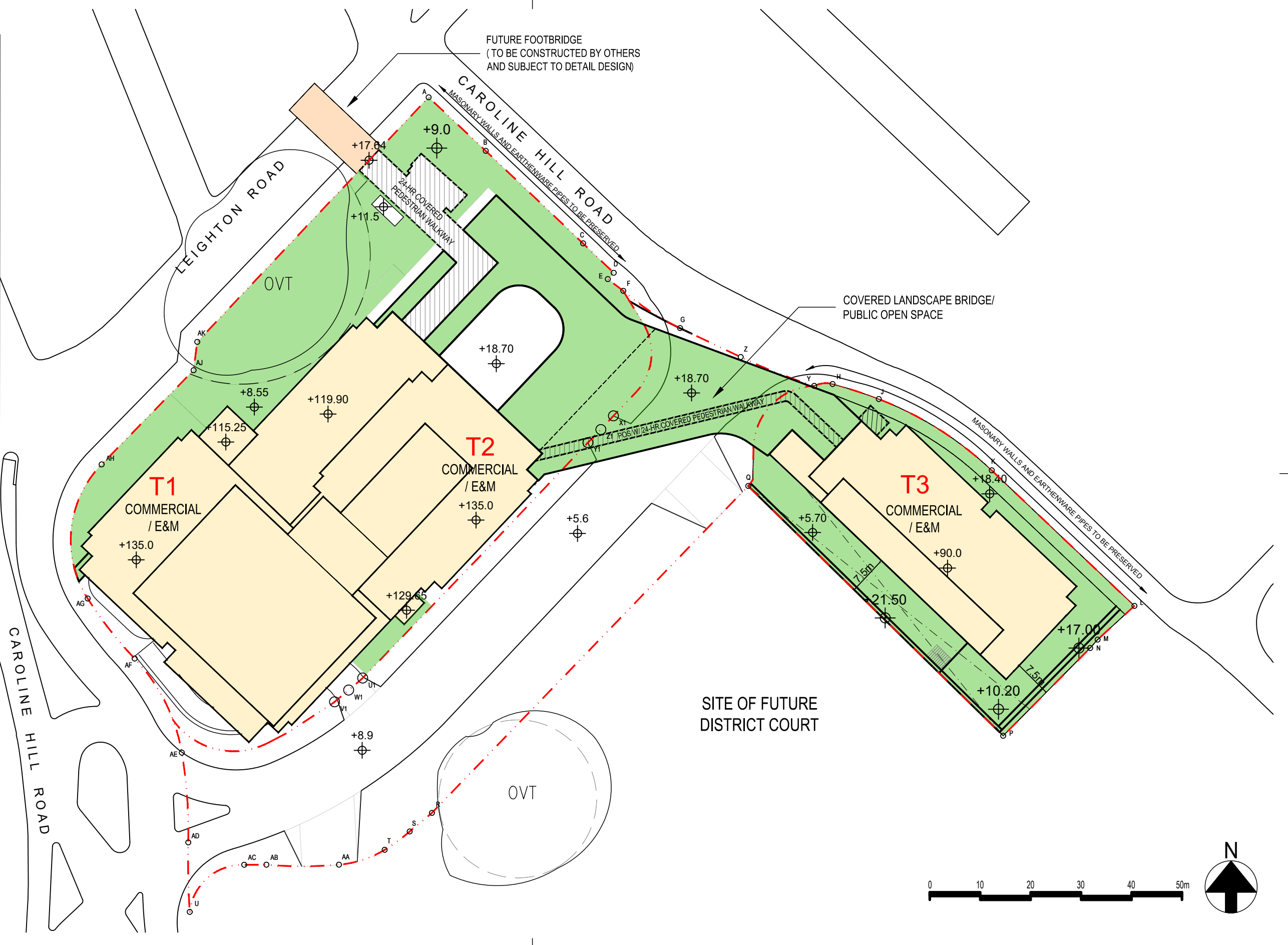

Rev.	Description	Drawn	Checked	Approved	Date
-	1st SUBMISSION				13-2022
A	1st AMENDMENT				9-2023
B	2nd AMENDMENT				1-2024

Rev.	Description	Drawn	Checked	Approved	Date

Check all measurements on site.
Do not scale off drawings.

This drawing is to be read in conjunction with the specification and any discrepancies are to be immediately reported to the Architect.

This drawing remains the copyright property of the Architect and is not to be reproduced in whole or in part without permission of the Architect.

B.D. Ref.	Date
F.S.D. Ref.	
D.L.O. Ref.	
Drawn	Date 1-2024
Checked	Date 1-2024
Approved	Date 1-2024
Cad File No.	



Project Title
PROPOSED COMMERCIAL DEVELOPMENT ON IL NO.8945 AT CAROLINE HILL ROAD, CAUSEWAY BAY, HONG KONG

Drawing Title
LAYOUT PLAN (ALL LEVELS)

Project No. 21105HK
Scale 1:750 (A3) Issue Date Sept 2024
Drawing No. MLP-001

Drawing Purpose

LEGEND

	APPLICATION SITE
	PINK HATCHED BLUE NO STRUCTURE ERECTED ABOVE OR WITHIN 4M BELOW GROUND LEVEL
	PUBLIC OPEN SPACE
	COMMERCIAL/E&M
	G.I.C. FACILITIES
	FUTURE FOOTBRIDGE
	LIGHT BUSES LAYBYS
	CARPARK (PVP)
	CARPARK (PRIVATE)
	CARPARK (G.I.C. FACILITIES)
	ACCESS ROAD
	LOADING & UNLOADING CARPARK (PVP)
	UNEXCAVATED
	24-HR PEDESTRIAN WALKWAY
	PUBLIC OPEN SPACE WITH 24-HR PEDESTRIAN WALKWAY
	PEDESTRIAN LINK
	E&M
	CIRCULATION/ E&M

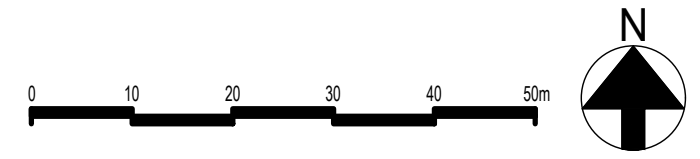
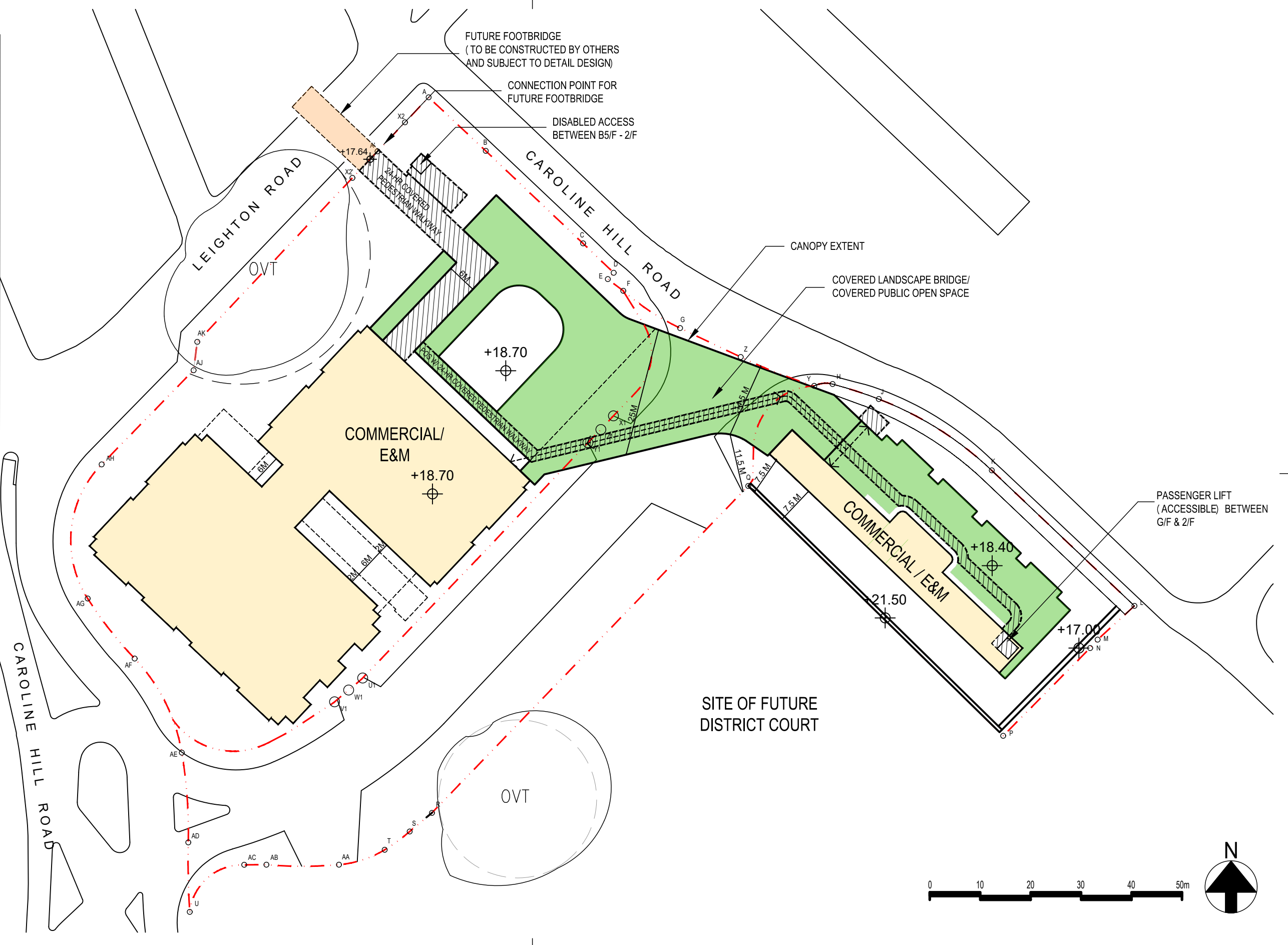

Rev.	Description	Drawn	Checked	Approved	Date
-	1st SUBMISSION				13-2022
A	1st AMENDMENT				9-2023
B	2nd AMENDMENT				1-2024

Rev.	Description	Drawn	Checked	Approved	Date

Check all measurements on site. Do not scale off drawings.

This drawing is to be read in conjunction with the specification and any discrepancies are to be immediately reported to the Architect.

This drawing remains the copyright property of the Architect and is not to be reproduced in whole or in part without permission of the Architect.

B.D. Ref.	
F.S.D. Ref.	
D.L.O. Ref.	
Drawn	Date 1-2024
Checked	Date 1-2024
Approved	Date 1-2024
Cad File No.	



Project Title
PROPOSED COMMERCIAL DEVELOPMENT ON IL NO.8945 AT CAROLINE HILL ROAD, CAUSEWAY BAY, HONG KONG

Drawing Title
SECOND FLOOR PLAN

Project No. 21105HK
Scale 1:750 (A3) Issue Date Sept 2024
Drawing No. MLP-008

Drawing Purpose

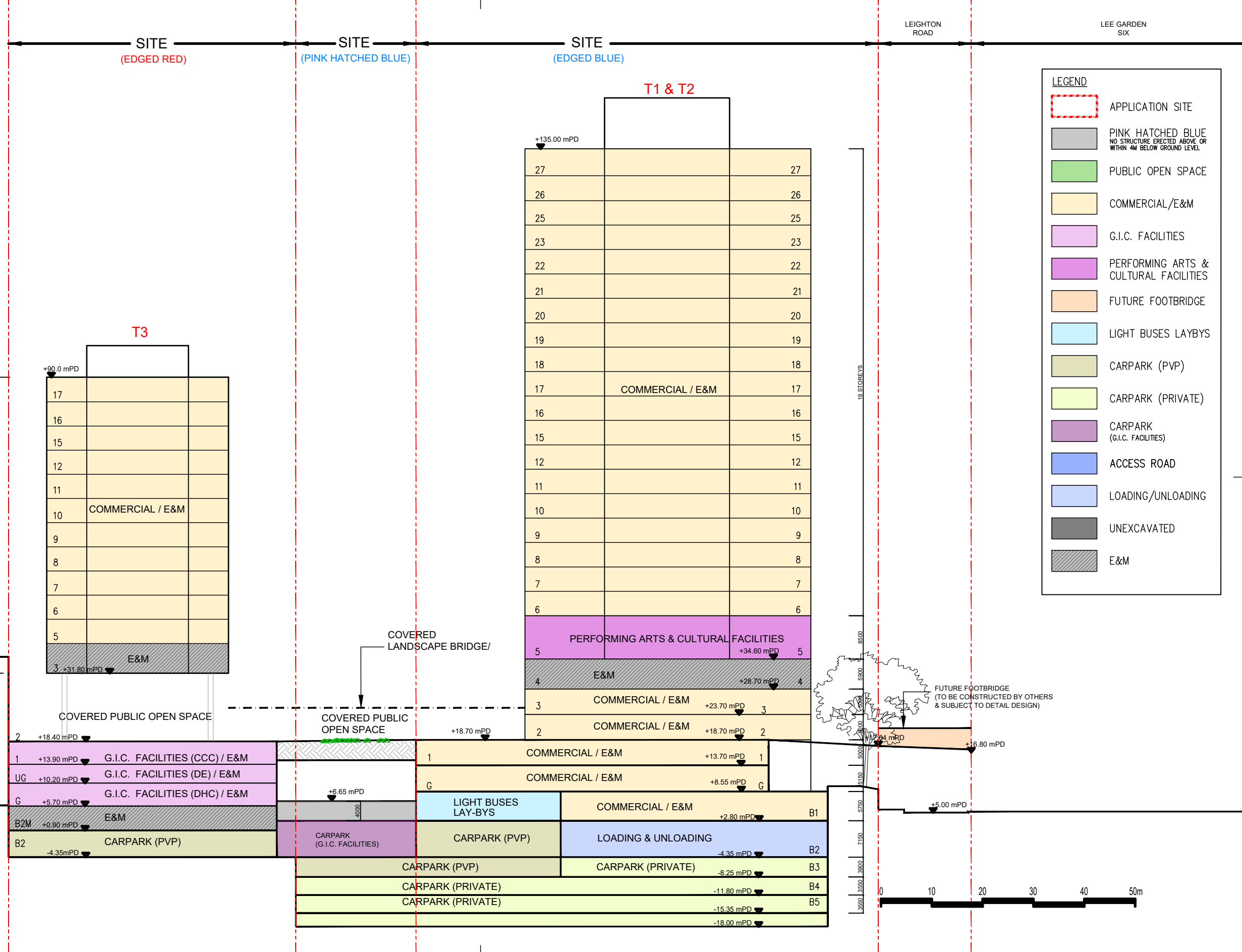
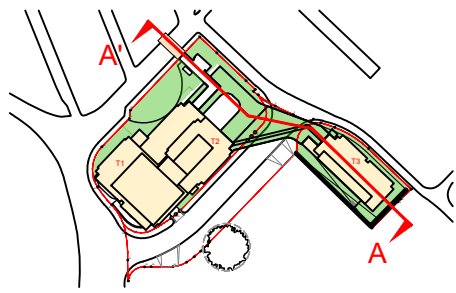

LEGEND

- APPLICATION SITE
- PINK HATCHED BLUE
NO STRUCTURE ERRECTED ABOVE OR WITHIN 4M BELOW GROUND LEVEL
- PUBLIC OPEN SPACE
- COMMERCIAL/E&M
- G.I.C. FACILITIES
- PERFORMING ARTS & CULTURAL FACILITIES
- FUTURE FOOTBRIDGE
- LIGHT BUSES LAYBYS
- CARPARK (PVP)
- CARPARK (PRIVATE)
- CARPARK (G.I.C. FACILITIES)
- ACCESS ROAD
- LOADING/UNLOADING
- UNEXCAVATED
- E&M

Rev.	Description	Drawn	Checked	Approved	Date
-	1st SUBMISSION				13-2022
A	1st AMENDMENT				9-2023
B	2nd AMENDMENT				1-2024

Rev.	Description	Drawn	Checked	Approved	Date

Check all measurements on site. Do not scale off drawings.

This drawing is to be read in conjunction with the specification and any discrepancies are to be immediately reported to the Architect.

This drawing remains the copyright property of the Architect and is not to be reproduced in whole or in part without permission of the Architect.

B.D. Ref.	Date
F.S.D. Ref.	
D.L.O. Ref.	
Drawn	Date 1-2024
Checked	Date 1-2024
Approved	Date 1-2024
Cad File No.	



Project Title
 PROPOSED COMMERCIAL DEVELOPMENT ON IL NO.8945 AT CAROLINE HILL ROAD, CAUSEWAY BAY, HONG KONG

Drawing Title	
SECTION AA'	
Project No.	21105HK
Scale	1:750 (A3)
Issue Date	Sept 2024
Drawing No.	MLP-012

Drawing Purpose

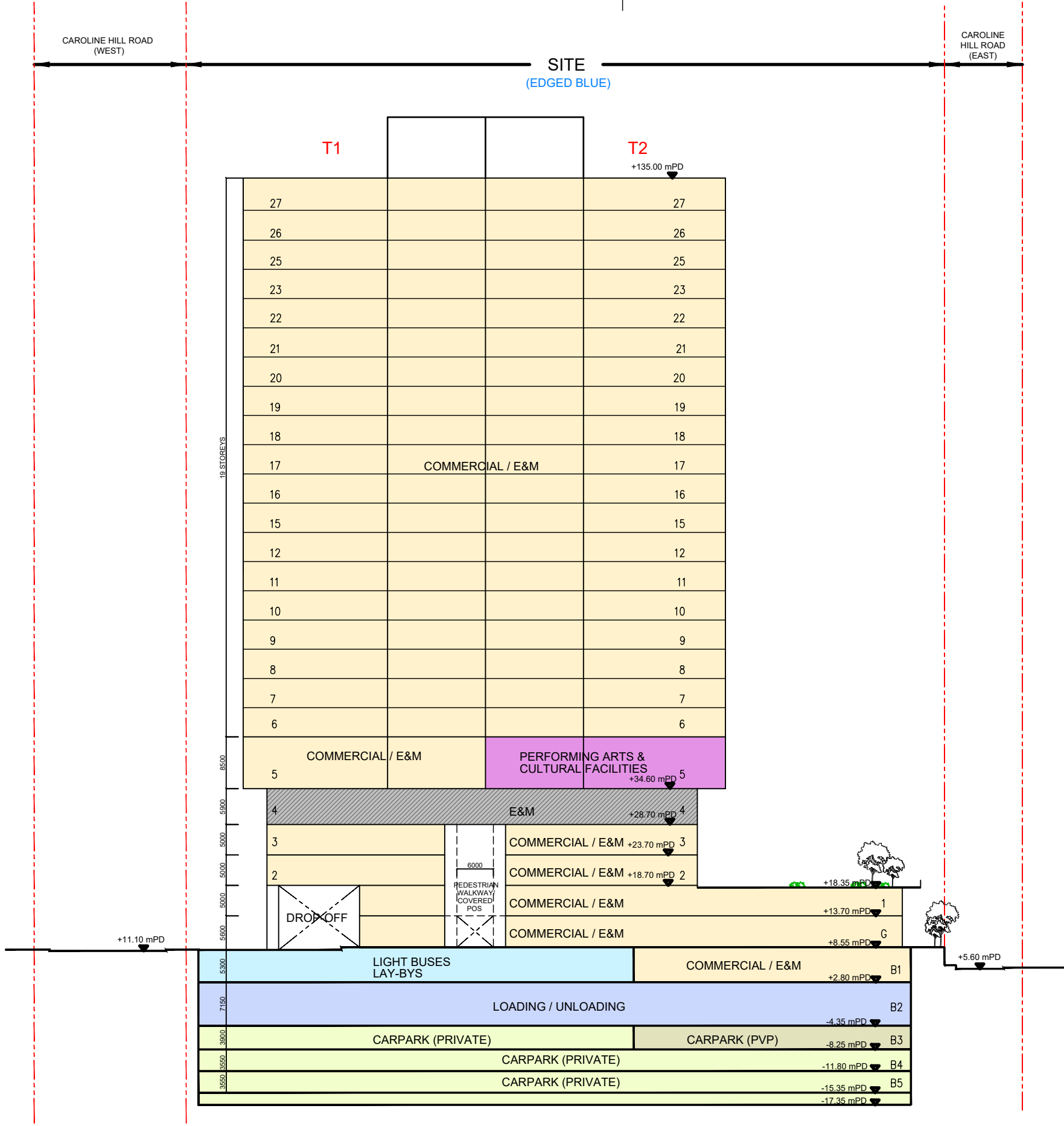
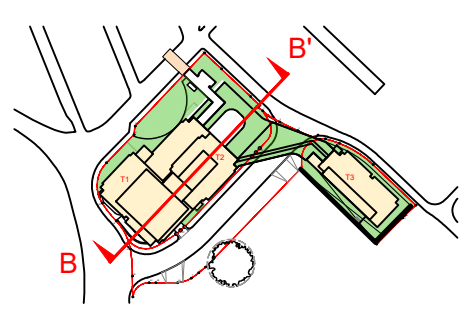

LEGEND	
	APPLICATION SITE
	PINK HATCHED BLUE NO STRUCTURE ERECTED ABOVE OR WITHIN 4M BELOW GROUND LEVEL
	PUBLIC OPEN SPACE
	COMMERCIAL/E&M
	G.I.C. FACILITIES
	PERFORMING ARTS & CULTURAL FACILITIES
	FUTURE FOOTBRIDGE
	LIGHT BUSES LAYBYS
	CARPARK (PVP)
	CARPARK (PRIVATE)
	CARPARK (G.I.C. FACILITIES)
	ACCESS ROAD
	LOADING/UNLOADING
	UNEXCAVATED
	E&M



Rev.	Description	Drawn	Checked	Approved	Date
-	1st SUBMISSION				13-2022
A	1st AMENDMENT				9-2023
B	2nd AMENDMENT				1-2024

Rev.	Description	Drawn	Checked	Approved	Date

Check all measurements on site. Do not scale off drawings.

This drawing is to be read in conjunction with the specification and any discrepancies are to be immediately reported to the Architect.

This drawing remains the copyright property of the Architect and is not to be reproduced in whole or in part without permission of the Architect.

B.D. Ref.	Date
F.S.D. Ref.	
D.L.O. Ref.	
Drawn	Date 1-2024
Checked	Date 1-2024
Approved	Date 1-2024
Cad File No.	



Project Title
PROPOSED COMMERCIAL DEVELOPMENT ON IL NO.8945 AT CAROLINE HILL ROAD, CAUSEWAY BAY, HONG KONG

Drawing Title	
SECTION BB'	
Project No.	21105HK
Scale	1:750 (A3)
Issue Date	Sept 2024
Drawing No.	MLP-013

Drawing Purpose