

## **Annex 1**

---

### Revised Fire Service Installations Proposal

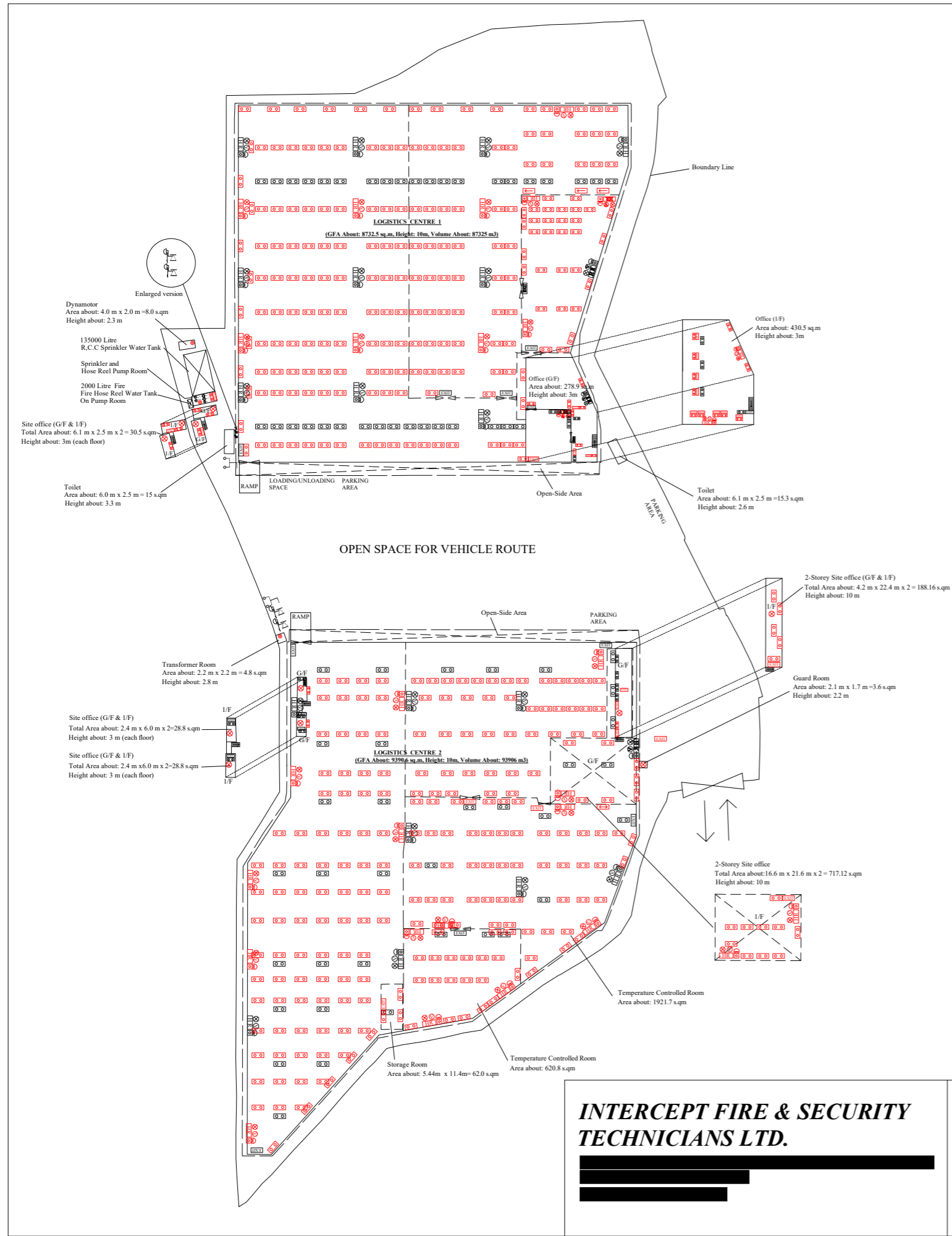

**F.S.Notes:**

1. Sufficient emergency lighting shall be provided throughout the entire buildings/structures in accordance with B.S.5266-1:2016 and EN 1838:2013 and FSD Circular Letter No.4/2021
2. Sufficient directional and exit sign shall be provided in accordance with B.S.5266:Part 1 and FSD circular letter 5/2008.
3. Sufficient Portable hand-operated Approved appliances shall be provided as required by occupancy and as marked on plans.
4. An Automatic sprinkler system supplied by 135,000L sprinkler water tank and hazard class; OH III should be provided to the entire building / structure in accordance with BS EN 12845; 2015 and FSD circular 5/2020. The sprinkler water tank, sprinkler pump room, sprinkler inlet, sprinkler control valve group shall be clearly marked on plans.
5. The storage configuration is ST1 & ST2.  
ST1: free standing or block stacking with reference to the section 6.3.2  
of B.S 12845 and storage pattern is the maximum storage height shall not exceed 4 m & the maximum storage areas shall be 50m<sup>2</sup> for any single block with no less than 2.4m clearance around the block as Ordinary Hazard Group 3 in accordance with LPC BS EN 12845(Storage Category I)  
ST2: Post pallets in single rows, with aisles not less than 2.4m wide with reference to be section 6.3.2 of B.S 12845. Maximum storage heights shall not exceed 3.5m & Aisles between rows shall be not less than 2.4m wide as Ordinary Hazard Group 3 in accordance with LPC BS EN 12845(Storage Category:Category I)
6. A modified hose reel system supplied by a 2000 litre FS water tank shall be provided. There shall be sufficient hose reels to ensure that every part of each building can be reached by a length of not more than 30m of hose reel tubing. The FS water tank, FS pump room and hose reel shall be clearly marked on plans.
7. Fire alarm system shall be provided throughout the entire building in accordance with BS 5839 -1 : 2017 and FSD Circular Letter no 6/2021. One actuation point and audio warning devices to be located at each hose reel point. This actuation point should include facilities for fire pump start and audio/visual warning device initiation.
8. The Sprinkler water Tank & F.S water Tank water supply pipe should be connected to Town Main.
9. Source of secondary power supply shall be provided.
10. Static or dynamic smoke extraction system is not provided. The openable windows of Logistics Centre "1" & "2" with aggregate area exceeding 6.25% of the floor area as marked on plans (detail see openable window layout plan).
11. When A Ventilation/air conditioning control system is provided, It shall stop mechanically induced air movement within a designated compartment.
12. Any intended storage or use of dangerous goods as defined in Chapter 295 of the Laws of Hong Kong should be notified to the Director of Fire Services.

**LEGEND**

- |  |  |  |                                  |
|--|--|--|----------------------------------|
|  | Gate Valve   |  | EXISTING EMERGENCY LIGHTING      |
|  | Non Return Valve   |  | EXISTING EXIT SIGN BOX           |
|  | Pump Set c/w Motor   |  | EXISTING DIRECTION SIGN BOX      |
|  | Sprinkler Control Valve  |  | EXISTING DIRECTION SIGN BOX      |
|  | Sprinkler Inlet  |  | NEWLY INSTALL EMERGENCY LIGHTING |
|  | Existing Fire Hose Reel Set c/w Break Glass and Alarm Bell & Visual Alarm Device & 4 kg dry powder type fire extinguisher      |  | NEWLY INSTALL EXIT SIGN BOX      |
|  | Newly Install Fire Hose Reel Set c/w Break Glass and Alarm Bell & Visual Alarm Device & 4 kg dry powder type fire extinguisher |  | NEWLY INSTALL DIRECTION SIGN BOX |
|  | JP Sprinkler Jockey Pump   |  | NEWLY INSTALL DIRECTION SIGN BOX |
|  | SP-1, SP-2 Sprinkler Duty and Standby Pump   |  |                                  |
|  | HR-P1, HR-P2 Hose Reel Duty and Standby Pump   |  |                                  |
|  | Newly Install 4.0 kg Dry Powder type fire extinguisher   |  |                                  |
|  | Newly Install 5.0 kg CO2 type fire extinguisher  |  |                                  |

**INTERCEPT FIRE & SECURITY  
TECHNICIANS LTD.**

[Redacted]  
[Redacted]  
[Redacted]

Project :  
Temporary Logistics Centre with Ancillary Office and Parking of Vehicle for a Period of 3 Years at Various Lots in D.D.125 and D.D129 and Adjoining Government Land, Ha Tsuen, Yuen Long, New Territories.

Title :  
**Proposed Automatic Sprinkler and Modified Hose Reel System**

Drawn By :	W.C WONG
Date :	2024-4-30
Scale :	1 : 600 @A1
Ref. No :	TPB/A/HSK/511
Revise Date:	2024-04-30

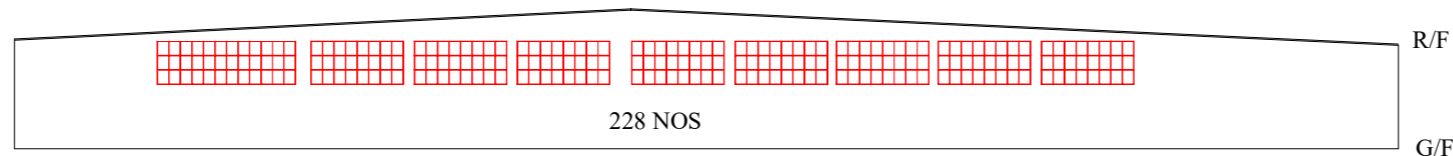

**Legend:**

□ Openable window (Area: 0.8m X 1m=0.8sq.m)

**Calculate(G/F):**

The aggregated area of openable window is:  
 $0.8\text{sq.m} \times (228+228+240)\text{ nos} = 556.8\text{sq.m}$   
 6.25% of the floor area(G/F) is:  $8732.5\text{sq.m} \times 6.25\% = 545.78\text{sq.m}$   
 $556.8\text{sq.m} > 545.78\text{sq.m}$

**Calculate(1/F):**

The aggregated area of openable window is:  
 $0.8\text{sq.m} \times (18+16)\text{ nos} = 27.2\text{sq.m}$   
 6.25% of the floor area(1/F) is:  $430.5\text{sq.m} \times 6.25\% = 26.9\text{sq.m}$   
 $27.2\text{sq.m} > 26.9\text{sq.m}$

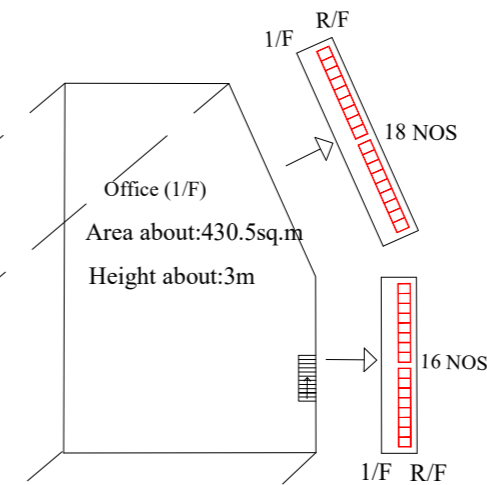
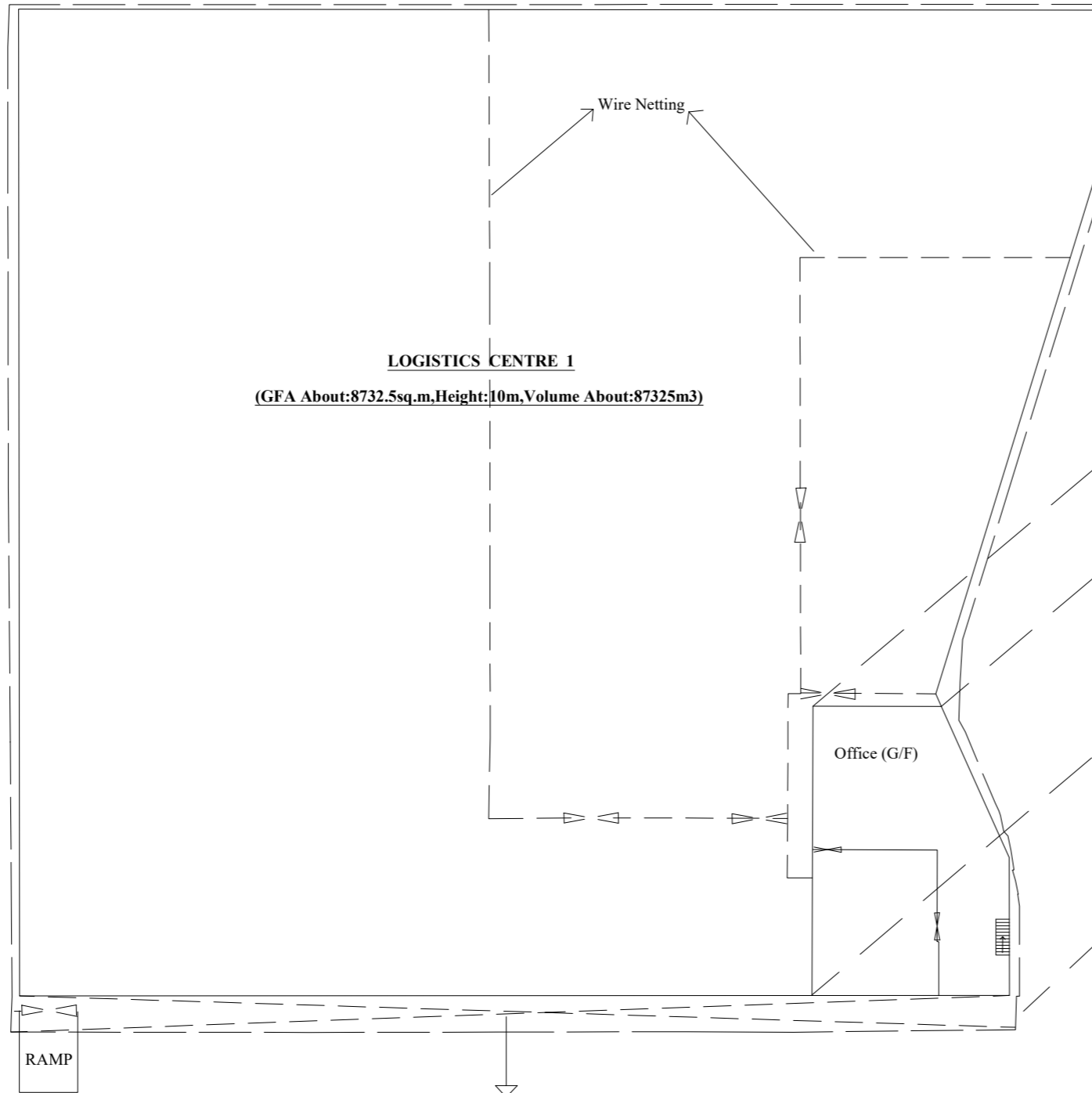
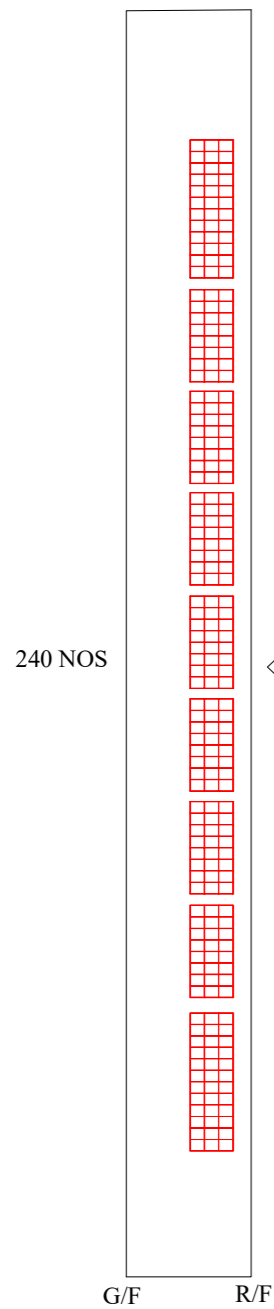

**1/F:OPENABLE WINDOWS LAYOUT OF OFFICE IN LOGISTICS CENTRE "1" (Side Elevation)**



**G/F:OPENABLE WINDOWS LAYOUT OF LOGISTICS CENTRE "1" (Side Elevation)**

Project :  
 Temporary Logistics Centre with Ancillary Office and Parking of Vehicle for a Period of 3 Years at Various Lots in D.D.125 and D.D129 and Adjoining Government Land, Ha Tsuen, Yuen Long, New Territories.

Title :  
**Proposed Openable window Layout Plan**

Drawn By :	W.C WONG
Date :	2024-04-30
Scale :	1 : 600 @A3
Ref. No :	TPB/A/HSK/511
Revise Date:	2024-04-30

INTERCEPT FIRE & SECURITY TECHNICIANS LTD.



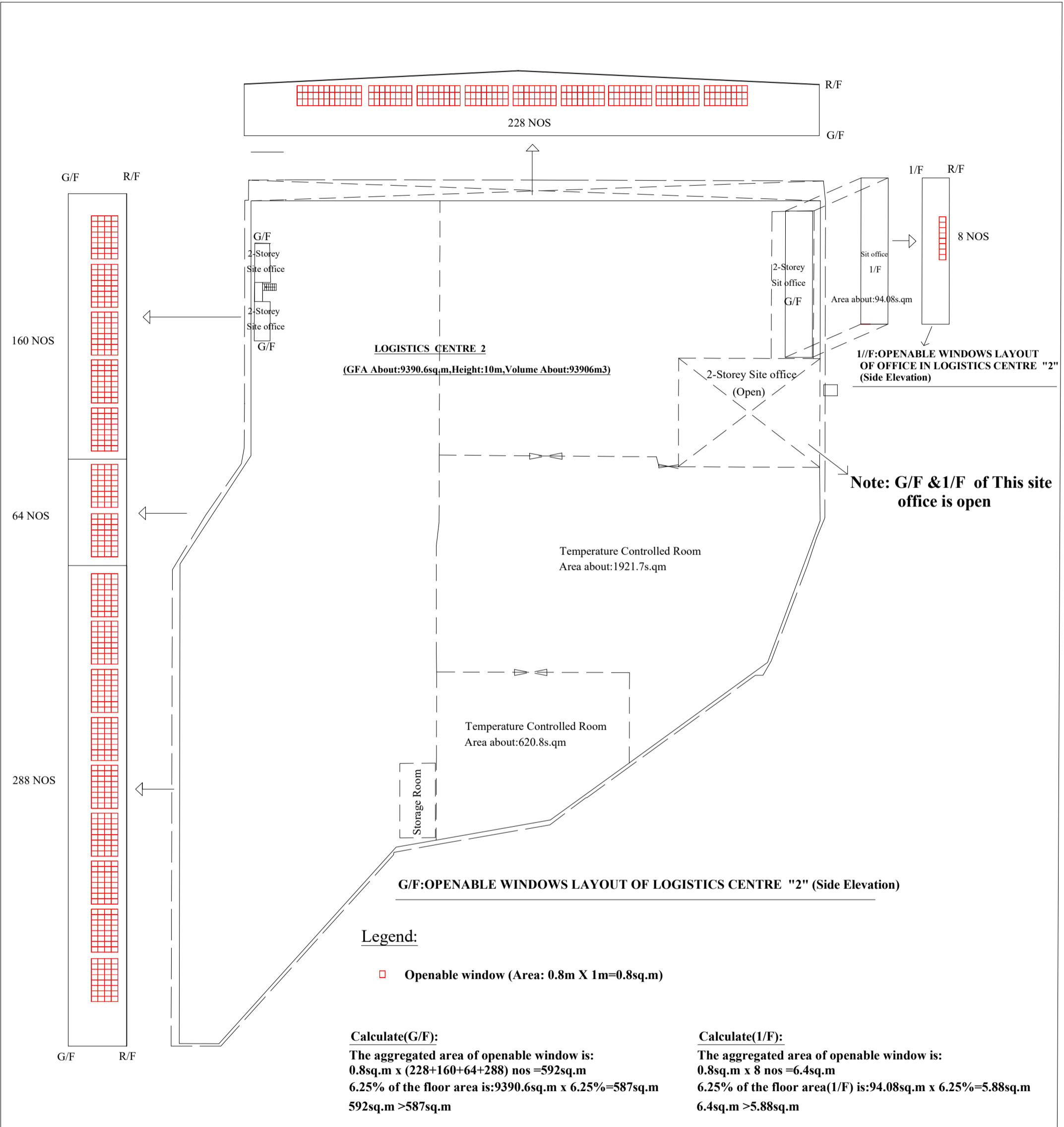

<b>INTERCEPT FIRE &amp; SECURITY TECHNICIANS LTD.</b> 	<b>Project :</b> Temporary Logistics Centre with Ancillary Office and Parking of Vehicle for a Period of 3 Years at Various Lots in D.D.125 and D.D129 and Adjoining Government Land, Ha Tsuen, Yuen Long, New Territories.	<b>Title :</b> Proposed Openable window Layout Plan	<b>Drawn By :</b> W.C WONG
			<b>Date :</b> 2024-04-30
			<b>Scale :</b> 1 : 600 @A3
			<b>Ref. No :</b> TPB/A/HSK/511
			<b>Revise Date:</b> 2024-04-30