



申請地點
Application Site

樓宇通知
Noticeplate

沙江圍仔
Sha Keng
Wai Tsai

濠浮山道
LAU FAU SHAN ROAD

屏廣路

PING HA ROAD

屏廣路
PING KONG ISHIN ROAD

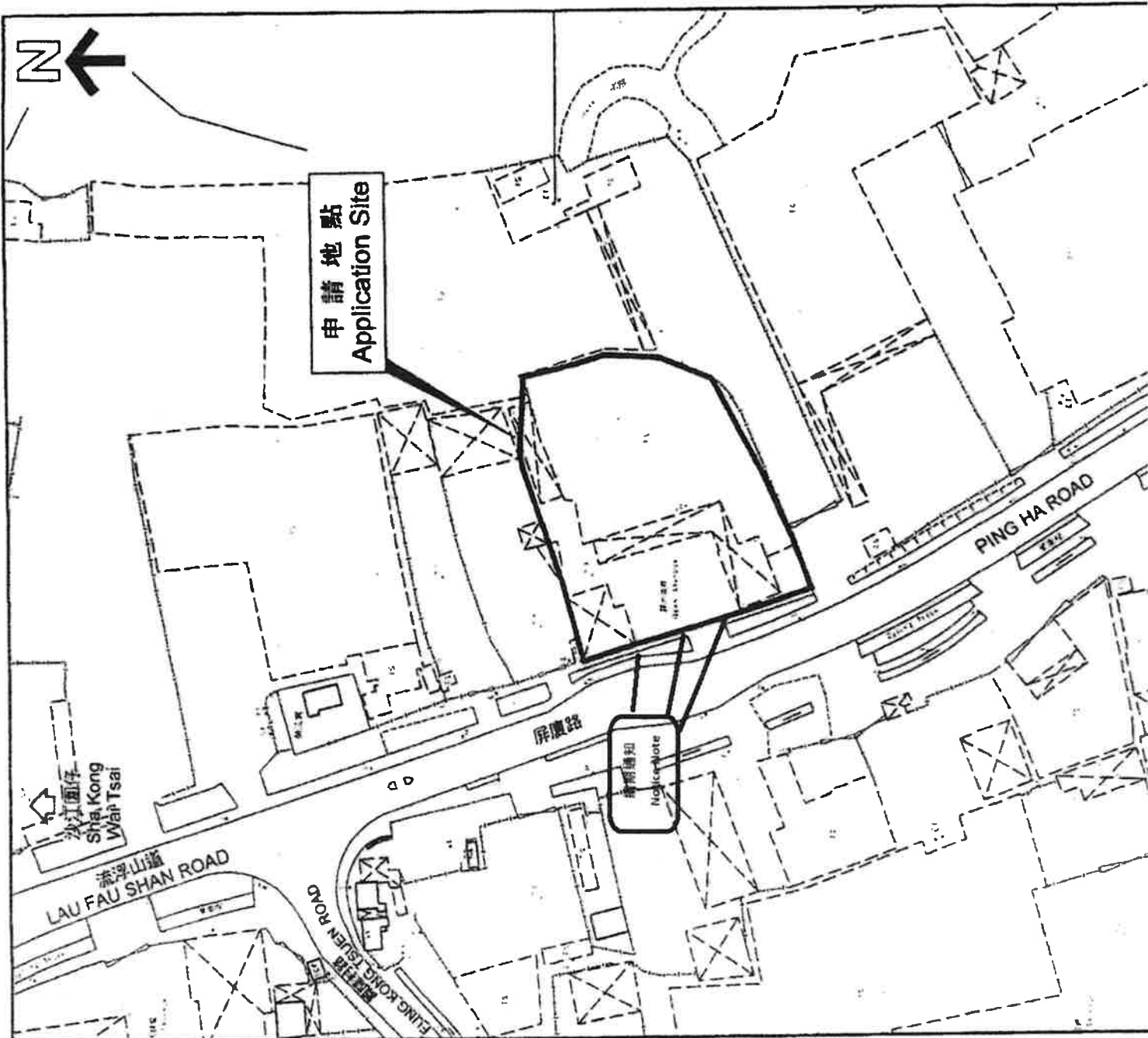

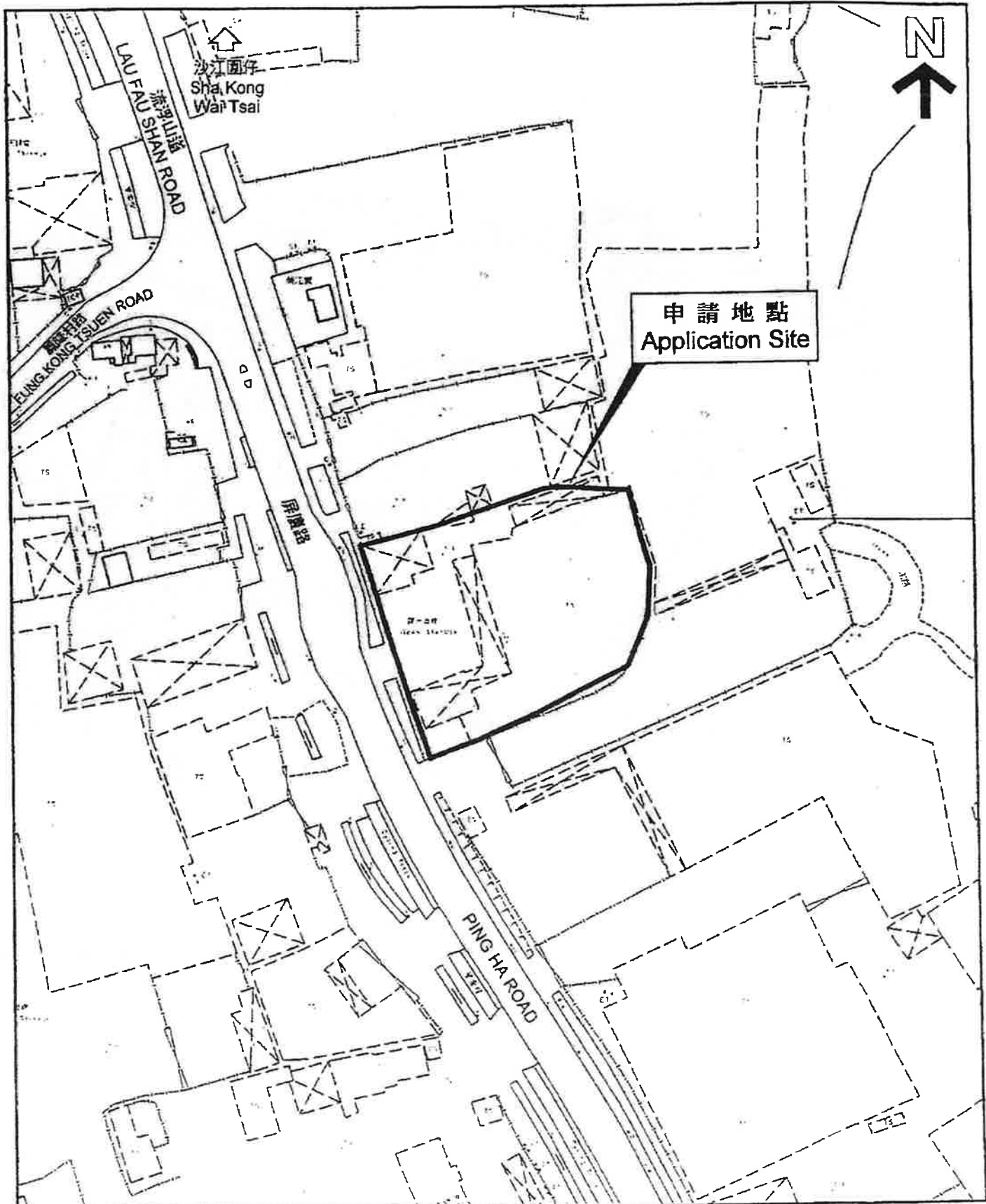

申請地點
Application Site

LAU FAU SHAN ROAD
沙江圍仔

沙江圍仔
Sha Kong
Wai Tsai

FUNG KONG TSUEN ROAD
鳳崗村

PING HA ROAD
平河路

沙江圍仔
Sha Kong
Wai Tsai

Drawing No. 圖號

1 1

Drawing Title 圖名

Project location

Scale 比例

1 : 1000

Project 項目

Temporary Logistics Centre
and Auxiliary Tyre Repair
Workshop for a Period of 3 Years

Lot 2309R (E-ent),

3306 (E-ent), 3307R (E-ent),

3310S, A, R (E-ent),

3310Y, B (E-ent), 3311R (E-ent),

3312S, A (E-ent), 3312S, D,

3313 (E-ent), 3314 (E-ent)

In D.D. 129, He Tuen, Yuen Long

Notes 附註

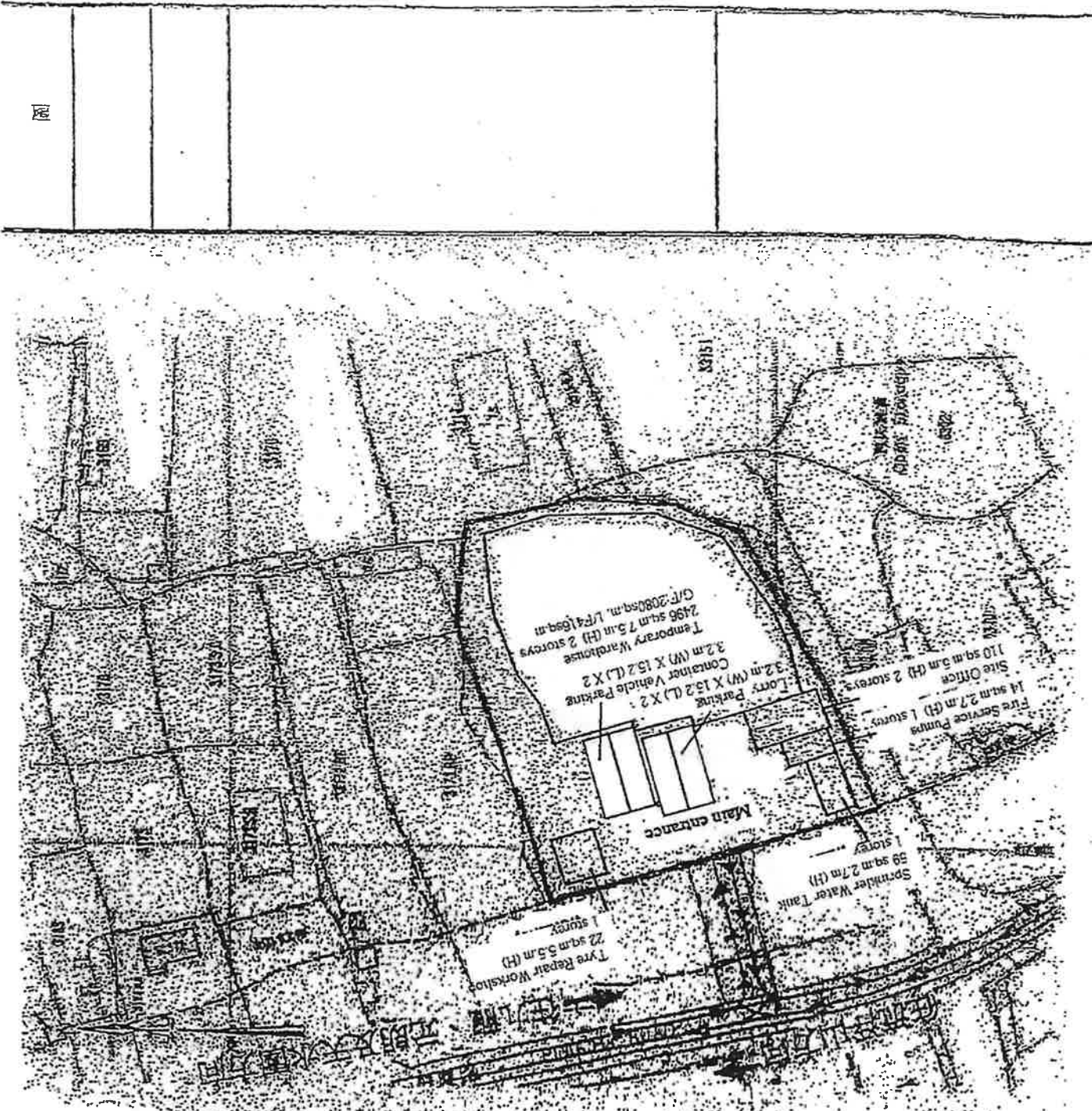

4 圖 4

Drawing Title 圖目

申請地渠渠務建議

Scale 比例

1 : 1000

Project 項目

有關元朗廣村丈量約份第 129 約
地段編號 3305(部份), 3306(部份),
3307, 3310SA(部份), 3310SB(部份),
3311, 3312SA(部份), 3312SB,
3313(部份) 及 3314(部份)之土地

規劃申請作

Location of Site
photos

Notes 備註

U型明渠

暗渠

有蓋U型明渠

沙井/集水位

出水口

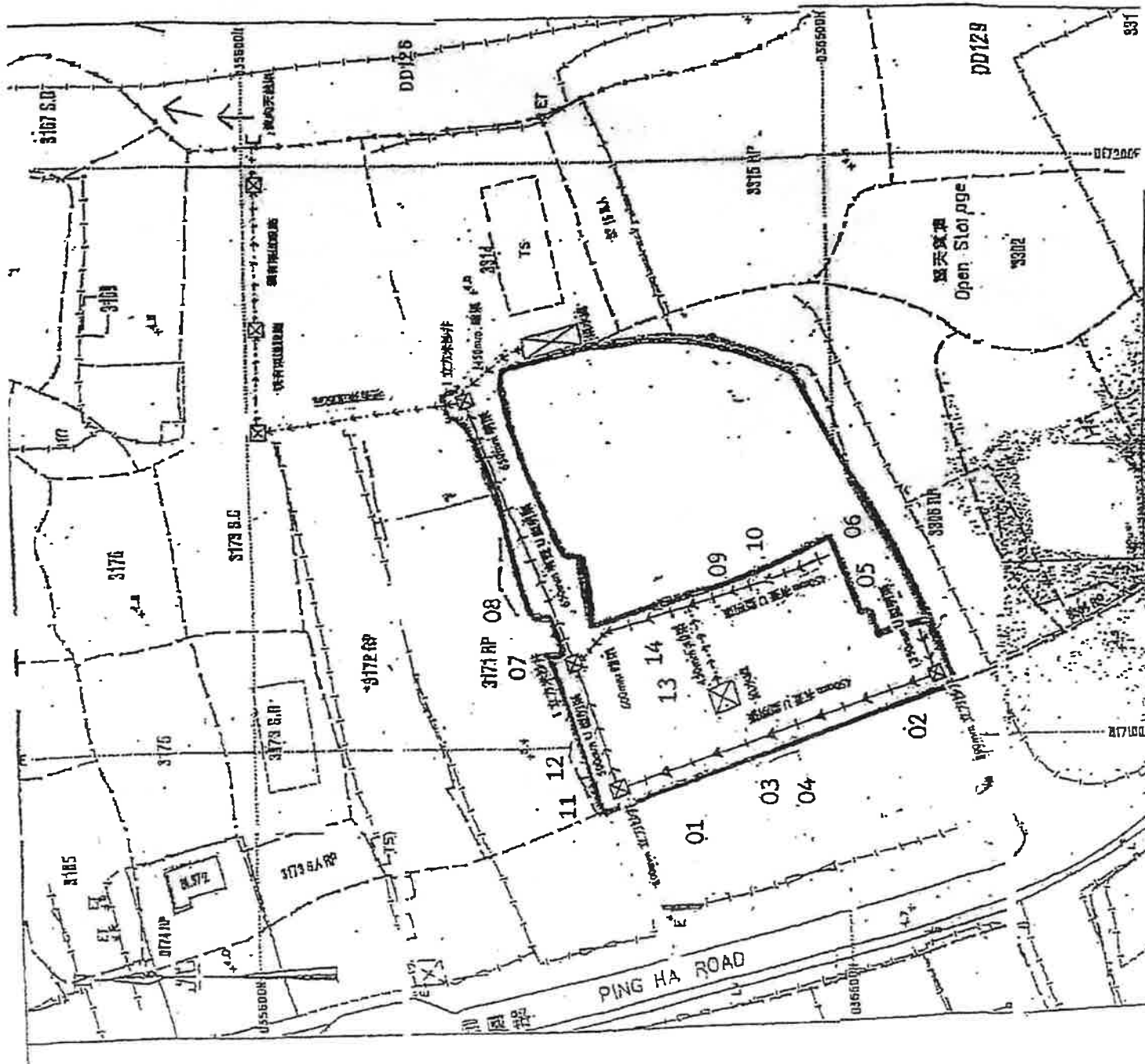

Drawing No. 4R

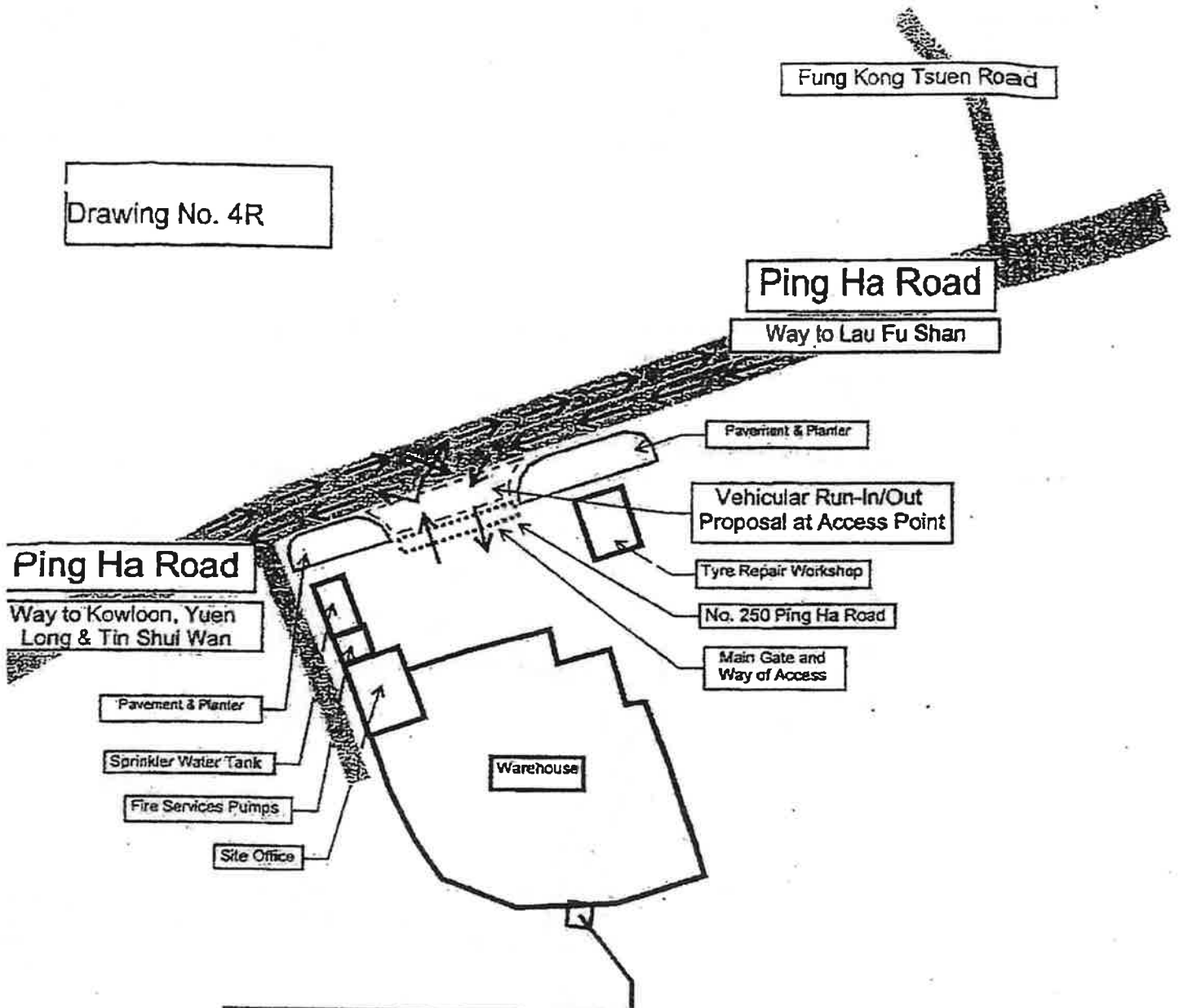

Block Plan of
Lots No. 3305 RP (Part), 3306 (Part), 3307 RP, 3310 S.A RP (Part), 3310 S.B (Part), 3311 RP, 3312 S.A (Part), 3312 S.B, 3313 (Part) and 3314 (Part) in D.D. 129, Ha Tsuen, Yuen Long.

Remarks:
The Run-In/Out at the road near Ping Ha Road is according to the latest version of Highways Standard Drawings No. H1113 and H1114, or H5133, H5134 and H5135, whichever set is appropriate to match with the existing adjacent pavement.

EXISTING TREES LOCATION

