

Urgent Return receipt Expand Group Restricted Prevent Copy

Moon Leong KOK/PLAND

寄件者: 陳灝然 <hoyinchan007@gmail.com>
寄件日期: 2024年10月17日星期四 16:09
收件者: tpbpd/PLAND
副本: Moon Leong KOK/PLAND
主旨: A/HSK/538補充資料
附件: 場地設計圖.pdf; 申請理由.pdf; 312 FS Plan Blank_proposal_02-09-2024-Model 3 (1).pdf; 312 FS Plan Blank_proposal_02-09-2024-FS-07 (2).pdf; 312 FS Plan Blank_proposal_02-09-2024-Model 1 (1).pdf; 312 FS Plan Blank_proposal_04-09-2024-Model 2.pdf; 312 FS Plan Blank_proposal_02-09-2024-FS-08 (2).pdf; 312 FS Plan Blank_proposal_04-09-2024-Model 4.pdf; 312 FS Plan Blank_proposal_02-09-2024-FS-01 (2).pdf; 312 FS Plan Blank_proposal_02-09-2024-FS-03 (2).pdf; 312 FS Plan Blank_proposal_02-09-2024-FS-02 (2).pdf; 312 FS Plan Blank_proposal_02-09-2024-FS-04 (2).pdf; 312 FS Plan Blank_proposal_02-09-2024-FS-05 (2).pdf; 312 FS Plan Blank_proposal_02-09-2024-FS-06 (2).pdf
類別: Internet Email

敬啟者

有關上述檔案，現提交消防建議及修改資料。

申請理由

申請地點位於新界元朗廈村丈量約份第125約地段第57號(部分)、第66號(部分)、第67號(部分)、第68號、第69號(部分)、第70號(部分)、第73號(部分)、第74號(部分)、第75號(部分)、第76號A分段(部分)、第76號B分段、第77號(部分)、第78號、第79號、第80號(部分)、第81號(部分)、第84號(部分)、第85號、第86號、第87號、第88號、第89號(部分)、第90號(部分)、第91號(部分)、第92號(部分)、第781號B分段餘段、第782號B分段餘段、第783號B分段餘段、第784號B分段餘段、第785號、第786號、第787號、第788號(部分)、第789號(部分)、第790號(部分)、第791號(部分)、第792號(部分)及第793號(部分)、丈量約份第129約地段第3212號餘段(部分)、第3234號(部分)、第3235號(部分)、第3237號(部分)、第3238號、第3239號(部分)、第3240號、第3241號、第3242號、第3243號、第3246號、第3248號、第3251號A分段(部分)、第3251號餘段(部分)、第3253號(部分)、第3265號餘段(部分)、第3268號、第3269號、第3270號(部分)、第3271號(部分)、第3272號、第3273號、第3274號、第3275號、第3276號、第3277號、第3278號、第3279號、第3280號、第3281號(部分)、第3282號(部分)、第3283號(部分)、第3284號(部分)、第3285號(部分)、第3286號(部分)、第3287號餘段(部分)、第3288號餘段(部分)、第3289號B分段餘段(部分)、第3290號、第3291(部分)、第3292號B分段餘段(部分)及第3442號(部分)和毗連政府土地，申請場地面積約 45900 平方米，包括約 3640 平方米政府土地。由思信停車場有限公司提出申請，作為期三年的擬議臨時物流中心、貯物倉庫、汽車修理工場、露天存放貨櫃及貨櫃車停車場連附屬工場(包括進行壓實及拆除包裝)及食堂。

申請地點位於洪水橋及廈村分區計劃大綱核准圖編號 S/HSK/2 的「政府、機構或社區」、「商業(4)」、「住宅(甲類)3」及顯示為「道路」的地方。申請地點由二十四幅相連的土地組成，涉及部分政府土地。申請地點地型不規則，近似長方型。按規劃署記錄，在申請地點所在的同一地帶內，申請地點四周有不少類似案件獲通過。

- 檔案編號：A/HSK/316，臨時物流中心及貨倉（為期3年），於23/07/2021在有條件下批給臨時性質的許可；
- 檔案編號：A/HSK/94，臨時物流中心及貨倉（為期3年），於21/09/2018在有條件下批給臨時性質的許可；
- 檔案編號：A/HSK/312，臨時物流中心、貯物倉庫、冷凍倉庫、露天存放貨櫃及貨櫃車停車場連附屬工場(包括進行壓實及拆除包裝和修補汽車輪胎)及食堂（為期3年），於09/07/2021在有條件下批給臨時性質的許可；
- 檔案編號：A/HSK/345，臨時物流中心（為期3年），於14/01/2022在有條件下批給臨時性質的許可；

- 檔案編號：A/HSK/307，臨時物流中心及附屬輪胎維修工場（為期3年），於25/06/2021在有條件下批給臨時性質的許可；
- 檔案編號：A/HSK/227，臨時物流中心及附屬泊車位（為期3年），於26/06/2020在有條件下批給臨時性質的許可；
- 檔案編號：A/HSK/163，臨時貯存倉庫及物流中心（為期3年），於19/07/2019在有條件下批給臨時性質的許可；

由於場地早年已發展作臨時物流中心及貨倉，已進行地基平整，基本設施齊備，無須進行任何斬樹、填池、鑽土及隔斷水源等損害環境的開關工作。地面鋪築成硬地表，容易去水。場地於前規劃申請已履行了渠務工程，且排水設施都有專人定期保養，其狀況良好。有關美化環境方面，前規劃申請也履行了美化環境及保護樹木建議，申請人至今一直都有保育場內樹木。因此是次申請的渠務建議計劃及美化環境及保護樹木建議計劃均沿用前申請繼續執行。

申請地點內不會存放易燃物品，從事工作整齊而簡單，容易還完，能與周圍環境配合。發展項目不含有害廢料或污染物，不會發出氣味，對生態及環境不會帶來任何負面影響。申請人會委託專業管理公司進行管理，對已實施的附帶條件工程設備提供維修及保養，包括現有樹木、渠道系統及現有的邊界圍欄等。

管理公司亦會負責環境衛生並按時派專員收集和清理垃圾，噴灑防蚊藥水，確保環境衛生及美觀，相信場地發展後亦能繼續與社區保持和諧。申請人會遵從環保署署長最新發出的《處理臨時用途及露天貯存用地的環境問題作業指引》，盡量減低可能對附近易受影響地方所造成的環境影響。

在營運性質方面，場地會由外國知名電器品牌租用作貯存高價家庭電器。所存放的高價家庭電器主要轉口到外地，部分會在香港出售。由於有部分貨物會在香港出售，所以發展包括物流中心連貯物貨倉，不過物流用途比例偏低。物流工作主要將部份貨物由貨車運走，分發予港九大型百貨公司。食堂方面，設約 30 個座位，屬場地人性化配套設施。由於場地位置偏僻，除了員工和有需要到場地工作之人士，例如：貨櫃車司機，並無外人光顧，食堂亦不會對外開放。

申請地點開放時間，為星期一至星期六，早上八時至晚上八時，星期日及公眾假期休息。必要運輸工作，會安排在日間非繁忙時間進行，晚上不會進行任何運輸工作。

場內共設 31 個構築物，構築物序號：TS1 至 TS31，上蓋面積共約 19692.7 平方米，佔場地約 42.90 % 的土地。以下為構築物的詳細資料：

構築物序號	上蓋面積 (平方米)	樓面面積 (平方米)	高度 (米)	層數	建築物料	用途
TS1	9736	19472	15	2	金屬	物流倉庫
TS2	26.5	26.5	3	1	金屬	電錶房
TS3	9	9	3	1	金屬	電錶房
TS4	6	6	3	1	金屬	電錶房
TS5	333	321	8	1	金屬	維修部 (其中突出簷篷面積約12平方米)
TS6	16	16	3	1	混凝土	廁所
TS7	150	300	6.4	2	金屬	寫字樓
TS8	9	9	3	1	金屬	廁所
TS9	58	92	6.4	2	金屬	貨櫃儲物、涼棚 (上層儲物空間以貨櫃形式存在， 因此樓面面積不作整層計算， 上層面積約34平方米)
TS10	7.5	7.5	3	1	金屬	電錶房
TS11	1016	1076	8	2	金屬	維修部、寫字樓 (只有寫字樓部分是兩層， 由兩層貨櫃搭建，第二層約60平方米)
TS12	247	237	8	1	金屬	維修部、廁所 (其中突出簷篷面積約10平方米)
TS13	42	42	6.4	1	金屬及混凝土	廁所、儲物室
TS14	102	204	6.4	2	金屬	員工飯堂
TS15	192	384	6.4	2	金屬	地下：員工飯堂 上層：寫字樓
TS16	530	725	6.4	2	金屬	地下：汽車維修 上層：寫字樓 (上層寫字樓發展的面積並沒有一 整層，只有約195平方米)
TS17	2	2	3	1	金屬	電錶房

TS18	363	443	8	1	金屬	倉庫、洗手間 (上層是一個可拆卸的貨架平台， 只有約80平方米，故作一層計算)
TS19	6	6	3	1	金屬	電錶房
TS20	1093	869.8	12	1	金屬	物流倉庫、寫字樓 (其中突出簷篷面積約223.2平方米)
TS21	15	30	6.4	2	金屬	廁所、寫字樓、員工休息室
TS22	21	21	3	1	金屬	廁所
TS23	141	282	6.4	2	金屬及混凝土	地下：石矢消防水缸及金屬泵房 上層：寫字樓
TS24	7.5	7.5	3	1	金屬	保安室
TS25	4.2	4.2	3	1	混凝土	電錶房
TS26	4936	4671.3	12	1	金屬	物流倉庫、寫字樓 (其中突出簷篷面積約264.7平方米)
TS27	21	42	6.4	2	金屬	電錶房、員工休息室
TS28	116	116	3.3	1	金屬	涼棚
TS29	50	100	6.4	2	金屬	地下：貨櫃儲物 上層：寫字樓
TS30	422	422	6.4	1	金屬	涼棚
TS31	15	15	3	1	金屬	廁所

「露天存放貨櫃範圍」，用作儲存貨櫃及貨物分流、包裝，該區內不設上蓋物，共佔面積約 2414 平方米，佔場地約 5.26% 土地。申請地點邊陲五米範圍不會存放貨櫃，存放貨櫃的高度不會超過八個貨櫃的堆疊高度。「車輛輪候及貨櫃車停泊區」，以供場地所屬的貨櫃車及拖頭停泊。設立此區的目的，可確保場地發展不會影響附近交通，共佔面積約 1006 平方米，佔場地約 2.19% 土地。

餘下面積約 22787.3 平方米的土地，佔申請地點約 49.65% 土地會用作流動空間。流動空間具緩衝及協調作用，可紓緩發展對環境的影響。即場地設計圖內所示，申請地點內未有註明的空白部份。

08:00 - 09:00	0	0	0	0	10	0	0
09:00 - 10:00	0	0	0	0	10	0	0
10:00 - 11:00	9	9	1	0	0	0	0
11:00 - 12:00	7	7	0	1	0	0	0
12:00 - 13:00	0	0	0	0	0	8	0
13:00 - 14:00	0	0	0	0	8	0	0
14:00 - 15:00	9	9	1	0	0	0	0
15:00 - 16:00	7	7	0	1	0	0	0
16:00 - 17:00	0	0	0	0	0	0	0
17:00 - 18:00	0	0	0	0	0	10	0
18:00 - 19:00	0	0	0	0	0	10	0
19:00 - 20:00	0	0	0	0	0	0	0
<p>以上數字為預算車輛進出場地記錄， 假設當天附近地區沒有交通事故，進出場地車輛數量正常。</p>							

由於申請地點需預約上落貨，實際運作時一半貨櫃車上落貨車位（9個）只用作輪侯用途，另外一半上落貨車位（9個）售進行裝卸。裝卸一個貨櫃需約 45 分鐘至 1 小時計算，預算上蓋倉庫每小時能處理 9 輛貨車的裝卸量。當裝卸完成便會有 9 輛貨車離開場地，換言之每小時等於有 18 輛貨車的汽車流量，不過以上只是最高用量的汽車流量。按實際情況及交收發票估計，每小時大約會裝卸 7-9 輛貨車。以裝卸一出一入來回計算，7-9 輛貨車離開亦會有 7-9 駕次貨車進場準備裝貨，即每小時實際會有 14-18 駕次貨車的汽車流量。



申請地點的運輸工作並無迫切性，可以完全控制貨物交收時間。運輸工作可按交通情況靈活調配，必要的交收運輸工作，會安排在日間非繁忙時間進行。按實際經驗，每天早上九時至十時（場地開放後）及下午四時至六時（場地關門前），屬繁忙時間。加上上午十二時下午至二時為午膳時間，不會有裝卸貨櫃工作。而晚上六時以後，亦不會進行任何運輸工作。故此，上述每小時 14-18 輛貨車的貨櫃車流量，只會出現在每天早上十時至上午十二時及下午二時至四時的非繁忙時間進行。

此申請發展能提高地區治安警覺性，從而改善環境衛生。在完善管理下，可避免土地荒廢或被人胡亂傾倒泥頭或廢物，減少細菌及蚊蟲滋生的可能。另外，申請地點位於物流業及貨櫃場雲集地區，周圍多屬露天倉地或貨櫃場地，加上業界對物流貨運用地有一定需求，申請能製造就業機會外，還能紓緩其需求。於提交申請前，申請人已徵詢過區內人士，並沒收到任何反對意見。

申請人承諾會以友善的態度，積極與各政府部門溝通，遵從各方面守則並努力進行多樣紓緩環境影響工程，務求令場地獲得發展後仍不會對周圍環境帶來顯著影響。此申請能有意義及靈活地善用地點資源。此乃屬過渡性質，為政府日後開闢土地帶來方便，發展項目簡單，容易還原，能與周圍環境配合，不存在任何永久建築，與未來規劃方向沒有抵觸。申請人明白政府有意發展元朗西即洪水橋及廈村區，團隊最終須配合洪水橋及廈村分區計劃大綱圖的意願發展，申請人願意配合，只希望在發展計劃動工前作其他發展。倘若政府工程展開，此申請亦會告一段落。敬希城規會能接受這份合乎情理的申請，並予以批准。

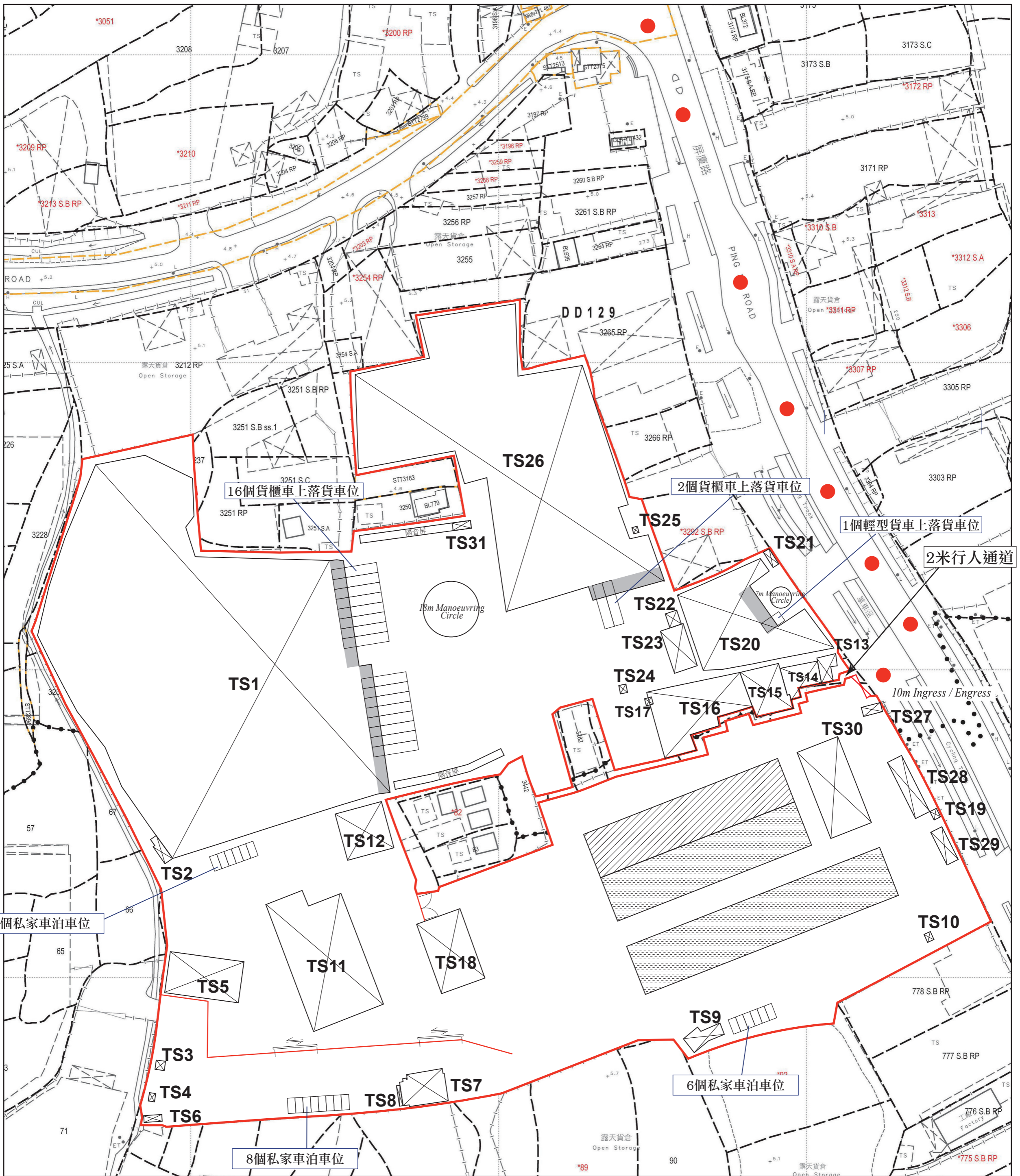
場地設計圖



-  簷篷
-  露天存放貨櫃範圍
-  車輛輪候及貨櫃車停泊區

● ● ● 行車路線
SCALE 1 : 1000

構築物序號	上蓋面積 (平方米)	樓面面積 (平方米)	高度 (米)	層數	建築物料	用途
TS1	9736	19472	15	2	金屬	物流倉庫
TS2	26.5	26.5	3	1	金屬	電錶房
TS3	9	9	3	1	金屬	電錶房
TS4	6	6	3	1	金屬	電錶房
TS5	333	321	8	1	金屬	維修部 (其中突出簷篷面積約12平方米)
TS6	16	16	3	1	混凝土	廁所
TS7	150	300	6.4	2	金屬	寫字樓
TS8	9	9	3	1	金屬	廁所
TS9	58	92	6.4	2	金屬	貨櫃儲物、涼棚 (上層儲物空間以貨櫃形式存在， 因此樓面面積不作整層計算， 上層面積約34平方米)
TS10	7.5	7.5	3	1	金屬	電錶房
TS11	1016	1076	8	2	金屬	維修部、寫字樓 (只有寫字樓部分是兩層， 由兩層貨櫃搭建，第二層約60平方米)
TS12	247	237	8	1	金屬	維修部、廁所 (其中突出簷篷面積約10平方米)
TS13	42	42	6.4	1	金屬及混凝土	廁所、儲物室
TS14	102	204	6.4	2	金屬	員工飯堂
TS15	192	384	6.4	2	金屬	地下：員工飯堂 上層：寫字樓
TS16	530	725	6.4	2	金屬	地下：汽車維修 上層：寫字樓 (上層寫字樓發展的面積並沒有一 整層，只有約195平方米)
TS17	2	2	3	1	金屬	電錶房
TS18	363	443	8	1	金屬	倉庫、洗手間 (上層是一個可拆卸的貨架平台， 只有約80平方米，故作一層計算)
TS19	6	6	3	1	金屬	電錶房

TS20	1093	869.8	12	1	金屬	物流倉庫、寫字樓 (其中突出簷篷面積約223.2平方米)
TS21	15	30	6.4	2	金屬	廁所、寫字樓、員工休息室
TS22	21	21	3	1	金屬	廁所
TS23	141	282	6.4	2	金屬及混凝土	地下：石矢消防水缸及金屬泵房 上層：寫字樓
TS24	7.5	7.5	3	1	金屬	保安室
TS25	4.2	4.2	3	1	混凝土	電錶房
TS26	4936	4671.3	12	1	金屬	物流倉庫、寫字樓 (其中突出簷篷面積約264.7平方米)
TS27	21	42	6.4	2	金屬	電錶房、員工休息室
TS28	116	116	3.3	1	金屬	涼棚
TS29	50	100	6.4	2	金屬	地下：貨櫃儲物 上層：寫字樓
TS30	422	422	6.4	1	金屬	涼棚
TS31	15	15	3	1	金屬	廁所

LEGEND	
	FIRE ALARM BELL
	VISUAL FIRE ALARM
	MANUAL FIRE ALARM CALL POINT (BREAK GLASS TYPE)
	EXIT SIGN
	HOSE REEL SET
	FIXED FIRE PUMP/SPRINKLER PUMP
	SPRINKLER CONTROL VALVE
	5KG CO2 FIRE EXTINGUISHER
	9 LITRES FOAM FIRE EXTINGUISHER
	4KG DRY POWDER FIRE EXTINGUISHER
	F.S. CONTROL PANEL
	SPRINKLER / F.S. INLET
	DOUBLE SLIDING DOOR
	W/S WORK SHOP
	5KG DRY POWDER FIRE EXTINGUISHER

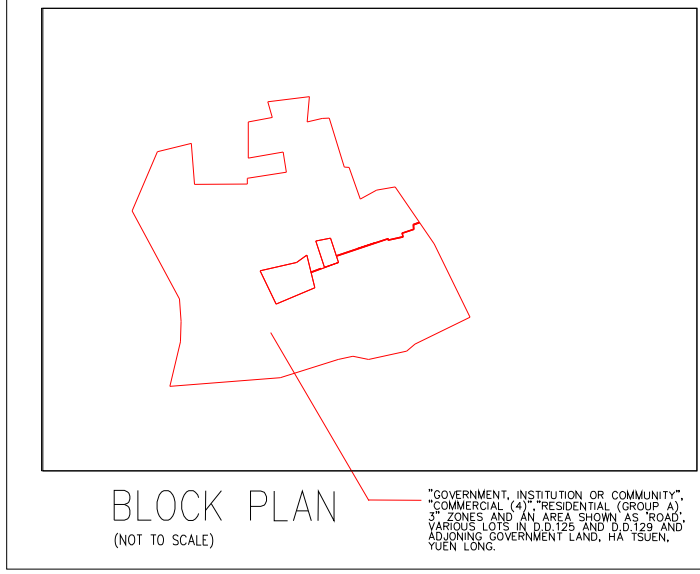

- FIRE SERVICE NOTES:**
- A MODIFIED HOSE REEL SYSTEM WITH A 2,000 L F.S. TANK SHALL BE PROVIDED TO THE SUBJECT BUILDINGS IN ACCORDANCE WITH PARA. 5.14 OF THE CODE OF PRACTICE FOR MINIMUM FIRE SERVICE INSTALLATIONS AND EQUIPMENT 2012. HOSE REEL SHALL BE PROVIDED TO ENSURE THAT EVERY PART OF THE BUILDINGS WHERE CAN BE REACHED BY A LENGTH OF NOT MORE THAN 30M OF HOSE REEL TUBING.
 - HOSE REEL SHALL BE PROVIDED AT POSITIONS AS INDICATED ON PLANS.
 - NO FIRE SERVICE INLET TO BE PROVIDED FOR MODIFIED HOSE REEL SYSTEM.
 - TWO FIXED FIRE PUMPS (DUTY/STANDBY) TO BE PROVIDED.
 - FIRE ALARM SYSTEM SHALL BE PROVIDED IN ACCORDANCE WITH BS 5839-1: 2002 + A2: 2008 AND FSD CIRCULAR LETTERS NO. 1/2009 & 3/2010 & 2/2012. ONE ACTUATING POINT AND ONE AUDIO WARNING DEVICE TO BE LOCATED AT EACH HOSE REEL POINT. VISUAL ALARM SIGNALS TO BE PROVIDED. ACTUATING POINT SHALL INCLUDE FACILITIES FOR FIRE PUMP START AND AUDIO VISUAL WARNING DEVICE INITIATION.
 - FIRE ALARM PANEL TO BE PROVIDED AND LOCATED INSIDE F.S. PUMP ROOM.
 - SUFFICIENT EMERGENCY LIGHTING WITH 2 HOURS BACK UP BATTERY TO BE PROVIDED TO THE BUILDINGS IN ACCORDANCE WITH BS 5266: PART 1 AND BS EN 1838.
 - SUFFICIENT EXIT SIGN / DIRECTIONAL SIGN TO BE PROVIDED IN ACCORDANCE WITH BS 5266: PART 1 AND FSD CIRCULAR LETTER NO. 5/2008.
 - FIRE EXTINGUISHERS SHALL BE PROVIDED AS INDICATED ON PLANS.
 - WHEN A VENTILATION/AIR CONDITIONING CONTROL SYSTEM TO THE AREAS/BUILDING IS REQUIRED TO BE PROVIDED, IT SHALL STOP MECHANICALLY INDUCED AIR MOVEMENT WITHIN A DESIGNATED FIRE COMPARTMENT.
 - AUTOMATIC SPRINKLER SYSTEM SHALL BE PROVIDED TO THE ENTIRE BUILDING STRUCTURE IN ACCORDANCE WITH LPC RULES INCORPORATING BS EN 12845: 2015 AND FSD CIRCULAR LETTER 5/2020 EXCEPT E&M PLANT ROOMS. SPRINKLER SHALL NOT BE PROVIDED TO STANDALONE TEMPORARY: TOILETS / OFFICES / STORES / WORK SHOP / GUARD HOUSE / STAFF ROOM WHERE TOTAL FLOOR AREA LESS THAN 230 SQUARE METRES. SPRINKLER SHALL NOT BE PROVIDED TO AREAS OF COVERED SHED AS THOSE ARE METAL STRUCTURE WITH 2 SIDES OPENING.
 - HAZARD CLASSIFICATION: OHS
 - STORED PRODUCTS AND CATEGORIES: CATEGORY (1)
 - STORAGE CONFIGURATION: FREE STANDING (ST1) & POST-PALLET STORAGE (ST2)
 - STORAGE HEIGHT NOT EXCEEDING: 4M & 3.5M
 - STORAGE SHOULD BE CONFINED TO BLOCKS NOT EXCEEDING 50 SQ M. IN PLAN AREA FOR CATEGORY I.
 - STORAGE BLOCKS SHOULD BE SEPARATED BY AISLES NO LESS THAN 2.4M WIDE.
 - ONE NUMBER 135,000 LITRES SPRINKLER WATER TANK TO BE PROVIDED AS INDICATED ON PLANS.
 - SPRINKLER PUMPS, SPRINKLER CONTROL VALVES AND SPRINKLER INLETS SHALL BE PROVIDED AS INDICATED ON PLANS.
 - SECONDARY SOURCE OF POWER SUPPLY FOR FIRE SERVICE INSTALLATIONS TO BE PROVIDED BY CONNECTION BEFORE THE MAIN SWITCH WITH AUTOMATIC CHANGE-OVER DEVICE AND SATISFACTION OF THE DIRECTOR OF FIRE SERVICES.
 - SMOKE EXTRACTION SYSTEM SHALL NOT BE PROVIDED WHEREAS THE AGGREGATE AREA OF OPENABLE WINDOWS OF THE COMPARTMENT EXCEEDS 6.25% OF THE FLOOR AREA OF THAT COMPARTMENT IN WAREHOUSES.
 - ALL DIMENSIONS ARE IN MILLIMETERS UNLESS OTHERWISE SPECIFIED.

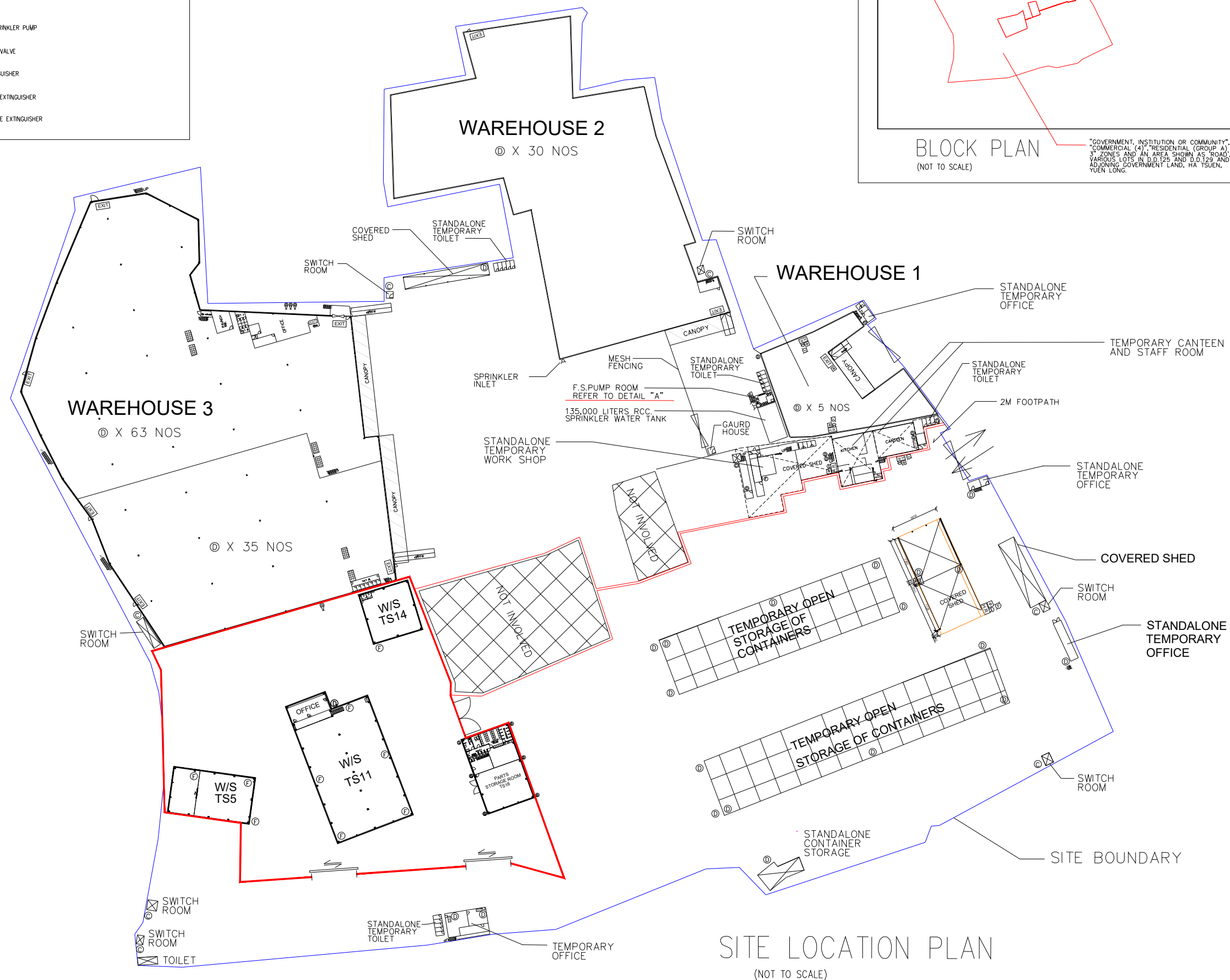

FSI CONSULTANT:
MORAL WAY ENGINEERING LIMITED
 [Redacted Name]
 [Redacted Name]
 [Redacted Name]

PROJECT:
 "GOVERNMENT, INSTITUTION OR COMMUNITY",
 "COMMERCIAL (4)", "RESIDENTIAL (GROUP A)",
 "3" ZONES AND AN AREA SHOWN AS "ROAD",
 VARIOUS LOTS IN D.D.125 AND D.D.129 AND
 ADJOINING GOVERNMENT LAND, HA TSUEN,
 YUEN LONG.

TITLE:
 FS NOTES, LEGEND, BLOCK
 PLAN AND LOCATION PLAN
 (RNTPC PAPER NO.A/HSK/312)

SCALE: 1:400 @A0	DRAWN BY: STANLEY TSUI
DATE: 17-08-2024	DESIGNED BY: HILLMAN LAU
DWG. NO.: FS/01	CHECKED BY: HILLMAN LAU
CONTRACT NO.:	SHEET: 12
REVISION:	

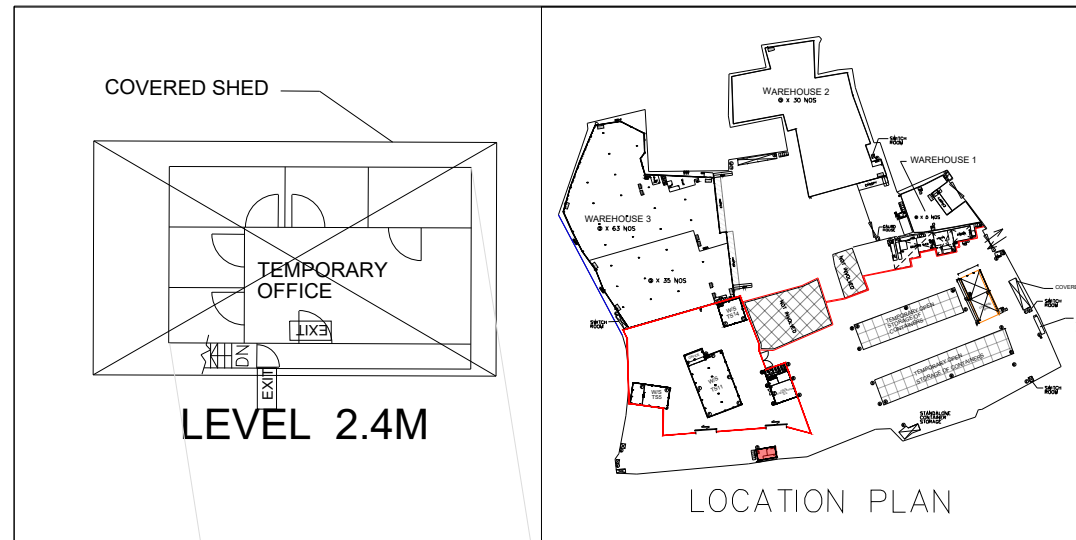

TEMPORARY OFFICE
(NOT TO SCALE)





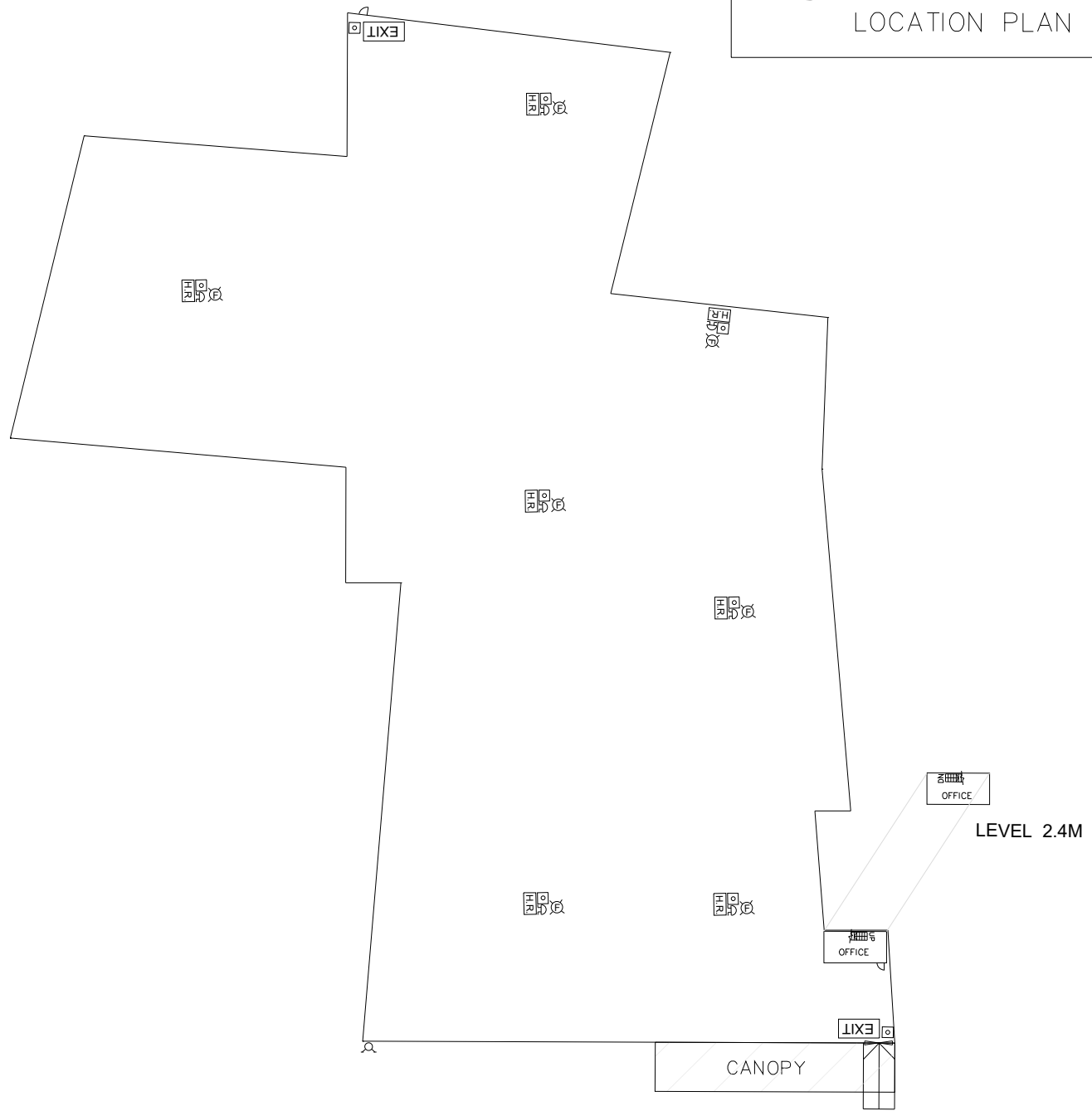











STANDALONE TEMPORARY OFFICE
(NOT TO SCALE)

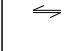
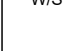

WAREHOUSE 2

LEGEND

-  FIRE ALARM BELL
-  VISUAL FIRE ALARM
-  MANUAL FIRE ALARM CALL POINT (BREAK GLASS TYPE)
-  EXIT SIGN
-  HOSE REEL SET
-  FIXED FIRE PUMP/SPRINKLER PUMP
-  SPRINKLER CONTROL VALVE
-  5KG CO2 FIRE EXTINGUISHER
-  9L FOAM FIRE EXTINGUISHER
-  4KG DRY POWDER FIRE EXTINGUISHER
-  F.S. CONTROL PANEL
-  SPRINKLER / F.S. INLET
-  DOUBLE SLIDING DOOR
-  WORK SHOP
-  5KG DRY POWDER FIRE EXTINGUISHER

FSI CONSULTANT:
MORAL WAY ENGINEERING LIMITED

PROJECT:
"GOVERNMENT, INSTITUTION OR COMMUNITY",
"COMMERCIAL (4)", "RESIDENTIAL (GROUP A)",
"3" ZONES AND AN AREA SHOWN AS "ROAD",
VARIOUS LOTS IN D.D.125 AND D.D.129 AND
ADJOINING GOVERNMENT LAND, HA TSUEN,
YUEN LONG.

TITLE:
FS LAYOUT FOR
WAREHOUSE 2 AND
STANDALONE TEMPORARY
OFFICE

(RNTPC PAPER NO.A/HSK/312)

SCALE: 1:200 @A0	DRAWN BY: STANLEY TSUI
DATE: 17-08-2024	DESIGNED BY: HILLMAN LAU
DWG. NO: FS/02	CHECKED BY: HILLMAN LAU
CONTRACT NO.:	SHEET: 14
REVISION:	

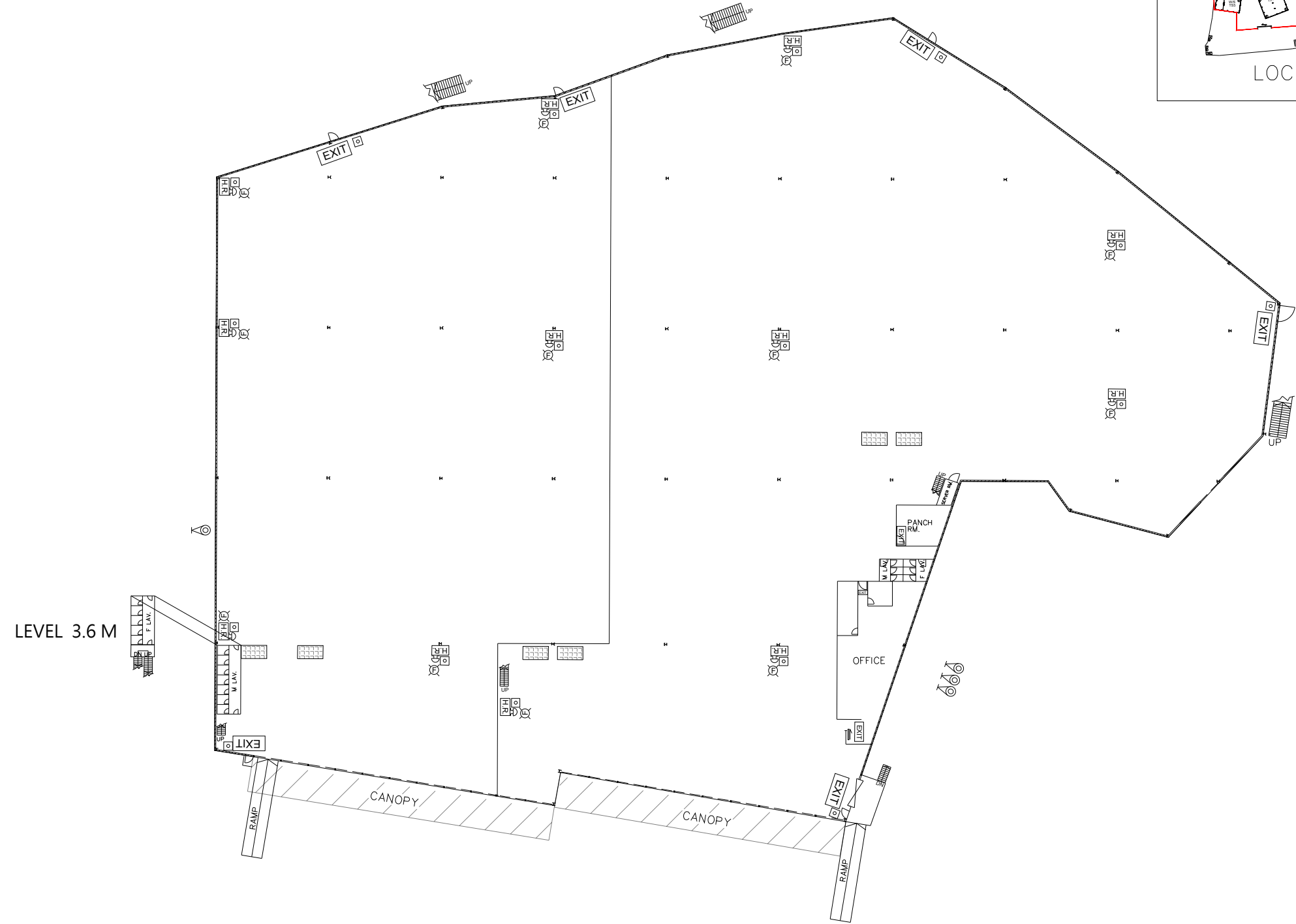

GROUND LEVEL

WAREHOUSE 3



LEGEND

- FIRE ALARM BELL
- VISUAL FIRE ALARM
- MANUAL FIRE ALARM CALL POINT (BREAK GLASS TYPE)
- EXIT SIGN
- H.R. HOSE REEL SET
- FIXED FIRE PUMP/SPRINKLER PUMP
- SPRINKLER CONTROL VALVE
- 5KG CO2 FIRE EXTINGUISHER
- 9L FOAM FIRE EXTINGUISHER
- 4KG DRY POWDER FIRE EXTINGUISHER
- F.S. CONTROL PANEL
- SPRINKLER / F.S. INLET
- DOUBLE SLIDING DOOR
- W/S WORK SHOP
- 5KG DRY POWDER FIRE EXTINGUISHER

FSI CONSULTANT:
MORAL WAY ENGINEERING LIMITED
 [REDACTED]
 [REDACTED]
 [REDACTED]

PROJECT:
 "GOVERNMENT, INSTITUTION OR COMMUNITY",
 "COMMERCIAL (4)", "RESIDENTIAL (GROUP A)",
 "3" ZONES AND AN AREA SHOWN AS 'ROAD',
 VARIOUS LOTS IN D.D.125 AND D.D.129 AND
 ADJOINING GOVERNMENT LAND, HA TSUEN,
 YUEN LONG.

TITLE:
 GROUND LEVEL FS LAYOUT
 FOR WAREHOUSE 3
 (RNTPC PAPER NO.A/HSK/312)

SCALE: 1:200 @A0	DRAWN BY: STANLEY TSUI
DATE: 17-08-2024	DESIGNED BY: HILLMAN LAU
DWG. NO: FS/03	CHECKED BY: HILLMAN LAU
CONTRACT NO.:	SHEET: 14
REVISION:	

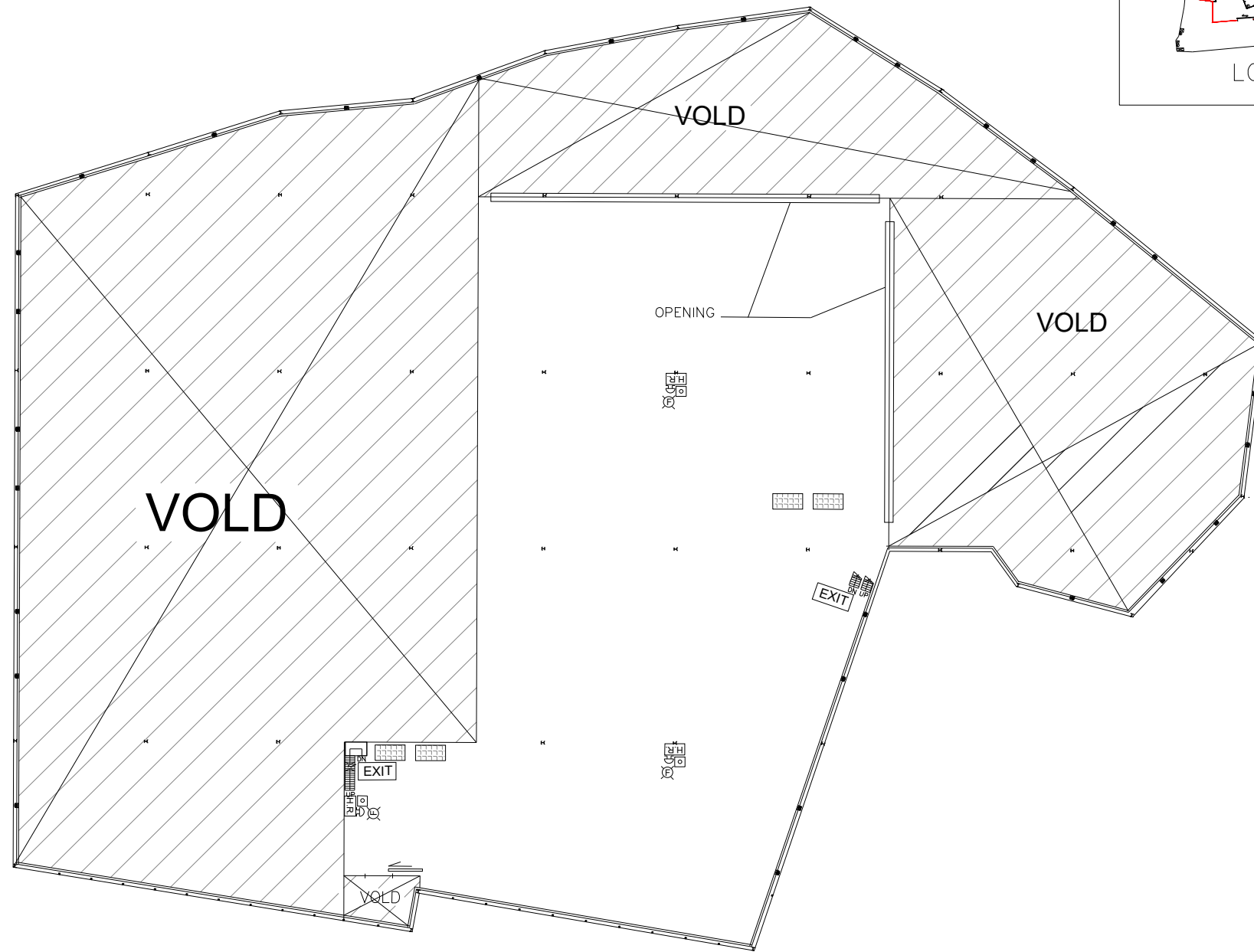





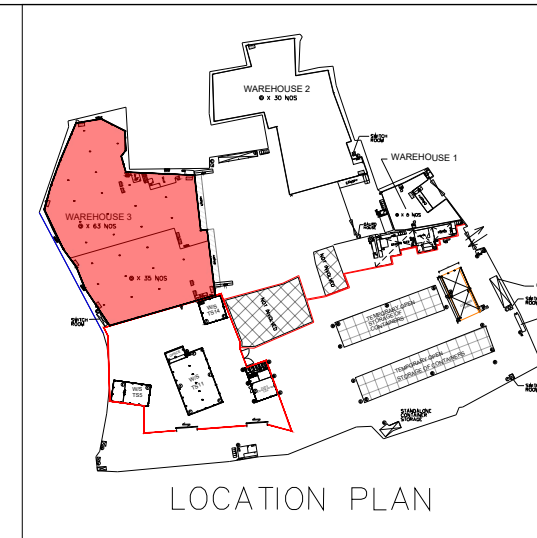



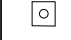
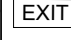

LEVEL 4.0M

WAREHOUSE 3

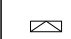
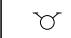
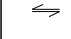
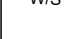

LEGEND

-  FIRE ALARM BELL
-  VISUAL FIRE ALARM
-  MANUAL FIRE ALARM CALL POINT (BREAK GLASS TYPE)
-  EXIT SIGN
-  H.R. HOSE REEL SET
-  FIXED FIRE PUMP/SPRINKLER PUMP
-  SPRINKLER CONTROL VALVE
-  4KG CO2 FIRE EXTINGUISHER
-  9L FOAM FIRE EXTINGUISHER
-  4KG DRY POWDER FIRE EXTINGUISHER
-  F.S. CONTROL PANEL
-  SPRINKLER / F.S. INLET
-  DOUBLE SLIDING DOOR
-  W/S WORK SHOP
-  5KG DRY POWDER FIRE EXTINGUISHER

FSI CONSULTANT:
MORAL WAY ENGINEERING LIMITED

[Redacted Name]
[Redacted Name]
[Redacted Name]

PROJECT:
"GOVERNMENT, INSTITUTION OR COMMUNITY",
"COMMERCIAL (4)", "RESIDENTIAL (GROUP A)",
"3" ZONES AND AN AREA SHOWN AS 'ROAD',
VARIOUS LOTS IN D.D.125 AND D.D.129 AND
ADJOINING GOVERNMENT LAND, HA TSUEN,
YUEN LONG.

TITLE:
LEVEL 4.0M FS LAYOUT
FOR WAREHOUSE 3
(RNTPC PAPER NO.A/HSK/312)

SCALE: 1:200 @A0	DRAWN BY: STANLEY TSUI
DATE: 17-08-2024	DESIGNED BY: HILLMAN LAU
DWG. NO: FS/04	CHECKED BY: HILLMAN LAU
CONTRACT NO.:	SHEET: 14
REVISION:	

GROUND LEVEL

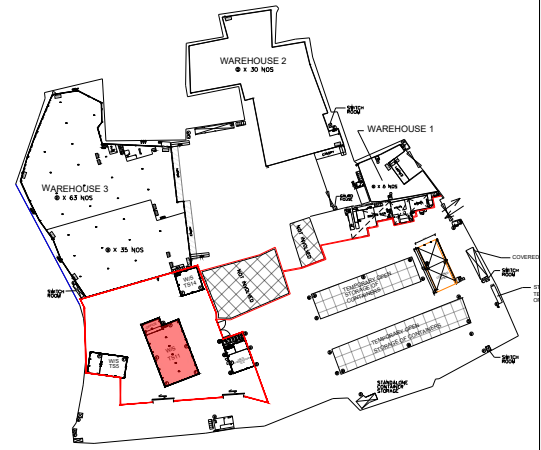
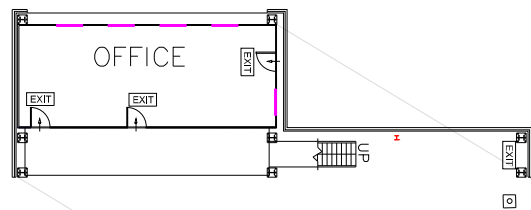

LOCATION PLAN

PASTS STORAGE ROOM TS18

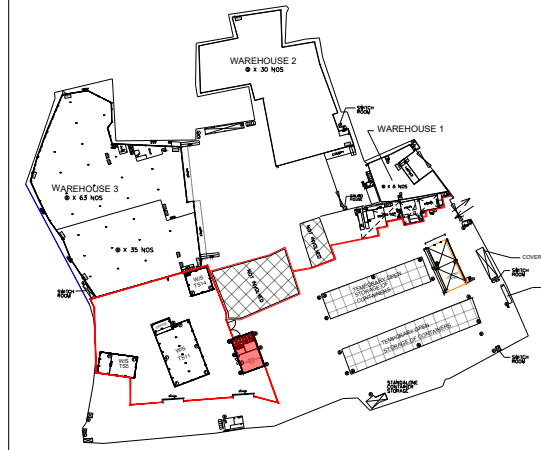

LOCATION PLAN

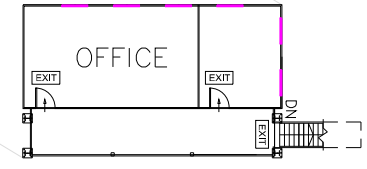
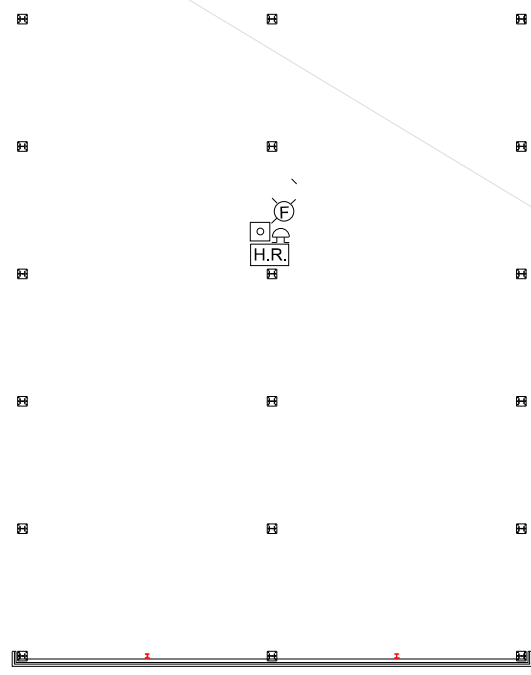

LEVEL 2.7M

WORK SHOP & OFFICE TS11

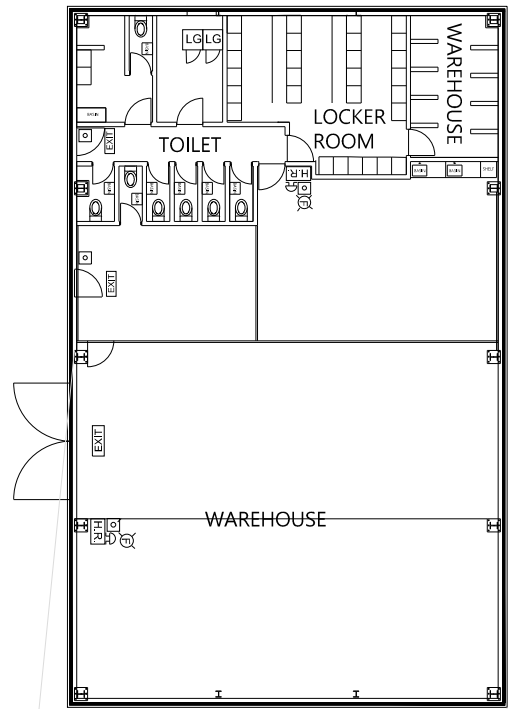

GROUND LEVEL

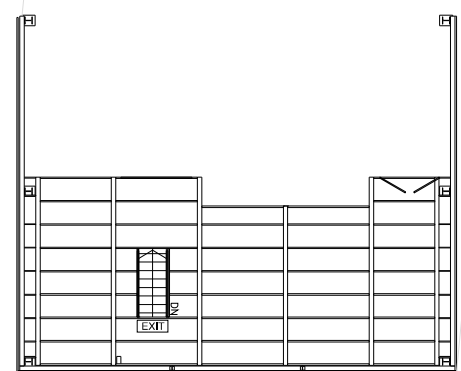

COCKLOFT

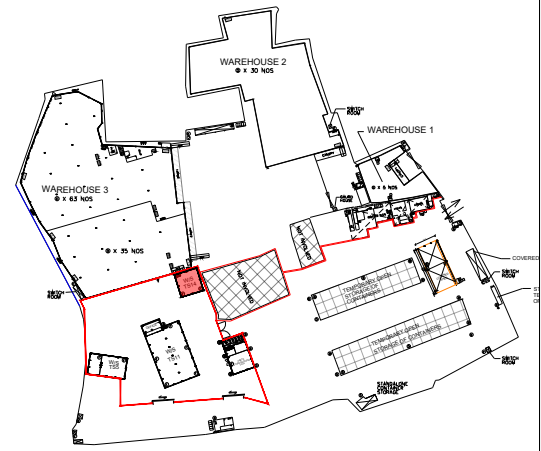

LOCATION PLAN

WORK SHOP TS14

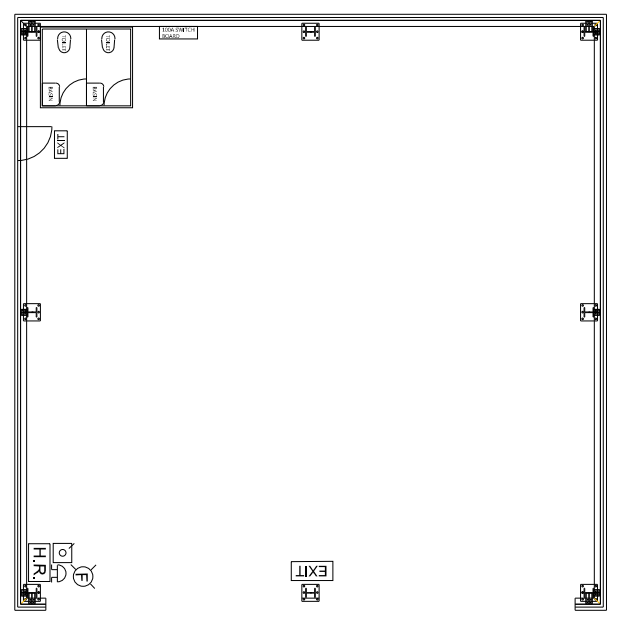

LEGEND	
	FIRE ALARM BELL
	VISUAL FIRE ALARM
	MANUAL FIRE ALARM CALL POINT (BREAK GLASS TYPE)
	EXIT SIGN
	H.R. HOSE REEL SET
	FIXED FIRE PUMP/SPRINKLER PUMP
	SPRINKLER CONTROL VALVE
	5KG CO2 FIRE EXTINGUISHER
	9L FOAM FIRE EXTINGUISHER
	4KG DRY POWDER FIRE EXTINGUISHER
	F.S. CONTROL PANEL
	SPRINKLER / F.S. INLET
	DOUBLE SLIDING DOOR
	W/S WORK SHOP
	5KG DRY POWDER FIRE EXTINGUISHER

FSI CONSULTANT:
MORAL WAY ENGINEERING LIMITED
 [REDACTED]
 [REDACTED]
 [REDACTED]

PROJECT:
 "GOVERNMENT, INSTITUTION OR COMMUNITY",
 "COMMERCIAL (4)", "RESIDENTIAL (GROUP A)",
 "3" ZONES AND AN AREA SHOWN AS 'ROAD',
 VARIOUS LOTS IN D.D.125 AND D.D.129 AND
 ADJOINING GOVERNMENT LAND, HA TSUEN,
 YUEN LONG.

TITLE:
 FS LAYOUT FOR WORK SHOP
 TS14, WORK SHOP & OFFICE
 TS11, PARTS STORAGE ROOM
 TS18
 (RNTPC PAPER NO.A/HSK/312)

SCALE: N.T.S.	DRAWN BY: STANLEY TSUI
DATE: 17-08-2024	DESIGNED BY: HILLMAN LAU
DWG. NO: FS/07	CHECKED BY: HILLMAN LAU
CONTRACT NO.:	SHEET: 14
REVISION:	

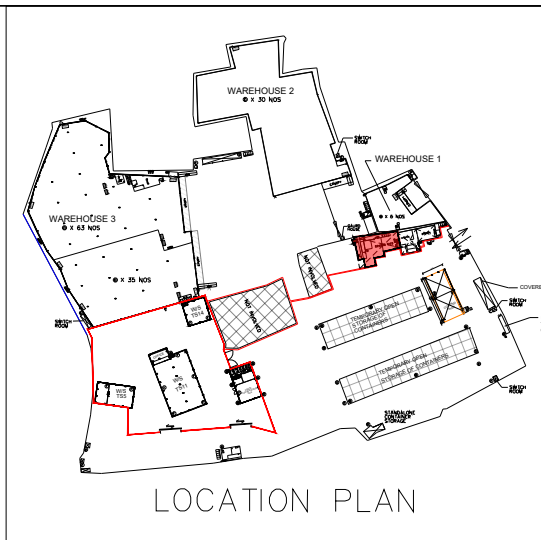

LOCATION PLAN

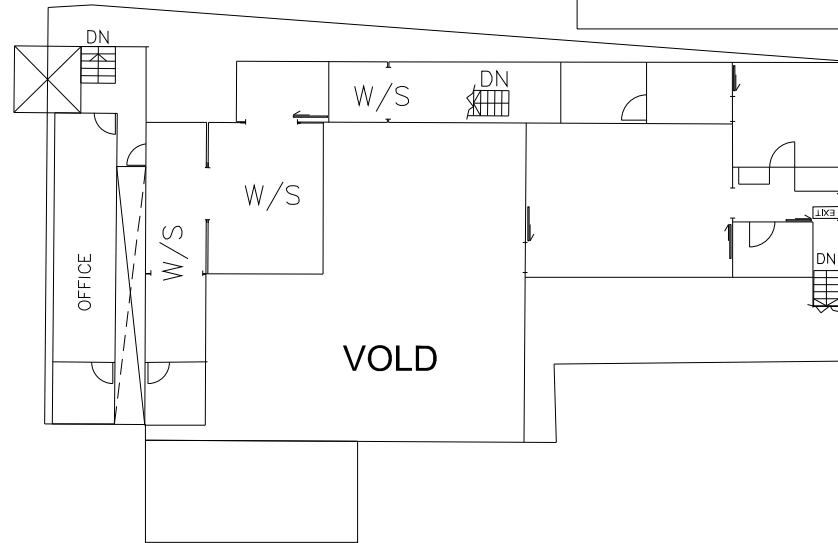

LEVEL 2.4M

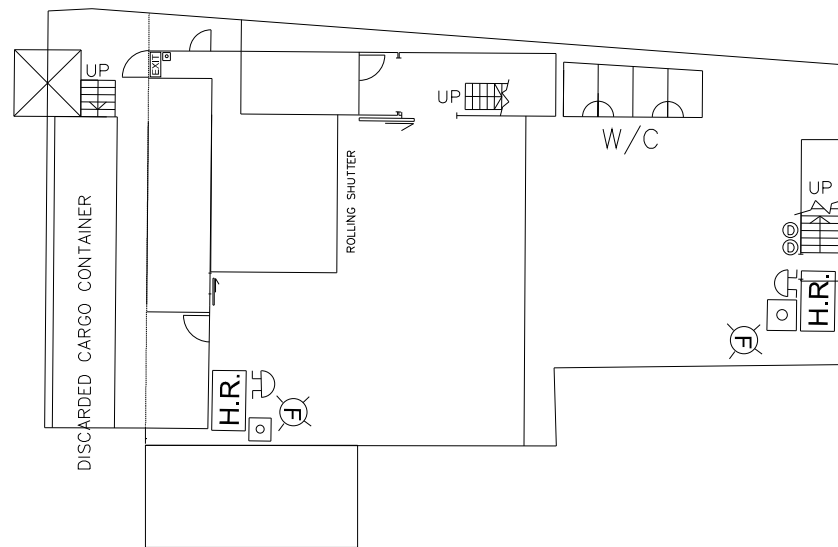

GROUND LEVEL

**STANDALONE
TEMPORARY WORK SHOP**

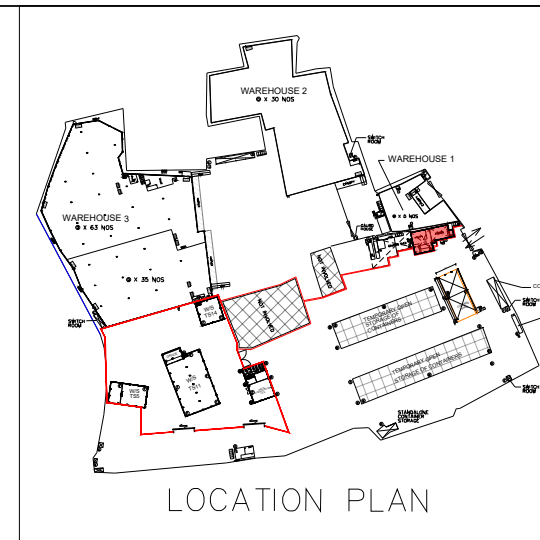

LOCATION PLAN

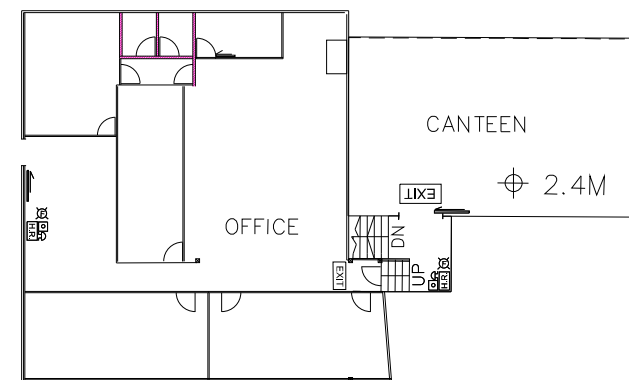



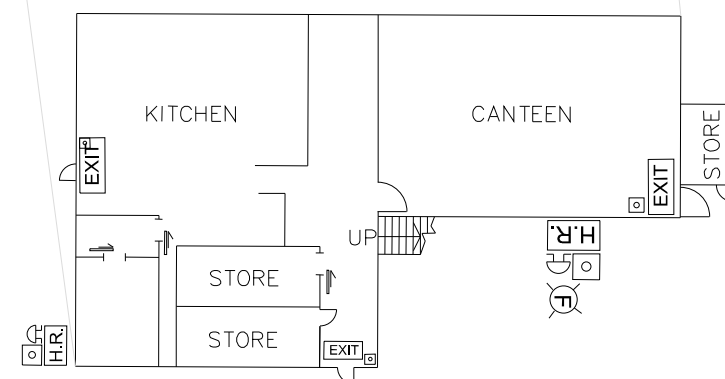









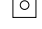

LEVEL 2.4M & 3.6M



GROUND LEVEL

**TEMPORARY CANTEN
AND STAFF ROOM**

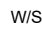
LEGEND

-  FIRE ALARM BELL
-  VISUAL FIRE ALARM
-  MANUAL FIRE ALARM CALL POINT (BREAK GLASS TYPE)
-  EXIT SIGN
-  HOSE REEL SET
-  FIXED FIRE PUMP/SPRINKLER PUMP
-  SPRINKLER CONTROL VALVE
-  5KG CO2 FIRE EXTINGUISHER
-  9L FOAM FIRE EXTINGUISHER
-  4KG DRY POWDER FIRE EXTINGUISHER
-  F.S. CONTROL PANEL
-  SPRINKLER / F.S. INLET
-  DOUBLE SLIDING DOOR
-  WORK SHOP
-  5KG DRY POWDER FIRE EXTINGUISHER

FSI CONSULTANT:
MORAL WAY ENGINEERING LIMITED



PROJECT:
"GOVERNMENT, INSTITUTION OR COMMUNITY",
"COMMERCIAL (4)", "RESIDENTIAL (GROUP A)",
"3" ZONES AND AN AREA SHOWN AS "ROAD",
VARIOUS LOTS IN D.D.125 AND D.D.129 AND
ADJOINING GOVERNMENT LAND, HA TSUEN,
YUEN LONG.

TITLE:
FS LAYOUT FOR STANDALONE
TEMPORARY WORK SHOP,
TEMPORARY CANTEN AND
STAFF ROOM

(RNTPC PAPER NO.A/HSK/312)

SCALE: N.T.S.	DRAWN BY: STANLEY TSUI
DATE: 17-08-2024	DESIGNED BY: HILLMAN LAU
DWG. NO: FS/08	CHECKED BY: HILLMAN LAU
CONTRACT NO.:	SHEET: 14
REVISION:	

OPENABLE WINDOW : WAREHOUSE 2				
FLOOR AREA		REQUIRED OPENABLE WINDOWS	OPENABLE WINDOWS	PROVIDED OPENABLE WINDOWS
AREA	4671.3 M ²	X 6.25% =	292.0 M ²	1 M X 1.5 M = 1.50 M ² X 219 NOS. = 328.5 M ² = 328.50 M ²
TOTAL:	4671.3 M ²	X 6.25% =	292.0 M ²	TOTAL: 328.50 M ²

OPENABLE WINDOW : WAREHOUSE 1				
FLOOR AREA		REQUIRED OPENABLE WINDOWS	OPENABLE WINDOWS	PROVIDED OPENABLE WINDOWS
AREA	869.8 M ²	X 6.25% =	54.4 M ²	1 M X 1.5 M = 1.50 M ² X 42 NOS. = 63.0 M ² = 63.0 M ²
TOTAL:	869.8 M ²	X 6.25% =	54.4 M ²	TOTAL: 63.0 M ²

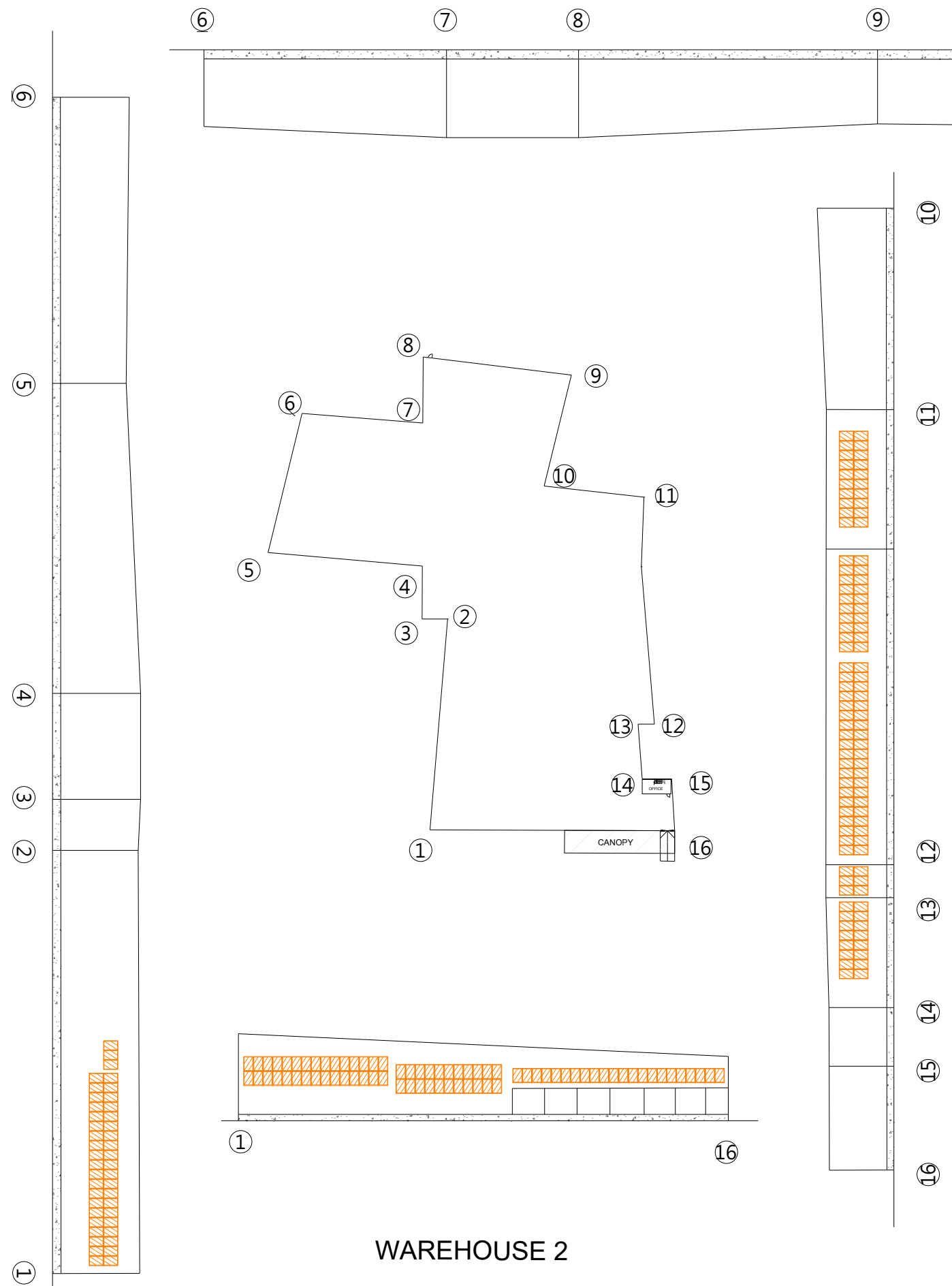

WAREHOUSE 2

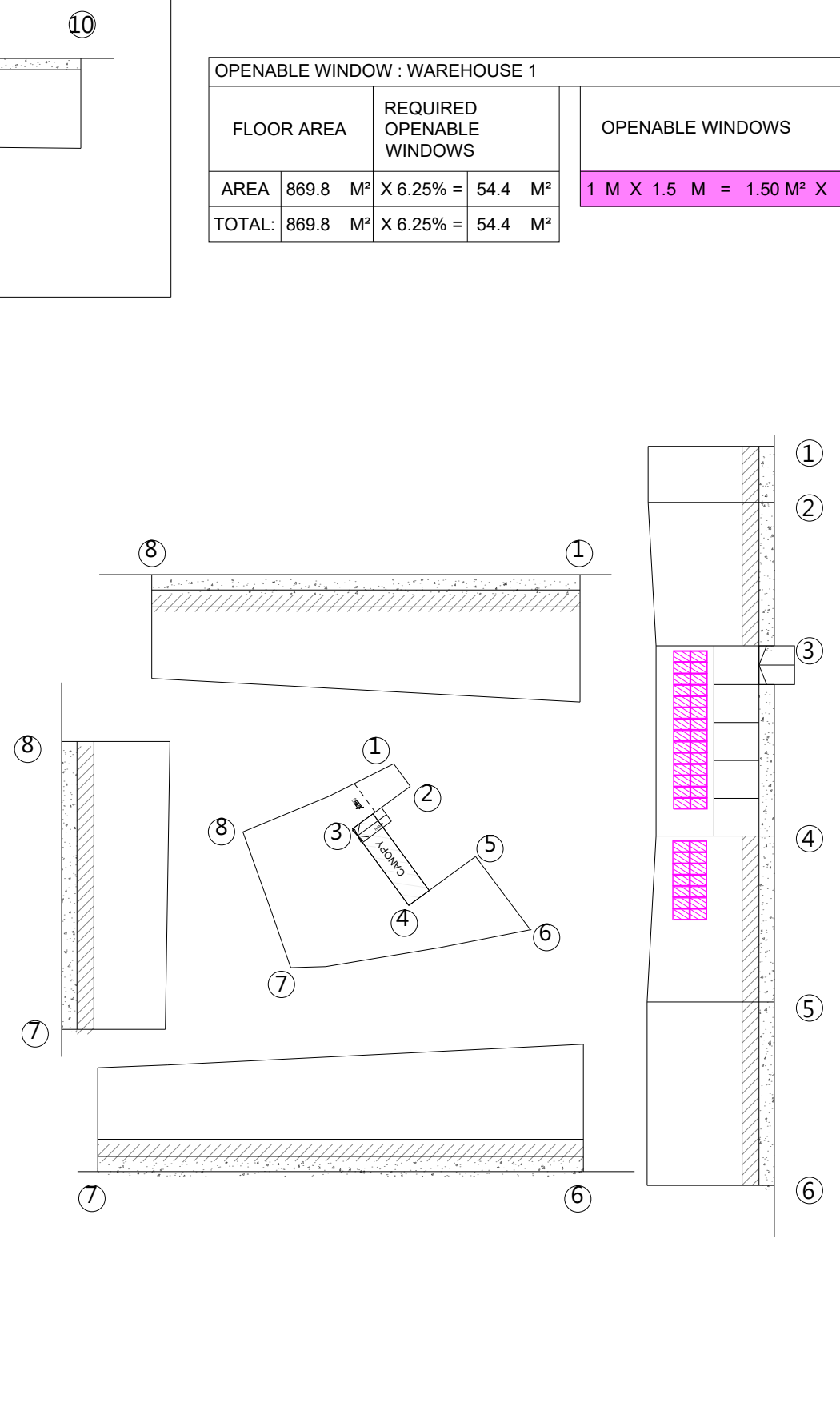

WAREHOUSE 1

FSI CONSULTANT:	
MORAL WAY ENGINEERING LIMITED	
[REDACTED]	
PROJECT:	
"GOVERNMENT, INSTITUTION OR COMMUNITY", "COMMERCIAL (4)", "RESIDENTIAL (GROUP A)", "3" ZONES AND AN AREA SHOWN AS "ROAD", VARIOUS LOTS IN D.D.125 AND D.D.129 AND ADJOINING GOVERNMENT LAND, HA TSUEN, YUEN LONG.	
TITLE:	
PROVISION OF OPENABLE WINDOW AREA WITH CALCULATION (1 OF 6)	
(RNTPC PAPER NO.A/HSK/312)	
SCALE:	DRAWN BY:
1 : 400 @A0	STANLEY TSUI
DATE:	DESIGNED BY:
17-08-2024	HILLMAN LAU
DWG. NO:	CHECKED BY:
FS/09	HILLMAN LAU
CONTRACT NO.:	SHEET:
	12
REVISION:	

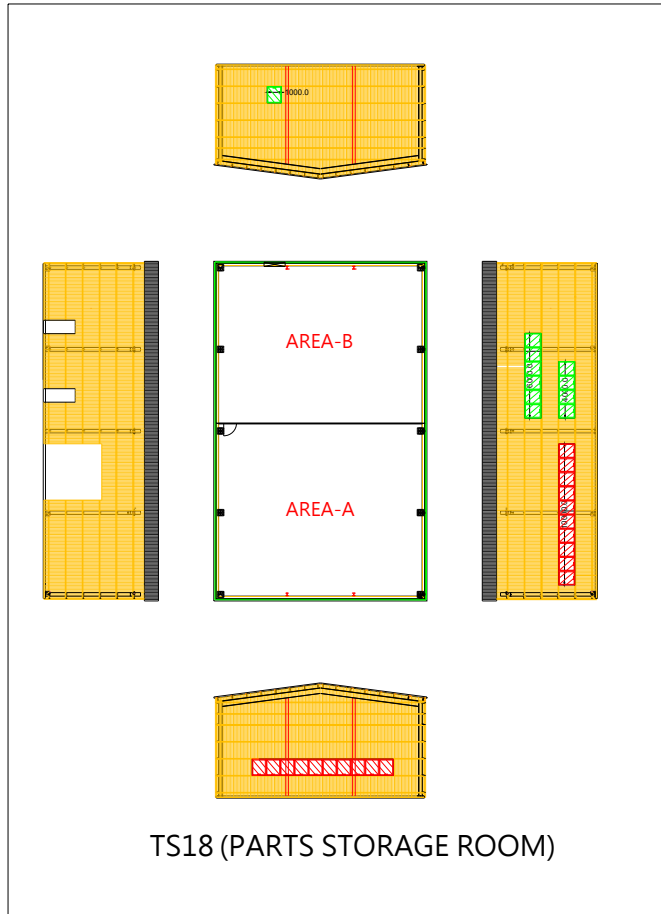

TS18 (PARTS STORAGE ROOM)

OPENABLE WINDOW : TS 18			
FLOOR AREA	REQUIRED OPENABLE WINDOWS	OPENABLE WINDOWS	PROVIDED OPENABLE WINDOWS
AREA-A	276 M ² X 6.25% = 17.3 M ²	3 M X 1.15 M = 1.15 X 20 NOS. = 23.0 M ²	23.00 M ²
AREA-B	167 M ² X 6.25% = 10.4 M ²	3 M X 1.15 M = 1.15 X 10 NOS. = 11.5 M ²	11.50 M ²
TOTAL:	443.0 M ² X 6.25% = 27.7 M ²		34.50 M ²

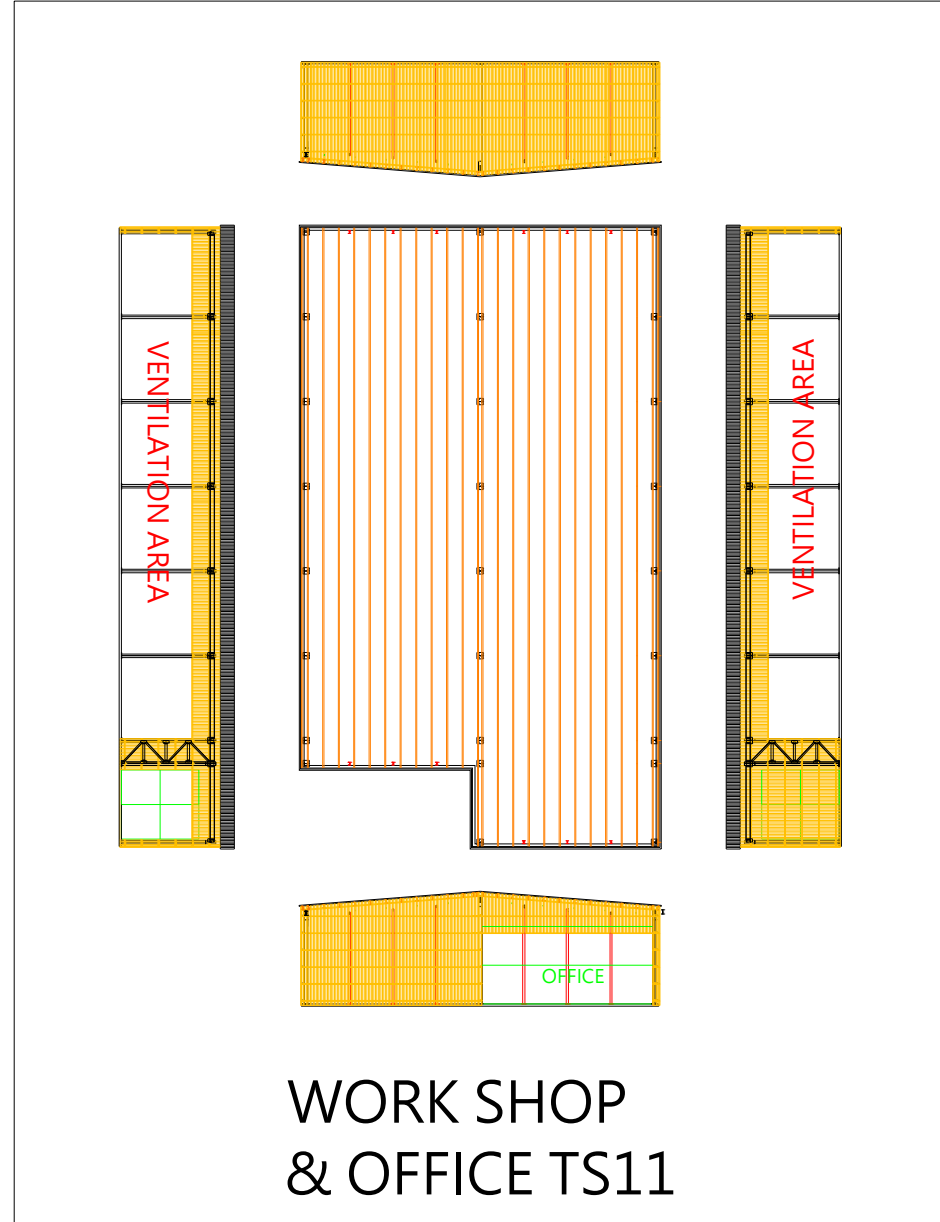

WORK SHOP & OFFICE TS11

OPENABLE WINDOW : TS11			
FLOOR AREA	REQUIRED OPENABLE WINDOWS	VENTILATION AREA	PROVIDED OPENABLE WINDOWS
AREA-A	1076 M ² X 6.25% = 67.3 M ²	70 M X 5 M = 350.00 M ²	350 M ²
TOTAL:	1076.0 M ² X 6.25% = 67.3 M ²		350.00 M ²

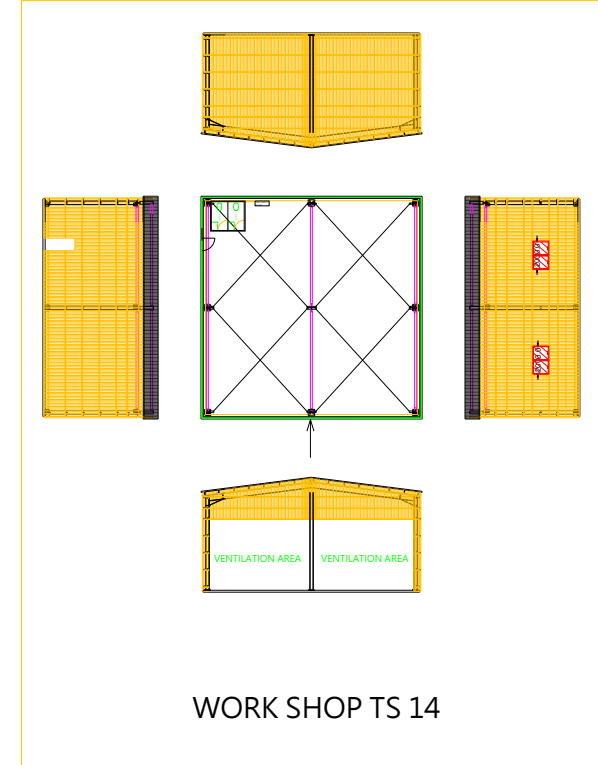

WORK SHOP TS 14

OPENABLE WINDOW : TS 14			
FLOOR AREA	REQUIRED OPENABLE WINDOWS	OPENABLE WINDOWS & VENTILATION AREA	PROVIDED OPENABLE WINDOWS
AREA-A	237 M ² X 6.25% = 14.8 M ²	10 M X 0.15 M = 0.15 X 10 NOS. = 1.5 M ²	1.50 M ²
		10 M X 5 M = 50.00 M ²	50.00 M ²
TOTAL:	237.0 M ² X 6.25% = 14.8 M ²		75.60 M ²

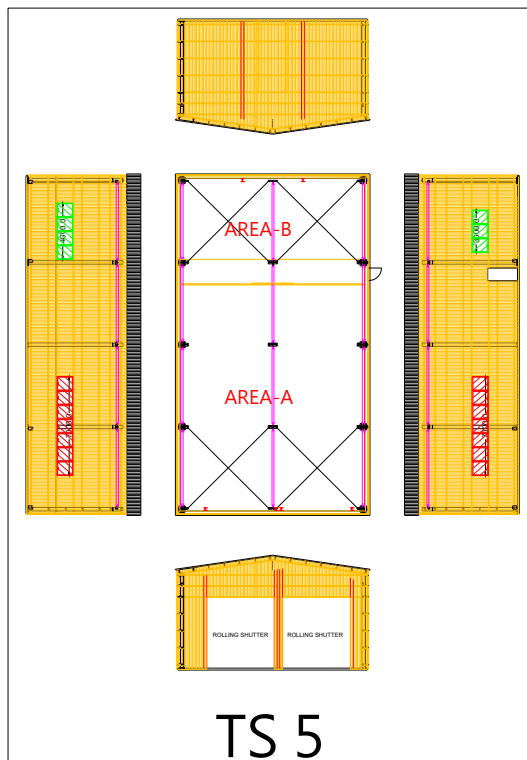

TS 5

OPENABLE WINDOW : TS 5			
FLOOR AREA	REQUIRED OPENABLE WINDOWS	OPENABLE WINDOWS	PROVIDED OPENABLE WINDOWS
AREA-A	218 M ² X 6.25% = 13.6 M ²	3 M X 1.15 M = 1.15 X 14 NOS. = 16.1 M ²	16.10 M ²
AREA-B	105 M ² X 6.25% = 6.4 M ²	3 M X 1.15 M = 1.15 X 7 NOS. = 8.0 M ²	8.00 M ²
TOTAL:	321.0 M ² X 6.25% = 20.1 M ²		24.15 M ²

FSI CONSULTANT:
MORAL WAY ENGINEERING LIMITED

PROJECT:
"GOVERNMENT, INSTITUTION OR COMMUNITY",
"COMMERCIAL (4)", "RESIDENTIAL (GROUP A)",
"3" ZONES AND AN AREA SHOWN AS "ROAD",
VARIOUS LOTS IN D.D.125 AND D.D.129 AND
ADJOINING GOVERNMENT LAND, HA TSUEN,
YUEN LONG.

TITLE:
PROVISION OF OPENABLE
WINDOW AREA WITH
CALCULATION (4 OF 6)
(RNTPC PAPER NO.A/HSK/312)

SCALE:
N.T.S

DRAWN BY:
STANLEY TSUI

DATE:
17-08-2024

DESIGNED BY:
HILLMAN LAU

DWG. NO:
FS/12

CHECKED BY:
HILLMAN LAU

CONTRACT NO.:

SHEET:
12

REVISION: