

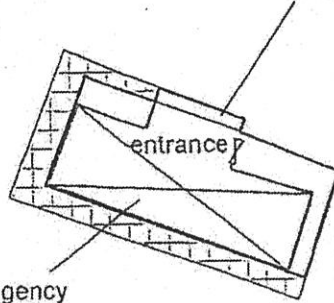

N



Open shed  
GFA: Not exceeding 168m<sup>2</sup>  
Height: Not exceeding 4.5m  
No. of storey: 1



Real estate agency  
with conference room  
under the Open shed  
GFA: Not exceeding 128m<sup>2</sup>  
Height: Not exceeding 4m  
No. of storey: 1

Project 項目名稱: Proposed Temporary Shop and Services (Real Estate Agency) for a Period of 3 Years at Lot 650 RP (Part) in D.D. 125 & Adjoining Government Land, Sik Kong Tsuen, Yuen Long, N.T.	Drawing Title 圖名: Proposed Layout Plan	Remarks 備註:  Uncovered area
	Drawing No. 圖號: Figure 3	Scale 比例: 1:500

Tree	Approximate Height	Spacing	Quantity
⊙ Proposed <i>Bauhinia blakeana</i>	2.75m	3m	13

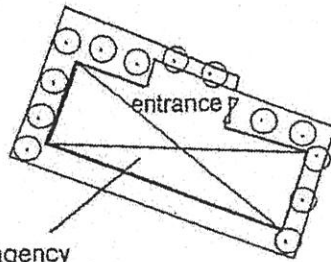
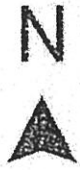

Real estate agency  
with conference room  
GFA: Not exceeding 128m<sup>2</sup>  
Height: Not exceeding 4m  
No. of storey: 1

Project 項目名稱: Proposed Temporary Shop and Services (Real Estate Agency) for a Period of 3 Years at Lot 650 RP (Part) in D.D. 125 & Adjoining Government Land, Sik Kong Tsuen, Yuen Long, N.T.	Drawing Title 圖名: Proposed Landscape Plan	Remarks 備註:
	Drawing No. 圖號: Figure 4	Scale 比例: 1:500

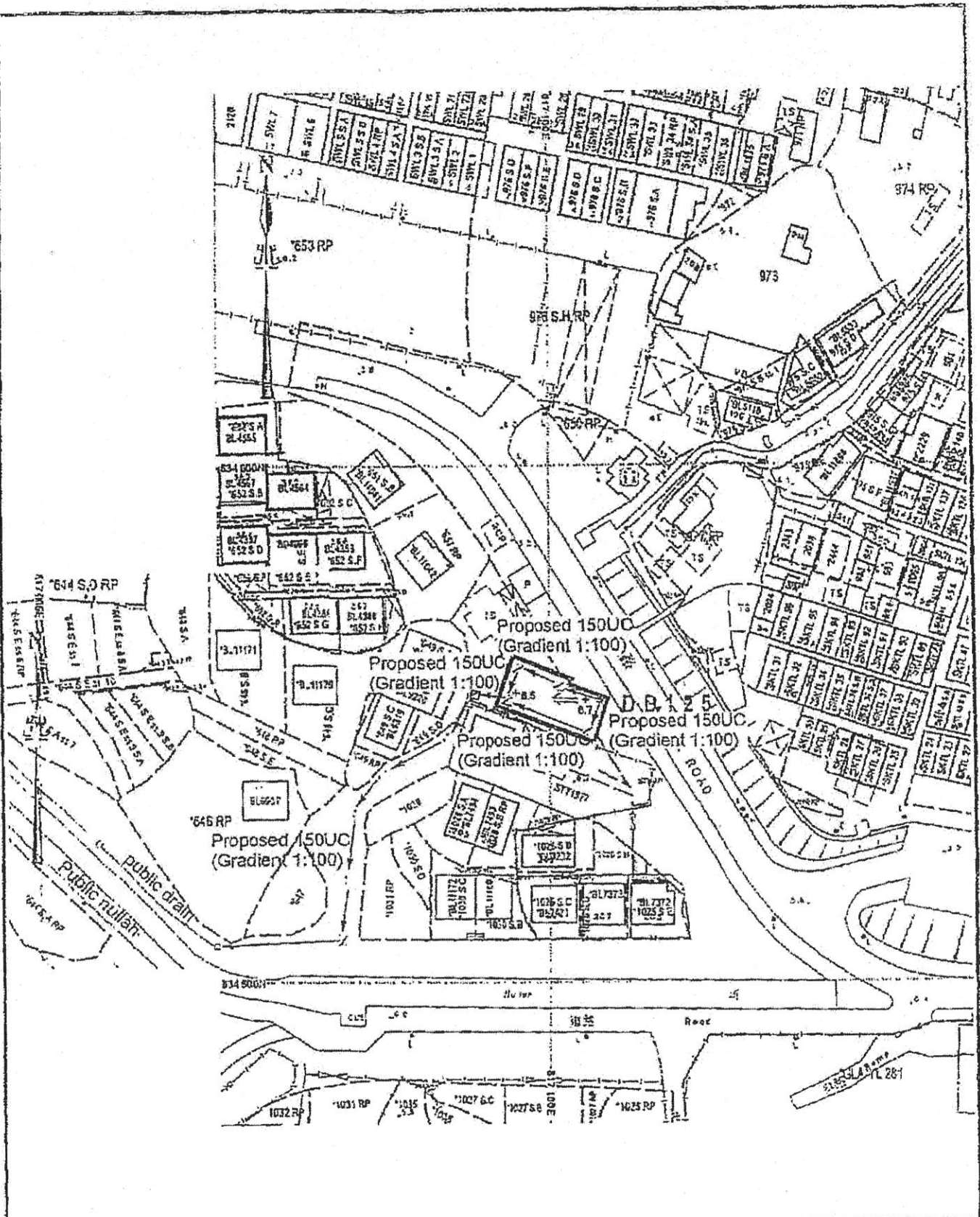

Project 項目名稱:  
 Proposed Temporary Shop and Services (Real Estate Agency) for a Period of 3 Years at Lot 650 RP (Part) in D.D. 125 & Adjoining Government Land, Sik Kong Tsuen, Yuen Long, N.T.

Drawing Title 圖名:  
 Proposed Drainage Plan

Remarks 備註:  
 +<sup>67</sup> Level (in mPD)  
 ← Flow of surface runoff  
 ☐ Proposed catchpit

Drawing No. 圖號:  
 Figure 5

Scale 比例:  
 1:1000

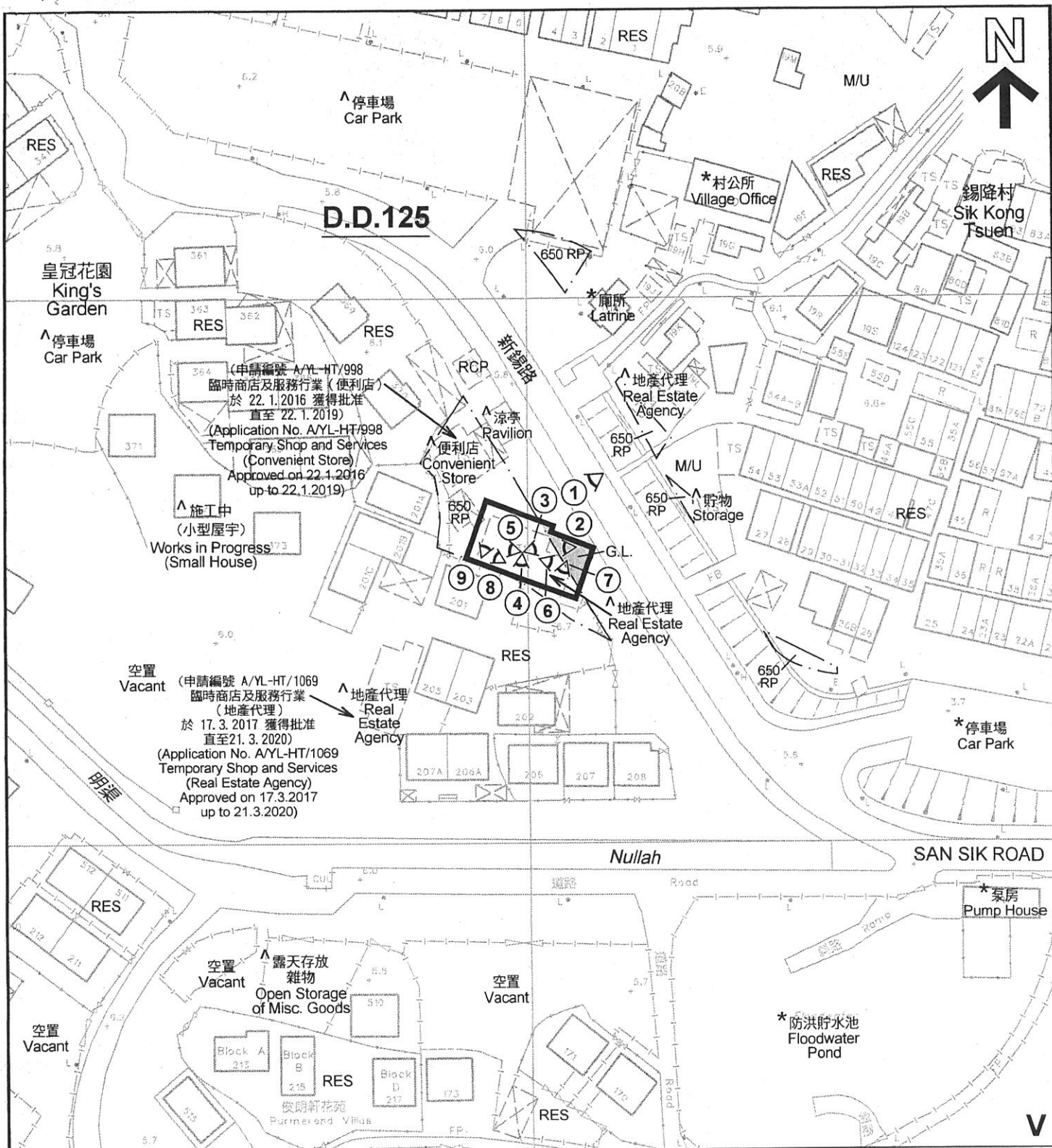

**註釋 Notes:**

- (1) 2018年12月7日勘測的土地用途  
Land uses shown on this plan are in accordance with the land use survey conducted by the Planning Department on 7.12.2018
- (2) \* 土地用途跟1992年3月勘測的土地用途一致  
Indicates that the use is the same as that revealed by the land use survey conducted by the Planning Department in Mar 1992
- (3) ^ 土地用途跟1992年3月勘測的土地用途有別  
Indicates that the use is different from that revealed by the land use survey conducted by the Planning Department in Mar 1992

**圖例 LEGEND**

- 申請地點(界線只作識別用)  
APPLICATION SITE (BOUNDARY FOR IDENTIFICATION PURPOSE ONLY)
- 鄉村式發展  
VILLAGE TYPE DEVELOPMENT
- 政府土地  
GOVERNMENT LAND
- RES 住用構築物  
RESIDENTIAL STRUCTURES
- M/U 荒地  
UNUSED LAND
- RCP 垃圾收集站  
REFUSE COLLECTION POINT
- 實地照片的觀景點  
VIEWING POINT OF SITE PHOTO

**位置圖**

元朗錫降村丈量約份第125約地段第650號餘段(部分)和毗連政府土地