

<p>Project 項目名稱: Proposed Temporary Eating Place for a Period of 3 Years at Lots 924 RP (Part) & 1007 RP (Part) in D.D. 125 and Adjoining Government Land, Ha Tsuen, Yuen Long, N.T.</p>	<p>Drawing Title 圖目: Application Site</p>	<p>Remarks 備註:</p>
<p>Drawing No. 圖號: Figure 1</p>	<p>Scale 比例: 1:1000</p>	

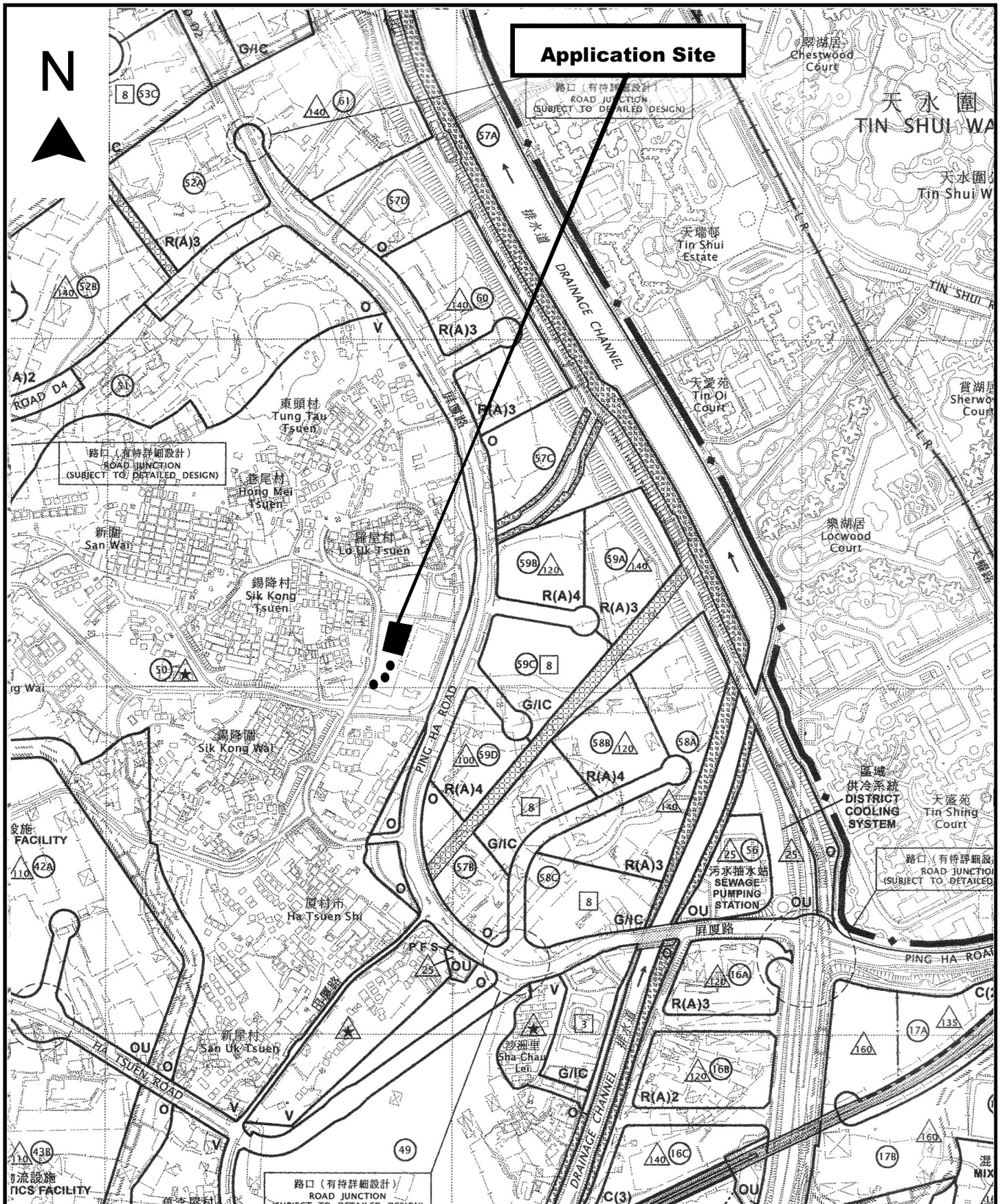

Application Site

Project 項目名稱:

Proposed Temporary Eating Place for a Period of 3 Years at Lots 924 RP (Part) & 1007 RP (Part) in D.D. 125 and Adjoining Government Land, Ha Tsuen, Yuen Long, N.T.

Drawing Title 圖目:

Location Plan

Drawing No. 圖號:

Figure 2

Remarks 備註:

● ● ● Vehicular access leading from Ha Mei Road

Scale 比例:

1:7500



Structure 1
 Eating place
 Covered area: Not exceeding 570m²
 GFA: Not exceeding 720m²
 Height: Not exceeding 7.5m
 No. of storey: 1 (white portion)
 2 (grey portion)

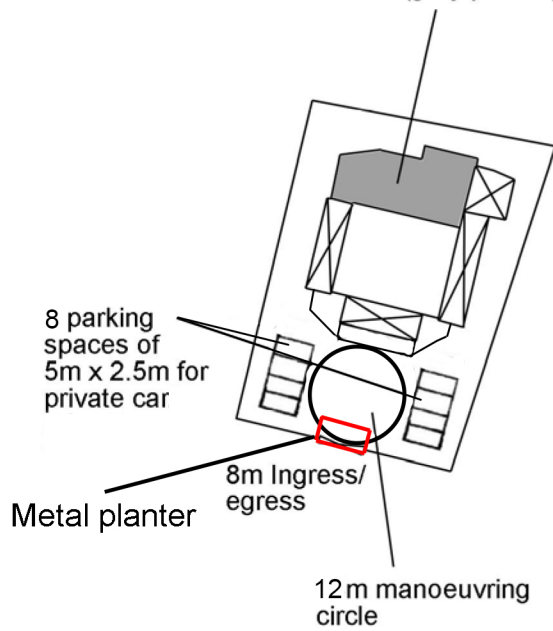

1/F Plan (Not exceeding 150m² in GFA)

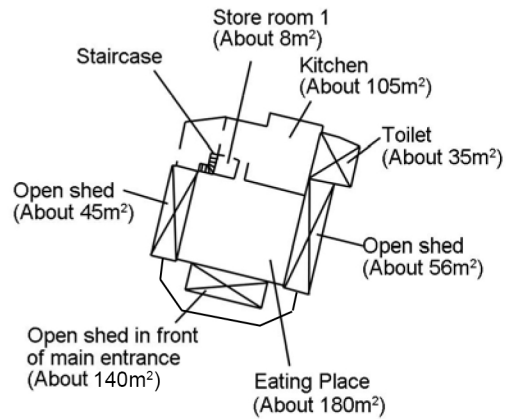

G/F Plan (Not exceeding 570m² in GFA)

Project 項目名稱: Proposed Temporary Eating Place for a Period of 3 Years at Lots 924 RP (Part) & 1007 RP (Part) in D.D. 125 and Adjoining Government Land, Ha Tsuen, Yuen Long, N.T.	Drawing Title 圖目: Proposed Layout Plan	Remarks 備註:
	Drawing No. 圖號: Figure 3	Scale 比例: 1:1000

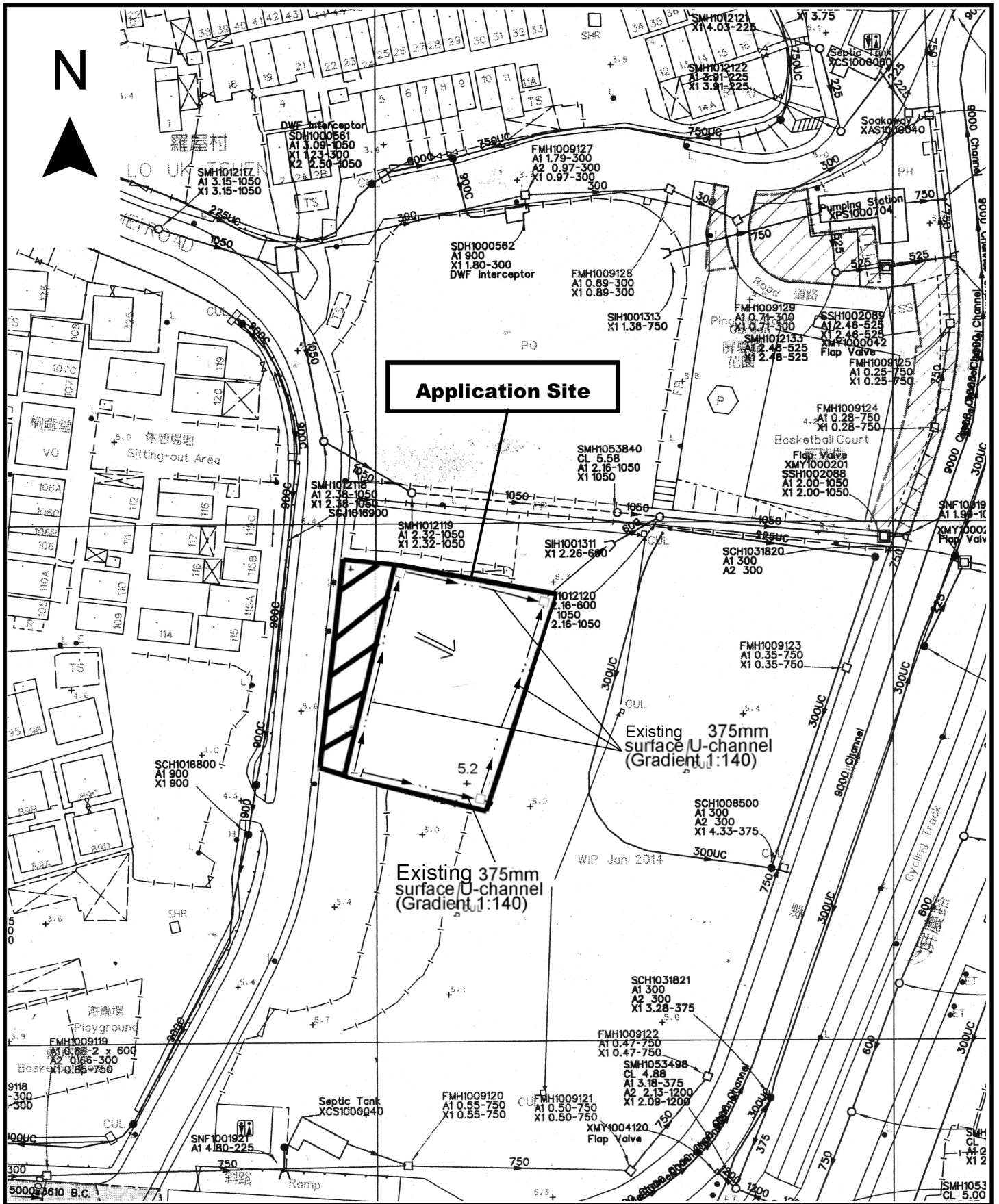

<p>Project 項目名稱:</p> <p>Proposed Temporary Eating Place for a Period of 3 Years at Lots 924 RP (Part) & 1007 RP (Part) in D.D. 125 and Adjoining Government Land, Ha Tsuen, Yuen Long, N.T.</p>	<p>Drawing Title 圖目:</p> <p>As-built Drainage Plan</p>	<p>Remarks 備註:</p> <p>+5.6 Level (in mPD)</p> <p>← Flow of surface runoff</p> <p>□ Proposed catchpit</p> <p>▨ External catchment</p>
<p>Drawing No. 圖號:</p> <p>Figure 4</p>	<p>Scale 比例:</p> <p>1:1000</p>	