

   APPLICATION PREMISES  
**GROUND FLOOR  
 PART PLAN**  
 (SCALE 1:100)

	<b>RAYMOND CHAN          SURVEYORS          LIMITED</b>	NOTES:	HAD REF.:	PROJECT:	DRAWING TITLE:	SIGNATURE:	DATE:
		1. ALL MEASUREMENT MUST BE CHECKED ON SITE.	BD REF.:	PLANNING APPLICATION FOR PROPOSED	PROPOSED LAYOUT FOR		APR 2024
		2. DO NOT SCALE DRAWING.	FSD REF.:	SHOP AND SERVICES USE AT	THE APPLICATION PREMISES		
		3. DRAWING AND COPY-RIGHT ARE PROPERTY OF THE RAYMOND CHAN SURVEYORS LTD AND SHALL BE RETURNED AT COMPLETION OF WORK.		PORTION OF G/F, JING WAH BUILDING,	SCALE: 1: 100 @A3		
4. DRAWING IS NOT VALID FOR CONSTRUCTION UNLESS EXPRESSEDLY CERTIFIED.		10 SAM CHUK STREET, SAN PO KONG, KOWLOON	DRAWN: P.C.				
							REFERENCE: -
							REVISION: A

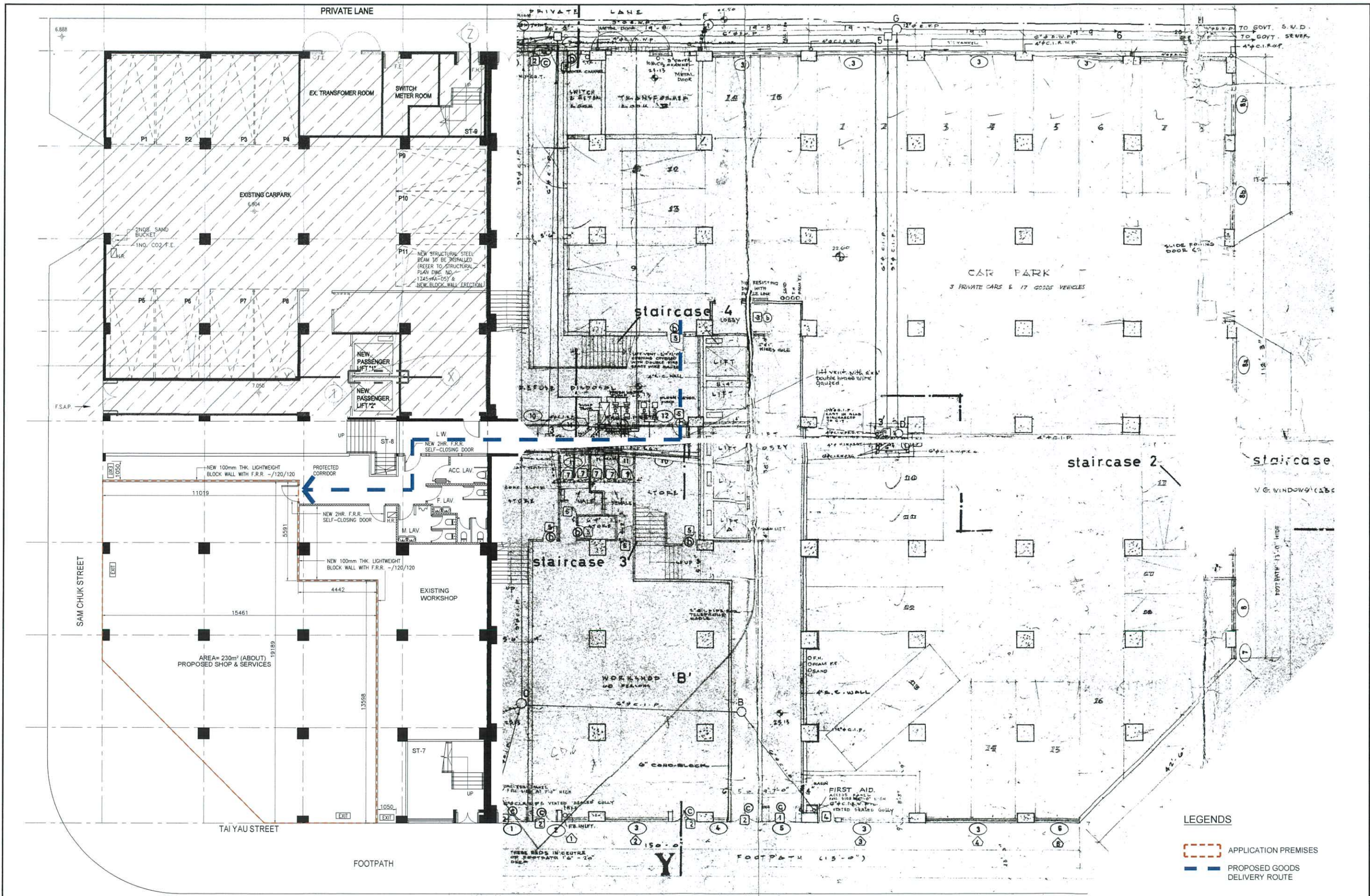

**LEGENDS**

- APPLICATION PREMISES
- PROPOSED GOODS DELIVERY ROUTE

**RAYMOND CHAN SURVEYORS LIMITED**  
 TEL.: 2722-7270      FAX.: 2311-3436

**NOTES:**  
 1. ALL MEASUREMENT MUST BE CHECKED ON SITE.  
 2. DO NOT SCALE DRAWING.  
 3. DRAWING AND COPY-RIGHT ARE PROPERTY OF THE RAYMOND CHAN SURVEYORS LTD AND SHALL BE RETURNED AT COMPLETION OF WORK.  
 4. DRAWING IS NOT VALID FOR CONSTRUCTION UNLESS EXPRESSEDLY CERTIFIED.

HAD REF.: \_\_\_\_\_  
 BD REF.: \_\_\_\_\_  
 FSD REF.: \_\_\_\_\_

**PROJECT:**  
 PLANNING APPLICATION FOR PROPOSED SHOP AND SERVICES USE AT PORTION OF G/F, JING WAH BUILDING, 10 SAM CHUK STREET, SAN PO KONG, KOWLOON

**DRAWING TITLE:**  
 PROPOSED GOODS DELIVERY ROUTE  
  
 SCALE: 1: 200 @A3  
 DRAWN: P.C.

SIGNATURE: \_\_\_\_\_  
  
 DATE: APR 2024  
 DRAWING NO.: FIGURE 3  
 REFERENCE: -  
 REVISION: -