



APPLICATION FOR REGISTRATION OF SCHOOL PREMISES

SCHOOL NAME : Gaintree Education House (Kai Tak) Education Centre
 思林教育城(啟德)教育中心
 SCHOOL ADDRESS : Shop M3-201, Level 2, Kai Tak Mall 3, Kai Tak Sports Park,
 Kowloon City, Kowloon
 九龍九龍城啟德體育園啟德零售館3, 2樓M3-201號舖

APPLICANT'S SIGNATURE : 

AUTHORIZED AGENT : 

APPLICANT'S NAME : MA Victor
 AUTHORIZED AGENT : IP lok Meng (葉毓明)
 CONTACT NUMBER : 9480 9417 (Andy IP)

CENTRE 4 APPLICATION DATE : 6/1/2025
 USEABLE AREA : 53.19 M² (573 FT²)
 ④ CLASSROOM 4 : 29 STUDENTS + 1 TEACHER

CENTRE 5
 USEABLE AREA (INCL. STORE ROOM)
 145.38 M² (1565 FT²)
 ⑤A CLASSROOM 5A : 29 STUDENTS + 1 TEACHER
 ⑤B CLASSROOM 5B : 16 STUDENTS + 1 TEACHER
 ⑤C CLASSROOM 5C : 26 STUDENTS + 1 TEACHER
 TOTAL NUMBER : 71 STUDENTS + 3 TEACHERS

CENTRE 3
 USEABLE AREA : 56.24 M² (605 FT²)
 ③ CLASSROOM 3 : 29 STUDENTS + 1 TEACHER

CENTRE 2
 USEABLE AREA : 43.55 M² (469 FT²)
 ② CLASSROOM 2 : 29 STUDENTS + 1 TEACHER

CENTRE 1
 USEABLE AREA : 36.94 M² (398 FT²)
 ①A CLASSROOM 1A : 4 STUDENTS + 1 TEACHER
 ①B CLASSROOM 1B : 6 STUDENTS + 1 TEACHER
 ①C CLASSROOM 1C : 4 STUDENTS + 1 TEACHER
 TOTAL NUMBER : 14 STUDENTS + 3 TEACHERS

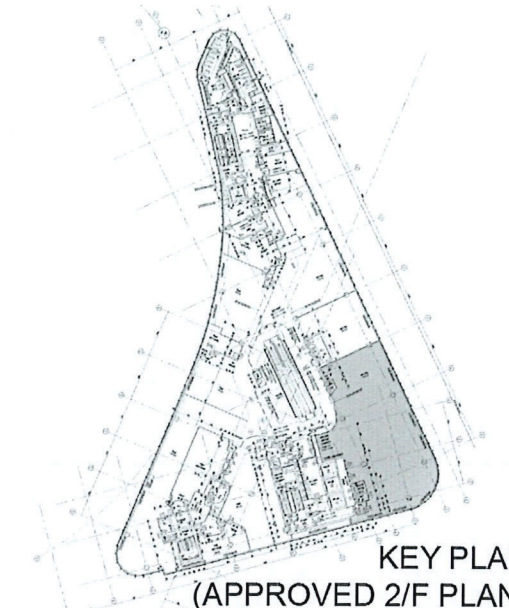

TOTAL AREA OF THE PREMISES : 409.27 M²

PROPOSED NO. OF STUDENTS = 172 NOS.
 PROPOSED NO. OF TEACHER/STAFF = 9 NOS.
 TOTAL POPULATION OF THE SCHOOL = 181 NOS.

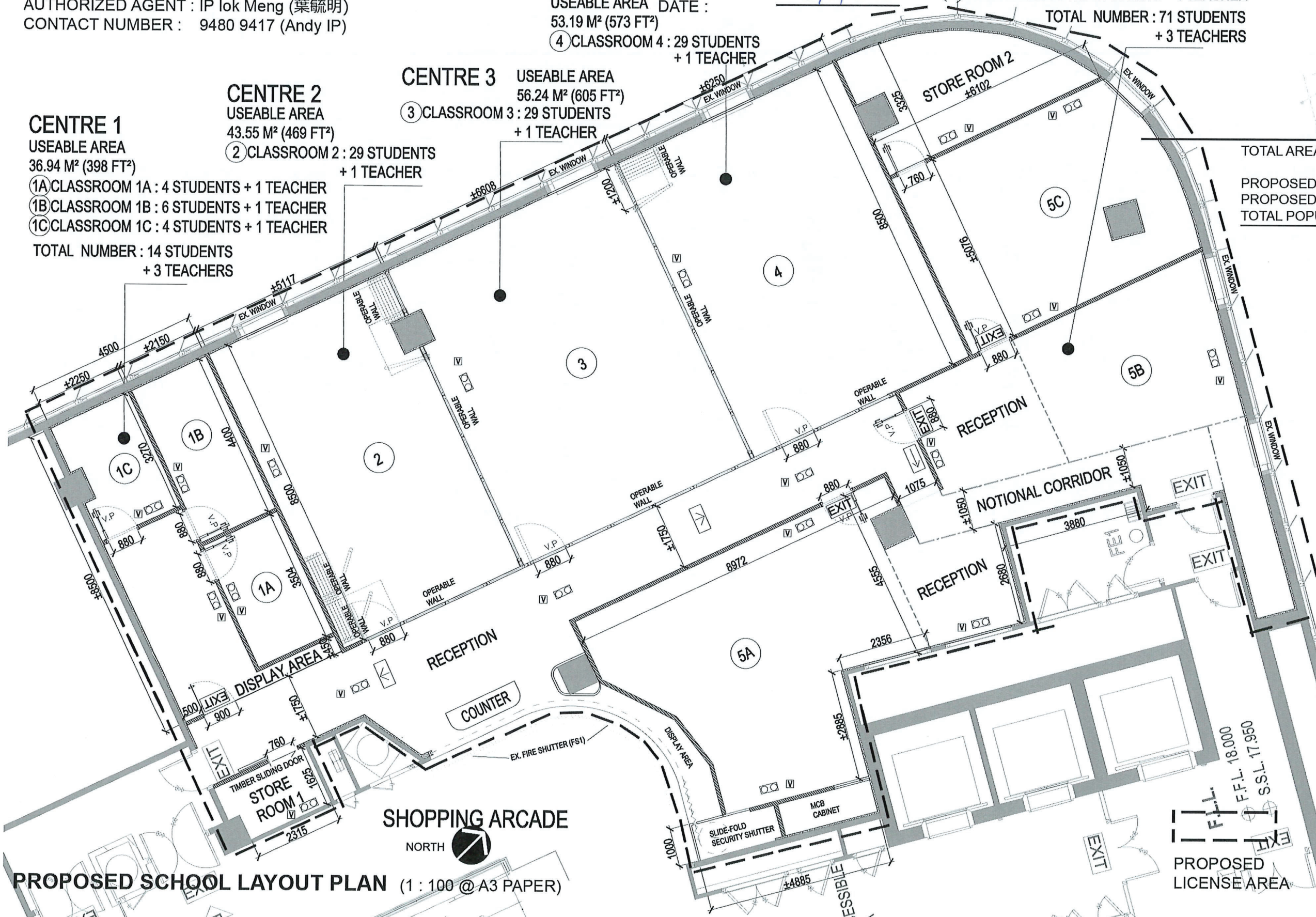

- NOTE :
- NO POPULATION SHALL BE GENERATED IN RECEPTIONS, DISPLAY AREA, STORE ROOM 1 & 2;
 - THE SCHOOL PREMISES SHALL BE PROTECTED WITH HOSE REEL SYSTEM, SPRINKLERS & MANUAL FIRE ALARM SYSTEM WITH BREAKGLASS UNITS NEAR MAIN EXITS
- EXISTING SOLID CONCRETE WALL/COLUMN (FULL HEIGHT)
 - NEW GYPSUM BOARD PARTITION
 - NEW OPERABLE WALL PARTITION (SLIDE-FOLD)
 - NEW EMERGENCY LIGHTS AT HL
 - NEW CEILING-TYPE VISUAL FIRE ALARM
 - NEW EXIT SIGN AT HL WITH RECHARGEABLE BATTERY
 - NEW DIRECTIONAL SIGN AT HL WITH RECHARGEABLE BATTERY
- NOTIONAL LINE / BOUNDARY
 - TIMBER DOOR WITH VISION PANEL
 - TIMBER DOOR WITHOUT VISION PANEL
 - GLASS DOOR UNLESS OTHERWISE STATED

PROPOSED SCHOOL LAYOUT PLAN (1 : 100 @ A3 PAPER)

PROPOSED LICENSE AREA

DRG. NO. : SK-KT-01