

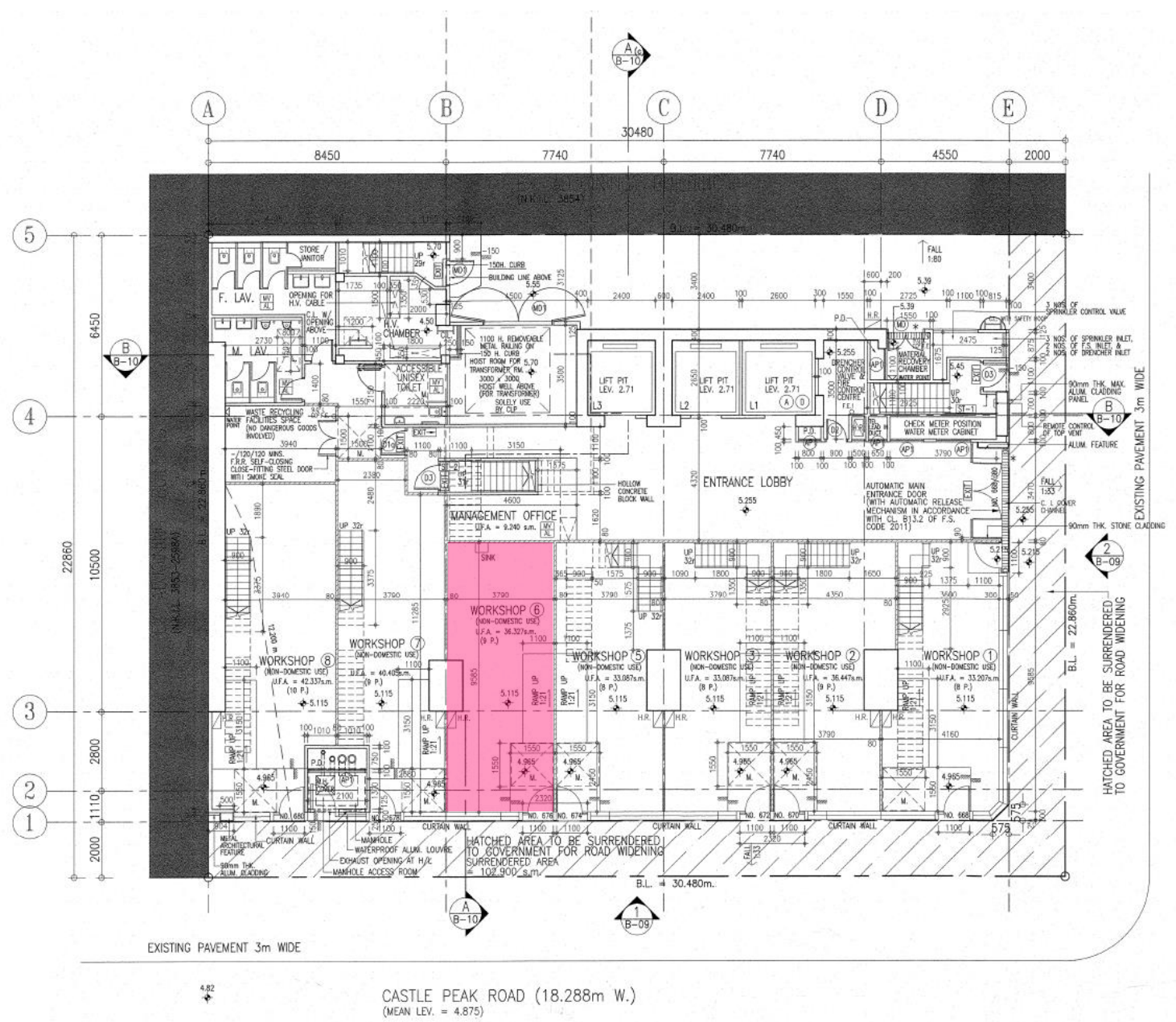

Location Plan



GROUND FLOOR PLAN

- NOTE :
1. AUTOMATIC SPRINKLER SYSTEM TO BE PROVIDED.
 2. FLOOR IMPOSED LOAD = 7.5 kpa.
 3. PERMANENT ARTIFICIAL LIGHTING SYSTEM WITH 30 LUX MIN. LIGHTING LEVEL BACKED UP BY AN EMERGENCY LIGHTING SYSTEM PROVIDING A HORIZONTAL ILLUMINANCE AT FLOOR LEVEL OF NOT LESS THAN 2 LUX COMPLYING WITH THE CODE OF PRACTICE FOR MINIMUM FIRE SERVICE INSTALLATIONS AND EQUIPMENT / REQUIREMENTS OF THE DIRECTOR OF FIRE SERVICES AND BS5266 : PART 1 : 1988 AND PERMANENTLY MAINTAINED IN EFFECTIVE WORKING ORDER WILL BE PROVIDED TO STAIRCASE NO. 2
 4. EMERGENCY POWER FOR LIFT HOMING (PASSENGER LIFT) - WHEN FIRE ALARM SIGNAL IS RECEIVED UNDER EMERGENCY POWER, THE PASSENGER LIFT SHALL TRAVEL DOWN TO G/F ONE BY ONE IN SEQUENCE AND REMAIN THERE INOPERATIVE WITH DOORS OPENED.
- * ALL 225 W. SURFACE CHANNEL HAVE 2 DRAINAGE POINTS & METAL GRILLE COVER TO BE PROVIDED IN ACCORDANCE WITH / P.H.A.P. APP-127

Proposed Layout Plan (Pink Colour)