

Total: 6 pages

Date: 8 April 2024

TPB Ref.: A/NE-HLH/68

By Email

Town Planning Board
15/F, North Point Government Offices
333, Java Road
North Point
Hong Kong
(Attn: The Secretary)

Dear Sir,

Proposed Temporary Warehouse and Open Storage of Construction Machinery & Construction Material for a Period of 3 Years at Lots 171 (Part), 172 (Part), 176 (Part) & 177 (Part) in D.D. 87, Ta Kwu Ling, New Territories

Our response to the comments of the Transport Department is shown in the attachment. Due to the submission of the swept path analysis, the location of the parking spaces and loading/unloading bay in the proposed layout plan have been updated.

Our response to the comments of DLO/N is found below:

The applicant will apply for short term waiver (STW) to DLO/N upon planning approval.

Should you have any enquiries, please feel free to contact our Mr. Patrick Tsui at at your convenience.

Yours faithfully,

The image shows a handwritten signature in blue ink, which appears to be 'Patrick Tsui'. To the right of the signature is a purple circular stamp. The stamp contains the text 'URBAN PLANNING & DEVELOPMENT COMPANY LIMITED' around the perimeter and '都市規劃及發展顧問有限公司' in the center.

Patrick Tsui

c.c. Sha Tin, Tai Po and North District Planning Office (Attn: Ms. Carmen CHEUNG) – By Email

**Proposed Temporary Open Storage and Warehouse (Storage Of Construction Machinery and Construction Materials) for a Period of 3 Years at Lots 171 (Part), 172 (Part), 176 (Part) and 177 (Part) in D.D. 87, Ta Kwu Ling, New Territories
(Planning Application No. A/NE-HLH/68)**

Summary Table of Responses to Comments

11 December 2023

Comments	Responses
Comments from Transport Department	
(i) The applicant shall demonstrate the satisfactory maneuvering of the goods vehicles entering and existing the subject site, maneuvering within the subject site and into/out of the parking and loading/unloading spaces, preferably using the swept path analysis;	Please refer to Figure 1 for the proposed layout plan and Figures 2 – 3 for the swept path analysis results.
(ii) The applicant shall advise the management/control measures to be implemented to ensure no queuing of vehicles outside the subject site;	No drop bar will be provided at the Site entrance. During the operation hours, the gate will be kept open. Furthermore, a visit-by-appointment system will be implemented to control the number of vehicles visiting the Site to ensure no queuing of vehicles outside the Subject Site.
(iii) The applicant shall advise the provision and management of pedestrian facilities to ensure pedestrian safety;	Revolving lanterns will be provided at both sides of the vehicular access to warn the pedestrians when there is a vehicle exiting from the Subject Site. Appropriate footway is demarcated within the warehouse to ensure the pedestrian safety.
(iv) The applicant shall advise the measure in preventing illegal parking by visitors to the subject site; and	Please note that a visit-by-appointment system will be implemented to control the number of vehicles visiting the Site to ensure all visitors parked within the Site.
(v) The proposed vehicular access between Ping Che Road and the application site is not managed by TD. The applicant should seek comments from the responsible party.	Noted. Notices were being posted during the public consultation process and the applicant will resolve any objection received.

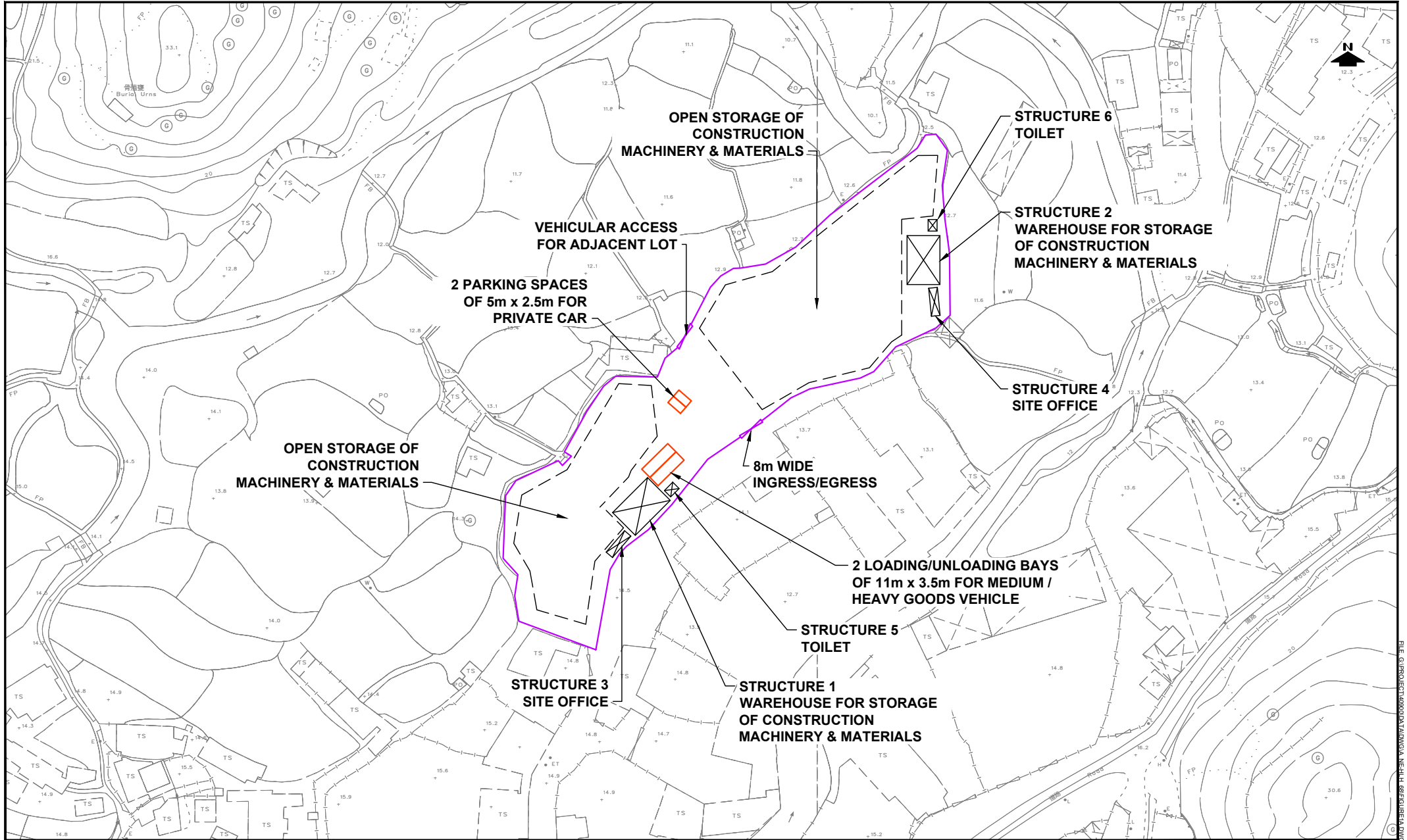

PROJECT NO.	40900
DESIGNED	SLN
DRAWN	CLL
CHECKED	SLN
DATE	DEC 2023
SCALE	1:1500

PROJECT TITLE	PROPOSED TEMPORARY WAREHOUSE AND OPEN STORAGE OF CONSTRUCTION MACHINERY & CONSTRUCTION MATERIAL FOR PERIOD OF 3 YEARS AT LOTS 171 (PART), 172 (PART), 176 (PART) & 177 (PART) IN D.D. 87, TA KWU LING, NEW TERRITORIES
DRAWING TITLE	PROPOSED LAYOUT PLAN

DRAWING NO.	FIGURE 1	REV.	A
LLA 顧問有限公司 Consultancy Limited			

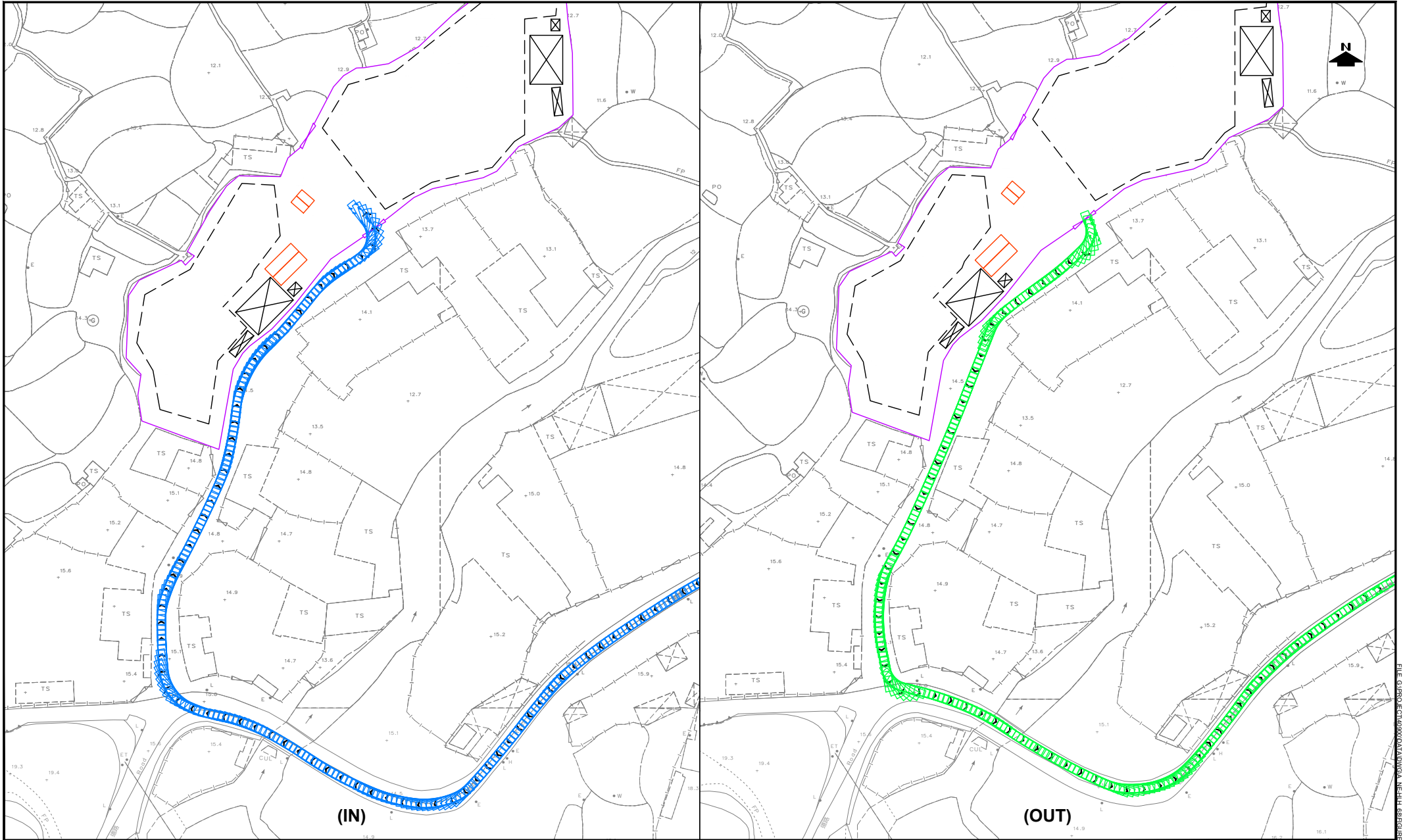

PROJECT NO.	40900	
DESIGNED	SLN	DATE DEC 2023
DRAWN	CLL	SCALE 1:1500
CHECKED	SLN	

PROJECT TITLE **PROPOSED TEMPORARY WAREHOUSE AND OPEN STORAGE OF CONSTRUCTION MACHINERY & CONSTRUCTION MATERIAL FOR PERIOD OF 3 YEARS AT LOTS 171 (PART), 172 (PART), 176 (PART) & 177 (PART) IN D.D. 87, TA KWU LING, NEW TERRITORIES**

DRAWING TITLE	SWEPT PATH ANALYSIS - HGV (ENTERING AND LEAVING THE SITE)	
---------------	--	--

DRAWING NO.	FIGURE 2	REV.	A
-------------	-----------------	------	----------

LLA 顧問有限公司
Consultancy Limited

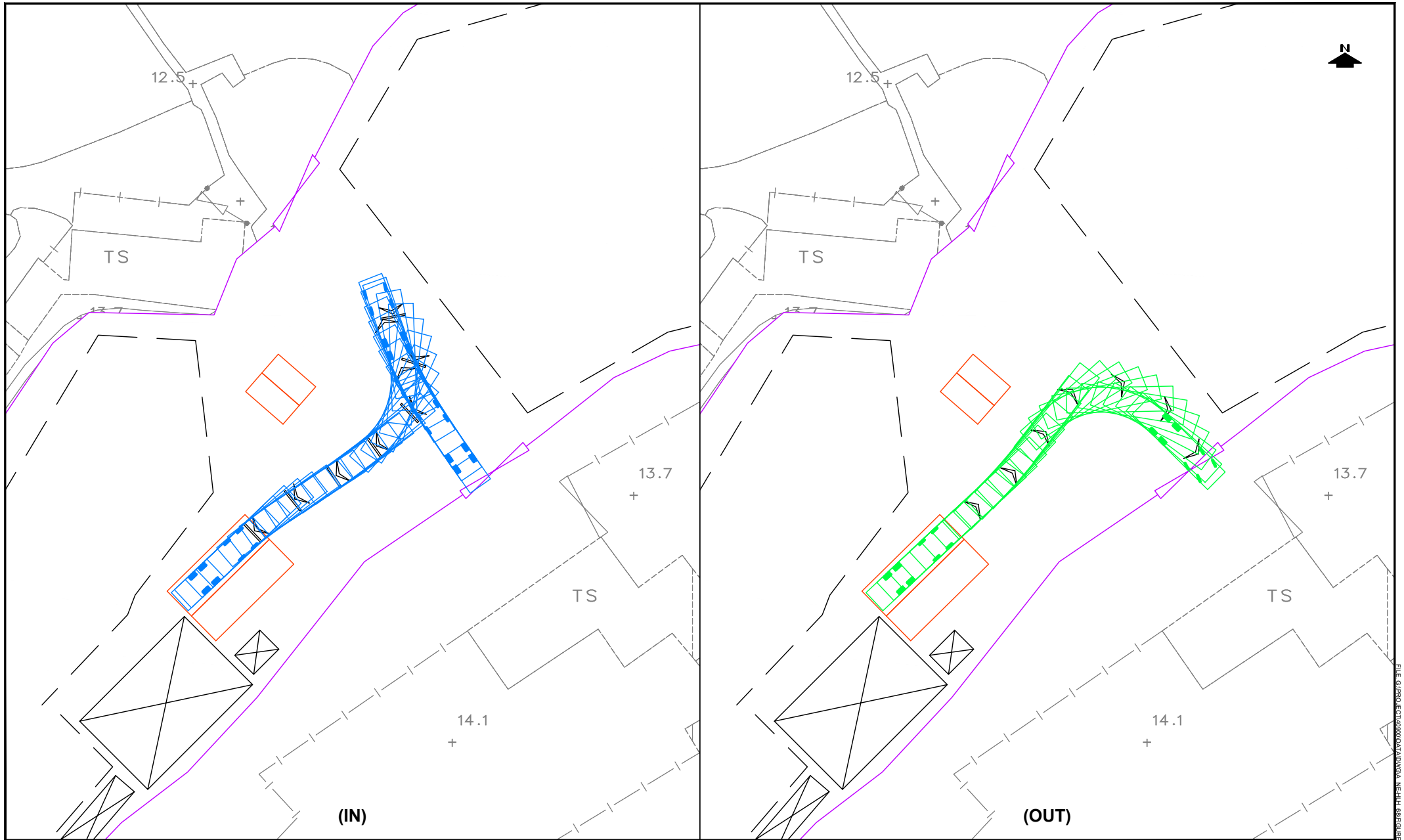

PROJECT NO.	40900	
DESIGNED	SLN	DATE DEC 2023
DRAWN	CLL	SCALE 1:500
CHECKED	SLN	

PROJECT TITLE PROPOSED TEMPORARY WAREHOUSE AND OPEN STORAGE OF CONSTRUCTION MACHINERY & CONSTRUCTION MATERIAL FOR PERIOD OF 3 YEARS AT LOTS 171 (PART), 172 (PART), 176 (PART) & 177 (PART) IN D.D. 87, TA KWU LING, NEW TERRITORIES

DRAWING NO.	FIGURE 3	REV.	A
-------------	-----------------	------	----------

SWEPT PATH ANALYSIS - HGV (ENTERING AND LEAVING LOADING/UNLOADING SPACE)

LLA 顧問有限公司
Consultancy Limited

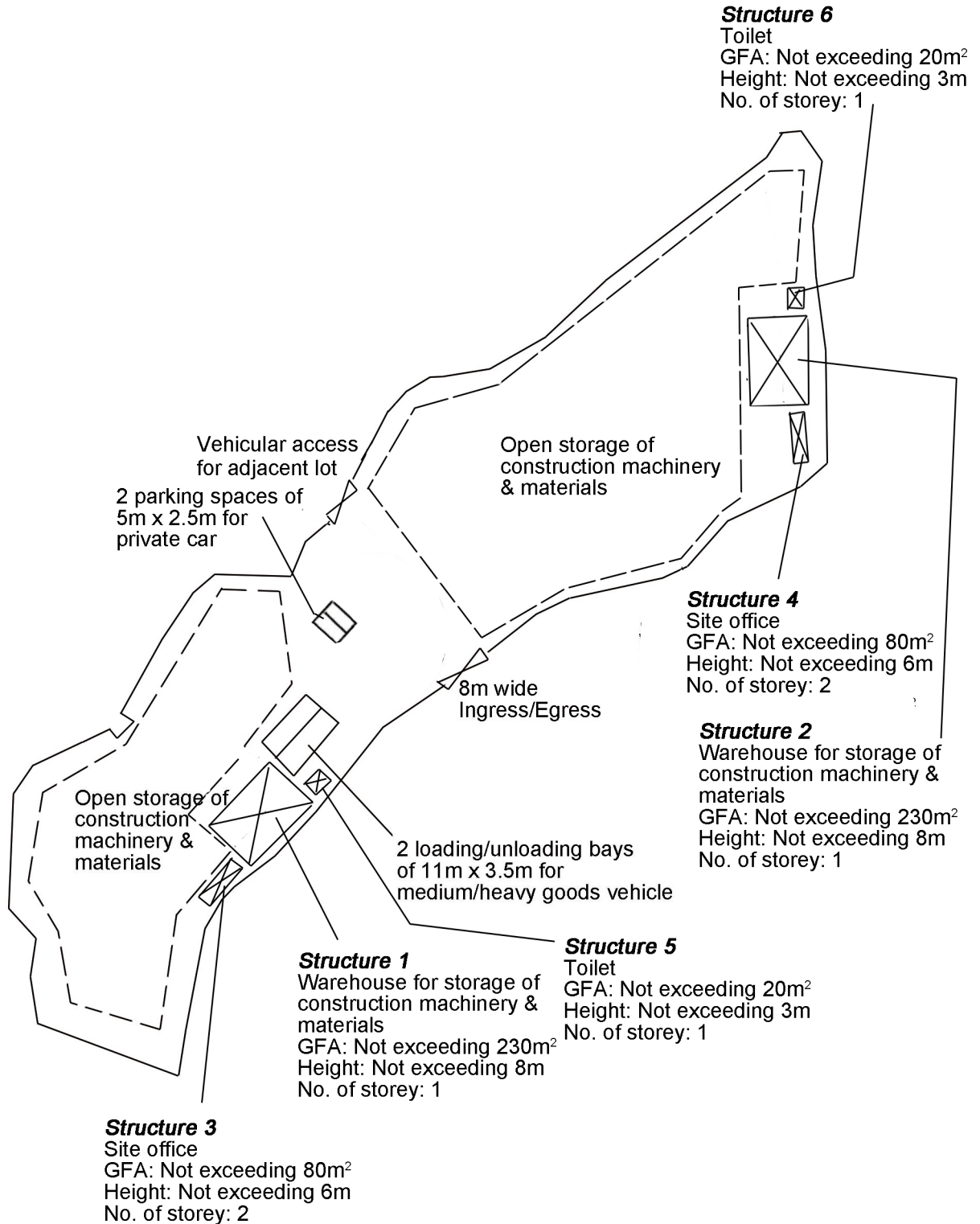

<p>Project 項目名稱:</p> <p>Proposed Temporary Warehouse and Open Storage of Construction Machinery & Construction Material for a Period of 3 Years at Lots 171 (Part), 172 (Part), 176 (Part) & 177 (Part) in D.D. 87, Ta Kwu Ling, New Territories</p>	<p>Drawing Title 圖目:</p> <p>Proposed Layout Plan</p>	<p>Remarks 備註:</p>
<p>Drawing No. 圖號:</p> <p>Figure 3</p>	<p>Scale 比例:</p> <p>1:1000</p>	