

N



Drawing No.

Figure 8

Project

Proposed Temporary Warehouse for Storage of Food Provisions for a Period of 3 Years and Filling of Land at Lots 478 S.A RP, 482 (Part), 484 & 487 (Part) in D.D. 90, Lin Ma Hang Road, Ta Kwu Ling, N.T.

Drawing Title

Swept Path Analysis for Medium/Heavy Goods Vehicle Getting Into the Site

Scale

1:1000

Remarks

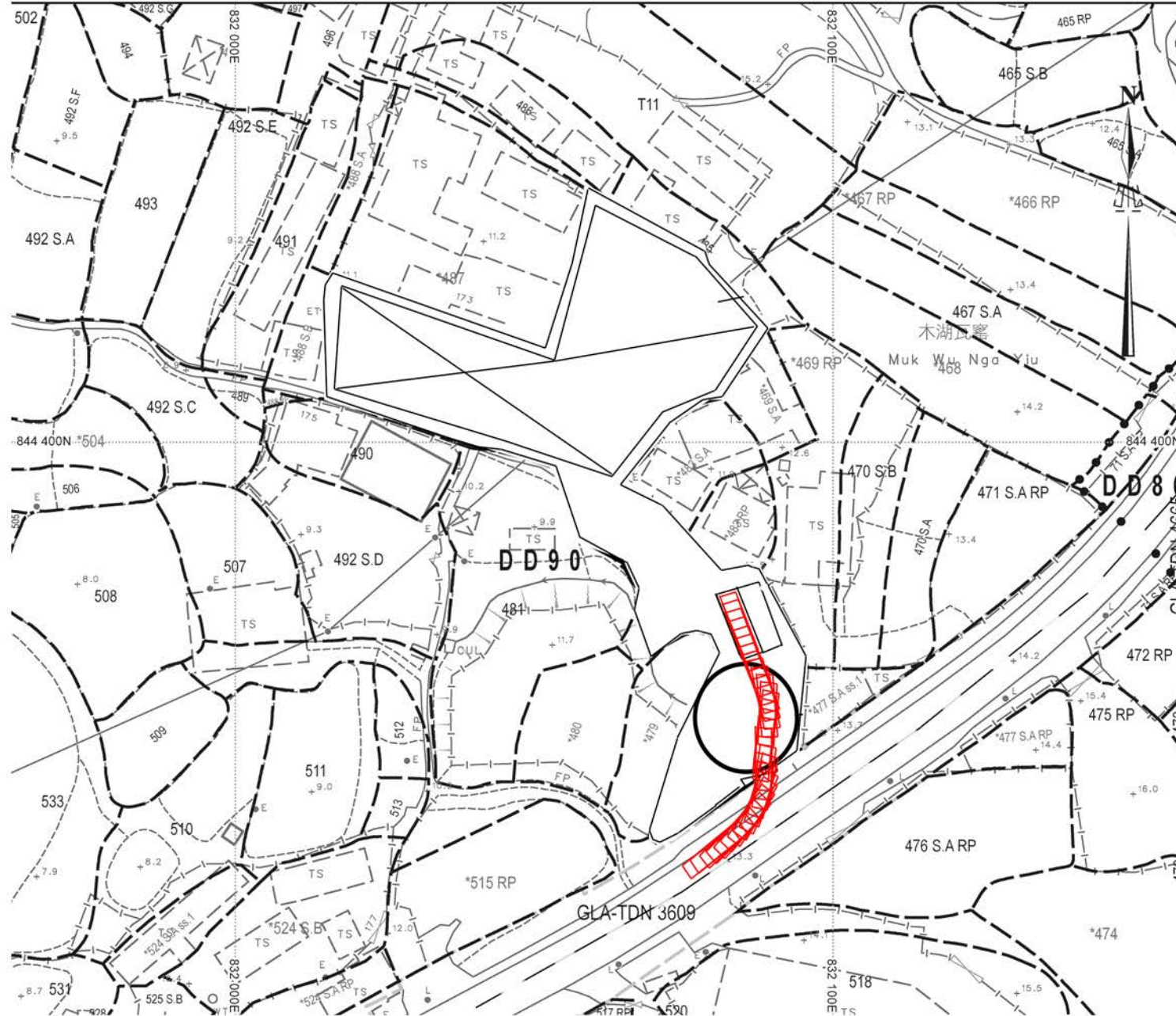

N



Drawing No.

Figure 9

Project

Proposed Temporary Warehouse for Storage of Food Provisions for a Period of 3 Years and Filling of Land at Lots 478 S.A RP, 482 (Part), 484 & 487 (Part) in D.D. 90, Lin Ma Hang Road, Ta Kwu Ling, N.T.

Drawing Title

Swept Path Analysis for Medium/Heavy Goods Vehicle Leaving the Site

Scale

1:1000

Remarks

