

Legend	
□	Application Site



**LCH Planning and Development
Consultants Limited**

Section 16 Application for Proposed Temporary Warehouse with Ancillary Office for a period of 3 Years at Loi Tung, New Territories

Figure 1 : Location Plan

(For reference only. Not to scale.)

(Source: HK GEODATA STORE, HKSAR Government)



**LCH Planning and Development
Consultants Limited**

Section 16 Application for Proposed Temporary Warehouse with Ancillary Office for a period of 3 Years at Loi Tung, New Territories

Figure 2 : Site Plan

(For reference only. Not to scale.)

(Source: HK GEODATA STORE, HKSAR Government)

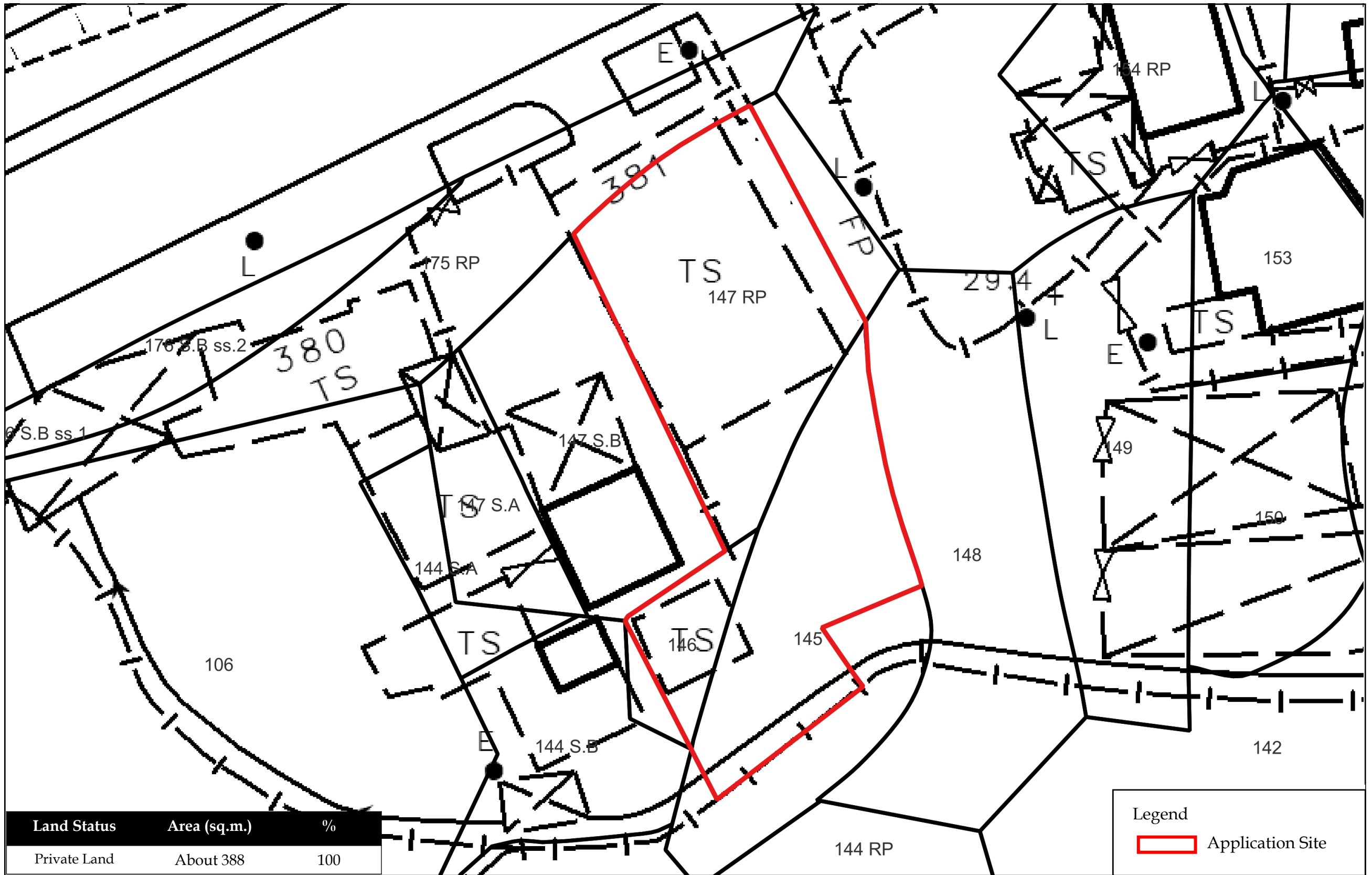

Land Status	Area (sq.m.)	%
Private Land	About 388	100

Legend

Application Site



**LCH Planning and Development
Consultants Limited**

Section 16 Application for Proposed Temporary Warehouse with Ancillary Office for a period of 3 Years at Loi Tung, New Territories

Figure 3 : Land Status
(For reference only. Not to scale.)

(Source: HK GEODATA STORE, HKSAR Government)

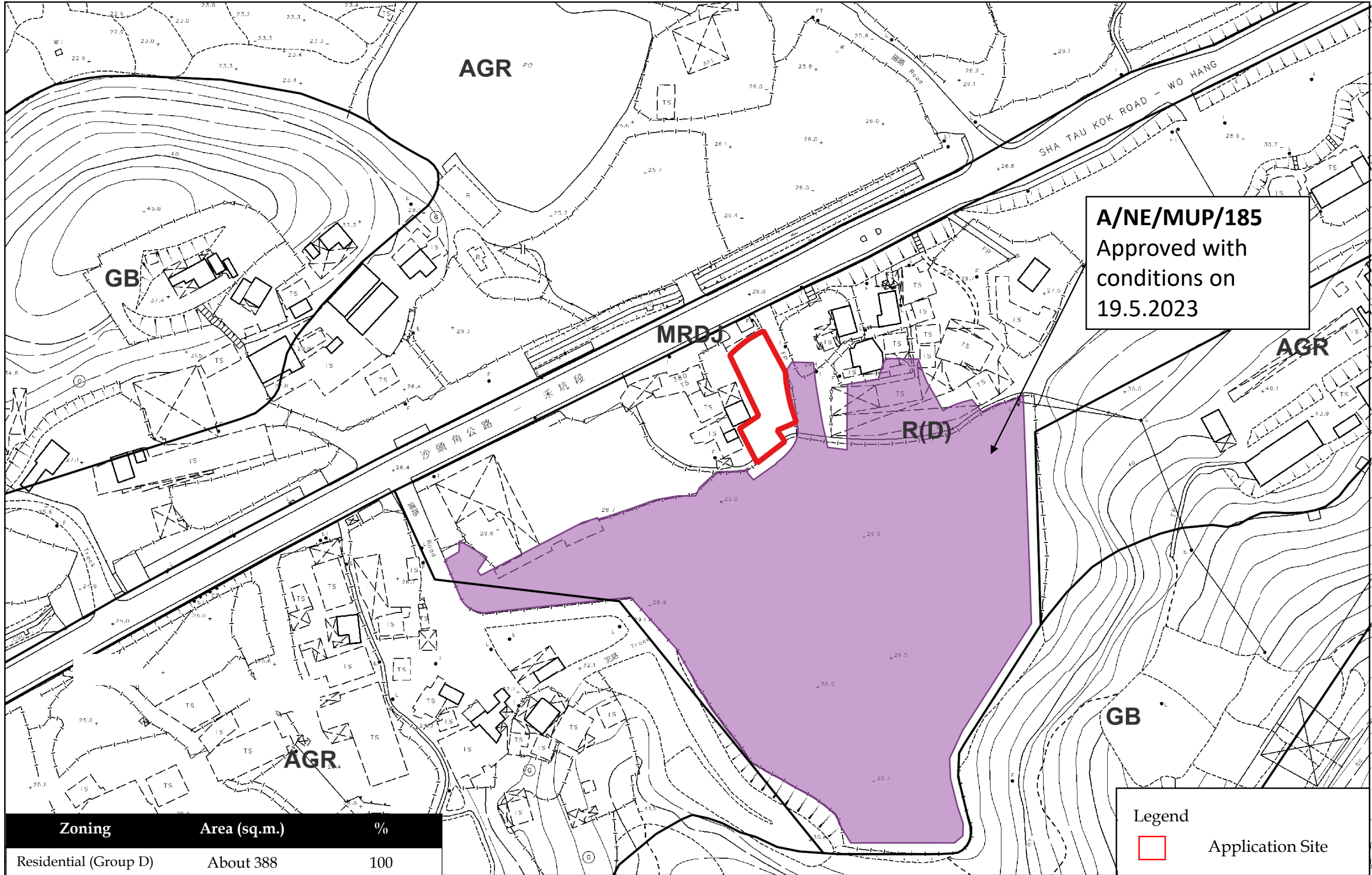

A/NE/MUP/185
 Approved with
 conditions on
 19.5.2023

Zoning	Area (sq.m.)	%
Residential (Group D)	About 388	100

Legend

Application Site

 **LCH Planning and Development Consultants Limited**

Section 16 Application for Proposed Temporary Warehouse with Ancillary Office for a period of 3 Years at Loi Tung, New Territories

Figure 4 : Extract of Outline Zoning Plan No. S/NE-MUP/11
 (For reference only. Not to scale.)

(Source: Town Planning Board & HK GEODATA STORE, HKSAR Government)



**LCH Planning and Development
Consultants Limited**

Annex 1 : Aerial Photos

(Extracted based on Aerial Photo no. A23075 taken on 12.10.1990 by Lands Department)

Section 16 Application for Proposed Temporary Warehouse with Ancillary Office for a period of 3 Years at Loi Tung, New Territories

(Source: HK GEODATA STORE, HKSAR Government)



**LCH Planning and Development
Consultants Limited**

Section 16 Application for Proposed Temporary Warehouse with Ancillary Office for a period of 3 Years at Loi Tung, New Territories

Annex 1 : Aerial Photos

(Extracted based on Aerial Photo no. CN07711 taken on 30.6.1994 by Lands Department)

(Source: HK GEODATA STORE, HKSAR Government)



**LCH Planning and Development
Consultants Limited**

Section 16 Application for Proposed Temporary Warehouse with Ancillary Office for a period of 3 Years at Loi Tung, New Territories

Annex 1 : Aerial Photos

(Extracted based on Aerial Photo no. A51071 taken on 9.8.2000 by Lands Department)

(Source: HK GEODATA STORE, HKSAR Government)



**LCH Planning and Development
Consultants Limited**

Annex 1 : Aerial Photos

(Extracted based on Aerial Photo no. CW66108 taken on 25.10.2005 by Lands Department)

Section 16 Application for Proposed Temporary Warehouse with Ancillary Office for a period of 3 Years at Loi Tung, New Territories

(Source: HK GEODATA STORE, HKSAR Government)



**LCH Planning and Development
Consultants Limited**

Annex 1 : Aerial Photos

(Extracted based on Aerial Photo no. E184381C taken on 22.2.2023 by Lands Department)

Section 16 Application for Proposed Temporary Warehouse with Ancillary Office for a period of 3 Years at Loi Tung, New Territories

(Source: HK GEODATA STORE, HKSAR Government)

Proposed Development Parameters



Site Area :	About 388 sq.m.
Nos. of Structure :	3
Built Over Area :	About 231 sq.m.
Max. Building Height :	5 meters
Site Coverage :	About 60%

Structure
 1-storey Warehouse with ancillary office
 Total Floor Area: 147 sq.m.
 Height: About 5m

Structure
 1-storey Storage
 Total Floor Area: 18 sq.m.
 Height: About 3m

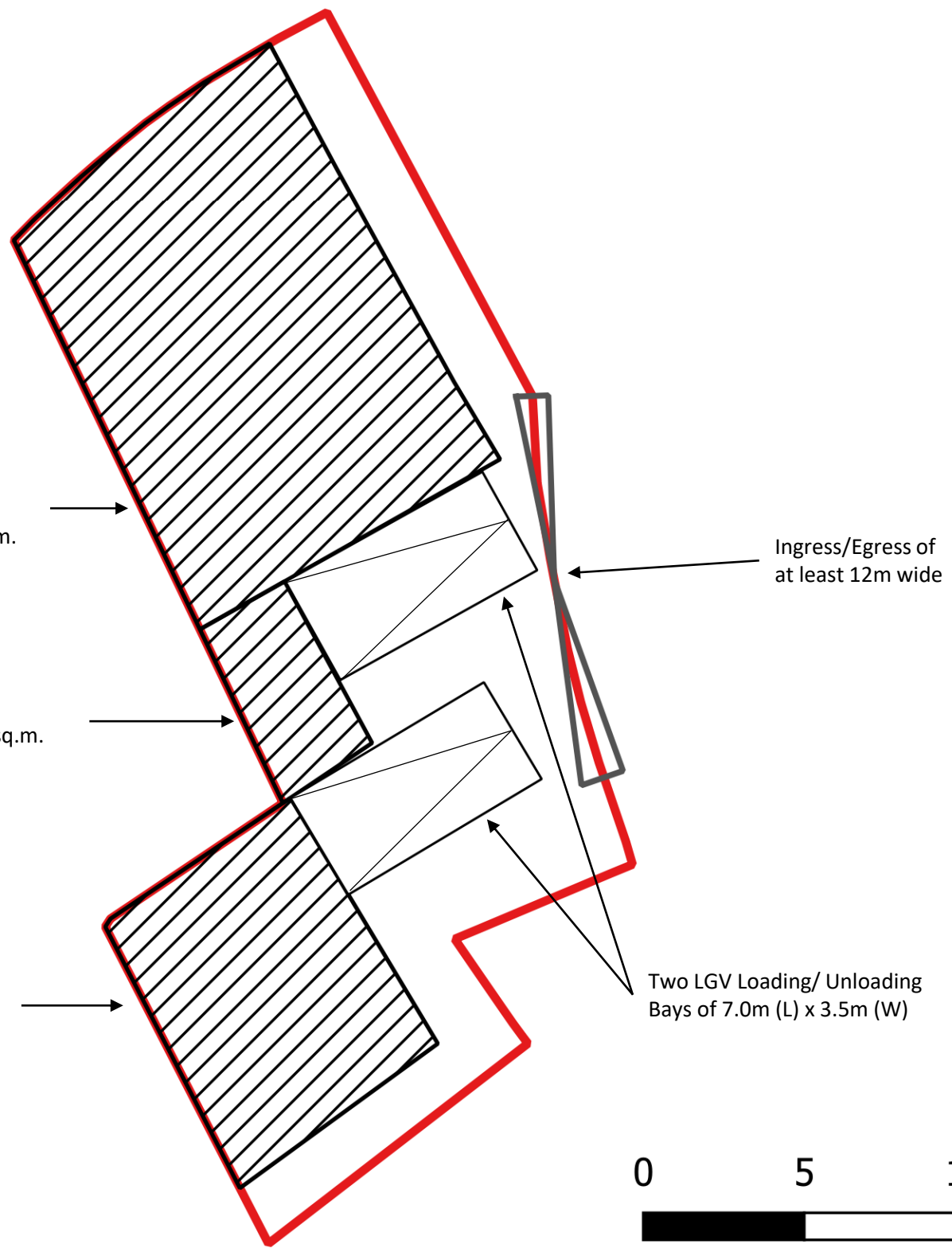
Structure
 1-storey Warehouse with ancillary office
 Total Floor Area: 66 sq.m.
 Height: About 5m



 Application Site
 Proposed Structures

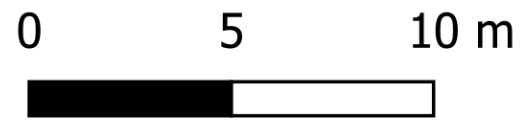

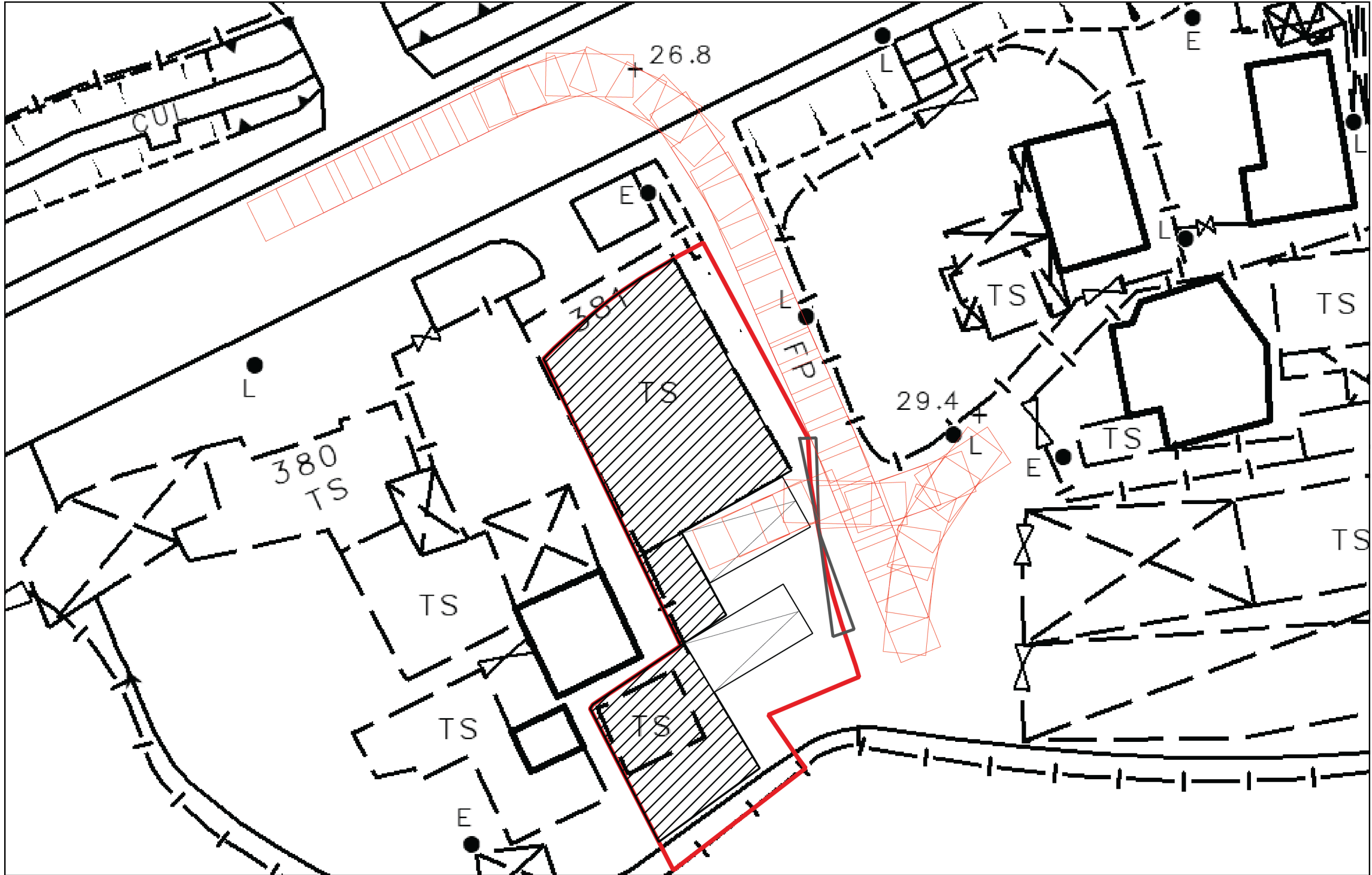

LCH Planning and Development Consultants Limited

Section 16 Application for Proposed Temporary Warehouse with Ancillary Office for a period of 3 Years at Loi Tung, New Territories

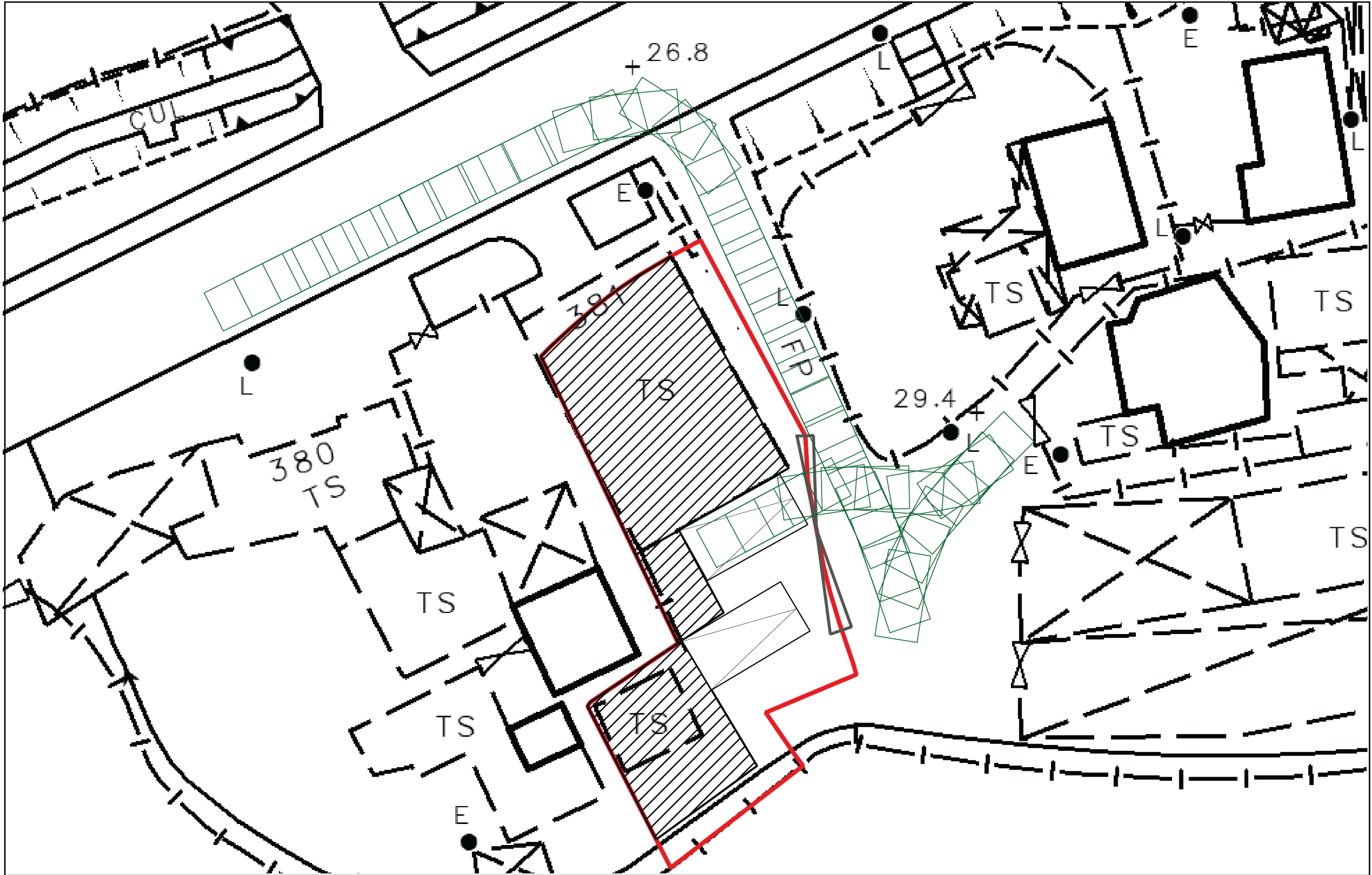

**LCH Planning and Development
Consultants Limited**

Section 16 Application for Proposed Temporary Warehouse with Ancillary Office for a period of 3 Years at Loi Tung, New Territories



**LCH Planning and Development
Consultants Limited**

Section 16 Application for Proposed Temporary Warehouse with Ancillary Office for a period of 3 Years at Loi Tung, New Territories