

地段索引圖 LOT INDEX PLAN

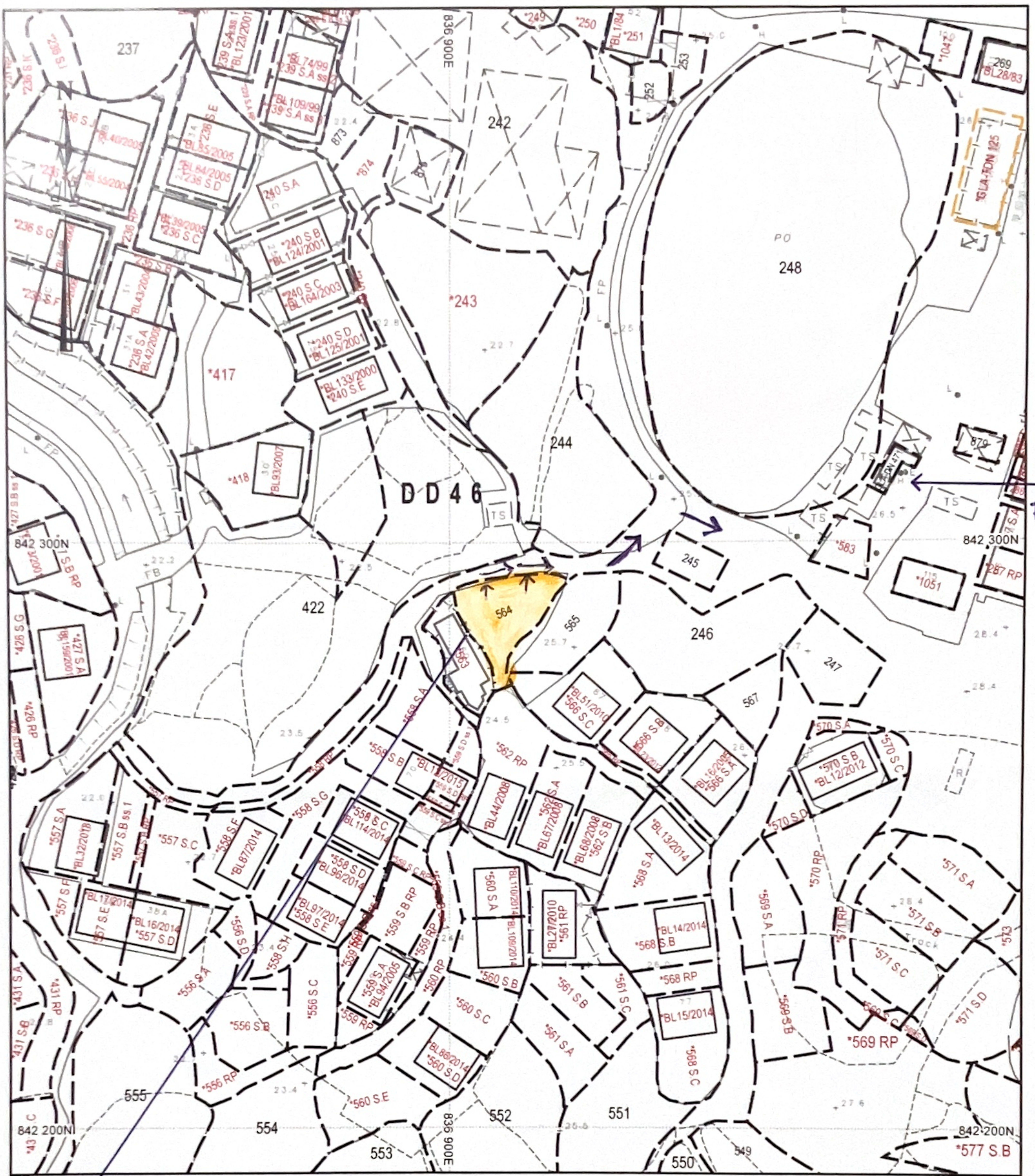

地政總署測繪處 Survey and Mapping Office, Lands Department

位置圖

比例尺 SCALE 1:1000

現存行車方向 →

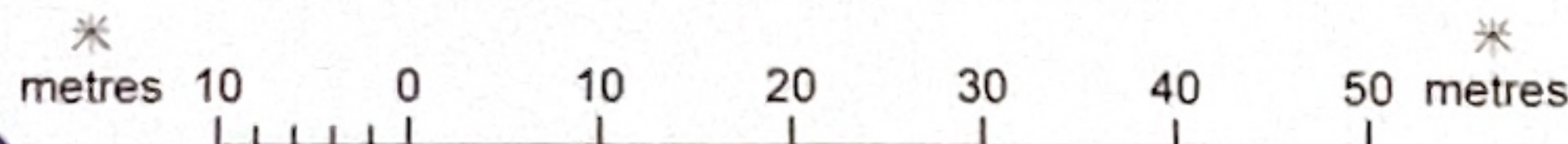

Locality : _____
 Lot Index Plan No. : LIP1583308P
 District Survey Office : DSON
 Date : 12-Apr-2024
 Reference No. : 3-NW-25D

摘要說明：本地段索引圖在其背景的地形圖上標示了各種永久和短期持有的土地的圖像界線。這些土地包括私人地段、政府撥地、短期租約批地，以及其他作核准用途的土地。請注意：(1)本索引圖上的資料會被不時更新而不作事先通知；(2)索引圖的更新或會延後於有關資料的實際變更；以及(3)本索引圖中顯示的界線僅供識別之用，資料是否準確可靠，應徵詢專業土地測量師的意見。
 免費說明：如因使用本地段索引圖，或因所依據的本索引圖資料出錯、遺漏、過時或有誤差而引致任何損失或損害，政府概不承擔任何法律責任。

Explanatory notes : This plan shows the graphical boundaries of different kinds of permanent and temporary land holdings with the topographic map in the backdrop. The land holdings as shown may include private lots, government land allocations, short term tenancies and other permitted uses of land. It must be noted that: (1) the information shown on this plan is subject to update without prior notification, (2) there may be time lag between an update and the related changes taken place, and (3) the graphical boundaries as shown are for identification purpose only and interpretation of their accuracy and reliability requires the advice from professional land surveyor.
Disclaimer : The Government shall not be responsible for any loss or damage howsoever arising from the use of this plan or in reliance upon its correctness, completeness, timeliness or accuracy.

香港特別行政區政府 — 版權所有
 © Copyright reserved - Hong Kong SAR Government
 SMO-P01 202404122022 10



現有出入口A至F
約20米闊

現存車路

泊車位

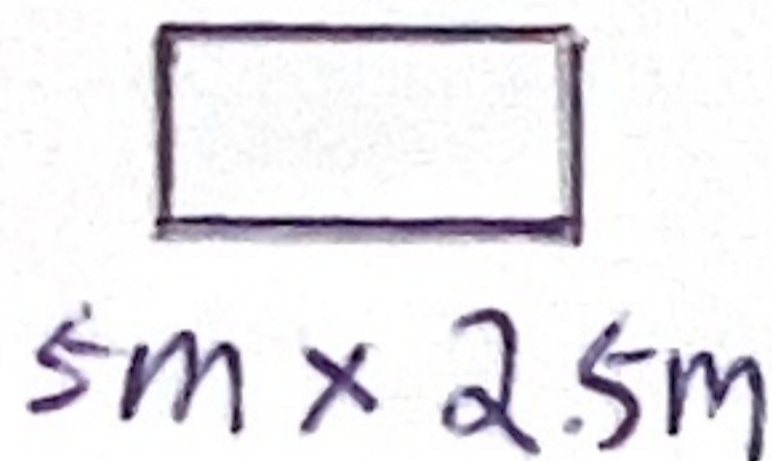

加馬駛方向

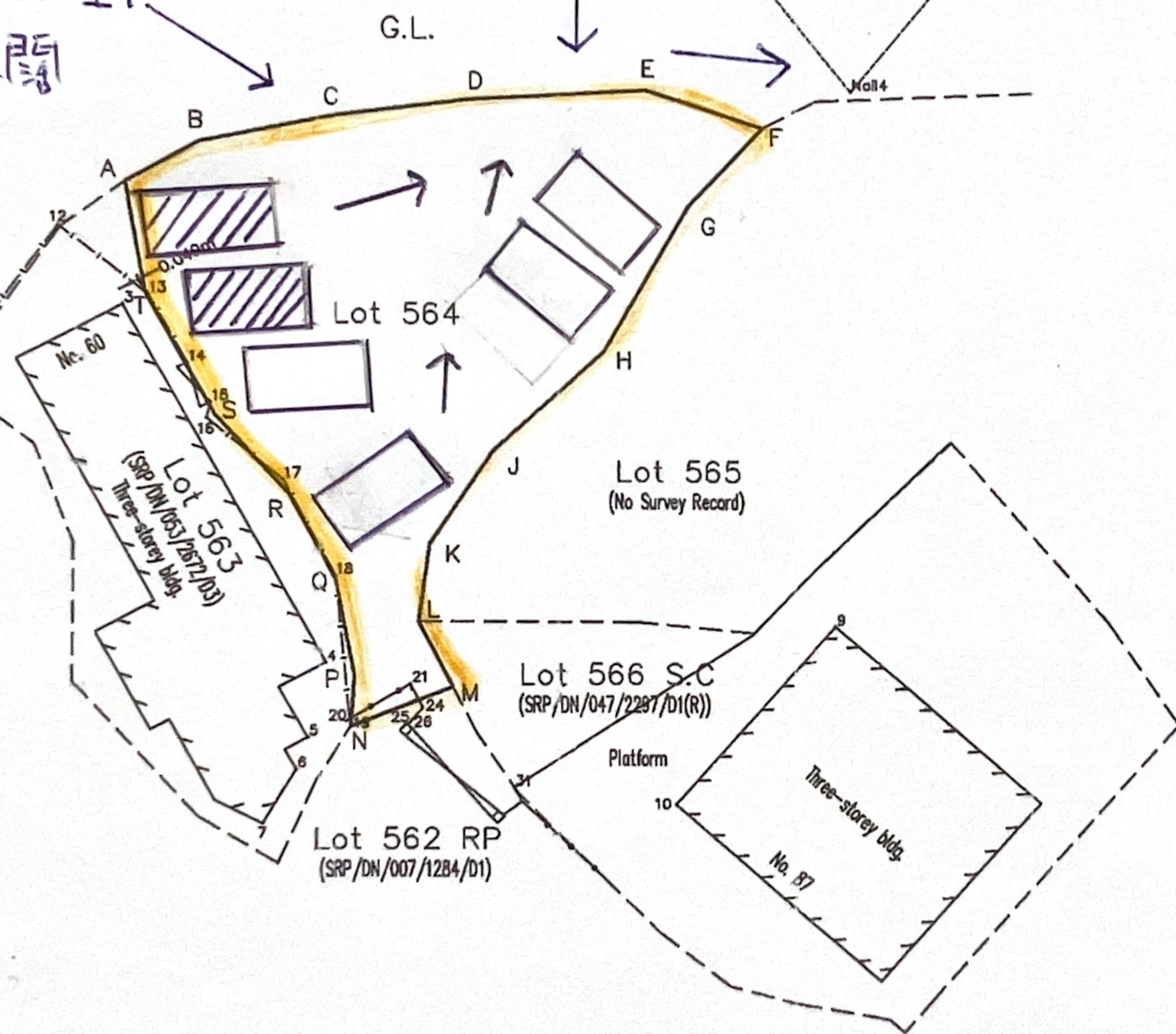
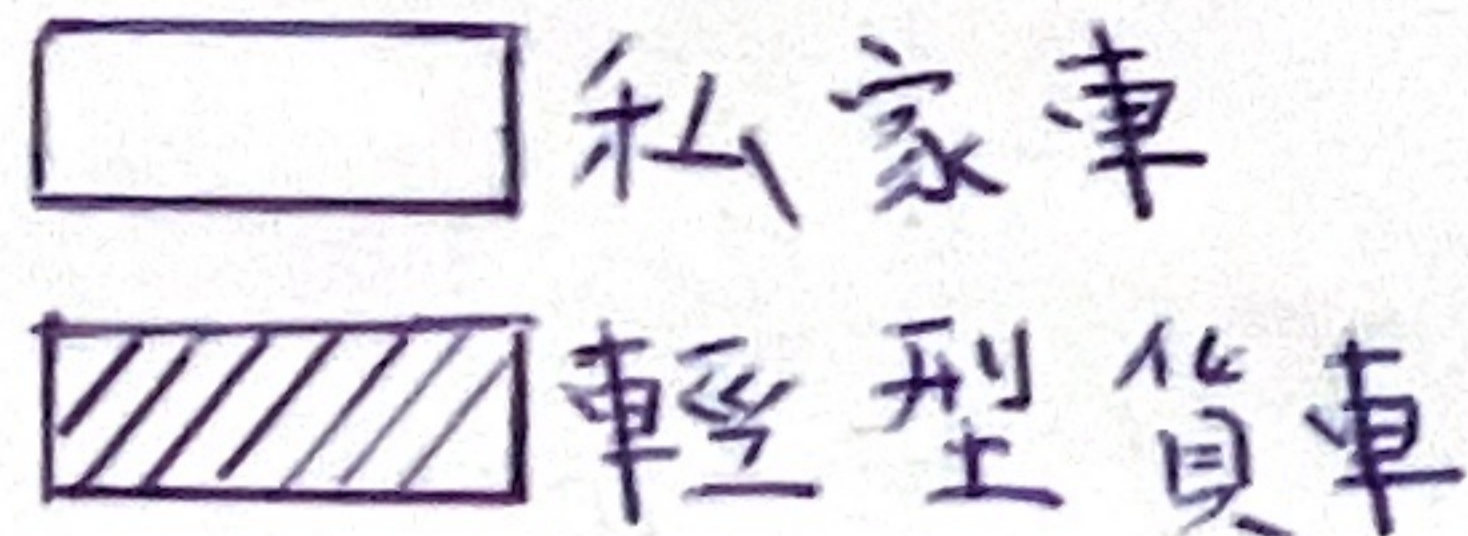

平面圖

PROVISIONAL

Check scale

Survey District : North
Date of Survey : December 2022
Scale: 1:200
Survey Sheet : 3-NW-25D
Ref. SRP No. : SRP/DN/053/2672/D3, SRP/DN/007/1284/D1, SRP/DN/047/2287/D1(R)

DIMENSION PLAN OF LOT 564
IN D.D. 46, LOI TUNG, NORTH

Boundary Point	Bearing	Distance in metres	Northing	Easting
SUBJECT LOT COORDINATES & DIMENSIONS:				
Lot 564 in D. D. 46				
A			842291.827	836900.687
B	60 28 30	2.593	842293.105	836902.943
C	77 44 07	4.069	842293.959	836906.920
D	82 24 19	4.360	842294.546	836911.242
E	86 18 31	5.371	842294.891	836916.602
F	107 36 45	3.809	842293.739	836920.232
G	222 55 48	3.384	842291.251	836917.927
H	209 21 28	5.290	842286.650	836915.334
J	227 29 22	4.691	842283.431	836911.876
K	213 10 43	3.580	842280.434	836909.917
L	187 33 40	2.468	842278.038	836909.592
M	153 12 17	2.313	842275.973	836910.635
N	248 07 06	3.364	842274.719	836907.513
P	3 56 20	1.609	842276.324	836907.624
Q	348 57 40	3.097	842279.354	836907.031
R	332 12 40	3.035	842282.049	836905.615
S	317 57 40	3.341	842284.530	836903.378
T	331 21 50	4.367	842288.352	836901.286
A	350 12 10	3.516	842291.827	836900.687

Traverse Station	Bearing	Distance in metres	Northing	Easting
TRAVERSE:				
DNa114/008/308			842381.869	837001.719
Na111	284 41 47	38.721	842381.693	836964.265
Na112	201 10 47	83.028	842314.275	836934.267
Na113	267 50 44	26.196	842313.290	836908.089
Na114	140 59 31	23.664	842294.902	836922.984
Na115	39 18 24	99.869	842372.179	836986.248
DNa113/008/308	88 51 10	9.486	842372.369	836995.732

Surveyed Point	Bearing	Distance in metres	Northing	Easting
RADIATIONS:				
Fr. Na114				
To 3	252 48 13	23.432	842294.902	836922.984
4	221 48 16	24.372	842276.735	836906.738
5	219 18 06	26.522	842274.379	836906.185
6	218 31 26	27.520	842273.372	836905.843
7	218 00 47	29.486	842271.671	836904.825
9	181 33 46	16.990	842277.919	836922.521
10	193 31 56	23.287	842272.262	836917.535
12	259 35 21	24.708	842280.437	836898.683
13	253 02 02	22.597	842288.308	836901.371
14	246 51 12	22.218	842286.169	836902.555
15	243 10 30	22.123	842284.919	836903.241
16	242 10 01	22.458	842284.417	836903.124
17	234 46 02	21.490	842282.505	836905.431
18	225 57 03	22.196	842279.470	836907.031
19	217 47 01	25.296	842274.910	836907.485
20	217 55 38	25.371	842274.890	836907.390
21	215 54 00	23.257	842276.063	836909.347
22	215 33 23	23.406	842275.861	836909.373
23	215 23 02	23.610	842275.653	836909.313
24	214 05 03	23.658	842275.308	836909.726
25	214 15 36	24.340	842274.786	836909.282
26	213 49 50	24.394	842274.639	836909.403
31	205 21 02	24.462	842272.795	836912.510

LOT/SECTION	AREA
LOT 564 in D.D. 46	185.5 m ² (About)

I, . . . Chan Tak Hing . . . an Authorized Land Surveyor registered under the Land Survey Ordinance (Cap. 473), hereby certify that this survey record plan has been prepared from land boundary surveys that were carried out by me, or under my direct supervision, in conformity with the Code of Practice approved by the Land Survey Authority under the above Ordinance, and that this plan correctly represents that survey completed on the . . . 5th day of December 2022 . . .

Dated this . . . 15th day of . . . APRIL . . . 2024 . . .

PROVISIONAL Authorized Land Surveyor

Survey Record Plan No.: SRP/DN/008/90015/D1