

Urgent Return receipt Expand Group Restricted Prevent Copy

From: Fongs Property < >
Sent: Wednesday, January 22, 2025 11:51 AM
To: William Shu Tai WONG/PLAND <wst Wong@pland.gov.hk>
Subject: 回覆: MUP/211 (2)

Dear Mr Wong,

回應運輸署進一步的題目

1. There is no proper vehicular access to/from the development to join/leave the linked public road. The details of run-in/out design is missing in the FI, and the run-in/out arrangement should be illustrated on the layout plan.

申請人根據運輸署的意見重新規劃有關車路入口的設計，請參閱(run in/ run out proposal for vehicle access)

2. The run-in/out design shall also be subject to HyD's comment and approval.

有關計劃完全根據路政署 / 運輸署標準設計的，申請人在施工時會記錄有關建造過程，並在完工後提供給路政署 / 運輸署批核。

3. The applicant shall undertake that it should be at his cost employ a competent professional to construct the run-in/out of the vehicular access, and the details of the works shall comply with current TD and Highways Department Standards.

申請人完全明白有關的路口重置計劃非常專業，並會自費聘請專業人士作指導及監督整個建造過程並作紀錄，確保完全符合運輸署 / 路政署的標準。

Regards

Ben Fong

Run-in/Run-Out Proposal
for vehicular access

項目
DD46 Lot 815 & 816 S.B RP
擬議臨時物流中心
(為期三年)



Town Planning Board

Ref : TPB_A/NE-MUP/211

Date 2025/1/21

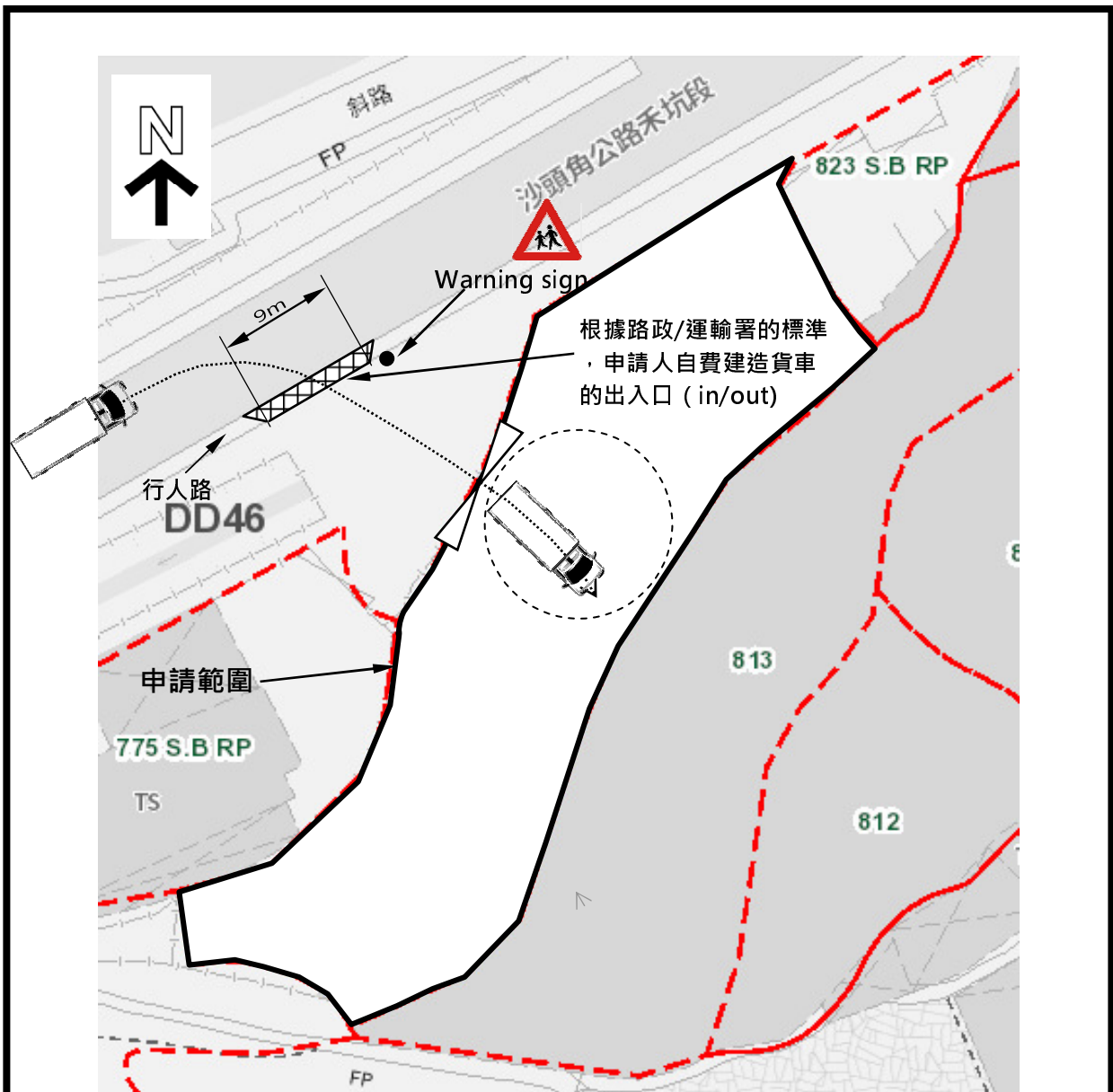
Revised

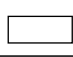

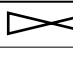
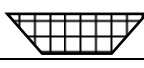
<p>項目名稱： DD46 Lot 815 & 816 S.B RP</p>	<p>圖目： Run-in/out design for vehicular access</p>	<p>圖例：</p>
<p>比例： 1 : 500</p>		<p>●  TS 460 標誌</p>
<p>日期： 22/1/2025</p>	<p>圖號： Figure 6.1</p>	<p> 私家車位 (5mX2.5m)</p>
		<p> 貨物裝卸位 (11mX3.5m)</p>
		<p>.....➔ 車道路線</p>
		<p> 閘門 (闊10米)</p>
		<p> 根據H1113C圖則及相關圖則重置出入口位置</p>
		<p>HONEST LAND SURVEYS COMPANY</p>

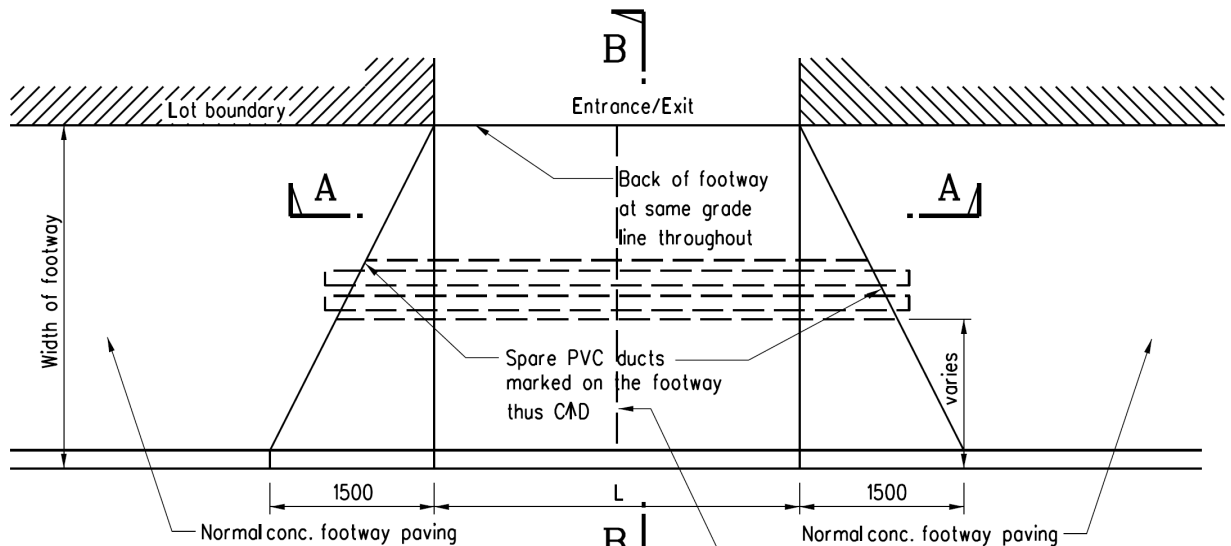

PLAN
N.T.S.

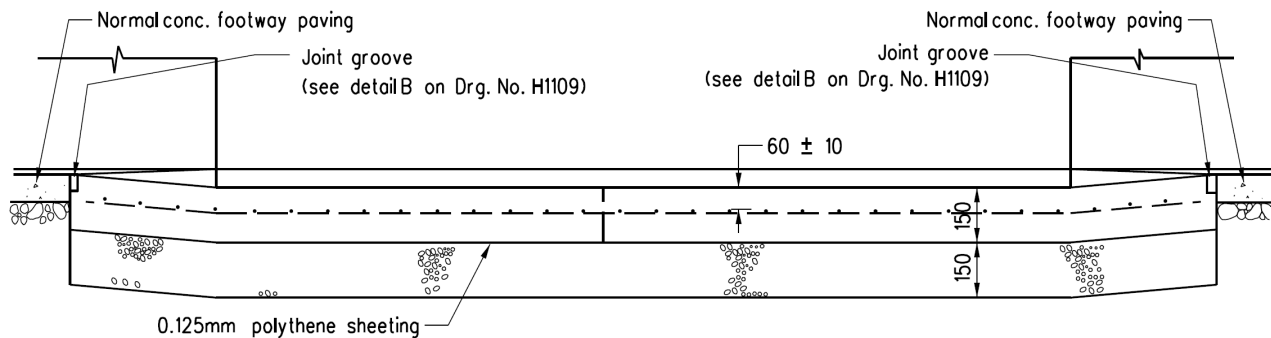

SECTION A - A

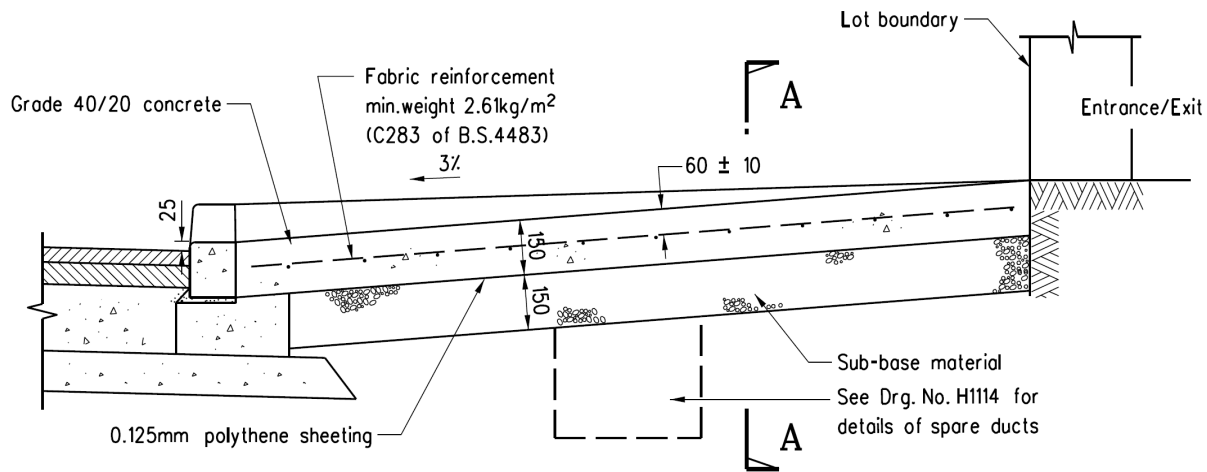

SECTION B - B

Note:

1. All dimensions are in millimetres.

C	General revision	Original signed	Oct 19
B	Joint groove details revised	-	Nov 96
A	Grade of concrete revised	-	Sept 96
	Former Drg. No. H1011A with general revision	-	June 94
REF.	REVISION	SIGNATURE	DATE

**TYPICAL DETAILS
OF RUN-IN
(SHEET 1 OF 2)**

HIGHWAYS DEPARTMENT

REFERENCE	DRAWING No.	CAD
SCALE 1:20	H 1113C	

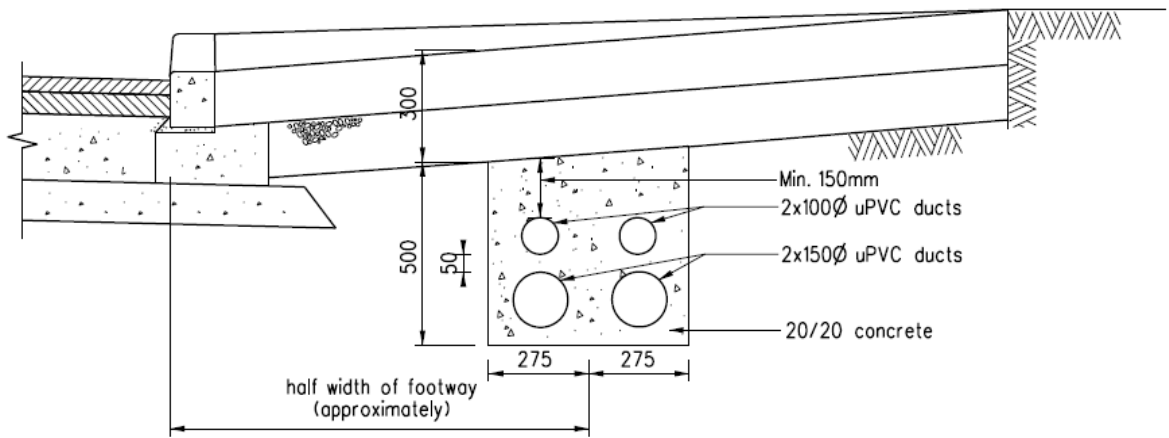

OPTION A

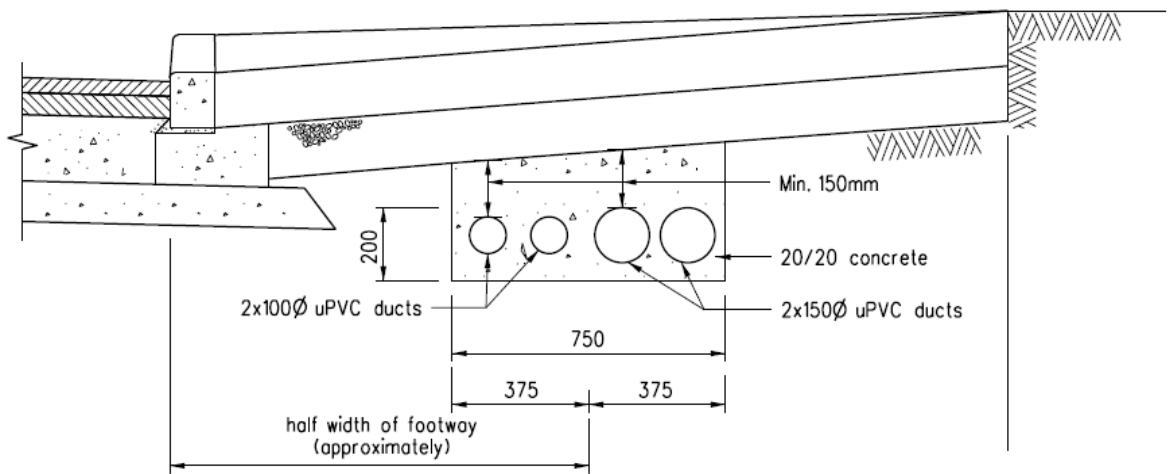

OPTION B

Notes:

1. 100 diameter ducts are provided for cables of ATC or CCTV.
150 diameter ducts are provided for power cables.
2. The choice of option depends on the site situations (e.g. width of footway, existing underground utilities).
3. Position of both ends of the duct bank to be marked on footway thus CAD.

B	General revision	Original signed	Oct 19
A	Concrete cover revised		Sep 96
	Former Drg. No. H1011A with general revision		Jun 94
REF.	REVISION	SIGNATURE	DATE

TYPICAL DETAILS
OF RUN-IN
(SHEET 2 OF 2)

HIGHWAYS DEPARTMENT

REFERENCE	DRAWING No.	CAD
SCALE 1:20	H 1114B	

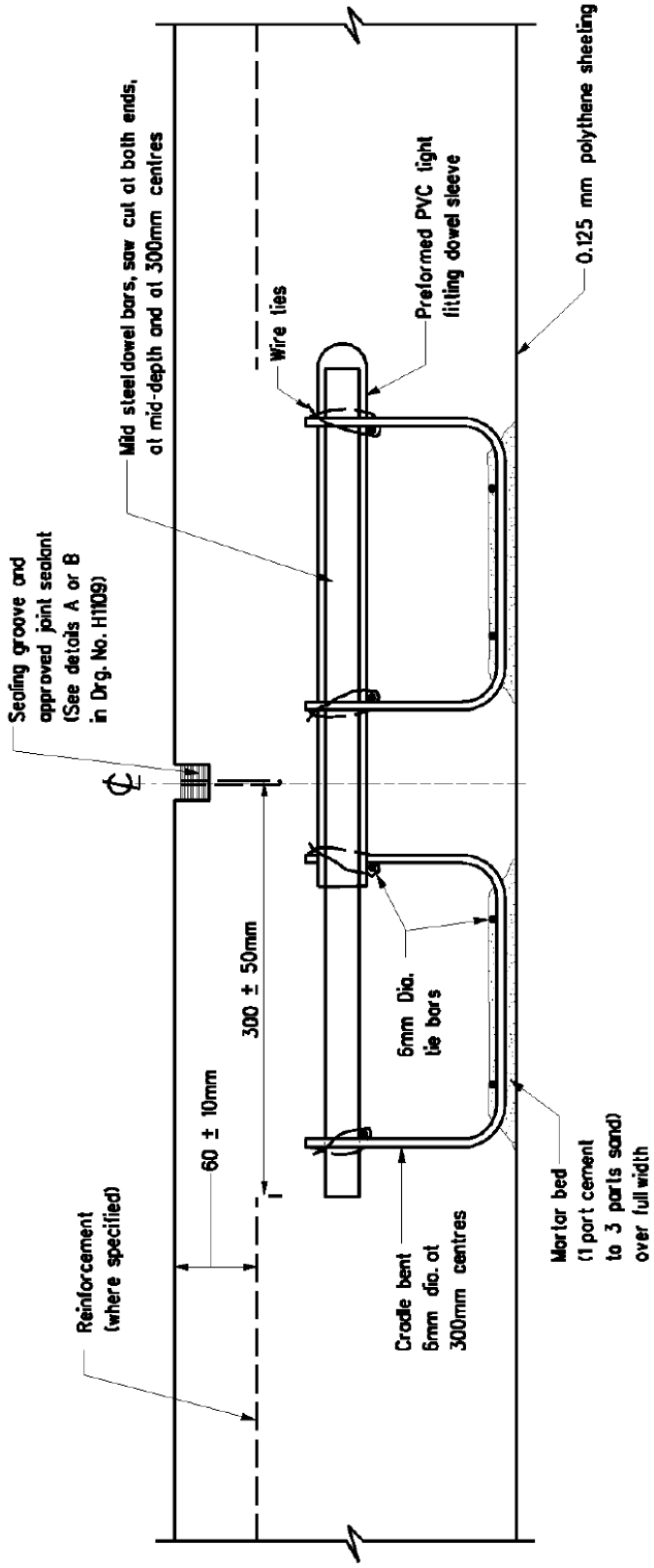

DIMENSIONS OF MILD STEEL DOWEL BARS

Slab thickness (mm)	Dowel bars Dia.(mm)	Dowel bars length(mm)	Sleeve Length(mm)
150 ~ 220	20	650	400
230 and over	25	650	400

* Dowel bars are not recommended for slabs thinner than 150mm

A	Tolerance to dowel length revised	Sept 96
REF.	Former Drg. No. H1003/1 with general revision	June 94
REF.	REVISION	SIGNATURE DATE

HIGHWAYS DEPARTMENT

REFERENCE	DRAWING No.	CAD
SCALE	H 1106A	
	Diagrammatic	

**DETAILS OF CONTRACTION JOINT
IN CONCRETE CARRIAGEWAY**

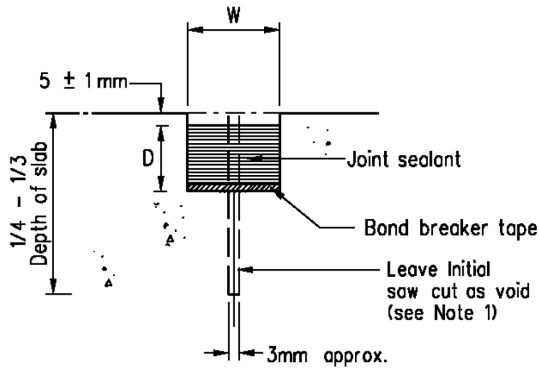

DETAIL A

(Contraction Joint for reinforced slabs)

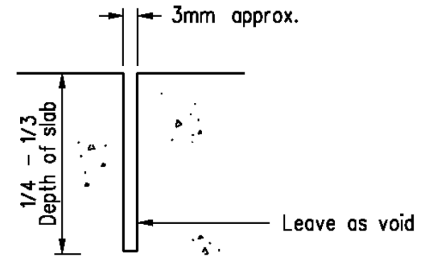

DETAIL B

(Contraction Joint for unreinforced slabs)

Joint spacing (m)	Width W (mm)	Depth D (mm)
Joint spacing \leq 10	10	See Note 2
10 < Joint spacing \leq 15	20	
15 < Joint spacing \leq 20	25	

(FOR DETAIL A ONLY)

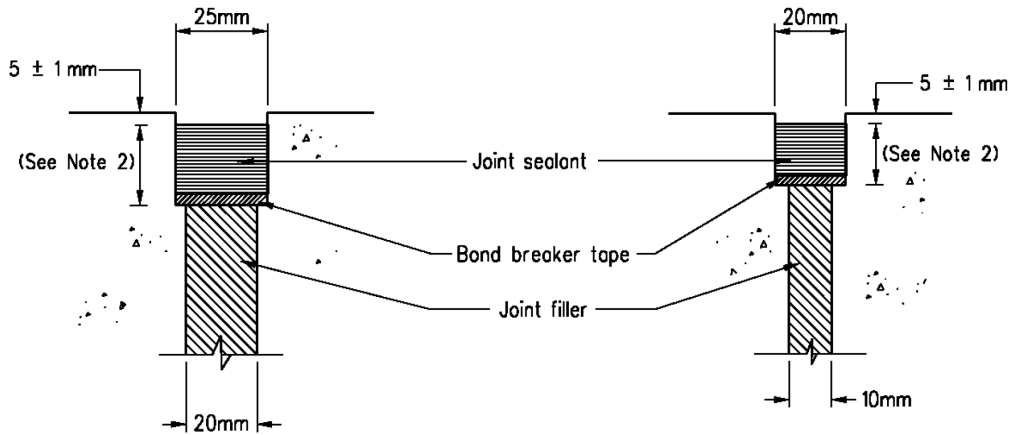

DETAIL C

(Expansion Joint)

DETAIL D

(Isolation Joint)

Notes:

1. Initial saw cut shall be omitted when slabs are not cast through the joint.
2. The depth of the joint sealant and bond breaker tape shall be in accordance with the manufacturer's recommendations.

A	General Revision		June 04
	Former Drg. No. H1004A with general revision		June 94
REF.	REVISION	SIGNATURE	DATE

**DETAILS OF
JOINT GROOVE FOR
TRANSVERSE JOINTS**

HIGHWAYS DEPARTMENT

REFERENCE

DRAWING No.

CAD

SCALE

DIAGRAMMATIC

H 1109A

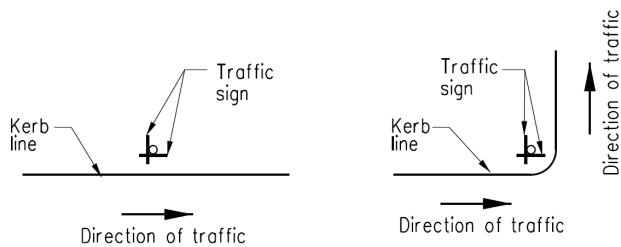
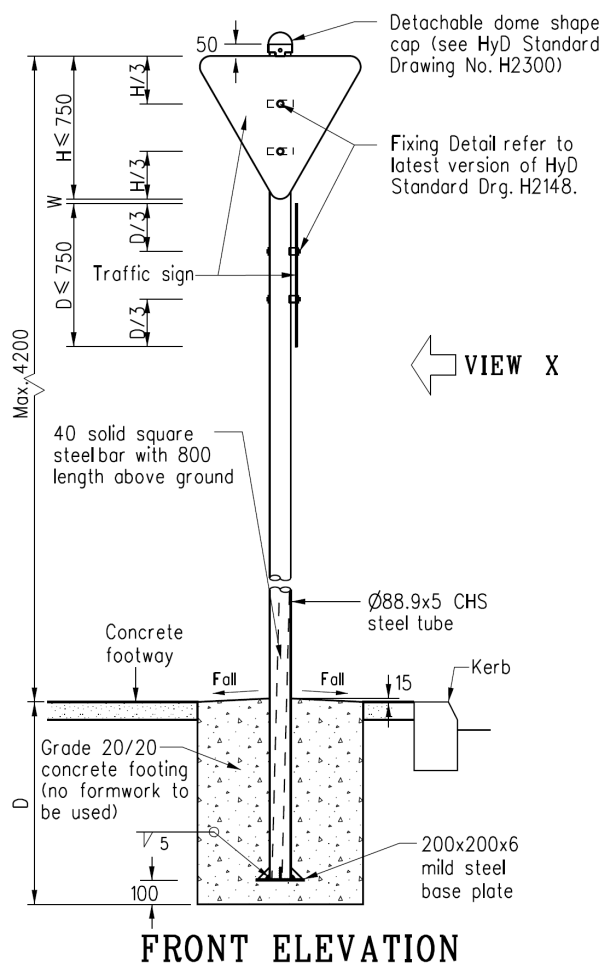
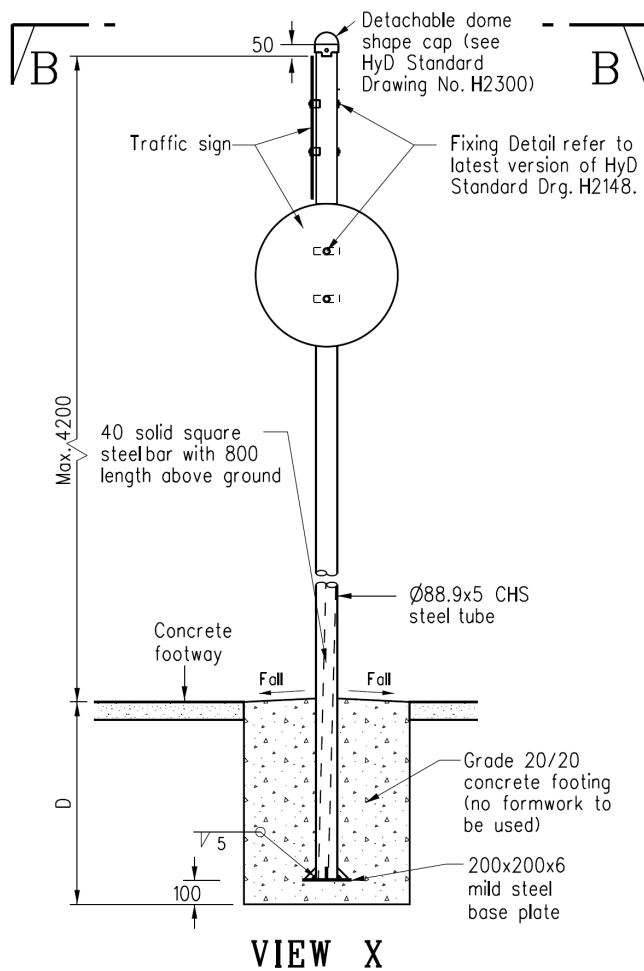

- Notes:
1. Refer to notes 1 to 12 of latest version of HyD Standard Drg. H2228.
 2. Refer to notes 2, 4 and 8 of latest version of HyD Standard Drg. H2230.
 3. No. of traffic signs mounted at single post can be varied to suit actual situation.
 4. The mounting height of traffic sign shall refer to TPDM Vol.3 Clause 2.2.3.1.
 5. The 40 solid square steel bar shall be placed freely on the mild steel base plate inside the steel tube.

B	Detachable dome shape cap added and other general revisions	Original signed	Feb 19
A	Note 4 and 40 solid square post added.	-	May 18
	New Issue	-	Jan 11
REF.	REVISION	SIGNATURE	DATE

**SINGLE POST MULTI-SIGN
SUPPORT FOR TRAFFIC SIGNS
PERPENDICULAR TO EACH OTHER
(CENTRE - MOUNTED)**

HIGHWAYS DEPARTMENT		
REFERENCE	DRAWING No.	CAD
SCALE	H 2268B	
NOT TO SCALE		