

LOCATION PLAN

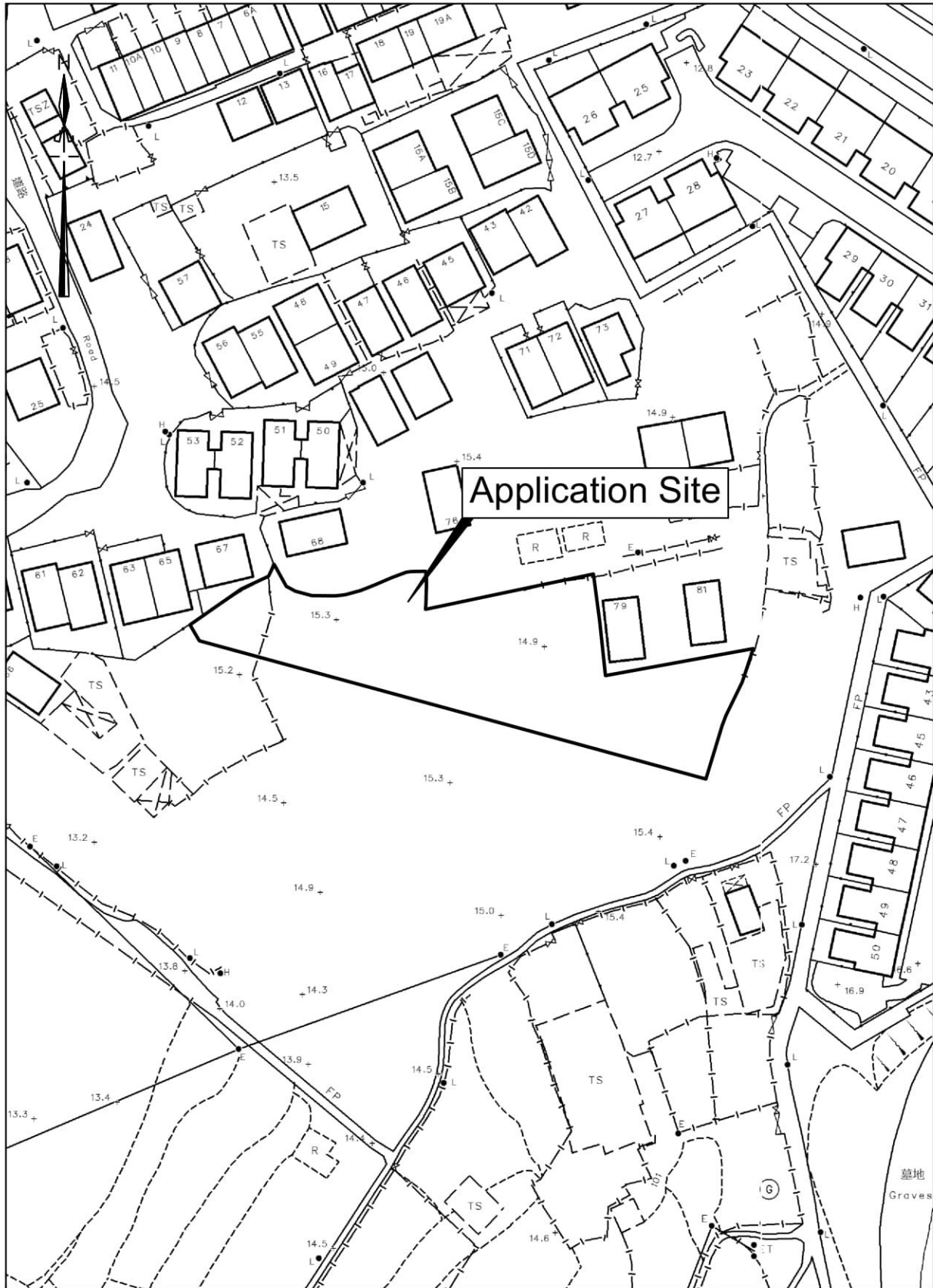

卓 弘 測 量 服 務 公 司
CHUO WANG SURVEY SERVICES COMPANY

1/F, Block A, Wo Tai Building, No. 2-24, Wo Tai Street,
Luen Wo Hui, Fanling, N.T.

Telephone : 26831600 Mobile : 66862836 Fax : 26831380
E-mail - chuowang.ssc@gmail.com / h.y.pang@hotmail.com

Scale : 1 : 1000

Survey Sheet No. : 3-SW-11B
3-SW-12A

Date : June 2024

LAYOUT PLAN

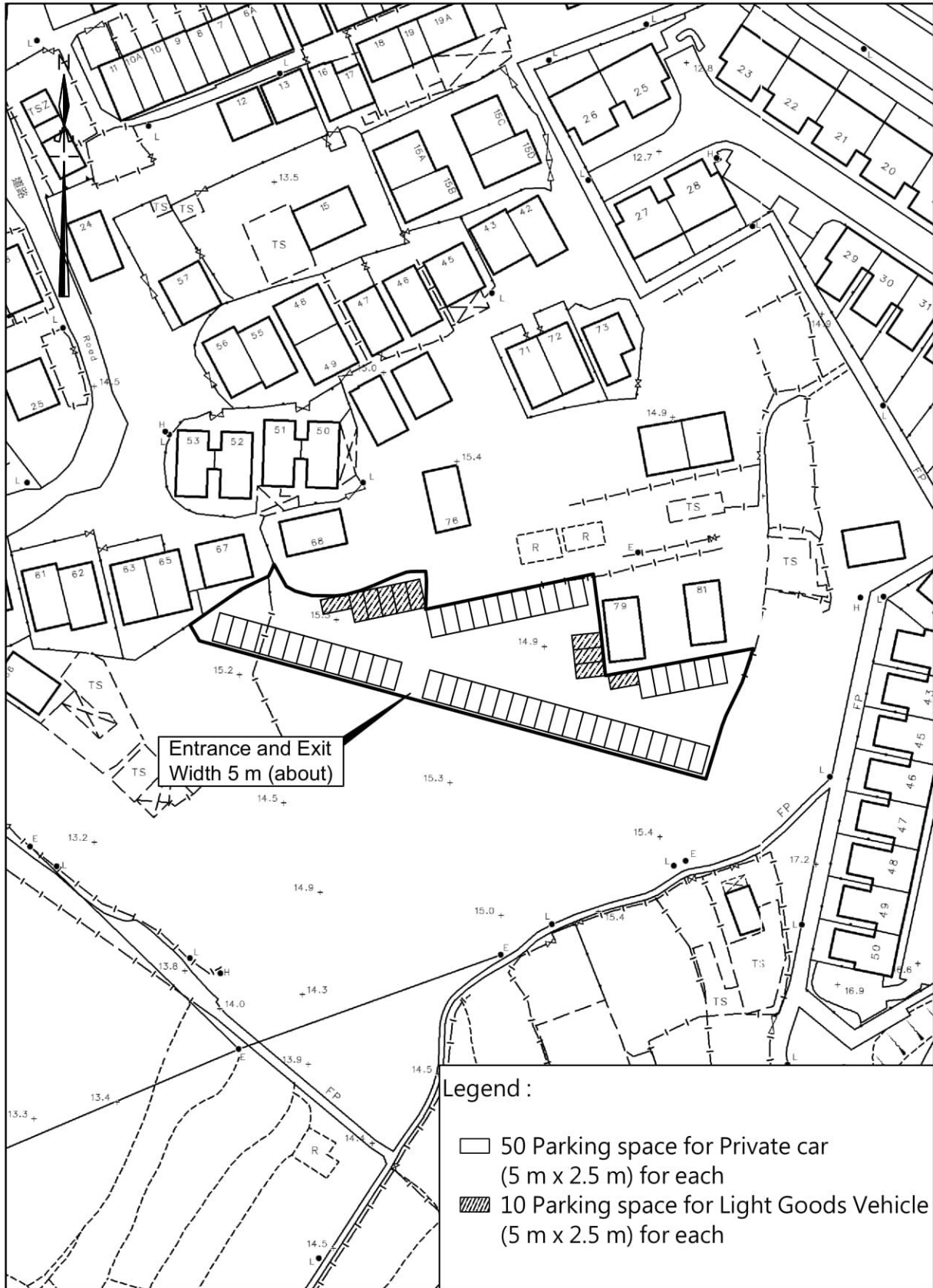

卓 弘 測 量 服 務 公 司
CHUO WANG SURVEY SERVICES COMPANY

1/F, Block A, Wo Tai Building, No. 2-24, Wo Tai Street,
Luen Wo Hui, Fanling, N.T.

Telephone : 26831600 Mobile : 66862836 Fax : 26831380
E-mail - chuowang.ssc@gmail.com / h.y.pang@hotmail.com

Scale : 1 : 1000

Survey Sheet No. : 3-SW-11B
3-SW-12A

Date : June 2024

ACCESS PLAN

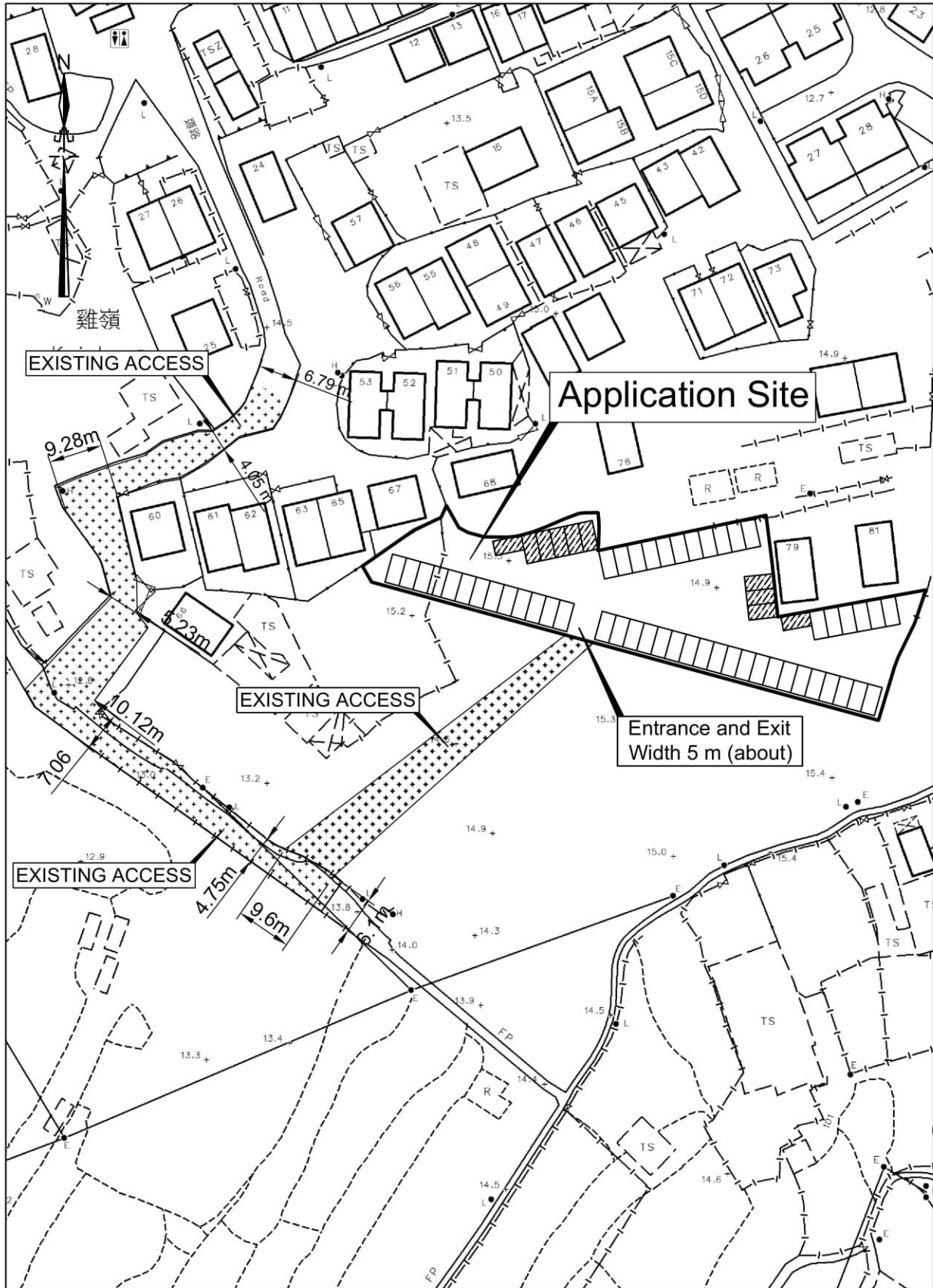

卓 弘 測 量 服 務 公 司
CHUO WANG SURVEY SERVICES COMPANY

1/F, Block A, Wo Tai Building, No. 2-24, Wo Tai Street,
Luen Wo Hui, Fanling, N.T.

Telephone : 26831600 Mobile : 66862836 Fax : 26831380
E-mail - chuowang.ssc@gmail.com / h.y.pang@hotmail.com

Scale : 1 : 1000

Survey Sheet No. : 3-SW-11B

3-SW-12A

Date : June 2024

ROUTING PLAN



卓 弘 測 量 服 務 公 司
CHUO WANG SURVEY SERVICES COMPANY

1/F, Block A, Wo Tai Building, No. 2-24, Wo Tai Street,
 Luen Wo Hui, Fanling, N.T.

Telephone : 26831600 Mobile : 66862836 Fax : 26831380
 E-mail - chuowang.ssc@gmail.com / h.y.pang@hotmail.com

Scale : 1 : 1000

Survey Sheet No. : 3-SW-11B

3-SW-12A

Date : June 2024

LEGEND :

- Lot Boundary
- Proposed 225 mm U - Channel with cast iron grating
- Proposed Catchpit with sand trap and with cast iron cover
- Existing Catchpit
- Existing U-Channel
- Stormwater Fall Direction
- +16.15 Spot Level (mPD)

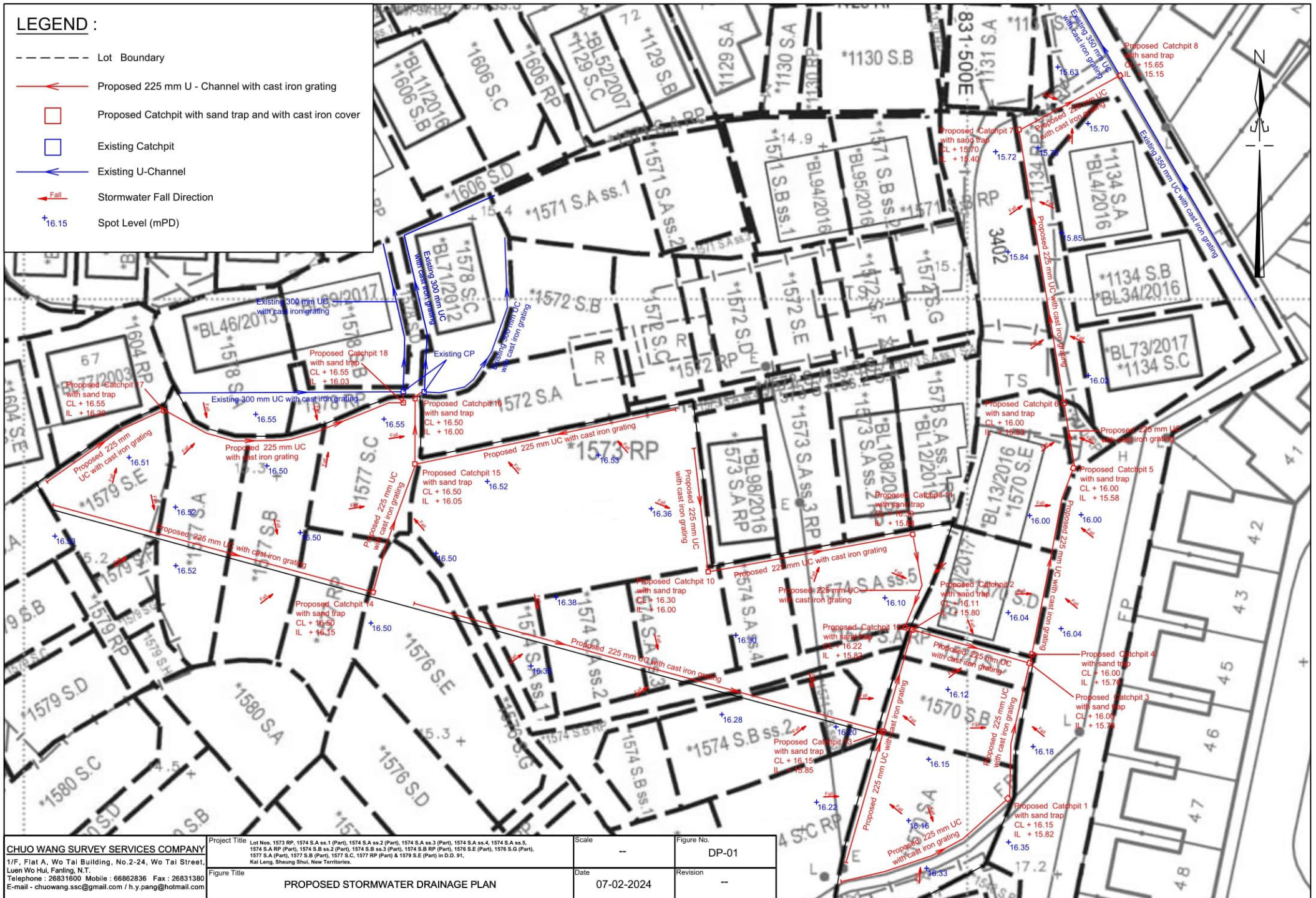

CHUO WANG SURVEY SERVICES COMPANY
 11/F, Flat A, Wo Tai Building, No.2-24, Wo Tai Street,
 Luen Wo Hui, Fanling, N.T.
 Telephone : 26831600 Mobile : 68682836 Fax : 26831380
 E-mail - chuowang.ssc@gmail.com / h.y.pang@hotmail.com

Project Title	Lot Nos. 1573 RP, 1574 S.A ss.1 (Part), 1574 S.A ss.2 (Part), 1574 S.A ss.3 (Part), 1574 S.A ss.4, 1574 S.A ss.5, 1574 S.A RP (Part), 1574 S.B ss.2 (Part), 1574 S.B ss.3 (Part), 1574 S.B RP (Part), 1574 S.B S.O (Part), 1575 S.A (Part), 1575 S.B (Part), 1575 S.C, 1575 RP (Part) & 1579 S.E (Part) in D.D. 91, Kai Leng, Sheung Shui, New Territories.
Figure Title	PROPOSED STORMWATER DRAINAGE PLAN

Scale	--	Figure No.	DP-01
Date	07-02-2024	Revision	--

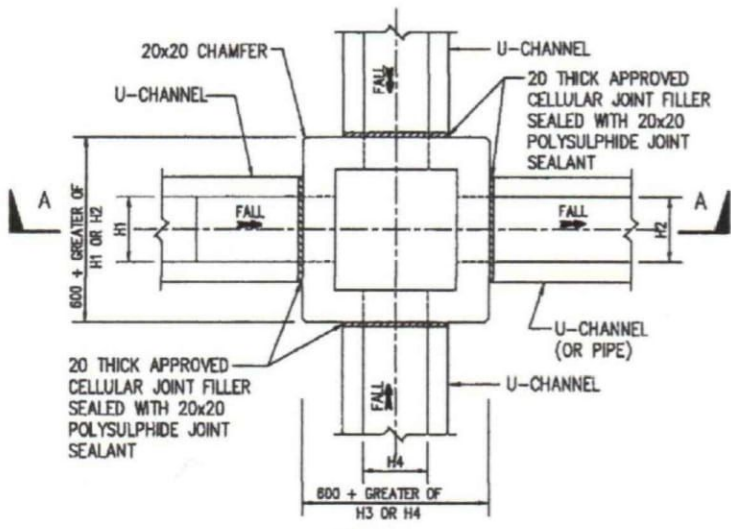

PLAN

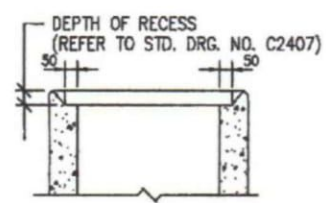

ALTERNATIVE TOP SECTION FOR PRECAST CONCRETE COVER

STANDARD CATCHPIT DETAILS

(ACCORDING TO CEDD'S DRAWING NO. C2405I & 2406I)

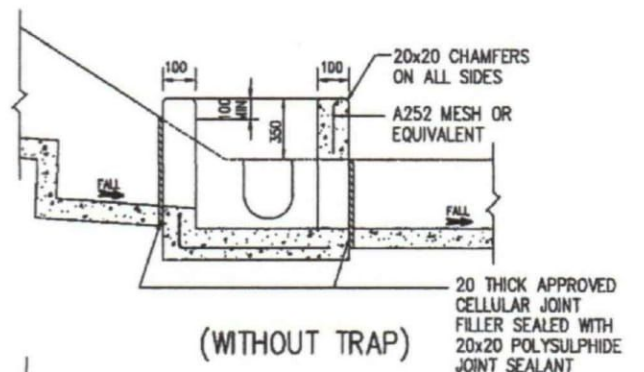

(WITHOUT TRAP)

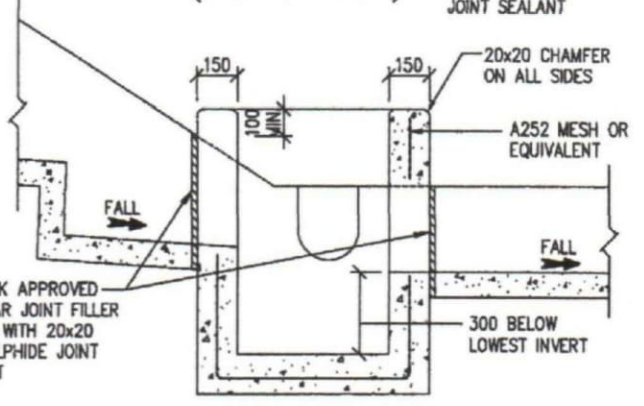

(WITH TRAP)

NOTES SECTION A - A

- (1) ALL DIMENSIONS ARE IN MILLIMETRES.
- (2) SIZE - DEPTH : $D \leq 750$
WIDTH : $W \geq 3B$
LENGTH : $L = 4.8D^{0.67} h^{0.5} F^{-0.5} > 4B$
- (3) GRADED STONE FILTER SHALL BE CRUSHER RUN GRANITE AGGREGATE.
- (4) THE SANDTRAP SHALL BE REGULARLY DESILTED TO AVOID BLOCKAGE.

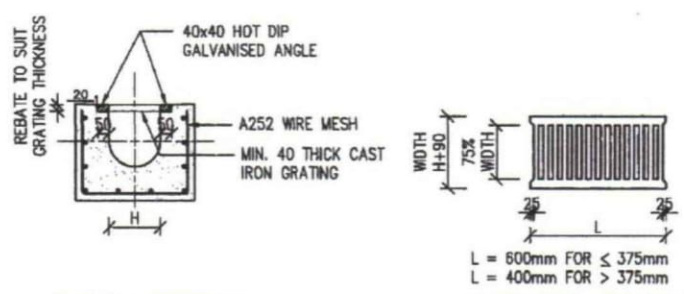

TYPICAL SECTION CAST IRON GRATING

U-CHANNEL WITH CAST IRON GRATING (UP TO H OF 525) (ACCORDING TO CEDD'S DRAWING NO. C2412E)

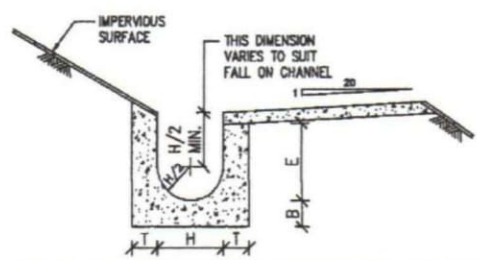

NOMINAL SIZE (H)	T	B	REINFORCEMENT
225-300	80	100	A252 MESH PLACED CENTRALLY AND T=100
375-600	100	150	WHEN E>650
675-900	100	150	A252 MESH PLACED CENTRALLY

TYPICAL U-CHANNEL DETAILS (ACCORDING TO CEDD'S DRAWING NO. C2410G) N.T.S.

NOTES FOR U-CHANNEL

1. THE COVER OF PROPOSED U-CHANNEL SHALL BE FLUSH WITH THE PATH SURFACE AND ANY HOLE IN SUCH COVER SHALL NOT EXCEED 20mm IN ONE DIMENSION.
2. CAST IRON GRATINGS TO BE USED SHALL BE COMPLIANCE WITH BS 437:2008.

Proposed Fire Service Installation

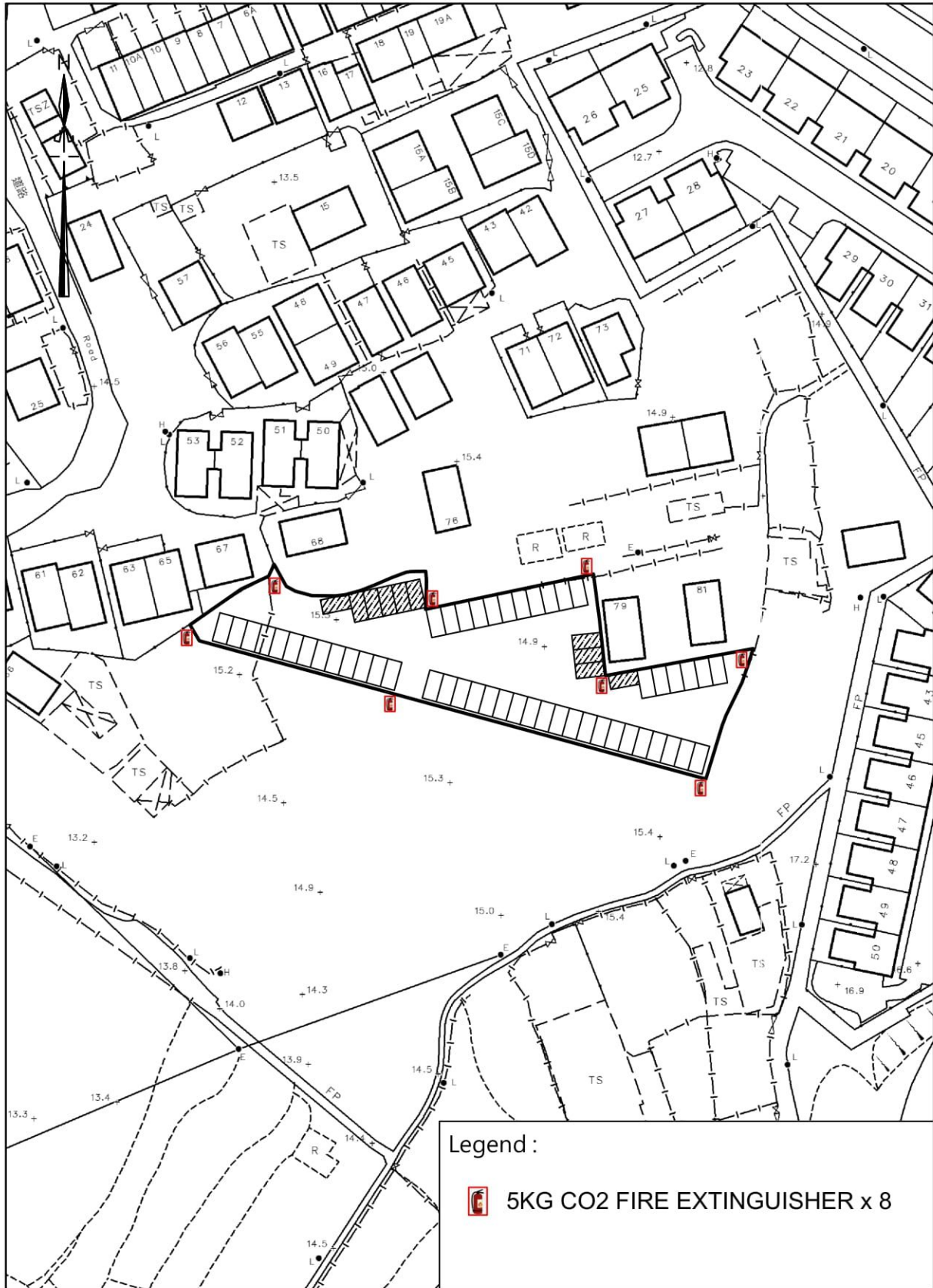

卓 弘 測 量 服 務 公 司
CHUO WANG SURVEY SERVICES COMPANY

1/F, Block A, Wo Tai Building, No. 2-24, Wo Tai Street,
Luen Wo Hui, Fanling, N.T.

Telephone : 26831600 Mobile : 66862836 Fax : 26831380
E-mail - chuowang.ssc@gmail.com / h.y.pang@hotmail.com

Scale : 1 : 1000

Survey Sheet No. : 3-SW-11B
3-SW-12A

Date : June 2024