

**Planning Application under Section 16 of Town Planning Ordinance for  
Public Utility Installation (Radio Base Station) and Excavation of Land on Government  
land, near Lin Ma Hang Road, Pak Fu Shan, New Territories**

**Executive Summary**

This planning application is prepared on behalf of the Applicant to seek planning permission from the Town Planning Board (“the Board”) for the installation of a Radio Base Station (the “RBS”) and Excavation of Land on Government land, near Lin Ma Hang Road, Pak Fu Shan, New Territories (the “Application Site”)

The Application Site is situated within an area zoned as “Green Belt” use on the Ta Kwu Ling North Outline Zoning Plan (No. S/NE-TKLN/2). RBS is classified as “Public Utility Installation” use under the OZP which is a Column 2 use in this zone.

The proposal includes a total Application Site area of about 6.98 s.m. included excavation of land of 5 s.m. for 0.6m depth. The maximum height of the RBS is about 1.6 m.

The proposed RBS will significantly enhance the mobile phone signal along the border and the user experience of locals and HKPF, especially in case of emergency. Also, there will be no adverse environmental impact during the construction and operation of the proposed RBS. The proposed RBS will not cause adverse visual impacts.

We sincerely hope the Board would consider the application favourably.

根據城市規劃條例第 16 條的規劃許可申請  
公用事業設施裝置 (無線電發射站)及挖土工程  
新界白虎山近蓮麻坑路政府土地

行政摘要

本規劃許可申請為代表申請人提出，以徵求城市規劃委員會（下稱「城規會」）批准於新界白虎山近蓮麻坑路政府土地（下稱「有關用地」）上安裝無線電發射站（下稱為「無線電發射站」）。

有關用地於《打鼓嶺北分區計劃大綱圖編號 S/NE-TKLN/2》劃作為「綠化地帶」。無線電發射站在大綱圖下歸類為第二欄中的公用事業設施裝置用途。

是次申請的地盤面積為約 6.98 平方米當中包括 5 平方米的挖土工程(0.6 米深)。無線電發射站的最高高度約為 1.6 米。

擬議的無線電發射站將大幅提升沿著邊界地區範圍的電話接收信號，以及附近用戶及香港警務處，尤其是在緊急情況下，的用戶體驗。另外，擬議的無線電發射站在施工及日後運作上均不會對周邊環境造成不良影響。擬議的無線電發射站不會造不良的視覺影響。

我們真誠希望城規會能極考慮准許是項申請。

**Planning Application under Section 16 of Town Planning Ordinance for  
Public Utility Installation (Radio Base Station) and Excavation of Land on Government  
land, near Lin Ma Hang Road, Pak Fu Shan, New Territories**

**Supporting Planning Statement**

**1. Background**

To improve the mobile phone signal coverage near boarder and vicinity area, the SmarTone Mobile Communications Limited (“SMT”) (the “Applicant”) and Hong Kong Police Force (“HKPF”) propose to install Radio Base Stations (the “RBS”) at Government land, near Lin Ma Hang Road, New Territories (the “Application Site”).

The Application Site is on government land near Lamp Pole Nos.258A and 254A, which is within an area zoned as “Green Belt” in Ta Kwu Ling North Outline Zoning Plan No. S/NE-TKLN/2 (“OZP”).

RBS is classified as “Public Utility Installation” use under the OZPs which is a Column 2 use in the Green Belt zone.

The proposed RBS will significantly enhance the mobile phone signal in the local area and the user experience of locals and HKPF, especially in case of emergency.

**2. Proposed Radio Base Station and Antennas**

The proposal includes a total Application Site area of around 6.98 s.m. The maximum height of the equipment is around 1.6m above ground level. Please refer to *Appendix 1* for the proposed location.

Details of the proposed installation are listed below for easy reference:-

<b><u>Item</u></b>	<b><u>Equipment Type (no.)</u></b>	<b><u>Dimension (each)</u></b>	<b><u>Area (s.m.)</u></b>
(1)	Equipment Set A on Concrete Plinth	2m (W) x 0.55m (L) x 1.35m (H) (rectangular shaped)	1.1
(2)	Equipment Set B on Concrete Plinth	1.6m (W) x 0.55m (L) x 1.35m (H) (rectangular shaped)	0.88
(3)	Underground Pipe	0.5m (W) x 10m (L) x 0.6m (depth)	5

		(excavation of land)	
Total Area:			6.98

Please refer to **Appendices 2 & 3** for the installation layout and existing site photos.

Antennas (dimension : 0.419m (W) x 0.203m (L) x 1.64m (H) each) for the RBS are proposed to be installed on the existing lamp poles adjoining to the equipment (Lamp Pole No.258A). As the antennas are attached to existing structure (i.e. lamp poles), they are considered as “telecommunication radio base station” which is always permitted use according to the covering notes of the OZPs. Therefore, the antennas shown on the layout plan are not included in the subject application and is for information only.

Apart from the SMT, if required by Office of the Communications Authority, the subject RBS will be shared to other local telecommunication operators.

For the proposed of laying underground cable, excavation of land of 5 s.m. with 0.6m depth is required.



### 3. **Justification**

#### Objective of the proposed RBS

The area of along the border and vicinity areas are from time to time suffer from weak mobile phone signal which would severely affect daily life and to the worst danger in life. The proposed RBS, which aims to enhance mobile phone signal so as to provide a higher quality and more reliable mobile phone services to local area, will greatly enhance the user experience of HKPF, local visitor, and provide a more stable connection in case of emergency. The proposed signal coverage of the RBS is attached in *Appendix 4*.

#### No adverse environmental impacts and minor visual impacts

The Application Site is currently a vacant land and does not fall within any environmentally sensitive areas. The proposed RBS will be installed on existing lamp pole and small equipment unit will be installed adjoining land. No trees and natural environment and visual field will be affected by the construction works and the operation of the proposed RBS. The proposed RBS would not higher than the nearby trees, therefore would not cause adverse visual impacts.

#### No adverse comment from other government departments

This RBS proposal has circulated to Architectural Services Department, Electrical and Mechanical Service Department, Lands Department, Hong Kong Police Force, Planning Department, Office of the Communications Authority, all departments do not have adverse comments on the proposal. The department's replies are attached in *Appendix 5*.



深圳河

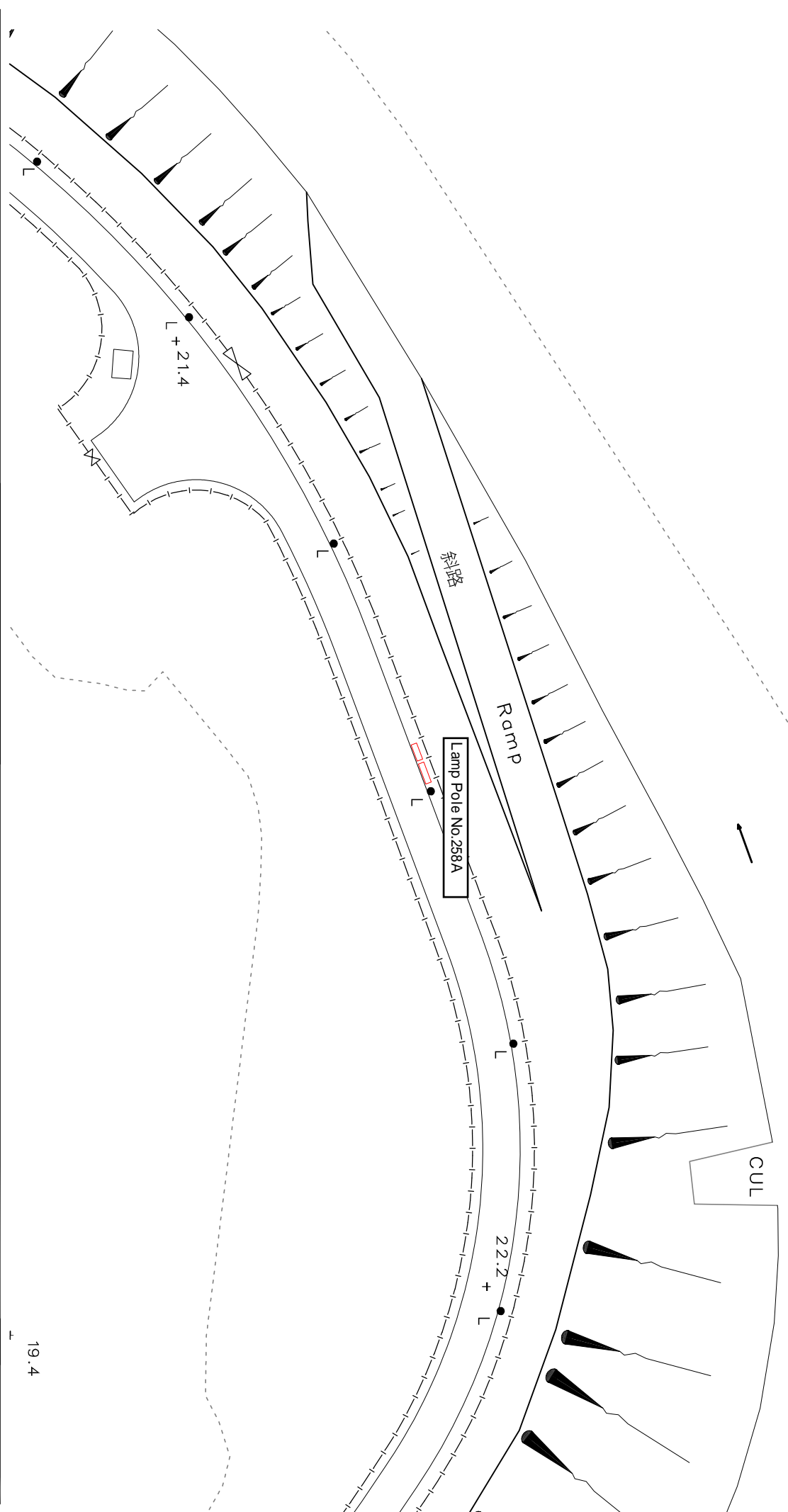

1	24/9/2024	1ST SUBMISSION	CLIENT:	Smartone	CONSULTANT:	PROJECT TITLE :	SCALE : 1 : 500 (A4)
REV/NO:	DATE	DESCRIPTION			測 行 PREUDENTIAL SURVEYORS INTL. LTD.	Public Utility Installation (Radio Base Station) and Excavation of Land on Government land, near Lin Ma Hang Road, Pak Fu Shan, New Territories	DRAWING NO. B8435-S3



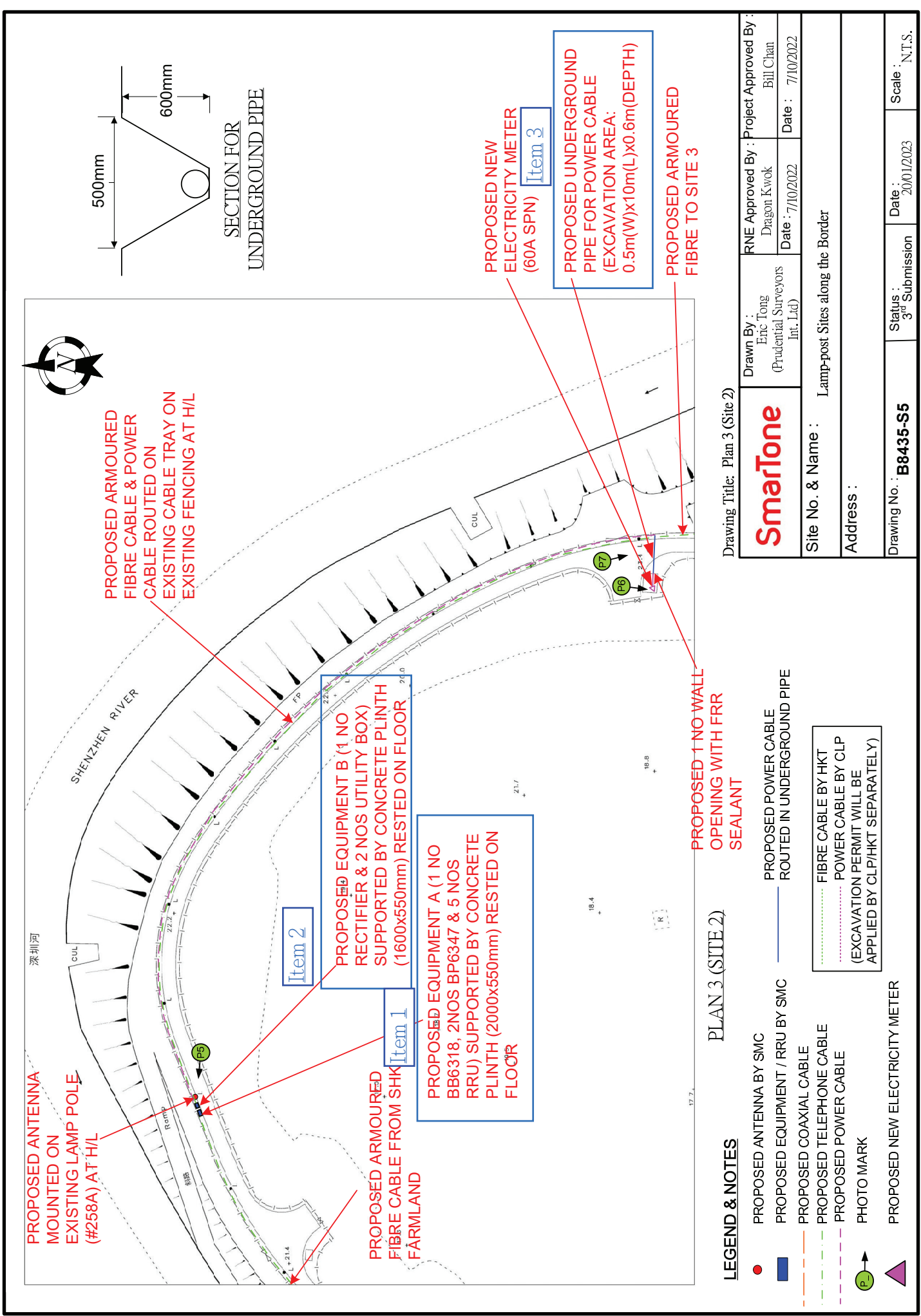

Drawing Title: Plan 3 (Site 2)

**Smartone**

Drawn By : Eric Tong (Prudential Surveyors Int. Ltd)	RNE Approved By : Dragon Kwok	Project Approved By : Bill Chan
Date : 7/10/2022	Date : 7/10/2022	Date : 7/10/2022

Site No. & Name : Lamp-post Sites along the Border

Address :

Drawing No. : <b>B8435-S5</b>	Status : 3 <sup>rd</sup> Submission	Date : 20/01/2023	Scale : N.T.S.
-------------------------------	--	-------------------	----------------

**LEGEND & NOTES**

- PROPOSED ANTENNA BY SMC
- PROPOSED EQUIPMENT / RRU BY SMC
- PROPOSED COAXIAL CABLE
- PROPOSED TELEPHONE CABLE
- PROPOSED POWER CABLE
- ▲ PHOTO MARK
- ▲ PROPOSED NEW ELECTRICITY METER
- PROPOSED ANTENNA BY HKT
- PROPOSED POWER CABLE BY CLP (EXCAVATION PERMIT WILL BE APPLIED BY CLP/HKT SEPARATELY)
- PROPOSED POWER CABLE ROUTED IN UNDERGROUND PIPE

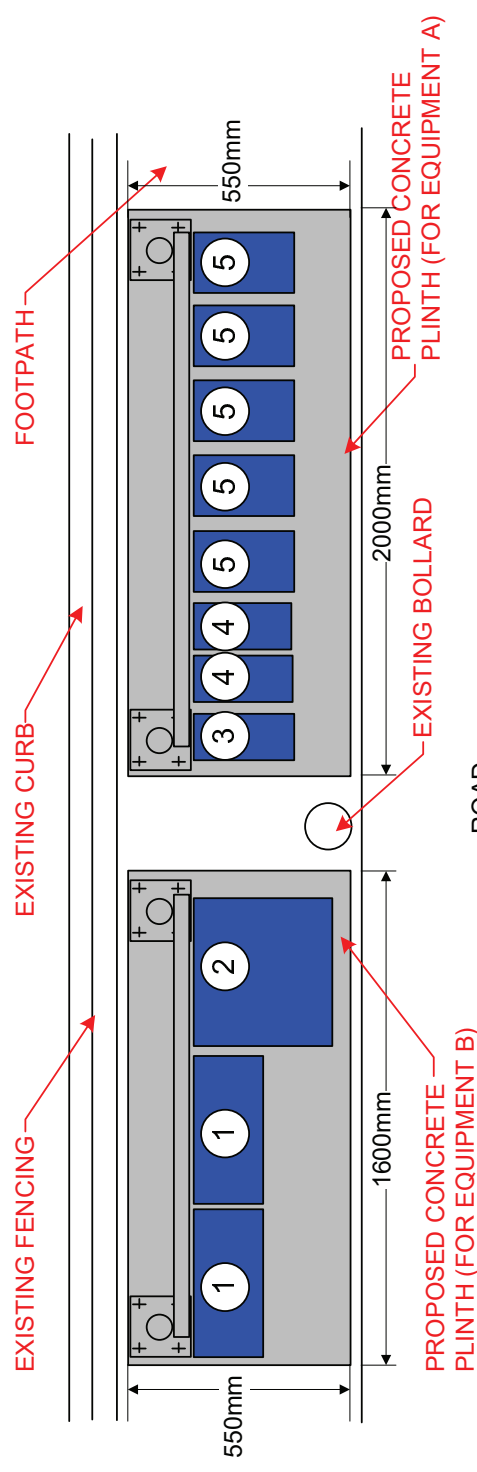

LAYOUT PLAN FOR EQUIPMENT A & B

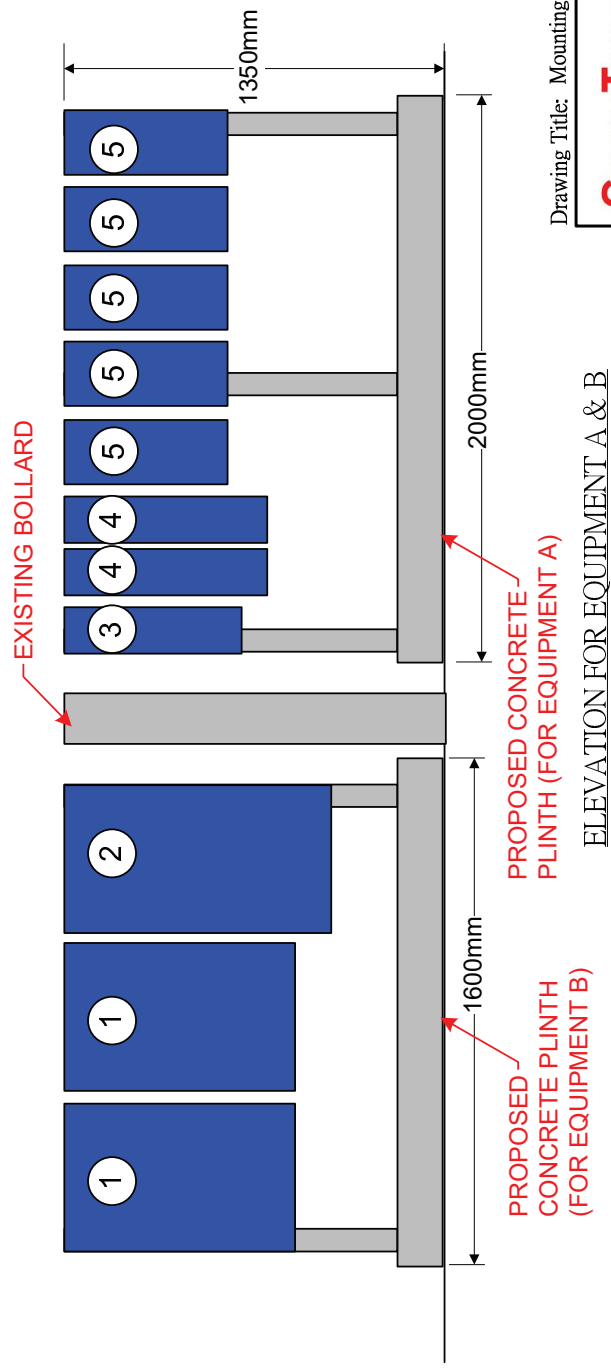

ELEVATION FOR EQUIPMENT A & B

NO.	EQUIPMENT	SIZE AND WEIGHT
1	UTILITY BOX	400(W)X200(D)X600(H) 50KG
2	RECTIFIER	550(W)X450(D)X750(H) 50KG
3	BB6318	123(W)X350(D)X420(H) 16KG
4	RP6347	103(W)X387(D)X507(H) 50KG
5	RRU4415	160(W)X342(D)X420(H) 21KG

Drawing Title: Mounting Details for Equipment A & B

<b>Smartone</b> Drawn By : Eric Tong (Prudential Surveyors Int. Ltd)	RNE Approved By : Dragon Kwok	Project Approved By : Bill Chan
	Date : 7/10/2022	Date : 7/10/2022
Site No. & Name : Lamp-post Sites along the Border		
Address :		

Drawing No. : <b>B8435-S7</b>	Status : 3 <sup>rd</sup> Submission	Date : 20/01/2023	Scale : N.T.S.
-------------------------------	--	----------------------	-------------------

MOUNTING DETAILS FOR EQUIPMENT A & B

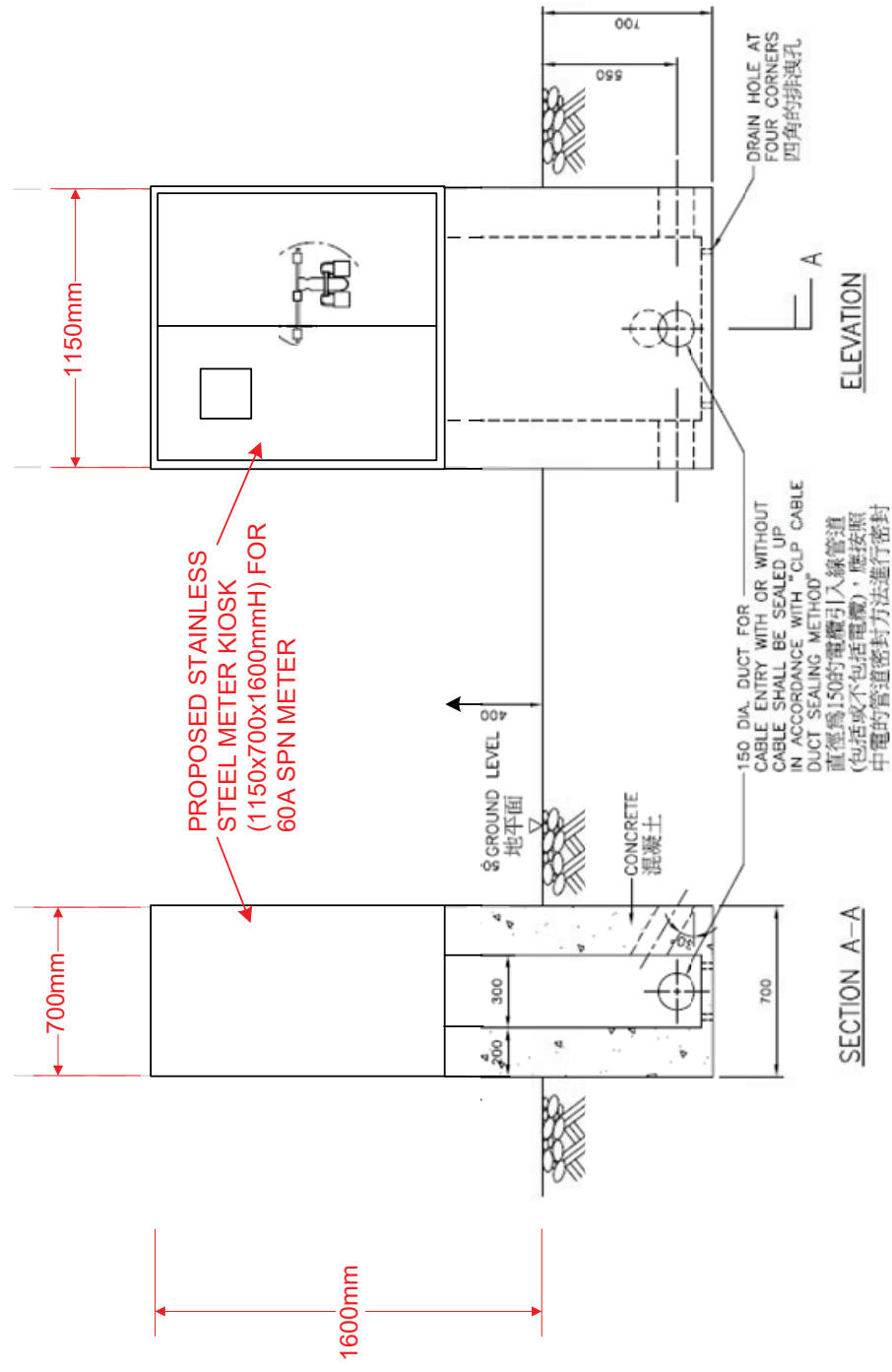

MOUNTING DETAILS FOR METER KIOSK  
 (SIZE OF KIOSK: 1.15m(W)x0.7m(D)x1.6m(H))  
 (LOCATION OF KIOSK IS WITHIN THE FENCE ROAD)

Drawing Title: Mounting Details for Meter Kiosk

<b>Smartone</b>	Drawn By : Eric Tong (Prudential Surveyors Int. Ltd)	RNE Approved By : Dragon Kwok	Project Approved By : Bill Chan
	Date : 7/10/2022	Date : 7/10/2022	Date : 7/10/2022
Site No. & Name : Lamp-post Sites along the Border			
Address :			
Drawing No. : <b>B8435-S9</b>	Status : 3 <sup>rd</sup> Submission	Date : 20/01/2023	Scale : N.T.S.

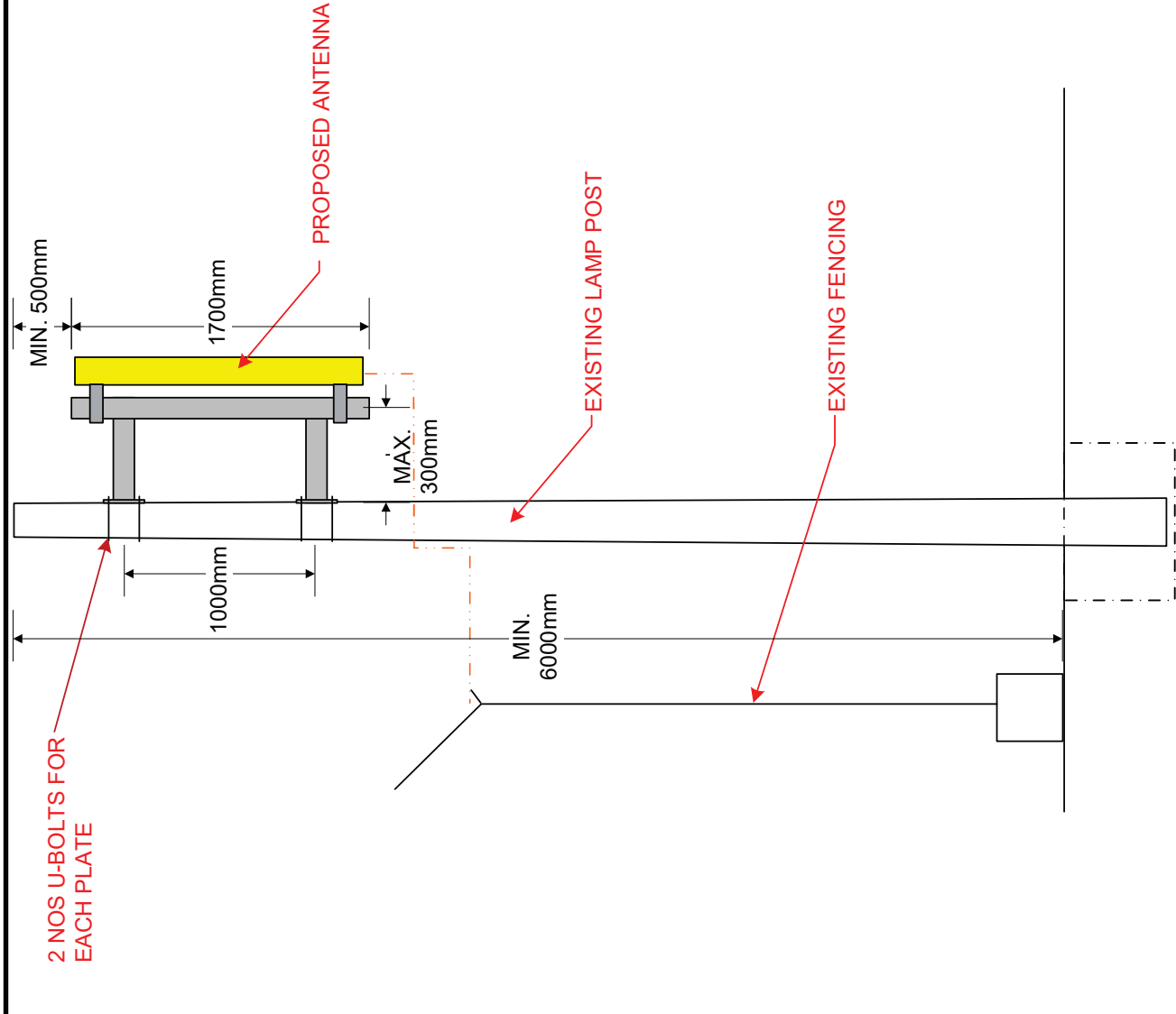

ANTENNA MODEL	SIZE AND WEIGHT
A+P_6419	419(W)X203(D)X1640(H) 35KG

Drawing Title: Mounting Details for Antenna on Existing Lamp Post

<b>Smartone</b>	Drawn By : Eric Tong (Prudential Surveyors Int. Ltd)	RNE Approved By : Dragon Kwok	Project Approved By : Bill Chan
	Date : 7/10/2022	Date : 7/10/2022	Date : 7/10/2022

Site No. & Name : Lamp-post Sites along the Border

Address :

Drawing No. : <b>B8435-S10</b>	Status : 3 <sup>rd</sup> Submission	Date : 20/01/2023	Scale : N.T.S.
--------------------------------	--	-------------------	----------------

MOUNTING DETAILS FOR ANTENNA ON LAMP POST



PROPOSED ARMoured  
FIBRE CABLE FROM SHK  
FARMLAND



Photo 4 (WITHIN THE FENCE ROAD)

PHOTOS FOR LEAD-IN FIBRE CABLE

ANTENNA

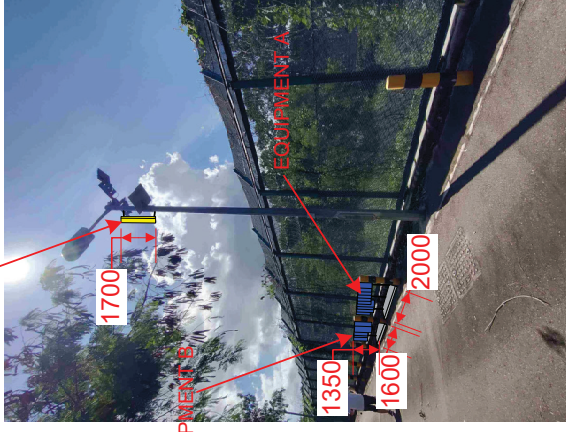

Photo 5 (WITHIN THE FENCE ROAD)

PHOTOS FOR SITE 2

NEW 60A SPN CLP  
ELECTRICITY METER IN  
SWITCH ROOM NO. 6



Photo 6 (WITHIN THE FENCE ROAD)

**LEGEND &**

- PR( ● )
- PR( ■ )
- PR( — )
- PR( - - - )
- PR( - · - · )
- PH( ⊕ )
- PR( ▲ )

Drawing Title: Photos for Lead-in Fibre Cable and Site 2

<b>Smartone</b>	Drawn By : Eric Tong (Prudential Surveyors Int. Ltd)	RNE Approved By : Dragon Kwok	Project Approved By : Bill Chan
	Date : 7/10/2022	Date : 7/10/2022	Date : 7/10/2022
Site No. & Name : Lamp-post Sites along the Border			
Address :			
Drawing No. : <b>B8435-S12</b>	Status : 3 <sup>rd</sup> Submission	Date : 20/01/2023	Scale : N.T.S.

IPE

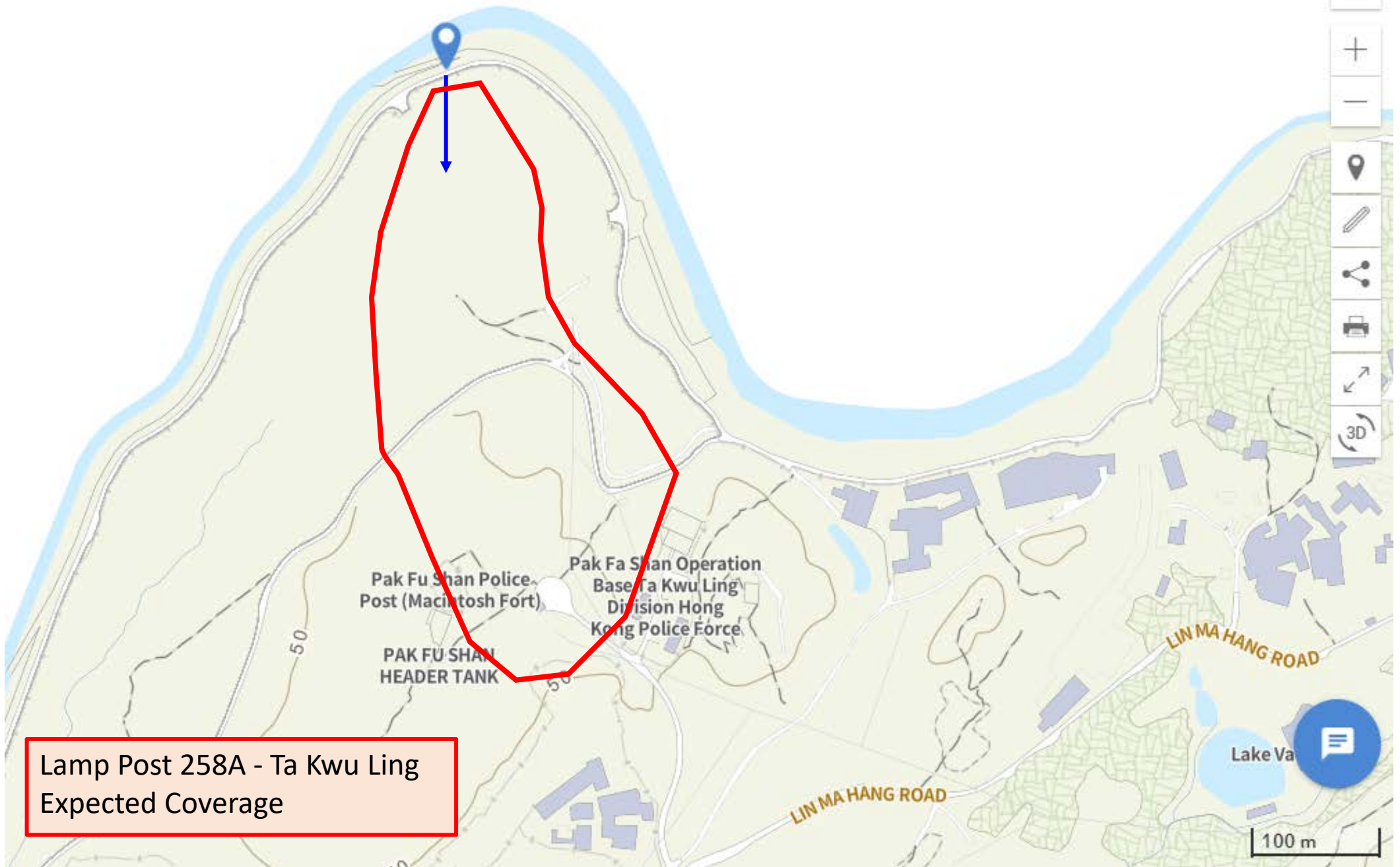

Lamp Post 258A - Ta Kwu Ling  
Expected Coverage

**From:** Siu Yee YUNG <siuyee-yung@ofca.gov.hk>  
**Sent:** Friday, October 21, 2022 9:54 AM  
**To:** YC Lee  
**Cc:** S LEE; Frankie Pang; Dragon Kwok  
**Subject:** Re: Provision of Mobile Services on lamppost at Frontier Closed Area.

**CAUTION : If you don't know the EXTERNAL sender, don't click on any link/attachment or reply to this Email.**

Dear YC,

I refer to your technical proposal of setting up the Radio Base Station (RBS) at the Frontier Closed Area as mentioned in your email of 2 September 2022 and HKPF's support of your proposal on 19 October 2022 at the HKPF's land allocation within the fence road where SmarTone's equipment will be installed. In order to improve the public mobile coverage in the border areas and support HKPF's operations, I have no objection to the technical proposal.

Please note that this email does not serve as an approval to the application of setting up the RBS at the Frontier Closed Area because you are required to comply with all the licence conditions as stated in the relevant telecommunications licence. Besides, you are required to obtain approval from our Spectrum Planning Section 2 for the technical details of the RBS such as antenna azimuth, maximum effective radiated power and frequencies to be used etc. You are also required to ensure that the RBS complies with the technical requirements of the Communications Authority in respect of prevention of radio interference and radiation safety prior to activation of the RBS.

The technical proposal is also subject to approvals of the relevant Government departments. You should share the antennae and other radio equipment and/or associated facilities of the RBS with other Mobile Network Operators as far as practicable and technically feasible if necessary.

Regards,

S Y Yung  
 Office of the Communications Authority  
 2961 6387

----- Forwarded by Siu Yee YUNG/OFCA/HKSARG on 2022/10/21 09:39 上午 -----

From: "YC Lee" <[REDACTED]>  
 To: "'shun-lee@ofca.gov.hk'" <shun-lee@ofca.gov.hk>  
 Cc: "'hpchung@police.gov.hk'" <hpchung@police.gov.hk>, "Siu Yee YUNG" <siuyee-yung@ofca.gov.hk>, "Frankie Pang" <[REDACTED]>, "Dragon Kwok" <[REDACTED]>  
 Date: 2022/10/19 10:07 上午  
 Subject: RE: Provision of Mobile Services on lamppost at Frontier Closed Area.

Dear Wilson,

Below is the reply from HKPF for your consideration.

YC Lee  
 Senior Manager  
 RNE  
 E&O division

SmarTone  
 Direct: [REDACTED]

Mobile: [REDACTED]  
Email: [REDACTED]  
31/F Millennium City 2, 378 Kwun Tong Road  
Kwun Tong, Kowloon, Hong Kong  
[smartone.com](http://smartone.com)



**From:** hpchung@police.gov.hk <hpchung@police.gov.hk>  
**Sent:** Wednesday, October 19, 2022 10:04 AM  
**To:** YC Lee <[REDACTED]>  
**Subject:** RE: Provision of Mobile Services on lamppost at Frontier Closed Area.

Dear Mr. LEE,

The land allocation within fence road should be under HKPF. Police is support and approve the captioned project due to operational need.

Thank you.

Best Regards,

(HUI Pak-chung, Anthony) SIP  
SIP OPS SUP & TRG BORDIST  
Office : 3661 4015

**\*\*\* This e-mail message (together with any attachments) is for the designated recipient only. It may contain information that is privileged. If you are not the intended recipient, you are hereby notified that any use, retention, disclosure, copying, printing, forwarding or dissemination of the message is strictly prohibited. If you have received the message in error, please erase all copies of the message (including attachments) from your system and notify the sender immediately. \*\*\***

**\*\*\* 此電郵訊息(連同任何附件)只發送給指定收件人。訊息可能包含享有特權資料。謹此通知，如你並非預定收件人，嚴禁使用、保留、披露、複製、列印、轉發或發布此訊息。如收到誤發的訊息，請把訊息的所有副本(包括附件)從系統內清除，並立即通知發件人。\*\*\***

"YC Lee" To: "shun-lee@ofca.gov.hk" <shun-lee@ofca.gov.hk>, "hpchung@police.gov.hk" <hpchung@police.gov.hk>  
2022/10/18 15:12 Cc: "Frankie Pang" <[REDACTED]>, "Dragon Kwok" <[REDACTED]>, "erictony@police.gov.hk" <erictony@police.gov.hk>, "Siu Yee YUNG" <siuyee-yung@ofca.gov.hk>  
Subject: RE: Provision of Mobile Services on lamppost at Frontier Closed Area.  
Reference:



Dear Anthony,

OFCA would to know whether the land allocation of the fence road is under HKPF or under Lands, and would like to know if your consent / approval is obtained on our proposed installation of base station on the lamppost along the fence road.

Dear Wilson – attached please find the email between HKPF and SMT on the proposed installation and reply from Lands D on the land usage.

Please contact me if you have further query.

YC Lee  
Senior Manager  
RNE  
E&O division

SmarTone  
Direct: [REDACTED]  
Mobile: [REDACTED]  
Email: [REDACTED]  
31/F Millennium City 2, 378 Kwun Tong Road  
Kwun Tong, Kowloon, Hong Kong  
[smartone.com](http://smartone.com)

**SmarTone**  
**MAKE US SMART**

**From:** YC Lee  
**Sent:** Friday, September 2, 2022 9:47 AM  
**To:** Siu Yee YUNG <[siuyee-yung@ofca.gov.hk](mailto:siuyee-yung@ofca.gov.hk)>  
**Cc:** [hpchung@police.gov.hk](mailto:hpchung@police.gov.hk); Frankie Pang <[REDACTED]>; Eric Wong <[REDACTED]>; Dragon Kwok <[REDACTED]>  
**Subject:** RE: Provision of Mobile Services on lamppost at Frontier Closed Area.

Dear SY,

SmarTone is working with Police to install mobile sites on lamppost along frontier closed area for enhancing mobile services around the area. The main purpose is to provide emergency services around the remote area for local residents as well as hikers.

Attached please find the application, proposal and email between Police and SmarTone.

Your early comment on the proposal is much appreciated.

Regards

YC Lee  
Senior Manager  
RNE  
E&O division

SmarTone  
Direct: [REDACTED]  
Mobile: [REDACTED]  
Email: [REDACTED]  
31/F Millennium City 2, 378 Kwun Tong Road  
Kwun Tong, Kowloon, Hong Kong  
[smartone.com](http://smartone.com)



[attachment "Email.pdf" deleted by Siu Yee YUNG/OFCA/HKSARG] [attachment "B8435C\_OFCA.pdf" deleted by Siu Yee YUNG/OFCA/HKSARG] [attachment "Base Station along Fence Road\_2022003.pdf" deleted by Siu Yee YUNG/OFCA/HKSARG]

[www.smartone.com](http://www.smartone.com)

\*\*\*\*\*E-mail Disclaimer  
\*\*\*\*\*

This e-mail message (together with any attachments) is confidential to the addressee and may also be privileged. If you are not the intended recipient, you are hereby notified that any dissemination, distribution or copying of this message is strictly prohibited.

Please also notify the sender immediately by return e-mail and delete it from your system. Internet communications cannot be guaranteed to be secure or error-free.

The sender and the entity through which this message is sent therefore do not accept liability for errors or omissions as contained in the message and any spreading of viruses as a result of Internet transmission.

Any opinions contained in this message are those of the sender personally and would not bind any entity unless otherwise clearly stated and with the authority of the sender duly verified.

\*\*\*\*\*  
\*\*\*\*\*

## 規 劃 署

沙田、大埔及北區規劃處  
香港新界沙田上禾輦路一號  
沙田政府合署  
十三樓 1301-1314 室



## Planning Department

Sha Tin, Tai Po & North District Planning Office  
Rooms 1301-1314, 13/F,  
Shatin Government Offices,  
1 Sheung Wo Che Road, Sha Tin,  
N.T., Hong Kong

來函編號 Your Reference: B8435B  
本署檔號 Our Reference: ( ) in PD/N1/01/14 (L)  
電話號碼 Tel. No.: 2158 6241  
傳真機號碼 Fax No.: 2691 2806

SmarTone Mobile Communications Limited  
31/F, Millennium City 2, 378 Kwun Tong Road  
Kwun Tong, Kowloon  
Hong Kong  
(Attn.: Y C Lee)

**By Post and Fax (3128 2266)**

27 October 2022

Dear Sir/Madam,

**Re: Proposed Installation of Mobile Radio Base Station and Antennae at  
Lamp-post Sites at Frontier Closed Area, Ta Kwu Ling, N.T.  
(Applicant: SmarTone Mobile Communications Limited)**

I refer to your letter dated 2.9.2022 regarding the captioned and your colleague's subsequent email dated 24.10.2022 (**Appendix I**) clarifying the dimensions of the proposed installations. An interim reply was issued on 2.9.2022.

2. The proposal involves provision of six equipment cabinets and two meter kiosks, as well as installation of three antennae to the existing lamp poles within areas zoned "Green Belt" ("GB") on the approved Man Kam To Outline Zoning Plan (OZP) No. S/NE-MKT/4, the approved Ta Kwu Ling North OZP No. S/NE-TKLN/2 and the approved Lin Ma Hang OZP No. S/NE-LMH/2. The dimensions of the proposed equipment cabinets, meter kiosks and the antennae are tabulated below.

Site	Equipment/Antenna	Dimension
1	• 2 sets of equipment (Equipment A and B)	Equipment A: 2m (L) x 0.55m (W) x 1.05m (H) Equipment B: 1.6m (L) x 0.55m (W) x 1.05m (H)
	• an antenna to be installed on existing lamp pole	1.64 (H) x 0.419 (W) x 0.203 (D)
	• a concrete meter kiosk	1.15m (L) x 0.7m (W) x 1.6m (H)
2	• 2 sets of equipment (Equipment A and B)	Equipment A: 2m (L) x 0.55m (W) x 1.05m (H) Equipment B: 1.6m (L) x 0.55m (W) x 1.05m (H)
	• an antenna to be installed on existing lamp pole	1.64 (H) x 0.419 (W) x 0.203 (D)
3	• 2 sets of equipment (Equipment C and D)	Equipment C: 1.2m (L) x 0.82m (W) x 1.05m (H) Equipment D: 1.2m (L) x 0.55m (W) x 1.05m (H)
	• an antenna to be installed on existing lamp pole	1.64 (H) x 0.419 (W) x 0.203 (D)
	• a concrete meter kiosk	1.15m (L) x 0.7m (W) x 1.6m (H)

3. According to the covering Notes of the OZPs, provision of 'telecommunications radio base station' including an equipment cabinet not bigger than 5 metres x 4.5 metres x 3.5 metres (L x W x H) and antenna(e) not bigger than 0.6 metre x 0.6 metre x 2.5 metres (L x W x H), excluding pole, for planar shape or 0.8 metre in diameter for circular shape, **within, attached to or on the roof top of a building or structure** for the provision of public telecommunications services to serve the local district is always permitted in the "GB" zone.

4. Based on the information provided by you, the proposed roadside equipment cabinets and meter kiosks (Drawing Nos. B8435-S11 to B8435-S13) do not fall within the specified limitation/requirement of telecommunications radio base station mentioned above, which is to install within, attach to or on the roof top of a building or structure, hence they are regarded as 'Public Utility Installation' requiring planning permission from the Town Planning Board (the Board). You are advised to critically review the project programme and allow sufficient time for pre-submission circulation to all relevant Government departments' prior formal submission to the Board. For making planning application under Section 16 of the Town Planning Ordinance, please refer to the following link for necessary reference: [https://www.info.gov.hk/tpb/en/forms/Guidance\\_Notes/S16\\_GN\\_ENG\\_Feb%202021.pdf](https://www.info.gov.hk/tpb/en/forms/Guidance_Notes/S16_GN_ENG_Feb%202021.pdf).

5. Having considered that the dimensions of the proposed antennae are within the specified limits of telecommunications radio base station, there is no statutory planning objection to the installation of the proposed antennae provided that relevant authorities including the Office of the Communications Authority are satisfied with the spatial and functional requirements of the proposed components of the subject antennae for mobile telephone services. Please note that any use or development must also conform to any other relevant legislation, the conditions of the Government lease concerned and any other Government requirements, as may be applicable.

Yours faithfully,



( Ms. Amy Y. T. CHONG )  
for District Planning Officer/  
Sha Tin, Tai Po & North,  
Planning Department

c.c.

GPA

(Attn.: Ms. Amy TANG/Mr. Terence TANG)

(Fax No. 2596 0859)

Internal

PD/N1/01/19 (L)

PD/N1/01/20 (L)

Site Record

TF/AC/NW/nw



## Appendix I



RE: Lamp-post Sites along the Border 24/10/2022 17:30

From: Dragon Kwok <dragon\_kwok@smartone.com>

To: YC Lee <[REDACTED]>, "aytchong@pland.gov.hk" <aytchong@pland.gov.hk>

Cc: Bill Chan <[REDACTED]>, "hpchung@police.gov.hk" <hpchung@police.gov.hk>, Dragon Kwok <[REDACTED]>

History:

This message has been forwarded.

Hi Ms Chong,

Please find the updated table as below. Thanks!

Site	Equipment/Antenna	Dimension
1	2 sets of equipment (Equipment A and B)	Equipment A: 2m (L) x 0.55m (W) x 1.05m (H) Equipment B: 1.6m (L) x 0.55m (W) x 1.05m (H)
	an antenna to be mounted on existing lamp pole	Antenna: 1640 (H) x 419 (W) x 203 (D) (mm)
	a concrete meter kiosk	1.15m (L) x 0.7m (W) x 1.6m (H)
2	2 sets of equipment (Equipment A and B)	Equipment A: 2m (L) x 0.55m (W) x 1.05m (H) Equipment B: 1.6m (L) x 0.55m (W) x 1.05m (H)
	an antenna to be mounted on existing lamp pole	Antenna: 1640 (H) x 419 (W) x 203 (D) (mm)
3	2 sets of equipment (Equipment C and D)	Equipment C: 1.2m (L) x 0.82m (W) x 1.05m (H) Equipment D: 1.2m (L) x 0.55m (W) x 1.05m (H)
	an antenna to be mounted on existing lamp pole	Antenna: 1640 (H) x 419 (W) x 203 (D) (mm)
	a concrete meter kiosk	1.15m (L) x 0.7m (W) x 1.6m (H)

Dragon Kwok  
Assistant Manager  
Radio Network Engineering  
Engineering & Operations

Smartone

Direct: [REDACTED]

Mobile: [REDACTED]

Email: [REDACTED]

Unit 01-23, 9/F KITEC, 1 Trademart Drive,  
Kowloon Bay, Kowloon, Hong Kong  
[smartone.com](http://smartone.com)

**Smartone**  
**MAKE US SMART**

From: YC Lee <yc\_lee@smartone.com>

Sent: Monday, October 24, 2022 17:24

To: aytchong@pland.gov.hk

Cc: Dragon Kwok <[REDACTED]>; Bill Chan <[REDACTED]>; hpchung@police.gov.hk

Subject: RE: Lamp-post Sites along the Border

Dear Ms. Chong,

It is agreed between HKPF and Smartone that the captioned cables (optical and power) will be placed on the upper fencing along the border. Underground work is not required.

YC Lee  
Senior Manager  
RNE  
E&O division

Smartone

Direct: [REDACTED]

Mobile: [REDACTED]

**From:** cheunpl@archsd.gov.hk  
**Sent:** Friday, September 2, 2022 3:07 PM  
**To:** hpchung@police.gov.hk  
**Cc:** Dragon Kwok; Eric Wong; Frankie Pang; YC Lee; chuklj@archsd.gov.hk; suenck@archsd.gov.hk  
**Subject:** HKPF (Smartone) Provision of Mobile Services on lamppost at Frontier Closed Area - ArchSD's Maintenance Comments  
**Attachments:** Email.pdf; B8435B\_ASD.pdf; Base Station along Fence Road\_2022003.pdf

**CAUTION : If you don't know the EXTERNAL sender, don't click on any link/attachment or reply to this Email.**

Dear Mr. Chung,

As requested in preceding email issued by the telecommunication company "SmarTone", please be generally reminded that "SmarTone" and his appointed contractors/ consultants shall take proper care of the government premises & building facilities in carrying out the installation works of mobile services (hereunder "works").

As a **building maintenance agent of border fence and government venues at Front Closed Area** as appointed by HKPF, ArchSD is **not** in the proper position to express comment for any installation of mobile services on lamppost therein.

Nevertheless, please convey the following general comments to "Smartone" and his appointed contractors/ consultants for full compliance with necessary precautionary measures if the works would involve government premises/ venues/ building facilities under maintenance ambit of ArchSD :

- 1) SmarTone shall provide written certification/ undertaking to confirm that all proposed works shall comply with the relevant statutory requirements, standards and related codes of practice in-force;
- 2) SmarTone shall ensure that the proposed works are structurally sound and would not affect the integrity of any building structure including the border fences and gates therein and nearby the works locations;
- 3) SmarTone shall be responsible for the all building & structural design, construction and future maintenance of the proposed works;
- 4) SmarTone shall be responsible for making good all affected areas to the satisfaction of HKPF and the venue management upon receipt of their notification;
- 5) SmarTone shall ensure that the works will not affect the integrity and waterproofing system of the floor slab and shall demonstrate such compliance before and during the site work implementation;
- 6) SmarTone shall ensure that no new fixtures nor conduit would be allowed to be mounted on the external wall of the building within the border area unless receiving written consent from HKPF and venue management;
- 7) If any new installation works are proposed to be erected higher than the height of existing buildings, SmarTone shall check and verify with the corresponding Government Land Allocation and its Engineering Conditions to ensure that this is permitted before the site works implementation;
- 8) No works shall obstruct the operation and maintenance of the existing government premises/ venues/ building facilities and the services/fixtures/installations therein. SmarTone shall undertake to relocate the proposed installations at his own cost if maintenance/repair work to the subject area is required to be carried out by this department;
- 9) SmarTone shall ensure that the proposed locations of relevant installation works will not cause any accumulation of water;
- 10) SmarTone shall apply the necessary excavation permit for any excavation works in public road;
- 11) SmarTone shall ensure that any structural works shall be designed and endorsed by Registered Structural Engineer (RSE) before commencement of site works;

12) SmarTone shall understand that ArchSD does not assume any supervision/auditing role on the actual works done. SmarTone should appoint an RSE to ensure that the design and supervision requirements set out under the Buildings Ordinance and the subsidiary legislations made thereunder and any amendments thereto are complied with in the design and construction of the structural works. The appointed RSE shall also verify the actual site conditions against the design assumptions prior to construction, and shall certify that the completed works have been carried out in accordance with the design and are, in his opinion, structurally safe;

13) As-fitted drawings and record photos showing the site conditions before and after the works shall be submitted to HKPF and ArchSD for record;

14) SmarTone shall also seek advice from EMSD if the proposed installation will affect the existing electrical installation, wiring circuit and power sources therein.

Should you have any questions, please feel free to discuss.

Regards,

Alan Cheung  
PSM/SS&SWH  
2773 2662

From: "YC Lee" <[REDACTED]>  
To: Po Leung CHEUNG/ARCHSD/HKSARG@ARCHSD  
Cc: "h\_chun @ olice.gov.hk" <hpchung@police.gov.hk> "Frankie Pan " <[REDACTED]>, "Eric Wong" <[REDACTED]>, "Dragon Kwok" <[REDACTED]>  
Date: 02/09/2022 10:08  
Subject: Provision of Mobile Services on lamppost at Frontier Closed Area.

---

Dear Mr. Cheung,

SmarTone is working with Police to install mobile sites on lamppost along frontier closed area for enhancing mobile services around the area. The main purpose is to provide emergency services around the remote area for local residents as well as hikers.

Attached please find the application, proposal and email between Police and SmarTone.

Your early comment on the proposal is much appreciated.

Regards

YC Lee  
Senior Manager  
RNE  
E&O division

SmarTone  
Direct: [REDACTED]  
Mobile: [REDACTED]  
Email: [REDACTED]  
31/F Millennium City 2, 378 Kwun Tong Road  
Kwun Tong, Kowloon, Hong Kong  
[smartone.com](http://smartone.com)

**SmarTone**  
MAKE US SMART

\*\*\*\*\*E-mail Disclaimer  
\*\*\*\*\*

This e-mail message (together with any attachments) is confidential to the addressee and may also be privileged. If you are not the intended recipient, you are hereby notified that any dissemination, distribution or copying of this message is strictly prohibited.

Please also notify the sender immediately by return e-mail and delete it from your system. Internet communications cannot be guaranteed to be secure or error-free.

The sender and the entity through which this message is sent therefore do not accept liability for errors or omissions as contained in the message and any spreading of viruses as a result of Internet transmission.

Any opinions contained in this message are those of the sender personally and would not bind any entity unless otherwise clearly stated and with the authority of the sender duly verified.

\*\*\*\*\*  
\*\*\*\*\* (File-Checksum-0506f993)(File-Checksum-2438de4b)(File-Checksum-403fb5ed)

**From:** lenlm6@landsd.gov.hk  
**Sent:** Monday, September 5, 2022 3:59 PM  
**To:** YC Lee  
**Cc:** slenlm@landsd.gov.hk; sleng@landsd.gov.hk; lenlm2@landsd.gov.hk  
**Subject:** Fw: Provision of Mobile Services on lamppost at Frontier Closed Area.

**CAUTION : If you don't know the EXTERNAL sender, don't click on any link/attachment or reply to this Email.**

Dear YC LEE,

I refer to your preceding email enquiry dated 2 September 2022 concerning the proposed installations in 3 sites (covering 5 locations) in connection with the purpose of provision of fixed telecommunication network services.

Whereas this office has no strong view on your proposal, you are required to apply to this office for Excavation Permits pursuant to Condition No. 10 of the Block License dated 23 November 2011 issued to SmarTone Communications Limited.

Separate applications for each of the 3 sites are preferred.

DLON 67/149/22

Regards,  
Bryan LEE  
LE/LM6, DLO/N  
Tel: 2675 1537

From: YC Lee <[REDACTED]>  
To: "lenlc2@landsd.gov.hk" <lenlc2@landsd.gov.hk>  
Cc: "hpchung@police.gov.hk" <hpchung@police.gov.hk>, Frankie Pang <[REDACTED]>, Eric Wong <[REDACTED]>, Dragon Kwok <[REDACTED]>  
Date: 02/09/2022 09:45  
Subject: RE: Provision of Mobile Services on lamppost at Frontier Closed Area.

Dear Mr. Tang

SmarTone is working with Police to install mobile sites on lamppost along frontier closed area for enhancing mobile services around the area. The main purpose is to provide emergency services around the remote area for local residents as well as hikers.

Attached please find the application, proposal and email between Police and SmarTone.

Your early comment on the proposal is much appreciated.

Regards

YC Lee  
Senior Manager  
RNE  
E&O division

SmarTone  
Direct: [REDACTED]  
Mobile: [REDACTED]  
Email: [REDACTED]  
31/F Millennium City 2, 378 Kwun Tong Road  
Kwun Tong, Kowloon, Hong Kong  
[smartone.com](http://smartone.com)



[www.smartone.com](http://www.smartone.com)

\*\*\*\*\*E-mail Disclaimer  
\*\*\*\*\*

This e-mail message (together with any attachments) is confidential to the addressee and may also be privileged. If you are not the intended recipient, you are hereby notified that any dissemination, distribution or copying of this message is strictly prohibited.

Please also notify the sender immediately by return e-mail and delete it from your system. Internet communications cannot be guaranteed to be secure or error-free.

The sender and the entity through which this message is sent therefore do not accept liability for errors or omissions as contained in the message and any spreading of viruses as a result of Internet transmission.

Any opinions contained in this message are those of the sender personally and would not bind any entity unless otherwise clearly stated and with the authority of the sender duly verified.

\*\*\*\*\*  
\*\*\*\*\* [attachment "Email.pdf" deleted by Chi Wa LEE/LAO/LANDSD/HKSARG] [attachment "B8435A\_LD.pdf" deleted by Chi Wa LEE/LAO/LANDSD/HKSARG] [attachment "Base Station along Fence Road\_2022003.pdf" deleted by Chi Wa LEE/LAO/LANDSD/HKSARG]

**From:** pangkm@emsd.gov.hk  
**Sent:** Wednesday, September 14, 2022 4:26 PM  
**To:** YC Lee  
**Cc:** Dragon Kwok; Eric Wong; Frankie Pang; hpchung@police.gov.hk; leungps@emsd.gov.hk; chankaichuen@emsd.gov.hk; shleung@emsd.gov.hk; wongkf@emsd.gov.hk  
**Subject:** 回覆: Provision of Mobile Services on lamppost at Frontier Closed Area.

**CAUTION : If you don't know the EXTERNAL sender, don't click on any link/attachment or reply to this Email.**

Dear Mr. Lee,

Please be advised that EMSTF is a maintenance agent of the fence boundary floodlights and we would only provide our comments on the related aspects. Please find our comments below:

1. It is recommend Smartone to apply a independent power supply from power company.
2. It is recommend not to connect the mobile services system to our existing system, e.g. power systems, lightning systems in order not to affect the operation and reliability of the existing systems.
3. Please seek ArchSD's comment on the structural issue of the lamp pole.
4. Please also inform us for the modification works on the lamp pole, if any.
5. Please be reminded to seek the venue owner's (HKPF) approval on the use of locations or modifications of fencing, etc.
- 6 Please be reminded to arrange appropriate maintenance services for the radio base stations.

If you have any enquiry, please feel free to contact me. Thank you!

Best Regards,  
Karman Pang  
E/S/NT2  
Electrical and Mechanical Services Department  
Tel : 2808 3779 / 6053 2296  
Fax: 2577 1824

寄件者: "YC Lee" <[REDACTED]>  
收件者: "pangkm@emsd.gov.hk" <pangkm@emsd.gov.hk>  
副本抄送: "hpchung@police.gov.hk" <hpchung@police.gov.hk>, "Frankie Pang" <[REDACTED]>, "Eric Wong" <[REDACTED]>, "Dragon Kwok" <[REDACTED]>  
日期: 2022/09/02 上午 10:12  
主旨: Provision of Mobile Services on lamppost at Frontier Closed Area.

Dear Mr. Pang,

SmarTone is working with Police to install mobile sites on lamppost along frontier closed area for enhancing mobile services around the area. The main purpose is provide emergency services around the remote area for local residents as well as hikers.

Attached please find the application, proposal and email between Police and SmarTone.

Your early comment on the proposal is much appreciated.

Regards

YC Lee  
Senior Manager  
RNE  
E&O division

SmarTone  
Direct: [REDACTED]  
Mobile: [REDACTED]  
Email: [REDACTED]  
31/F Millennium City 2, 378 Kwun Tong Road  
Kwun Tong, Kowloon, Hong Kong  
[smartone.com](http://smartone.com)



[www.smartone.com](http://www.smartone.com)

\*\*\*\*\*E-mail Disclaimer  
\*\*\*\*\*

This e-mail message (together with any attachments) is confidential to the addressee and may also be privileged. If you are not the intended recipient, you are hereby notified that any dissemination, distribution or copying of this message is strictly prohibited.

Please also notify the sender immediately by return e-mail and delete it from your system. Internet communications cannot be guaranteed to be secure or error-free.

The sender and the entity through which this message is sent therefore do not accept liability for errors or omissions as contained in the message and any spreading of viruses as a result of Internet transmission.

Any opinions contained in this message are those of the sender personally and would not bind any entity unless otherwise clearly stated and with the authority of the sender duly verified.

\*\*\*\*\*

\*\*\*\*\* [附件檔 "B8435A\_EMSSD.pdf" 已被 ESNT2/HQ/EMSD 刪除] [附件檔 "Base Station along Fence Road\_2022003.pdf" 已被 ESNT2/HQ/EMSD 刪除] [附件檔 "Email.pdf" 已被 ESNT2/HQ/EMSD 刪除]

=====  
IMPORTANT: This electronic transmission and its enclosure, if any, contain information intended only for the addressee(s) named. Any use, distribution, copying or disclosure by any other person in whole or in part is strictly prohibited. If you receive this transmission in error, please notify the sender by e-mail or telephone and delete the message and any attachment from your system.

Any comments, opinions or other information contained in this transmission that do not relate to the official business of the Electrical and Mechanical Services Department shall not be construed to be expressed or endorsed by the Department.  
=====