

Our Ref.: DD82 Lot 1114 & VL  
Your Ref.: TPB/A/NE-TKL/761

The Secretary,  
Town Planning Board,  
15/F, North Point Government Offices,  
333 Java Road,  
North Point, Hong Kong

**By Email**

17 October 2024

Dear Sir,

**3<sup>rd</sup> Further Information**

**Proposed Temporary Open Storage of Construction Material and Machinery with  
Ancillary Facilities for a Period of 3 Years and Associated Filling of Land  
in “Agriculture” Zone, Various Lots in D.D. 82, Ta Kwu Ling, New Territories**

**(S.16 Planning Application No. A/NE-TKL/761)**

We are writing to submit further information to address departmental comments of the subject application (**Appendix I**).

Should you require more information regarding the application, please contact our Mr. Danny NG [REDACTED] or the undersigned at your convenience. Thank you for your kind attention.

Yours faithfully,

For and on behalf of  
**R-riches Property Consultants Limited**

**Louis TSE**  
Town Planner

cc DPO/STN, PlanD

(Attn.: Mr. Timothy WU

email: twpwu@pland.gov.hk )

(Attn.: Ms. Katie LEUNG

email: kyyleung@pland.gov.hk )



**Responses-to-Comments**

**Proposed Temporary Open Storage of Construction Material and Machinery with Ancillary Facilities for a Period of 3 Years and Associated Filling of Land in “Agriculture” Zone, Various Lots in D.D. 82, Ta Kwu Ling, New Territories**

**(Application No. A/NE-TKL/761)**

(i) A RtoC Table:

Departmental Comments		Applicant’s Responses
<b>1. Comments of the Chief Town Planner/Urban Design and Landscape, Planning Department (CTP/UD&amp;L, PlanD)</b>		
(a)	Having reviewed the submitted RtC and supplementary information, 21 nos. of trees including 18 nos. of undesirable species (i.e. <i>Leucaena leucocephala</i> ) and no old and valuable trees (OVTs) or protected species are identified within the application site. According to the revised Landscape Proposal (Annex II), 3 nos. of new trees (i.e. N1 to N3) with continuous soil trench are proposed at the eastern boundary to compensate the loss of trees.	Due to the proposed hard-paving works for site formation of structures and circulation purposes, all existing trees will be affected, and it is not proposed to retain any of the existing trees within the application site (the Site). 3 new trees (i.e. N1 to N3) with continuous soil trench are proposed at the eastern boundary of the Site to compensate the loss of trees ( <b>Annex I</b> ).
(b)	The applicant is advised to adjust or revise the layout of the proposed development to preserve existing trees, e.g. T17 and T21, at the periphery of site as far as practicable	
(c)	Annex II – Tree number, T21, is missing at “ <i>Celtis sinensis</i> ” of “No. of existing trees tree species”.	It is revised accordingly ( <b>Annex I</b> ).
(d)	Annex II – “No. of new trees will be planted” should be 3 (N1 to N3). Please review and rectify	It is revised accordingly ( <b>Annex I</b> ).
(e)	Approval of the application does not imply approval of tree works such as pruning, transplanting and felling. The applicant is reminded to seek approval for any proposed tree works from relevant authority prior to commencement of the works.	Noted.

**LANDSCAPE PROPOSAL**

APPLICATION SITE AREA : 2,255 m<sup>2</sup> (ABOUT)  
 NO. OF EXISTING TREES : 21 (T1 TO T21)  
 TREE SPECIES : *LEUCAENA LEUCOCEPHALA* (T1 TO T16, T18, T20)  
 : *MANGIFERA INDICA* (T17)  
 : *CELTIS SINENSIS* (T19, T21)  
 NO. OF TREES TO BE FELLED : 21 (T1 TO T21)

**APPLICATION SITE (A)**  
 AREA: 487 m<sup>2</sup> (ABOUT)

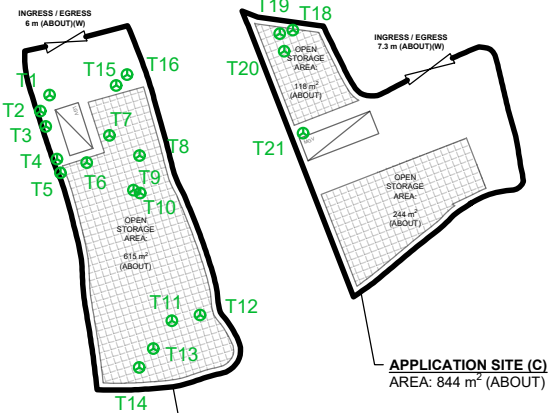
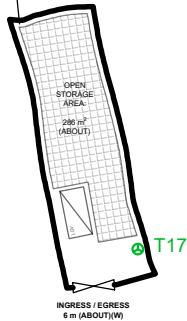

**APPLICATION SITE (C)**  
 AREA: 844 m<sup>2</sup> (ABOUT)

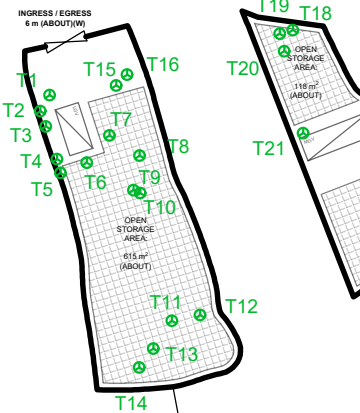

**APPLICATION SITE (B)**  
 AREA: 924 m<sup>2</sup> (ABOUT)

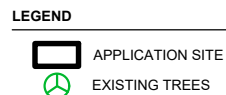

**LANDSCAPE PROPOSAL**

APPLICATION SITE AREA : 2,255 m<sup>2</sup> (ABOUT)  
 COVERED AREA : NOT APPLICABLE  
 UNCOVERED AREA : 2,255 m<sup>2</sup> (ABOUT)  
 NO. OF NEW TREES WILL BE PLANTED : 3 (N1 TO N3)  
 SPECIES OF NEW TREES : *SENNA SURATTENSIS*  
 HEIGHT OF NEW TREES : NO LESS THAN 2.75 m  
 SPACING OF NEW TREES : NOT LESS THAN 4 m  
 DIMENSION OF SOIL TRENCH : 1.2 m (W) X 1.2 m (D)

**APPLICATION SITE (A)**  
 AREA: 487 m<sup>2</sup> (ABOUT)

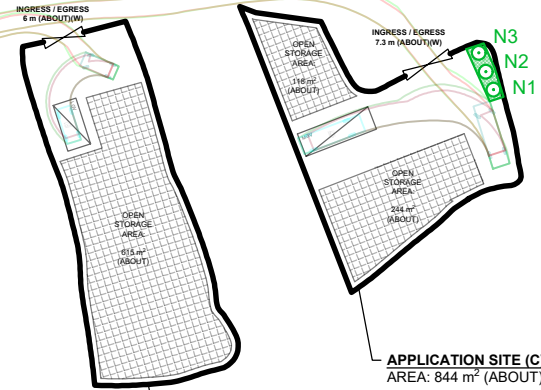
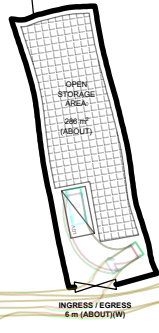

**APPLICATION SITE (C)**  
 AREA: 844 m<sup>2</sup> (ABOUT)

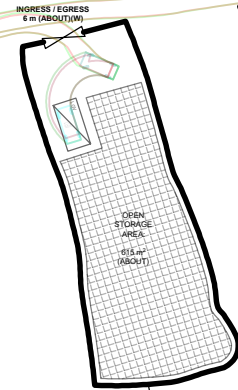

**APPLICATION SITE (B)**  
 AREA: 924 m<sup>2</sup> (ABOUT)

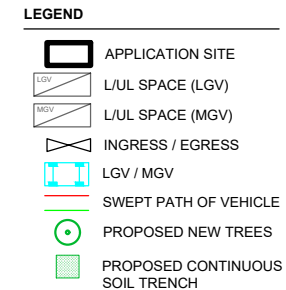
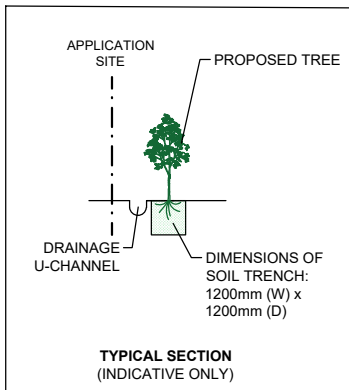

- NOTES:**
- 1) THE APPLICANT WILL MAINTAIN TREES IN GOOD CONDITION DURING THE PLANNING APPROVAL PERIOD.
  - 2) THE APPLICANT WILL REPLACE TREES WHICH ARE DYING OR DEAD DURING THE PLANNING APPROVAL PERIOD.
  - 3) THE APPLICANT WILL PROVIDE ADEQUATE IRRIGATION FOR TREES.

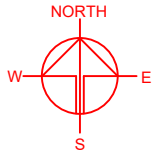

PLANNING CONSULTANT

PROJECT  
 PROPOSED TEMPORARY OPEN STORAGE OF CONSTRUCTION MATERIAL AND MACHINERY WITH ANCILLARY FACILITIES FOR A PERIOD OF 3 YEARS AND ASSOCIATED FILLING OF LAND

SITE LOCATION  
 VARIOUS LOTS IN D.D. 82, TA KWU LING, NEW TERRITORIES

SCALE  
 1 : 1100 @ A4

DRAWN BY : LT DATE : 12.8.2024

REVISED BY : DATE :

APPROVED BY : DATE :

DWG. TITLE  
 LANDSCAPE PROPOSAL

DWG NO. : ANNEX I VER. : 001