

LOCATION OF THE APPLICATION SITE

APPLICATION SITE AREA : 4,970 m² (ABOUT)

VEHICULAR ACCESS

ACCESSIBLE FROM PING CHE ROAD VIA A LOCAL ACCESS

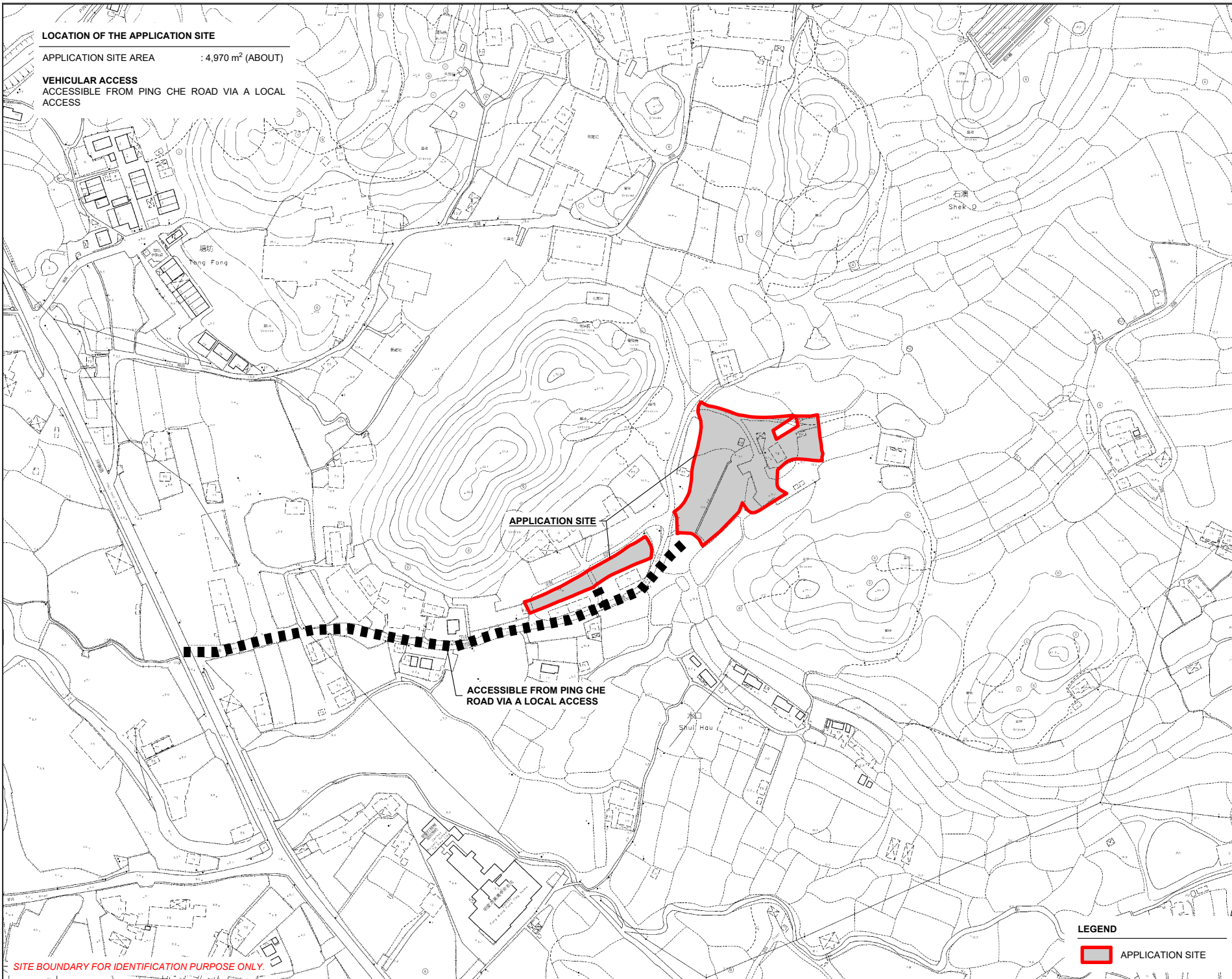
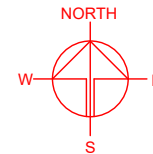

APPLICATION SITE

ACCESSIBLE FROM PING CHE ROAD VIA A LOCAL ACCESS

LEGEND

 APPLICATION SITE

SITE BOUNDARY FOR IDENTIFICATION PURPOSE ONLY.

PLANNING CONSULTANT



PROJECT

PROPOSED TEMPORARY OPEN STORAGE OF CONSTRUCTION MATERIAL AND MACHINERY WITH ANCILLARY FACILITIES FOR A PERIOD OF 3 YEARS AND ASSOCIATED FILLING OF LAND

SITE LOCATION

VARIOUS LOTS IN D.D. 82, TA KWU LING, NEW TERRITORIES

SCALE
1 : 3000 @ A4

DRAWN BY MN DATE 17.5.2024

CHECKED BY DATE

APPROVED BY DATE

DWG. TITLE
LOCATION PLAN

DWG NO. PLAN 1 VER. 001

ZONING OF THE APPLICATION SITE

APPLICATION SITE AREA : 4,970m² (ABOUT)
OUTLINE ZONING PLAN : APPROVED PING CHE AND TA KWU LING OZP
OZP PLAN NO. : S/NE-TKL/14
ZONING OF THE SITE : "AGRICULTURE" ("AGR")

TA KWU LING

塘坊
Tong Fong

石澳
Shek O

APPLICATION SITE

GB

GB

水口
Shui Hau

AGR

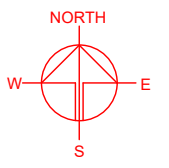

PLANNING CONSULTANT



PROJECT

PROPOSED TEMPORARY OPEN STORAGE OF CONSTRUCTION MATERIAL AND MACHINERY WITH ANCILLARY FACILITIES FOR A PERIOD OF 3 YEARS AND ASSOCIATED FILLING OF LAND

SITE LOCATION

VARIOUS LOTS IN D.D. 82, TA KWU LING, NEW TERRITORIES

SCALE
1 : 3000 @ A4

DRAWN BY
MN 17.5.2024

CHECKED BY
DATE

APPROVED BY
DATE

LEGEND

APPLICATION SITE

SITE BOUNDARY FOR IDENTIFICATION PURPOSE ONLY

DWG. TITLE
ZONING OF THE SITE

DWG NO.
PLAN 2

VER.
001

LAND STATUS OF THE APPLICATION SITE

APPLICATION SITE AREA : 4,970 m² (ABOUT)
AREA OF PRIVATE LAND : 4,970 m² (ABOUT)
AREA OF GOVERNMENT LAND : NOT APPLICABLE

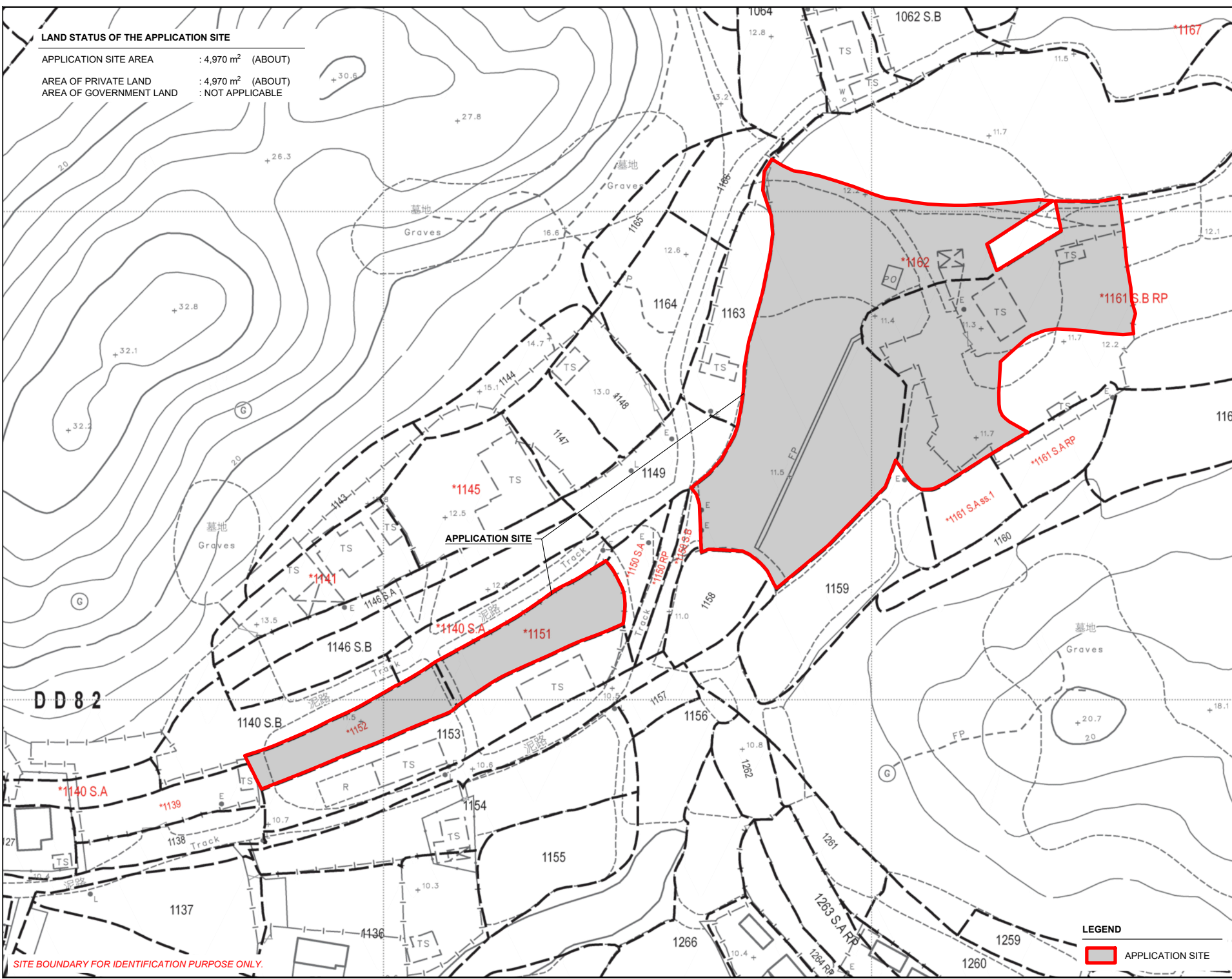
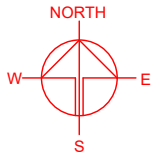

SITE BOUNDARY FOR IDENTIFICATION PURPOSE ONLY.

LEGEND
[Red outline box] APPLICATION SITE

PLANNING CONSULTANT
R-Riches
Property Consultants Ltd.

PROJECT
PROPOSED TEMPORARY OPEN STORAGE OF CONSTRUCTION MATERIAL AND MACHINERY WITH ANCILLARY FACILITIES FOR A PERIOD OF 3 YEARS AND ASSOCIATED FILLING OF LAND

SITE LOCATION
VARIOUS LOTS IN D.D. 82, TA KWU LING, NEW TERRITORIES

SCALE 1 : 1000 @ A4	
DRAWN BY MN	DATE 17.5.2024
CHECKED BY	DATE
APPROVED BY	DATE
DWG. TITLE LAND STATUS OF THE SITE	
DWG NO. PLAN 3	VER. 001

**TOWN PLANNING BOARD GUIDELINES NO. 13G
FOR APPLICATION FOR OPEN STORAGE AND PORT BACK-UP
USES UNDER SECTION 16 OF THE TOWN PLANNING ORDINANCE**

APPLICATION SITE AREA : 4,970 m² (ABOUT)

CATEGORY OF THE SITE : CATEGORY 2 AREA

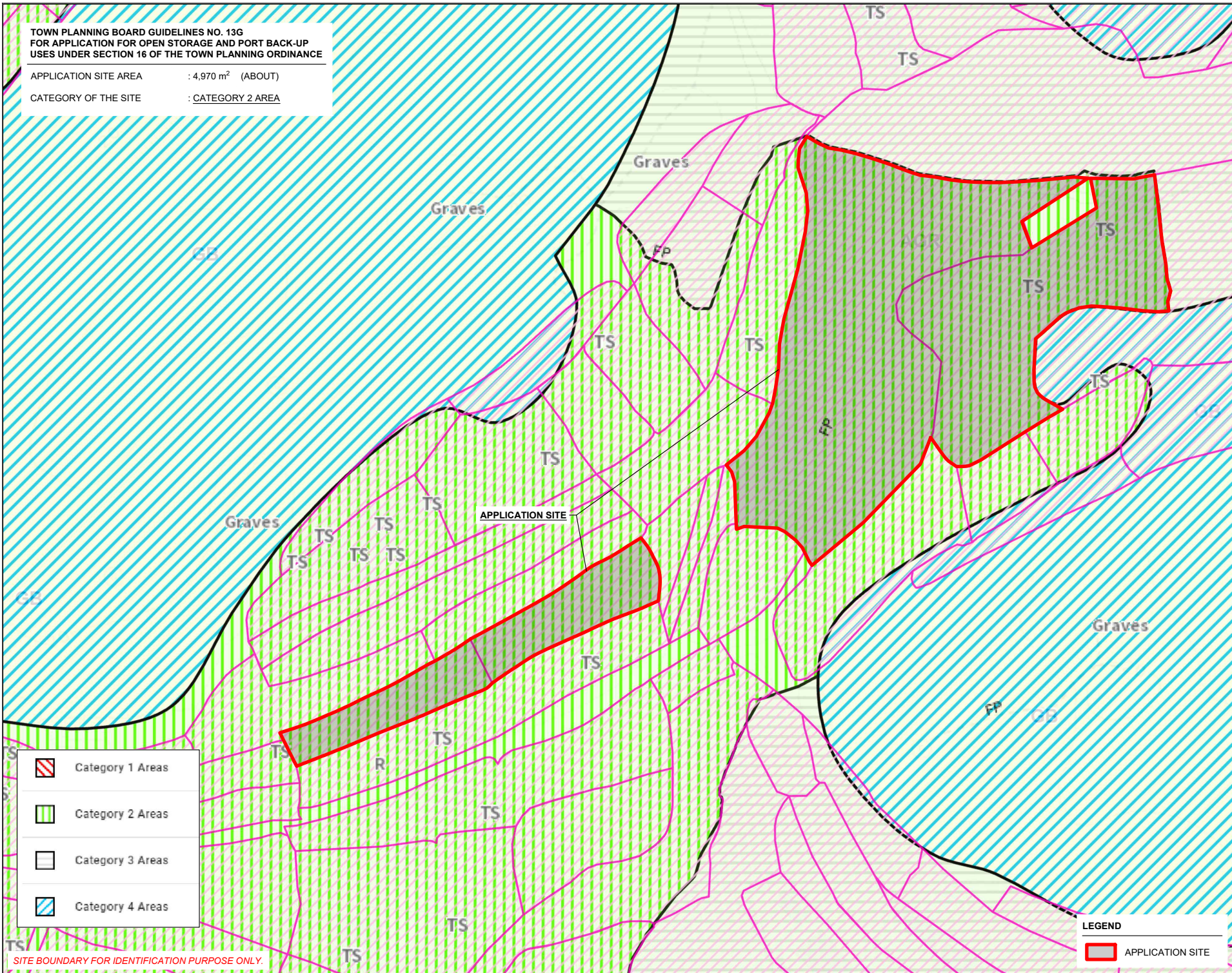
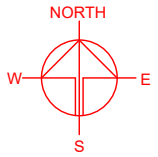

-  Category 1 Areas
-  Category 2 Areas
-  Category 3 Areas
-  Category 4 Areas

SITE BOUNDARY FOR IDENTIFICATION PURPOSE ONLY.

LEGEND

 APPLICATION SITE

PLANNING CONSULTANT



PROJECT
PROPOSED TEMPORARY OPEN STORAGE OF CONSTRUCTION MATERIAL AND MACHINERY WITH ANCILLARY FACILITIES FOR A PERIOD OF 3 YEARS AND ASSOCIATED FILLING OF LAND

SITE LOCATION
VARIOUS LOTS IN D.D. 82, TA KWU LING, NEW TERRITORIES

SCALE
1 : 1000 @ A4

DRAWN BY: MN DATE: 16.5.2024

CHECKED BY: DATE:

APPROVED BY: DATE:

DWG. TITLE
TPB PG-13G

DWG NO.: PLAN 4 VER.: 001

DEVELOPMENT PARAMETERS

APPLICATION SITE AREA	: 4,970 m ²	(ABOUT)
COVERED AREA	: 216 m ²	(ABOUT)
UNCOVERED AREA	: 4,754 m ²	(ABOUT)
PLOT RATIO	: 0.04	(ABOUT)
SITE COVERAGE	: 4 %	(ABOUT)
NO. OF STRUCTURE	: 1	
DOMESTIC GFA	: NOT APPLICABLE	
NON-DOMESTIC GFA	: 216 m ²	(ABOUT)
TOTAL GFA	: 216 m ²	(ABOUT)
BUILDING HEIGHT	: 5 m	(ABOUT)
NO. OF STOREY	: 1	

STRUCTURE	USE	COVERED AREA	GFA	BUILDING HEIGHT
B1	STORAGE OF CONSTRUCTION MATERIAL AND MACHINERY, SITE OFFICE AND WASHROOM	216 m ² (ABOUT)	216 m ² (ABOUT)	5 m (ABOUT)(1-STOREY)
TOTAL		216 m² (ABOUT)	216 m² (ABOUT)	

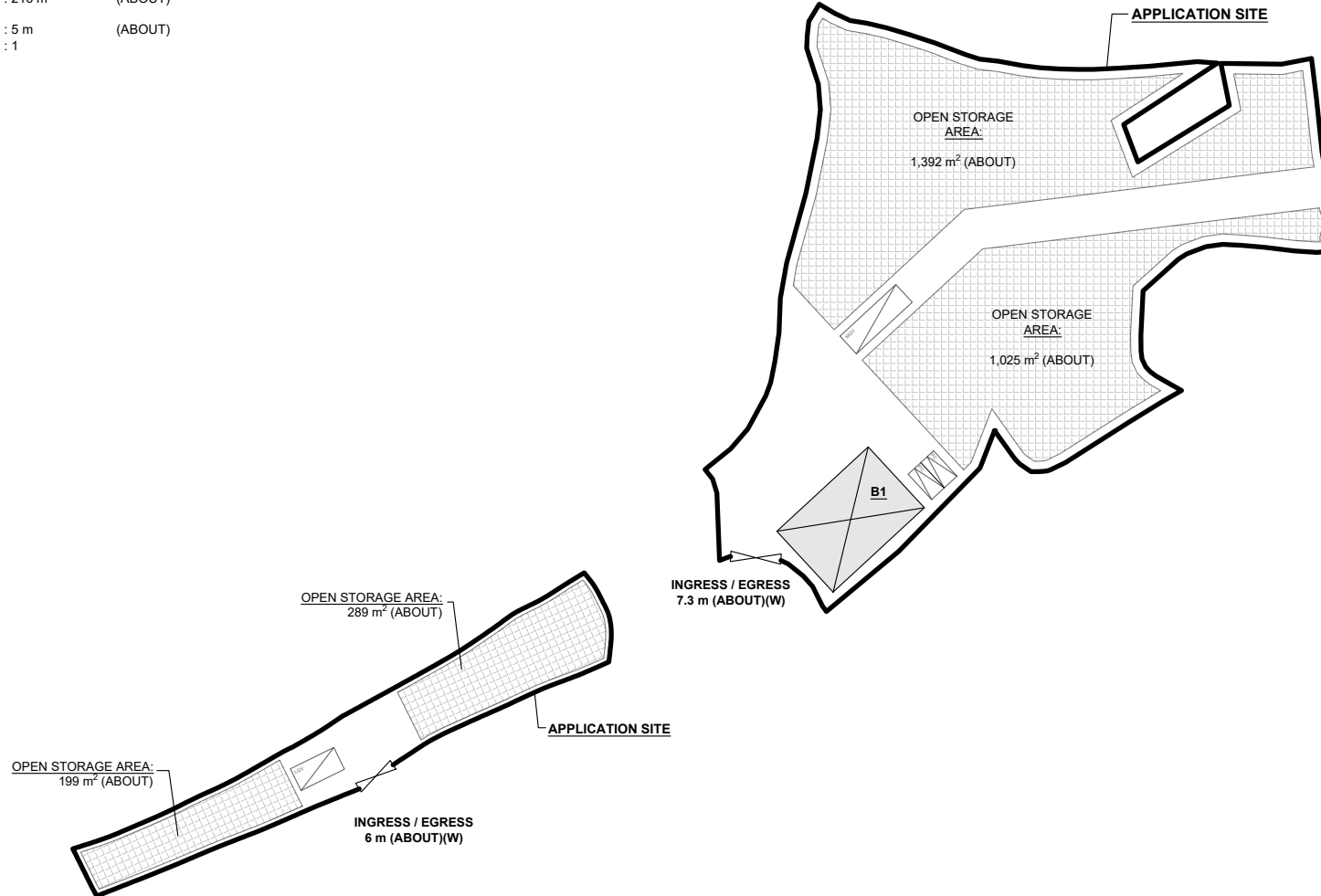
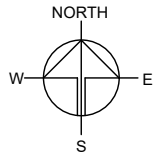

PARKING AND LOADING/UNLOADING PROVISIONS

NO. OF PRIVATE CAR PARKING SPACE	: 2
DIMENSION OF PARKING SPACE	: 5 m (L) X 2.5 m (W)
NO. OF L/U SPACE FOR LIGHT GOODS VEHICLE	: 1
DIMENSION OF L/U SPACE	: 7 m (L) X 3.5 m (W)
NO. OF L/U SPACE FOR MEDIUM GOODS VEHICLE	: 1
DIMENSION OF L/U SPACE	: 11 m (L) X 3.5 m (W)

LEGEND

- APPLICATION SITE
- STRUCTURE
- PARKING SPACE (PRIVATE CAR)
- L/U SPACE (LIGHT GOODS VEHICLE)
- L/U SPACE (MEDIUM GOODS VEHICLE)
- INGRESS / EGRESS

PLANNING CONSULTANT



PROJECT

PROPOSED TEMPORARY OPEN STORAGE OF CONSTRUCTION MATERIAL AND MACHINERY WITH ANCILLARY FACILITIES FOR A PERIOD OF 3 YEARS AND ASSOCIATED FILLING OF LAND

SITE LOCATION

VARIOUS LOTS IN D.D. 82, TA KWU LING, NEW TERRITORIES

SCALE

1 : 1000 @ A4

DRAWN BY	DATE
MN	17.5.2024
CHECKED BY	DATE
APPROVED BY	DATE

DWG. TITLE
LAYOUT PLAN

DWG NO.	VER.
PLAN 5	001

EXISTING CONDITION OF THE APPLICATION SITE

APPLICATION SITE AREA : 4,970 m² (ABOUT)
 EXISTING SOILED GROUND AREA : 4,970 m² (ABOUT)
 EXISTING SITE LEVELS : +11.5 mPD (ABOUT)

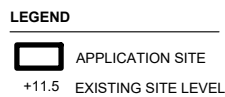
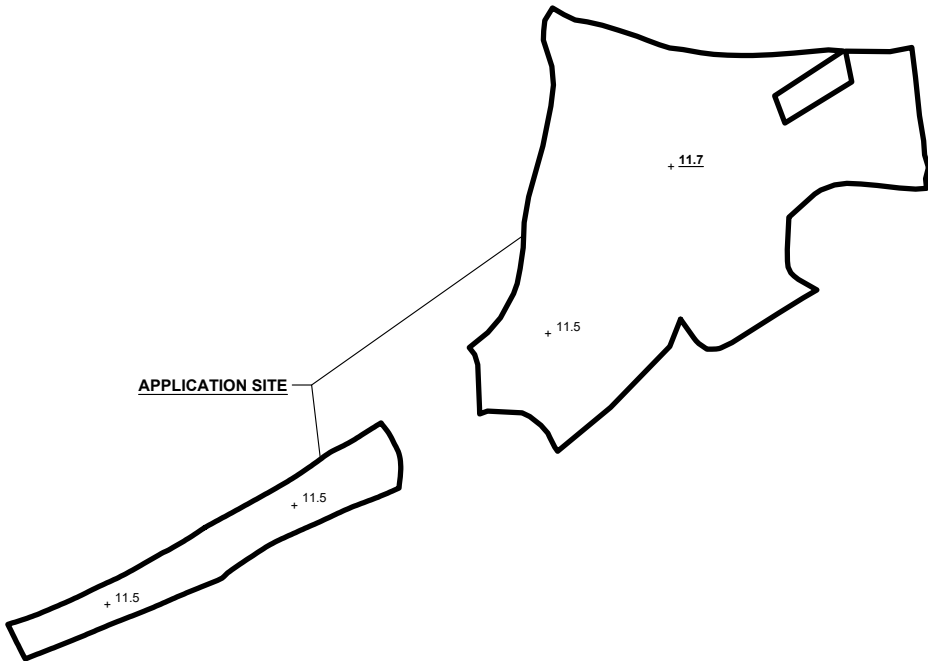

*SITE LEVELS ARE FOR ILLUSTRATION PURPOSE ONLY

PROPOSED FILLING OF LAND AREA

APPLICATION SITE AREA : 4,970 m² (ABOUT)
 COVERED BY STRUCTURE : 216 m² (ABOUT)
 PROPOSED FILLING AREA : 4,970 m² (ABOUT)
 DEPTH OF LAND FILLING : NOT MORE THAN 0.2 m
 PROPOSED SITE LEVELS : +11.7 mPD (ABOUT)
 MATERIAL OF LAND FILLING : CONCRETE
 USE : PARKING AND LOADING / UNLOADING SPACE,
 OPEN STORAGE AND CIRCULATION AREA

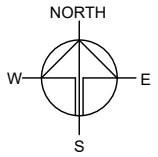
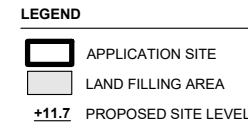
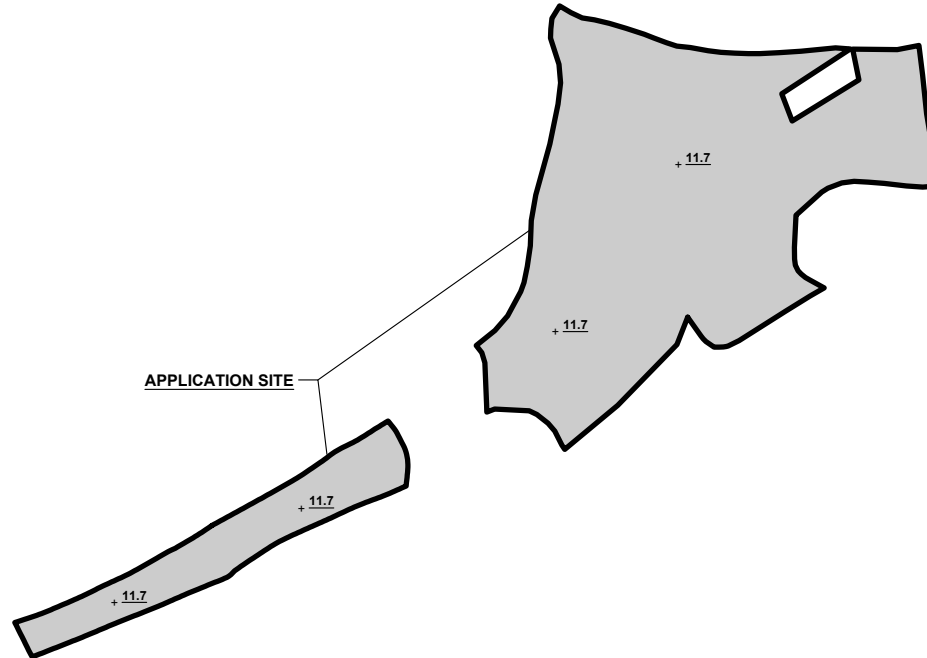

PLANNING CONSULTANT

PROJECT
 PROPOSED TEMPORARY OPEN STORAGE OF CONSTRUCTION MATERIAL AND MACHINERY WITH ANCILLARY FACILITIES FOR A PERIOD OF 3 YEARS AND ASSOCIATED FILLING OF LAND

SITE LOCATION
 VARIOUS LOTS IN D.D. 82, TA KWU LING, NEW TERRITORIES

SCALE
 1 : 1500 @ A4

DRAWN BY MN	DATE 17.5.2024
----------------	-------------------

REVISED BY	DATE
------------	------

APPROVED BY	DATE
-------------	------

DWG. TITLE
 FILLING OF LAND AREA

DWG NO. PLAN 6	VER. 001
-------------------	-------------

SWEPT PATH ANALYSIS

TYPE OF VEHICLE : MEDIUM GOODS VEHICLE
 DIMENSION OF VEHICLE : 2.5 m (W) X 9.8 m (L)

SWEPT PATHS GENERATED BY AUTODESK VEHICLE TRACKING 2024

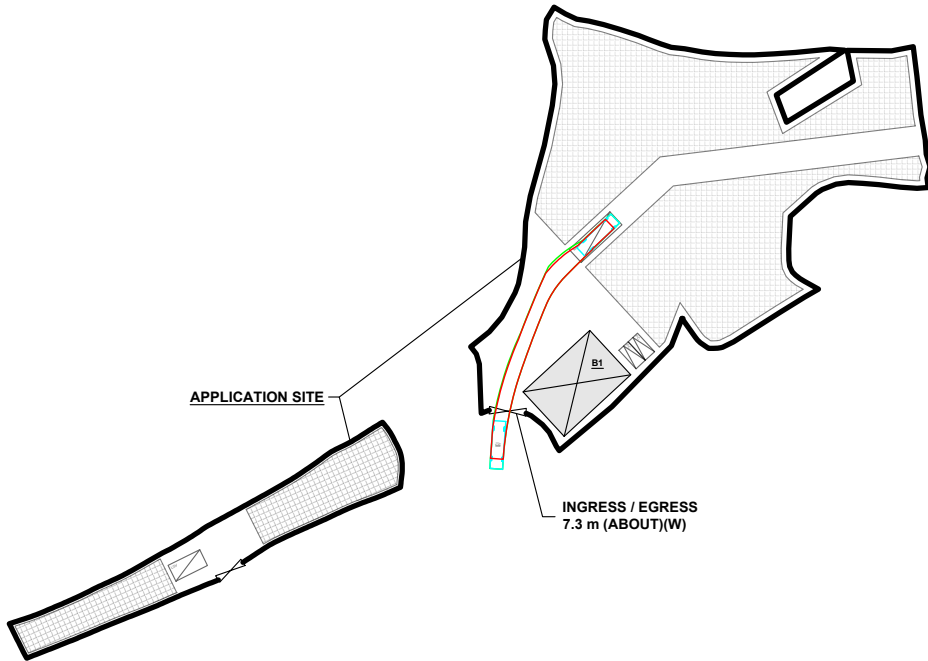

FROM THE LOCAL ACCESS TO
 THE APPLICATION SITE

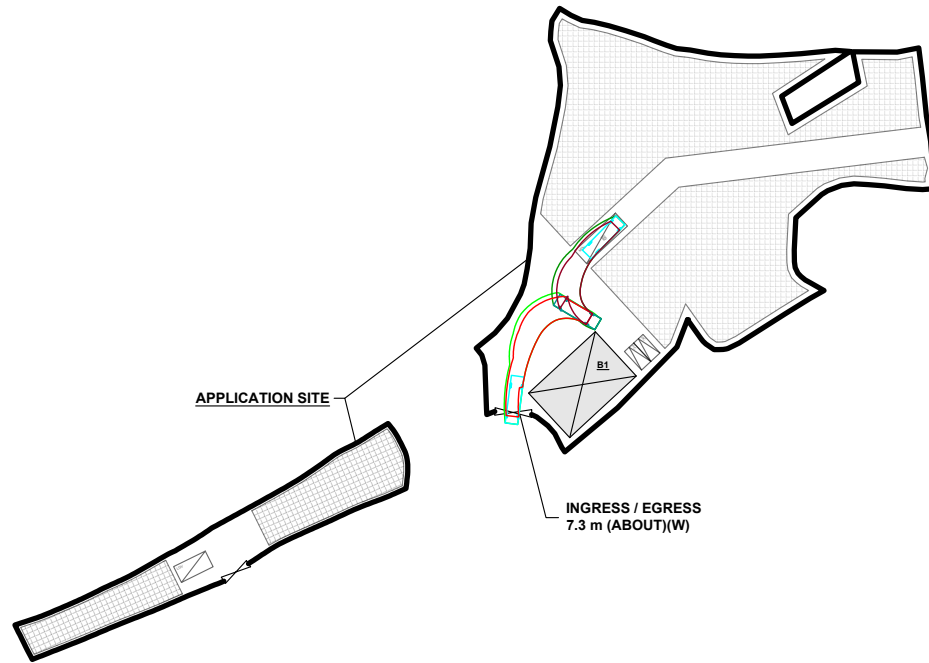

FROM THE APPLICATION SITE
 TO THE LOCAL ACCESS

LEGEND

- APPLICATION SITE
- STRUCTURE
- PARKING SPACE (PRIVATE CAR)
- LUL SPACE (LIGHT GOODS VEHICLE)
- LUL SPACE (MEDIUM GOODS VEHICLE)
- INGRESS / EGRESS
- MEDIUM GOODS VEHICLE
- SWEPT PATH OF VEHICLE

SITE BOUNDARY FOR IDENTIFICATION PURPOSE ONLY.

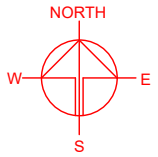

PLANNING CONSULTANT



PROJECT

PROPOSED TEMPORARY OPEN STORAGE OF CONSTRUCTION MATERIAL AND MACHINERY WITH ANCILLARY FACILITIES FOR A PERIOD OF 3 YEARS AND ASSOCIATED FILLING OF LAND

SITE LOCATION

VARIOUS LOTS IN D.D. 82, TA KWU LING, NEW TERRITORIES

SCALE

1 : 1500 @ A4

DRAWN BY

MN

DATE

16.5.2024

CHECKED BY

DATE

APPROVED BY

DATE

DWG. TITLE

SWEPT PATH ANALYSIS (MGV)

DWG NO.

PLAN 7

VER.

001

SWEPT PATH ANALYSIS

TYPE OF VEHICLE : LIGHT GOODS VEHICLE
 DIMENSION OF VEHICLE : 2.1 m (W) X 5.2 m (L)

SWEPT PATHS GENERATED BY AUTODESK VEHICLE TRACKING 2024

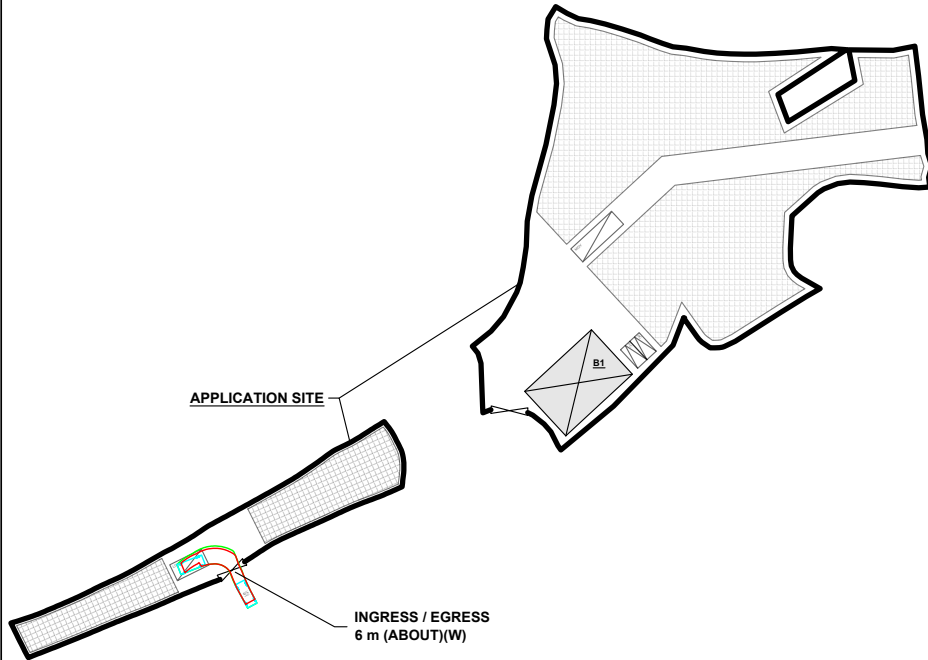

FROM THE LOCAL ACCESS TO THE APPLICATION SITE

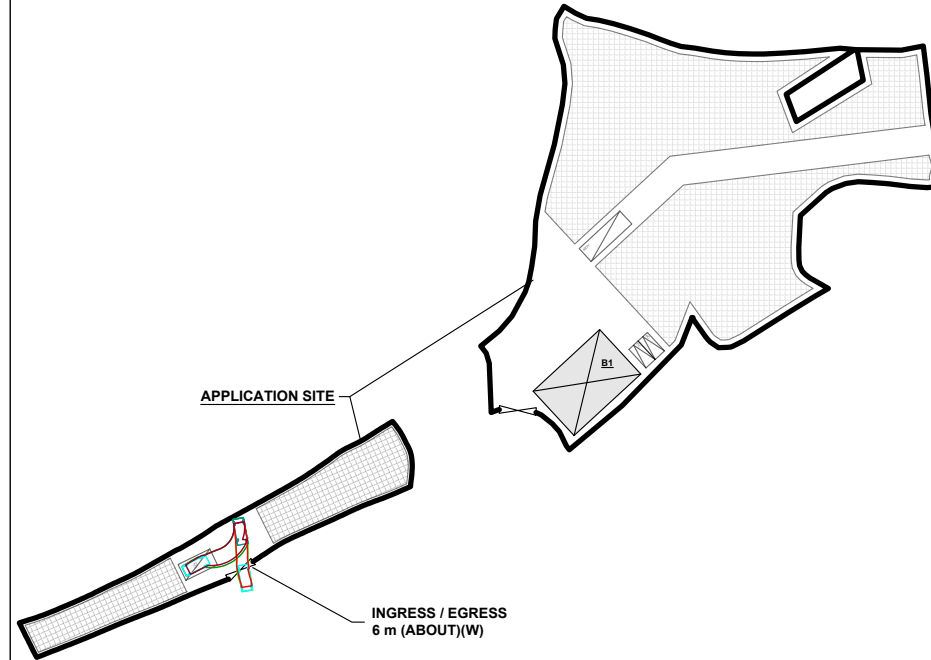

FROM THE APPLICATION SITE TO THE LOCAL ACCESS

LEGEND

- APPLICATION SITE
- STRUCTURE
- PARKING SPACE (PRIVATE CAR)
- L/U/L SPACE (LIGHT GOODS VEHICLE)
- L/U/L SPACE (MEDIUM GOODS VEHICLE)
- INGRESS / EGRESS
- MEDIUM GOODS VEHICLE
- SWEPT PATH OF VEHICLE

SITE BOUNDARY FOR IDENTIFICATION PURPOSE ONLY.

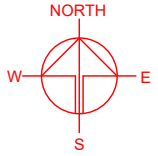

PLANNING CONSULTANT



PROJECT

PROPOSED TEMPORARY OPEN STORAGE OF CONSTRUCTION MATERIAL AND MACHINERY WITH ANCILLARY FACILITIES FOR A PERIOD OF 3 YEARS AND ASSOCIATED FILLING OF LAND

SITE LOCATION

VARIOUS LOTS IN D.D. 82, TA KWU LING, NEW TERRITORIES

SCALE

1 : 1500 @ A4

DRAWN BY MN	DATE 17.5.2024
----------------	-------------------

CHECKED BY	DATE
------------	------

APPROVED BY	DATE
-------------	------

DWG. TITLE
SWEPT PATH ANALYSIS (LGV)

DWG NO. PLAN 8	VER. 001
-------------------	-------------