

SITE PLAN

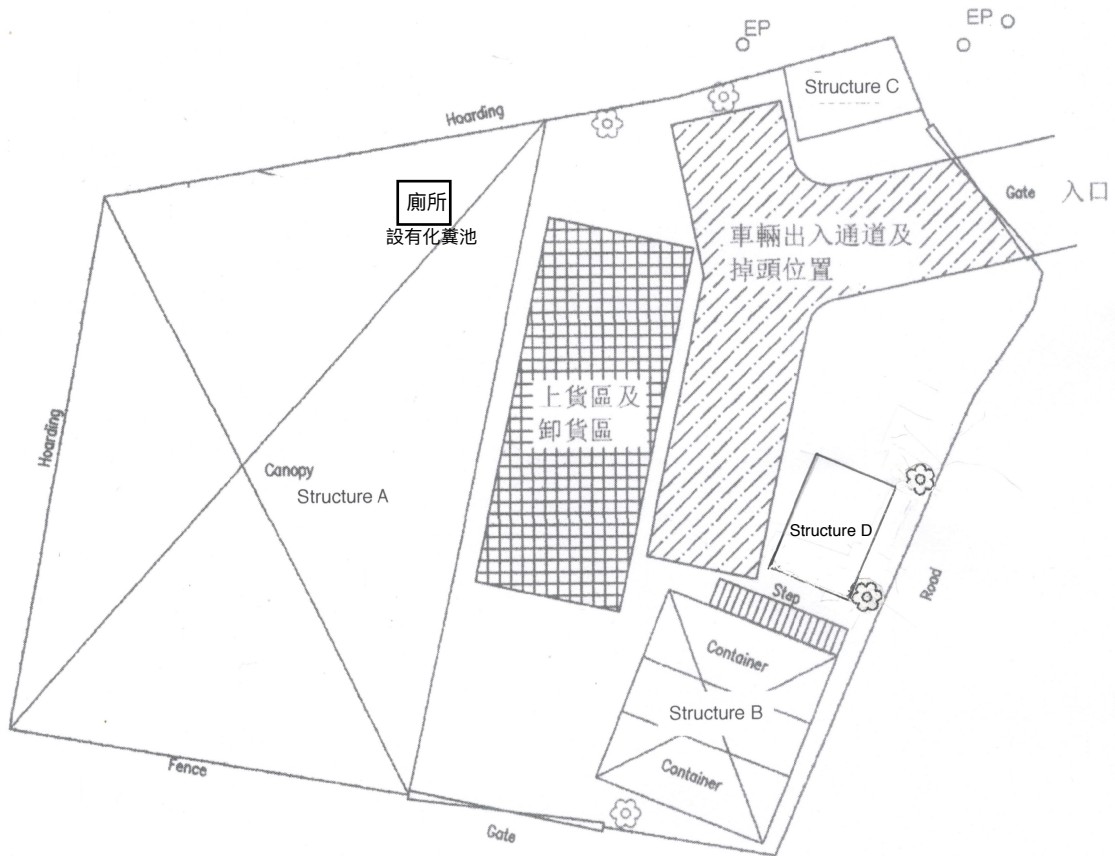

SYMBOLS :

- CANOPY
- 🌸 TREE
- ++ FENCE/HOARDING
- ⚡ GATE
- 📏 上貨區及卸貨區
- ▨ 車輛出入通道及掉頭位置

卓弘測量服務公司
CHUO WANG SURVEY SERVICES COMPANY

G/F, No. 21A, Luen Hing Street, Luen Wo Hui, Fanling, N.T.
Telephone : 26831600 Mobile : 66862836 Fax : 26831380
E-mail : chuowang.ssc@gmail.com / h.y.pang@hotmail.com

Project Title
LOT 2195 RP (PART) IN D.D. 76 AND ADJOINING GOVERNMENT LAND,
KWAI TEI NORTH VILLAGE, FANLING, N.T.

Scale
1 : 250

Figure No.
2B

Figure Title
SITE PLAN

Date
7-11-2012

Revision
-

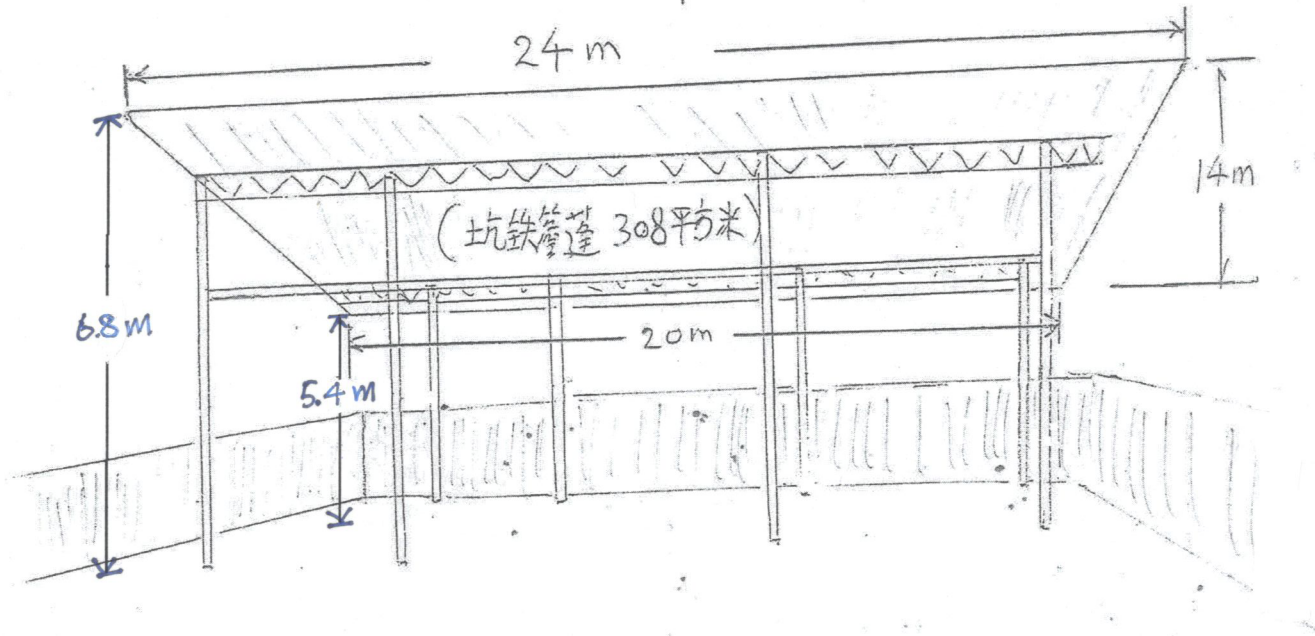

Structure A

$$(20 \times 14) + (4 \times 14 / 2) = 308 \text{ 平方米}$$

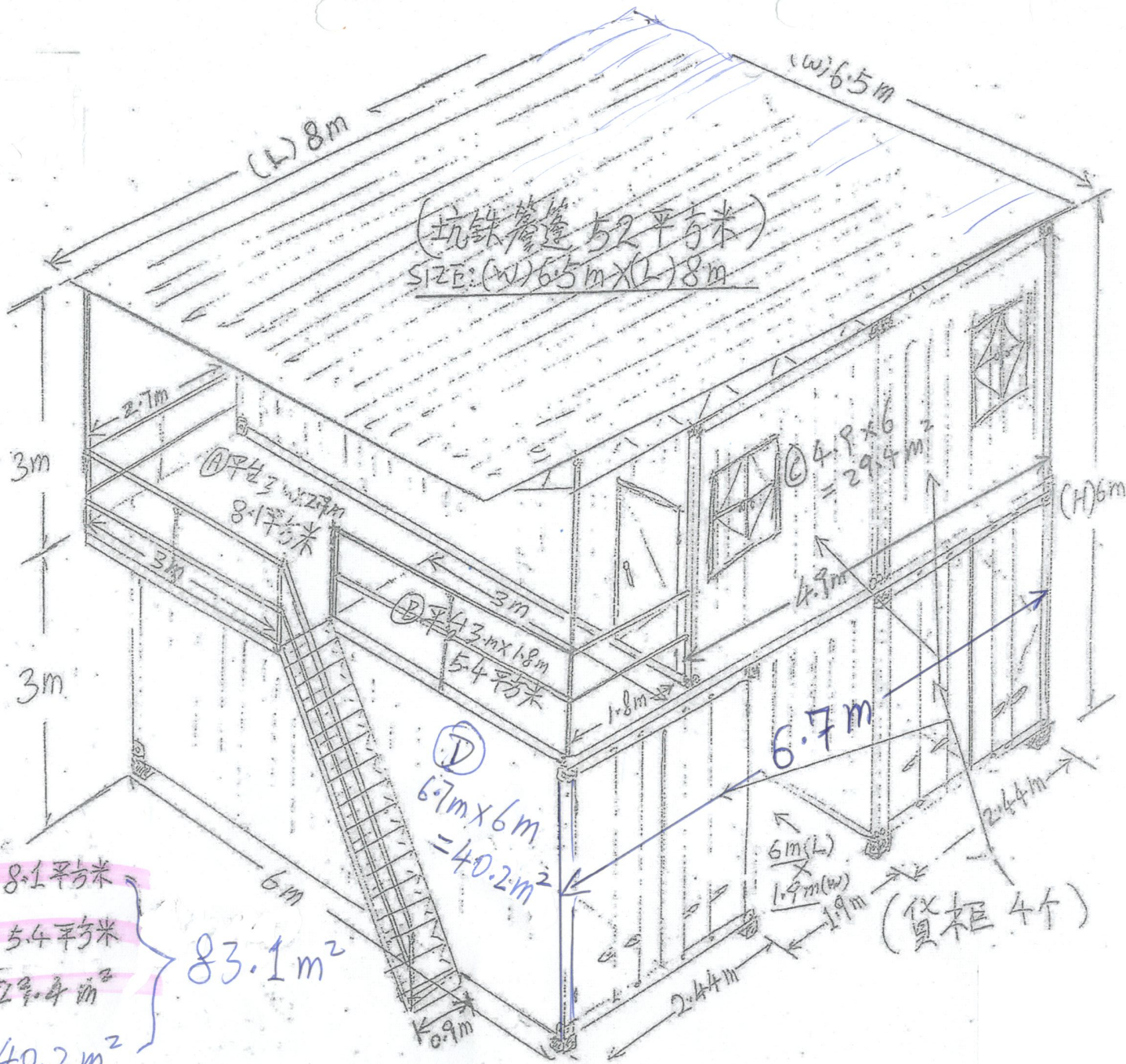

① $3 \times 2.7 = 8.1 \text{ m}^2$
 +
 ② $3 \times 1.8 = 5.4 \text{ m}^2$
 +
 ③ $4.9 \times 6 = 29.4 \text{ m}^2$
 +
 ④ $6.7 \times 6 = 40.2 \text{ m}^2$
 共 = 83.1 m²

① 平台 8.1 平方米
 +
 ② 平台 5.4 平方米
 +
 ③ 29.4 平方米
 +
 ④ 40.2 平方米
 } 83.1 m²

Structure B

$$(4.6 \times 3.8) + (1.4 \times 3.8 / 2) = (20.14 \text{ 平方米})$$

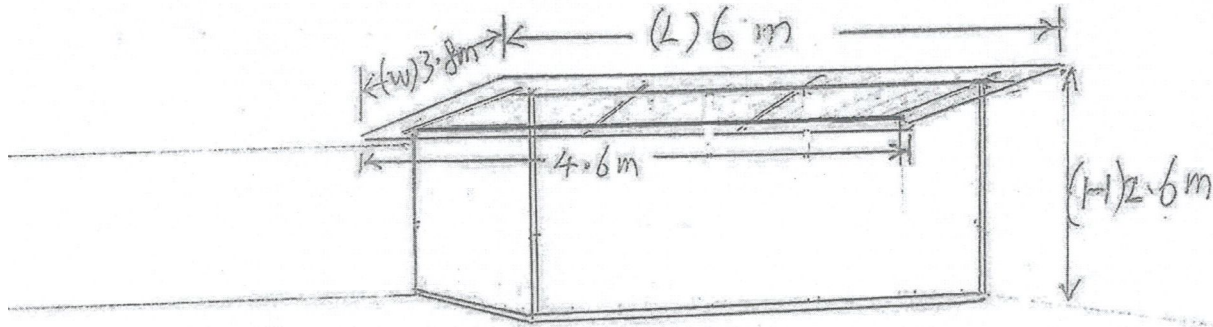

Structure C

面積 37.5 平方米

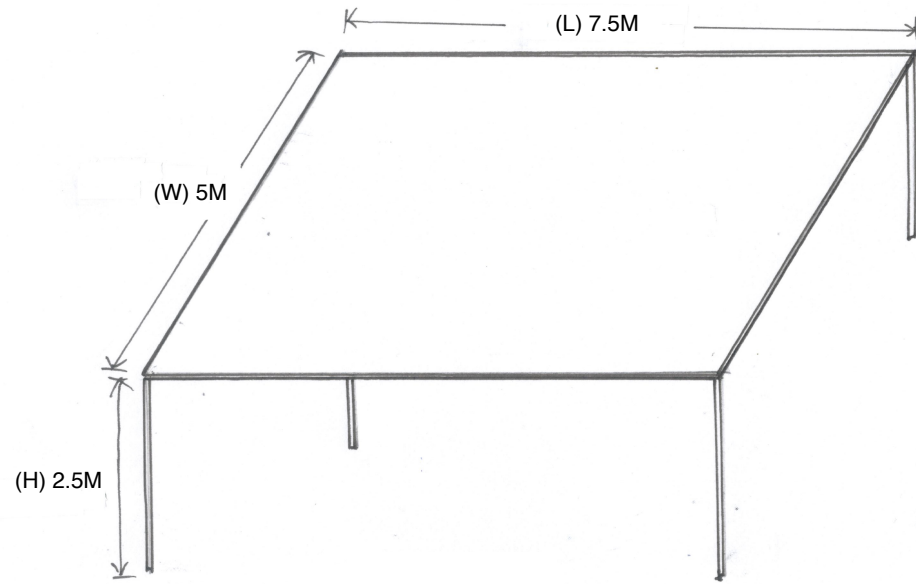

Structure D

車輛路線圖

駛入坪輦路向打鼓嶺方向
見第二組行人斑馬線前
左轉入小路

申請地點
全程約五分鐘

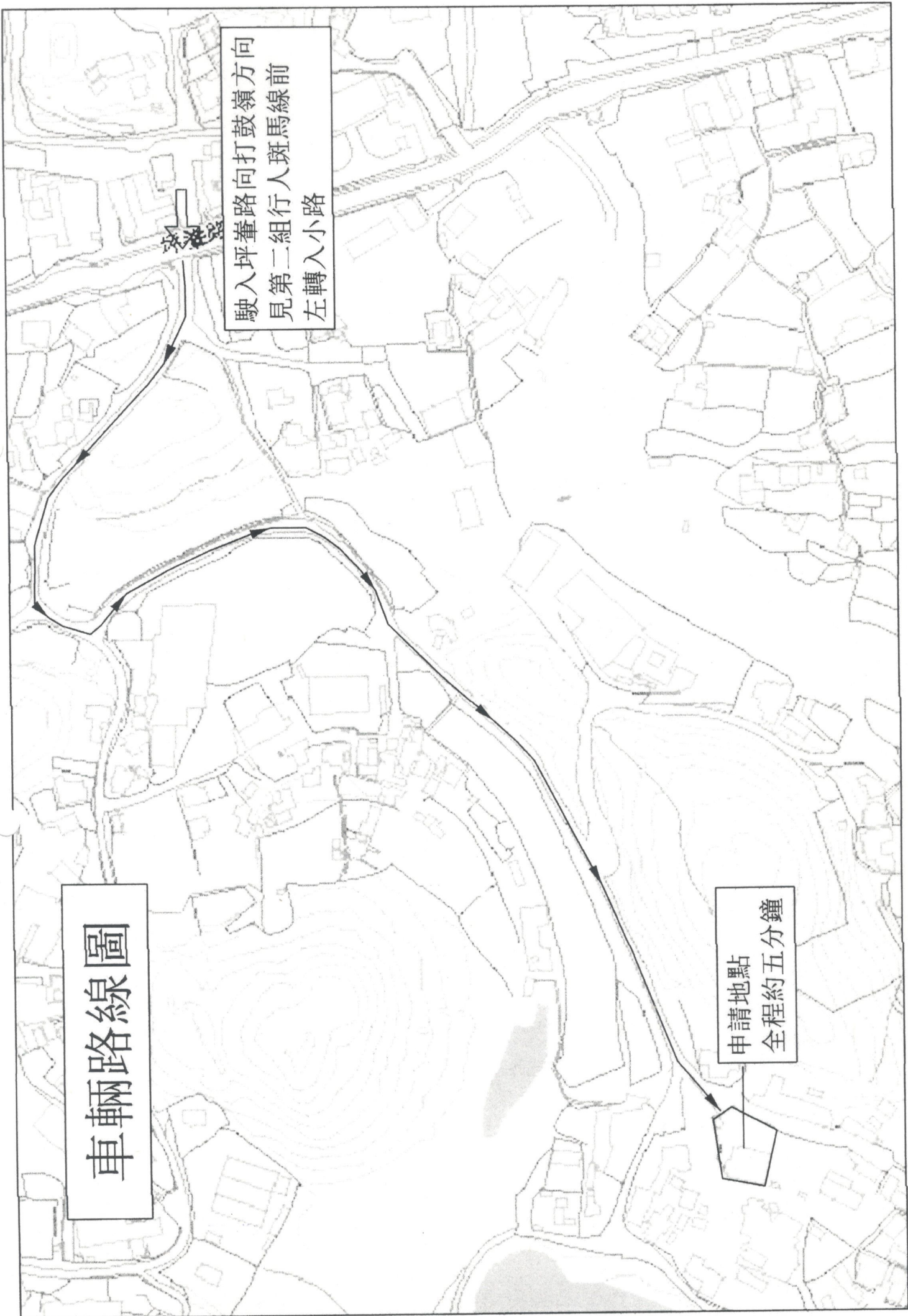



圖 1



圖 2

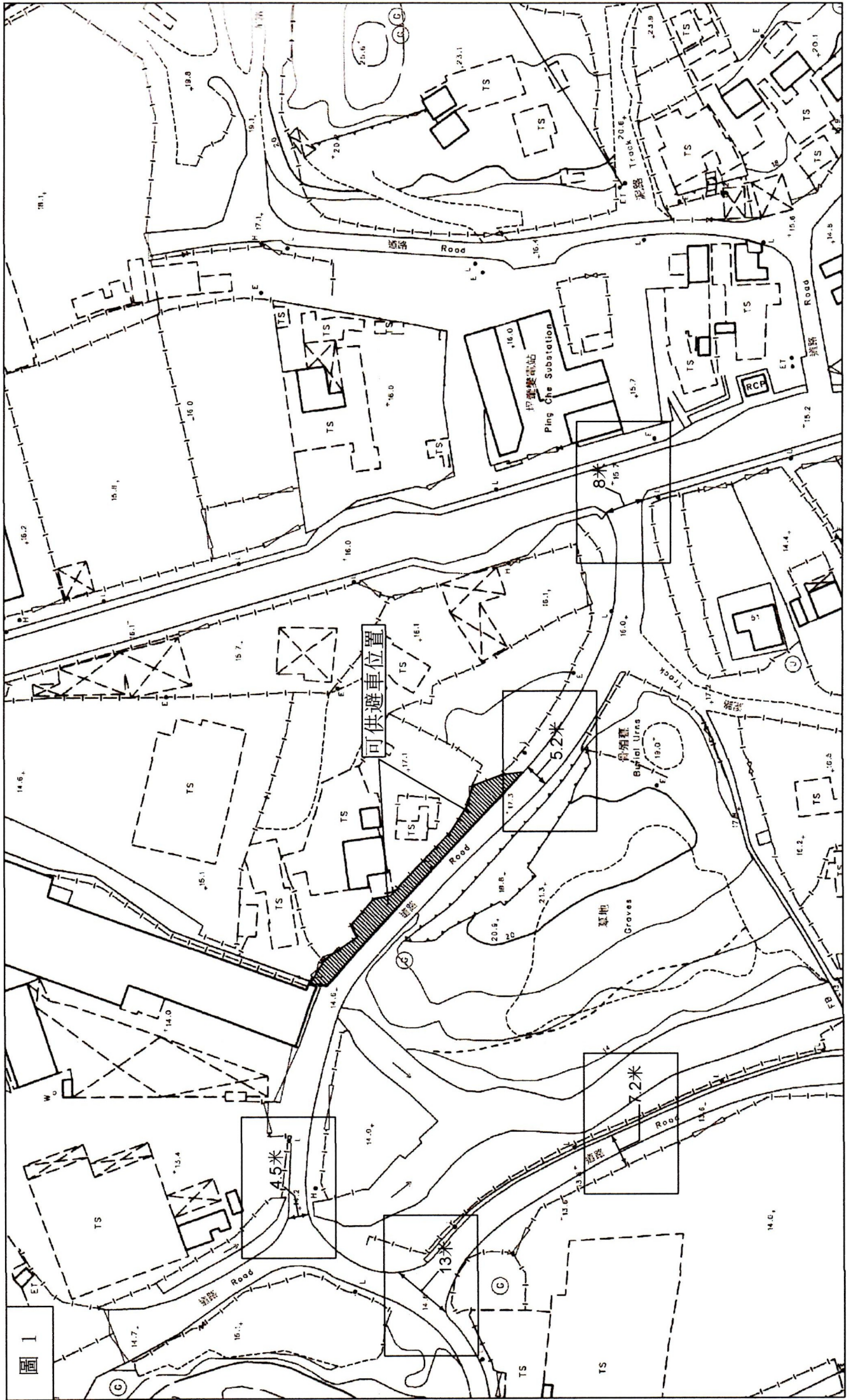

圖 3

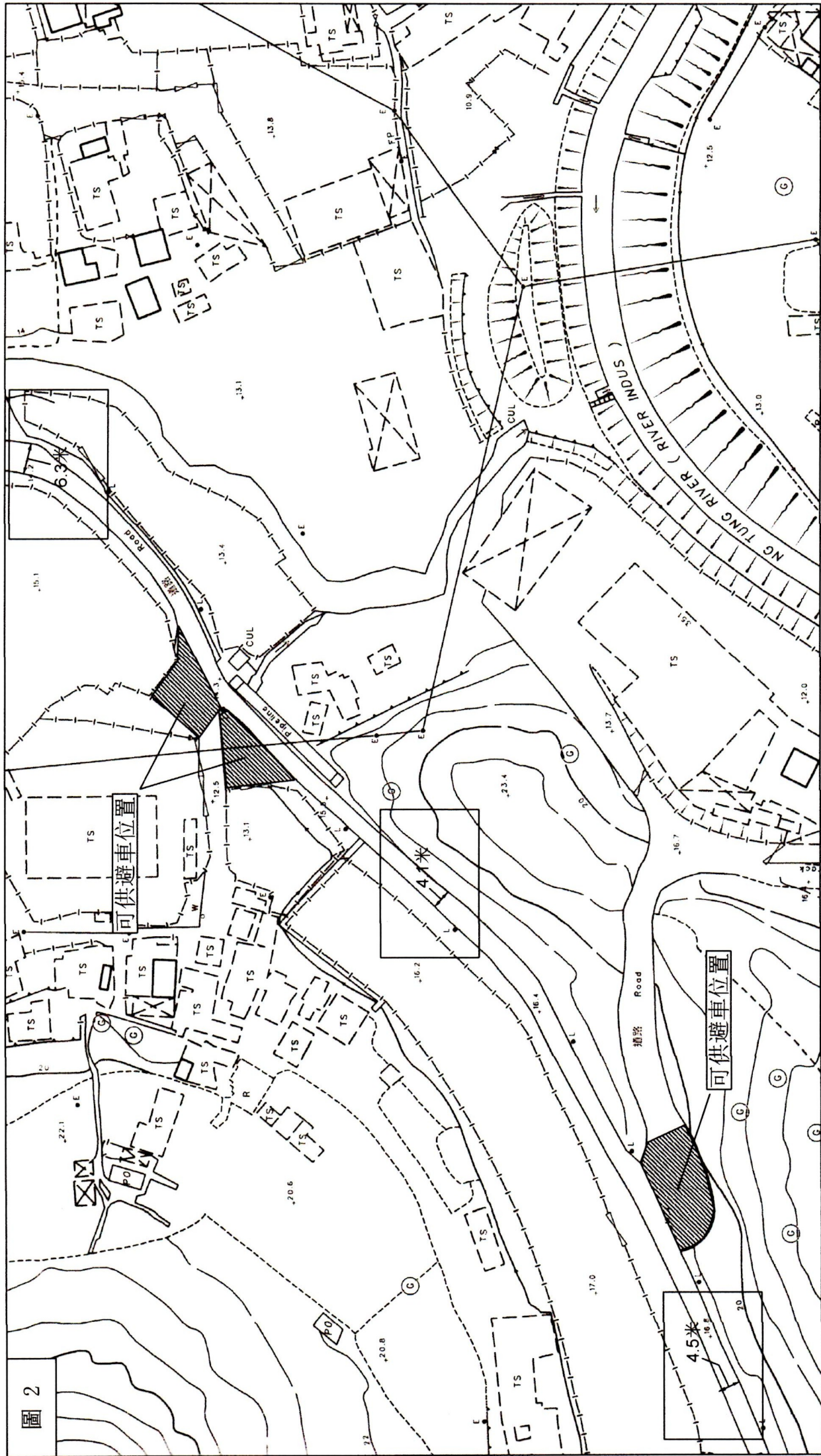

 EMERGENCY VEHICLES ACCESS

卓 弘 測 量 服 務 公 司
CHUO WANG SURVEY SERVICES COMPANY

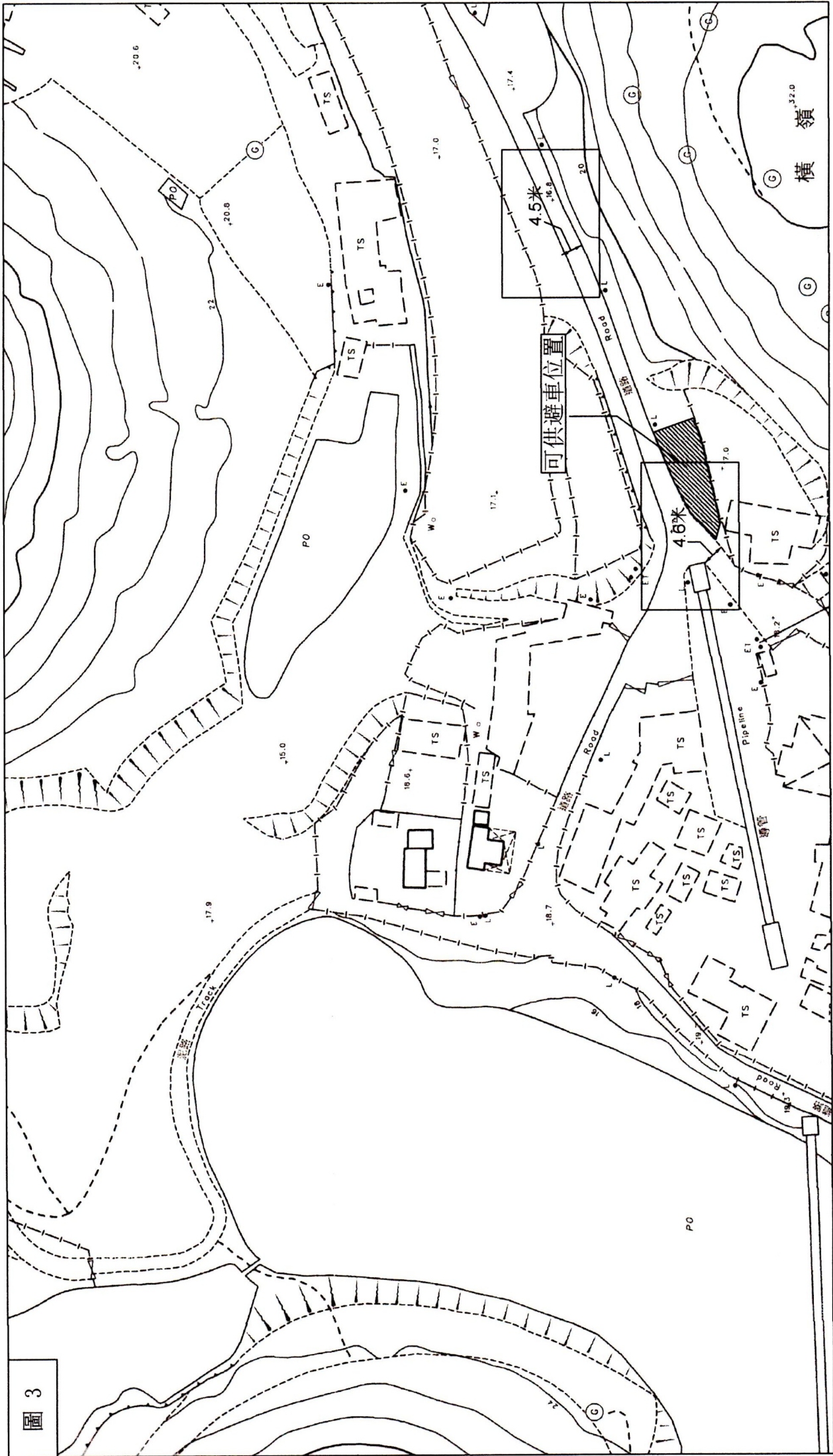
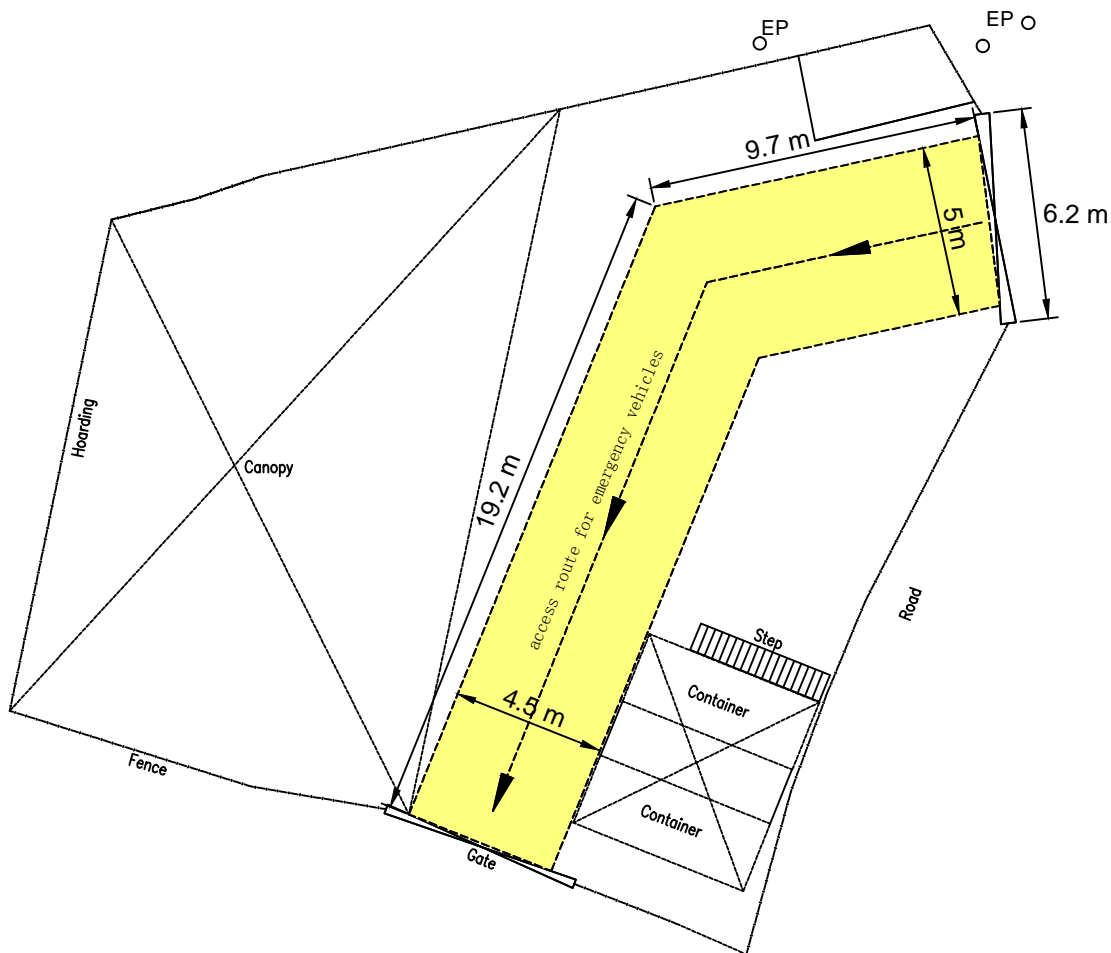
G/F, No.21 A, Luen Hing Street, Luen Wo Hui, Fanling, N.T.
Telephone : 26831600 Mobile : 66862836 Fax : 26831380
E - mail : chuowang.ssc@gmail.com / h.y.pang@hotmail.com

Project Title LOT 2195 RP (PART) IN D.D. 76 AND ADJOINING GOVERNMENT LAND,
KWAI TEI NORTH VILLAGE, FANLING, N.T.

Figure Title EMERGENCY VEHICLES ACCESS LAYOUT PLAN

Scale - Figure No. 6

Date 04-07-2013 Revision --

EXISTING STORMWATER PIPE (Ø150) (FROM PUMP HOUSE TO OUT FALL)

EXISTING CATCHPIT WITHIN BOUNDARY LINE

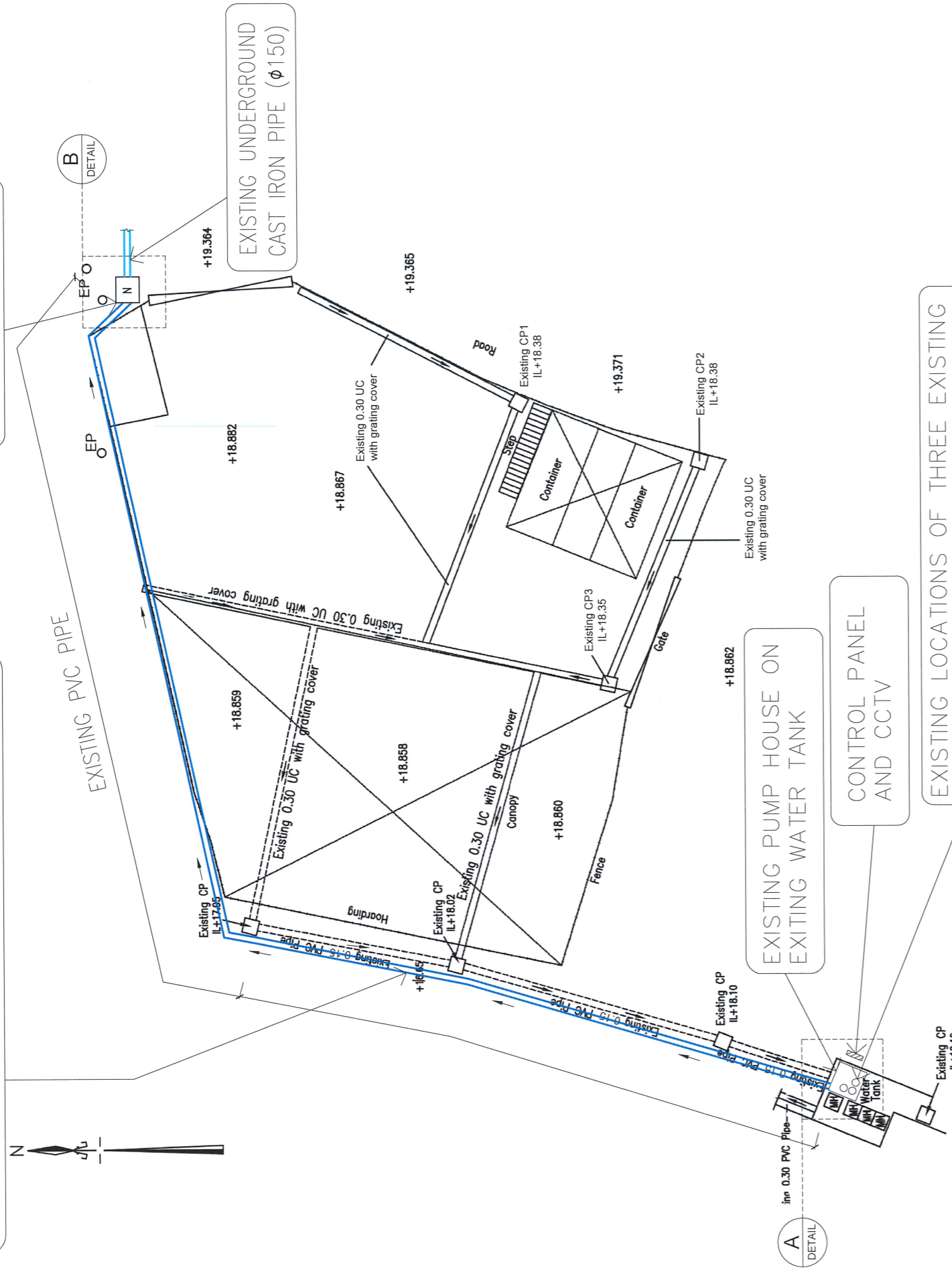

B
DETAIL

A
DETAIL

LEGEND :

- CATCHPIT
- + 13.50 SPOT LEVEL
- +IL13.50 INVERT LEVEL
- MH MANHOLE
- FB FLOWER BED
- 300 UC 300 UC, 0.30 METRE IN DIAMETER
- 150 UC 150 UC, 0.30 METRE IN DIAMETER

LEGEND FOR EXISTING STORM WATER DRAINAGE SYSTEM:

- DIRECTION OF WATER FLOW
- N
- ▨ CCTV AND CONTROL PANEL
- ▬ EXISTING CATCHPIT
- ▬ EXISTING UNDERGROUND CAST IRON PIPE (Ø150)
- ▬ EXISTING GALVANIZED IRON PIPE (Ø150)

EXISTING PUMP HOUSE ON EXITING WATER TANK

CONTROL PANEL AND CCTV

EXISTING LOCATIONS OF THREE EXISTING PUMPS (TWO FOR DUTY AND ONE FOR STANDBY)

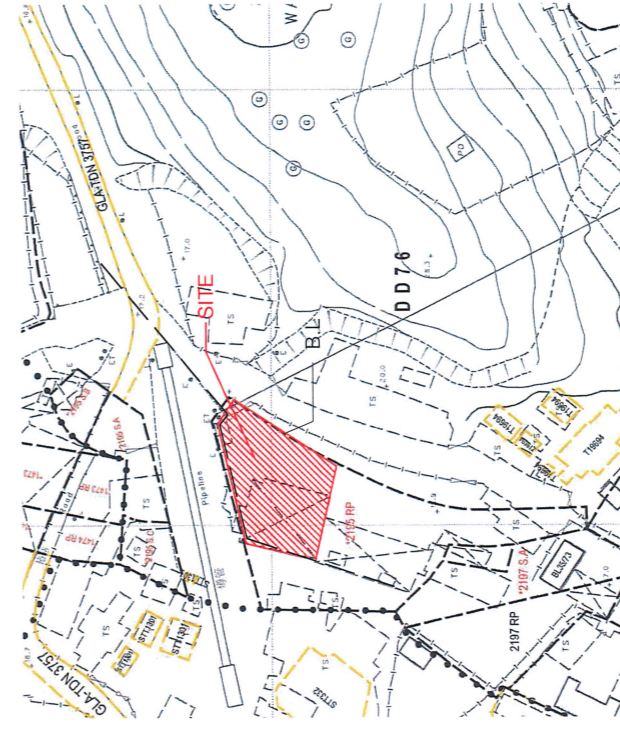

BLOCK PLAN SCALE: 1:2000

EXISTING LAYOUT PLAN

1:250

<p>M: +852 5444 2737 T: +852 2177 0277 E: ayanpl2009@gmail.com F: +852 2177 0901 UNIT 24, 11/F, BLOCK A, HOI LUEN INDUSTRIAL CENTER, 55 HOI YUEN ROAD, KWUN TONG, HONG KONG</p>	<p>Title EXISTING STORM WATER DRAINAGE SYSTEM</p>	<p>Project 臨時露天存放五金鑄鐵配件連附屬工場 許可續期</p>	<p>Size:- A3</p> <p>Scale:- AS SHOWN</p> <p>Date:- 27/07/21</p> <p>DWG. NO. A19109/01/01 (R)</p>
	<p>1</p>	<p>1</p>	<p>1</p>

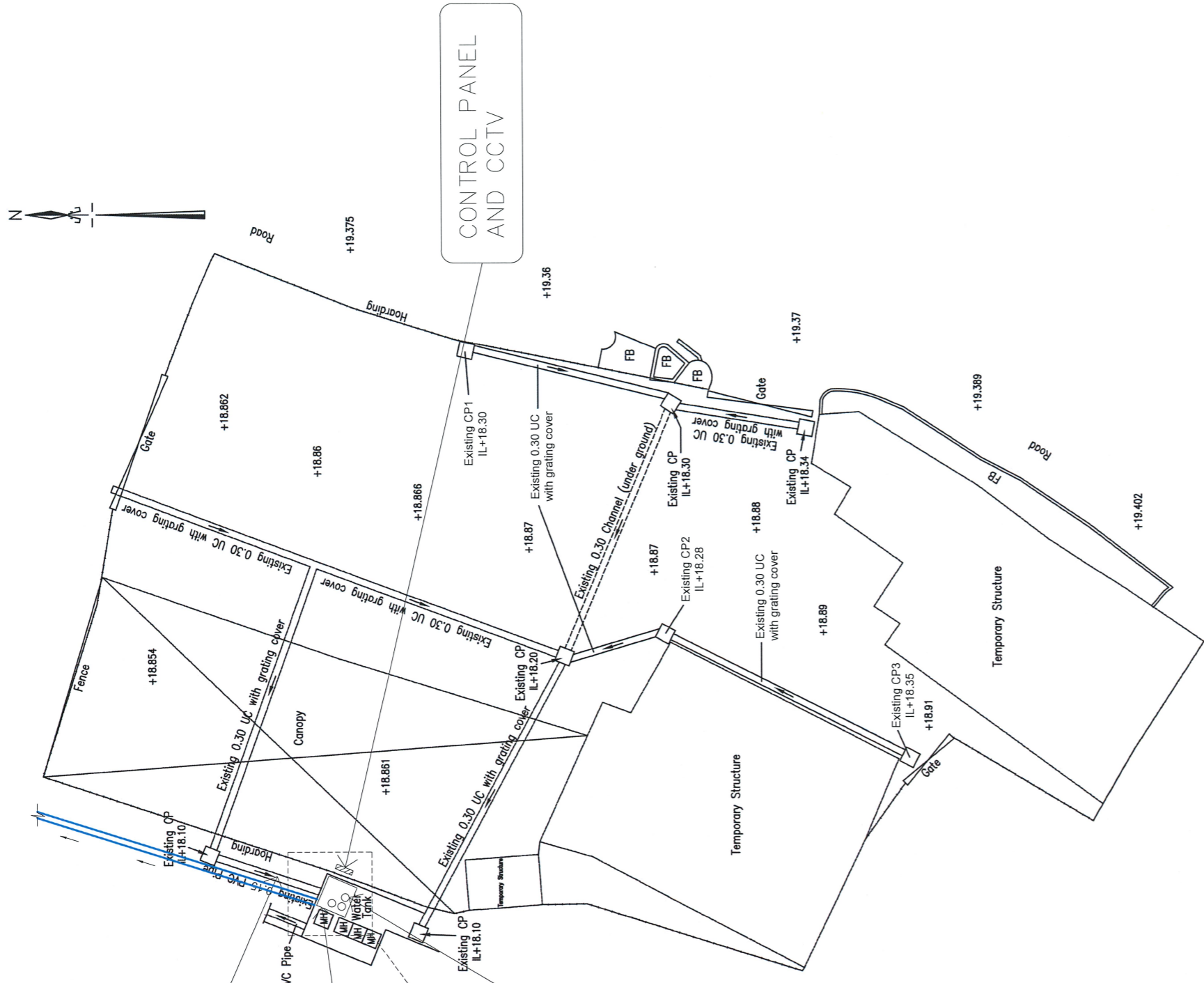

EXISTING STORMWATER PIPE (Ø150) (FROM PUMP HOUSE TO OUT FALL)

EXISTING PUMP HOUSE ON EXISTING WATER TANK

A
DETAIL

EXISTING LOCATIONS OF THREE EXISTING PUMPS (TWO FOR DUTY AND ONE FOR STANDBY)

- LEGEND :
- CATCHPIT
 - + 13.50 SPOT LEVEL
 - +IL13.50 INVERT LEVEL
 - MH MANHOLE
 - FB FLOWER BED
 - UC, 0.30 METRE IN DIAMETER
 - UC, 0.30 METRE IN DIAMETER

LEGEND FOR EXISTING STORM WATER DRAINAGE SYSTEM:

- DIRECTION OF WATER FLOW
- N
- EXISTING CATCHPIT

- EXISTING UNDERGROUND CAST IRON PIPE (Ø150)
- EXISTING GALVANIZED IRON PIPE (Ø150)

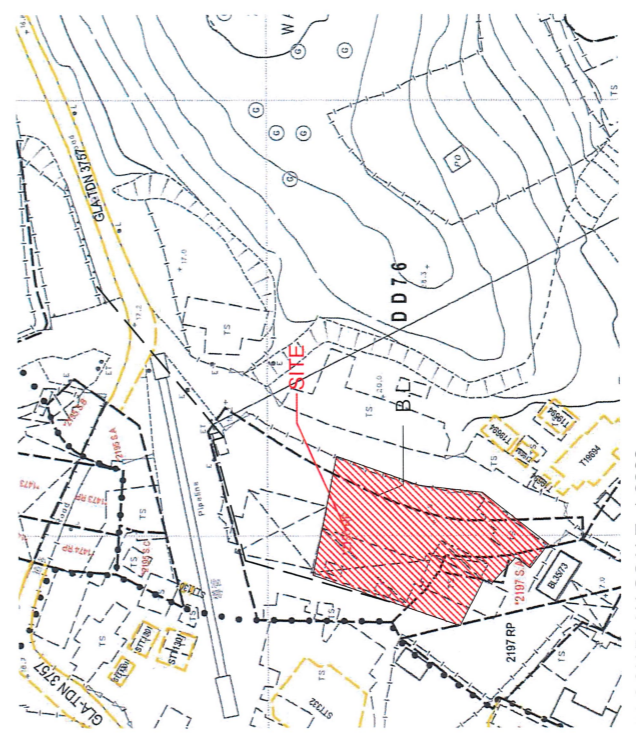

BLOCK PLAN SCALE: 1:2000





2 EXISTING LAYOUT PLAN 1:250

	Tel: +852 5444 2737 Fax: +852 2177 0901 Email: aaymc2009@gmail.com Unit 24, 11/F, Block A, Hoi Luen Industrial Centre, 55 Hoi Yuen Road, Kwun Tong, Hong Kong	Title EXISTING STORM WATER DRAINAGE SYSTEM	Project 臨時倉庫(存放架空天線工程 工具)及狗房的規劃許可續期	A 1 9 1 0 9 Size: A3 Scale: AS SHOWN Date: 27/07/21 DWG. NO. A19109/UT/02 (R)
	-/-			

EXISTING LAYOUT PLAN

1:250

LEGEND FOR EXISTING STORM WATER DRAINAGE SYSTEM:

 DIRECTION OF WATER FLOW
 N
 EXISTING CATCHPIT
 EXISTING UNDERGROUND CAST IRON PIPE (φ150)
 EXISTING GALVANIZED IRON PIPE (φ150)

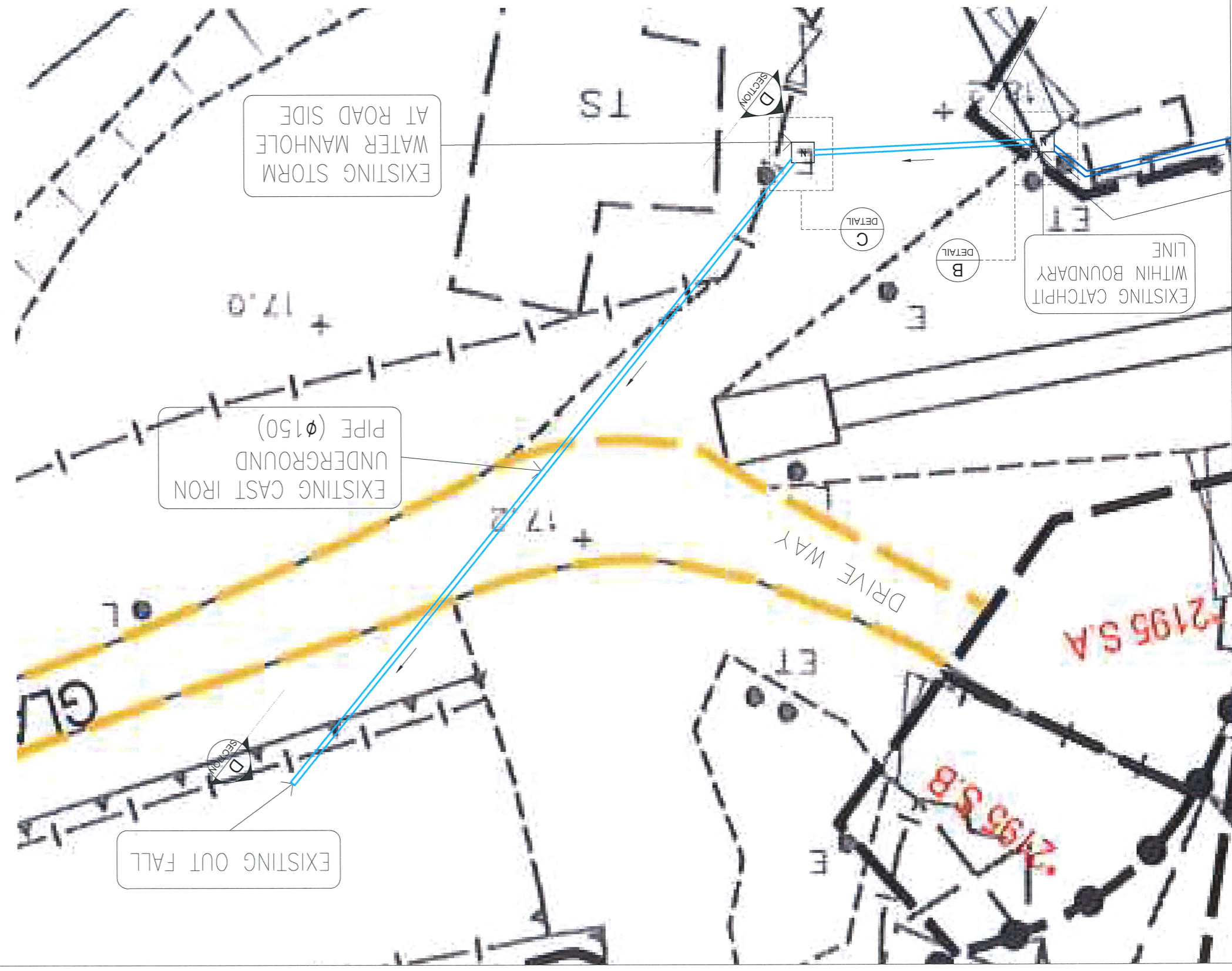
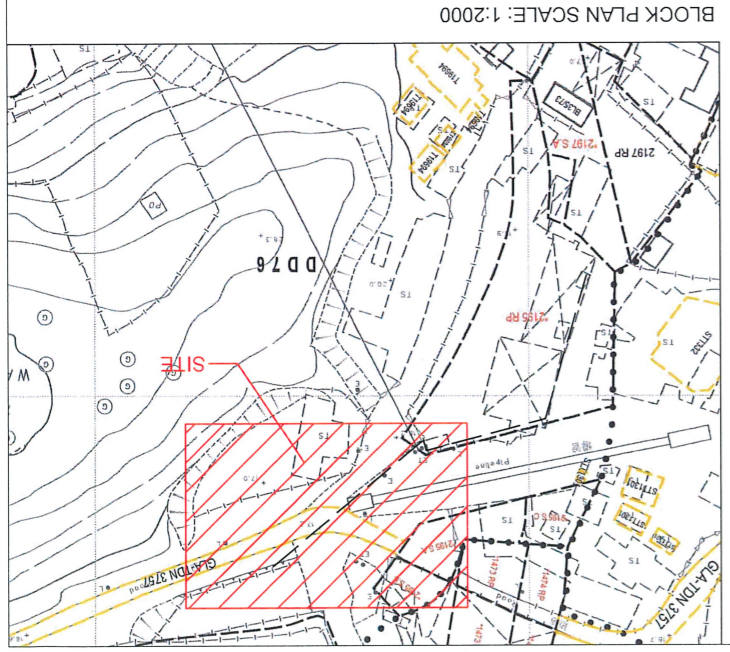

Project
 臨時露天存放五金製品及物料和存放五金鋼鐵配件製品連附屬工
 場及臨時倉庫(存放架空天線工程工具)及狗房的規劃許可續期

消防裝置

露天存放五金製品及物料和存放五金鋼鐵配件製品連附屬工場

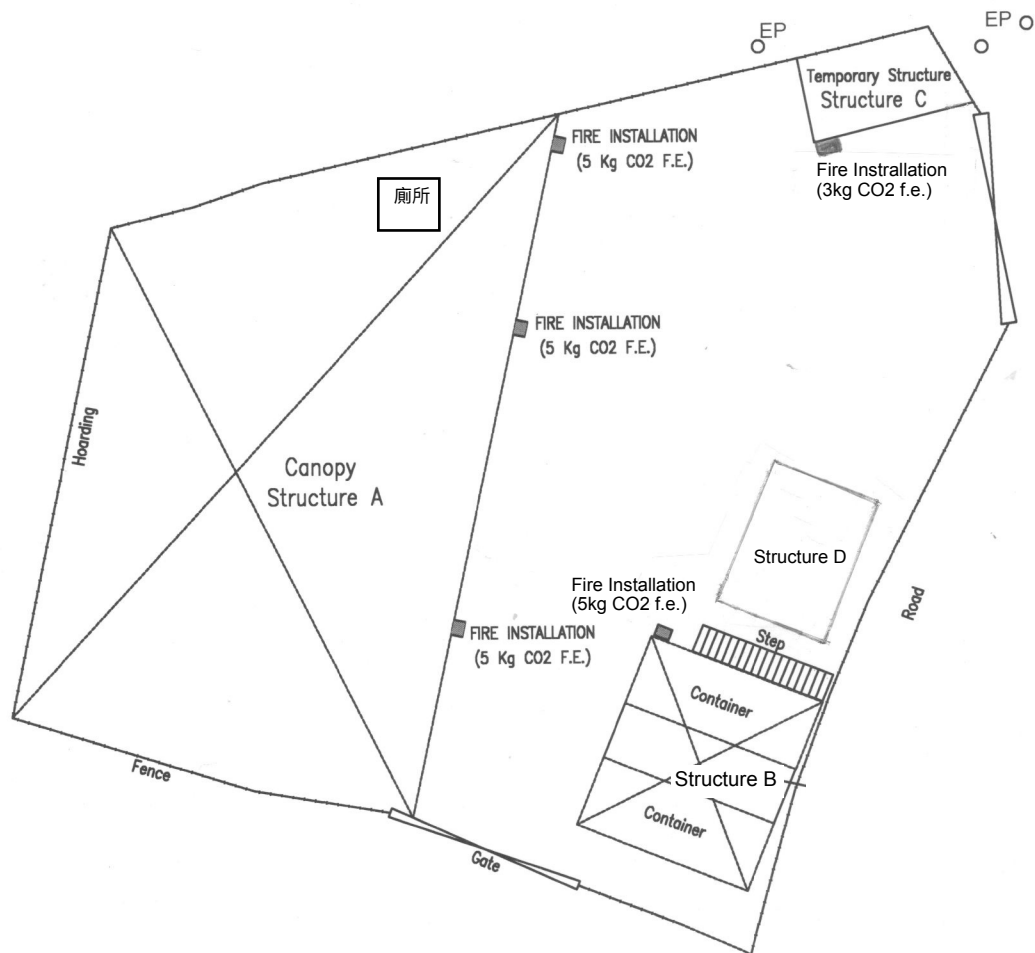

■ FIRE INSTALLATION

備註：此為第5個向城規會申請3年臨時許可申請，今次的申請無論在發展參數及場地布局對與之前TKL686均沒有改變。

距離申請場地約一百米外消防處有設置消防栓。

現設置共5只滅火器 (1 no 3kg CO2 gas f.e.) (4 nos 5kg CO2 gas f.e.)

構築物 A：坑鐵簷篷 上蓋面積308平方米 用作存放車床及工場。

構築物 B：兩層上蓋面積52平方米由4只20呎貨櫃組成，上層辦公室，下層存放物件。

構築物 C：一層上蓋面積20.14平方米 員工休息室。

構築物 D：一層鐵架上蓋面積37.5平方米 存放工具及物料。

卓 弘 測 量 服 務 公 司
CHUO WANG SURVEY SERVICES COMPANY

G/F, No.21 A, Luen Hing Street, Luen Wo Hui, Fanling, N.T.
Telephone : 26831600 Mobile : 66862836 Fax : 26831380
E - mail : chuowang.ssc@gmail.com / h.y.pang@hotmail.com

Project Title LOT 2195 RP (PART) IN D.D. 76 AND ADJOINING GOVERNMENT LAND,
KWAI TEI NORTH VILLAGE, FANLING, N.T.

Scale -- Figure No. 1

Figure Title LOCATION OF FIRE INSTALLATIONS

Date -- Revision --

FIRE SERVICE (INSTALLATIONS AND EQUIPMENT) REGULATIONS

消防 (裝置及設備) 規例

(Regulation 9(1))

(第九條 (1) 款)

A 9434131

FSD Ref.:

消防處檔號

CERTIFICATE OF FIRE SERVICE INSTALLATION AND EQUIPMENT

消防裝置及設備證書

Name of Client: 長城機械工程有限公司
顧客姓名

Name of Building:
樓宇名稱

Street No./Town Lot: 76 地段 2195 號 Street/Road/Estate Name: 車地北邨
門牌號數/市地段 街道/屋苑名稱

Block: 座 District: 粉嶺坪輦 Area: HK 香港 K 九龍 NT 新界
座 分區 地區

Type of Building 樓宇類型: Industrial 工業 Commercial 商業 Domestic 住宅 Composite 綜合 Licensed premises 持牌處所 Institutional 社團

Part 1 Annual Inspection ONLY
第一部 只適用於年檢事項

In accordance with Regulation 8(b) of Fire Service (Installations and Equipment) Regulations, the owner of any fire service installation or equipment which is installed in any premises shall have such fire service installation or equipment inspected by a registered contractor at least once in every 12 months. 根據消防 (裝置及設備) 規例第八條(b)款, 擁有裝置在任何處所內的任何消防裝置或設備的人, 須每12個月由一名註冊承辦商檢查該等消防裝置或設備至少一次。

Code 編碼 (1-35)	Type of FSI 裝置類型	Location(s) 位置	Comment on Condition 狀況評述	Completion Date 完成日期(DD/MM/YY)	Next Due Date 下次到期日(DDMMYY)
24	1 no 3kg CO2 gas f.e	地下	Conforms with FSD requirements	5-7-2024	4-7-2025

Part 2 第二部 Installation / Modification / Repair / Inspection work 裝置/改裝/修理/檢查工作

Code 編碼 (1-35)	Type of FSI 裝置類型	Location(s) 位置	Nature of Work Carried out 完成之工作內容	Comment on Condition 狀況評述	Completion Date 完成日期(DDMMYY)
24	4 nos 5kg CO2 gas f.e	地下	To supply	Conforms with FSD requirements	5-7-2024

Part 3 第三部 Defects 損壞事項

Code 編碼 (1-35)	Type of FSI 裝置類型	Location(s) 位置	Outstanding Defects 未修缺點	Comment on Defects 缺點評述
			NIL.	



I/We hereby certify that the above installations/equipment have been tested and found to be in efficient working order in accordance with the Codes of Practice for Minimum Fire Service Installations and Equipment and Inspection, Testing and Maintenance of Installations and Equipment published from time to time by the Director of Fire Services. Defects are listed in Part 3.

本人藉此證明以上之消防裝置及設備經試驗, 證明性能良好, 符合消防處處長不時公佈的最低限度之消防裝置及設備守則與裝置及設備之檢查測試及保養守則的規格, 損壞事項列於第三部。

Authorized Signature: 授權人簽署

Wong Hoi Hang

Name: 姓名

Wong Hoi Hang

FSD/RC No.: 消防處註冊號碼

RC 3 / 697

Company Name: 公司名稱

Hang Yue Engineering Consultants Limited

Telephone: 聯絡電話

3617 7738

Date: 日期

9-7-2024

For FSD use only:

Inspected

Key-in

Verified

如證書涉及年檢事項, 應張貼於大廈或處所當眼處以供消防處人員查核

This certificate should be displayed at prominent location of the building or premises for FSD's inspection if any annual maintenance work is involved.

Code 編碼	Type of FSI 裝置類型
1	Audio/Visual Advisory System 聲響/視象警報系統
2	Automatic Actuating Device 自動啟動裝置
3	Automatic Fixed Installation other than Water 不含水的滅火劑自動固定裝置
4	Automatic Fixed Installation using Water 用水作滅火劑的自動固定裝置
5	Deluge System 集水花灑系統
6	Drencher System 水簾系統
7	Dry Riser System 乾喉系統
8	Dust Detection System 塵埃偵測系統
9	Dynamic Smoke Extraction System 機械式排煙系統
10	Emergency Generator 應急發電機
11	Emergency Lighting 應急照明系統
12	Exit Sign 出口指示牌
13	Fire Alarm System (MFA) 火警警報系統
14	Fire Control Centre 消防控制中心
15	Fire Detection System 火警偵測系統
16	Fire Hydrant/Hose Reel System 消防栓/喉轆系統
17	Fire Shutter 防火捲閘
18	Reserved 保留
19	Fixed Automatically Operated Approved Appliance 認可的自動操作固定器具
20	Fixed Foam System 固定泡沫系統
21	Gas Detection System 氣體偵測系統
22	Gas Extraction System 氣體排放系統
23	Hose Reel 消防喉轆
24	Portable Fire Extinguisher 手提滅火筒
25	Portable Hand-operated Approved Appliance 認可的人手操作手提器具
26	Pressurization of Staircase 樓梯增壓
27	Ring Main System with Fixed Pump(s) 裝有固定水泵的環狀水管系統
28	Sprinkler System 花灑系統
29	Static Smoke Extraction System 靜態式排煙系統
30	Supply Tank 供水缸
31	Ventilation/Air Conditioning Control System 通風/空氣調節控制系統
32	Water Spray System 噴水系統
33	Water Supply 供水
34	Street Fire Hydrant System 街道消防栓系統
35	Others 其他

露天存放五金製品及物料和存放五金鋼鐵配件製品連附屬工場

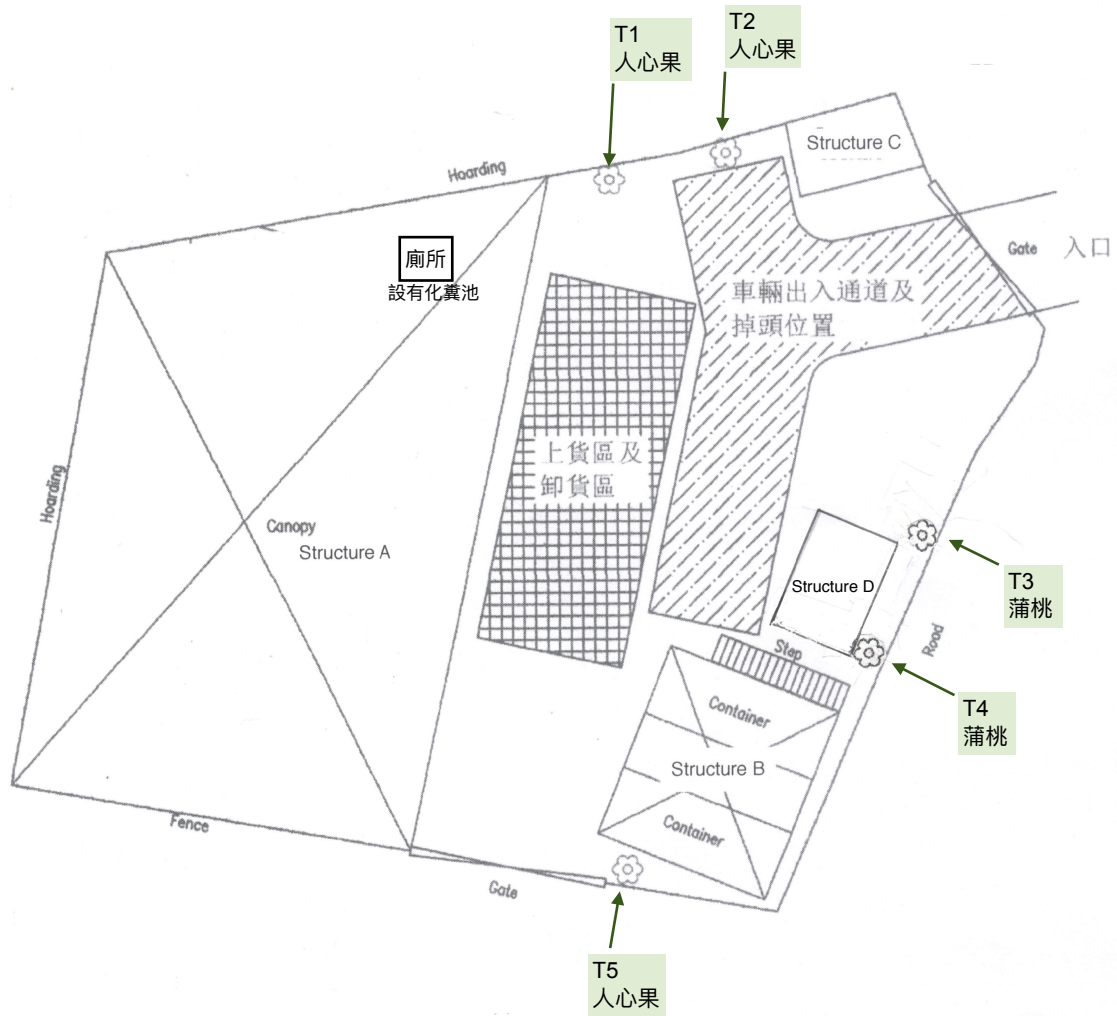

備註：
 此為第五個向城規會申請3年臨時許可申請，
 期間申請用途未有變更



卓弘測量服務公司
 CHUOWANG SURVEY SERVICES COMPANY

GF, No. 21A, Luen Hing Street, Luen Wo Hui, Fanling, N.T.
 Telephone : 26831600 Mobile : 66862836 Fax : 26831380
 E-mail : chuowang.ssc@gmail.com / h.y.pang@hotmail.com

Project Title
 LOT 2195 RP (PART) IN D.D. 76 AND ADJOINING GOVERNMENT LAND,
 KWAI TEI NORTH VILLAGE, FANLING, N.T.

Scale
 1 : 250

Figure No.
 2B

Figure Title
 現有樹木布局圖

Date
 7-11-2012

Revision
 -