

Urgent Return receipt Expand Group Restricted Prevent Copy Confidential

Charlotte Tsz Wing WUN/PLAND

寄件者: Victor Hui [REDACTED]
寄件日期: 2024年11月13日星期三 11:17
收件者: Charlotte Tsz Wing WUN/PLAND
主旨: Planning Applications No. A/NE-TK/826
附件: 2024-11-13 排水Plan.pdf

類別: Internet Email

Dear Ms. Wun,

Attached is the requested plan. Please advise if necessary.

--

Best Regards,
Victor,Hui Kwan Yee

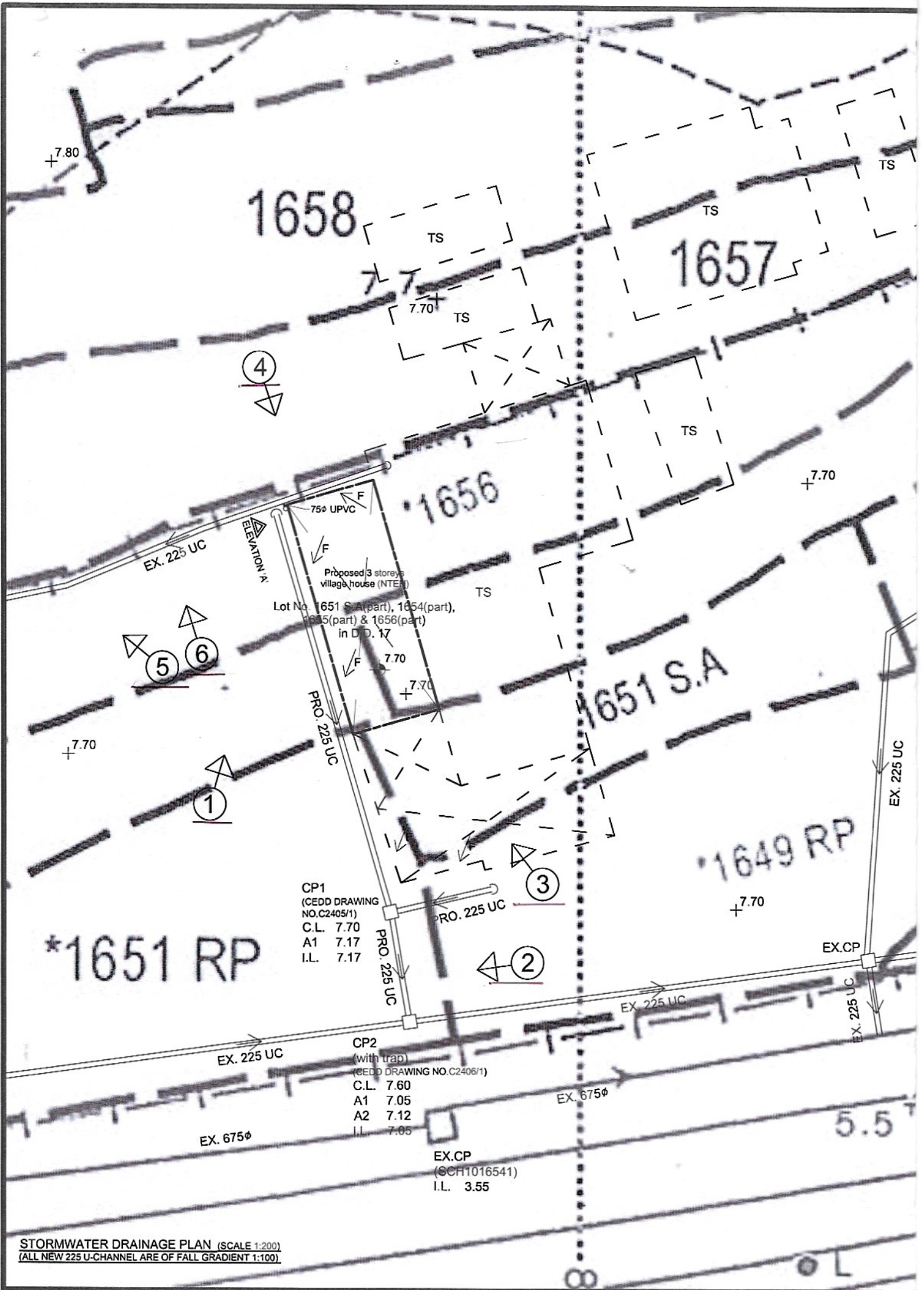

1658

1657

1656

1651 S.A

1649 RP

*1651 RP

Proposed 3 storeys village house (NTEP)
 Lot No. 1651 S.A part, 1654(part),
 1655(part) & 1656(part)
 in D.D. 17

CP1
 (CEDD DRAWING
 NO.C2405/1)
 C.L. 7.70
 A1 7.17
 I.L. 7.17

CP2
 (with trap)
 (CEDD DRAWING NO.C2406/1)
 C.L. 7.60
 A1 7.05
 A2 7.12
 I.L. 7.05

















EX.CP
 (SCH1016541)
 I.L. 3.55

STORMWATER DRAINAGE PLAN (SCALE 1:200)
 (ALL NEW 225 U-CHANNEL ARE OF FALL GRADIENT 1:100)

COLOUR INDICATION

- PROPOSED STORMWATER WORKS
- PROPOSED SEWERAGE DRAINAGE WORKS
- CONCRETE WORKS
- STEEL WORKS

LEGEND

-  PROPOSED SITE FORMATION LEVEL
-  EXISTING SITE FORMATION LEVEL
-  FLOW PATTERN
-  SUBJECT LOT BOUNDARY
-  SUBJECT BUILDING LINE
-  EXISTING 225mm / 300mm U-CHANNEL WITH CONC./C.I. COVER
-  PROPOSED 225mm STEP CHANNEL
-  PROPOSED 750 UPVC PIPE FOR RAINWATER ROOF FALL
-  PROPOSED 225 UPVC UNDERGROUND PIPE
-  EXISTING STORMWATER MANHOLE
-  PROPOSED STORMWATER CATCHPIT
-  PROPOSED SEWERAGE MANHOLE
-  EXISTING GOVERNMENT SEWERAGE MANHOLE
-  PROPOSED SEWERAGE TERMINAL MANHOLE
-  C.L. COVER LEVEL
-  I.L. INVERT LEVEL
-  D.T.L. DISCONNECTING TRAP LEVEL

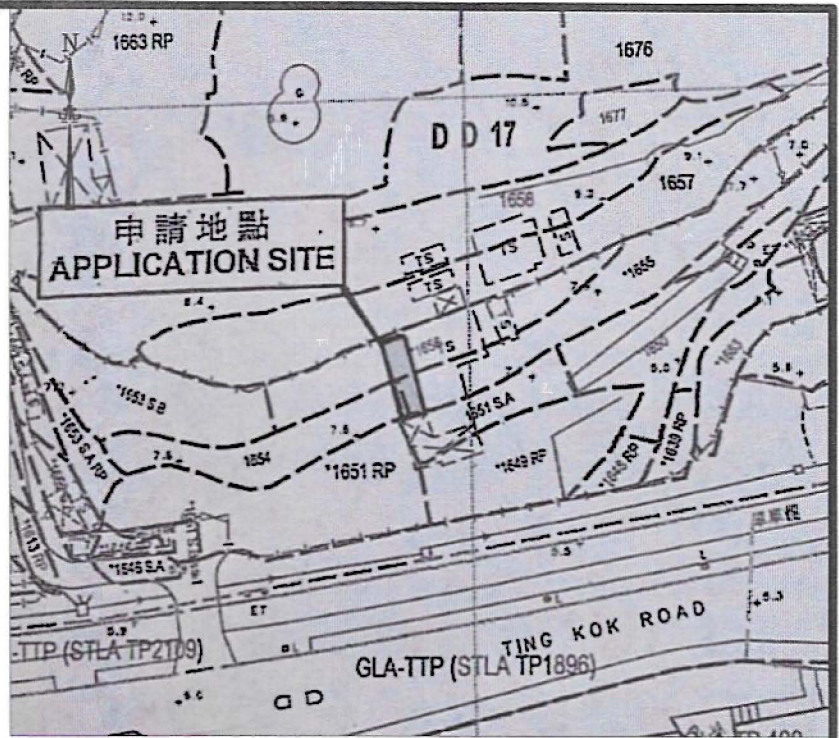

BLOCK PLAN (SCALE 1 : 1000)

NOTES FOR DRAINAGE WORKS

1. Concrete mix to be grade 30D/20 design mix and comply with CSI:1990.
2. Blinding layer to be grade 15P mix.
3. Concrete cover to main steel bar to be 50mm.
4. Reinforcement marked "R" denote mild steel bar ($f_y=250$ MPa) and marked "Y" denote high tensile steel bar ($f_y=460$ MPa) in compliance with B.S.4449: 1988 and CS2: 1995.
5. Confirm that the invert levels of inlet u-channels and outlet u-channels are the same.
6. Confirm that the levels of inlet invert and outlet invert of the proposed catchpits are the same.

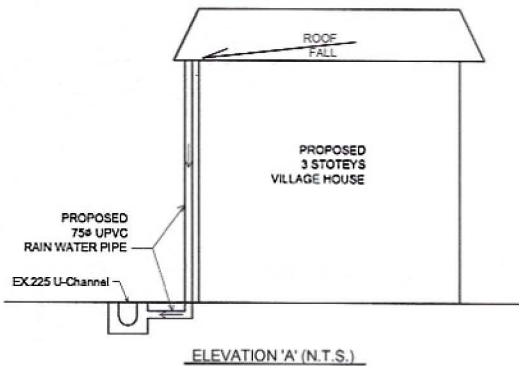

REVISION		
NO.	DATE	AMENDED
1a	10/2023	

THIS SET OF DRAWING INCLUDES:

DLO Ref.:	
Our Ref.:	
	NAME DATE
DRAWN	Veronica Chiu 08/2023
CHECKED	Vincent Li 08/2023

PROJECT
PROPOSED STORMWATER DRAINAGE WORKS on LOT 1651 S.A(part), 1654(part), 1655(part) & 1656(part) in D.D. 17, LO TSZ TIN, TAI PO, N.T.
 Ref. No. : A/NE-TK/826

DRAWING TITLE
BLOCK PLAN, STORMWATER DRAINAGE PLAN, DETAILS AND NOTES

DRAWING NO.	SCALE
D - 1a	AS SHOWN

WINLI
 永利建設
CONSULTING ENGINEERS