

Approved Ting Kok  
Outline Zoning Plan No. S/NE-TK/19

Located in "Village Type Development"

The proposed land use satisfies the column 2 item - Eating Place of Village Type Development at S/NE-TK/19. Proposed Temporary Eating Place for a Period of 3 Years

Application Site  
Site Area: About 43.8 sq.m

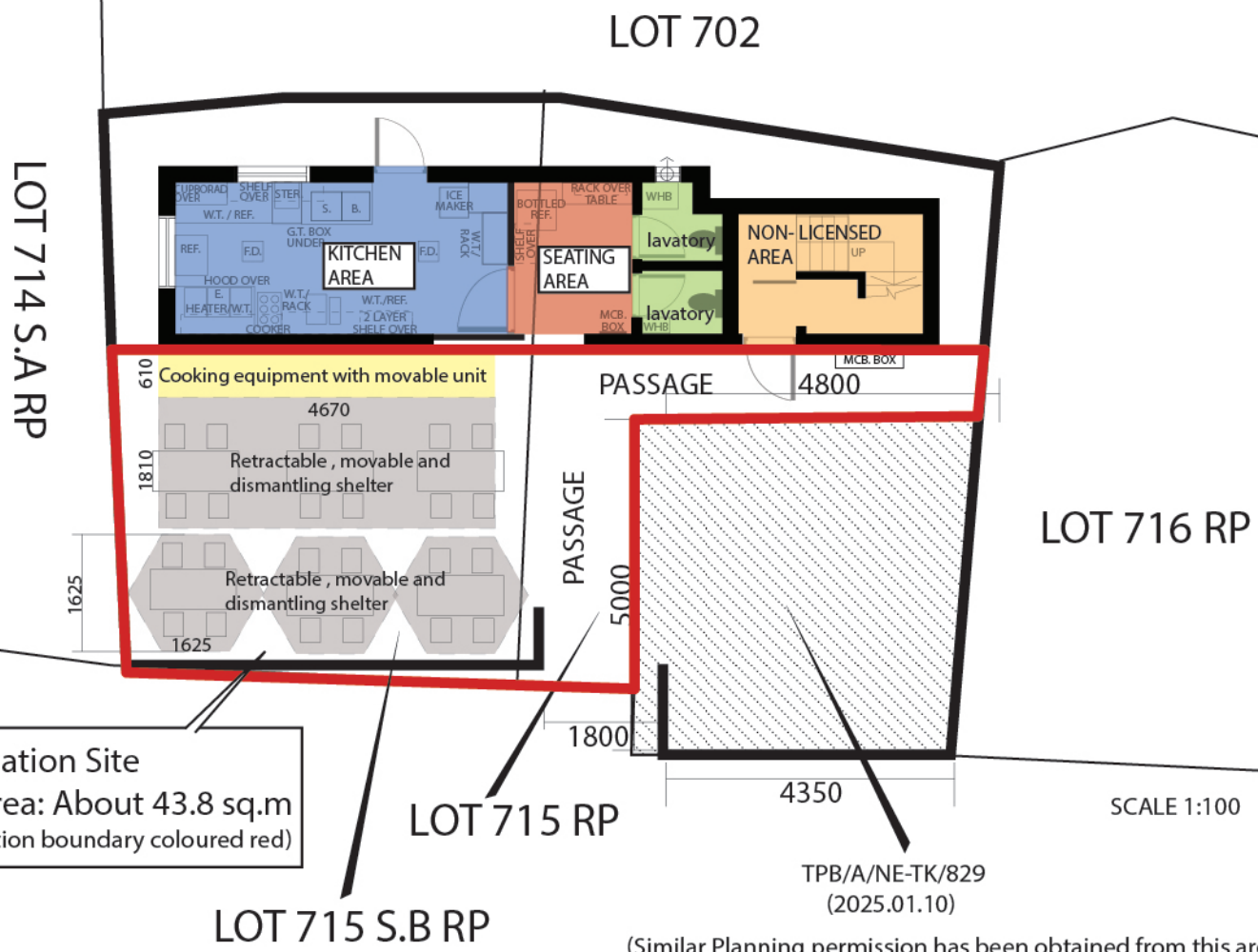

Application Site  
 Site Area: About 43.8 sq.m  
 (Application boundary coloured red)

TPB/A/NE-TK/829  
 (2025.01.10)

(Similar Planning permission has been obtained from this area, but TPB/A/NE-TK/829 is not included in this application)

**Summary**

The application falls within the Village Type Development Land Use Category II coverage - Temporary Eating Place under the Outline Planning Plan S/NE-TK/19. The Town Planning Board approved the adjacent areas under this application for the same application use on January 10, 2025, TPB/A/NE-TK/829.

Tai Mei Tuk is one of the most popular places for outings in Hong Kong, so the applicant hopes to make better use of the land and add value. The cooking equipment with movable units and retractable, movable, and dismantling shelters, as well as seating requirements, do not affect the environment of the surrounding site. Thus, tourists can enjoy the restaurant's food and appreciate the surroundings.

The addition of movable mobile shelters is anticipated to enable guests to eat in a more comfortable environment while avoiding the effects of hot weather or rainy seasons.

The relevant facilities (movable mobile shelter) will only be on top of the seating and tables, and all are retractable, movable, and easy to dismantle. The Applicant only carries out simple cooking activities that do not generate much greasy fumes. It will not cause fire or affect the surrounding.

The application and the existing restaurant area have one sanitary facility with men's and women's toilets, which meets the FEHD requirements. The fire protection system will also have appropriate fire extinguishers to meet environmental needs.

Plan 2

Revised version

Location: Lot 715 RP (Part) & 715 S.B RP (Part) in D.D. 28, Tai Mei Tuk, Tai Po, New Territories

Application: Temporary Eating Place for a Period of 3 Years

Ver.20250220



**Conditions:**  
 The application site is very close to the adjacent planning-approved application A/NE-TK/829, so it has no existing access rights. The relevant drainage/u-channel will be directly through the A/NE-TK/829 drainage design and connected to the government canal to meet the stormwater drainage requirements.

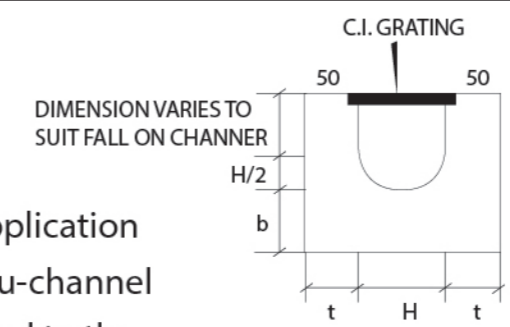

Level of Catchpits		
CP NO.	CL (+MPD)	IL (+MPD)
CP1	4.4	4.1
CP2	4.5	4.2
CP3	4.1	3.8
CP4	4.3	4.0
CP5	4.65	4.35
CP6	4.6	4.3
CP7	4.35	4.05

TYPICAL SECTION OF U-CHANNER

DIMENSION OF U-CHANNER  
 H: 150  
 t: 50  
 b: 100

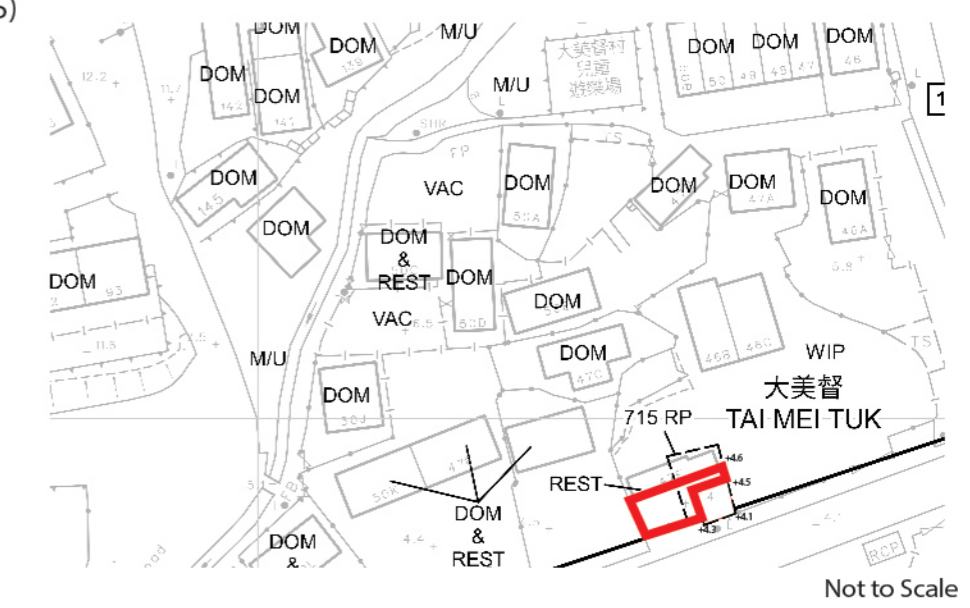
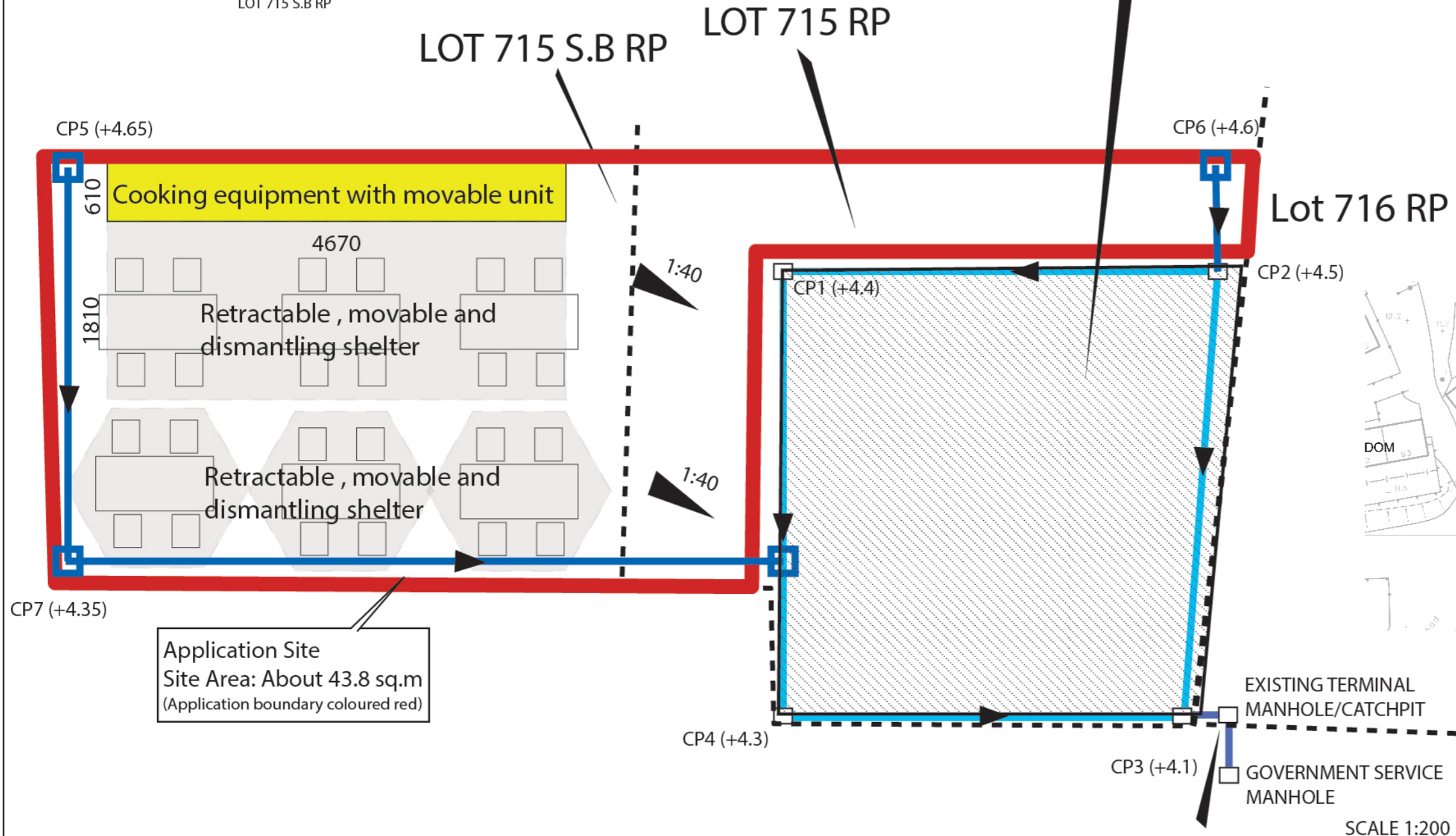
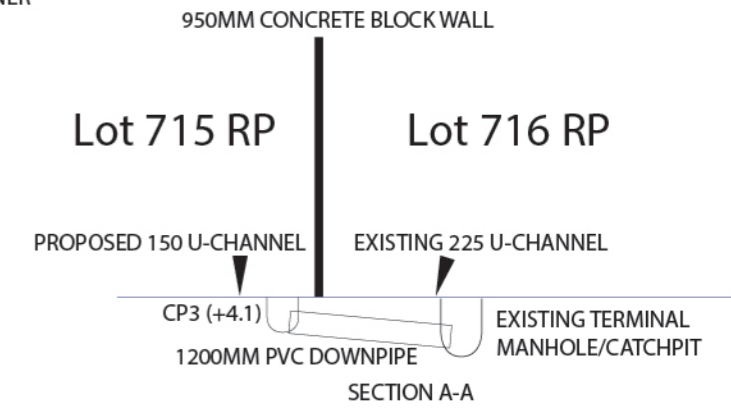

THE 716RP LANDOWNER HAS BEEN APPROVED (WITH A CONSENT PERMIT) AND CAN USE EXISTING MANHOLES WITHIN THE RELEVANT AREA

SCALE 1:200

Plan 3

Location: Lot 715 RP (Part) & 715 S.B RP (Part) in D.D. 28, Tai Mei Tuk, Tai Po, New Territories

Application: Temporary Eating Place for a Period of 3 Years

Revised version

Ver.20250220