





**Proposed Filling and Excavation of Land
for the Permitted “Agricultural Use” in “Conservation Area”
at Various Lots in DD238 in Clear Water Bay
S16 Planning Application**





(Planning Application No: A/SK-CWBN/77)

Appendix I
Revised Layout Plan

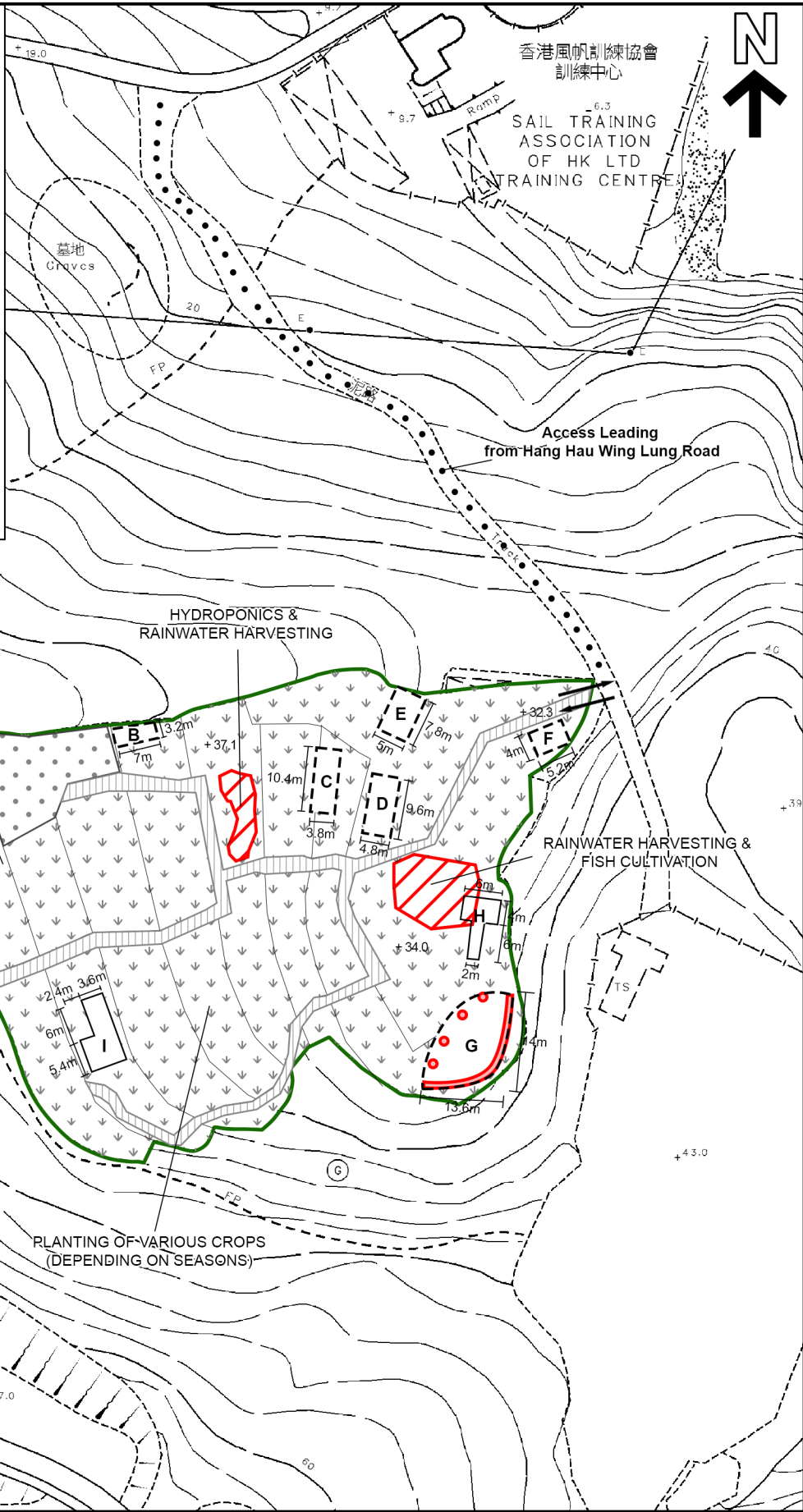
SOMEWHERE ORGANIC FARM LAYOUT
(FOR REFERENCE ONLY, NOT FOR APPROVAL)

-  TEMPORARY STRUCTURE
- A SHELTER FOR WORKERS & VISITORS
- B TOILET/CHANGING ROOM/
STORAGE OF PERSONAL ITEMS/
EQUIPMENT/ CONSUMABLES
- C STORAGE OF COMPOST
- D STORAGE OF CONSUMABLES
(E.G. ORGANIC FERTILIZER)
- E SHELTER FOR LARGE/HEAVY EQUIPMENT
- F CONTROL ROOM/STORAGE OF HOE
AND MATTOCK
- G RESTING AREA
-  PLATFORM
- H RESTING AREA
- I RESTING AREA
-  AGRICULTURAL LAND
-  SUCCULENT GARDEN
-  FOOTPATH



- LEGEND**
-  SOMEWHERE ORGANIC FARM
 -  MAIN ENTRANCE
 - APPLICATION ITEM**
 -  LAND EXCAVATION AREA
 -  LAND FILLING AREA
 - APPLICATION SITE BOUNDARY
FOR IDENTIFICATION PURPOSE ONLY



PLANNING LIMITED
規劃顧問有限公司

LAYOUT PLAN

PROPOSED EXCAVATION AND FILLING OF LAND
IN SUPPORT OF THE EXISTING AGRICULTURAL USE
VARIOUS LOTS IN D.D. 238, CLEAR WATER BAY,
SAI KUNG, NEW TERRITORIES

SCALE 1 : 1 000

PLAN 2

EXTRACT PLAN BASED ON
SURVEY SHEETS No. 12-NW-17B

DATE: 26.7.2024