

Appendix 3

Broad-brush Tree Survey

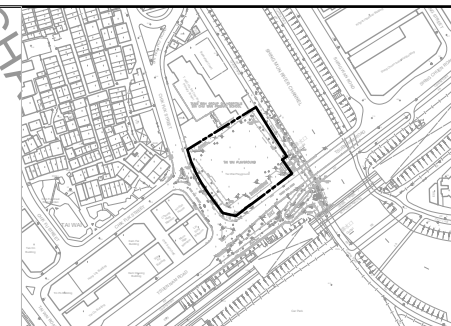
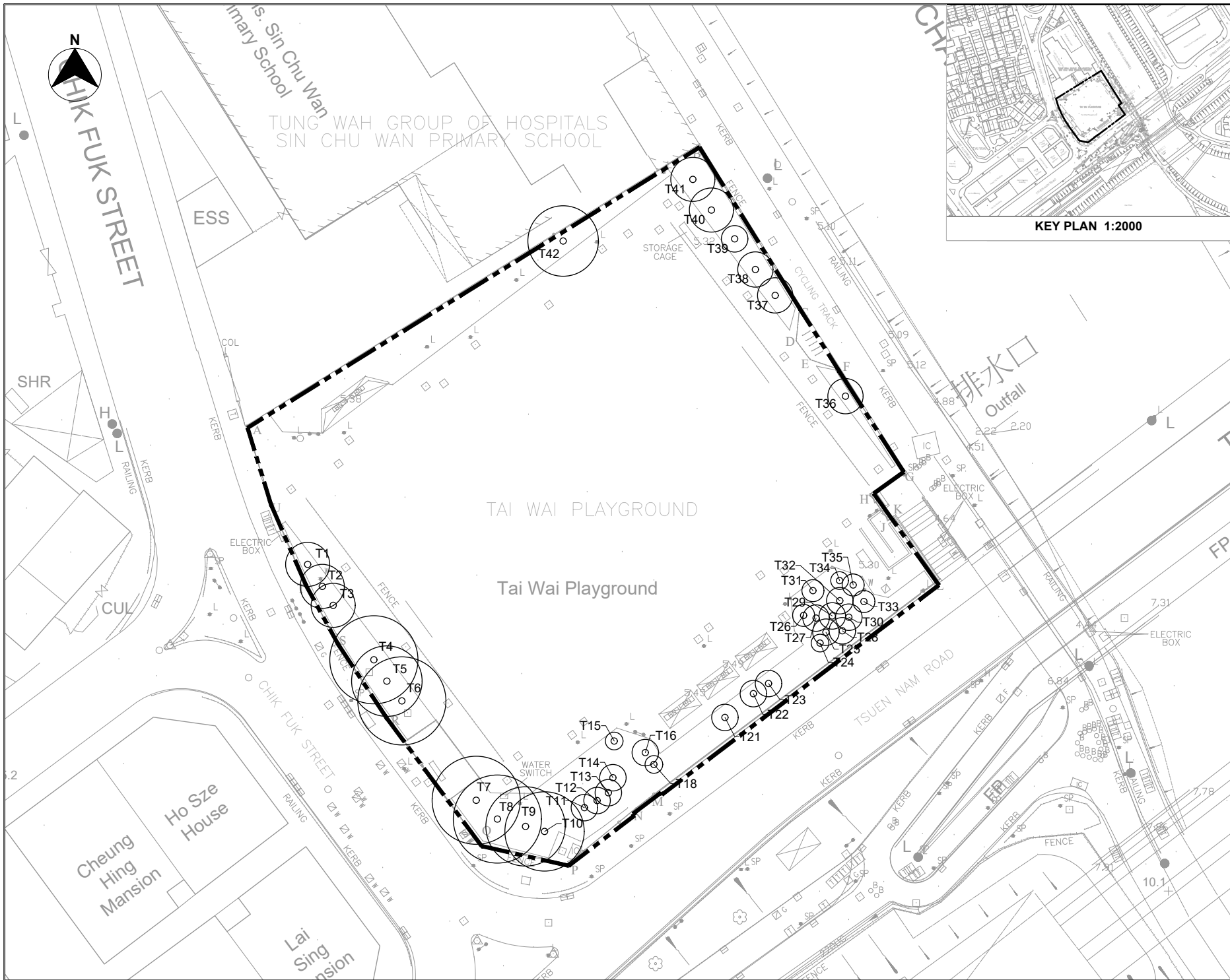

KEY PLAN 1:2000

NOTES

- LEGEND:
- SITE BOUNDARY
 - ⊙ EXISTING TREE (39 nos.)

REVISIONS

| NO | DESCRIPTION AND DATE | INITIAL AND DESIGNATION | |
|----|----------------------|-------------------------|------------|
| | | DWN | CHK / AUTH |
| | | | |
| | | | |

| | NAME AND DESIGNATION | INITIAL | DATE |
|------------|--|---------|------|
| AUTHORISED | MORRIS CHEUNG SLA/1 | | |
| CHECKED | KAREN CHEUNG LA/7 ANGUS KWAN ST(A)/24 | | |
| DRAWN | EUNICE NG CTA(A)/294 | | |

PROJECT
PROPOSED PUBLIC HOUSING DEVELOPMENT AT TSUEN NAM ROAD

DRAWING TITLE
TREE SURVEY PLAN

SCALE 1: 500 @ A1 1:1000 @ A3

DRAWING NO.
ST52 / - / TS / L / LO-01

SOURCE VIAT62462

ICU NO.



AutoCAD 2000 A1 594 x 941

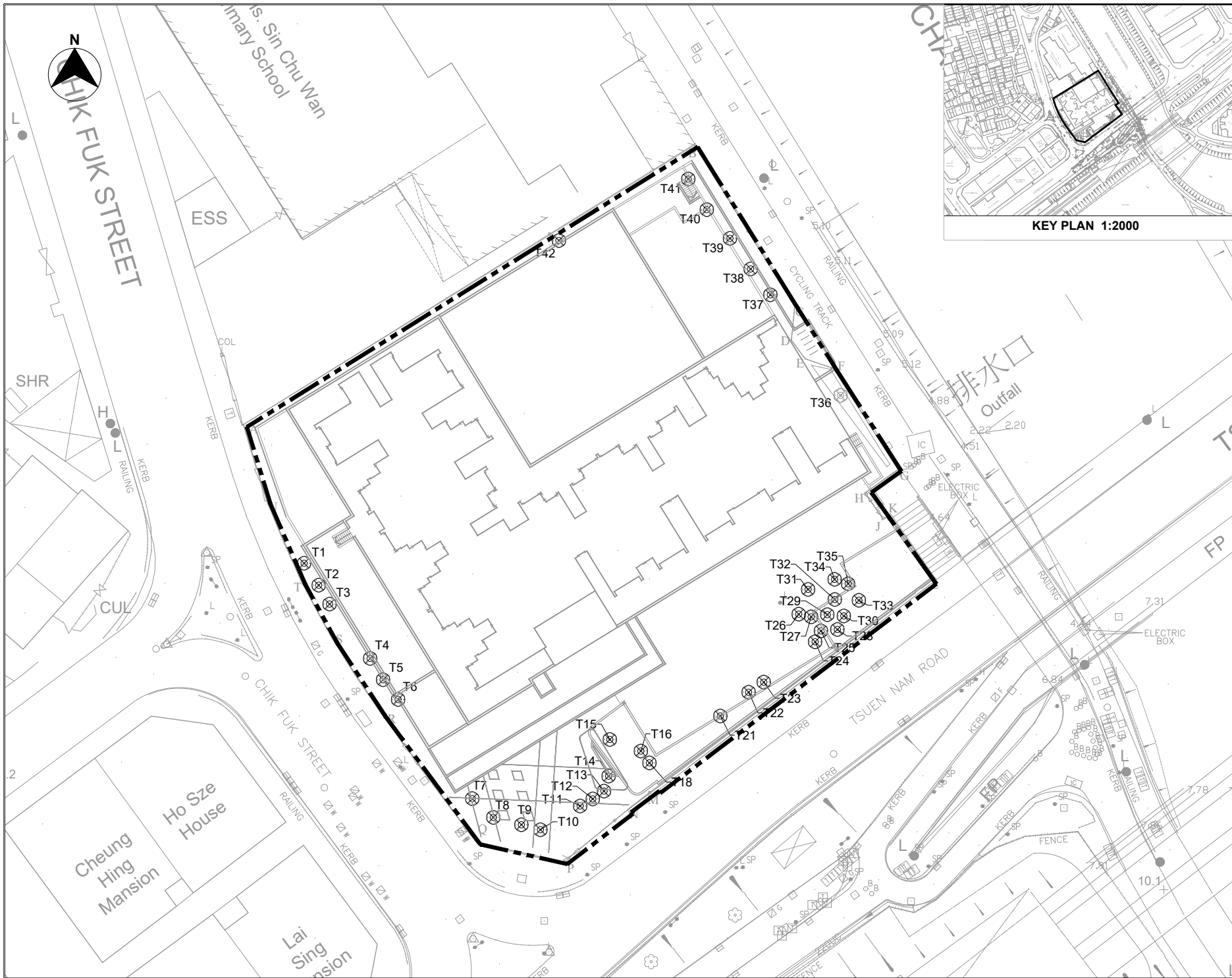

NOTES

- LEGEND:
- SITE BOUNDARY
 - ⊗ PROPOSED TREE TO BE FELLED (39 nos.)

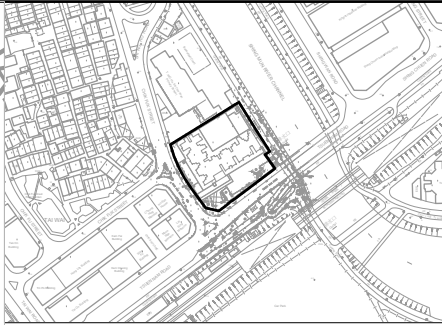

KEY PLAN 1:2000

REVISIONS

| NO | DESCRIPTION AND DATE | INITIAL AND DESIGNATION | |
|----|----------------------|-------------------------|------------|
| | | DWN | CHK / AUTH |
| | | | |
| | | | |

| | NAME AND DESIGNATION | INITIAL | DATE |
|------------|---|---------|------|
| AUTHORISED | MORRIS CHEUNG SLA/1 | | |
| CHECKED | KAREN CHEUNG LA/7 ANGUS KWAN STA(A)/24 | | |
| DRAWN | EUNICE NG CTA(A)/294 | | |

PROJECT
PROPOSED PUBLIC HOUSING DEVELOPMENT AT TSUEN NAM ROAD

DRAWING TITLE
PROPOSED TREE TREATMENT PLAN

SCALE 1: 500 @ A1 1:1000 @ A3

DRAWING NO.
ST52 / - / TT / L / LO-01

SOURCE VIAT62462

ICU NO.



Tree Assessment Schedule

Project Title : Public Housing Development at Tsuen Nam Road
 Plan Ref: ST52 / - / TS / L / LO-01

Surveyed by : ALMI/LA1
 Date of Survey : 15/5/2023

Sheet 1 of 1

| Tree no. | Species ¹ | | Measurements | | | | Amenity value | Form | Health condition | Structural condition | Suitability for transplanting (Survival Rate after Transplanting High(H)/Medium(M)/Low(L)) | Remarks ⁴ | Recommendation |
|----------|----------------------------|--------------|--------------|-----------------------|------------------|-------------------------|---------------|------|------------------|----------------------|---|--|----------------|
| | Scientific name | Chinese name | Height (m) | DBH ² (mm) | Crown Spread (m) | Girth ² (mm) | | | | | | | |
| T1 | Taxodium distichum | 落羽松 | 11 | 370 | 5 | 1,162 | M | F | P | F | L | Epicormics, limited root growth on planter | F |
| T2 | Taxodium distichum | 落羽松 | 11 | 380 | 5 | 1,194 | M | F | P | F | L | Epicormics, limited root growth on planter | F |
| T3 | Taxodium distichum | 落羽松 | 12 | 330 | 5 | 1,037 | M | F | P | F | L | Limited root growth on planter | F |
| T4 | Melia azedarach | 苦楝 | 15 | 740 | 10 | 2,325 | M | F | F | P | L | Codominant trunk, unbalance crown, limited root growth on planter | F |
| T5 | Melia azedarach | 苦楝 | 14 | 370 | 8 | 1,162 | M | F | F | P | L | Leaning, limited root growth on planter, codominant trunk | F |
| T6 | Melia azedarach | 苦楝 | 14 | 650 | 10 | 2,042 | M | F | F | P | L | Large branch cut, limited root growth on planter, codominant trunk | F |
| T7 | Melia azedarach | 苦楝 | 14 | 500 | 10 | 1,571 | M | F | F | P | L | Epicormics, broken branch, leaning at crown, limited root growth on planter, leaning | F |
| T8 | Melia azedarach | 苦楝 | 15 | 420 | 10 | 1,319 | M | F | P | P | L | Epicormics, codominant trunk, limited root growth on planter | F |
| T9 | Melia azedarach | 苦楝 | 16 | 650 | 9 | 2,042 | M | F | F | P | L | Epicormics, codominant trunk, limited root growth on planter | F |
| T10 | Melia azedarach | 苦楝 | 10 | 500 | 9 | 1,571 | M | F | F | P | L | Cross roots, damaged root, codominant trunk, limited root growth on planter | F |
| T11 | Livistona chinensis | 蒲葵 | 10 | 200 | 3 | 628 | L | F | F | F | L | Leaning | F |
| T12 | Livistona chinensis | 蒲葵 | 7 | 220 | 3 | 691 | L | F | F | F | L | Leaning | F |
| T13 | Livistona chinensis | 蒲葵 | 6 | 190 | 3 | 597 | L | F | F | F | L | Leaning | F |
| T14 | Livistona chinensis | 蒲葵 | 9 | 220 | 3 | 691 | L | F | F | F | L | Leaning | F |
| T15 | Archontophoenix alexandrae | 假檳榔 | 7 | 130 | 2 | 408 | L | F | P | F | L | Sparse frond | F |
| T16 | Archontophoenix alexandrae | 假檳榔 | 11 | 180 | 3 | 565 | L | F | P | F | L | Sparse frond | F |
| T18 | Archontophoenix alexandrae | 假檳榔 | 9 | 150 | 2 | 471 | L | F | P | F | L | Sparse frond | F |
| T21 | Archontophoenix alexandrae | 假檳榔 | 11 | 140 | 3 | 440 | L | F | F | P | L | Decay on trunk | F |
| T22 | Archontophoenix alexandrae | 假檳榔 | 11.5 | 170 | 3 | 534 | L | F | F | F | L | Decay on trunk | F |
| T23 | Archontophoenix alexandrae | 假檳榔 | 12 | 180 | 3 | 565 | L | F | F | F | L | Wound on trunk | F |
| T24 | Archontophoenix alexandrae | 假檳榔 | 9 | 150 | 2 | 471 | L | F | F | F | L | Leaning | F |
| T25 | Livistona chinensis | 蒲葵 | 9.5 | 180 | 3 | 565 | L | F | F | F | L | Leaning | F |
| T26 | Archontophoenix alexandrae | 假檳榔 | 11 | 175 | 2.5 | 550 | L | F | F | F | L | Decay on trunk | F |
| T27 | Livistona chinensis | 蒲葵 | 11 | 180 | 3 | 565 | L | F | F | F | L | Leaning | F |
| T28 | Livistona chinensis | 蒲葵 | 11 | 190 | 3 | 597 | L | F | F | F | L | Leaning | F |
| T29 | Livistona chinensis | 蒲葵 | 11 | 180 | 3 | 565 | L | F | F | F | L | Conflict with development, too tall to be transplanted off site | F |
| T30 | Livistona chinensis | 蒲葵 | 11 | 180 | 3 | 565 | L | F | F | F | L | Leaning | F |
| T31 | Archontophoenix alexandrae | 假檳榔 | 12 | 190 | 2.5 | 597 | L | F | F | F | L | Wound on trunk | F |
| T32 | Livistona chinensis | 蒲葵 | 10 | 180 | 3 | 565 | L | F | F | F | L | Leaning | F |
| T33 | Archontophoenix alexandrae | 假檳榔 | 12 | 180 | 2.5 | 565 | L | F | F | F | L | Conflict with development, too tall to be transplanted off site | F |
| T34 | Archontophoenix alexandrae | 假檳榔 | 10.5 | 180 | 2 | 565 | L | F | P | F | L | Conflict with development, too tall to be transplanted off site | F |
| T35 | Archontophoenix alexandrae | 假檳榔 | 12 | 170 | 2.5 | 534 | L | F | F | F | L | Conflict with development, too tall to be transplanted off site | F |
| T36 | Lagerstroemia speciosa | 大花紫薇 | 6 | 210 | 4 | 660 | L | F | F | F | L | Fungi on trunk | F |
| T37 | Lagerstroemia speciosa | 大花紫薇 | 6 | 200 | 4 | 628 | L | F | F | F | L | Crack on trunk | F |
| T38 | Lagerstroemia speciosa | 大花紫薇 | 7 | 250 | 4 | 785 | L | F | F | P | L | Codominant trunk | F |
| T39 | Lagerstroemia speciosa | 大花紫薇 | 5 | 200 | 3 | 628 | L | P | F | P | L | Wound and cut on branch, crook trunk | F |
| T40 | Lagerstroemia speciosa | 大花紫薇 | 7.5 | 320 | 5 | 1,005 | L | F | P | P | L | Broken branch, trunk cavity, tear bark | F |
| T41 | Lagerstroemia speciosa | 大花紫薇 | 8 | 400 | 5 | 1,257 | L | F | F | P | L | Codominant trunk, cross branch | F |
| T42 | Peltophorum pterocarpum | 盾柱木 | 17 | 740 | 8 | 2,325 | M | F | F | F | L | Limited root growth on planter | F |

Guidance on proper use of scientific name of plants is given in the Agriculture, Fisheries and Conservation Department's Nature Conservation Practice Note No. 3, which can be viewed at AFCD's web page http://www.afcd.gov.hk/english/conservation/con_tech/files/common/NPC3_The_use_of_plant_names_rev_2008_2.pdf.

DBH of a tree refers to its diameter at breast height (i.e. measured at 1.3 m above ground level). Guidance on DBH measurement is given in the Agriculture, Fisheries and Conservation Department's Nature Conservation Practice Note No. 2, which can be viewed at AFCD's web page http://www.afcd.gov.hk/english/conservation/con_tech/files/common/NCPN_02_measurement_of_DBH_ver.2006.pdf. Girth refers to the circumference of the trunk measured at 1.3 m above ground level.

Amenity value of a tree should be assessed by its functional values for shade, seasonal interest, screening, reduction of pollution and noise and also its fung shui significance, and classified into the following categories.

High (H): important trees which should be retained by adjusting the design layout accordingly.

Medium (M): trees that are desirable to be retained in order to create a pleasant environment, which includes healthy specimens of lesser importance than "High" trees.

Low (L): trees that are dead, dying or potentially hazardous and should be removed.

Assessment shall take into account conditions of an individual tree at the time of survey (including health, structure, age and root conditions), site conditions (including topography and accessibility), and intrinsic characters of tree species (survival rate after transplanting).

For trees recommended for transplanting and felling, major determining factors for the rating on suitability for the treatment should be included if necessary. Any additional information deemed necessary should also be provided for consideration by the Committee.

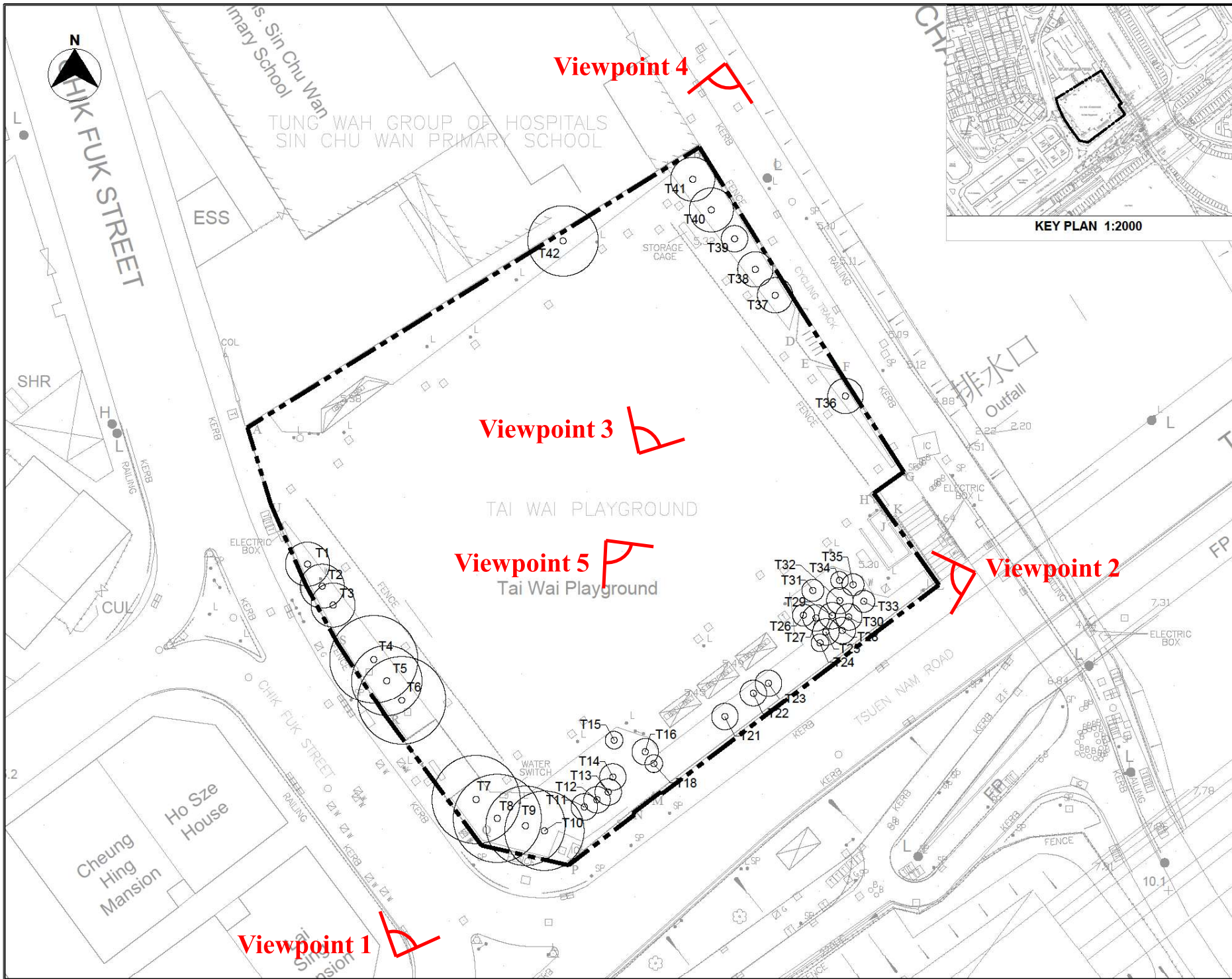

NOTES

LEGEND:

- SITE BOUNDARY
- ⊙ EXISTING TREE (39 nos.)

KEY PLAN 1:2000

REVISIONS

| NO | DESCRIPTION AND DATE | INITIAL | AND DESIGNATION |
|----|----------------------|---------|-----------------|
| | | | |

| NAME AND DESIGNATION | INITIAL | DATE |
|--|---------|------|
| AUTHORISED MORRIS CHEUNG SLA/1 | | |
| CHECKED KAREN CHEUNG LA/7 ANGUS KWAN STO(A)/24 | | |
| DRAWN EUNICE NG CTA(A)/294 | | |

PROJECT

PROPOSED PUBLIC HOUSING DEVELOPMENT AT TSUEN NAM ROAD

DRAWING TITLE

TREE SURVEY PLAN

SCALE 1:500 @ A1 1:1000 @ A3

DRAWING NO.

ST52 / - / TS / L / LO-01

SOURCE VIAT/62462

ICU NO.

HOUSING DEPARTMENT

BROAD-BRUSH TREE SURVEY

Photographs of Tree Groups



Viewpoint 1



Viewpoint 2

PROPOSED PUBLIC VEHICLE PARK (EXCLUDING CONTAINER VEHICLE)
AT THE GOVERNMENT COMPLEX CO-LOCATING WITH THE PERMITTED
PUBLIC HOUSING DEVELOPMENT AT TSUEN NAM ROAD, TAI WAI

BROAD-BRUSH TREE SURVEY

Photographs of Tree Groups



Viewpoint 3



Viewpoint 4

PROPOSED PUBLIC VEHICLE PARK (EXCLUDING CONTAINER VEHICLE)
AT THE GOVERNMENT COMPLEX CO-LOCATING WITH THE PERMITTED
PUBLIC HOUSING DEVELOPMENT AT TSUEN NAM ROAD, TAI WAI

BROAD-BRUSH TREE SURVEY

Photographs of Tree Groups



Viewpoint 5