

Urgent Return receipt Expand Group Restricted Prevent Copy

Avis Lok Tung POON/PLAND

主旨: S.16 Planning Application No. A/TM-SKW/130 - Proposed Temporary Open Storage of Construction Materials for a Period of 3 Years at Lots 194,195,197,198 and 209 in D.D. 385, Tai Lam Chung, Tuen Mun, New Territories - DPO/TM&YLW, PlanD's comments

附件: 2024-10-29 plan.pdf

From: Victor Hui <[REDACTED]>
Sent: Wednesday, November 27, 2024 2:13 PM
To: tpbpd/PLAND <tpbpd@pland.gov.hk>
Cc: Avis Lok Tung POON/PLAND <altpoon@pland.gov.hk>
Subject: S.16 Planning Application No. A/TM-SKW/130 - Proposed Temporary Open Storage of Construction Materials for a Period of 3 Years at Lots 194,195,197,198 and 209 in D.D. 385, Tai Lam Chung, Tuen Mun, New Territories - DPO/TM&YLW, PlanD's comments

敬啟者：

現就有關部門之意見作出回應：—

有關上落物料車輛停泊位置曾於10月底就回應運輸署時曾經提供，現再隨函附上相關圖則，至於現場會存放之建築物料則為興建新界鄉村屋宇常見之鋼筋、金屬、木材、石料等，由於是用作運輸建築材料之車輛，則為常見之中型或大型運輸車，基於只有上落貨物時才會暫時停泊，並不會長期停泊於申請範圍之內，因此只會有大概範圍而非劃定之停車格，懇請明察。

--

Best Regards,
Victor, Hui Kwan Yee

Avis Lok Tung POON/PLAND <altpoon@pland.gov.hk> 於 2024年11月11日 週一 下午3:48寫道：

Dear Victor,

Regarding the captioned application, please find the comments from the District Planning Office/Tuen Mun & Yuen Long West, Planning Department (DPO/TM&YLW, PlanD) as below for your follow-up action:

Comments from DPO/TM&YLW, PlanD (Contact Person: Ms. Anson YING; tel: 2158 6298)

Please provide details of the subject application, such as any temporary structures or parking/loading/unloading spaces, types of construction materials and vehicles involved, and include them in the layout plan.

Urgent Return receipt Expand Group Restricted Prevent Copy

If you have any responses to the comments, please send to the Secretary of the Town Planning Board by post and email (tpbpd@pland.gov.hk) and copy to this office (by email) for advance reference.

Regards,

Avis POON

for DPO/TM&YLW
Planning Department
Tel: 2158 6331

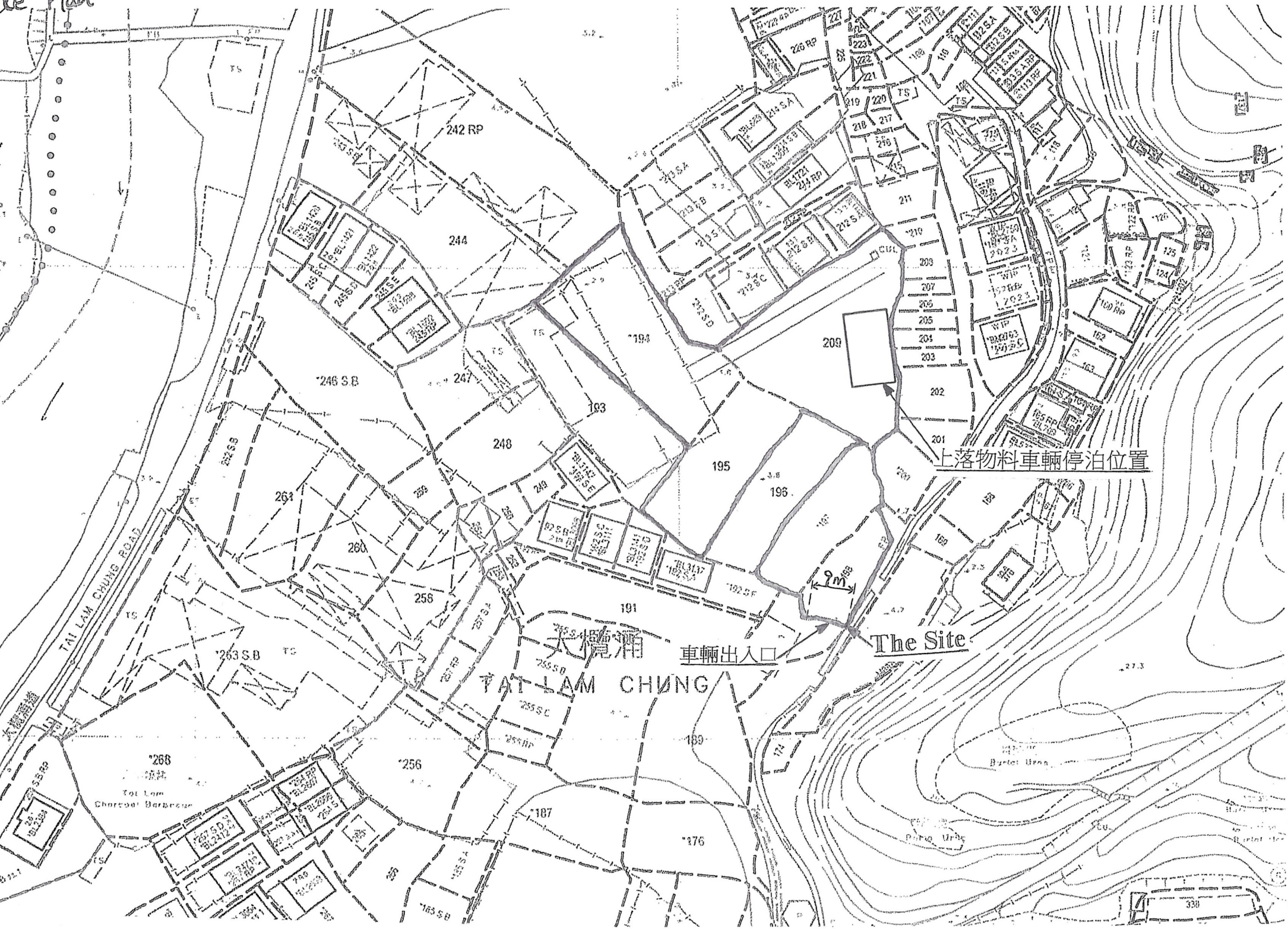

上落物料車輛停泊位置

車輛出入口

The Site

大橋涌
TAT LAM CHUNG

266
Tot Lam
Charcoal Barbecue

Burial Urn