

DEVELOPMENT PARAMETERS

APPLICATION SITE AREA	: 41,569 m ² (ABOUT)
COVERED AREA	: 756 m ² (ABOUT)
UNCOVERED AREA	: 40,813 m ² (ABOUT)
PLOT RATIO	: 0.04 (ABOUT)
SITE COVERAGE	: 1.8 % (ABOUT)
NO. OF STRUCTURE	: 7
DOMESTIC GFA	: NOT APPLICABLE
NON-DOMESTIC GFA	: 1,512 m ² (ABOUT)
TOTAL GFA	: 1,512 m ² (ABOUT)
BUILDING HEIGHT	: 7 m (ABOUT)
NO. OF STOREY	: 2
OPEN STORAGE OF CONSTRUCTION MATERIALS	: 4,102 m ² (ABOUT)
OPEN STORAGE OF CONSTRUCTION MACHINERIES	: 3,440m ² (ABOUT)
OPEN STORAGE OF VEHICLES	: 17,989m ² (ABOUT)

STRUCTURE	USE	COVERED AREA	GFA	BUILDING HEIGHT
B1	SITE OFFICE, WASHROOM AND METER ROOM	108 m ² (ABOUT)	216 m ² (ABOUT)	7 m (ABOUT)(2-STOREY)
B2	SITE OFFICE, WASHROOM AND METER ROOM	108 m ² (ABOUT)	216 m ² (ABOUT)	7 m (ABOUT)(2-STOREY)
B3	SITE OFFICE, WASHROOM AND METER ROOM	108 m ² (ABOUT)	216 m ² (ABOUT)	7 m (ABOUT)(2-STOREY)
B4	SITE OFFICE, WASHROOM AND METER ROOM	108 m ² (ABOUT)	216 m ² (ABOUT)	7 m (ABOUT)(2-STOREY)
B5	SITE OFFICE, WASHROOM AND METER ROOM	108 m ² (ABOUT)	216 m ² (ABOUT)	7 m (ABOUT)(2-STOREY)
B6	SITE OFFICE, WASHROOM AND METER ROOM	108 m ² (ABOUT)	216 m ² (ABOUT)	7 m (ABOUT)(2-STOREY)
B7	SITE OFFICE, WASHROOM AND METER ROOM	108 m ² (ABOUT)	216 m ² (ABOUT)	7 m (ABOUT)(2-STOREY)
TOTAL		756 m² (ABOUT)	1,512 m² (ABOUT)	

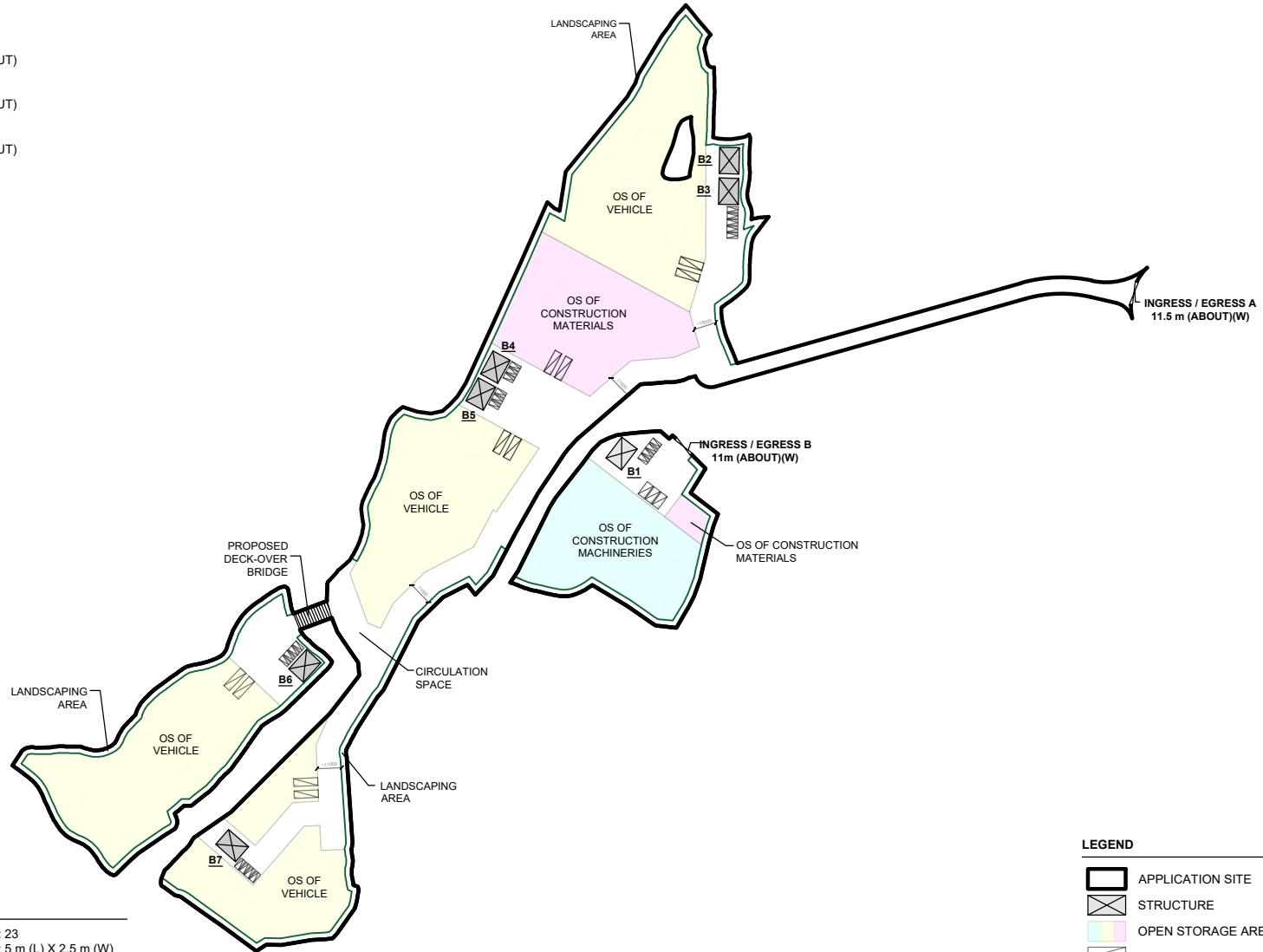
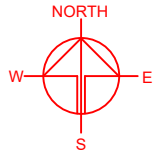

PARKING AND LOADING/UNLOADING PROVISIONS

NO. OF PRIVATE CAR PARKING SPACE	: 23
DIMENSIONS OF PARKING SPACE	: 5 m (L) X 2.5 m (W)
NO. OF L/UL SPACE FOR LIGHT GOODS VEHICLE	: 3
DIMENSION OF L/UL SPACE	: 7 m (L) X 3.5 m (W)
NO. OF L/UL SPACE FOR MEDIUM GOODS VEHICLE	: 10
DIMENSION OF L/UL SPACE	: 11 m (L) X 3.5 m (W)

LEGEND

- APPLICATION SITE
- STRUCTURE
- OPEN STORAGE AREA
- PARKING SPACE (PC)
- L/UL SPACE (LGV)
- L/UL SPACE (MGV)
- INGRESS / EGRESS

PLANNING CONSULTANT



PROJECT

PROPOSED TEMPORARY OPEN STORAGE OF CONSTRUCTION MATERIALS, CONSTRUCTION MACHINERIES AND VEHICLES WITH ANCILLARY FACILITIES FOR A PERIOD OF 3 YEARS AND ASSOCIATED FILLING OF POND/LAND AND EXCAVATION OF LAND

SITE LOCATION

VARIOUS LOTS IN D.D. 125 AND ADJOINING GOVERNMENT LAND, HA TSUEN, YUEN LONG, NEW TERRITORIES

SCALE

1 : 3000 @ A4

DRAWN BY	DATE
MN	5.3.2024
CHECKED BY	DATE
LT	12.04.2024
APPROVED BY	DATE

DWG. TITLE
LAYOUT PLAN

DWG NO.	VER.
PLAN 1	002

DEVELOPMENT PARAMETERS

APPLICATION SITE AREA	: 41,569 m ² (ABOUT)
COVERED AREA	: 756 m ² (ABOUT)
UNCOVERED AREA	: 40,813 m ² (ABOUT)
PLOT RATIO	: 0.04 (ABOUT)
SITE COVERAGE	: 1.8 % (ABOUT)
NO. OF STRUCTURE	: 7
DOMESTIC GFA	: NOT APPLICABLE
NON-DOMESTIC GFA	: 1,512 m ² (ABOUT)
TOTAL GFA	: 1,512 m ² (ABOUT)
BUILDING HEIGHT	: 7 m (ABOUT)
NO. OF STOREY	: 2
OPEN STORAGE OF CONSTRUCTION MATERIALS	: 4,102 m ² (ABOUT)
OPEN STORAGE OF CONSTRUCTION MACHINERIES	: 3,440m ² (ABOUT)
OPEN STORAGE OF VEHICLES	: 17,989m ² (ABOUT)

STRUCTURE	USE	COVERED AREA	GFA	BUILDING HEIGHT
B1	SITE OFFICE, WASHROOM AND METER ROOM	108 m ² (ABOUT)	216 m ² (ABOUT)	7 m (ABOUT)(2-STOREY)
B2	SITE OFFICE, WASHROOM AND METER ROOM	108 m ² (ABOUT)	216 m ² (ABOUT)	7 m (ABOUT)(2-STOREY)
B3	SITE OFFICE, WASHROOM AND METER ROOM	108 m ² (ABOUT)	216 m ² (ABOUT)	7 m (ABOUT)(2-STOREY)
B4	SITE OFFICE, WASHROOM AND METER ROOM	108 m ² (ABOUT)	216 m ² (ABOUT)	7 m (ABOUT)(2-STOREY)
B5	SITE OFFICE, WASHROOM AND METER ROOM	108 m ² (ABOUT)	216 m ² (ABOUT)	7 m (ABOUT)(2-STOREY)
B6	SITE OFFICE, WASHROOM AND METER ROOM	108 m ² (ABOUT)	216 m ² (ABOUT)	7 m (ABOUT)(2-STOREY)
B7	SITE OFFICE, WASHROOM AND METER ROOM	108 m ² (ABOUT)	216 m ² (ABOUT)	7 m (ABOUT)(2-STOREY)
TOTAL		756 m² (ABOUT)	1,512 m² (ABOUT)	

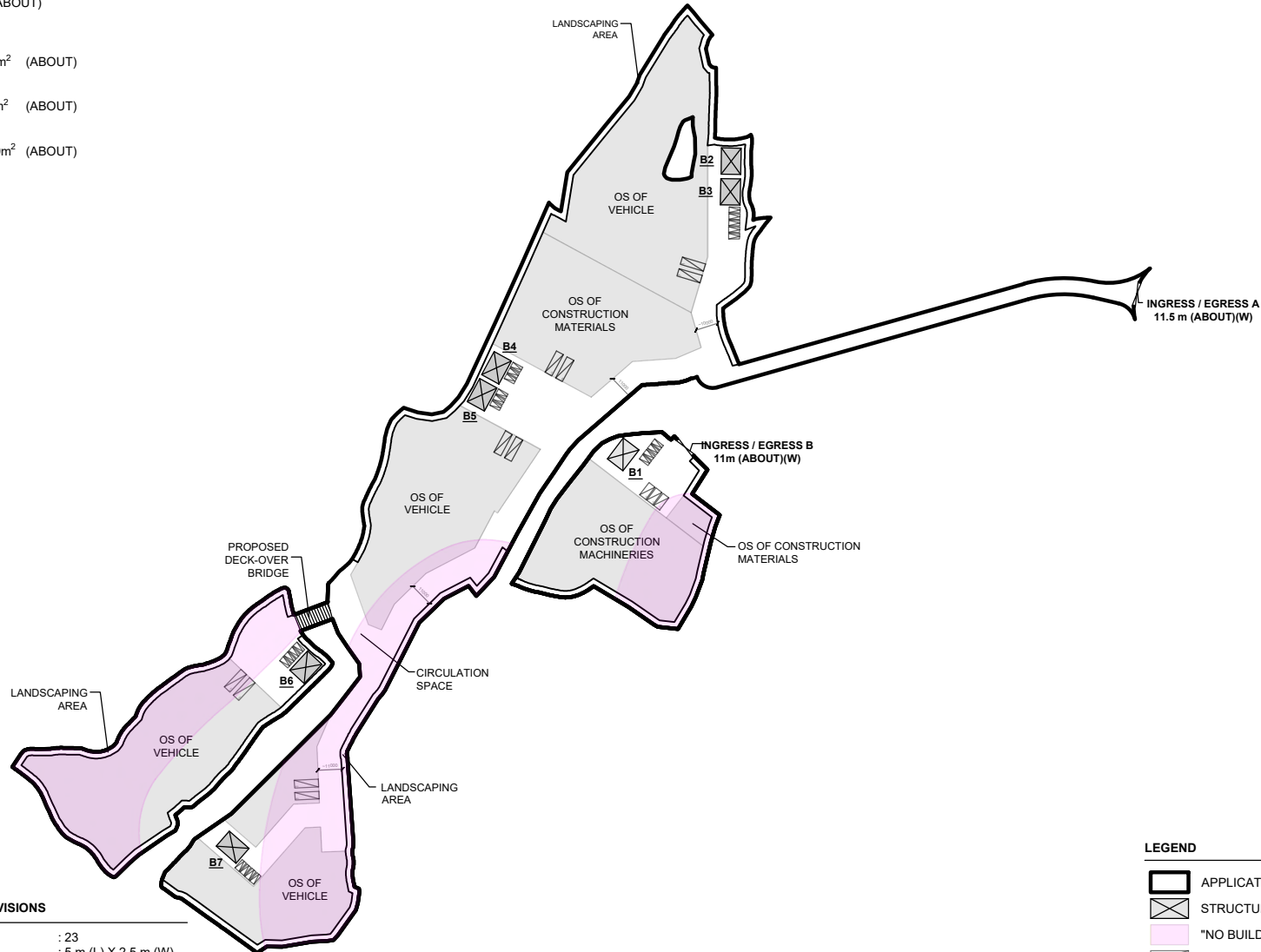
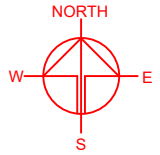

PARKING AND LOADING/UNLOADING PROVISIONS

NO. OF PRIVATE CAR PARKING SPACE	: 23
DIMENSIONS OF PARKING SPACE	: 5 m (L) X 2.5 m (W)
NO. OF L/LU SPACE FOR LIGHT GOODS VEHICLE	: 3
DIMENSION OF L/LU SPACE	: 7 m (L) X 3.5 m (W)
NO. OF L/LU SPACE FOR MEDIUM GOODS VEHICLE	: 10
DIMENSION OF L/LU SPACE	: 11 m (L) X 3.5 m (W)

LEGEND

- APPLICATION SITE
- STRUCTURE
- "NO BUILD" ZONE
- PARKING SPACE (PC)
- L/LU SPACE (LGV)
- L/LU SPACE (MGV)
- INGRESS / EGRESS

PLANNING CONSULTANT



PROJECT

PROPOSED TEMPORARY OPEN STORAGE OF CONSTRUCTION MATERIALS, CONSTRUCTION MACHINERIES AND VEHICLES WITH ANCILLARY FACILITIES FOR A PERIOD OF 3 YEARS AND ASSOCIATED FILLING OF POND/LAND AND EXCAVATION OF LAND

SITE LOCATION

VARIOUS LOTS IN D.D. 125 AND ADJOINING GOVERNMENT LAND, HA TSUEN, YUEN LONG, NEW TERRITORIES

SCALE

1 : 3000 @ A4

DRAWN BY	DATE
MN	5.3.2024
CHECKED BY	DATE
LT	12.04.2024
APPROVED BY	DATE

DWG. TITLE
LAYOUT PLAN (2/2)

DWG NO.	VER.
PLAN 2	002

LAND STATUS AND LAND USE OF THE APPLICANT'S ORIGINAL PREMISES IN HUNG SHUI KIU

APPLICATION SITE AREA : 41,569 m² (ABOUT)
 AREA OF ORIGINAL PREMISES : 43,570 m² (ABOUT)

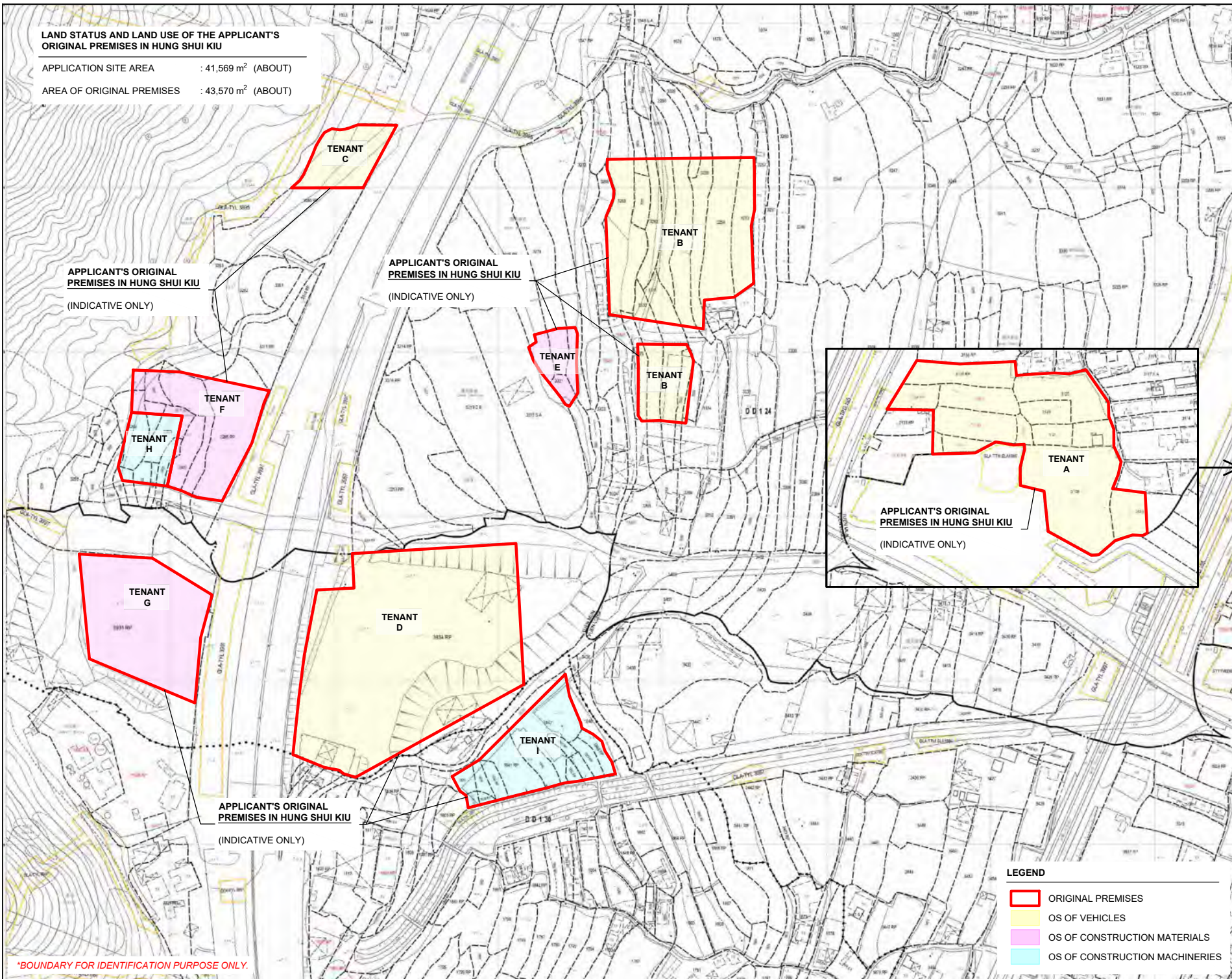
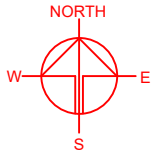

*BOUNDARY FOR IDENTIFICATION PURPOSE ONLY.

LEGEND

	ORIGINAL PREMISES
	OS OF VEHICLES
	OS OF CONSTRUCTION MATERIALS
	OS OF CONSTRUCTION MACHINERIES

PLANNING CONSULTANT	
PROJECT	
PROPOSED TEMPORARY OPEN STORAGE OF CONSTRUCTION MATERIALS, CONSTRUCTION MACHINERIES AND VEHICLES WITH ANCILLARY FACILITIES FOR A PERIOD OF 3 YEARS AND ASSOCIATED FILLING OF POND/LAND AND EXCAVATION OF LAND	
SITE LOCATION	
VARIOUS LOTS IN D.D. 125 AND ADJOINING GOVERNMENT LAND, HA TSUEN, YUEN LONG, NEW TERRITORIES	
SCALE	
1 : 3000 @ A4	
DRAWN BY	DATE
MN	31.1.2024
CHECKED BY	DATE
APPROVED BY	DATE
DWG. TITLE	
OP (LAND STATUS AND USE)	
DWG NO.	VER.
PLAN 3	001

SWEPT PATH ANALYSIS

TYPE OF VEHICLE : MEDIUM GOODS VEHICLE
 DIMENSION OF VEHICLE : 2.5 m (W) X 11 m (L)

TYPE OF VEHICLE : LIGHT GOODS VEHICLE
 DIMENSION OF VEHICLE : 2.1 m (W) X 5.2 m (L)

SWEPT PATHS GENERATED BY AUTODESK VEHICLE TRACKING 2019

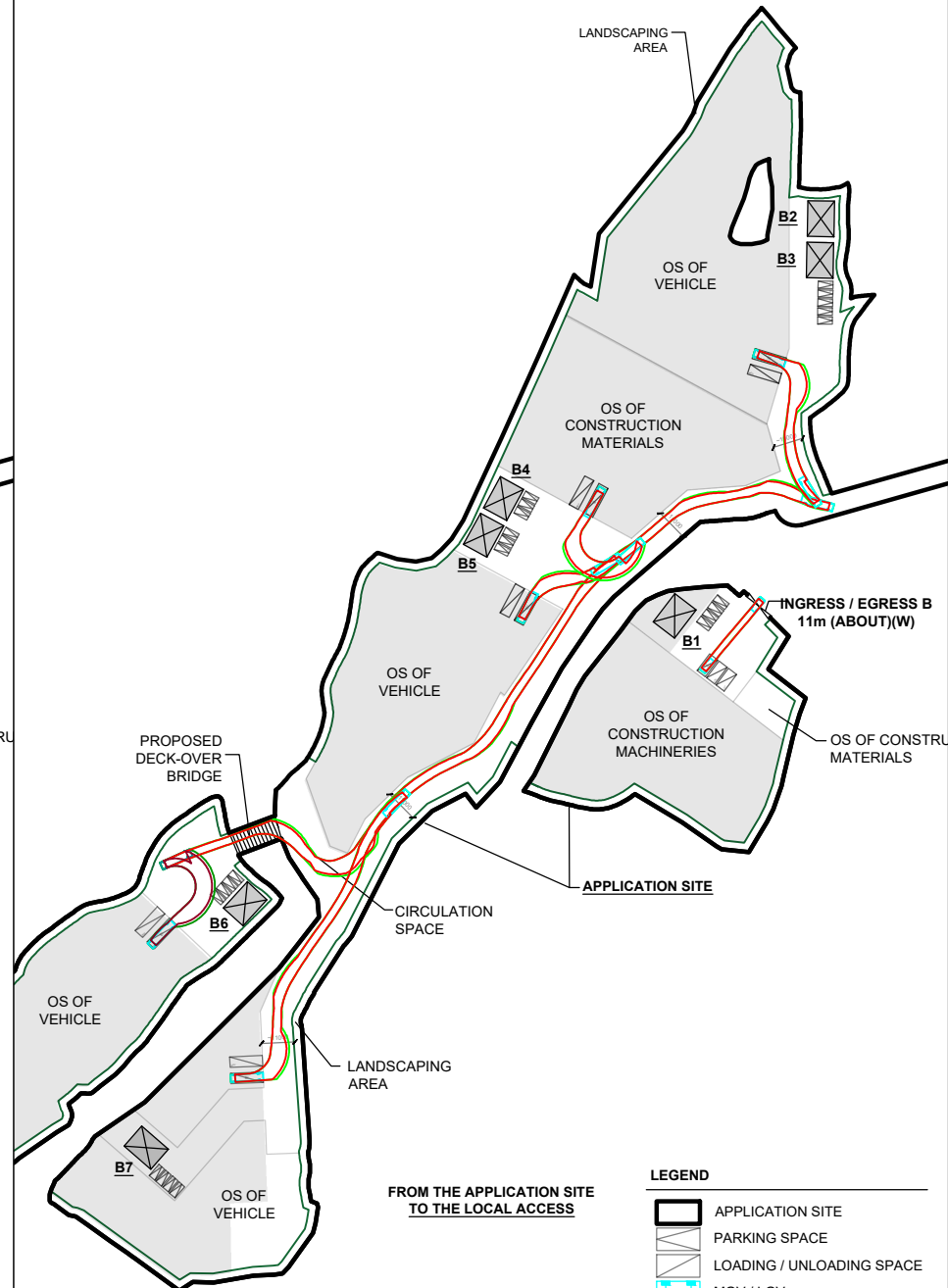
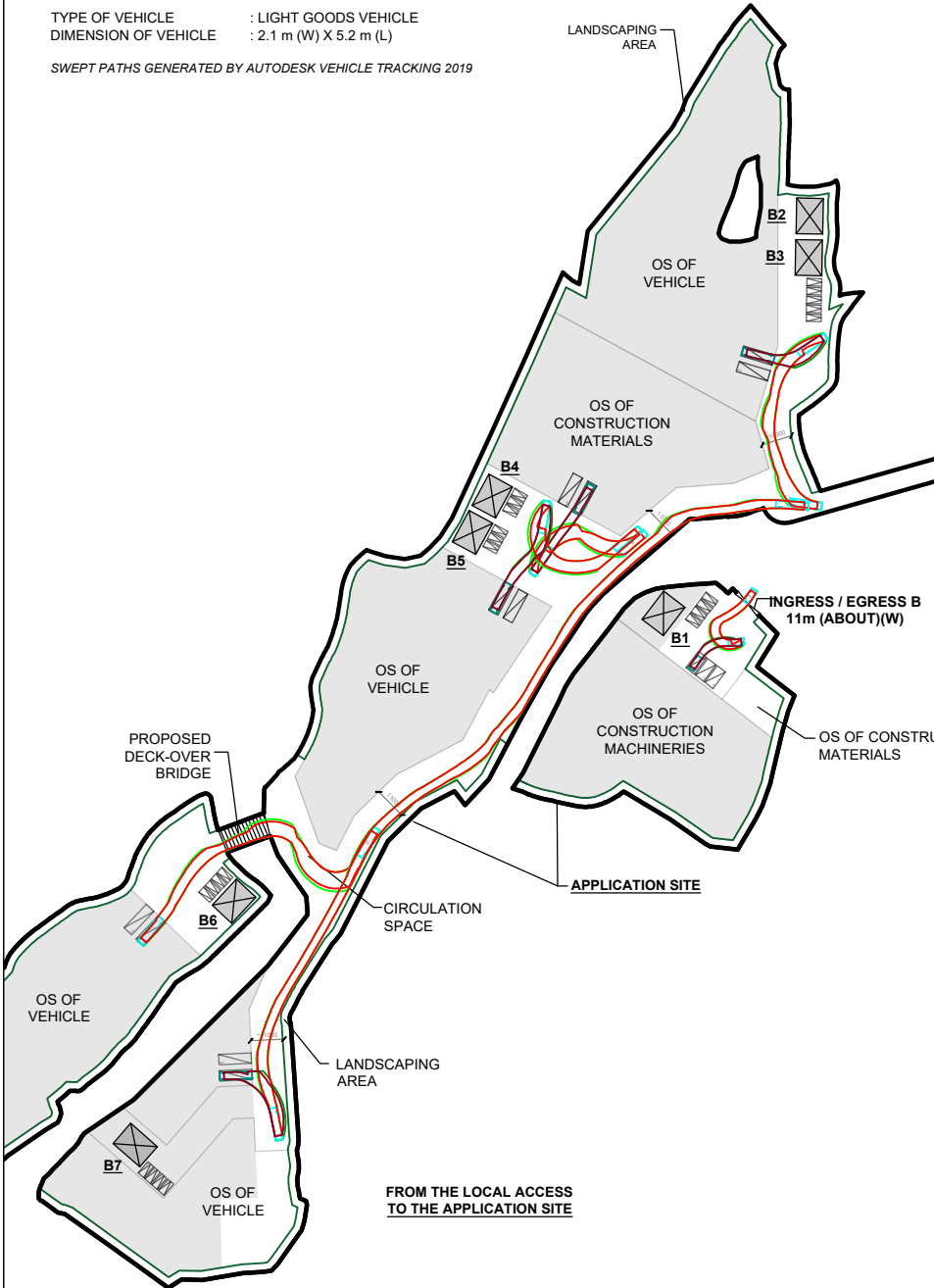

LEGEND

- APPLICATION SITE
- PARKING SPACE
- LOADING / UNLOADING SPACE
- MG / LGV
- SWEPT PATH OF VEHICLE

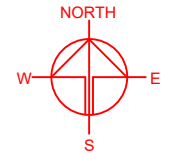

PLANNING CONSULTANT



PROJECT

PROPOSED TEMPORARY OPEN STORAGE OF CONSTRUCTION MATERIALS, CONSTRUCTION MACHINERIES AND VEHICLES WITH ANCILLARY FACILITIES FOR A PERIOD OF 3 YEARS AND ASSOCIATED FILLING AND EXCAVATION OF LAND AND FILLING OF POND

SITE LOCATION

VARIOUS LOTS IN D.D. 125 AND ADJOINING GOVERNMENT LAND, HA TSUEN, YUEN LONG, NEW TERRITORIES

SCALE
1 : 2500 @ A4

DRAWN BY: MN DATE: 31.1.2024

REVISED BY: LT DATE: 12.04.2024

APPROVED BY: DATE:

DWG. TITLE
SWEPT PATH ANALYSIS

DWG. NO.: PLAN 4 VER.: 001