



Tree Survey Report

Date of Survey: 15th October 2024

Location:

Lot 385 Rp (Part) In D.D. 128 And Adjoining Government Land, Ha Tsuen, Yuen Long, New Territories

Prepared by:

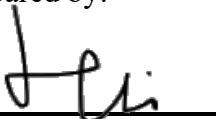

Mak Ka Hei

Registered Arborist

Date: 15th October 2024

Table of contents

1. Introduction	3
2. Summary of Existing Trees	4

Appendix:

- I. Tree Survey Plan Schedule
- II. Tree Survey Schedule
- III. Photo Records

Disclaimer:

The tree survey conducted indicates the condition of the surveyed trees at the time of inspection only. The assessments of amenity value, form, health and structural condition of the trees surveyed are based on visual inspection from the ground only. No aerial inspection, root digging or mapping, or diagnostic testing has been conducted as part of this survey. Wing Ho Yuen Landscaping Company Limited cannot accept responsibility for future failure or defects detected after the time of inspection of the trees surveyed in this report.

1. Introduction

The survey conducted is to record all the existing trees in the tree survey boundary. The survey include tree species identification, tree tagging with durable labels, the measurements of overall tree height, Diameter at Breast Height (DBH), average crown spread, the evaluation on amenity value, form, health and structural conditions.

The tree survey was conducted on 15th October 2024. Plants with DBH less than 95mm were not recorded in the survey.

2. Summary of Existing Trees

The surveyed site is located at Lot 385 Rp (Part) In D.D. 128 And Adjoining Government Land, Ha Tsuen, Yuen Long, New Territories.

At the time of inspection on 15th October 2024, **18 nos.** tree were found within the Site. **3** dead trees (T14, T15, and T16) were recorded in the surveyed area. Location of individual tree refers to Appendix I.

Details of tree conditions and photo records for individual tree are recorded in the Appendix II and Appendix III respectively.

Appendix I – Tree Survey Plan

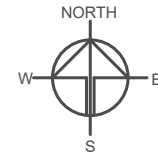
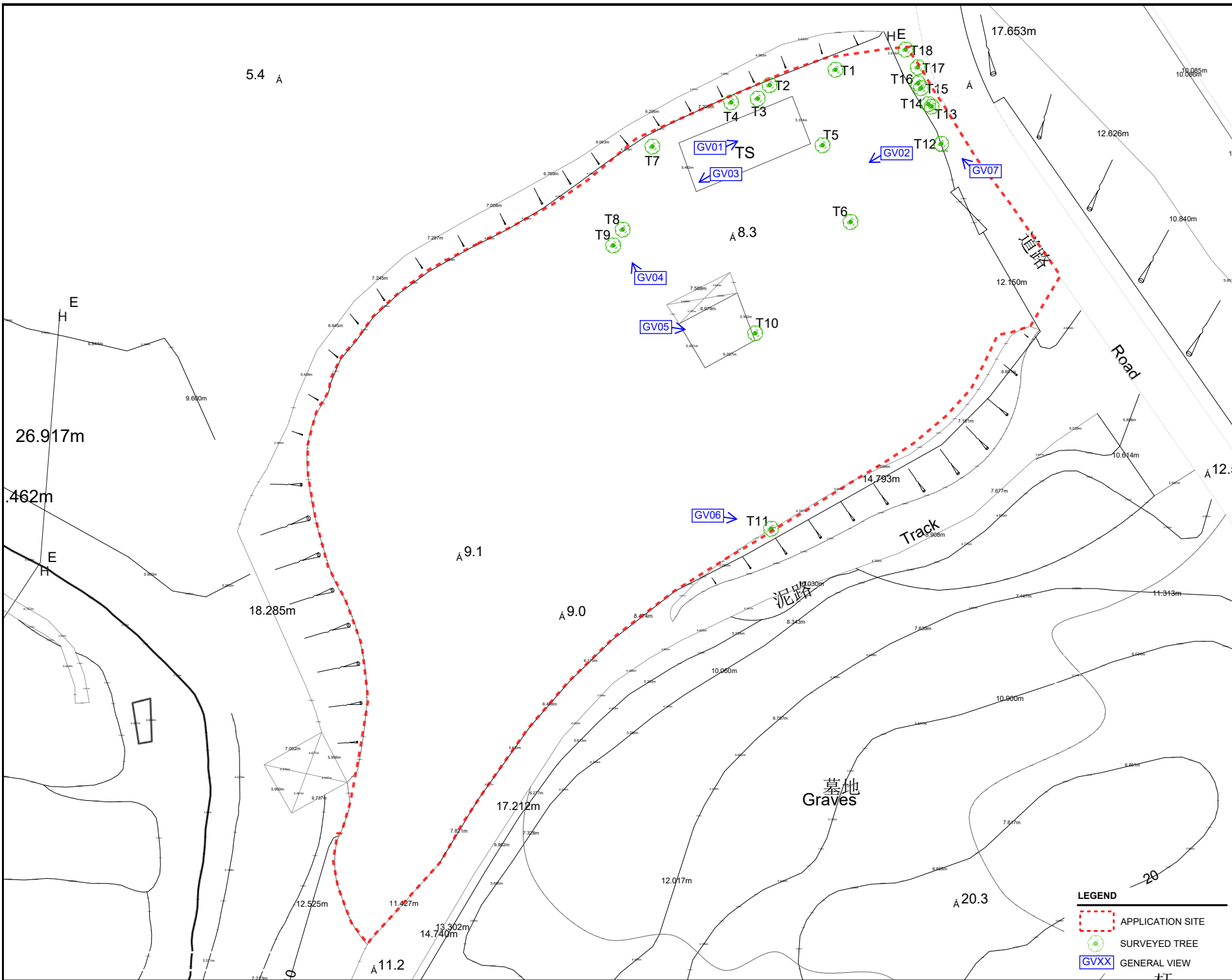

PLANNING CONSULTANT
R-Riches
 Property Consultants Ltd.

PROJECT
 PROPOSED TEMPORARY OPEN STORAGE OF CONSTRUCTION MATERIALS AND MACHINERY AND STORAGE OF TOOLS AND PARTS WITH ANCILLARY FACILITIES FOR A PERIOD OF 3 YEARS AND ASSOCIATED FILLING OF LAND

SITE LOCATION
 LOT 385 RP (PART) IN D.D. 128 AND ADJOINING GOVERNMENT LAND, HA TSUEN, YUEN LONG, NEW TERRITORIES

SCALE AS SHOWN	
DRAWN BY KYU	DATE 15.10.2024
REVISED BY	DATE
APPROVED BY	DATE
DWG. TITLE TREE SURVEY PLAN	
DWG. NO. TSP	VER. 0

LEGEND
 [Red dashed line] APPLICATION SITE
 [Green circle with tree] SURVEYED TREE
 [Blue arrow] GVXX GENERAL VIEW

Appendix II –Tree Survey Schedule

Tree Survey Schedule

Location: Lot 385 Rp (Part) In D.D. 128 And Adjoining Government Land, Ha Tsuen, Yuen Long, New Territories
 Tree surveyor(s): Mak Ka Hei
 Field Survey was conducted on: 15 October 2024



Tree No.	Tree Species		Tree Size Measurements			Amenity Value	Form	Health Condition	Structural Condition	Suitability for Transplanting	Remarks
	Botanical Name	Chinese Name	Overall Height (m)	DBH (mm)	Average Crown Spread (m)	High /Med /Low	Good /Fair /Poor	Good /Fair /Poor /Dead	Good /Fair /Poor	High /Med /Low	
T1	<i>Acacia auriculiformis</i>	耳果相思(耳葉相思)	8.5	130	3.0	Low	Fair	Fair	Fair	Low	
T2	<i>Celtis sinensis</i>	朴樹	8.0	95	2.0	Low	Fair	Fair	Fair	Low	
T3	<i>Celtis sinensis</i>	朴樹	8.0	100	3.0	Low	Fair	Fair	Fair	Low	
T4	<i>Celtis sinensis</i>	朴樹	8.0	110	5.0	Low	Fair	Fair	Fair	Low	
T5	<i>Dimocarpus longan</i>	龍眼	7.0	160	8.0	Med	Fair	Fair	Fair	Low	
T6	<i>Dimocarpus longan</i>	龍眼	8.0	440	9.0	Med	Fair	Fair	Fair	Low	
T7	<i>Celtis sinensis</i>	朴樹	8.5	110	6.0	Low	Fair	Fair	Fair	Low	
T8	<i>Psidium guajava</i>	番石榴	9.0	190	6.0	Med	Fair	Fair	Fair	Low	
T9	<i>Celtis sinensis</i>	朴樹	9.5	130	5.0	Low	Poor	Poor	Poor	Low	cavity at trunk base
T10	<i>Celtis sinensis</i>	朴樹	8.0	150	5.0	Low	Fair	Fair	Fair	Low	
T11	<i>Celtis sinensis</i>	朴樹	9.0	160	5.0	Low	Fair	Fair	Fair	Low	
T12	<i>Celtis sinensis</i>	朴樹	6.5	110	4.0	Low	Fair	Fair	Fair	Low	
T13	<i>Melia azedarach</i>	楝(苦楝)	7.0	95	4.0	Low	Fair	Fair	Fair	Low	
T14	Dead tree	死樹	6.5	150	1.0	-	-	Dead	-	-	dead tree
T15	Dead tree	死樹	5.0	150	1.0	-	-	Dead	-	-	dead tree
T16	Dead tree	死樹	5.0	150	1.0	-	-	Dead	-	-	dead tree
T17	<i>Celtis sinensis</i>	朴樹	8.0	160	5.0	Low	Fair	Fair	Poor	Low	crooked trunk
T18	<i>Celtis sinensis</i>	朴樹	8.0	190	7.0	Low	Poor	Poor	Poor	Low	co-dominant trunks with included bark, crack at trunk base

Notes: Amenity Value, Form, Health Condition and Structural Condition of trees were obtained by Visual Assessment Only.

Appendix III – Photo Records

General View



General view 01



General view 02

General View



General view 03



General view 04

General View



General view 05



General view 06

General View



General view 07

Photo Record



T1 (Overview)



T2 (Overview)



T3 (Overview)



T4 (Overview)

Photo Record



T5 (Overview)



T6 (Overview)



T7 (Overview)



T8 (Overview)

Photo Record



T9 (Overview)



T9 Cavity at trunk base



T10 (Overview)



T11 (Overview)

Photo Record



T12 (Overview)



T13 (Overview)



T14 (Overview)



T14 Fungal fruiting bodies

Photo Record



T15 (Overview)



T15 Trace of termite



T16 (Overview)



T16 Trace of termite

Photo Record



T17 (Overview)



T17 Crooked trunk



T18 (Overview)



T18 Co-dominant trunks with included bark

Photo Record



T18 Crack at trunk base